



## wemo WSC010 Stage Smart Scene Controller User Guide

[Home](#) » [WeMo](#) » wemo WSC010 Stage Smart Scene Controller User Guide 

wemo WSC010 Stage Smart Scene Controller User Guide



## Contents

- 1 What's in the box?
- 2 What you'll need
- 3 Quick setup
  - 3.1 Adding to Apple Home
  - 3.2 Creating scenes
  - 3.3 Assigning scenes
- 4 Example scenes
- 5 Status light
  - 5.1 Installing or changing battery
- 6 Troubleshooting
- 7 Wall-mounting
- 8 Have questions?
- 9 Documents / Resources
  - 9.1 References
- 10 Related Posts

## What's in the box?

- Cradle and faceplate (for optional wall-mounting)

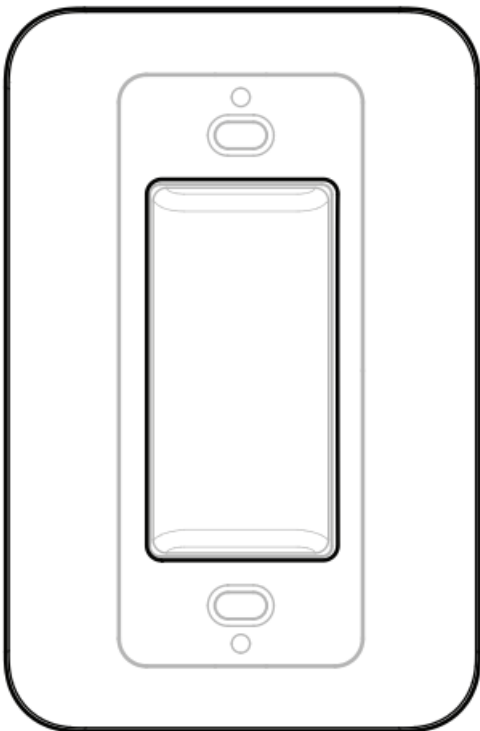

- Controller

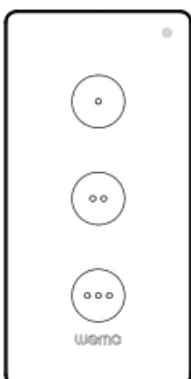

- CR2032 battery (install + side up)



## What you'll need

To control Wemo Stage, you'll need an iPhone or iPad and a HomePod, Apple TV, or iPad set up as a home hub. Make sure your devices have the latest software and operating system updates.

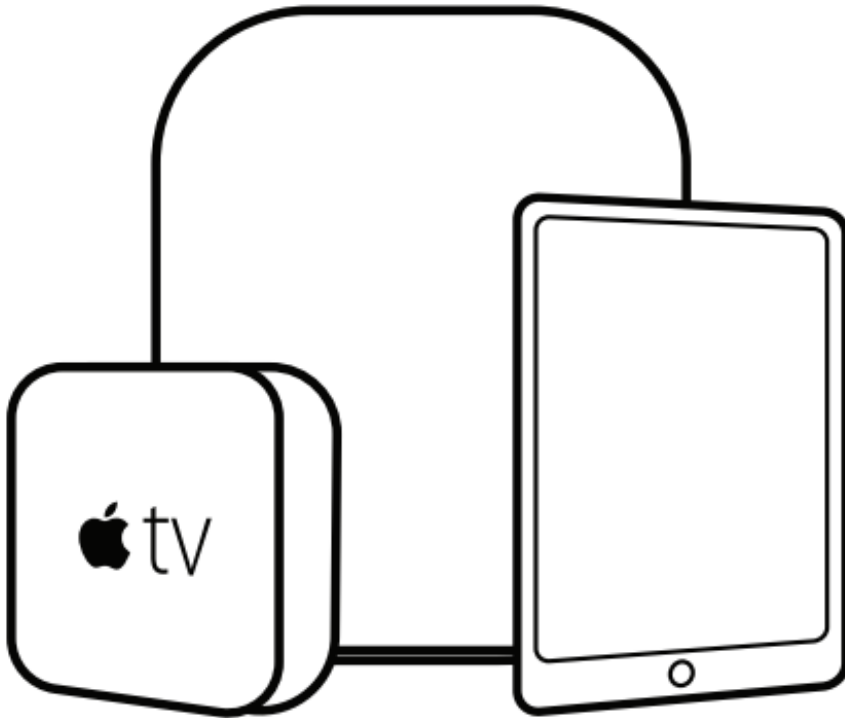

- How to set up a home hub: [support.apple.com/en-us/HT207057](https://support.apple.com/en-us/HT207057)
- HomeKit-compatible devices: [apple.com/ios/home/accessories](https://apple.com/ios/home/accessories)

## Quick setup

Use the Apple Home app to:

1. Add Wemo Stage as an accessory

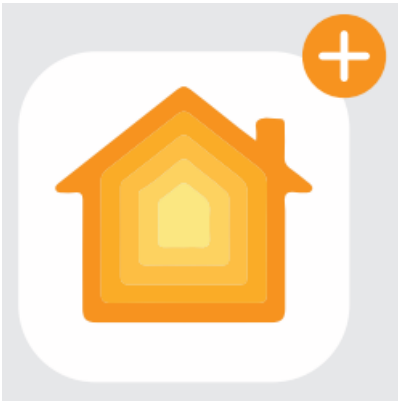

2. Create scenes that control your smart devices

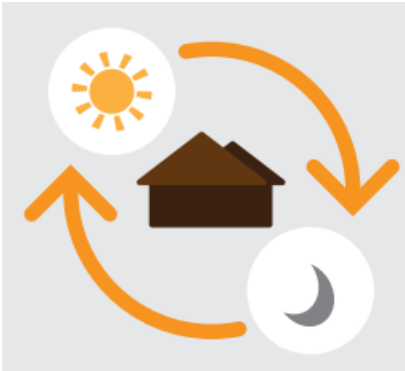

3. Assign scenes to buttons on Wemo Stage

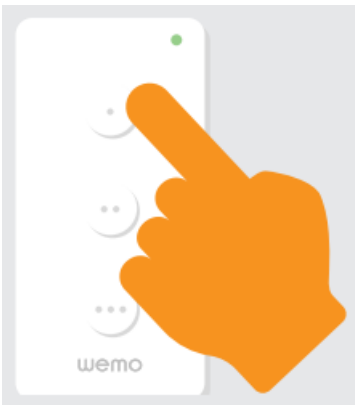

### **Adding to Apple Home**

1. Install battery into the controller with the positive side facing up
2. Wait for the controller to enter setup mode in the Home app (light blinks yellow and green)
3. Launch the Apple Home app
4. Hold your phone near the controller and follow the prompts when they appear

For iPhone X or below, you'll need to add (+) Wemo Stage as an accessory in the Home app.

### **Creating scenes**

Scenes allow you to automatically control single or multiple smart devices with the touch of a button.

### **Creating scenes in the Home app**

1. Add a scene (+) from the Home app
2. Choose a scene name or create a custom name

3. Add accessories (smart devices) to the scene
4. Assign actions to these accessories (example: turn on/off a light)

### Assigning scenes

Your Wemo Stage can trigger up to 6 scenes. Each button can be assigned a scene for a short press or long press.

### Assigning scenes to buttons in the Home app

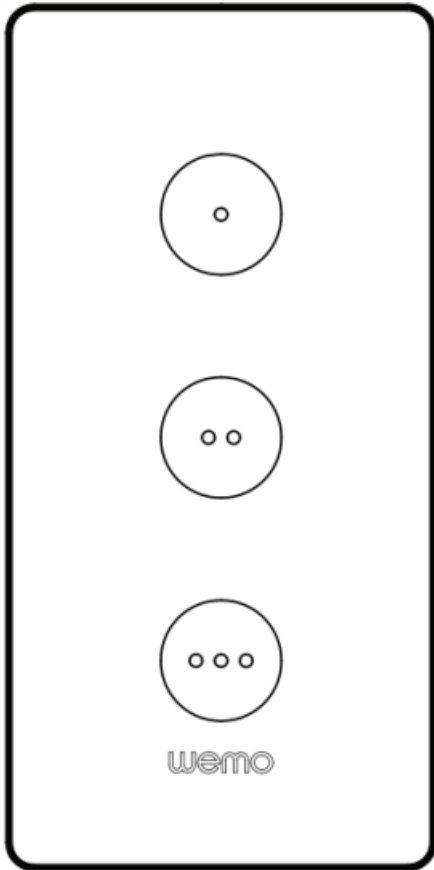

1. Tap your Wemo Stage from the list of accessories
2. Decide which button you want to assign the scene to, then choose short press or long press
3. Assign your scenes

### Example scenes

**Bedtime:** Place Wemo Stage on your bedside table. Before sleeping, press to turn off all your home lights and turn on your security system.









**Entertainment:** Place Wemo Stage on your coffee table. When ready to party, press to dim the lights and turn on the music or TV.



**Guest room on/off:** Give guests control of smart lights, fans, blinds, and other devices in their room.



## Status light

-  **Off**  
Working normally; press any button to show status
-  **Green**  
A scene has been triggered or setup has just completed
-  **Yellow**  
Low-battery level
-  **Blinking Yellow**  
An error has occurred
-   **Yellow and Green (Alternating)**  
Ready for setup

## Installing or changing battery

- Remove the cover on the back of the controller
- Install CR2032 battery in the compartment positive (+) side up
- Replace back cover

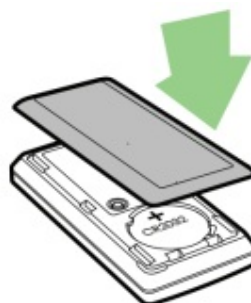
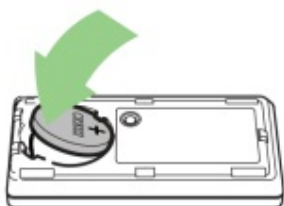

## Troubleshooting

## **Restart**

Having setup or control issues? Remove and re-insert the battery to restart.

## **Factory restore**

If a restart doesn't help, factory restore your controller.

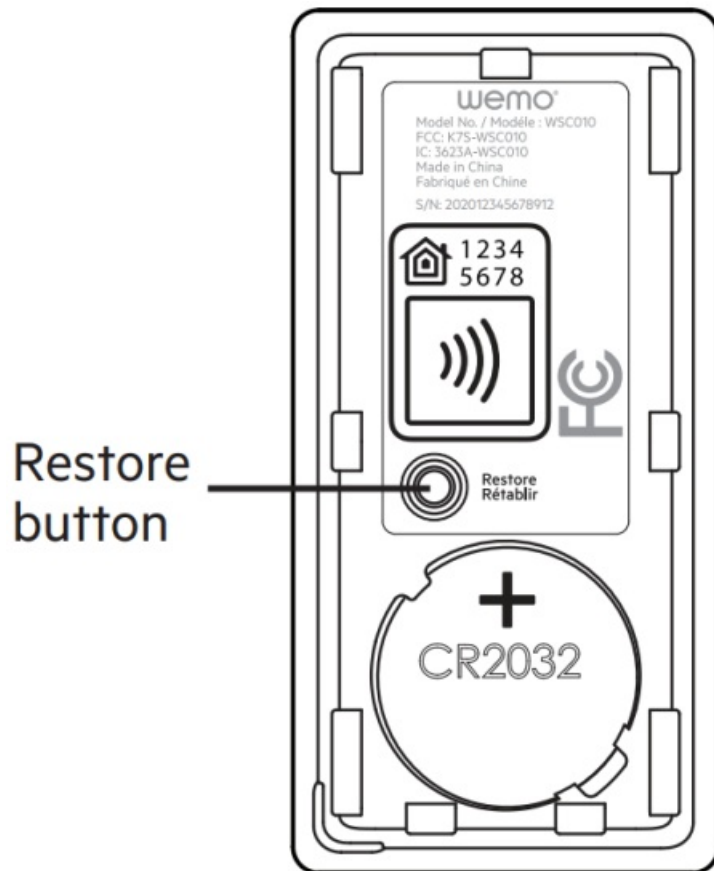

1. Press and hold Restore button for 5 seconds
2. Wait for the light to blink yellow, then green and release
3. Re-add your Wemo Stage to Apple Home and reassign scenes to buttons

## **Wall-mounting**

- Thoroughly clean wall surface.  
Remove the paper from the adhesive strips on the back of the cradle.
- Attach the cradle to the wall

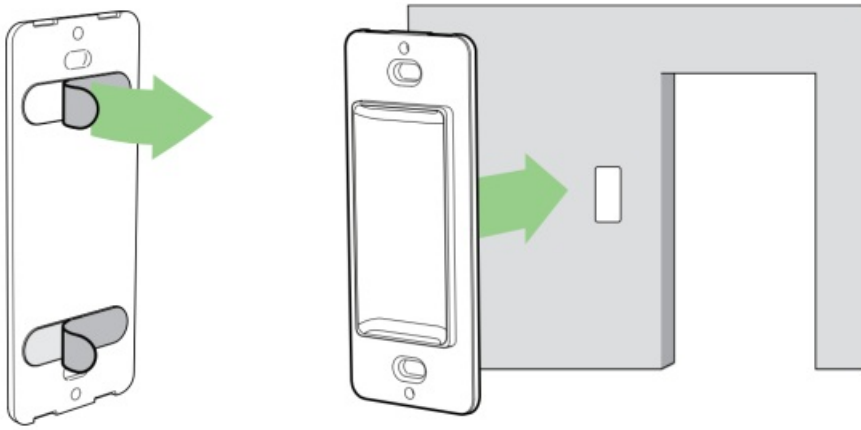

- Snap the faceplate onto the mounted cradle
- A magnet in the controller holds it to the wall mount

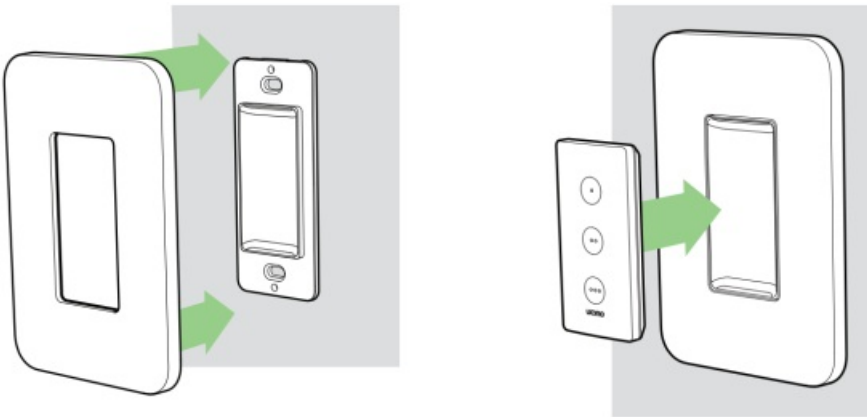

## Have questions?

- HomeKit Setup Code



Keep this HomeKit Code handy in case you need it for setup later

- Wemo Stage Support







Visit [wemo.com/stage](https://wemo.com/stage) for support with your Wemo Stage or call us at 1-844-745-WEMO.





For warranty information, go to [wemo.com/warranty](https://wemo.com/warranty)



## Documents / Resources

	<a href="#">wemo WSC010 Stage Smart Scene Controller</a> [pdf] User Guide WSC010, K7S-WSC010, K7SWSC010, WSC010 Stage Smart Scene Controller, Stage Smart Scene Controller
	<a href="#">wemo WSC010 Stage Smart Scene Controller</a> [pdf] User Guide 08346, K7S-08346, K7S08346, WSC010 Stage Smart Scene Controller, WSC010, Stage Smart Scene Controller

## References

-  [Home app - Accessories - Apple](#)
-  [Set up your HomePod, HomePod mini, Apple TV, or iPad as a home hub - Apple Support](#)
-  [WEMO](#)
-  [Wemo Stage Scene Controller with Thread | Belkin](#)
-  [Belkin - Warranty Center](#)