

weinmann 9100 Multi Layer Pipe Ring



## weinmann 9100 Multi Layer Pipe Ring User Manual

[Home](#) » [WEINMANN](#) » weinmann 9100 Multi Layer Pipe Ring User Manual 

### Contents

- 1 weinmann 9100 Multi Layer Pipe Ring
- 2 Product Usage Instructions
- 3 DESCRIPTION
- 4 FEATURES
- 5 LEADING DIMENSIONS
- 6 OVERVIEW
- 7 Documents / Resources
  - 7.1 References



weinmann 9100 Multi Layer Pipe Ring



### Product Specifications

- **Model:** 9100
- **Working Pressure:** 10 bar
- **Working Temperature:** Not specified

## Product Description

This product is a valve assembly consisting of the following components:

1. **CARLOTTA MUTTER**
2. **ANELLO TAGLIATO KLEMMRING CORPO**
3. **ORING EDPM** (EPDM O-rings)
4. **ORING EDPM** (EPDM O-ring)
5. **ANELLO in PTFE** (PTFE ring)

## Product Usage Instructions

### Installation

1. Ensure all components are clean and free from debris.
2. Assemble the parts in the following order: CALOTTA MUTTER, ANELLO TAGLIATO KLEMMRING, CORPO, ORING EDPM, ORING EDPM, ANELLO inPTFE.
3. Tighten all connections securely but avoid over-tightening to prevent damage.

### Maintenance

Regularly inspect O-rings for signs of wear or damage and replace if necessary. Keep the valve assembly clean and lubricate moving parts as needed.

### Operation

To operate the valve, turn the CALOTTA MUTTER to open or close the flow of fluid. Ensure proper pressure and temperature conditions are maintained within the specified limits.

## Frequently Asked Questions (FAQ)

- Q: What is the maximum working temperature for this product?  
A: The maximum working temperature is not specified in the provided information. Please refer to the manufacturer's guidelines or contact customer support for detailed temperature limits.
- Q: How often should the O-rings be replaced?  
A: O-rings should be inspected regularly and replaced if signs of wear or damage are present. As a general guideline, consider replacing O-rings during routine maintenance or if leaks are detected.

## DESCRIPTION

Compression fittings with O-ring for multi-layer pipe.

## FEATURES

- Brass nut and ring
- EPDM O-ring
- PTFE ring
- Working pressure 10bar
- Working temperature  $-20^{\circ}\text{C} +110^{\circ}\text{C}$

## LEADING DIMENSIONS

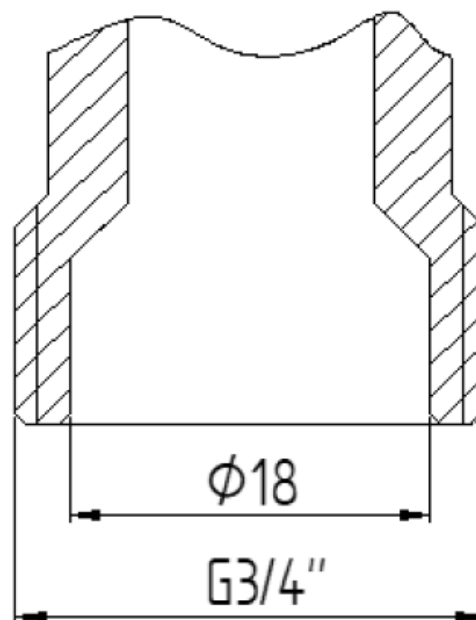
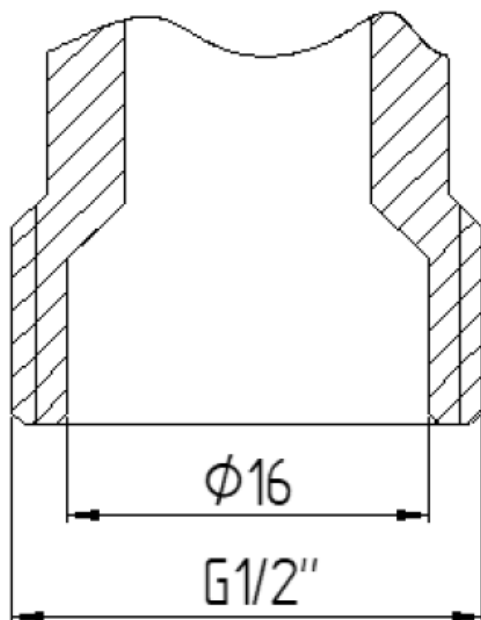

EUROCONO

Multilayer clamping torque PEX-AL-PEX: 25-35 Nm

OVERVIEW

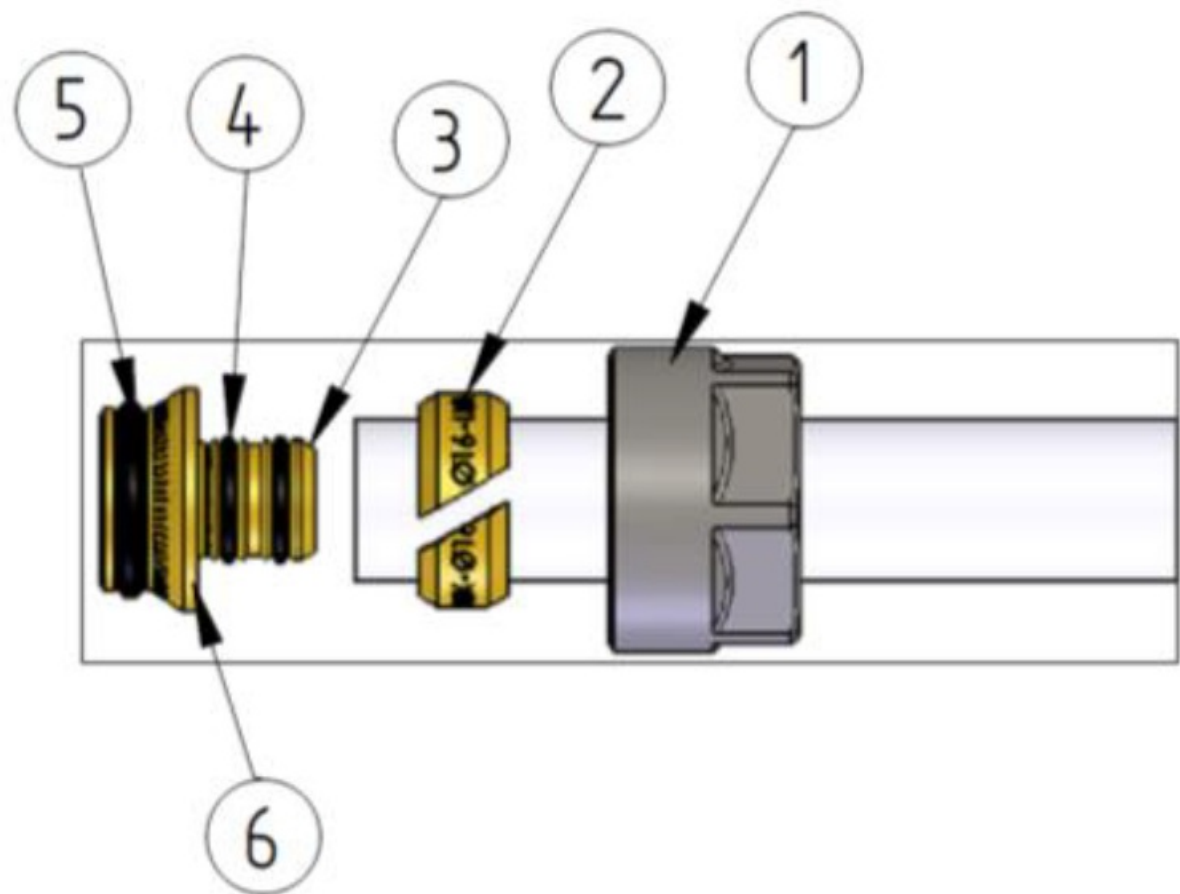

PART NAME
NUT
CUTTED RING
BODY
EPDM O-rings
EPDM O-ring
PTFE ring

Documents / Resources

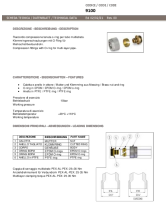
	<p><a href="#">weinmann 9100 Multi Layer Pipe Ring</a> [pdf] User Manual</p> <p>9100 Multi Layer Pipe Ring, 9100, Multi Layer Pipe Ring, Layer Pipe Ring, Pipe Ring, Ring</p>
---	---

## References

- [User Manual](#)

[Manuals+](#), [Privacy Policy](#)

This website is an independent publication and is neither affiliated with nor endorsed by any of the trademark owners. The "Bluetooth®" word mark and logos are registered trademarks owned by Bluetooth SIG, Inc. The "Wi-Fi®" word mark and logos are registered trademarks owned by the Wi-Fi Alliance. Any use of these marks on this website does not imply any affiliation with or endorsement.