

WeHere® B100 Smart Lock



WeHere B100 Smart Lock User Guide

[Home](#) » [WeHere](#) » WeHere B100 Smart Lock User Guide 

Contents

- 1 WeHere B100 Smart Lock
- 2 Specifications
- 3 B100 Smart lock exterior
- 4 How to install a battery
- 5 B100 smart lock parameters
- 6 APP Download
- 7 APP Register
- 8 APP Use Tutorial
- 9 Product Description
- 10 Customer Q&A
- 11 Documents / Resources
 - 11.1 References
- 12 Related Posts

WeHere®

WeHere B100 Smart Lock



Specifications

- **Unlock method:** Bluetooth/dynamic password/period password/static password
- **Material:** Zinc Alloy
- **Size:** 145*63*26mm
- **Weight:** 0.4kg
- **Battery:** 2*AA (alkaline battery, not included)
- **Battery Life:** 1 year

B100 Smart lock exterior



How to install a battery



1.unscrew



2.Open the battery compartment



3.Install battery

How to install a lock

1. B100 is installed externally on the product

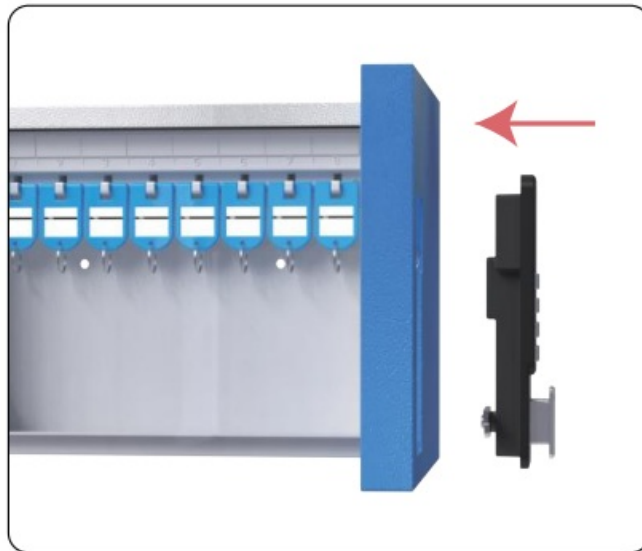

2. Install screws from the inside



B100 smart lock parameters

Unlock method	Bluetooth/dynamic password/period password/ static password
Material	Zinc Alloy
Size	145*63*26mm
Weight	0.4kg
Battery	2*AA (alkaline battery, not including)
Battery Life	1 year

APP Download

1. Scan the QR code below, or visit the website to download the APP and register for an account.
2. Or you can also search“ Wehere ” in Google play or App store to download the app and register an account.



- <https://wehereapp.we-here.com/en/app.html>

Roles in the system

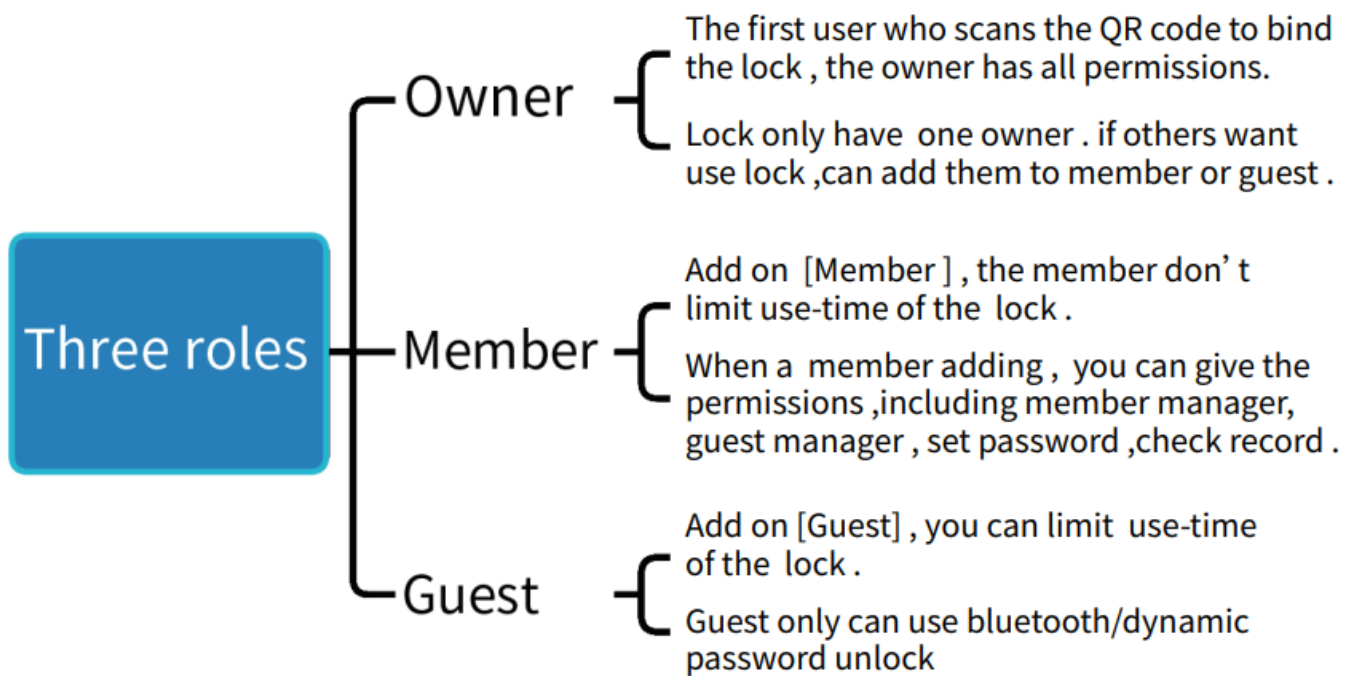

APP Register

Three registration methods

1. Phone registration (need to enter sms code)
2. Email registration (need enter the Email verification code)
3. User-defined account registration

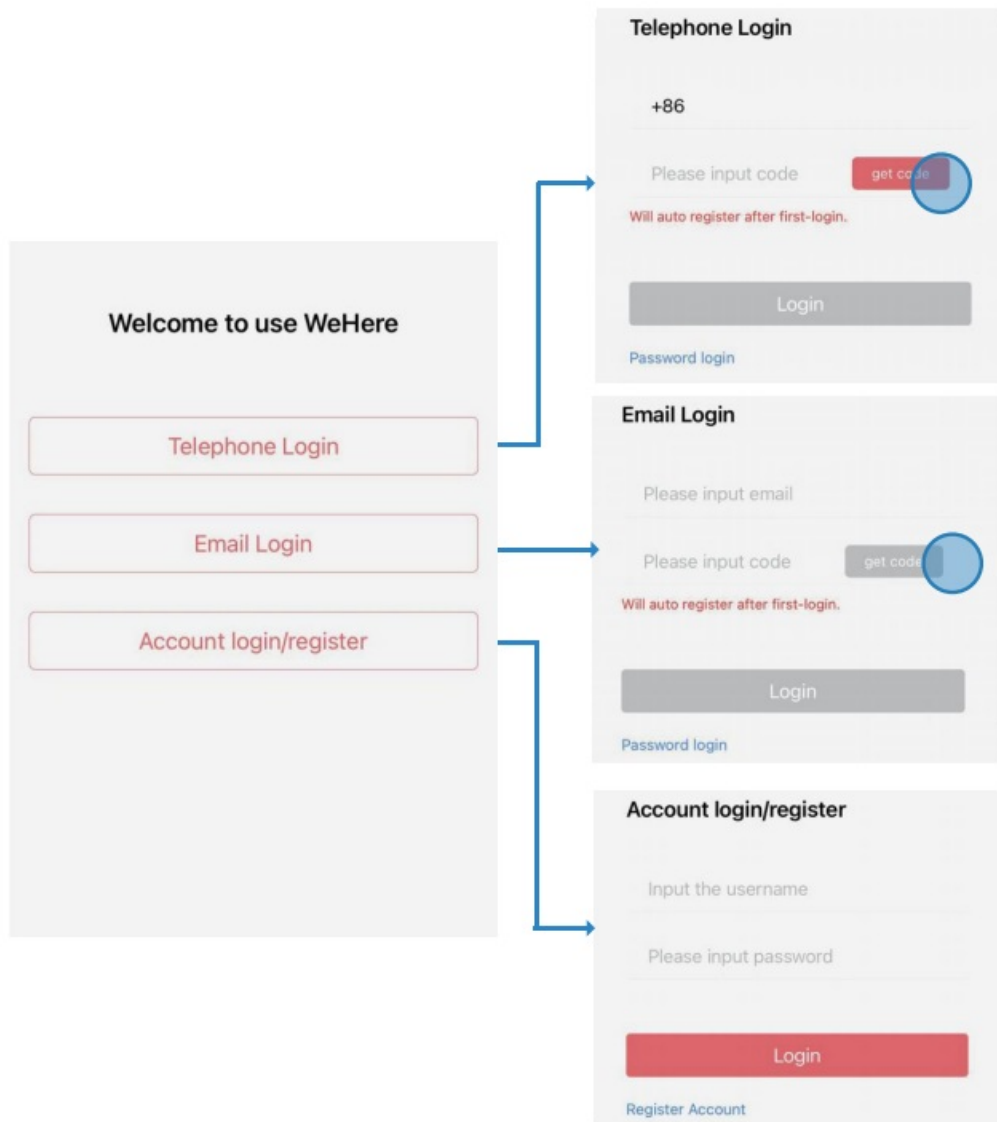

APP Use Tutorial

How to add the lock to where the app

- You can scan the qr code of the lock to bind the lock. the person who first binds the lock is the lock owner, and has all permissions.
 - (Note: the owner can manager members/guests, set passwords, and hand over the lock) (The owner/member who has the permission can add [Member] or [Guest])

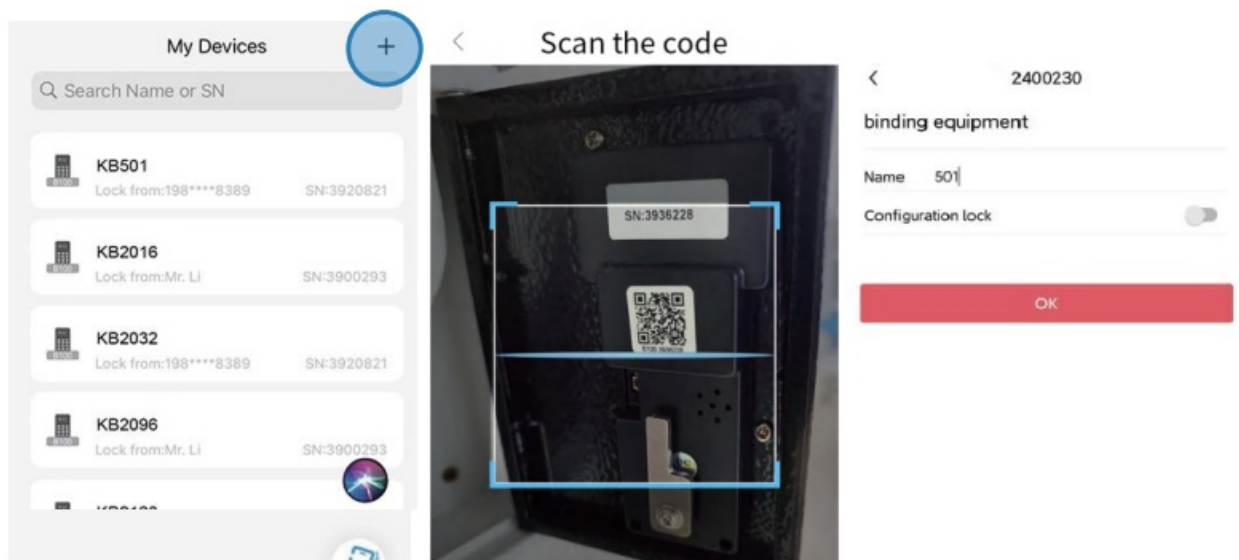

How to share access rights to others

- The owner /member who have permission can add [Member] or [Guest]
- (Note: when adding a member , can give the permissions , including member manager, guest manager, set password,check record .)
- Open [Member] and click on the “+” to add member.

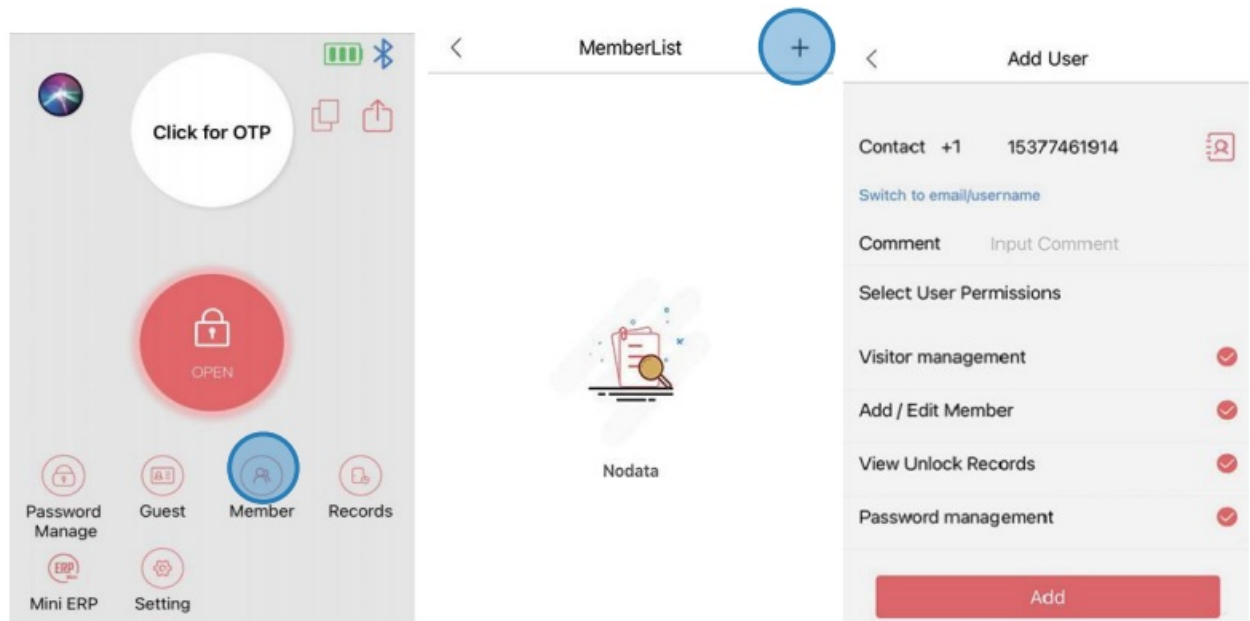

After the members added, they can login the account and see the lock on the [My Devices] page. if don't see, pull down to refresh.

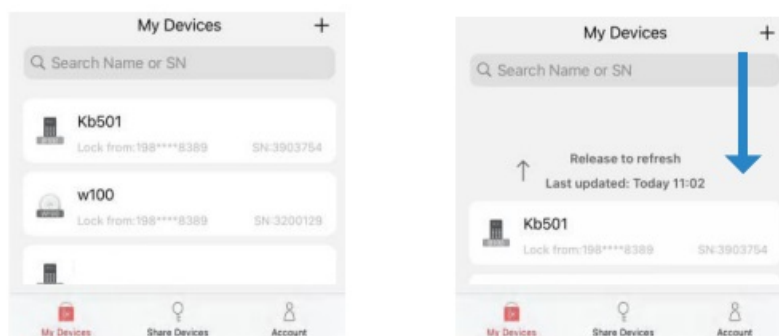

Open [Guest] and click on the “+” to add Guest.

(When adding guest, you can also set the access time. You don't need to delete the guest , the lock can not open when time expired when time expired)

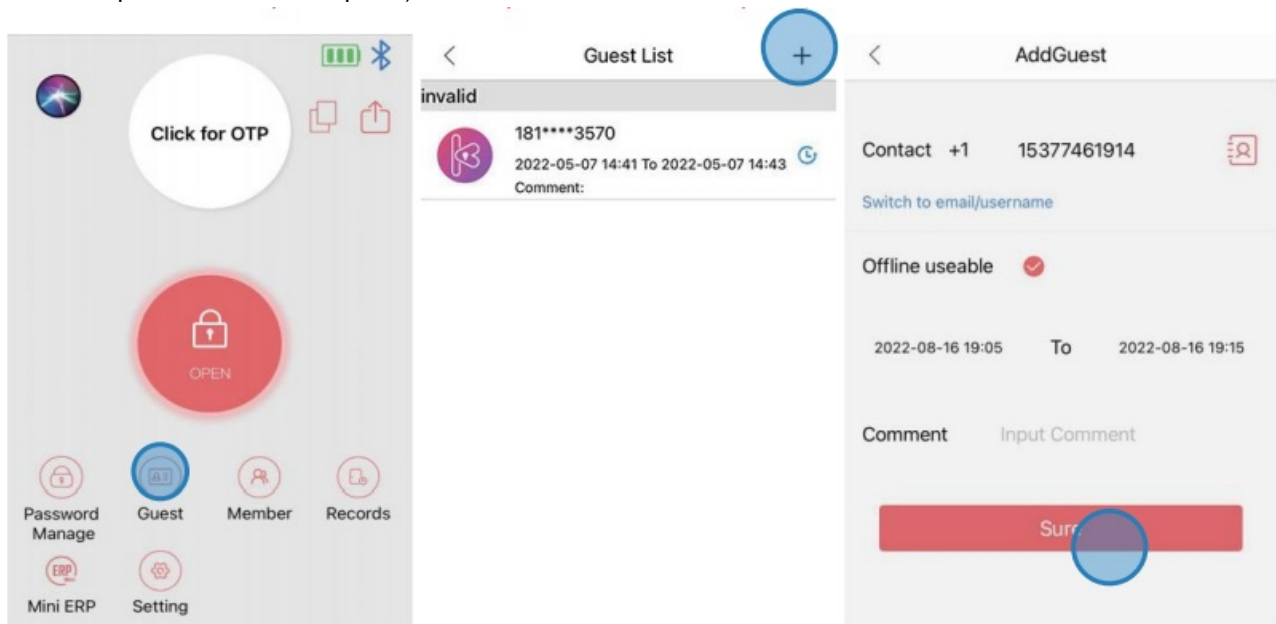

After the guests added , they can login the account and see the lock on the [share Devices] page. if don't see, pull down to refresh.

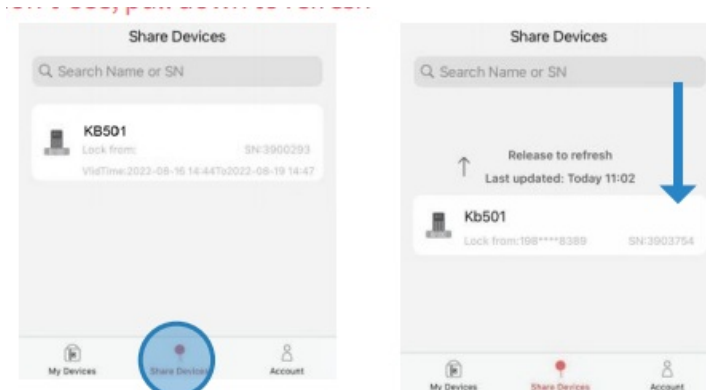

How to set password

- Dynamic password change each minute.

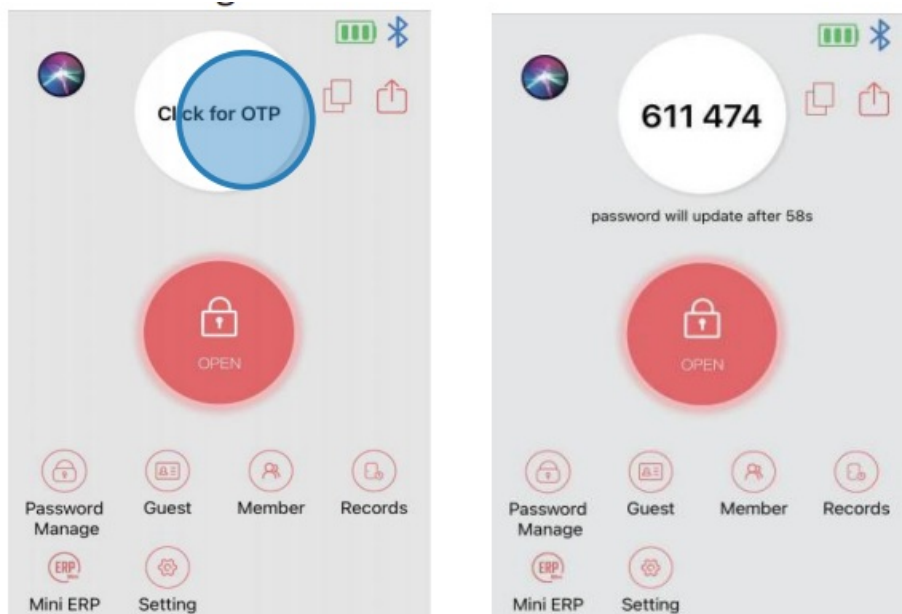

- Period password (you can set the password validity time)

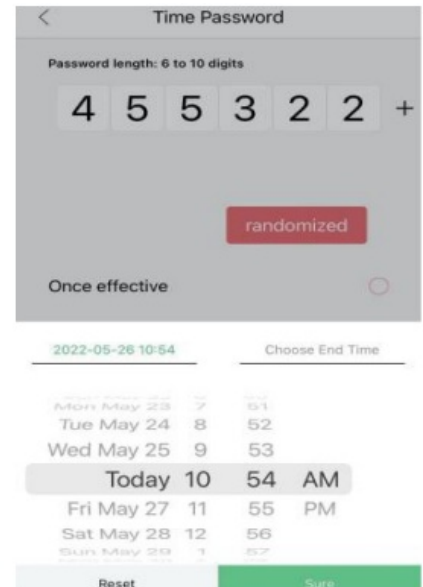
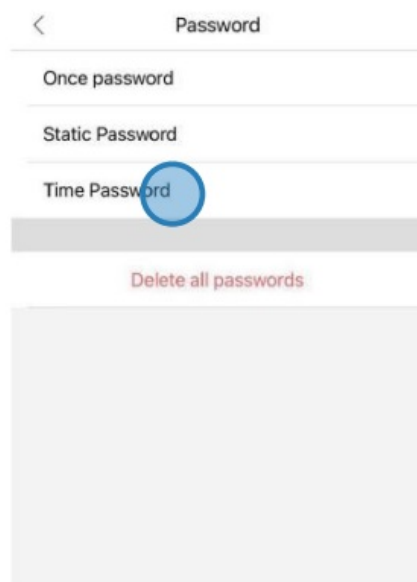
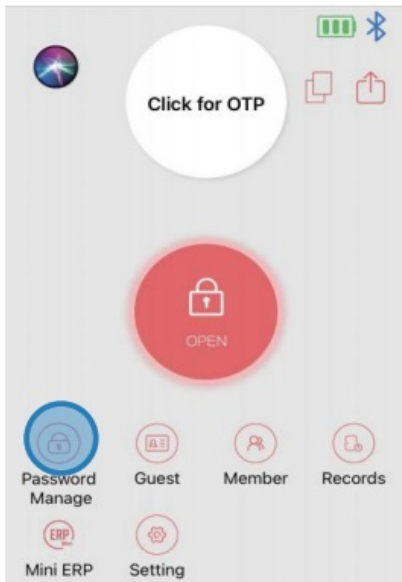

- Static password.

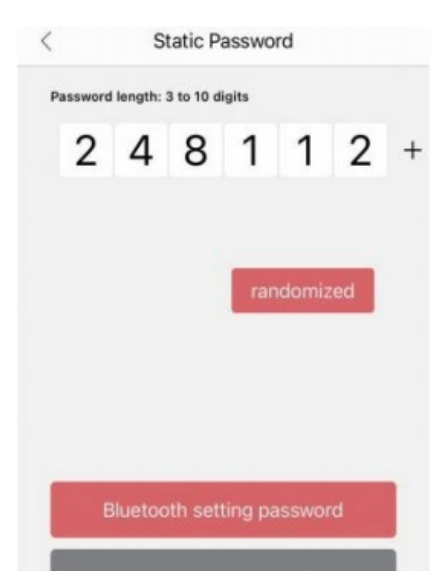
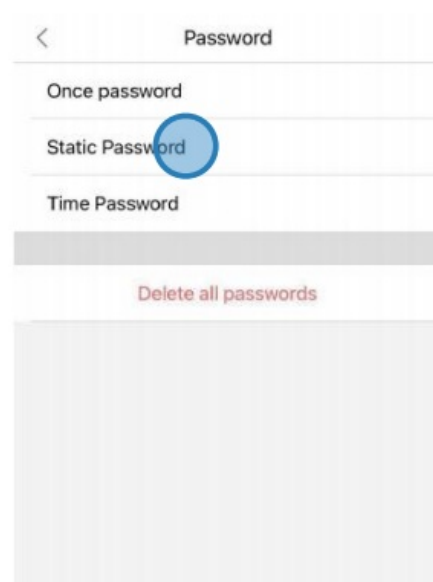
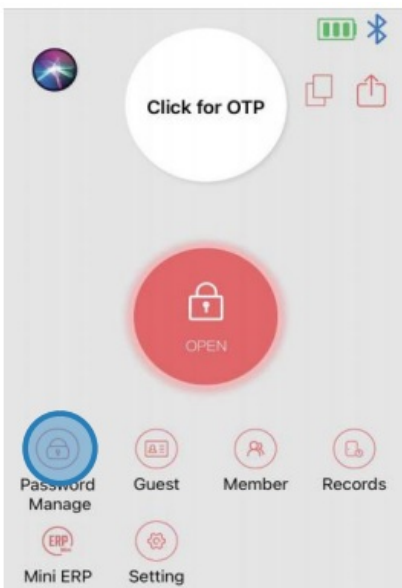

Two of Unlocking methods

1. Bluetooth unlocking

(If your lock page is [click for OTP], click left lower corner icon [Bluetooth] to switch .)

2. Password unlocking

(You can use static/period password unlocking that you set before .For dynamic password, click the center icon [click for OTP] to get)

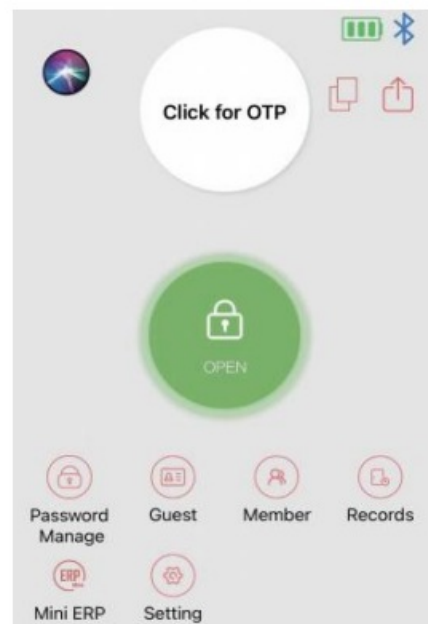
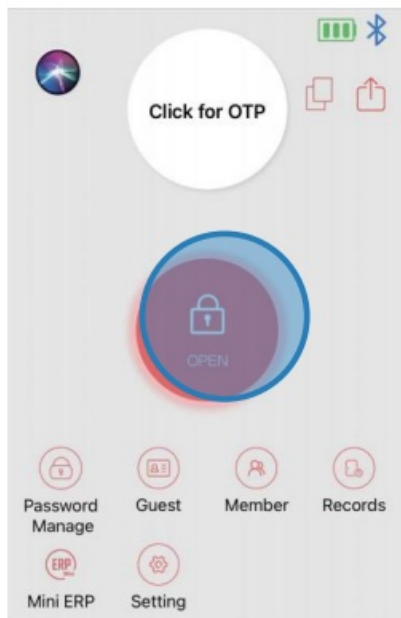

How to check record

The owner (member who have the permission) can check the records.

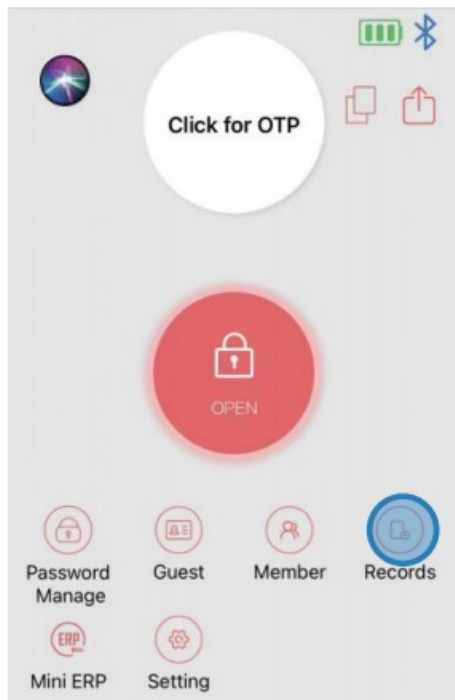

Kb2016		
PreDay	2022-05-26	NextDay
	Get otp 198****8389 19864588389	10:26
	Get otp 198****8389 19864588389	10:26
	Get otp 198****8389 19864588389	10:26
	198****8389 19864588389	09:51
	198****8389 19864588389	09:51
	198****8389 19864588389	09:51
	198****8389 19864588389	09:51

How to share Dynamic Password by URL

- Go to lock manage page, open [Share] icon,click on [Add OTP Url].

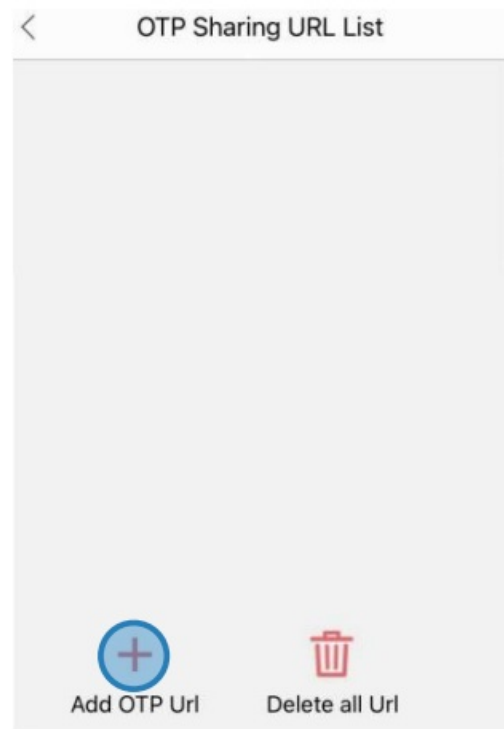
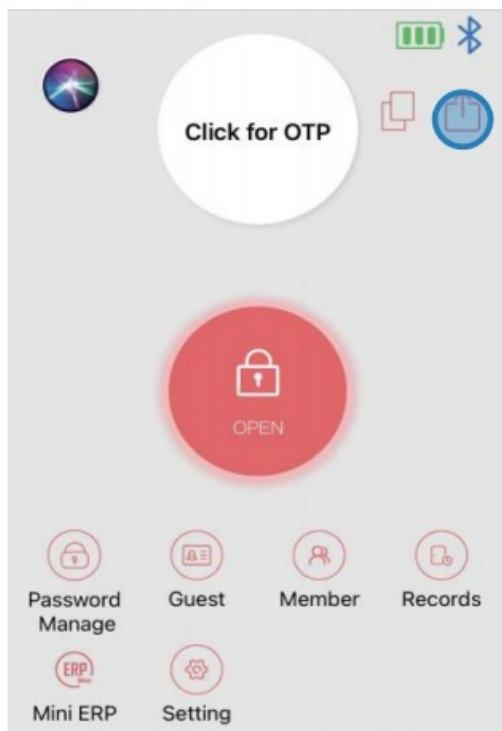

- You can set the Url access time by setting start time and send time. Click to save this url share.

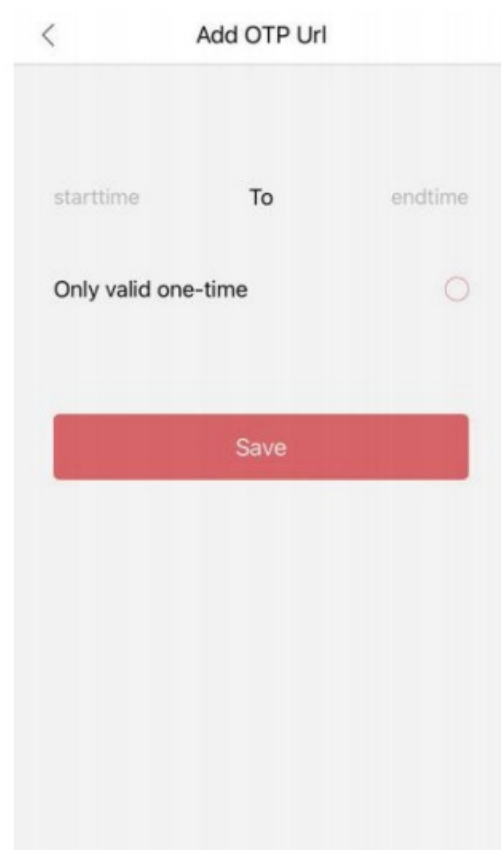
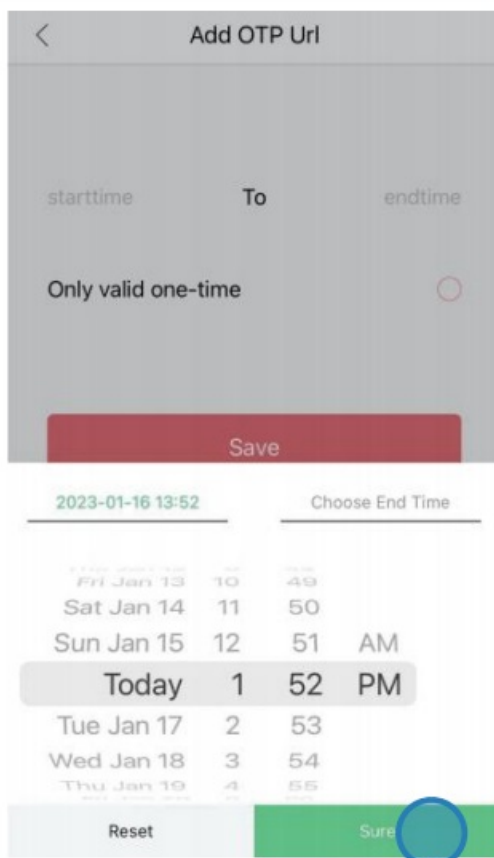

- Click on [Copy] icon, then can copy the url message, and send this to your friend/guest by message.

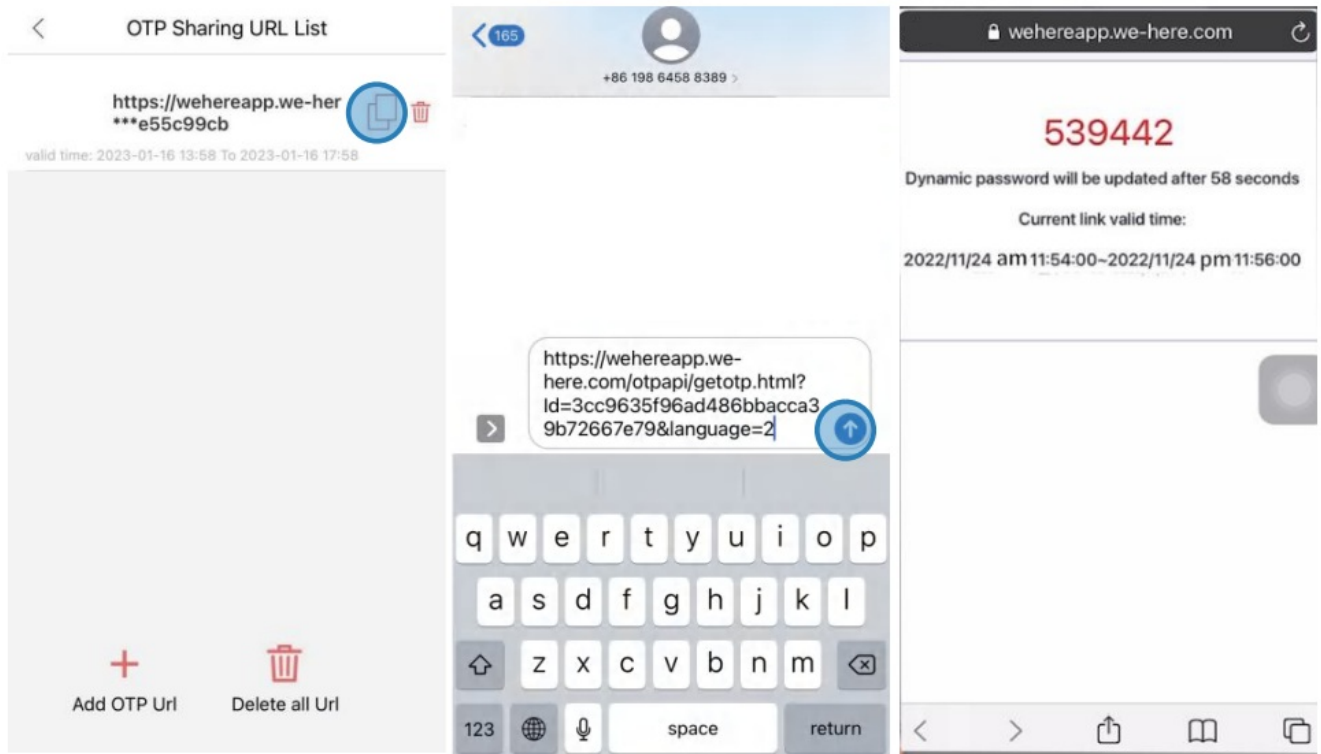

- You also can delete the Url shared, after you delete, the Url can not access anymore.

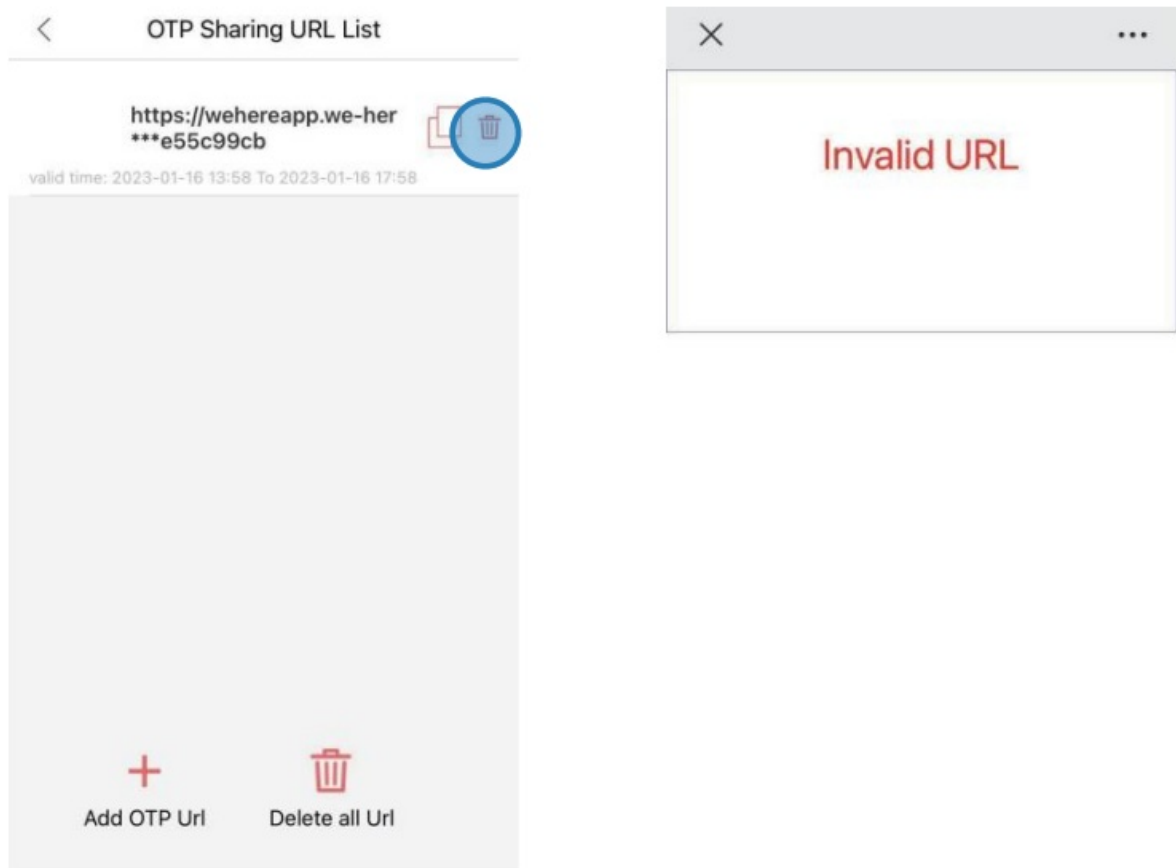

Mini ERP

- Go to lock manager page, open [MiniERP] ,enter your keybox position number

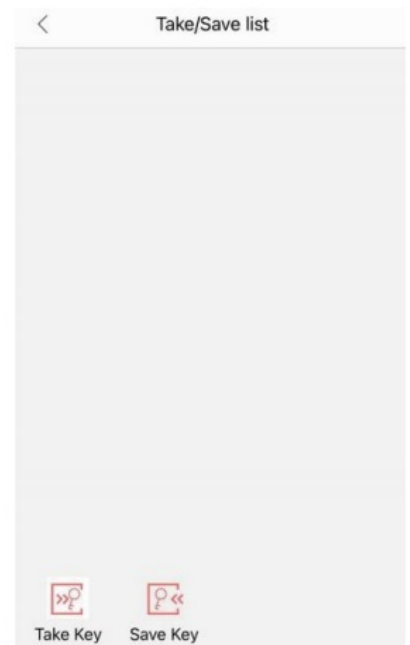
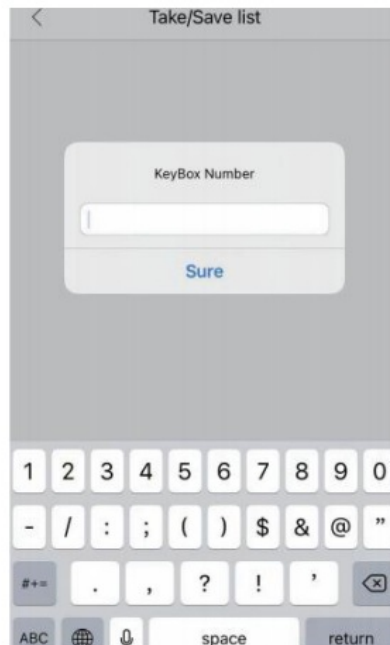
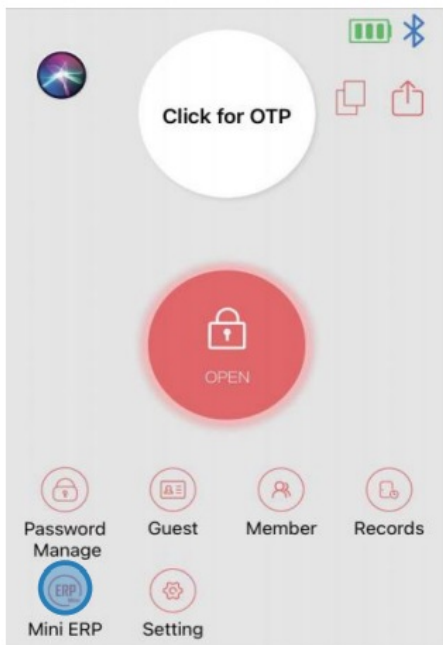

- Click [Save key] icon, choose key position ,and input comment.

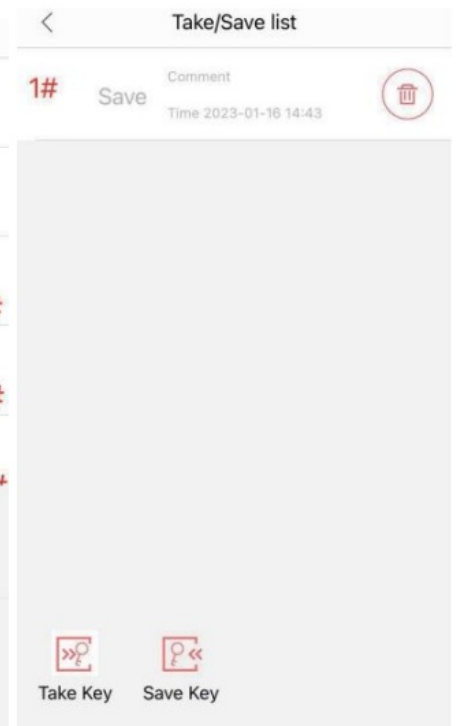
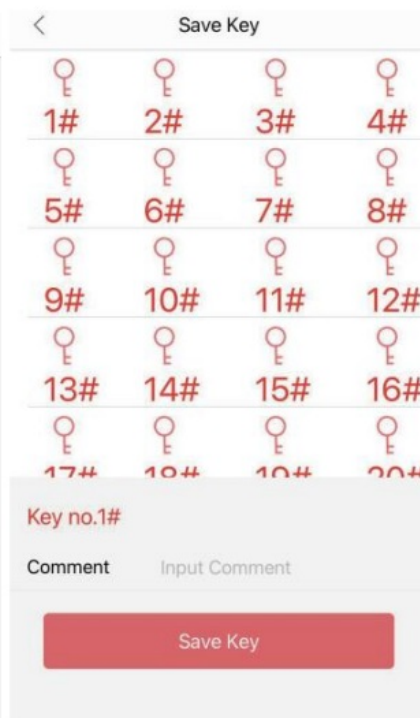
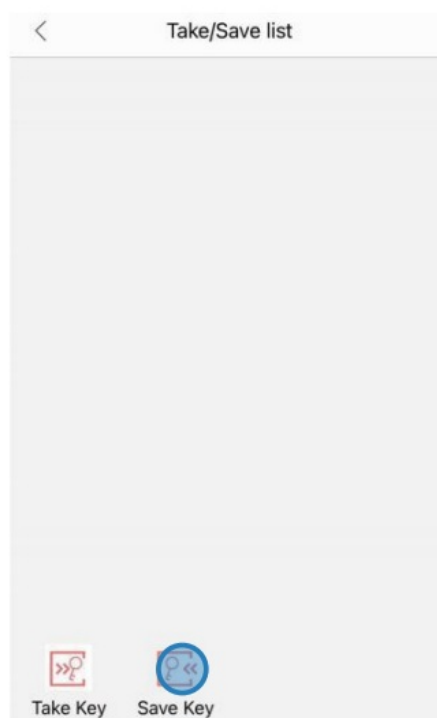

- Click [Take key] icon, choose key postion, and input comment

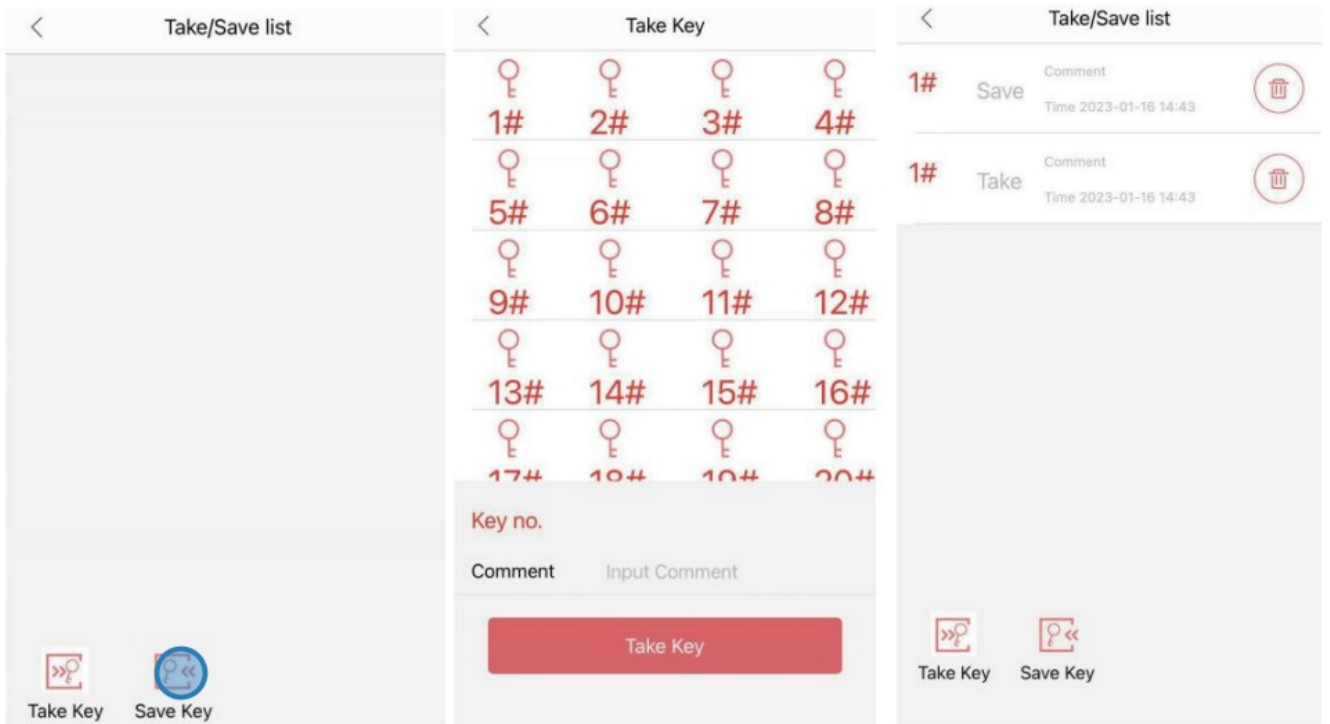

- click [🗑️] icon, and delete the record.

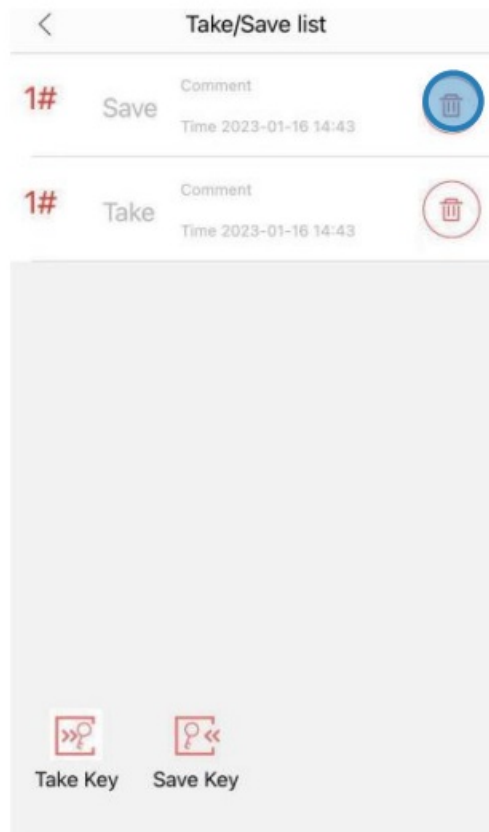

How to delete the lock

Click the lock you want delete, Open [Setting] and click on [Delete lock].

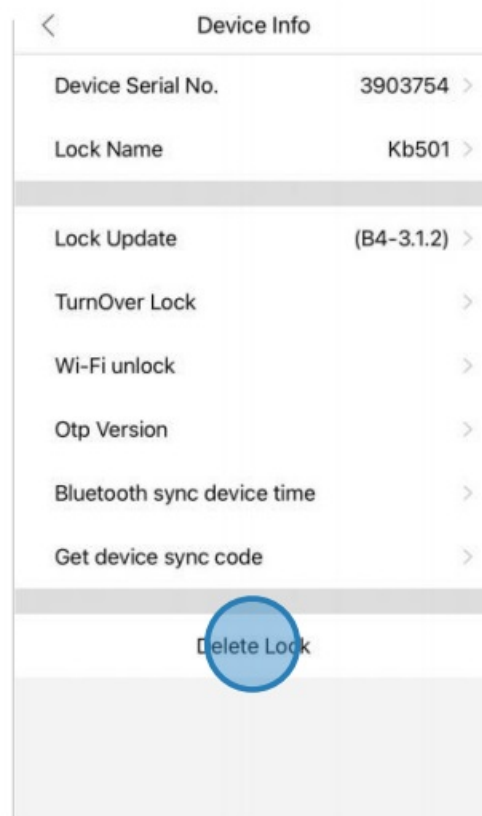
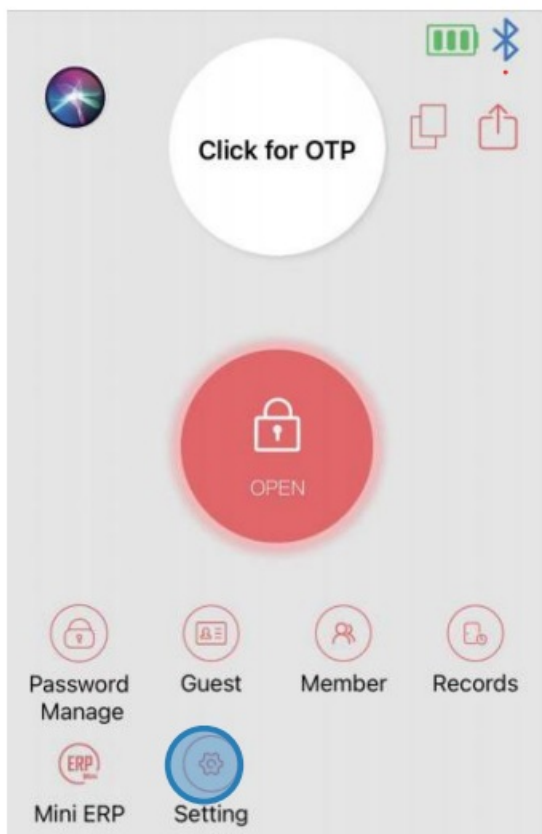

How to transfer the lock

Click the lock you want transfer, Open[Setting] and click on [TurnOver Lock] Enter the account you want to transfer, then this person will be the new owner of this lock.

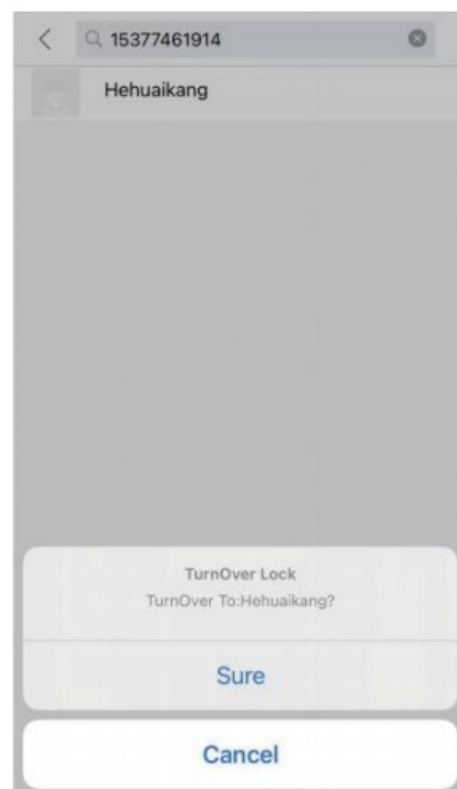
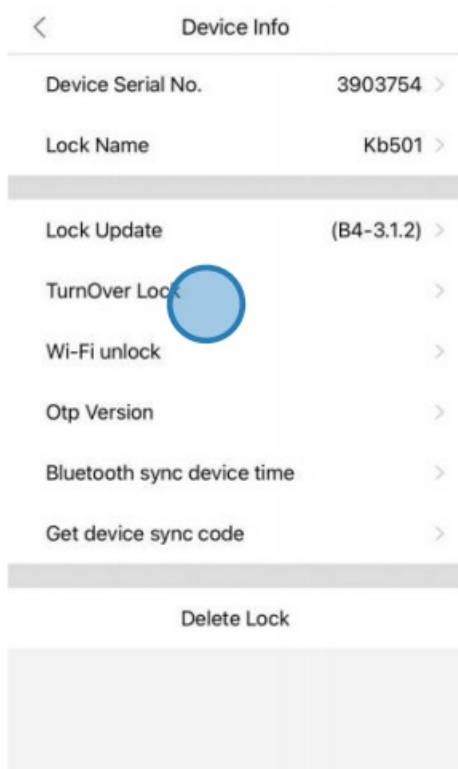

Product Description

SmartSteel key management box

W:286mm
H:210mm
L:59mm



KB2016 (Blue /Black)

W:406mm
H:210mm
L:59mm



KB2024 (Blue /Black)

W:286mm
H:361mm
L:59mm



KB2032 (Blue /Black)

W:286mm
H:550mm
L:59mm



KB2048 (Blue /Black)



W:550mm
H:406mm
L:59mm



KB2072 (Blue /Black)



W:650mm
H:406mm
L:59mm



KB2096 (Blue /Black)



W:805mm
H:406mm
L:59mm



KB2120 (Blue /Black)



W:685mm
H:406mm
L:110mm



KB2192 (Blue /Black)

Tips: If have many car keys or large keys to store ,using usingthe Plus version will not interfere the box door close



KB7024Plus (Blue /Black)

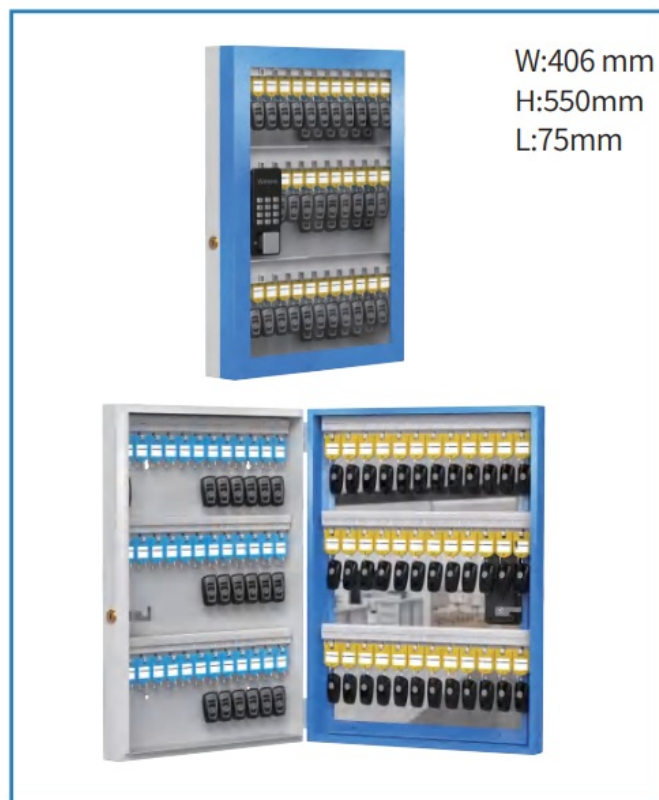

KB7072Plus (Blue /Black)



KB2032Plus (Blue /Black)



KB2096Plus (Blue /Black)

Smart Small Steel key management box



W:105mm
H:185mm
L:45mm

KB501 (Blue /Black)



W:140mm
H:212mm
L:68mm

KB503 (Blue /Black)

New

W:170mm
H:214mm
L:68mm

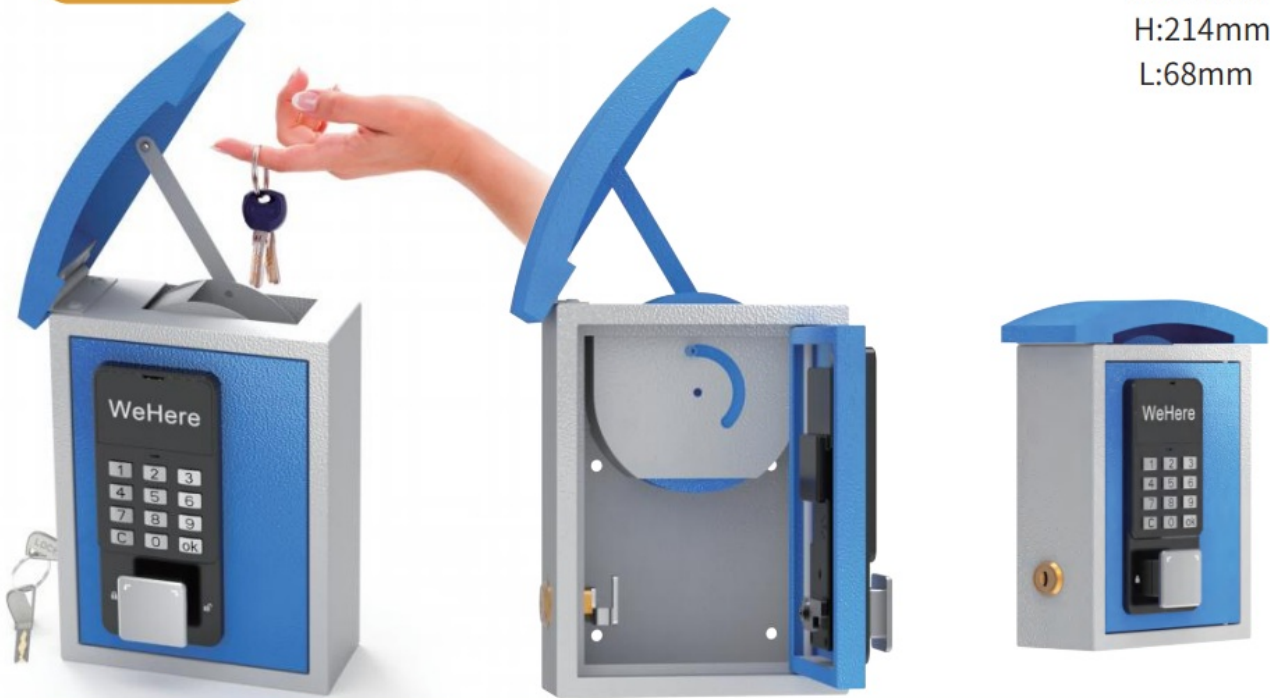

KB521 (Blue /Black)

New

W:450mm
H:805mm
L:110mm



KB3104 (Blue /Black)

SFB1001



W:280mm
H:220mm
L:220mm

SFB1002



W:430mm
H:220mm
L:370mm

SFB1003



W:430mm
H:270mm
L:370mm

Customer Q&A

to get the OTP code, then send the code via SMS/WhatsApp to somebody who near the lock to unlock; 2. Share App You can ask your peopel to install WeHere App on his phone and regist account, then you add his account

into Member/ Guess list to share lock,then he can unlock; 3. Via W100 If you buy our W100(Wifi-Bluetooth bridge), then you can via wifi to remote unlock directly; also You can via W100 to Set/ delete period password/static password remotely;" image-9="" count="10" html="true" css_class=""]

Shenzhen Seamooncloud Technology Co., Ltd.

E-mail: service@we-here.com

Tel: +86-755-26052705

web: we-here.com

Add: The 2nd Floor,B1 Tower Of Jinshun Industrial Park, Anliang Anju Road,Henggang, Longgang, Shenzhen, China

Documents / Resources

	<p>WeHere B100 Smart Lock [pdf] User Guide B100, B100 Smart Lock, Smart Lock, Lock</p>
---	--

References

- [The brand of intelligent home furnishing under the brand of Seamooncloud provides intelligent home furnishing products and services](#)
- [User Manual](#)

[Manuals+](#), [Privacy Policy](#)

This website is an independent publication and is neither affiliated with nor endorsed by any of the trademark owners. The "Bluetooth®" word mark and logos are registered trademarks owned by Bluetooth SIG, Inc. The "Wi-Fi®" word mark and logos are registered trademarks owned by the Wi-Fi Alliance. Any use of these marks on this website does not imply any affiliation with or endorsement.