



we are rewind WE-001 Cassette Player and Recorder User Guide

[Home](#) » [we are rewind](#) » we are rewind WE-001 Cassette Player and Recorder User Guide 

we are rewind WE-001 Cassette Player and Recorder User Guide



Contents

- [1 SAFETY INSTRUCTIONS](#)
- [2 CHARGE THE BATTERY](#)
- [3 CASSETTE PLAYBACK](#)
- [4 ASSETTE RECORDING](#)
- [5 CONNECTING WIRELESS HEADPHONES](#)
- [6 Documents / Resources](#)
 - [6.1 References](#)
- [7 Related Posts](#)

SAFETY INSTRUCTIONS

- Read, follow and keep these instructions.
- Heed all warnings.
- Clean the unit only with a soft, dry cloth.
- Do not expose the unit to dripping or splashing.
- Do not subject the unit to extreme conditions (force, shock, dust, sand, humidity, cold, heat).
- Do not place or operate the unit near heat sources such as radiators, stoves or other equipment that produces heat.
- Do not place naked flame sources, such as lighted candles, on the unit.
- Keep the unit away from interference sources such as fluorescent lights or electric motors.
- **Caution:** danger of explosion if batteries are replaced incorrectly – the battery and all other parts of this unit are not user-serviceable.
- **Caution:** at full power, prolonged listening via headphones or earphones can damage the user's hearing. To prevent excessive sound levels, set the volume to a low level first, then increase it gradually until the sound can be heard comfortably and without distortion.
- Do not use headphones or earphones while driving a motorized vehicle or riding a bicycle. This is dangerous and also illegal in some states or countries.
- While using headphones or earphones, decrease the volume when you cross roads or need to pay attention to external sounds.

CHARGE THE BATTERY

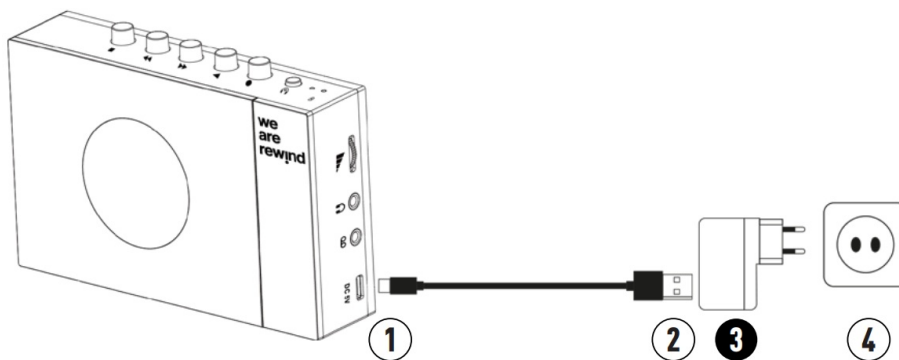

3 5V/1.5A minimum not included

- **While charging:** red
- **Battery full:** light off
- **Durant la charge:** rouge

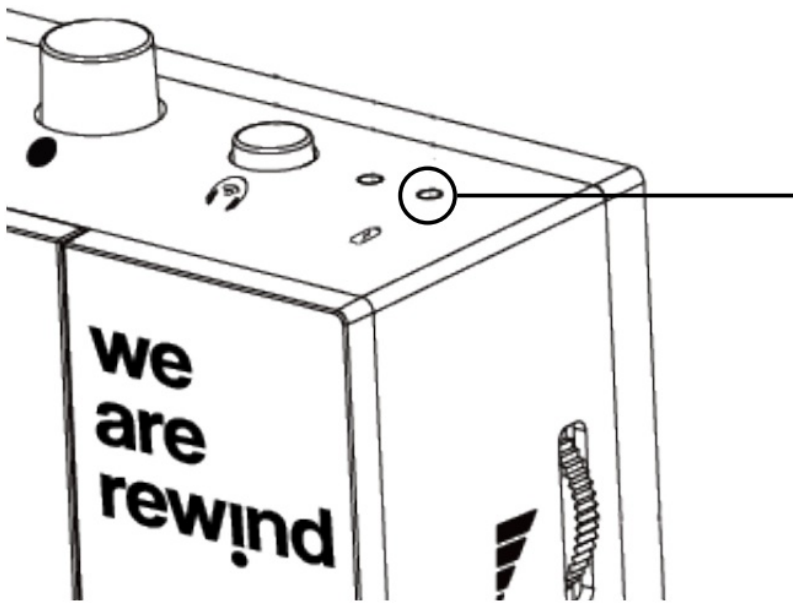

CASSETTE PLAYBACK

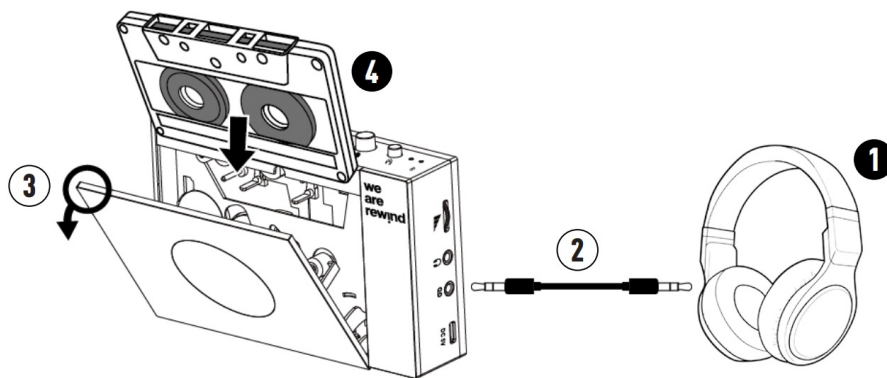

Not included
Pre-recorded cassette

Play

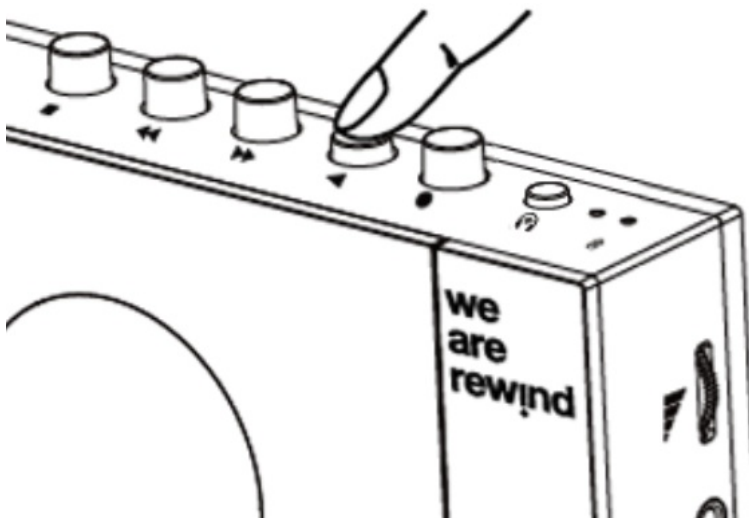

Volume+/-

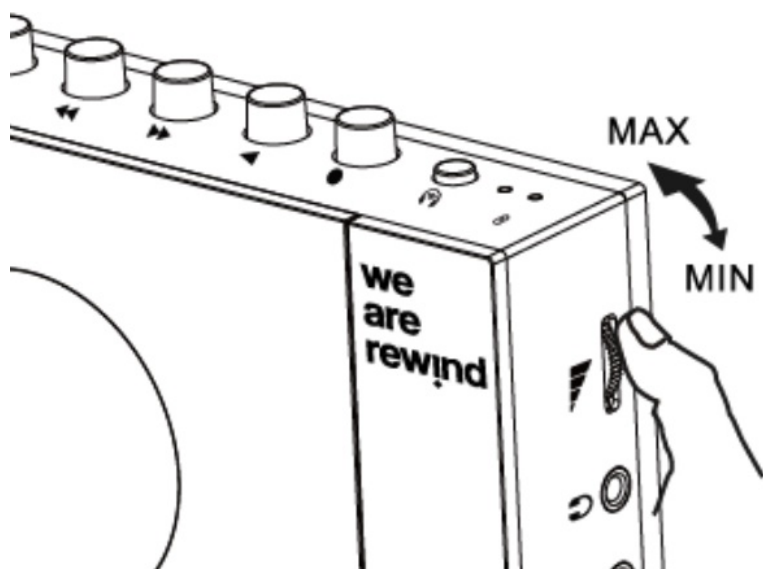

Stop

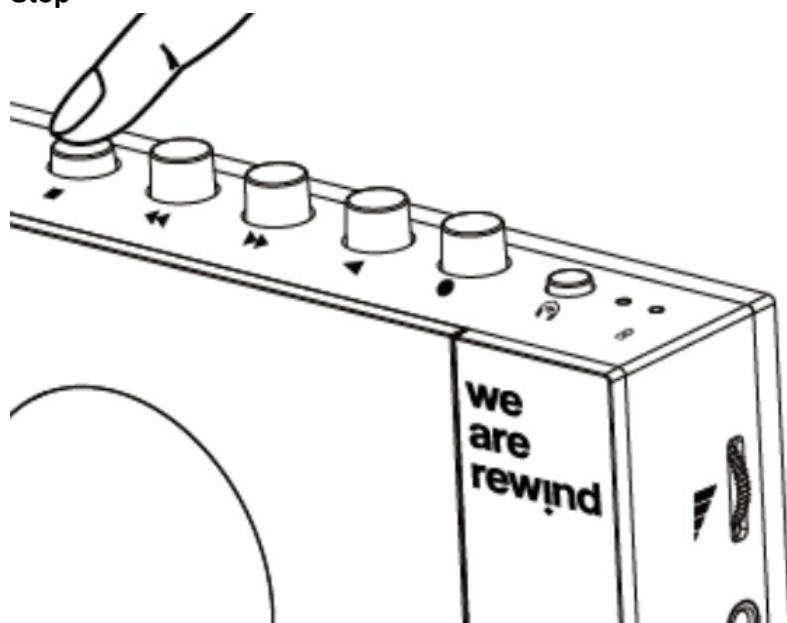

Fast forward

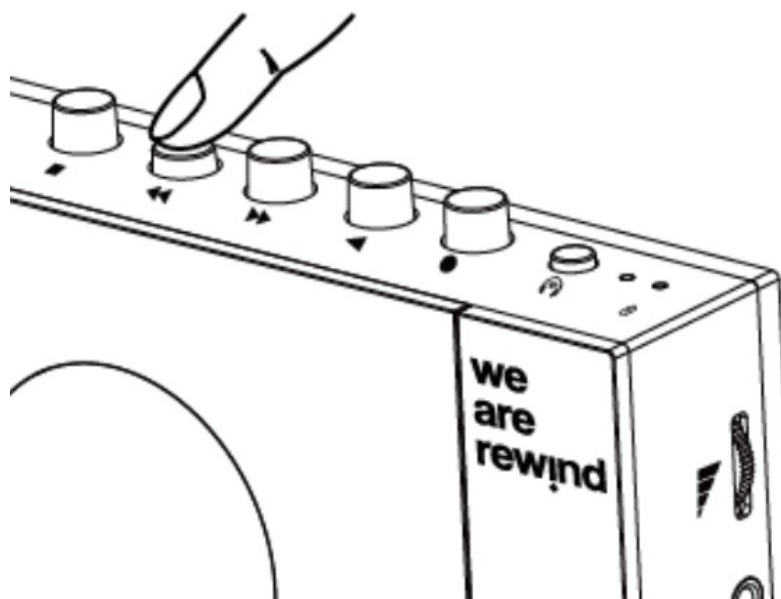

Rewind

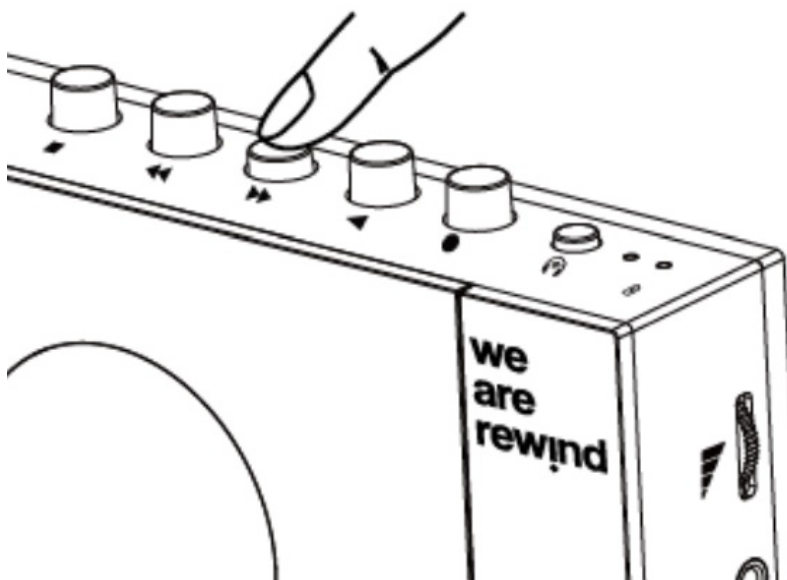

ASSETTE RECORDING

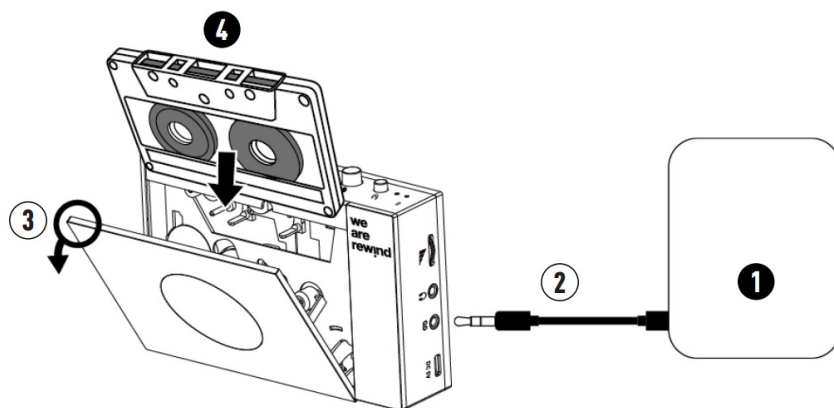

- Music source
- Blank cassette
- Record

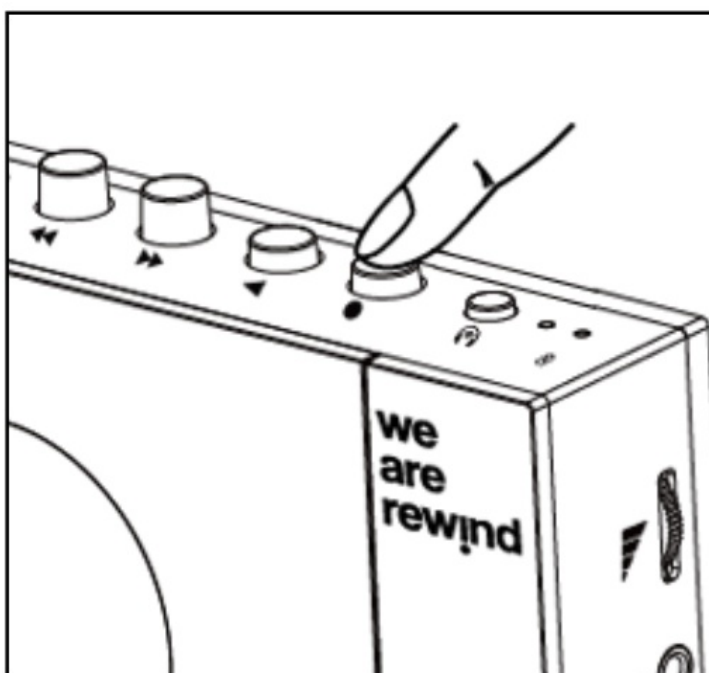

- Recording stop

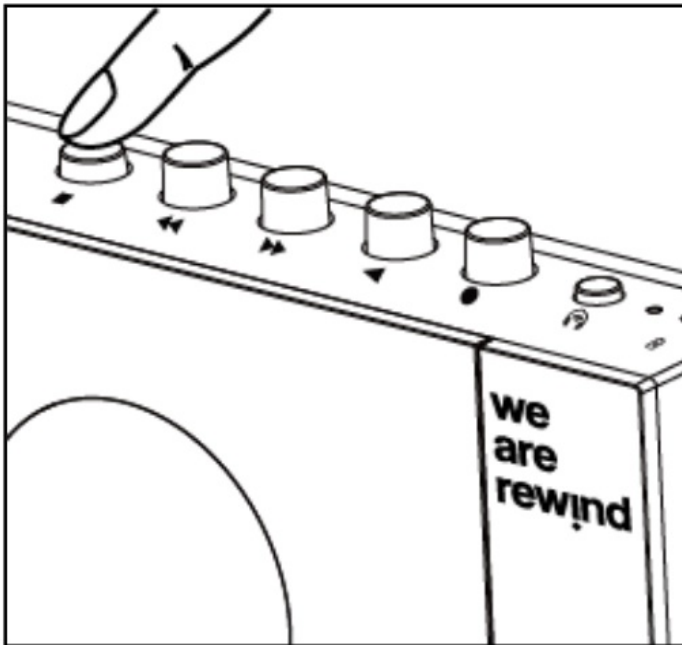

CONNECTING WIRELESS HEADPHONES

1. Switch off other nearby wireless receiving devices

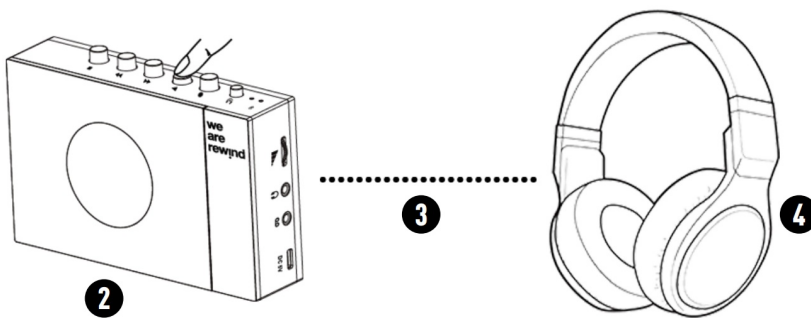

2. Play a cassette
3. Very close
4. Power On, pairing mode On

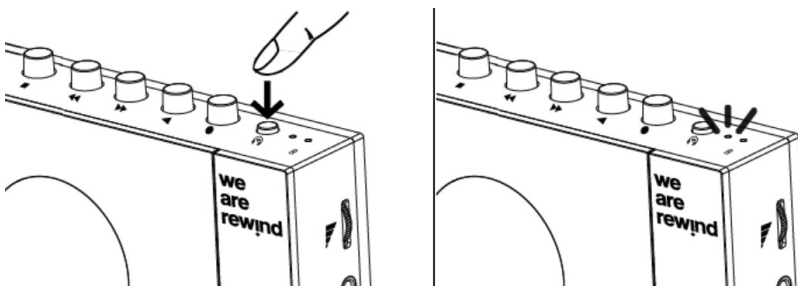

5. Long press the pairing button until the blue indicator turns on
6. The cassette sound is now played in the wireless headphones



www.wearerewind.com

we are rewind

Documents / Resources

	<p>we are rewind WE-001 Cassette Player and Recorder [pdf] User Guide WE-001 Cassette Player and Recorder, WE-001, Cassette Player and Recorder, Player and Recorder, Recorder</p>
---	--

References

-  [WE ARE REWIND](#)

[Manuals+.](#)