

WAYNE Pumps WWB-TSC Waterbug and TSC Utility Pump



WAYNE Pumps WWB-TSC Waterbug and TSC Utility Pump User Manual

[Home](#) » [WAYNE Pumps](#) » WAYNE Pumps WWB-TSC Waterbug and TSC Utility Pump User Manual 

Contents

- [1 WAYNE Pumps WWB-TSC Waterbug and TSC Utility Pump](#)
- [2 WWB & TSC Maintenance](#)
- [3 Documents / Resources](#)
 - [3.1 References](#)

WAYNE

WAYNE Pumps WWB-TSC Waterbug and TSC Utility Pump



Specifications:

- Product Name: Wayne Water Bug or TSC Utility Pump
- Application: Removes standing water around the home
- Maintenance: Regular maintenance required for optimal performance

Maintenance Procedure

1. Unplug the pump from the power source before handling or performing any maintenance.
2. Rinse any debris accumulated from the bottom of the pump using a faucet or garden hose.
3. Remove the 6 screws on the bottom of the pump using a #2 Phillips screwdriver to access the inlet screen.
4. Gently separate the inlet screen from the pump, taking care not to tear the cork gasket. Clean and rinse any debris from the inlet screen.
5. Rinse any debris from the impeller area. Soak in water if necessary and use mild detergent with a toothbrush to clean.
6. Reposition the cork gasket aligning with the figure provided, ensuring pump discharge openings are not covered.
7. Reinstall the inlet screen without over-tightening the screws.
8. Your pump is now ready for use again.

FAQ

Q: How often should I perform maintenance on my Wayne Water Bug or TSC Utility Pump?

A: It is recommended to perform maintenance as needed, especially if you notice a decrease in performance or clogging issues. Regular inspection and cleaning can help maintain optimal pump performance.

WWB & TSC Maintenance

Thank you for buying the Wayne Water Bug or TSC Utility Pump.



These pumps can be used for many application to remove standing water around the home. They are designed to remove virtually all standing water and as such, do require maintenance to keep them performing their best. Occasionally, it may become necessary to remove debris clogging some or all of the discharge areas. This is the procedure to do that.

1. Unplug the pump from the power source before handling or orperforming any maintenance on your pump.



2. Using a faucet or garden hose, rinse any debris that has accumulated from the bottom of the pump.

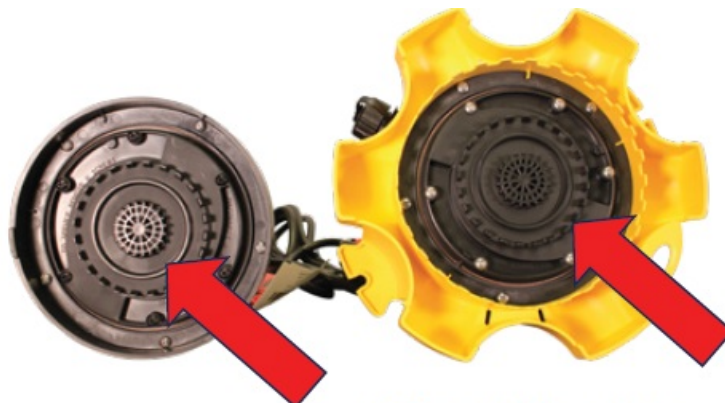

*rinse this area

3. On the bottom of the pump, remove the 6 screws using a #2 Phillips screwdriver. This will loosen the inlet screen from the pump. Do not remove the outer screw as this is not required to remove the inlet screen (red X's signify screw to NOT remove).

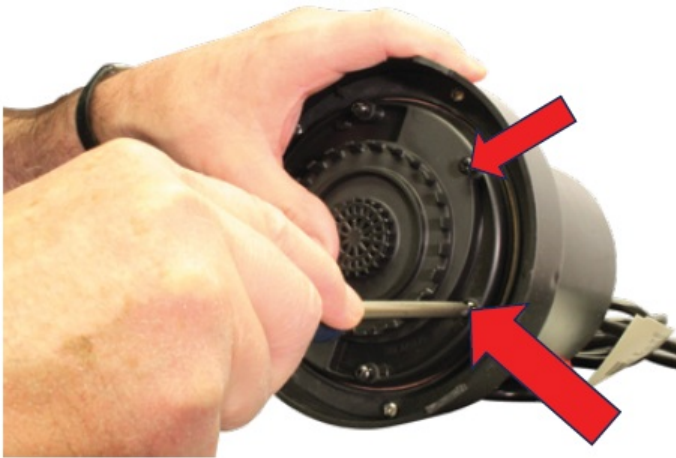
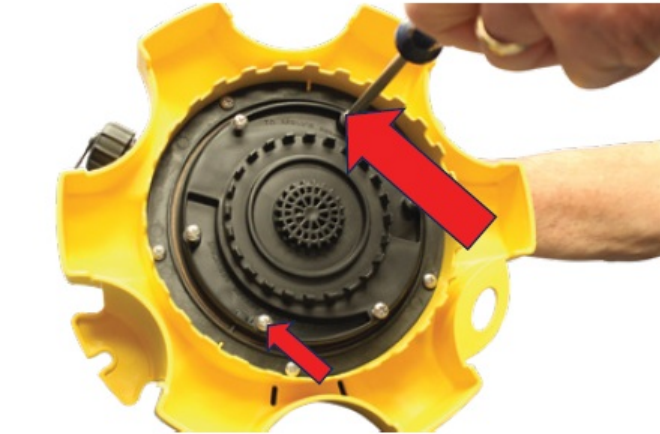

4. Using care to not tear the cork gasket on the bottom side of the inlet screen, gently separate the inlet screen from the pump. Clean and rinse any debris from the inlet screen.



*caution do not tear



*rinse/clean

5. Rinse any debris from the impeller area. If there is debris caked onto the impeller area, you may soak the area in a bucket or tub of water. You may use a mild dish detergent and an old tooth brush to help remove debris. Periodically inspect the pump and continue to soak until the debris has loosened and you can fully clean.

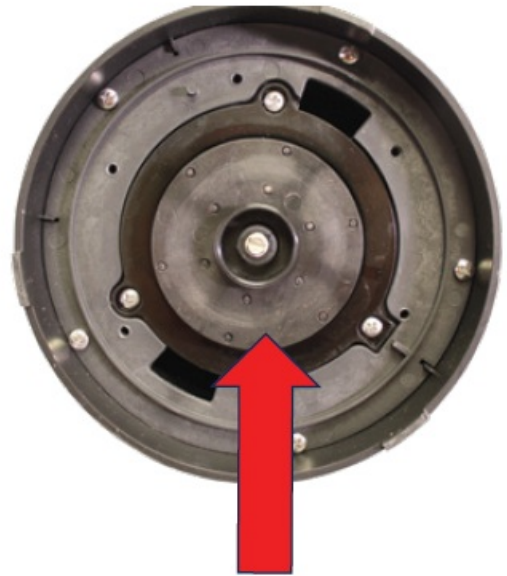
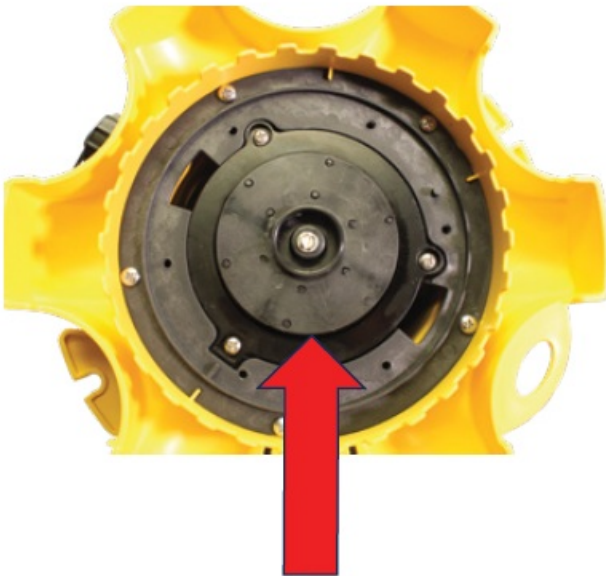

6. Once all debris has been removed, reposition the cork gasket using the alignment features shown in the figure, and take care not to cover the pump discharge openings.

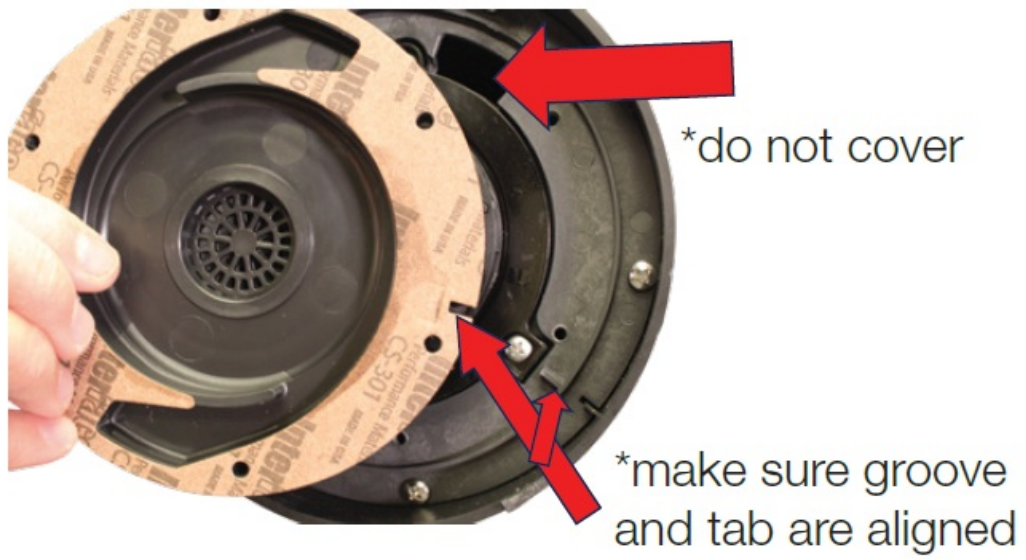

7. Reinstall the inlet screen using caution not to over tighten or strip the screws or screw holes.



8. Now your pump is ready to be used again.



Documents / Resources

<p>WWB & TSC Maintenance</p> <p>Thank you for buying the Wayne Water Bug or TSC Utility Pump.</p> <p>These pumps can be used for many applications to remove standing water around the home. They are designed to remove all types of standing water and as such, do require maintenance to keep them performing their best. Occasionally it may become necessary to remove debris clogging some or all of the discharge areas. This is the procedure to do this:</p> <p>1. Unplug the pump from the power source before handling or performing any maintenance on your pump.</p> 	<p>WAYNE Pumps WWB-TSC Waterbug and TSC Utility Pump [pdf] User Manual</p> <p>WWB-TSC Wayne Waterbug and TSC Utility Pump, WWB-TSC, Wayne Waterbug and TSC Utility Pump, Waterbug and TSC Utility Pump, TSC Utility Pump, Utility Pump, Pump</p>
--	--

References

- [User Manual](#)

[Manuals+](#), [Privacy Policy](#)

This website is an independent publication and is neither affiliated with nor endorsed by any of the trademark owners. The "Bluetooth®" word mark and logos are registered trademarks owned by Bluetooth SIG, Inc. The "Wi-Fi®" word mark and logos are registered trademarks owned by the Wi-Fi Alliance. Any use of these marks on this website does not imply any affiliation with or endorsement.