



WAVLINK HBR2 USB Triple Display Docking Station User Manual

[Home](#) » [WavLink](#) » WAVLINK HBR2 USB Triple Display Docking Station User Manual 

Contents

- [1 WAVLINK HBR2 USB Triple Display Docking Station](#)
- [2 Safety Instructions](#)
- [3 Copyright Statement](#)
- [4 Disclaimer](#)
- [5 WEEE Directive & Product Disposal](#)
- [6 Introduction](#)
- [7 Features](#)
- [8 OVERVIEW](#)
- [9 System Requirement](#)
- [10 Single Display](#)
- [11 Dual Display](#)
- [12 Installation](#)
- [13 Display Mode Setting](#)
- [14 Q & A](#)
- [15 CONTACT](#)
- [16 Documents / Resources](#)
 - [16.1 References](#)
- [17 Related Posts](#)



WAVLINK HBR2 USB Triple Display Docking Station



Safety Instructions

- Always read the safety instructions carefully.
- Keep this User Manual for future reference.
- Keep this equipment away from humidity.
- If any of the following situation arises, get the equipment checked by a service technician:
 - The equipment has been exposed to moisture.
 - The equipment has been dropped and damaged.
 - The equipment has obvious sign of breakage.
 - The equipment has not been working well or you cannot get it work according to user's manual.

Copyright Statement

- No part of this publication may be reproduced in any form by any means without the prior written permission.
- Other trademarks or brand names mentioned herein are trademarks or registered trademarks of their respective companies.

Disclaimer

Information in this document is subject to change without notice. The manufacturer does not make any representations or warranties (implied or otherwise) regarding the accuracy and completeness of this document and shall in no event be liable for any loss of profit or any commercial damage, including but not limited to special, incidental, consequential, or other damage.

WEEE Directive & Product Disposal

At the end of its serviceable life, this product should not be treated as household or general waste. It should be handed over to the applicable collection point for the recycling of electrical and electronic equipment, or returned to the supplier for disposal.

Introduction

- Built in a slim, light, and miniature case, the MST dock is designed to meet more demands of extra USB peripherals and monitors. To extend or duplicate the content of your AV sources, you can select either DP or HDMI port for display of high resolution.
- Besides, you can also connect your laptop to the upstream USB-C port and get it charged. The dock also

provides you with three USB 3.0 interfaces to enable you to enjoy high-speed data transfer.

Features

- **USB Power Delivery**

The upstream USB-C port is compliant with USB power delivery specification revision 3.0 and supports up to 65W power supply.

- **USB Data Transmission**

The MST dock has three USB 3.0 ports, providing your devices plenty of connection possibilities with data transfer rate up to 5Gbps.

- **Triple Display**

This MST dock has 3 different video ports, you can either select one port or combine two or all three of them for your own need.

- **RJ45 Gigabit Ethernet**

Gigabit Ethernet port provides high-speed network and is backward compatible with 10/100Mbps.

- **SD/TF Card Reader**

- Support Secure Digital™ v5.0 and SD V3.1 UHS-I.
- Support Card Reader SDHC/SDXC (Capacity up to 2TB).

OVERVIEW

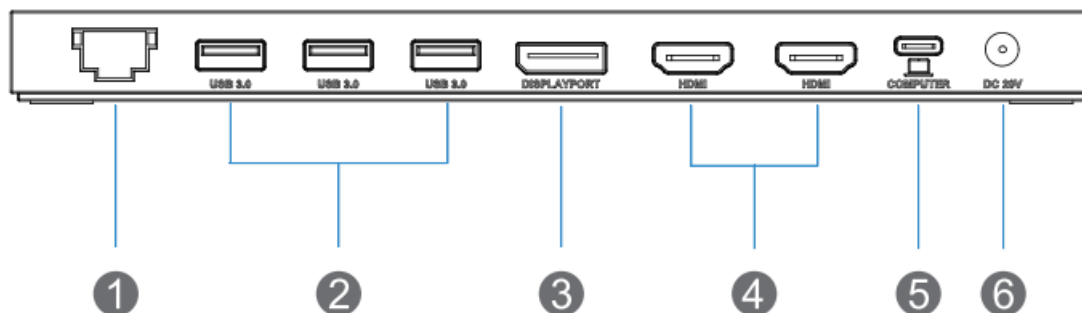

1. 1 Gigabit Ethernet port
2. 3 x USB 3.0 port
3. 1 x DisplayPort
4. 2 x HDMI port
5. Upstream USB-C port
6. Power port

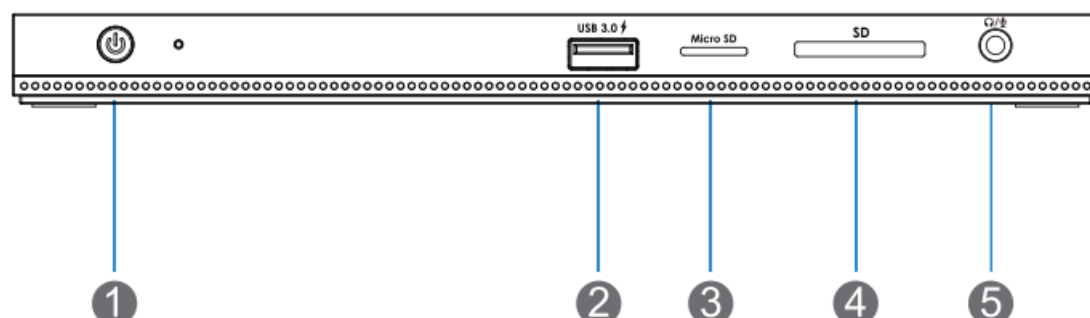

1. 1 Power button
2. USB 3.0 port with BC 1.2 fast charging
3. Micro SD card reader
4. SD card reader
5. 4-pole phone jack

System Requirement

- **Windows** 7/8/10 or later
- **Mac** OS X 10 or later
- **CPU** i7 or higher, RAM 4GB or above
- Host PC/laptop supporting PD 3.0
- PC/laptop with USB 3.1 full function Type-C port (Power Delivery, Video Alternate, Data Transfer)

Single Display

Video Port		DP	HDMI	HDMI
DP version of PC/laptop	HBR2 (DP1.2)	3840 x 2160@30Hz	3840 x 2160@30Hz	3840 x 2160@30Hz
	HBR3 (DP1.4)	3840 x 2160@60Hz	3840 x 2160@60Hz	3840 x 2160@60Hz

Dual Display

Video Port		Dual HDMI	DP + HDMI
DP version of PC/laptop	HBR2 (DP1.2)	1920 x 1080@60Hz	1920 x 1080@60Hz
	HBR3 (DP1.4)	3840 x 2160@60Hz	3840 x 2160@60Hz

Triple Display

Video Port		DP	+	HDMI	+	HDMI
DP version of PC/laptop	HBR2 (DP1.2)	1600 x 900@60Hz		1600 x 900@60Hz		1600 x 900@60Hz
	HBR3 (DP1.4)	1920 x 1080@60Hz		1920 x 1080@60Hz		1920 x 1080@60Hz

Note:

If you want to use 3 displays with your PC/laptop simultaneously, please make sure that the Graphics card of the USB-C port supports at least 4 displays of DP ALT Mode, including your PC's own screen. Check with your PC manufacturer on this. If your graphics card doesn't support 4 displays, please check Q&A Q2 for details.

Remarks for Windows based PC/laptops:

1. Before you connect two or three monitors, we suggest you lower monitor resolution, please check Q&A Q3 for details.
2. Before you connect three monitors, we suggest you disconnect laptop/PC first, please check Q&A 02 for details.

Remarks for Mac based PC/laptops:

1. When you connect only one external monitor to the dock, the extend and mirror modes are both available.
2. If you have two or three monitors connected to the dock, then you can only extend to one monitor while the other one or two monitor(s) will copy the same content on your extended monitor.

Installation

Before using this dock, please make sure that the latest PC/laptop drivers have been installed (including USB, graphics card etc) because the network port needs specific drivers. For Windows 10, the system detects and automatically installs them after the dock is connected to the network. If drivers cannot be automatically installed, or the network port can't perform properly, and then please install them manually. For MAC OS system, you need to install the network port driver manually, please visit www.wavlink.com > Support > Driver > PC peripherals > USB Docking.

1. Connect the USB-C connector of the dock to your host laptop/PC, the LED light on the dock will turn blue.
2. Connect your monitor(s) to video ports of the dock then you can proceed to configure the display modes.
3. Plug the power adapter of the dock in a power outlet.

Display Mode Setting

For Windows Users

1. Right-click at any spot on your desktop and select "Display settings".

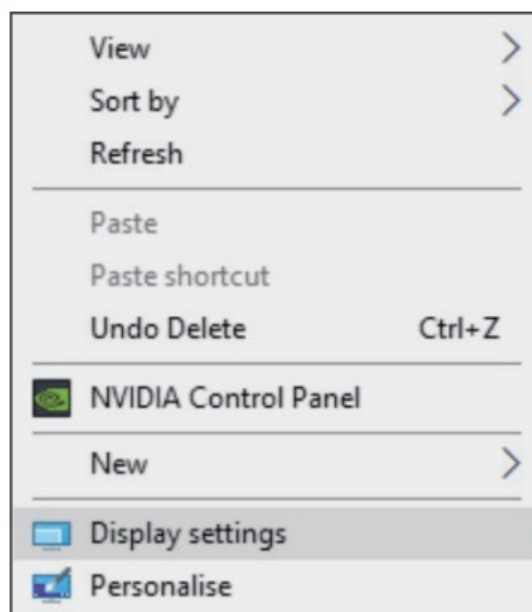

2. On "Display", please select either monitor 1 or monitor 2.



3. Scroll down to the “Multiple displays”, and select the mode in the drop-down list that is fit for your need.

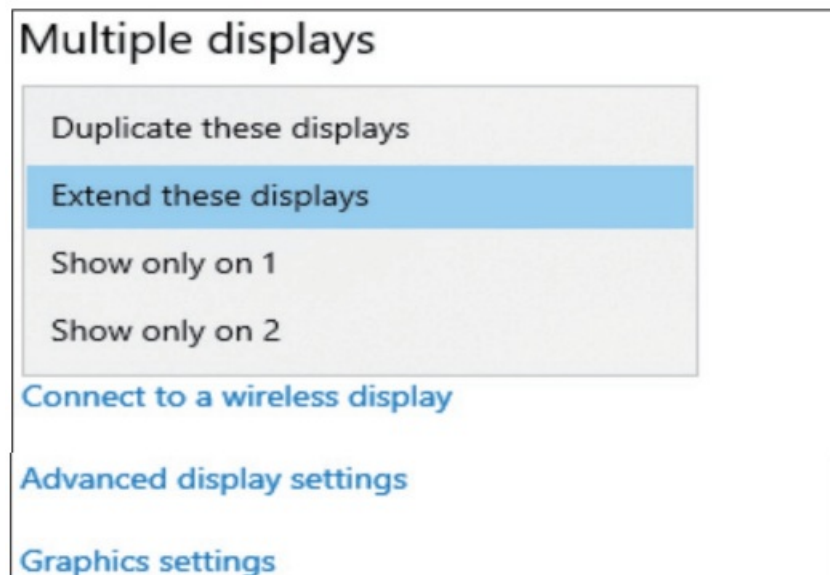

For MacOS Users

1. Select “System Preferences” and then choose “Displays”.

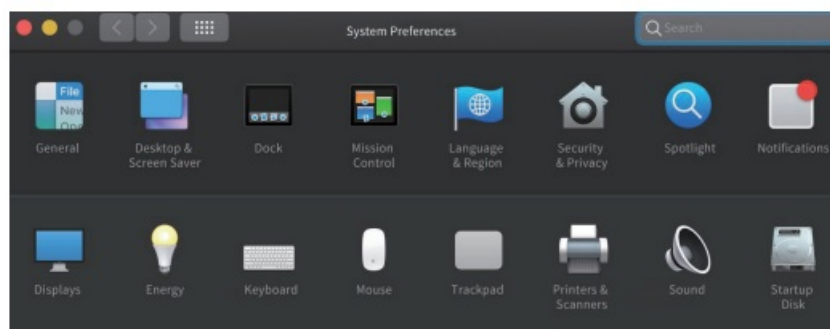

2. Click on “Arrangement” to change the position of displays currently connected.

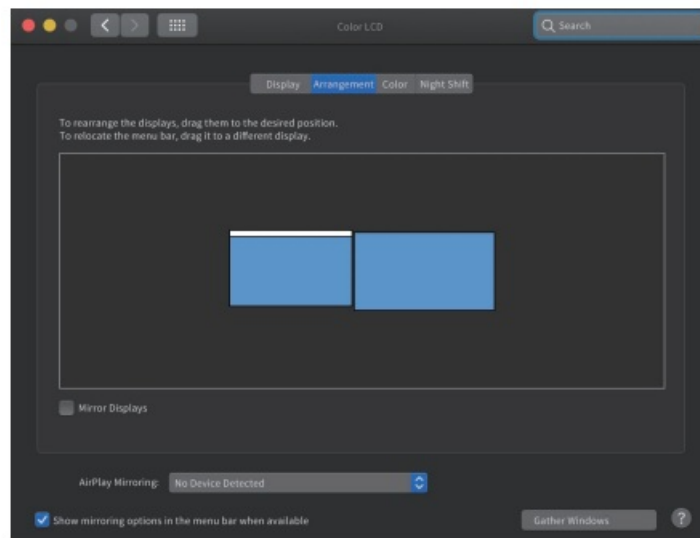

Extend Mode

3. Select either extend or mirror mode on your demand.

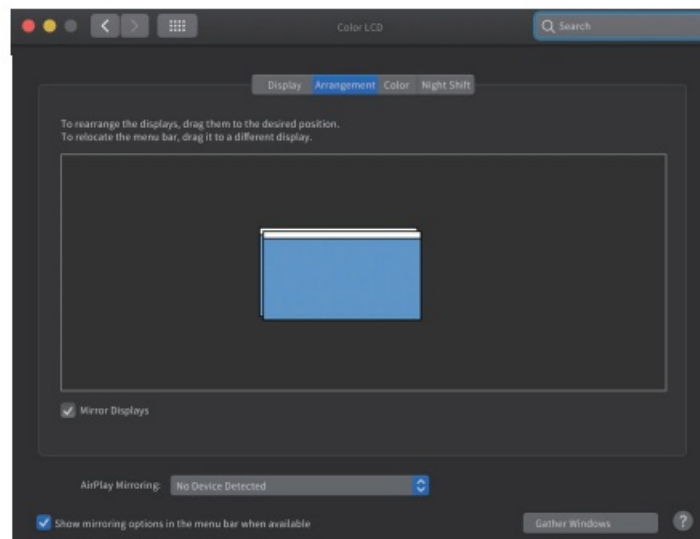

Mirror Mode

Q & A

- **How to figure out the maximum resolution (DP1.2/DP1.4) my laptop supports?**
 1. Firstly check the Graphics card version of your laptop; *Find “display adapter” in “Device Manager”.
 2. Check your Graphics card information with its manufacturer.
- **Why doesn't my third monitor display when I set the triple display mode?**
 - **Step 1:** Choose the main display
 1. Right-click to select “Display settings”.
 2. Choose a monitor display and scroll down to “Multiple displays”

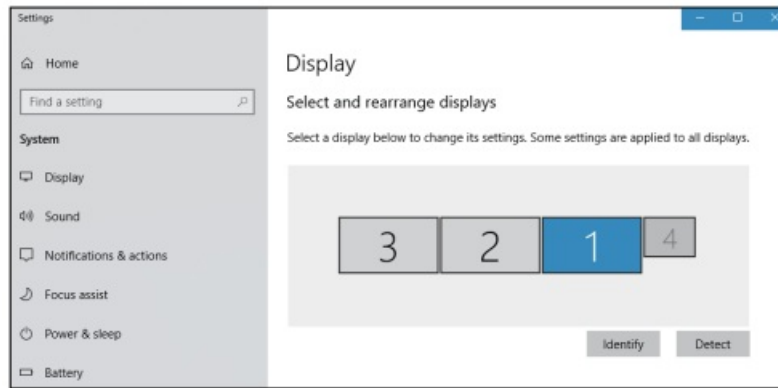

3. Mark “Make this my main display”.

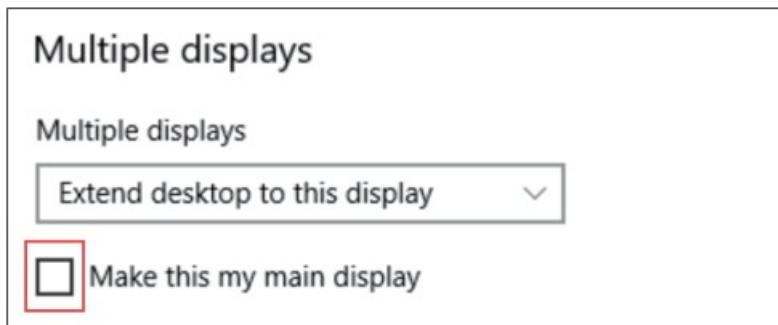

◦ **Step 2:** Disconnect laptop display

1. Select the laptop display (“1” is the default display for the laptop) and scroll down to “Multiple displays”.
2. Select “Disconnect this display”. then the laptop display panel will become disconnected.

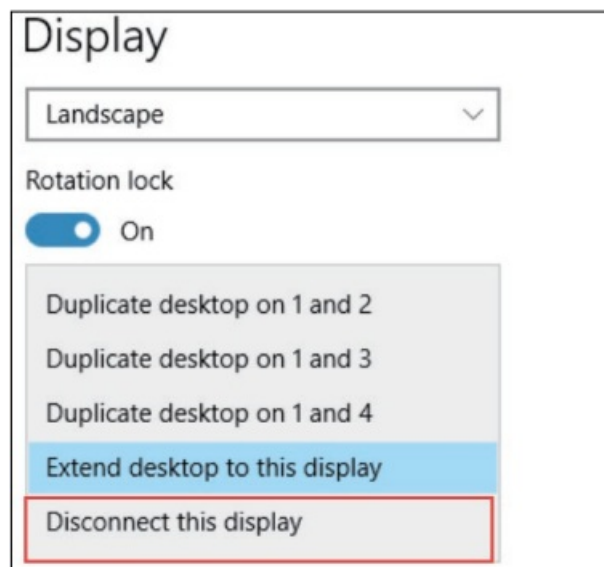

◦ **Step 3:** Turn on the third monitor display

1. Choose the remaining monitor display, then scroll down to “Multiple displays”.
2. Select “Extend desktop to this display” to enable this display.

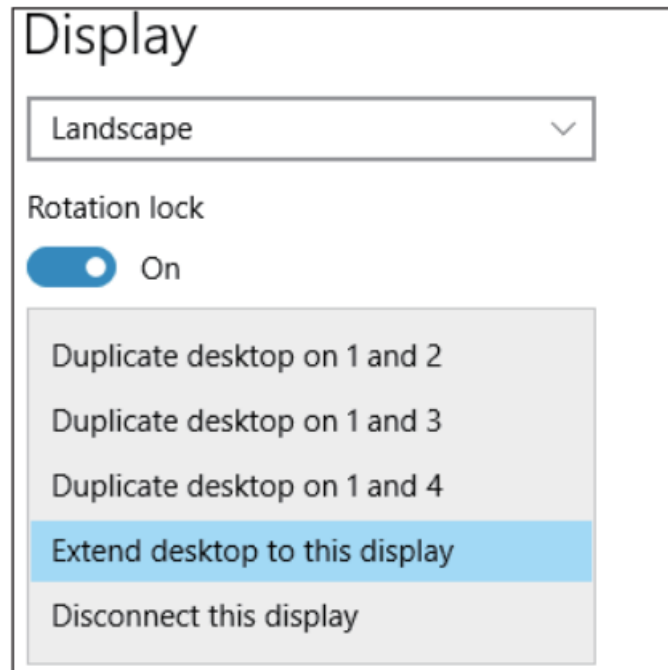

- **03: Why are my 2K and 4K monitor display abnormal when I set dual or triple display mode?**

The resolution of some branded monitors cannot be adjusted automatically, the “Active signal resolution” of which is different from Windows setting “Desktop resolution”, hence you’d better set the resolution at the same value.

1. Right-click and select “Display settings”.
2. Select your monitor display and click on it, then scroll down to select “Advanced display settings”.

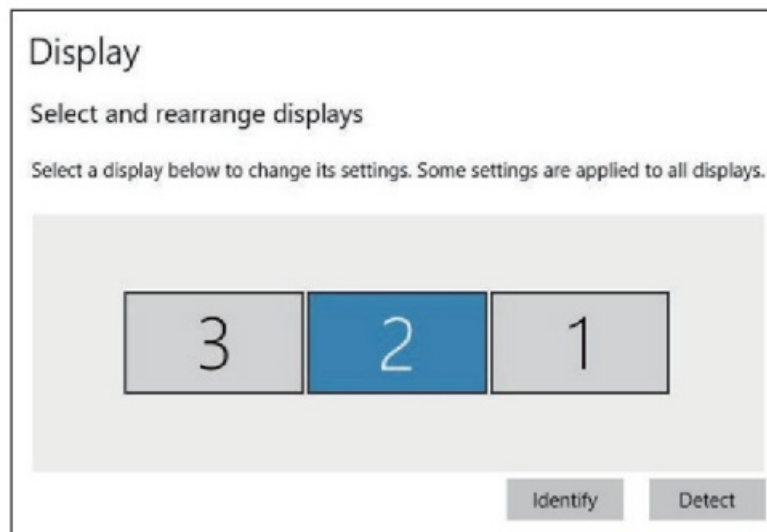

3. Check if resolution values of each monitor on “Desktop resolution” and “Active signal resolution” are the same.

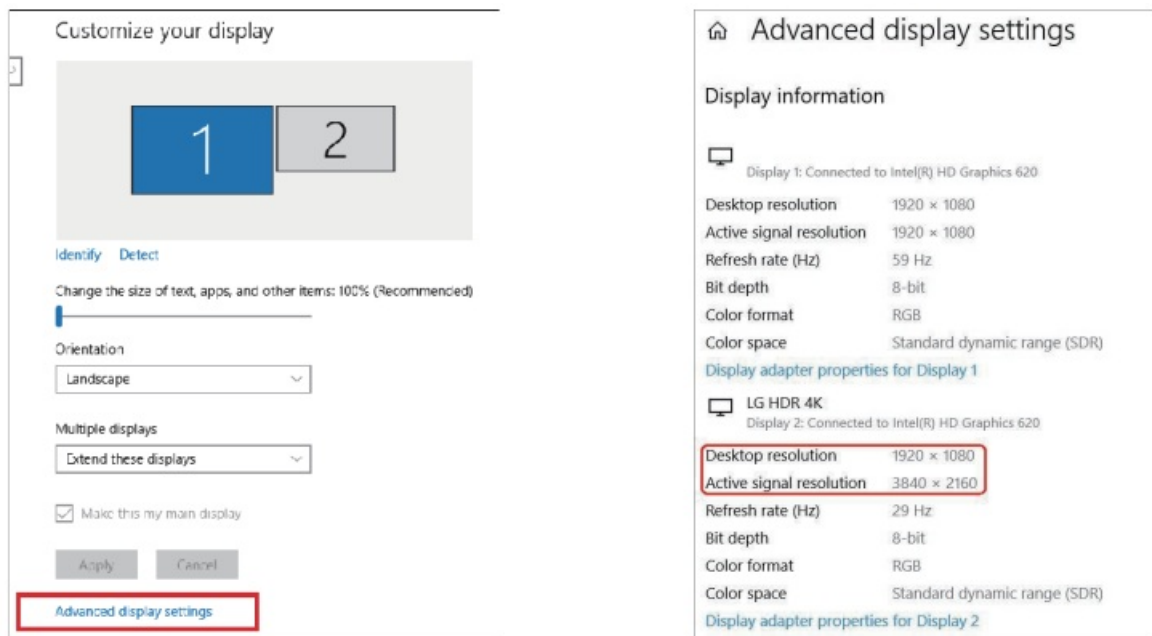

4. Click on “Display adapter properties for Display 2” and lower the resolution to the right value if two values are different.

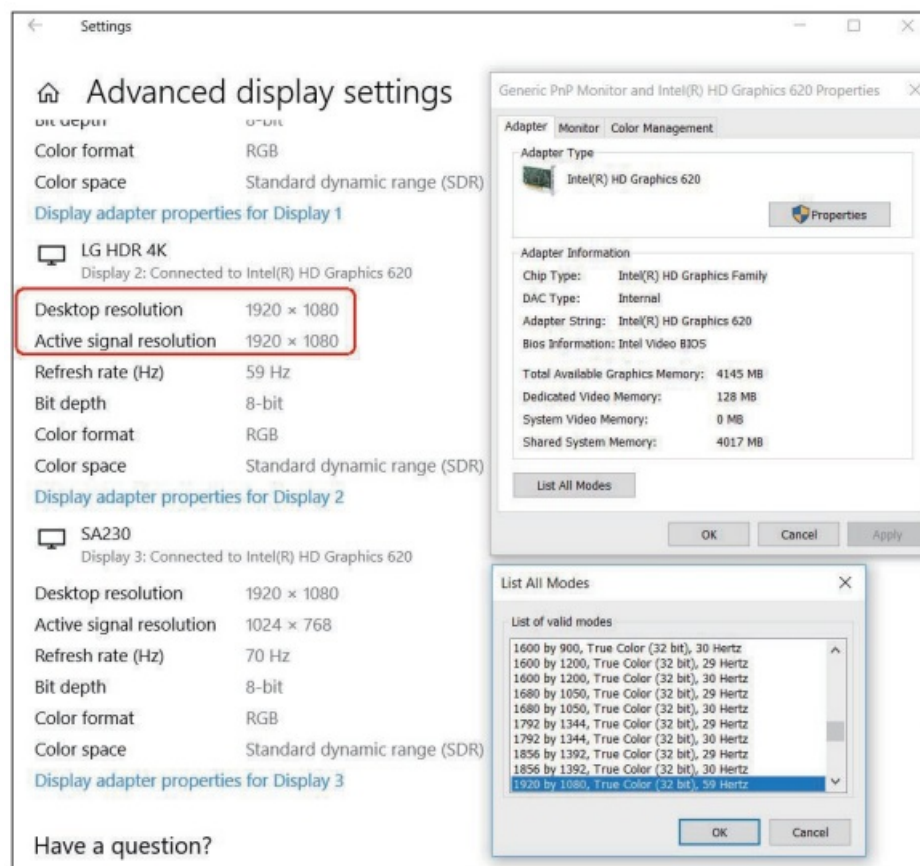

- **Why does it show “slow charging” on my laptop?**

Some users may notice that the charging status shows “slow charging”, this is because some series of laptop have protection protocol, especially laptops that have both Thunderbolt 3 port and over 100W external DC power adapter. Please use the original laptop charger to charge.

- **What is High Dynamic Range (HDR)?**

- High Dynamic Range (HDR) creates much more lifelike experiences by allowing bright objects such as lights and highlights glinting off shiny objects to be displayed much more brightly than other objects in the scene. HDR also allows for more details in dark scenes. True HDR playback is not yet available on the built-in displays of laptops and tablets, many of TVs and PC monitors start to build in HDR-10 with

HDCP2.2 to support. Some of the key HDR content sources today are:

- Streaming HDR (e.g. YouTube*) & Streaming premium HDR (e.g. Netflix*)
 - Local HDR Video Files
 - ULTRA HD Blu-ray*
 - HDR games//
 - HDR content creation apps
- Also, if you need to stream HDR contents with applications like Netflix and YouTube, make sure in Windows 10 “Stream HDR Video” setting is “on” in the “Video playback settings” page.

CONTACT

- Official website: www.wavlink.com
 - Technical support: support@wavlink.com
-

Documents / Resources



[WAVLINK HBR2 USB Triple Display Docking Station](#) [pdf] User Manual
HBR2 USB Triple Display Docking Station, HBR2, USB Triple Display Docking Station, Triple Display Docking Station, Display Docking Station, Docking Station, Station

References

- [User Manual](#)