

Contents [[hide](#)]

- [1 WAVeTeC WT CDU-RGB Spectra Controller](#)
- [2 Product Usage Instructions](#)
- [3 Features](#)
- [4 SPECIFICATION](#)
- [5 Packaging Items](#)
- [6 Dimensions and Layout](#)
- [7 FCC STATEMENT](#)
- [8 Frequently Asked Questions](#)
- [9 Documents / Resources](#)
 - [9.1 References](#)



WAVeTeC WT CDU-RGB Spectra Controller



Specifications:

- **Product:** WT CDU – RGB
- **Model:** F-05H v1.0
- **Product Code:** 701-0005-0013-0A
- **Display Features:**

- RGB Full Color LED Display
- Elegant Design
- Displays Ticket Numbers
- Displays Scrolling Messages
- Low Power Consumption
- Display Messages in Multiple Languages
- **Display Communication:**
 - **Display Color Resolution:** Full Color RGB
 - **Display Languages:** Multilingual
 - **Counter Number Sticker:** 128 (H) x 85 (W) mm
 - **Branding Sticker:** 128 (H) x 85 (W) mm
 - **LED Display Area:** 128 (H) x 256 (W) mm
 - **LED Type:** RGB SMD LED
- **Physical Environment:**
 - **Dimensions (H x W x D):**
 - **Without packaging:** 128 x 426 x 53.90 mm
 - **With packaging:** 245 x 515 x 100 mm
 - **Material:** Plastic and metal
 - **Weight:**
 - **Without packaging:** 0.92 Kg
 - **With packaging:** 1.5 Kg
 - **Color:** Dull Black
 - **Mounting Options:** Wall Mount / Ceiling Mount
 - **Operating Temperature:** Maximum 60% (relative humidity, non-condensing)

Product Usage Instructions

Installation:

1. Determine the appropriate mounting location for the display.
2. If wall mounting, use suitable hardware to securely attach the display to the wall.
3. If ceiling mounting, ensure proper support is in place to hold the display safely.

Power Connection:

1. If using an external adaptor, connect the provided +5V DC, 4.0 A power supply to the display.
2. If not using an external adaptor, ensure the Active HUB is providing 12V power through the data cable.

Data Communication:

1. Use Cat5e/Cat6 cable for data communication with the appropriate connectors.
2. Connect the data cable to an ACTIVE HUB for differential RS-485 data signal transmission.

Features

- RGB Full Color LED Display
- Elegant Design
- Displays Ticket Numbers
- Displays Scrolling Messages
- Low Power Consumption
- Display Messages in Multiple Languages

SPECIFICATION

Display	Display Color	Full Color RGB
	Resolution	32(H) x 64(W) = 2048 dots
	Display Languages	Multilingual
	Counter Number Sticker Branding Sticker	Counter Number Sticker with Wavetec Logo (Right Side) 128 (H) x 85 (W) mm Branding Area (Left Side) 128 (H) x 85 (W) mm
	LED Display Area	128 (H) x 256 (W) mm

	Display Type	RGB SMD LED
	LED Pitch	4.0mm
Communication	Cable Type	Cat5e/Cat6, 4 pair twisted cable with pure copper solid wire conductor of 24 AWG
	Data Communication	115k bps Differential RS-485 data signal from ACTIVE HUB
Power Requirement	Power Supply	<p>– Provided 12V through Active HUB on the data cable.</p> <p>– OPTIONAL +5V DC, 4.0 A (Provided through an external Adaptor) only needed when.</p>
Physical	Dimensions (Height x Width x Depth)	Without packaging: 128 (H) x 426(L) x 53.90(D) mm With packaging 245 (H) x 515 (W) x 100 (D) mm
	Material	Plastic and metal
	Weight (Kg)	Without packaging: 0.92 Kg With packaging: 1.5 Kg
	Color	Dull Black
	Mounting Options	Wall Mount / Ceiling Mount

Environment	Operating Temperature	0 – 45 °C
	Humidity	Maximum 60% (relative humidity, non-condensing)

Packaging Items

Item Name	Product Code
WT CDU (R/G/B)	701-0005-0013-0A
CDU Holding Pipes (Black) with Accessories	498-0195-0001-0A

Dimensions and Layout

WT CDU – RGB:

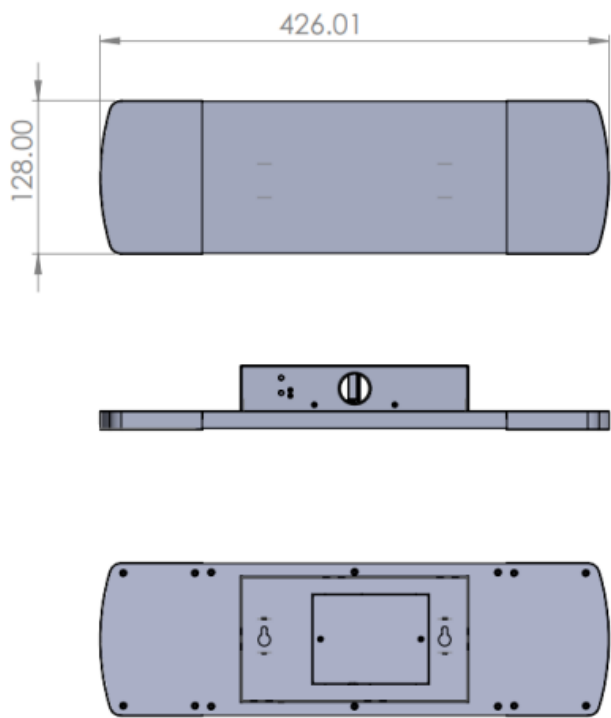

701-0005-0013-0A

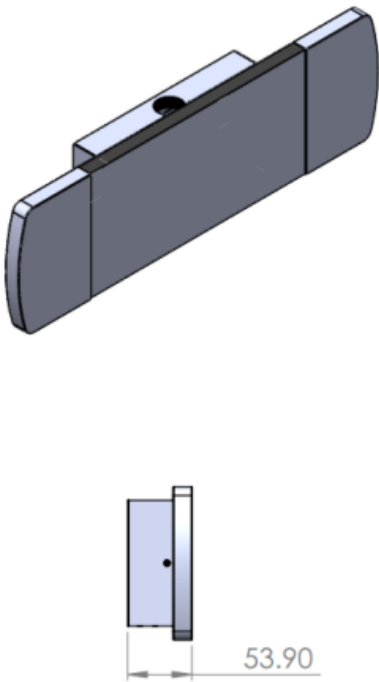

FCC STATEMENT

This device complies with part 15 of the FCC Rules. Operation is subject to the following two conditions:

1. This device may not cause harmful interference, and

2. this device must accept any interference received, including interference that may cause undesired operation.

Any Changes or modifications not expressly approved by the party responsible for compliance could void the user's authority to operate the equipment.

Note: This equipment has been tested and found to comply with the limits for a Class B digital device, pursuant to part 15 of the FCC Rules. These limits are designed to provide reasonable protection against harmful interference in a residential installation. This equipment generates uses and can radiate radio frequency energy and, if not installed and used in accordance with the instructions, may cause harmful interference to radio communications. However, there is no guarantee that interference will not occur in a particular installation. If this equipment does cause harmful interference to radio or television reception, which can be determined by turning the equipment off and on, the user is encouraged to try to correct the interference by one or more of the following measures:

- Reorient or relocate the receiving antenna.
- Increase the separation between the equipment and receiver.
- Connect the equipment into an outlet on a circuit different from that to which the receiver is connected .
- Consult the dealer or an experienced radio/TV technician for help.

This equipment complies with FCC radiation exposure limits set forth for an uncontrolled environment. This equipment should be installed and operated with minimum distance 20cm between the radiator & your body

Frequently Asked Questions

Q: What is the maximum operating temperature for the WT CDU – RGB display?

A: The maximum operating temperature is 60% relative humidity, non-condensing.

Q: Do I need an external power adaptor for the display?

A: An external +5V DC, 4.0 A power adaptor is optional and only needed when not using the Active HUB for power.

Documents / Resources

	WAVeTeC WT CDU-RGB Spectra Controller [pdf] Owner's Manual 2AGQF-WT-CDU-RGB, 2AGQFWTCDURGB, WT CDU-RGB Spectra Co ntroller, WT CDU-RGB, Spectra Controller, Controller
---	--

References

- [User Manual](#)

■ WAVETEC
🔍 2AGQF-WT-CDU-RGB, 2AGQFWTCDURGB, controller, Spectra Controller, WAVETEC, WT CDU-RGB, WT CDU-RGB Spectra Controller

Leave a comment

Your email address will not be published. Required fields are marked *

Comment *

Name

Email

Website

☐ Save my name, email, and website in this browser for the next time I comment.

Post Comment

Search:

e.g. whirlpool wrf535swhz

Search

[Manuals+](#) | [Upload](#) | [Deep Search](#) | [Privacy Policy](#) | [@manuals.plus](#) | [YouTube](#)

This website is an independent publication and is neither affiliated with nor endorsed by any of the trademark owners. The "Bluetooth®" word mark and logos are registered trademarks owned by Bluetooth SIG, Inc. The "Wi-Fi®" word mark and logos are registered trademarks owned by the Wi-Fi Alliance. Any use of these marks on this website does not imply any affiliation with or endorsement.