



# Waterdrop WD-A1-CF Filter Replacement Instructions

[Home](#) » [Waterdrop](#) » Waterdrop WD-A1-CF Filter Replacement Instructions 

## Contents

- [1 Waterdrop WD-A1-CF Filter Replacement](#)
- [2 Filter Replacement Guide](#)
- [3 Storage and Maintenance](#)
- [4 Frequently asked questions](#)
- [5 Documents / Resources](#)
  - [5.1 References](#)
- [6 Related Posts](#)



**Waterdrop WD-A1-CF Filter Replacement**



**Model:** WD-AI-CF

**Filter life:** More than 6 months (which may vary according to local water quality).

**Note:** Do not use it with water that is microbiologically unsafe or of unknown water quality without adequate disinfection.

## Filter Replacement Guide

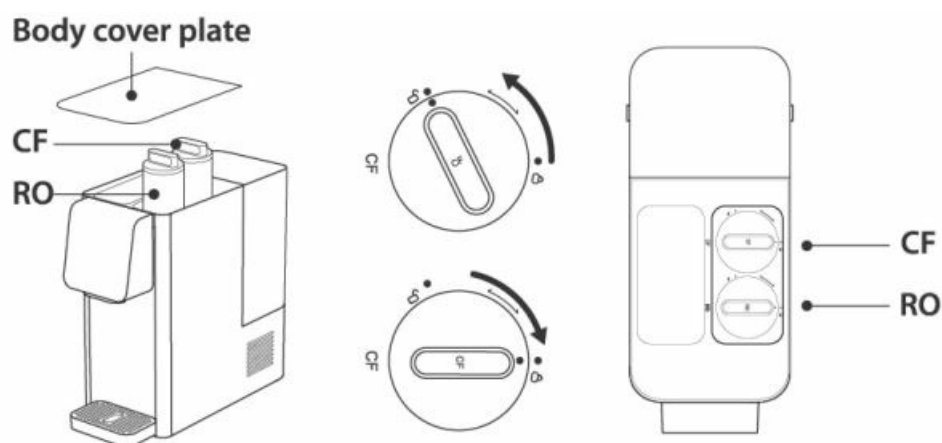

- Step 1: Open the body cover plate as shown in the figure, and rotate the CF filter counterclockwise by 90 degrees to take it out.
- Step 2: Install a new CF filter: Align the positioning mark on the CF filter with that on the dispenser, and gently put it in the corresponding filter bucket.
- Step 3: Gently press the filter and rotate the filter handle to the horizontal position.

**After the filter is installed in place:**

- The filter handle should be locked in the direction of "🔒".
- The icon "●" on the top surface of the filter should be aligned with "●" on the middle frame.
- Please do not replace the filter when the water filtering icon lights up or flashes.

#### Step 4: Reset the newly installed filter as follows:

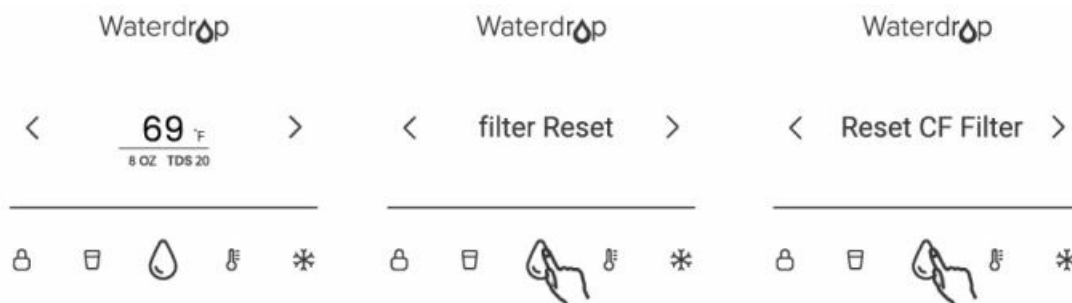

- Step 1: On the water dispensing interface, press the right key ">" to switch to the filter resetting interface, and press the confirm key "💧".
- Step 2: Press the left key "<" or the right key ">" to switch and select "Reset CF filter" or "Reset RO filter". select the filter requiring resetting based on actual demands, and press the confirm key "💧".
- Step 3: After the filter is successfully reset, the interface will automatically skip to the flushing interface. After the CF filter is reset, the dispenser will automatically flush for 1 tank of water, and after the RO filter is reset, it will automatically flush for 3 tanks of water.

**Note:** After the CF filter is reset, the dispenser will automatically flush it for 1-2 tanks of water, taking about 10 minutes. DO NOT drink water produced during flushing.

#### Storage and Maintenance

- After the filter life indicator flashes or lights up, please replace the filter as soon as possible.
- DO NOT store it for a long time. Please keep it in a cool and dry place when not in use. Feed water should meet the requirement of municipal tap water.
- DO NOT expose it under direct sunlight.

#### Warning:

To reduce the risk of property damage due to water leakage, this filter MUST be installed in accordance with the manufacturer's specifications and instructions. Failure to follow instructions and operating specifications will void your warranty. Further, manufacturer assumes no responsibility or liability for damages arising out of misuse of the product

#### Manufacturer Technical Support

Tel: 1-888-352-3558 (U.S.)

E-mail: [service@waterdropfilter.com](mailto:service@waterdropfilter.com)



Made in China V001  
Qingdao Ecopure Filter Co., Ltd.

## Frequently asked questions

- **Q: Why does my filtered water taste weird?**

A: (1) The filter will expire soon. Please check whether the filter will expire soon and if yes, replace it as soon as possible;

(2) The dispenser has not been used for a long time. Please flush it first before use and refer to the flushing instructions on page 5 of the Instruction Manual.

- **Q: What will happen if I don't replace the filter when the filter life indicator flashes?**

A: Excessive use of the filter will decrease its filtration performance, resulting in leakage of contaminants into water and doing harm to your physical health. When the filter life indicator lights up, it is suggested to replace the filter as soon as possible.

- **Q: Why does the filter life indicator keep flashing or staying on after filter replacement?**

A: This usually happens when you forget to reset the filter or don't reset the filter. Please reset the filter.

---

## Documents / Resources

	<p><a href="#">Waterdrop WD-A1-CF Filter Replacement</a> [pdf] Instructions WD-A1-CF Filter Replacement, WD-A1-CF, Filter Replacement, Replacement</p>
---	--

## References

- [User Manual](#)