



Watchguard AP330 WiFi 6 Wireless Access Point User Guide

[Home](#) » [Watchguard](#) » Watchguard AP330 WiFi 6 Wireless Access Point User Guide 

Contents

- [1 Watchguard AP330 WiFi 6 Wireless Access Point](#)
- [2 WHAT YOU NEED](#)
- [3 ACTIVATE YOUR AP](#)
- [4 MOUNT THE AP](#)
- [5 CONNECT THE AP](#)
- [6 CONFIGURE AND TROUBLESHOOT THE AP](#)
- [7 NOTICES](#)
- [8 Declaration of Conformity](#)
- [9 WATCHGUARD TECHNICAL SUPPORT](#)
- [10 Documents / Resources](#)
- [11 Related Posts](#)



Watchguard AP330 WiFi 6 Wireless Access Point



WHAT YOU NEED

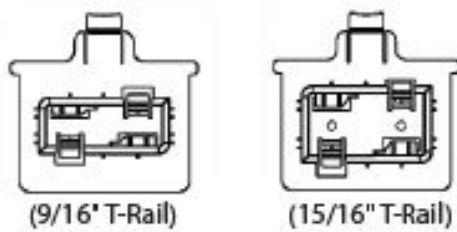

Ceiling Mount Brackets

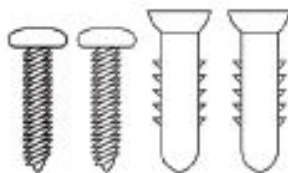

Wall Mount Screws



Spacers

ACTIVATE YOUR AP

GO TO:

watchguard.com/activate

Enter Serial Number or License Key

- To activate a new device, type the serial number exactly as it appears (include any hyphens). You can find the serial number on a label on your device or on the fulfillment email for your virtual device.
- To activate an add-on license, service, or renewal, type the license key from your fulfillment email or online store receipt.

CONTINUE ▶



MOUNT THE AP

CEILING MOUNT

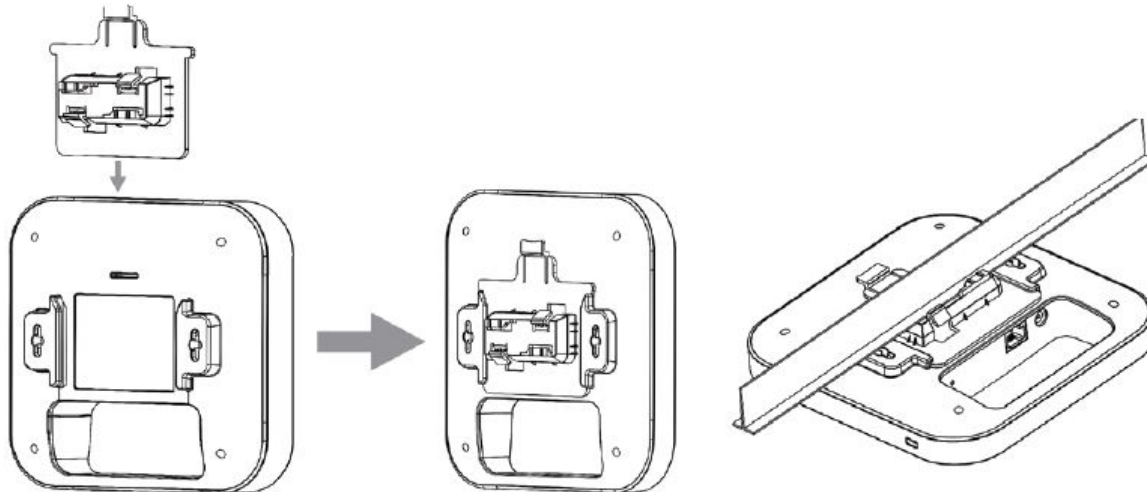

WALL MOUNT

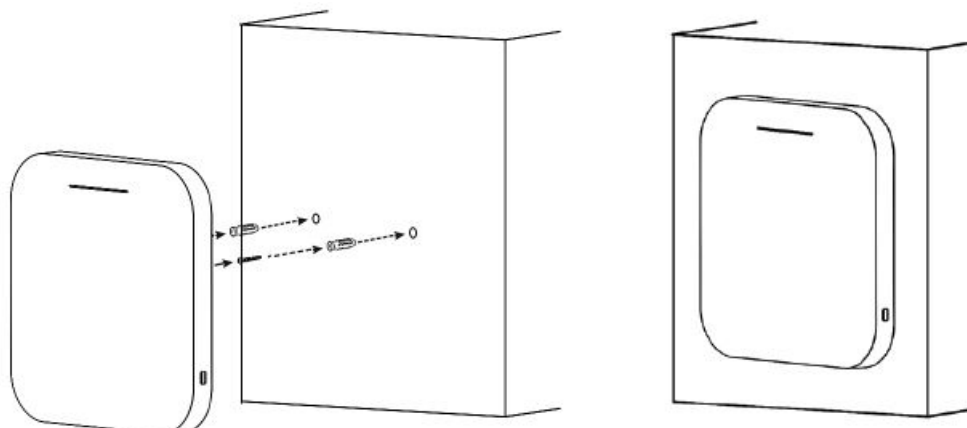

Use the included spacers if you mount to a wall with the 15/16" bracket attached to the access point.



CONNECT THE AP

Plug one end of the Ethernet cable from your network into the LAN PoE+ port on the bottom panel of the AP. Make sure the other end of the Ethernet cable is connected to your network through a hub, switch, or injector with PoE+ (802.3at) power enabled.

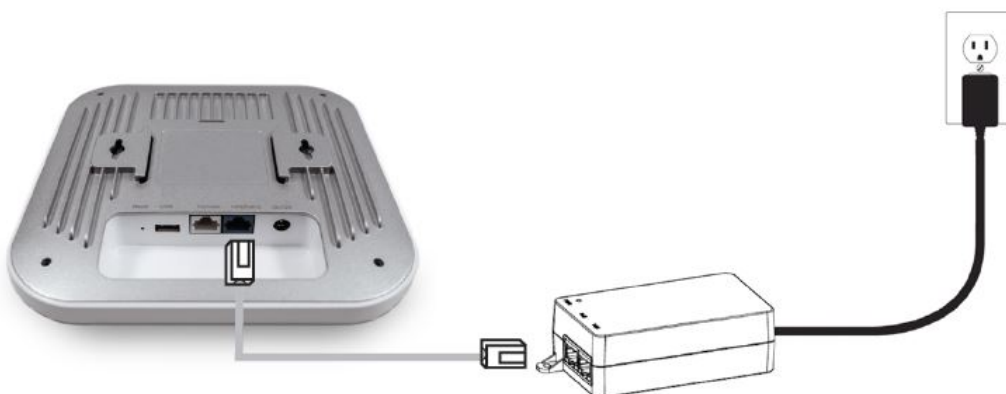

Access Point connected to PoE+ injector



Access Point connected to switch with PoE+ power

CONFIGURE AND TROUBLESHOOT THE AP

GO TO:

watchguard.com/start



Wi-Fi in WatchGuard Cloud



NOTICES

All WatchGuard products are designed and tested to meet strict safety requirements. These requirements include product safety approvals and other global compliance standards. Please read these instructions carefully before operating the product, and refer to them as needed to ensure the continued safe operation of your product. Additional information, including a full list of safety approvals, global compliance standards, and certifications can be found in the Hardware Guide for this device located on the WatchGuard website:

<https://www.watchguard.com/wgrd-help/documentation/hardware-guides>

For patent information, please visit <http://www.watchguard.com/patents>

Safety Warning

If protective earthing is used as a safeguard, the instructions shall require connection of the equipment protective earthing conductor to the installation protective earthing conductor (for example, by means of a power cord connected to a socket-outlet with earthing connection). To meet safety and electromagnetic interference (EMI) requirements, you must make sure the power source is connected to earth ground before you connect power to the AP.

Power Adapter Requirements

This product is intended to be supplied by a Listed Power Adapter or DC power source marked “L.P.S.” (or Limited Power Source or PS2) rated 12V DC, 2A minimum, maximum ambient temperature (Tma)=40°C, or supplied by a Listed PoE Adapter marked “L.P.S.” (or Limited Power Source or PS2) rated 48V DC, 0.6A minimum, maximum ambient temperature (Tma)=40°C. For more information regarding approved power sources, please contact WatchGuard Technologies.

This product is for indoor use only.

Declaration of Conformity

WatchGuard Technologies Inc. hereby declares that the product(s) listed below conform to the European Union directives and standards identified in this declaration.

Product (s): 802.11 a/b/g/n/ac/ax Access Point, AP330

EU Directive(s): Low Voltage (2014/35/EU) Electromagnetic Compatibility (2014/30/EU) Energy-related Products (2009/125/EC) RoHS (2011/65/EU and 2015/863/EU RoHS) WEEE Directive 2012/19/EU The Radio Equipment Directive (2014/53

Common Standard(s):

EN 62368-1:2014+A11:2017 Safety for ITE

EN 55024:2010

EN 55024: 2010+A1:2015 Immunity for ITE

EN 55032:2015+A11:2020

EN 55035: 2017

EN 61000-3-2:2014 Harmonics

EN 61000-3-3:2013 Flicker

Wireless Standard(s):

EN 62311:2008

EN 301 489-1 v2.2.3 (2019-11) EMC and Radio Spectrum Matters

EN 301 489-17 v3.1.1 (2017-02) EMC and Radio Spectrum Matters

EN 300 328 v2.2.2 (2019-07) Radio Spectrum Matters

EN 301 893 v2.1.1 (2017-05) Broadband Radio Access Networks

EN 50385: 2017

This device complies with Directive 2014/53/EU issued by the Commission of the European Community.

Manufacturer / Hersteller:

WatchGuard Technologies

505 5th Ave S. Suite 500, Seattle, WA 98104 USA Radio

Equipment / Funkanlage:

802.11 a/b/g/n/ac/ax Access Point

Type Designation / Typenbezeichnung:

AP330

Specifications / Technische Daten:

802.11a,b,g,n,ac,ax (2.4Ghz & 5GHz)

Intended Purpose / Verwendungszweck:

Indoor access point

Equipment Class / Betriebsmittel der Klasse:

Class II

Operating temperature

0° C to 40° C

The above device complies with the essential requirements and other relevant provisions to Directive 2014/53/EU when used for its intended purpose. This equipment may be operated in the USA, Canada, & Europe Union.

Warning

This is a Class B product. In a domestic environment this product may cause radio interference in which case the user may be required to take adequate measures.

Frequency range (MHz)	Max. Transmit Power (W)
Bluetooth	0.00794
WLAN Wi-Fi 802.11x; 2, 4 GHz	0.09418
WLAN Wi-Fi 802.11x; 5 GHz	0.86896

WATCHGUARD TECHNICAL SUPPORT

1.877.232.3531
(U.S. and Canada)
+1.206.613.0456
(all other countries)
<http://www.watchguard.com/support>

ADDRESS: 505 Fifth Avenue South, Suite 500, Seattle, WA 98104 U.S. SALES: 1.800.734.9905 •
INTERNATIONAL SALES: +1.206.613.0895

WEB: www.watchguard.com

© 2022 WatchGuard Technologies, Inc. All rights reserved. WatchGuard, the WatchGuard Logo, Fireware, and LiveSecurity are registered trademarks of WatchGuard Technologies, Inc. in the United States and/or other countries. All other trademarks and tradenames are the property of their respective owners.
P.N. 352-4330-001 Rev B 011222

Documents / Resources

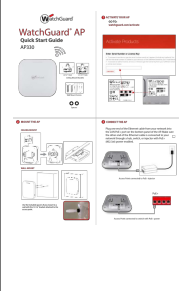
	<p>Watchguard AP330 WiFi 6 Wireless Access Point [pdf] User Guide</p> <p>AP330, WiFi 6 Wireless Access Point, AP330 WiFi 6 Wireless Access Point, Wireless Access P oint, Access Point</p>
---	--