



# WatchGuard AP130 WiFi Access Point Cloud Managed User Guide

[Home](#) » [Watchguard](#) » WatchGuard AP130 WiFi Access Point Cloud Managed User Guide 



**WatchGuard® AP  
Quick Start Guide  
AP130**

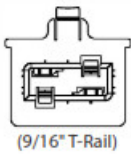

(9/16" T-Rail)

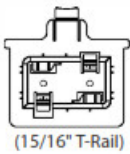

(15/16" T-Rail)

Ceiling Mount Brackets



Wall Mount Screws



Spacers

## Contents

- 1 ACTIVATE YOUR AP
- 2 MOUNT THE AP
- 3 CONNECT THE AP
- 4 CONFIGURE AND TROUBLESHOOT THE AP
- 5 NOTICES:
- 6 Declaration of Conformity
- 7 WATCHGUARD TECHNICAL SUPPORT
- 8 Documents / Resources
- 9 Related Posts

## ACTIVATE YOUR AP

GO TO: [watchguard.com/activate](http://watchguard.com/activate)

Activate Products

Enter Serial Number or License Key

- To activate a new device, type the serial number exactly as it appears (include any hyphens). You can find the serial number on a label on your device or on the fulfillment email for your virtual device.
- To activate an add-on license, service, or renewal, type the license key from your fulfillment email or online store receipt.

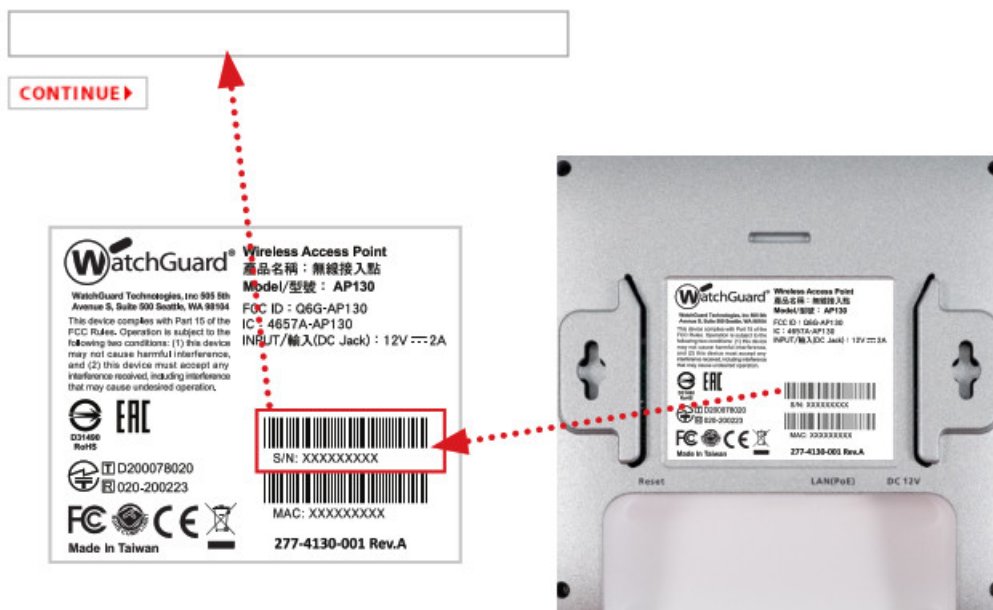

## MOUNT THE AP

### CEILING MOUNT

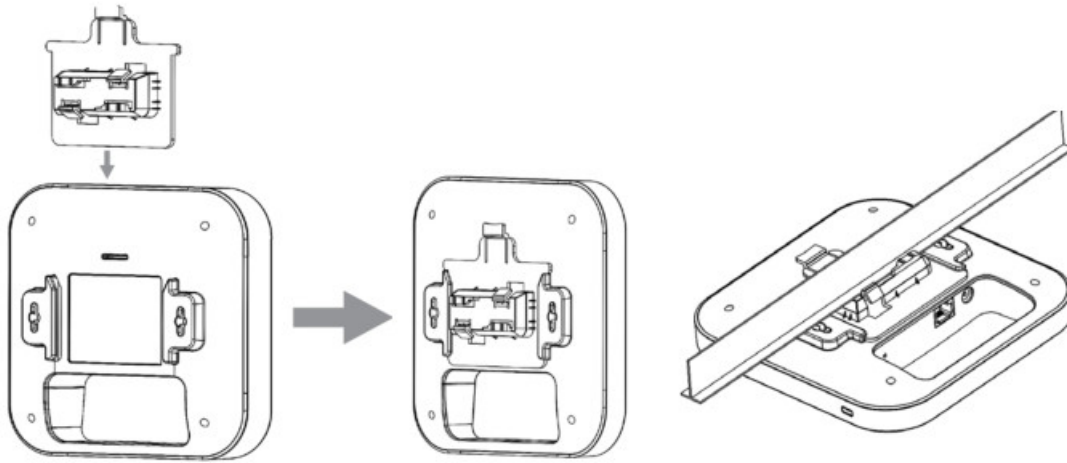

## WALL MOUNT

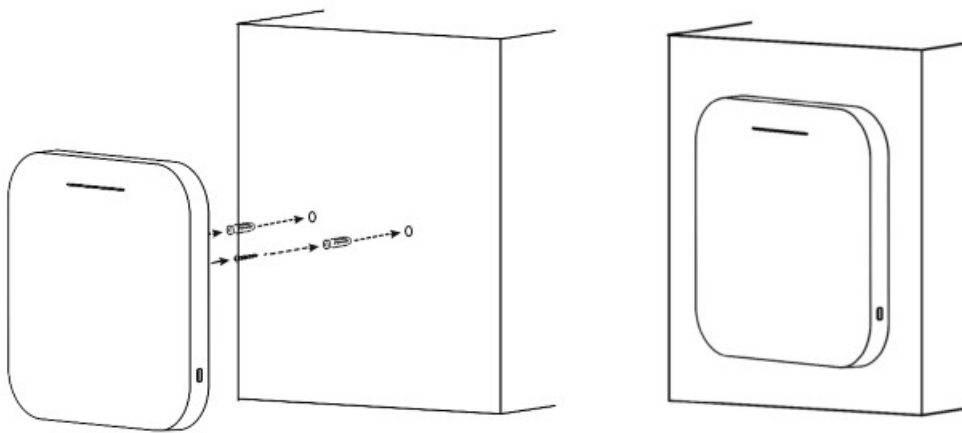

Use the included spacers if you mount to a wall with the 15/16" bracket attached to the access point.

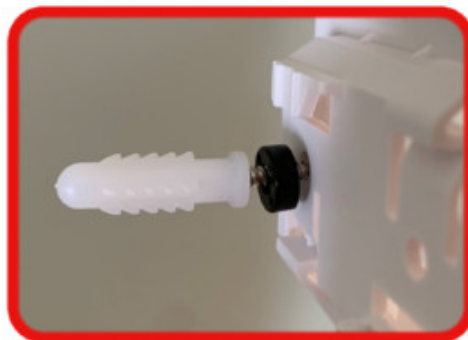

## CONNECT THE AP

Plug one end of the Ethernet cable from your network into the LAN PoE port on the bottom panel of the AP. Make sure the other end of the Ethernet cable is connected to your network through a hub, switch, or injector with PoE (802.3af/at) power enabled.

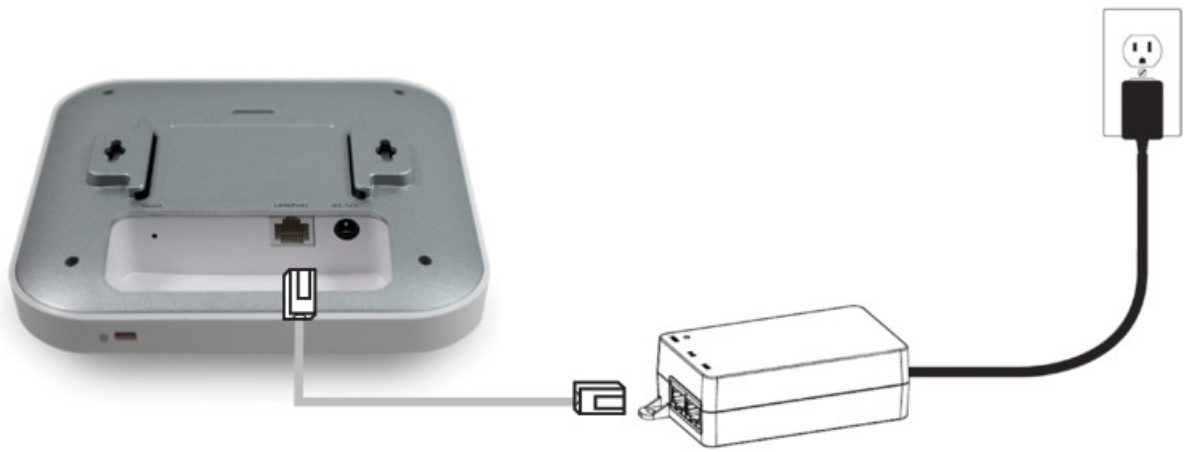

Access Point connected to PoE Injector



Access Point connected to switch with PoE power

## FRONT PANEL



## BACK PANEL

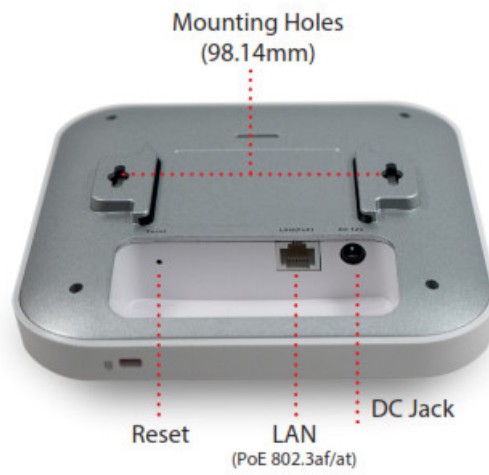

## POWER REQUIREMENTS

- PoE 802.3af/at (48V DC, 0.6A)
- Optional DC power adapter (12V, 2A)

Power Options	
WG8602 (AU), WG8601 (UK), WG8600 (EU), WG8599 (US)	WatchGuard 802.3at PoE+ Injector with AC cord
WG9009	12V Power Adapter for WatchGuard AP130

## CONFIGURE AND TROUBLESHOOT THE AP

GO TO: [watchguard.com/start](https://watchguard.com/start)



Wi-Fi in WatchGuard Cloud



<http://www.watchguard.com/start>

## **NOTICES:**

All WatchGuard products are designed and tested to meet strict safety requirements. These requirements include product safety approvals and other global compliance standards. Please read these instructions carefully before operating the product, and refer to them as needed to ensure the continued safe operation of your product. Additional information, including a full list of safety approvals, global compliance standards, and certifications can be found in the Hardware Guide for this device located on the WatchGuard website:

<https://www.watchguard.com/wgrd-help/documentation/hardware-guides>

For patent information, please visit <http://www.watchguard.com/patents>

### **Safety Warning**

If protective earthing is used as a safeguard, the instructions shall require the connection of the equipment protective earthing conductor to the installation protective earthing conductor (for example, by means of a power cord connected to a socket-outlet with earthing connection). To meet safety and electromagnetic interference (EMI) requirements, you must make sure the power source is connected to earth ground before you connect power to the AP.

### **Power Adapter Requirements**

This product is intended to be supplied by a Listed Power Adapter or DC power source marked “L.P.S.” (or Limited Power Source or PS2) rated 12V DC, 2A minimum, maximum ambient temperature (Tma)=40°C, or supplied by a Listed PoE Adapter marked “L.P.S.” (or Limited Power Source or PS2) rated 48V DC, 0.6A minimum, maximum ambient temperature (Tma)=40°C. For more information regarding approved power sources, please contact WatchGuard Technologies.

This product is for indoor use only.

### **Declaration of Conformity**

WatchGuard Technologies Inc. hereby declares that the product(s) listed below conform to the European Union directives and standards identified in this declaration.

#### **Product (s):**

802.11 a/b/g/n/ac Access Point, AP130

#### **EU Directive(s):**

Low Voltage (2014/35/EU)

Electromagnetic Compatibility (2014/30/EU)

Energy-related Products (2009/125/EC)

RoHS (2011/65/EU and 2015/863/EU RoHS) WEEE Directive 2012/19/EU

The Radio Equipment Directive (2014/53/EU)

#### **Common Standard(s):**

EN 62368-1:2014+A11:2017 EN 55024:2010 EN 55024: 2010+A1:2015 EN 55032:2015/AC:2016 EN 55035: 2017 EN 61000-3-2:2014 EN 61000-3-3:2013	Safety for ITE Immunity for ITE Harmonics Flicker
--	--

**Wireless Standard(s):**



EN 62311:2008 EN 301 489-1 v2.2.3 (2019-11) EN 301 489-17 v3.1.1 (2017-02) EN 300 328 v2.2.2 (2019-07) EN 301 893 v2.1.1 (2017-05) EN 50385: 2017	EMC and Radio Spectrum Matters EMC and Radio Spectrum Matters Radio Spectrum Matters Broadband Radio Access Networks
---	---

This device complies with Directive 2014/53/EU issued by the Commission of the European Community.

Manufacturer / Hersteller: Equipment / Funkanlage: Type Designation / Typenbezeichnung: Specifications / Technische Daten: Intended Purpose / Verwendungszweck: Equipment Class / Betriebsmittel der Klasse: Operating temperature	WatchGuard Technologies 505 5thAve S. Suite 500, Seattle, WA 98104 USA Radi o 802.11 a/b/g/n/ac Access Point AP130 802.11a,b,g,n,ac (2.4Ghz & 5GHz) Indoor access point Class II 0° C to 40° C
--	--

The above device complies with the essential requirements and other relevant provisions to Directive 2014/53/EU when used for its intended purpose. This equipment may be operated in the USA, Canada, & Europe Union. Warning! This is a Class B product. In a domestic environment, this product may cause radio interference in which case the use may be required to take adequate measures.

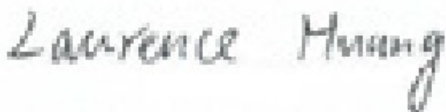
Frequency range (MHz)	Max. Transmit Power (W)
WLAN Wi-Fi 802.11x; 2, 4 GHz	0.09418
WLAN Wi-Fi 802.11x; 5 GHz	0.86896

Signature  

## WATCHGUARD TECHNICAL SUPPORT

1.877.232.3531 (U.S. and Canada)  
+1.206.613.0456 (all other countries)  
[www.watchguard.com/support](http://www.watchguard.com/support)



ADDRESS: 505 Fifth Avenue South, Suite 500, Seattle, WA 98104  
U.S. SALES: 1.800.734.9905  
INTERNATIONAL SALES: +1.206.613.0895  
WEB: [www.watchguard.com](http://www.watchguard.com)

© 2022 WatchGuard Technologies, Inc. All rights reserved. WatchGuard, the WatchGuard Logo, Fireware, and LiveSecurity are registered trademarks of WatchGuard Technologies, Inc. in the United States and/or other countries. All other trademarks and tradenames are the property of their respective owners. P.N. 352-4130-001 Rev B 011222

### Documents / Resources

	<p><a href="#">WatchGuard AP130 WiFi Access Point Cloud Managed</a> [pdf] User Guide AP130, WiFi Access Point Cloud Managed</p>
---	---