

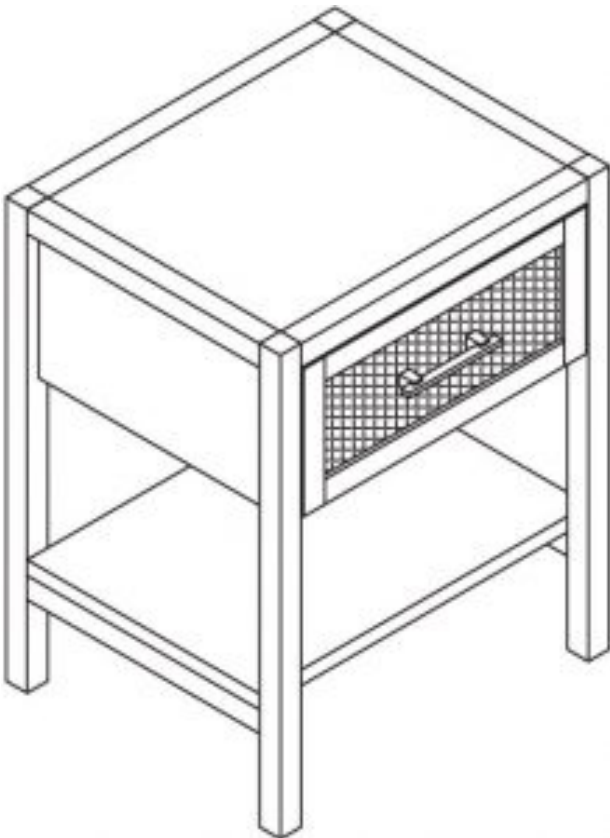

# warwick Side Table Instruction Manual

[Home](#) » [warwick](#) » warwick Side Table Instruction Manual 

warwick Side Table Instruction Manual



## Contents

- [1 Introduction](#)
- [2 Hardware](#)
- [3 How to use the cam lock system](#)
- [4 Assembly Instructions](#)
  - [4.1 Step 1: attach back panel to right side frame](#)
  - [4.2 Step 2: attach top panel](#)
  - [4.3 Step 3: attach left side frame](#)
  - [4.4 Step 4: attach shelf](#)
  - [4.5 Step 5: assemble drawer starting with drawer sides / finish assembly with handle](#)
  - [4.6 Step 6: install drawer](#)
- [5 Quality That Lasts A Lifetime](#)
- [6 THE SALICE LIFETIME GUARANTEE AND LIMITED WARRANTY\\*](#)
- [7 Support](#)
- [8 Documents / Resources](#)
- [9 Related Posts](#)

## Introduction

**Congratulations on your latest Target purchase.**

Now what? Don't start sweating over this box of parts. This will be easy. We did the hard work for you. All you need to do is follow our simple instructions and you'll be on your way to transforming your room in no time. Good luck—though we're confident you won't need it.

### before you begin

1. Check for damaged or missing parts. Call 1-855-MYTGTHOME (855-698 4846) to order missing supplies.
2. Use the carton as a working surface to prevent product damage during assembly.
3. Read through and review assembly steps.
4. Gather all tools prior to assembly.

### tools needed



## Hardware

- (H1) x 14 wooden dowel

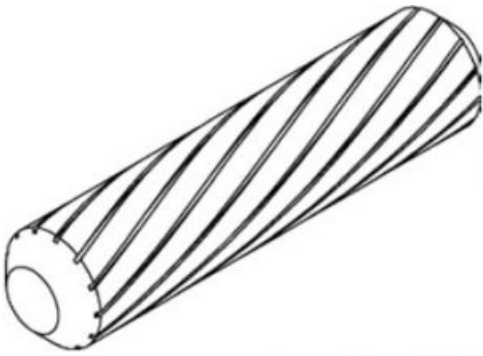

- (H2) x 6 cam bolt

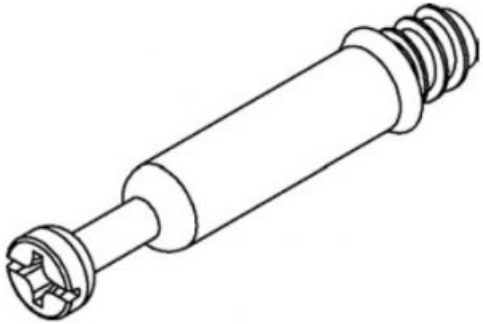

- (H3) x 6 cam

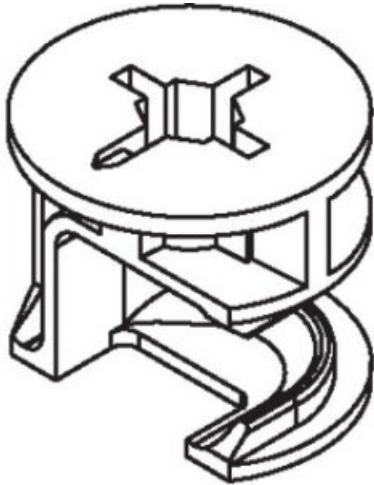

- (H4) x 8 bolt

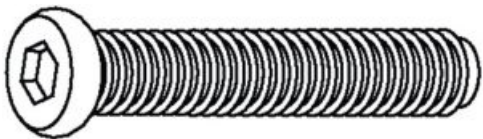

- (H5) x 8 lock washer

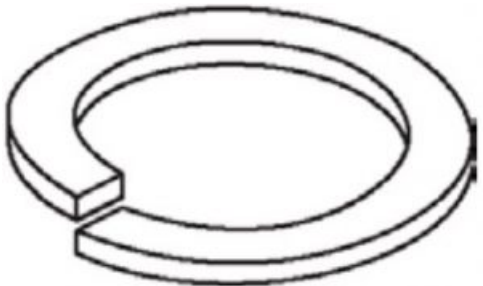

- (H6) x 8 washer

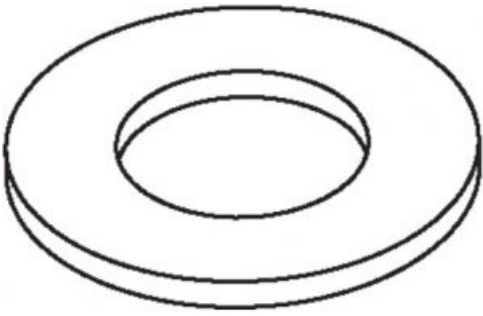

- (H7) x 1 allen wrench



- (H8) x 2 handle bolt

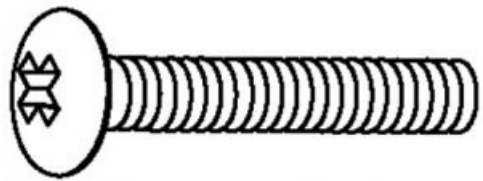

- H9) x 1 handle

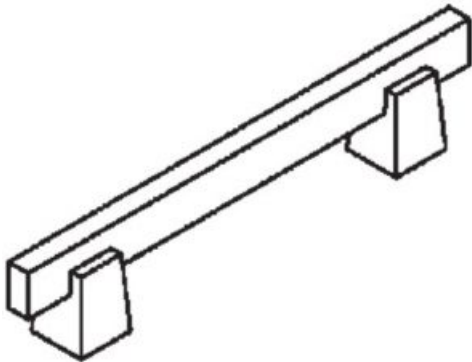

- (H10) x 4 flat head screw

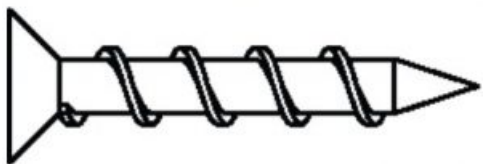

Exploded diagram

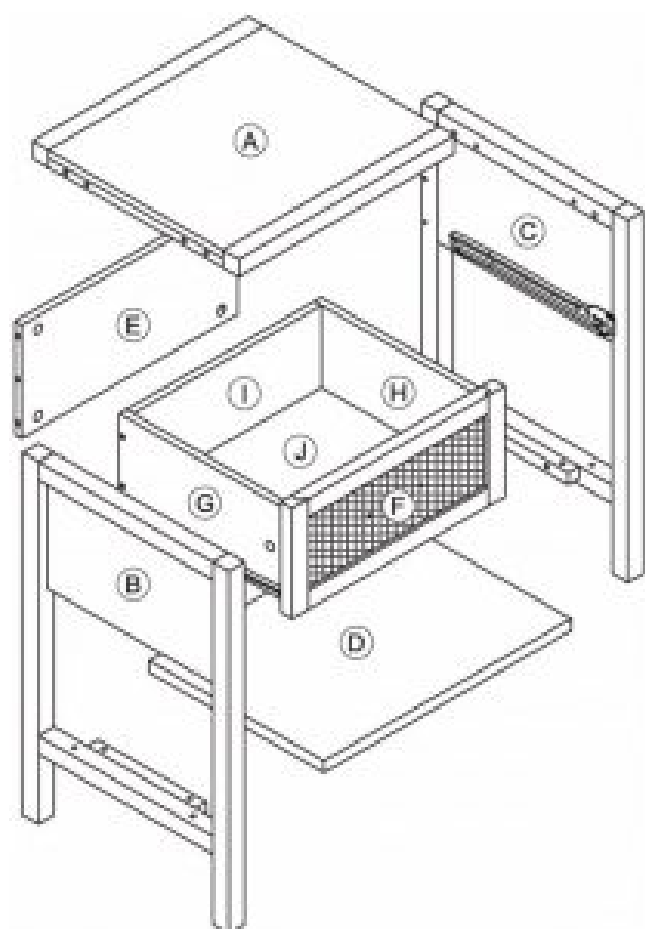

ITEM	DESCRIPTION	QUANTITY
A	top panel	1
B	left side frame	1
C	right side frame	1
D	shelf	1
E	back panel	1
F	drawer face	1
G	left drawer side	1
H	right drawer side	1
I	drawer back	1
J	drawer bottom	1

## How to use the cam lock system

1. Screw cam bolt into panel

**1.**

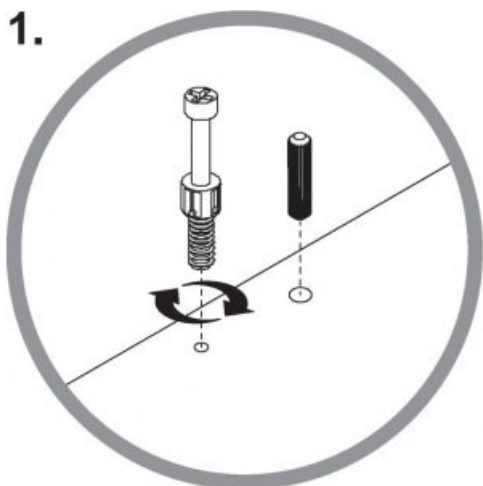

2. Align cam bolt(s) with cam(s) and insert all the way into cross-bored hole(s)

**2.**

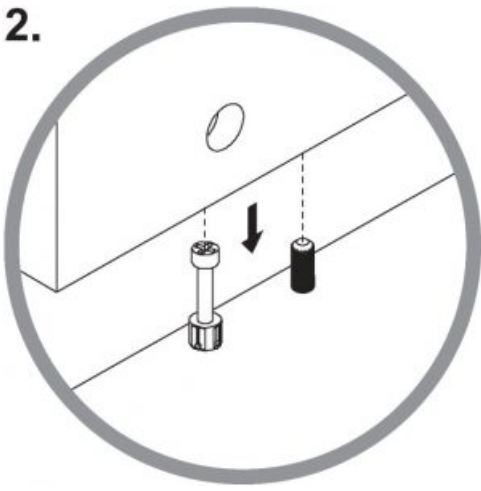

3. Push cam into panel – arrow feature on cam top points to panel edge

**3.**

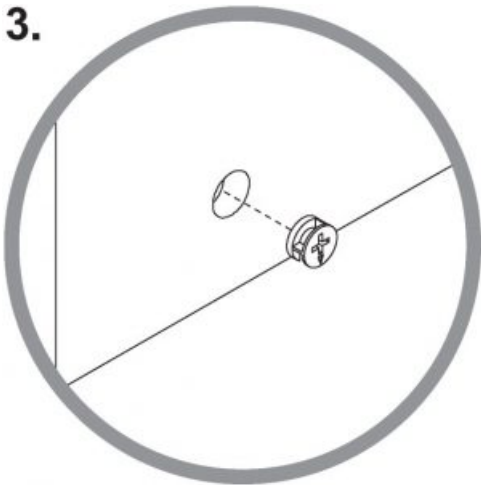

4. Rotate cam(s) clockwise 180° to lock panels together

**4.**

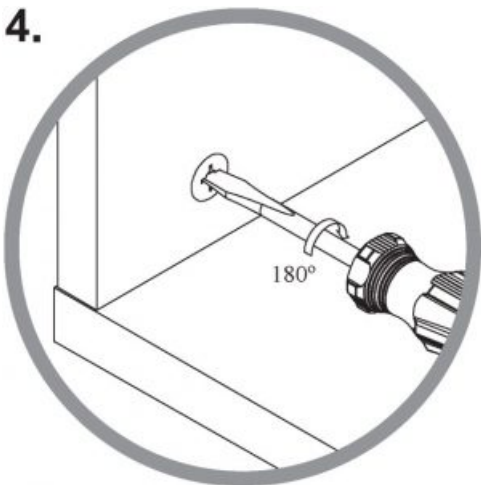

5. Panels should be tight against each other and connection should be rigid

5.

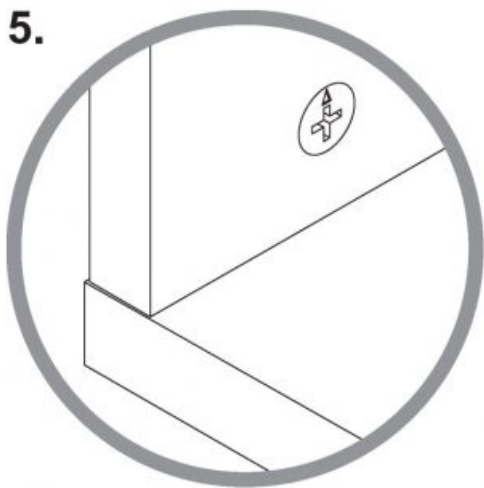

## Assembly Instructions

### Step 1: attach back panel to right side frame

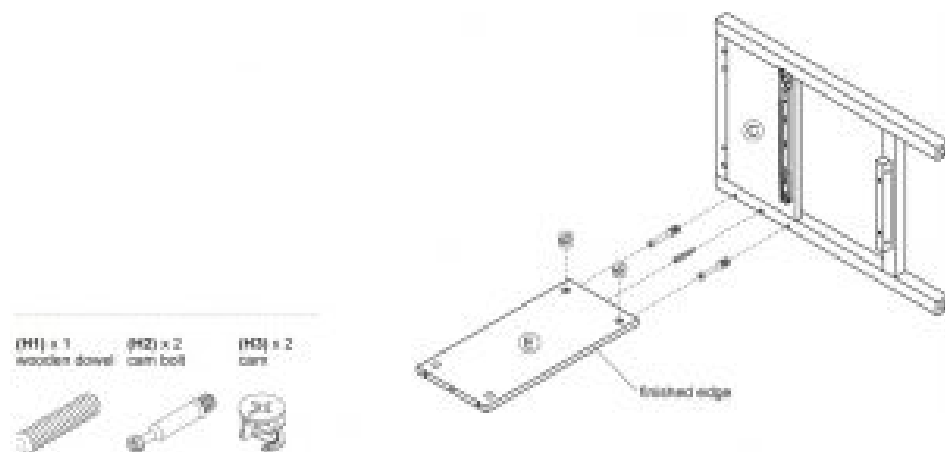

1. Carefully tap small wooden dowels into place. Leave 1/2" of the dowels sticking out.
2. Screw-In cam bolts must be screwed down flush.
3. Refer to page 6 for instructions on how to use the cam lock system.

### Step 2: attach top panel

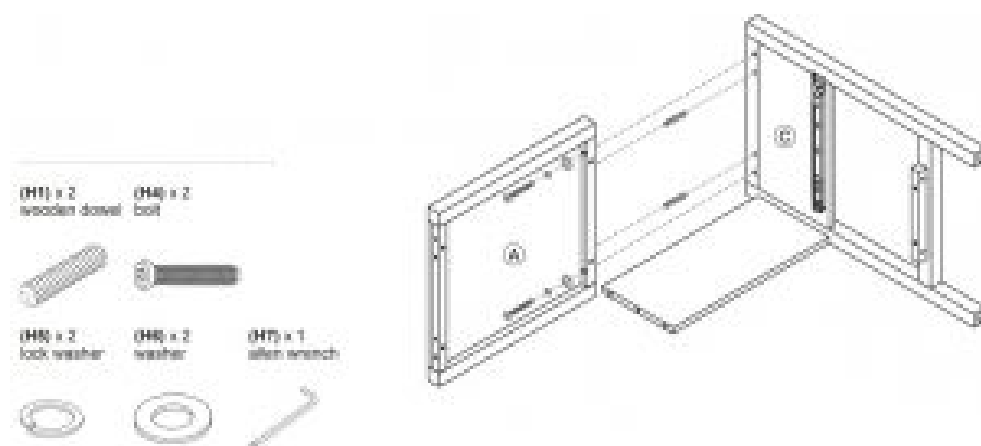

1. Carefully tap small wooden dowels into place. Leave 1/2" of the dowels sticking out.
2. Align bolts with pre-drilled holes.



3. Do no over tighten bolts.

### Step 3: attach left side frame

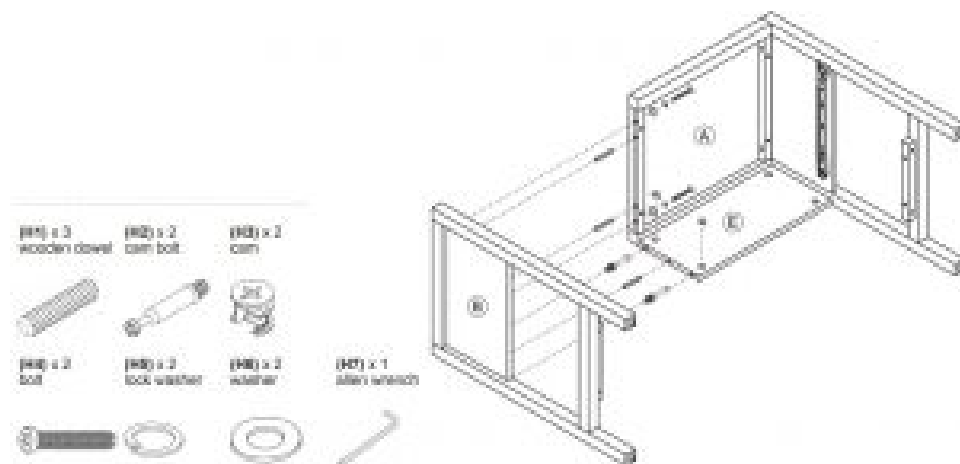

1. Carefully tap small wooden dowels into place. Leave 1/2" of the dowels sticking out.
2. Screw-In cam bolts must be screwed down flush.
3. Refer to page 6 for instructions on how to use the cam lock system.
4. Align bolts with pre-drilled holes.
5. Do no over tighten bolts.

### Step 4: attach shelf

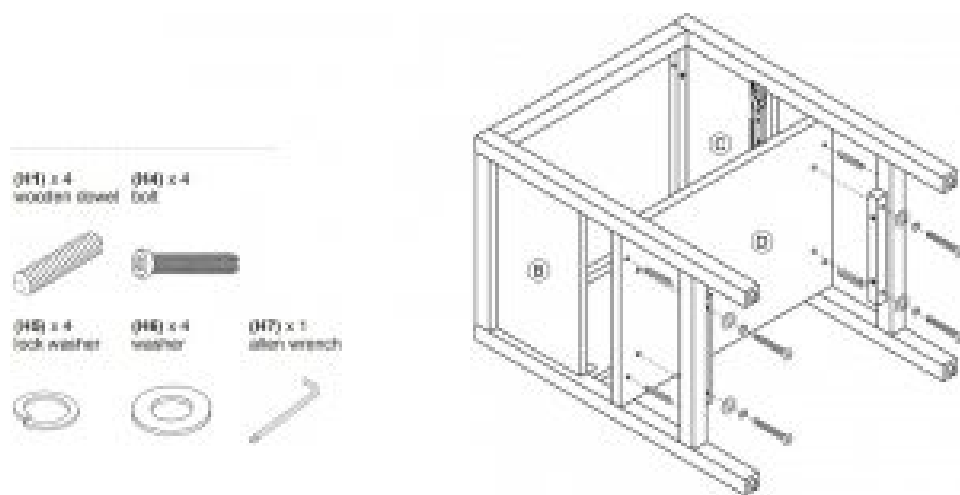

1. Carefully tap small wooden dowels into place. Leave 1/2" of the dowels sticking out.
2. Align bolts with pre-drilled holes.
3. Do no over tighten bolts.

### Step 5: assemble drawer starting with drawer sides / finish assembly with handle

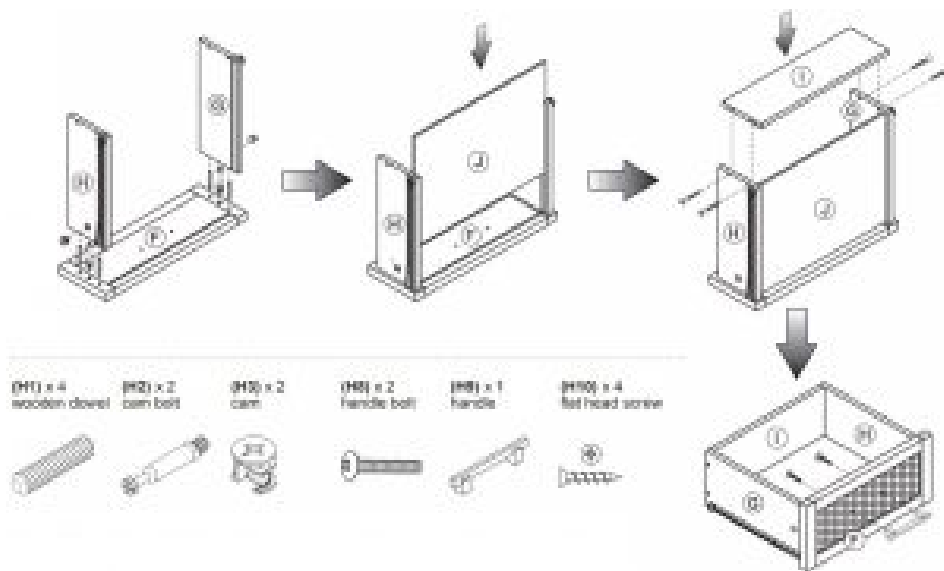

1. Carefully tap small wooden dowels into place. Leave 1/2" of the dowels sticking out.
2. Screw-In cam bolts must be screwed down flush.
3. Refer to page 6 for instructions on how to use the cam lock system.
4. Align screws with pre-drilled holes.
5. Do not over tighten screws.

#### Step 6: install drawer

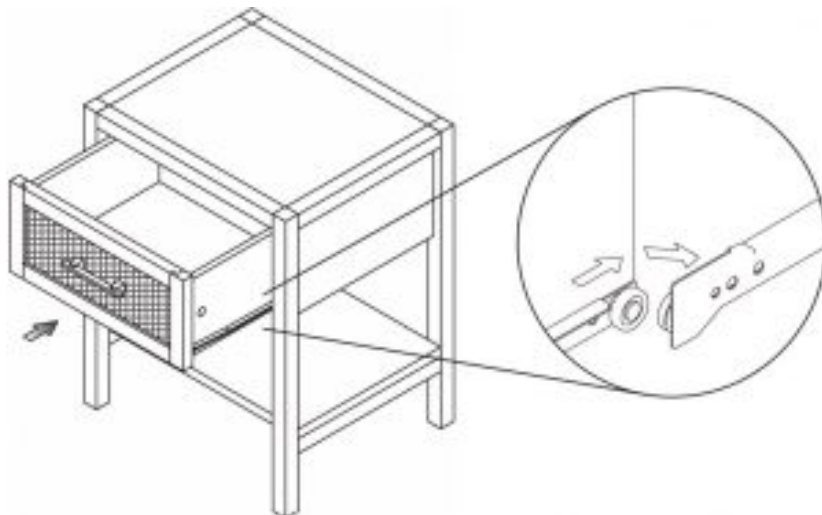

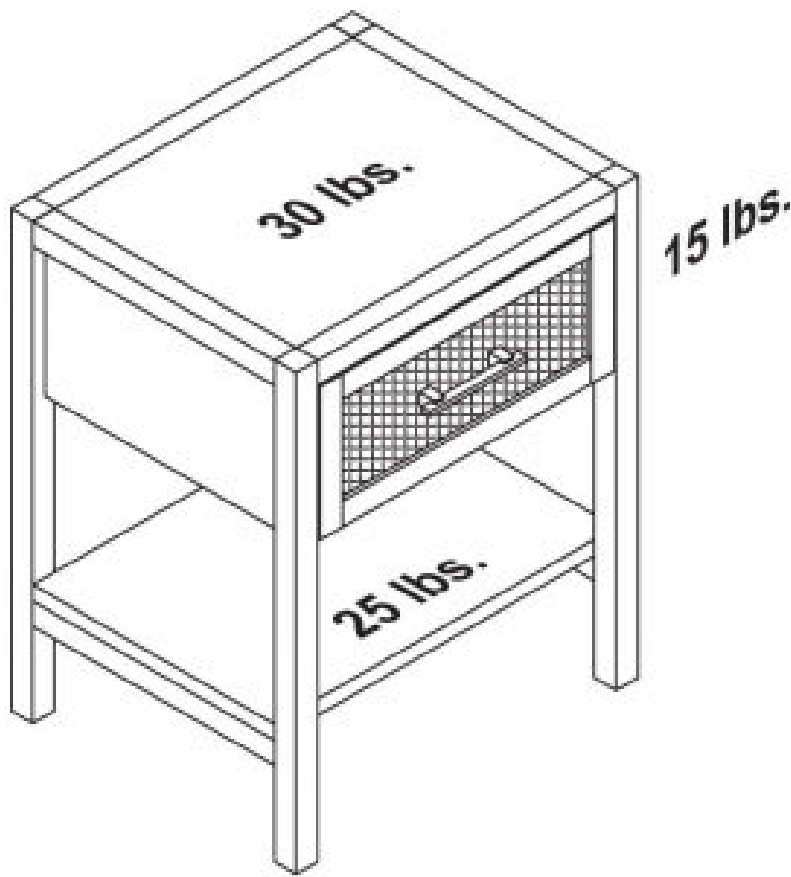

1. This unit has been designed for the weight shown. Exceeding this recommended weight could result in excessive “sagging” of the top. Extreme overloading can cause failure of the top and possible injury.
2. Furniture Care Instructions: Dust with a clean, lint-free cloth. Use a spray furniture polish as needed.

### **Quality That Lasts A Lifetime**

The maker of this product has extended his craftsmanship to include Salice hinges and/or other Salice products. Having undergone severe usage tests and met industry standards worldwide, our products confirm our commitment to pleasing the most discriminating customer – you.

### **THE SALICE LIFETIME GUARANTEE AND LIMITED WARRANTY\***

Salice America, Inc., warrants that all hinges and/or Salice products contained in this product, (but not the product itself) against defects in material and workmanship for as long as the original consumer purchaser owns the products. Salice will send the original consumer purchaser a new Salice hinge to replace any defective Salice hinge subject to this warranty without charge. The warranty is a warranty of replacement only. Salice specifically does not warrant removal of the defective hinge nor installation of a new hinge. This warranty does not cover hinges which have been incorrectly installed, exposed to excessive loads or abused.

To obtain a replacement, you should, within 30 days of discovery of the defect, remove the defective hinge and mail it postage prepaid to:

# ***SALICE***

SALICE AMERICA Inc.  
2123 CROWN CENTRE DRIVE

Enclose a brief letter explaining the defect with a copy of your proof of purchase. Allow approximately four (4) weeks for delivery of the replacement.

ALL WARRANTIES IMPLIED BY STATE LAW, INCLUDING THE IMPLIED WARRANTIES OF MERCHANTABILITY AND FITNESS FOR A PARTICULAR PURPOSE, ARE EXPRESSLY LIMITED AS SET FORTH ABOVE. However, some states do not allow limitations on how long an implied warranty lasts, so the above limitation may not apply to you. WITH THE EXCEPTION OF ANY WARRANTIES IMPLIED BY STATE LAW AS HEREBY LIMITED, THE FOREGOING EXPRESS LIMITED WARRANTY IS EXCLUSIVE AND IN LIEU OF ANY OTHER WARRANTIES OF SALICE WITH RESPECT TO THE REPAIR OR REPLACEMENT OF ANY PROPS OR PARTS.

IN NO EVENT SHALL SALICE BE LIABLE FOR CONSEQUENTIAL OR INCIDENTAL DAMAGES RESULTING FROM THE USE, INSTALLATION, PERFORMANCE OR FAILURE OF ITS PRODUCT. However, some states do not allow the exclusion of limitation of incidental or consequential damages, so the above exclusion may not apply to you. This limited warranty gives you specific legal rights and you may also have other rights which vary from state to state.

## Support

### QUESTIONS?

Just **call 1-855-MYTGTHOME (855-698-4846)** for parts and service.

For faster service, have the style number and DPCI number ready when calling.

© 2019 Target. The Bullseye Design is a trademark of Target Brands, Inc. All rights reserved.

## Documents / Resources

	<a href="#">warwick Side Table</a> [pdf] Instruction Manual Side Table
---	---