



WANWAYTECH B097R8S22D Portable GPS Tracker User Manual

[Home](#) » [WanWayTech](#) » WANWAYTECH B097R8S22D Portable GPS Tracker User Manual 

WANWAYTECH B097R8S22D Portable GPS Tracker User Manual



To ensure quick and correct usage, please read the instruction manual carefully before using it.

Contents

- [1 Product Introductions](#)
- [2 Download “TrackerOne”](#)
- [3 Device Binding](#)
- [4 Device Renewal](#)
- [5 Device Installation](#)
- [6 Device Functions](#)
- [7 Working Mode](#)
- [8 Precautions](#)
- [9 Basic Parameters](#)
- [10 Warranty policy](#)
- [11 Documents / Resources](#)
- [12 Related Posts](#)

Product Introductions

Power Supply

Open the device silicone plug connect to external power, red LED indicator long light means device charging, power LED slow Flashing means device full charged.

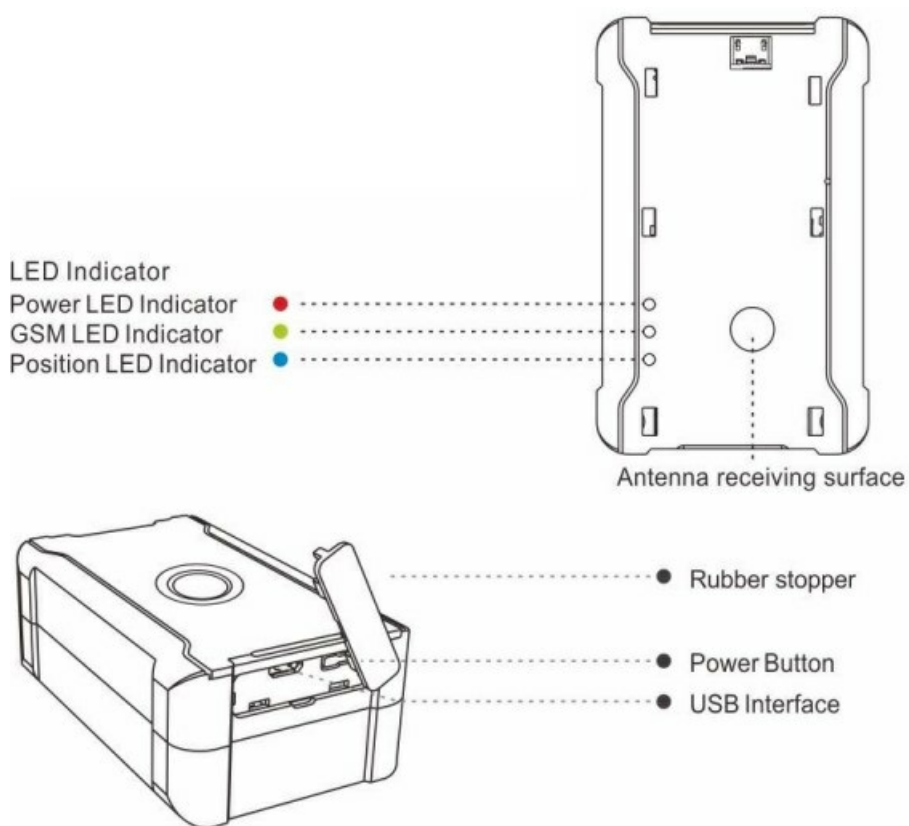

Power On and Off

Long press the power button for more than 3 seconds to switch on or off.

Download “TrackerOne”



TrackerOne APP

Search "TrackerOne" in Google play store or app store or scan the QR code to download and install the latest TrackerOne APP.

Device Binding

Start the TrackerOne APP, use your email to register and log in. It also supports Imei login.

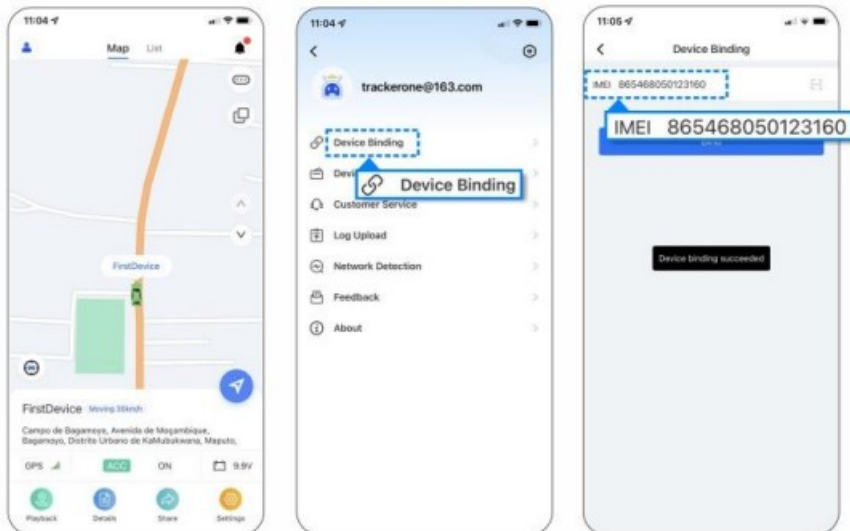

Login by IMEI number(the 15 digits on the device label), default password is the last 6 digits of imei number.

Device Renewal

Select a plan to complete device activation and continuous use.

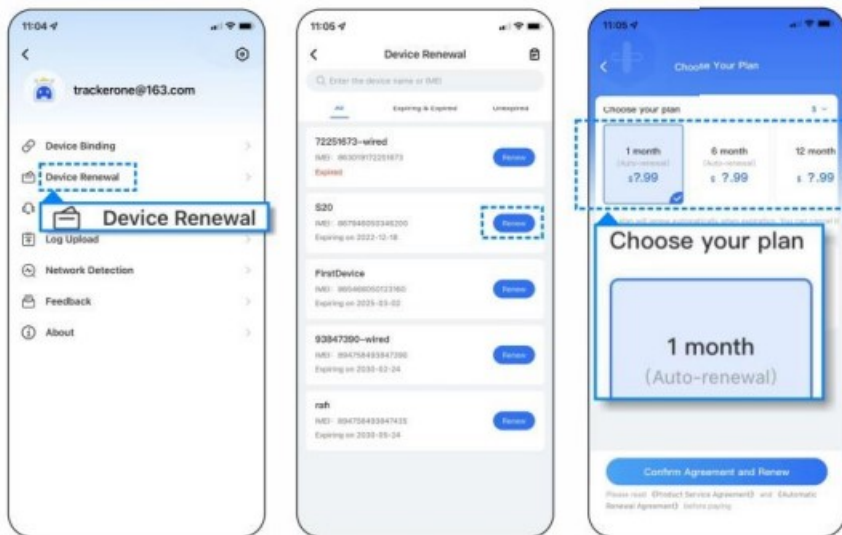

Device Installation

Before installation, check device shell and its accessories. These positions are advised to install the device.

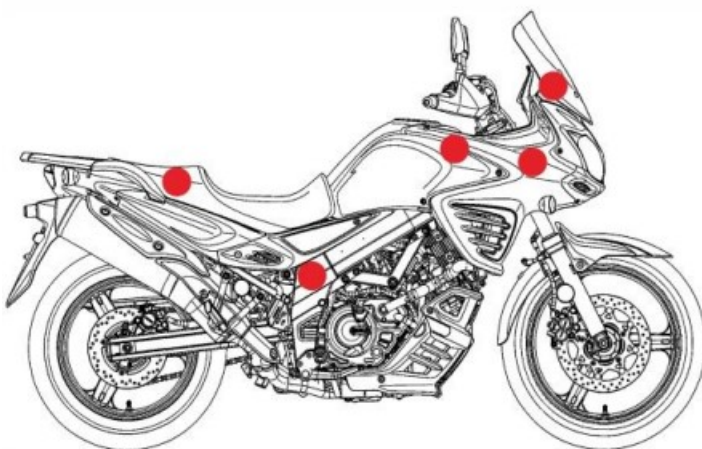
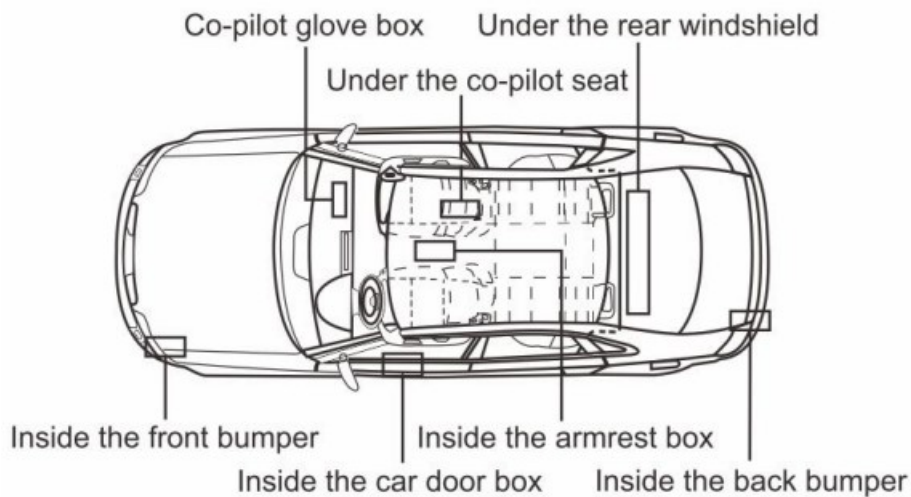

Note:

1. Avoid device to touch somewhere high temperature such as car exhaust pipe, or it will make magnet useless.
2. Avoid device covered by metal things, and ensure the side with GPS antenna face the sky.

Device Functions

- **Tracking Location**

Support GPS+LBS positioning method to quickly obtain device location.

- **Trace Playback**

Query the vehicle driving track in the past 180 days.

- **Over-speed Alarm**

Set maximum speed and an alarm will be given if the speed is exceeded.

- **Geo-fence Alarm**

Set various circular or polygonal fences, and the alarm information will be uploaded when the vehicle in-fence or out-fence.

- **Lower Battery Alarm**

When the device power is low, it will remind you to supply power in time.

- **Light-sensor Alarm**

Built-in light sensor, the backside of device sees light to trigger an alarm immediately.

Working Mode

- **Intelligent Power Saving Mode**

It's a default mode. Device uploads positioning data when it's moving, and GPS-off after it's static. Recommend this mode for power saving.

- **Time Interval Mode**

The device uploads the positioning data according to the presetting time interval and keeps the working state.

Precautions

- Device warranty not including the damage of human factor.
- Do not put device or its built-in battery in water or fire, do not bend or open the battery.
- Do not disassemble device, which may cause damage for device due to un-professional handing.

Basic Parameters

GSM Frequency	850/9001180011900 MHZ
Supported location method	GPS/ LBS
Location Accuracy	<5m
Light Alarm	Yes
Device Dimension	80x50x32mm
Battery Volume	6000mAh
Working Voltage	3.7V
Working Temperature	-25°C to+85°C
Weight	175g

Warranty policy

Special statement

This product is subject to any technical change without prior notice.
Product appearance and color are subject to the real product.

Replacement policy

We can replace a new one for you if device not damaged by human factor.

Warranty Card

Customers Data

Customers Name		Telephone	
Address			
Model Type		IMEI number	
Purchase Data		Invoice No	
Company Address			

Please reserve the warranty card carefully.

Documents / Resources



[WANWAYTECH B097R8S22D Portable GPS Tracker](#) [pdf] User Manual
B097R8S22D Portable GPS Tracker, B097R8S22D, Portable GPS Tracker, GPS Tracker, Tracker