

WAN WAY TECH GS05 3G GPS Tracker User Manual

[Home](#) » [WAN WAY TECH](#) » WAN WAY TECH GS05 3G GPS Tracker User Manual 

Contents

- [1 WAN WAY TECH GS05 3G GPS Tracker](#)
- [2 Product Parameters & Functions](#)
- [3 Product Features](#)
- [4 Product Size](#)
- [5 Sim Installation](#)
- [6 Wire Connection](#)
- [7 LED Indicator](#)
- [8 Product Installation](#)
- [9 Quick Operation Instructions](#)
- [10 Working Description](#)
- [11 Trouble Shooting](#)
- [12 Access to Platform](#)
- [13 Documents / Resources](#)
- [14 Related Posts](#)



WAN WAY TECH GS05 3G GPS Tracker

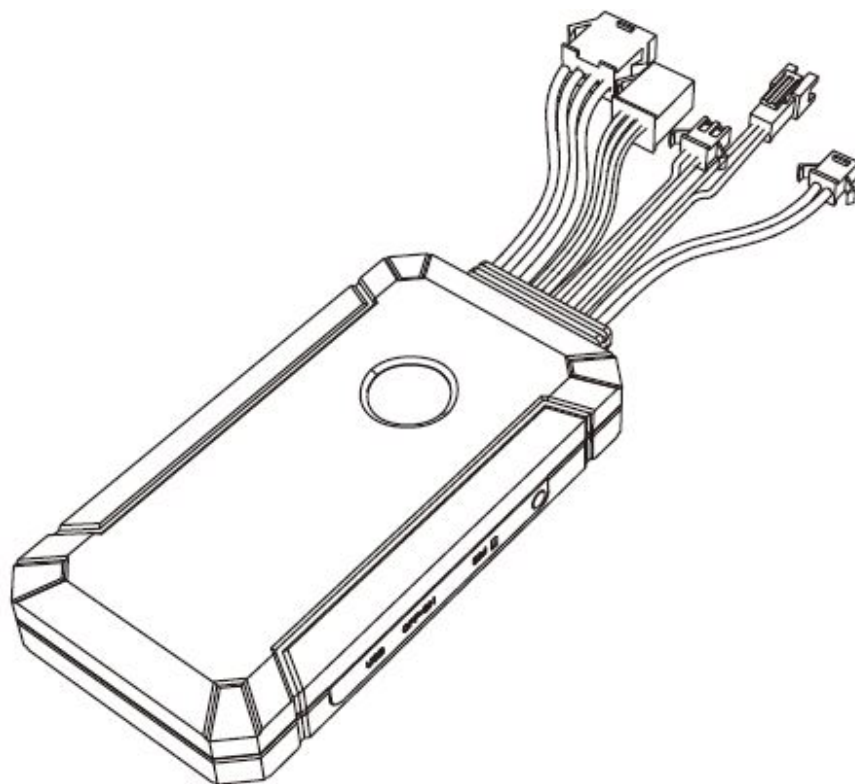

Product Parameters & Functions

Product Parameters

Item	Name	Specification
Main Features	Size	100x53x17mm
	Battery	180mAh
	Voltage Range	9V - 75V
GPS	GPS Fixed Time	Hot<1sec (Open Sky)
		Cold<32sec(Open Sky)
	Positioning Accuracy	< 10m
Working temperature		-30°C ~ 60°C

Operating Frequency Band(RF):

GSM 850 :824.2-848.8MHz (TX),869.2-893.8MHz (RX) GSM 900 :880.2-914.8MHz(TX),925.2-959.8MHz(RX)
DCS :1710.2-1784.8MHz(TX),1805.2-1879.8MHz(RX) PCS :1850.2-1909.8MHz(TX),1930.2-1989.8MHz(RX)
WCDMA Band1 :1920-1980MHz (TX),2110-2170MHz (RX) WCDMA Band2 :1850-1910MHz(TX),1930-1990MHz(RX)
WCDMA Band5 :824-849.0MHz(TX),869-894.0MHz(RX) WCDMA Band8 :880-915MHz(TX),925-960MHz(RX)

Modulation mode:

WCDMA Uplink: BPSK/QPSK/16QAM; WCDMA Downlink: BPSK/QPSK/16QAM/64QAM GSM850 EGSM900 8-PSK DCS1800 PCS1900 8-PSK

RF output power

Class 3 (24dBm \pm 1/-3dB) @WCDMA bands Class E2 (27dBm \pm 3dB) @GSM850 EGSM900 8-PSK Class E2 (26dBm \pm 3dB) @DCS1800 PCS1900 8-PSK Class 4 (33dBm \pm 2dB) @EGSM900 GSM850 Class 1 (30dBm \pm 2dB) @DCS1800 PCS1900

Operate at 20 cm or more from nearly persons

FCC This device complies with part 15 of the FCC Rules. Operation is subject to the following two conditions:

1. This device may not cause harmful interference
2. this device must accept any interference received,

including interference that may cause undesired operation. Caution: Changes or modifications to this unit not expressly approved by the party responsible for compliance could void the user's authority to operate this equipment.

NOTE: This equipment has been tested and found to comply with the limits for a Class B digital device, pursuant to part 15 of the FCC Rules. These limits are designed to provide reasonable protection against harmful interference in a residential installation. This equipment generates, uses and can radiate radio frequency energy and, if not installed and used in accordance with the instructions, may cause harmful interference to radio communications. However, there is no guarantee that interference will not occur in a particular installation. If this equipment does cause harmful interference to radio or television reception, which can be determined by turning the equipment off and on, the user is encouraged to try to correct the interference by one or more of the following measures:

- Reorient or relocate the receiving antenna.
- Increase the separation between the equipment and receiver.
- Connect the equipment into an outlet on a circuit different from that to which the receiver is connected.
- Consult the dealer or an experienced radio/TV technician for help.

Product Features

SIM Card needs SMS, data service and phone call functions



ACC
Detection



Geo-fence



Low Battery
Alarm



Trace
Playback



Real-time
Tracking

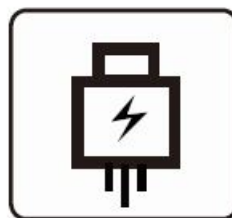

Remotely
Stop Engine



Cut-wire
Alarm



SOS
Emergency



Voice
Monitoring

Product Size

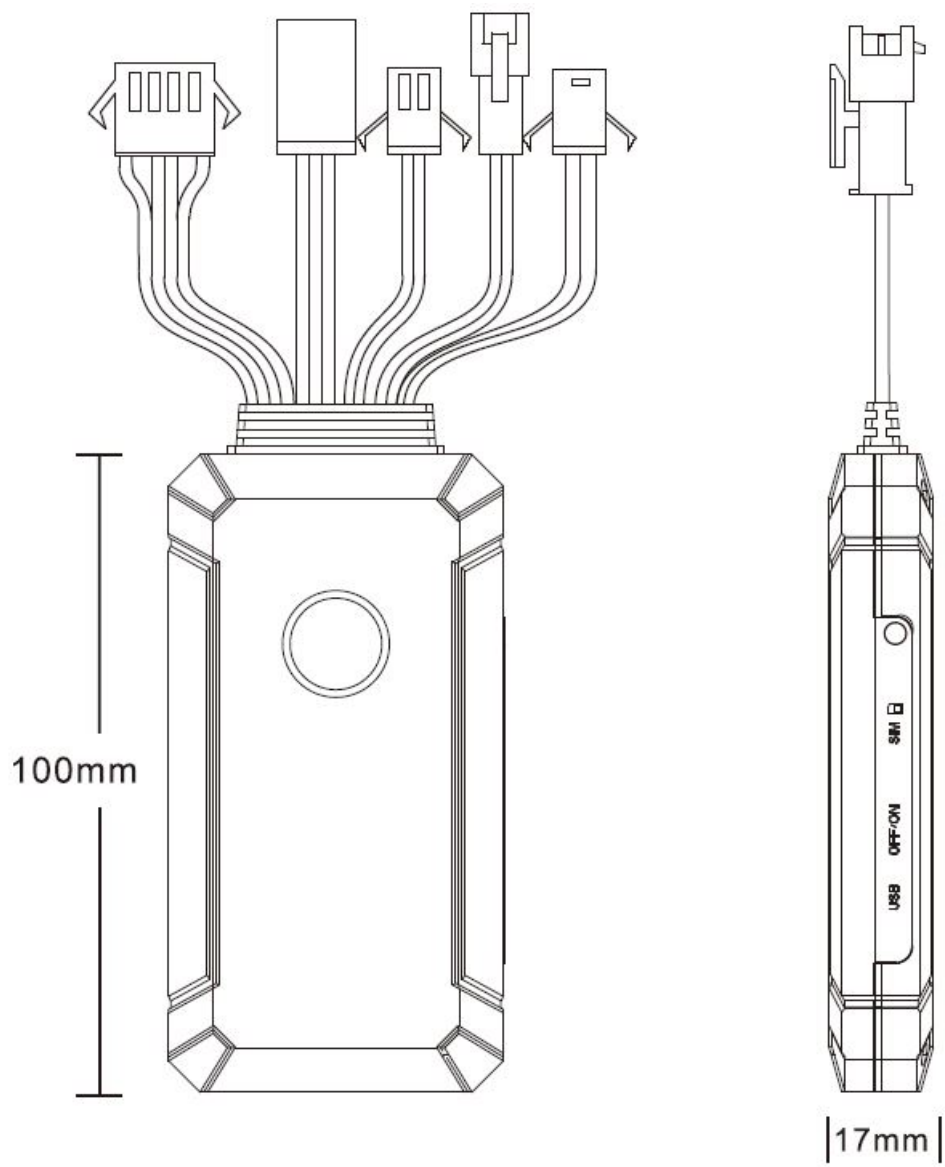

Sim Installation

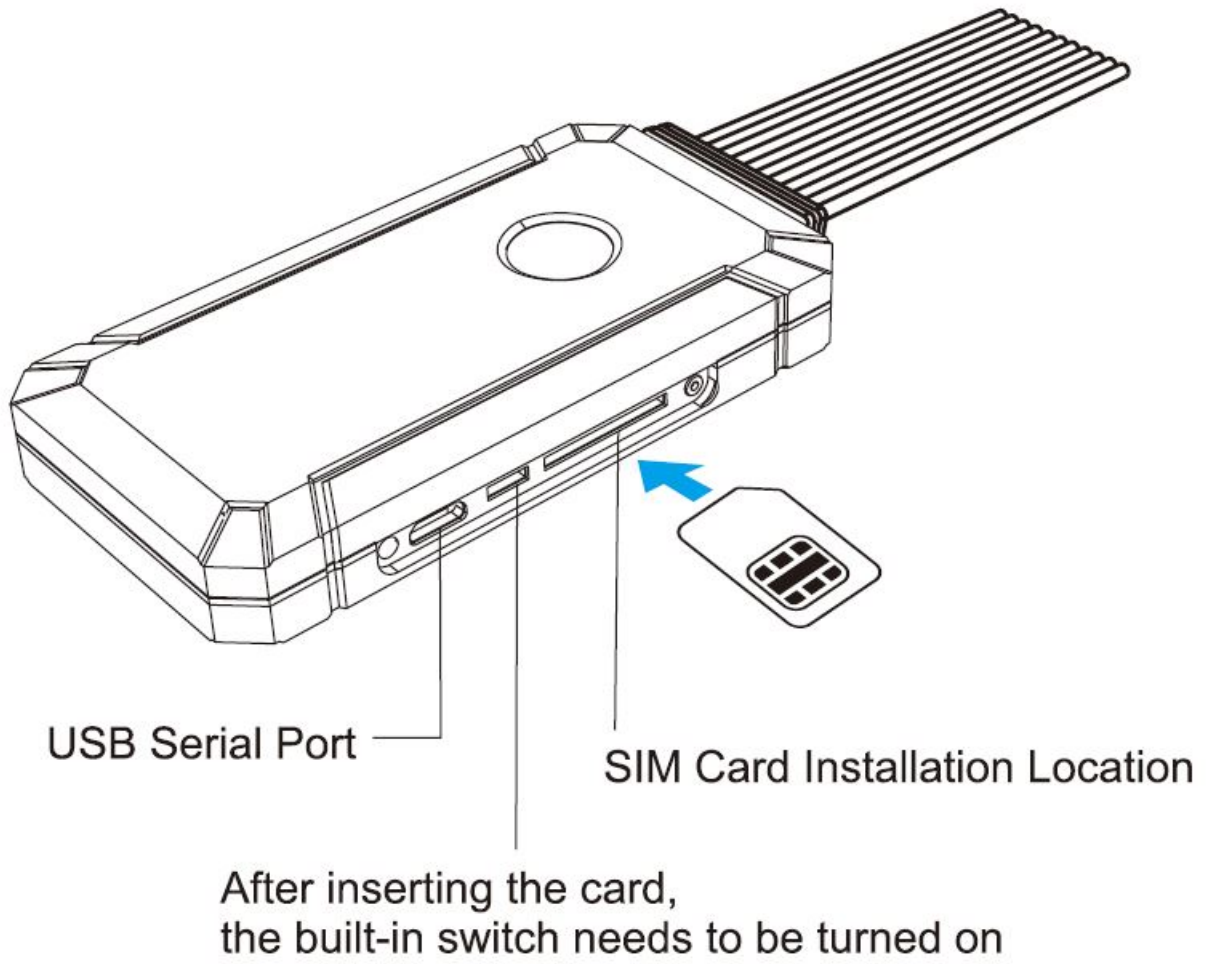

Wire Connection

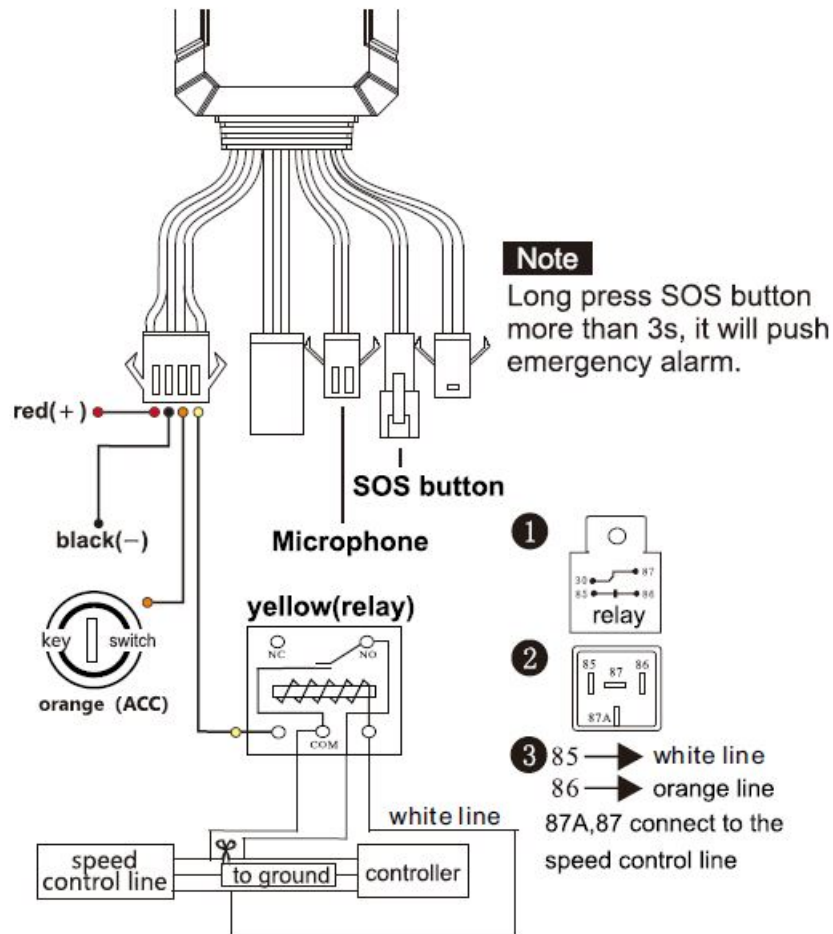

LED Indicator

LED type	LED status	Meaning
Yellow Light	Slow flash	GSM initialization
	Steady	GSM communication normal
	No Light	GSM in sleep mode / shut down
Blue Light	Slow flash	Searching for satellite signals
	Steady	GPS / BDS is located
	No Light	GPS is in sleep mode
Red Light	Steady	GPS unit ON

Product Installation

Please consult a technician for installation.

1. The device should be installed in a waterproof and dry place.
2. Please Insert SIM card before connecting power and switching ON .
3. Ensure device light in the front and there is no metal ~-
4. Secure with a cable tie or sponge double sided tape

Quick Operation Instructions

To ensure GPRS is active, please make sure APN is COIT8ct. You can send SMS command tD set APN. APNcommand Format APN, APN's Nam Eg: APN,ln('tamer is 1he APN of carrier

Working Description

1. Turn on the switch after inserting SIM card and connect the device to the vehicle power, and then the indicator lights will start blinking.
2. If the device is using its own battery, the power indical0r light (red) will slowly blink after turning on manually.

Trouble Shooting

Problem	Description	Solution
Failed to connect the internet	SIM card not installed	Check the SIM card
	SIM card not installed properly	Install again
	No GSM network	Move the device to the GSM network area.
	Weak GSM network	Move the device to strong GSM network area.
Location failed	SIM card has no GPRS functions	Contact SIM card supplier to activate the GPRS function
	Always reply "failed to get location"	Contact the supplier
No GPS location	Some poor signal areas like basement, tunnels are not able to acquire GPS signals	Move the device to open sky areas

Access to Platform

1. Platforn(www.wanwaygps.com).
2. Android end 10S APP(Scan the qr code to download app)_



There are two methods to login In the platform or app

1. Login by IMEI number(the 15 digits In the back of the device), password: the last 6 digits of IMEI number.
2. Contact the supplier to cniat& an account for you.

Documents / Resources



[WAN WAY TECH GS05 3G GPS Tracker](#) [pdf] User Manual
GS05, 2AWBA-GS05, 2AWBAGS05, GS05, 3G GPS Tracker

Manuals+.