

Walmart
i2
Horizontal
Mouse



Walmart i2 Horizontal Mouse Instruction Manual

[Home](#) » [Walmart](#) » Walmart i2 Horizontal Mouse Instruction Manual 

Contents

- 1 Walmart i2 Horizontal Mouse
- 2 Product Information
- 3 Product Usage Instructions
- 4 FAQs
- 5 Product Introduction
- 6 Quick Start Guide
- 7 Basic parameters
- 8 Packaging content
- 9 FCC NOTE
- 10 Documents / Resources
 - 10.1 References
- 11 Related Posts

Walmart 

Walmart i2 Horizontal Mouse



Product Information

Specifications:

- **Model:** &&5XOHV2SHUDWLRQ
- **Compatibility:** Compatible with systems supporting the IROORZLQJWZRFRQGLWLRQV standard
- **Power:** Requires external power source

Product Usage Instructions

Overview:

The &&5XOHV2SHUDWLRQ is a versatile device designed to enhance your user experience by providing connectivity options to compatible systems.

Installation:

1. Connect the device to a power source using the provided cable.
2. Ensure the device is placed within range of the system you wish to connect to.
3. Follow the system's instructions to enable compatibility with the device.

Operation:

1. Power on the device by pressing the designated power button.
2. Wait for the device to establish a connection with the system.
3. Once connected, you can now utilize the enhanced features provided by the device.

Maintenance:

1. Keep the device clean and free from dust or debris.
2. Avoid exposing the device to extreme temperatures or moisture.
3. Regularly check for software updates to ensure optimal performance.

FAQs

- **Does the device support wireless connectivity?**

No, the device requires a physical connection to the system for operation.

- **How can I troubleshoot connectivity issues?**

Ensure that the device is properly powered and within range of the system. Restart both devices if connectivity issues persist.

Product Introduction

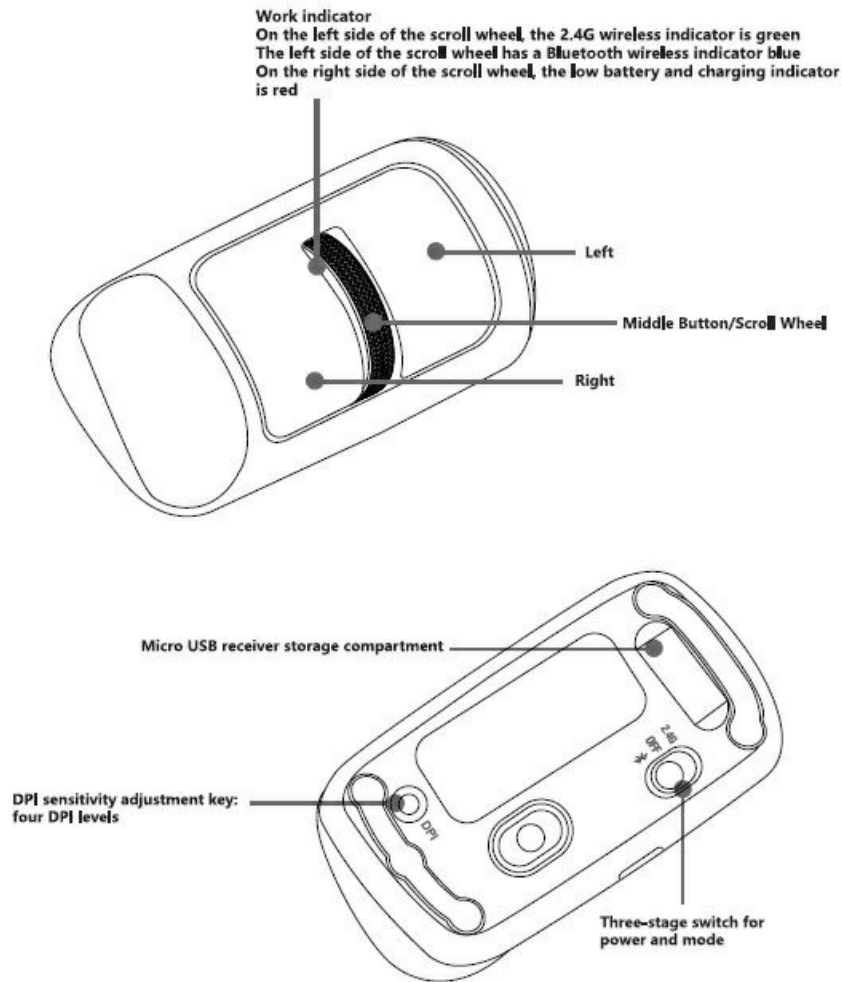

Quick Start Guide

Power & Mode Switches

- The power switch is toggled from the middle position to both sides, the mouse is turned on in USB wireless or Bluetooth wireless mode, and the corresponding method is used to wirelessly connect with the computer/host in the corresponding mode.
- The mouse is powered off when the power switch is in the middle position

USB Wireless connection

- The Micro Wireless USB Receiver is a standard USB Type-A port that can be installed on any computer equipped with a standard USB Type-A port.
- When the computer is turned on, plug the micro wireless USB receiver into the USB port of the computer, and turn the power and mode switch on the bottom of the mouse to the USB side.
- When you connect for the first time, the computer will automatically install the driver, wait for a while, and the mouse will be ready to use after the driver installation is completed. When the USB driver installation on the host side is not completed, or the USB receiver is not plugged into the host interface, the green indicator of the mouse flashes. When the USB receiver is plugged into the host interface and the host driver is installed, the green indicator of the mouse stays on for 5 seconds and then turns off.

Storage of USB receivers

When not in use, the micro wireless USB receiver can be placed in the magnetic compartment on the bottom of the mouse, which has magnets to prevent the USB receiver from falling off.

Coding of USB receivers

- i2 one-to-one matching between the mouse and its supporting USB receiver, if the receiver is accidentally lost, you can use the same model of USB receiver of our company to replace it, but you need to re-configure the code so that the mouse and the new receiver can be connected.
- The method is: (1) download the special code matching software MTP: (2) switch the mouse power and mode switch to USB wireless 2.4G mode: (3) insert the USB connector into the USB interface of the computer: (4) open the MTP code matching software and set it according to the tutorial (please ask customer service for a video or picture tutorial link).

Bluetooth connection

- To connect a computer/host/mobile phone using Bluetooth, you need to turn the power and mode switch to the Bluetooth side Bluetooth 5.0 is a standard proposed after 2016, which has relatively better performance, but needs to be supported by version 5.0 Bluetooth hardware.
- This mouse supports the Bluetooth Low Energy (BLE) protocol, and Bluetooth 4.1 was released in 2013 later Bluetooth 4.2, Bluetooth 5.0, and newer versions all support the Bluetooth Low Energy (BLE) protocol.
- This mouse can be connected to a host that supports the Bluetooth Low Energy (BLE) protocol, that is, the Bluetooth device on the host is Bluetooth 4.1 or above hardware.

Bluetooth Pairing

- The mouse needs to be paired with Bluetooth before it can be connected to a Bluetooth terminal device for the first time. The mouse needs to enter pairing mode before it can be searched by the Bluetooth of the computer/mobile Phone.
- When the mouse is turned on for the first time, it will automatically enter the pairing mode because there is no pairing record inside (the blue light flashes rapidly at a frequency of 0.5 seconds)
- For the mouse in the pairing state (blue light flashing), you can search for the device name "ronPaw BT5.0" on the Bluetooth side of the host, and select it to connect. (In smartphones, the list of "Available Devices" in Settings/Bluetooth is generally displayed; In Windows, in "Settings"/"Bluetooth and other devices", select Add Bluetooth or other devices, and you can search and discover our mouse) Once the connection is successful, it will not be visible to other hosts. If the mouse is not paired with any host connection, the mouse will go to sleep at the end of the 2 minutes.
- **Forced pairing mode:** When there is a pairing record inside the mouse, press the left + middle + right button without releasing for 3 seconds when the mouse is turned on, and you can enter the forced pairing mode. At this point, the mouse can be searched and paired by any host, and if there is no new host to pair within 2 minutes, the mouse will return the connection to the original host.
- **Successfully paired mice:** If the paired host is not powered on or the host is not turned on, the Bluetooth mouse will flash blue 3 times at a 1-second code and then enter sleep. If the host and its Bluetooth are played, and the blue light will turn on after the connection is successful, then the mouse in the power-on state will automatically "turn back to the company for 5 seconds as an indication."

- Only the last pairing information can be retained in the mouse.
- Clear the pairing information: Press and hold the middle button to turn on the mouse while the mouse is powered off and hold for 3 seconds to clear the pairing information in the mouse. The mouse that clears the pairing information will automatically enter the pairing mode (the blue light flashes rapidly in 0.5-second cycles), and if there is no pairing within 2 minutes, it will enter sleep.
- If the host unilaterally deletes the pairing information, the host needs to search for and pair again.
- If the mouse clears the pairing information, the host needs to search and pair again.
- If the mouse has been paired with another device, you also need to search for the mouse again, turn on the pairing mode of the mouse, and pair the two.
- Because the mouse unilaterally deletes/abandons the pairing information, and the host connects to the same mouse through the search and pairing process multiple times, multiple identical device names will be left on the host. Expired pairing information can be deleted/canceled to keep the host-side device list concise.
- Bluetooth mouse to connect to different types of hosts (Windows computer, Apple computer, Android phone, iPhone phone...). The function is determined by the system settings on the host side. For example, in all systems of Apple, iPad, and iPhone, the scrolling direction of the mouse wheel in the system is opposite to the up and down" direction of the mouse scroll in Windows, but this can be modified by manually finding the mouse settings in the system settings to conform to your habits.
- In some versions of Android phones/tablets: The left mouse button is equal to the single and can be clicked, long-pressed, and swiped. The right mouse button is equal to the back button; The middle mouse button is equal to the home button.

Power & Energy Saving

- After turning on the power switch of the mouse, if you enter Bluetooth mode, the blue indicator of the mouse will light up 3 times, and if you enter the 2.4G mode, the green indicator of the mouse will light up for 5 seconds – indicating that the mouse status is normal. After that, the mouse will detect whether the host is connected, if the USB receiver is not connected to the host the host is not turned on, the host in Bluetooth connection mode is not turned on or the Bluetooth switch is not turned on, the mouse will enter a deep sleep state, until it is triggered by the key and detects that the host has been connected will return to the working state.
- 2.4G mode: the working current is 4mA, it will enter the first-level sleep state (current 0.14mA) after the movement/operation signal stops, stop the operation for 20 seconds, and enter the second-level sleep state (SensorLED micro-bright current 95μA), and move the mouse to wake up;
- BT mode: the working current is 3.4mA, it will enter the first-level sleep state (current 0.07-0.24mA) after the movement/operation signal stops, and enter the second-level sleep state after stopping the operation for 5 minutes (SensorLED micro-bright current 44μA), and the mouse can be woken up by moving the mouse.

Turn off

You can wake up the dormant mouse by moving or clicking the mouse. When you do not use it for a long time, or put the mouse in a backpack, you should turn off the mouse power supply. This can extend the available working time after charging the mouse to reduce the frequency of charging.

Electricity and charging

The mouse has a built-in 120mA charging lithium battery. When the mouse is low, move the mouse's low-voltage indicator light to red light in 2.4G mode. After the mouse enters the first level dormant state. Always flashed. At this time, pay attention to charging the mouse in time. The charging interface is the standard USB TYPE-C interface. The (5V charger) is inserted into the charging cable and the red indicator lights are on, which represents the

charging time, If the representative is full, please disconnect the charging cable in time.

Sensitivity/DPI regulation

- In the mouse boot state, after pressing the mouse sensitivity/DPI switch, the mouse sensitivity will roll up and adjust the gear upwards. (3200DPI) The default value of the factory is 1200 dpi.
- The sensitivity/DPI parameter of the mouse means that each mouse moves 1 inch on the mouse pad, and the mouse cursor will slide on the computer screen.
- The higher the sensitivity setting, the same as the movement of the d on the screen, the farther the screen on the screen.
- For example, a computer screen with a resolution of 2K (full HD/FHD) has 1920x 1080 pixels, of which 1920 pixels are horizontal. If the mouse sensitivity is set to 1200DPI, the mouse is required to slide the left and right on the desktop 1.6 inches to allow the mouse cursor to make the mouse cursor Sliding from the left end of the screen to the right end; if the mouse sensitivity is set to 3200DPL, you only need to move the mouse left and right to 0.6 inches on the desktop to allow the mouse cursor to slide from the left end of the screen to the right end.
- Generally, lower (low resolution) screens use lower sensitivity, and higher (higher resolution) screens use higher sensitivity.
- For example, the 13-inch full HD (FHD) screen has a resolution of 1920×1080, which represents a total of 1920×1080 pixels on the screen, of which 1920 pixels are horizontal. If the mouse sensitivity is set to 1600DPI, only the mouse moves on the left and right of the desktop 1.2 The inch can slide the mouse cursor from the left end of the screen to the right end.
- Another example is the 27-inch ultra-high-definition (UHD) 4 screen has a resolution of 4096X2160 and 4096 pixels horizontally. If the mouse sensitivity is set to 1200DPI, you need to move the mouse on the left and right 34 inches on the left and right. Sliding to the right end, but if the mouse sensitivity is 3200DPI, you only need to move 1.28 inches to allow the mouse cursor to slide from the left end of the screen to the right end.

Horizontal mouse i2

- Long x wide X height: 39x75x31mm, can recharge the battery, wireless mouse.
- Specializing in traditional mouse users' habit of "holding mouse operations" and guidance on the structure. Users can find the correct grasp position the first time when they come into contact with the product.
- I2 is more suitable for the "tightly grasped" posture, such as operating the mouse on the leg (or other narrow spaces), which can ensure that the I2 mouse and mouse are caught stable and easily.

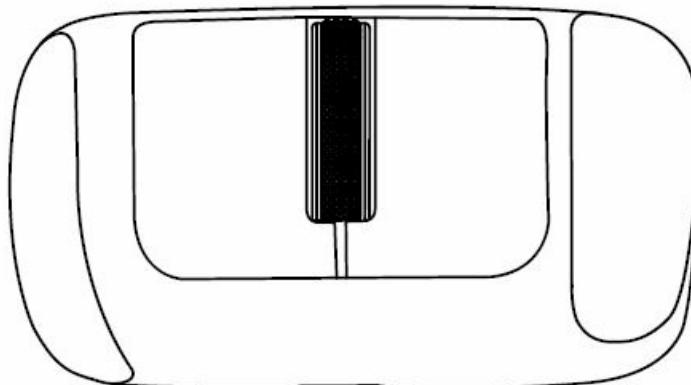

- I2 is small and convenient to carry. It is a standard mouse and can be used in a standard working environment.

- I2 can be picked up very quickly and conveniently. This removes the user's learning threshold, which allows everyone to use it quickly. It is smoothly adapted from the transformation from the traditional "vertical long mouse" to "horizontal mouse".
- I2 horizontal mouse has the advantages: flexible operation, supporting a variety of operation gestures that do not require the palm to participate in holding the grip, and no rubbing of the wrist, which can effectively avoid the occurrence of "mouse hands" (hand fatigue, pain, and other symptoms).

Ecological engineering advantages designed by horizontal mouse "(common advantage)

- Give the width of the mouse in the left and right directions. Users can completely control the mouse when holding the palm and fingers when holding the hand.
- Short the tail to move the center of gravity forward. The mouse can be completely controlled by the fingers alone. The palm is no longer necessary to assist the control of the tail, and the wrist is no longer necessary to assist the movement of the mouse. Callow and pain.
- Various posture support: Because it is easy to control, users can use a variety of different postures to operate the horizontal mouse. This can allow users to replace users in different postures (using different muscle groups) after fatigue or allow mouse patients to avoid the force of pain to protect the health of the user.

i2 mouse supports three basic operation positions

1. Obief of traditional habits, operate buttons with the index finger and middle finger fingertips, five fingers are stretched, and five fingertips are lined up.

The mouse will meet the length of the finger about 25° to the left.



2. The finger can move forward more so that the button finger is bent downward at the front of the mouse, and the button is pressed/operated by the inner side of the second or even third knuckles.

This is the most stable posture of "catch". Because of the orientation of the ring finger, the mouse will be less than 10° to the left to the left.

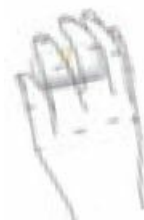

3. Allow the thumb pressure/to put on the left and back of the mouse by pressing the pressure to help control, so that the wrist can be turned on, relaxing the pressure of the wrist and the forearm at this time, the horizontal mouse can achieve vertical mouse "and" tilted one-handed mouse "The mechanical effect, but it is more convenient and easier, and it will not reduce efficiency.

At this time, on the right side of the mouse, the ring finger is pressed on the steps, and the little finger is blocked outside the steps. The cooperation of these three fingers can completely control the mouse without the need to "hold". The right hand is equivalent to a "put on" desktop. By the way, the mouse is controlled just because of

contacting the mouse.



Place navigation finger (size finger and ring finger) in the icon position

- At this time, because the fingers are bent and the mouse is conforming to the length of the finger, the mouse will tilt to the left at about 45 degrees.
- If you need to pick up the mouse, your thumb can be easily and flexibly descended to the left side of the mouse, and it will be transformed into 1 posture, so it will not affect any operation.
- Among the several gestures supported by the i2 mouse, the mouse tilted to the left under various gestures to varying degrees, but this tilt does not lead to the trajectory of the screen cursor when moving the mouse when moving the mouse.
- Because five fingers are controlled by controlling mouse movements, human fingers, and wrist joints with 14 flexion and extension joints will automatically correct the direction of the mouse under the brain command. Strife as left and right.



Keep your finger (index finger and middle finger) naturally put on the button.

Basic parameters

Horizontal mouse i2 dual-mode wireless enhancement version (wireless/charging/portable/office)

- **Product model:** i2
- **Working method:** optoelectronic
- **Connection method:** 2.4G wireless USB; Bluetooth wireless
- **Receiving distance:** 10M
- **Sensitivity:** 1200/1600/2400/3200 dpi Four gear can be adjusted
- **Battery capacity:** 120mA lithium battery
- **Charging voltage/charging current:** DC 5V/200mA
- **Working current:** 4mA/Intelligent Electricity
- **Product size:** 31x39x75mm (high x long x wide)
- **Product weight:** 38.5g (including receiver)

- **Applicable system [2.4G wireless USB connection]:** hardware with standard
- **USB interface** (USB Type-A), MacOS, Linux, Windows XP/7/8/10/11 or higher versions [Wireless Bluetooth connection]; Windows-Suggestion Windows 8.0 or above
- MacOS-Suggestion MacOS 10.10 above versions
- Android-Suggestion Android 5.0 above versions

Packaging content

- Mouse main body
- micro receiver
- USB-Type C charging cable
- manual

FCC NOTE

This device complies with part 15 of the FCC Rules. Operation is subject to the following two conditions:

1. this device may not cause harmful interference
2. this device must accept any interference received, including interference that may cause undesired operation.

Any changes or modifications not expressly approved by the party responsible for compliance could void the user's authority to operate the equipment.

NOTE: This equipment has been tested and found to comply with the limits for a Class B digital device, under Part 15 of the FCC Rules. These limits are designed to provide reasonable protection against harmful interference in a residential installation. This equipment generates, uses, and can radiate radio frequency energy and, if not installed and used by the instructions, may cause harmful interference to radio communications. However, there is no guarantee that interference will not occur in a particular installation. If this equipment does cause harmful interference to radio or television reception, which can be determined by turning the equipment off and on, the user is encouraged to try to correct the interference by one or more of the following measures:

- Reorient or relocate the receiving antenna.
- Increase the separation between the equipment and the receiver.
- Connect the equipment to an outlet on a circuit different from that to which the receiver is connected.
- Consult the dealer or an experienced radio/TV technician for help.

The device has been evaluated to meet general RF exposure requirements. The device can be used in portable exposure conditions without restriction.

Documents / Resources

	Walmart i2 Horizontal Mouse [pdf] Instruction Manual i2 Horizontal Mouse, i2, Horizontal Mouse, Mouse
---	--

References

- [User Manual](#)

Manuals+. Privacy Policy

This website is an independent publication and is neither affiliated with nor endorsed by any of the trademark owners. The "Bluetooth®" word mark and logos are registered trademarks owned by Bluetooth SIG, Inc. The "Wi-Fi®" word mark and logos are registered trademarks owned by the Wi-Fi Alliance. Any use of these marks on this website does not imply any affiliation with or endorsement.