



wallbox 000000578 Fuse Box Lite and Pro Installation Guide

[Home](#) » [wallbox](#) » wallbox 000000578 Fuse Box Lite and Pro Installation Guide 

Contents

- [1 wallbox 000000578 Fuse Box Lite and Pro](#)
- [2 Installation Overview](#)
- [3 Security Warnings](#)
- [4 Fuse Box Models](#)
- [5 Assembly](#)
- [6 Connection](#)
- [7 Documents / Resources](#)
 - [7.1 References](#)
- [8 Related Posts](#)



wallbox 000000578 Fuse Box Lite and Pro



Installation Overview

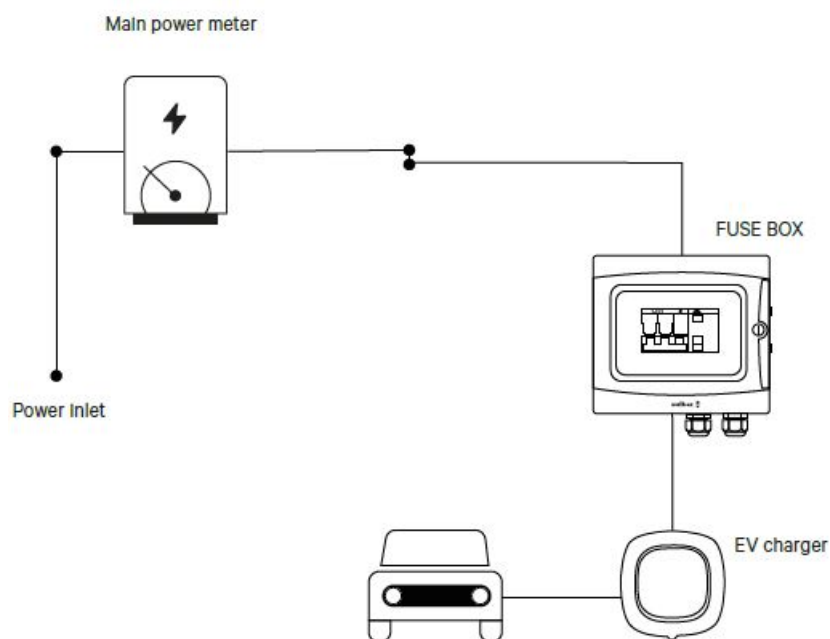

Security Warnings

Make sure to read the following warnings before installing and using the Fuse Box.

- Before installing, operating, performing maintenance or testing this equipment, carefully read the present manual. Incorrect operation, handling or maintenance may result in death, serious injury or damage to the equipment.
- Install the device respecting the local safety procedures and practices. Failure to do so may result in death, serious injury or damage to the equipment.
- Follow the instructions provided by the manufacturer when using the device to avoid risks. Remember that the

installation should be carried out only by qualified personnel in accordance with the applicable local regulations.

- Regular inspections and maintenance must be performed to ensure the correct operation of the device. Incorrect use and lack of maintenance may cause damage to the equipment.
- The connections must be carried out by qualified personnel. Failure to comply with this may result in an electric discharge.
- High voltage. Contact with the electrical current may cause serious injury or death. Follow the local safety procedures when working near high-voltage power lines and equipment.
- Connect the phases to the terminals “I” and the neutral to the terminal “N”. Do not install the connections without a neutral wire (N) or a ground wire (PE).

Fuse Box Models

Fuse Box Lite

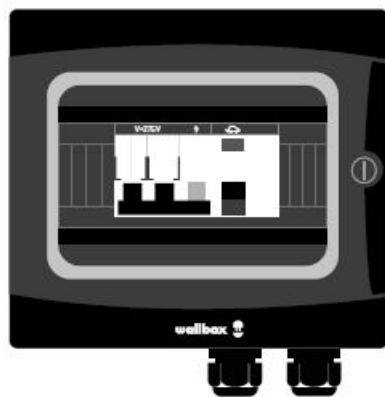

- Surge protection
- MCB 40A curve C
- MRCD 40A type A
- IP65/UV
- Key lock

Fuse Box Pro



- Surge protection
- Automatic reconnection
- MCB 40A curve C

- RCD 40A type A
- Schuko 16A/MCB
- IP65/UV

Assembly

- Use the key and press the two buttons placed on the right side of the device to open the Fuse Box.
- Remove the 4 screws and take off the cover.

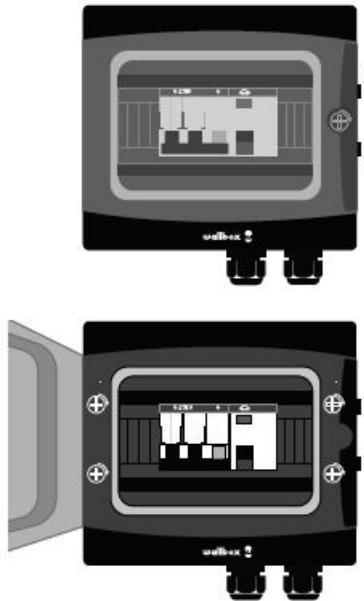

- Drill all 4 drilling holes and fix the device to the wall.
- Place the four rubber stoppers in correspondence with the drilling holes to avoid humidity to damage the Fuse Box.

Connection

- A. Insert the cable in the left cable gland, to connect the Fuse Box to your home.
- B. Insert the cable in the right cable gland to connect the Fuse Box to your charger.
- Close the Fuse Box by screwing the cover back to the body of the device. Then, use the key to lock the door.

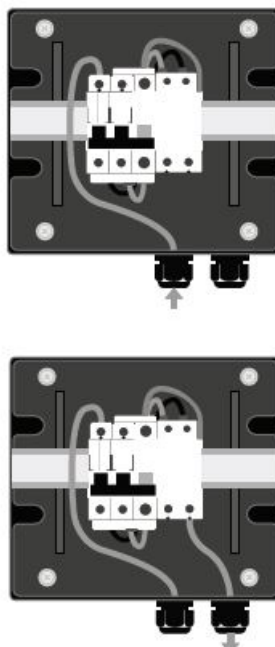

Documents / Resources

 <p>The image shows the cover of the 'wallbox 000000578 Fuse Box Lite and Pro Installation Guide'. It features a technical diagram of the fuse box with labels for 'Fuse 1', 'Fuse 2', and 'Fuse 3'. Below the diagram, the text 'FUSE BOX LITE AND PRO Installation Guide' and the 'wallbox' logo are visible.</p>	<p>wallbox 000000578 Fuse Box Lite and Pro [pdf] Installation Guide 000000578, Fuse Box Lite, Box Lite, Lite, Fuse Box Lite and Pro, 000000578 Fuse Box Lite and Pro, Box Lite and Pro, Lite and Pro</p>
--	--

References

- [🏠 Home - Wallbox Academy](#)

Manuals+.