



Walkie-Talkie BT1 Wireless Programming Kits User Manual

[Home](#) » [Walkie-Talkie](#) » Walkie-Talkie BT1 Wireless Programming Kits User Manual 

Walkie-Talkie BT1 Wireless Programming Kits



Please read this manual carefully before using the product and keep it in a safe place

Contents

- 1 Specifications
- 2 APP download
- 3 Operation steps
- 4 Operations and Safety
- 5 Documents / Resources
 - 5.1 References
- 6 Related Posts

Specifications

Product Name:Wireless Programming Kits

Battery Capacity: 140mAh

Charging interface: Type-C

Adapter: Standard K head

Standard accessories:

Wireless Programming Kits

TYPE-C data cable

APP download

Scan to download APP



Operation steps

1. Insert the Wireless Programming Kits into the audio interface of the walkie-talkie

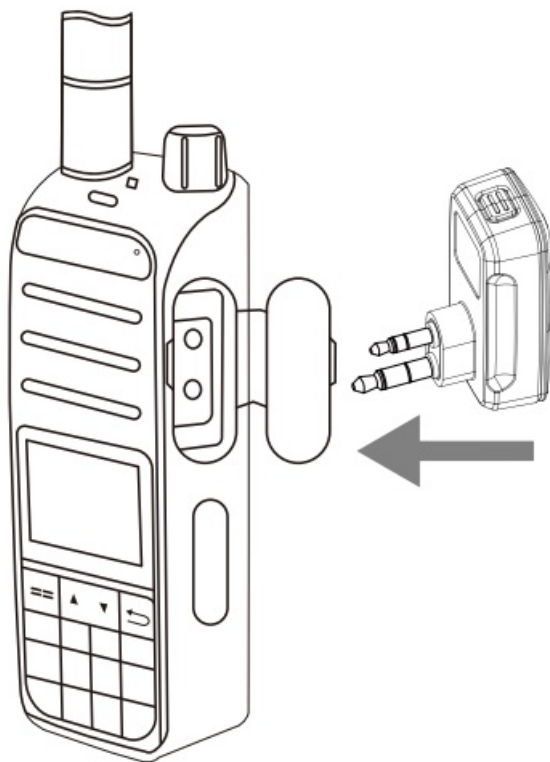

2. Short press to power on, the blue light continues to flash slowly, and enters the pairing mode (Long press for 2 seconds to shut down, the blue light stays on for 2 seconds and then goes out)

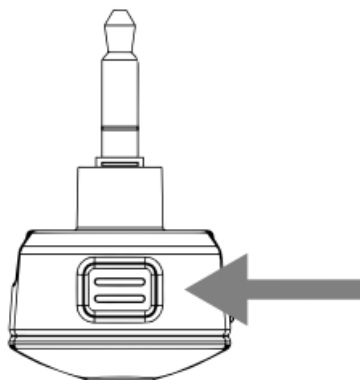

3. Enter the mobile phone system settings, turn on the Bluetooth function

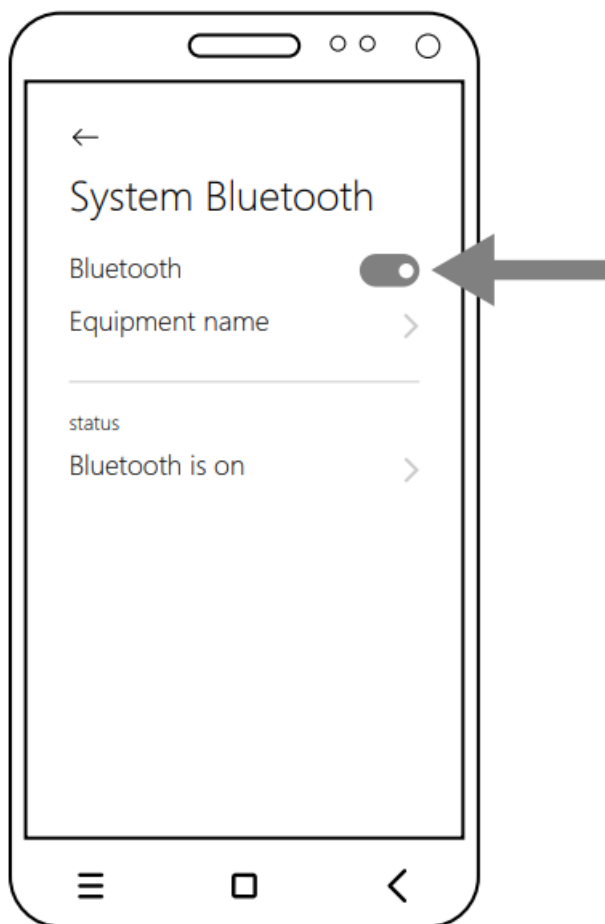

4. Open the APP, click the connect button Select “walkie-talkie” in the list and connect

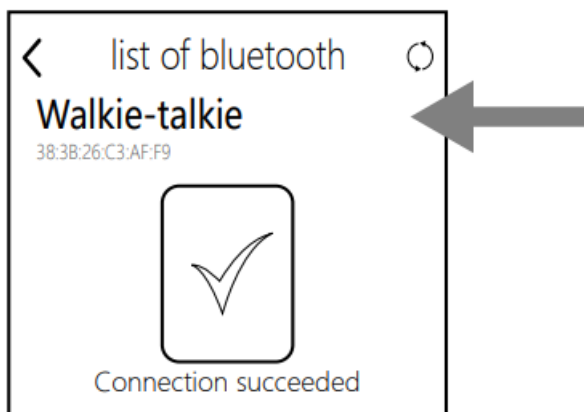
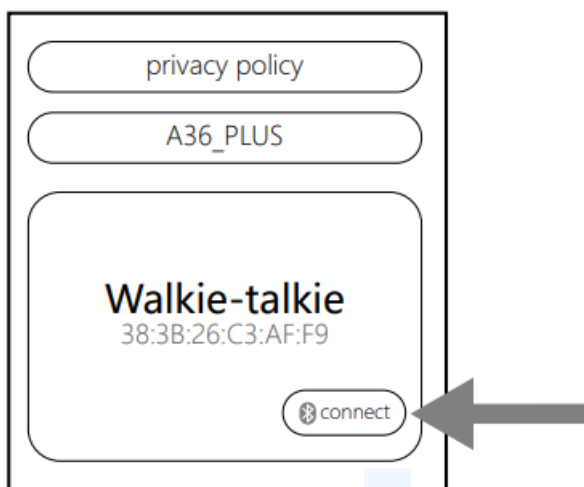

5. Select the model and plan Read frequency, change frequency, write frequency and other operations

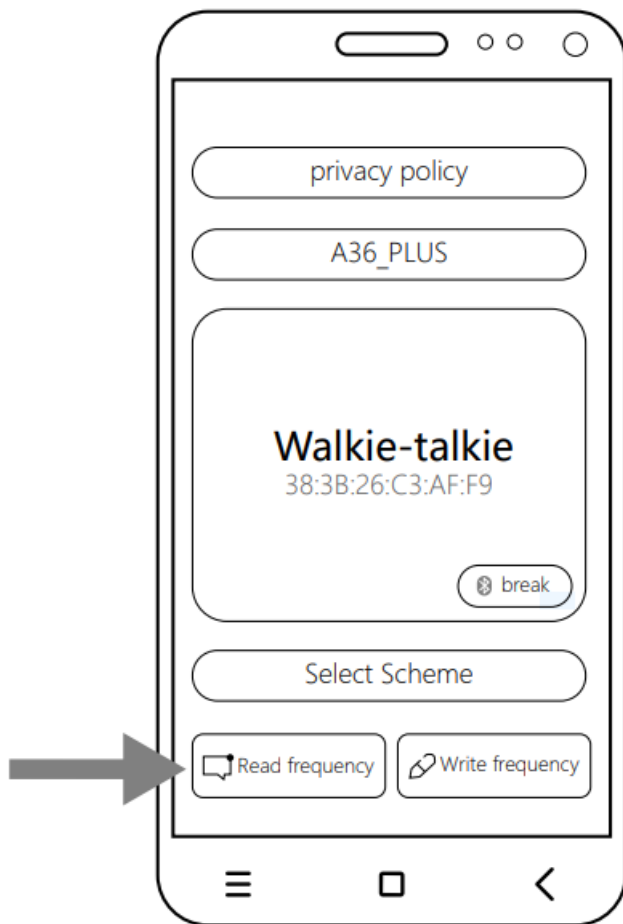

Operations and Safety

- Please use this frequency writer at a temperature of 0°C~35°C, and at a temperature of -20°C Store the frequency writer and its accessories within ~+45°C. When the ambient temperature is too high or too low it may cause the frequency writer failure.
- When charging is complete or not charging, please disconnect the charger from the frequency writer and unplug the charger from the power socket.
- The frequency writer uses a non-removable built-in battery.
Do not replace the battery by yourself, so as not to cause the frequency writer to fail to operate normally or the battery to be damaged. For your personal safety and to ensure the normal operation of the product, it is strongly recommended that you go to the official customer service center to replace this writing frequency battery.
- It is forbidden to throw the battery into the fire, do not disassemble, drop, squeeze or modify the battery, avoid foreign objects inserting, puncturing the battery or immersing the battery in water or other liquids, and avoid external impact and pressure on the battery, so as not to cause battery leakage, overheating, fire or explosion fry.

FCC Statement

Any Changes or modifications not expressly approved by the party responsible for compliance could void the user's authority to operate the equipment.

This device complies with part 15 of the FCC Rules. Operation is subject to the following two conditions:

1. This device may not cause harmful interference, and

2. This device must accept any interference received, including interference that may cause undesired operation .

RF warning for Portable device:

The device has been evaluated to meet general RF exposure requirement. The device can be used in portable exposure condition without restriction.

Note: This equipment has been tested and found to comply with the limits for a Class B digital device) pursuant to part 15 of the FCC Rules. These limits are designed to provide reasonable protection against harmful interference in a residential installation. This equipment generates> uses and can radiate radio frequency energy and, if not installed and used in accordance with the instructions, may cause harmful interference to radio communications. However, there is no guarantee that interference will not occur in a particular installation. If this equipment does cause harmful interference to radio or television reception, which can be determined by turning the equipment off and on) the user is encouraged to try to correct the interference by one or more of the following measures:

- Reorient or relocate the receiving antenna.
- Increase the separation between the equipment and receiver.
- Connect the equipment into an outlet on a circuit different from that to which the receiver is connected.
- Consult the dealer or an experienced radio/TV technician for help.

Walkie-Talkie **Tool**

Documents / Resources

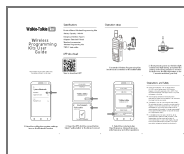

[Walkie-Talkie BT1 Wireless Programming Kits](#) [pdf] User Manual
BT1 Wireless Programming Kits, BT1, Wireless Programming Kits, Programming Kits

References

- [User Manual](#)