



WAGNER Control Spray Max User Guide

[Home](#) » [Wagner](#) » WAGNER Control Spray Max User Guide 

WAGNER Control Spray Max



Contents

- 1 Setup
- 2 Important Safety Safety Information
- 3 Components
- 4 Assembly
- 5 Spraying
- 6 Cleanup
- 7 Maintenance
- 8 Troubleshooting
- 9 Documents / Resources
 - 9.1 References
- 10 Related Posts

Setup

1. Read all warnings

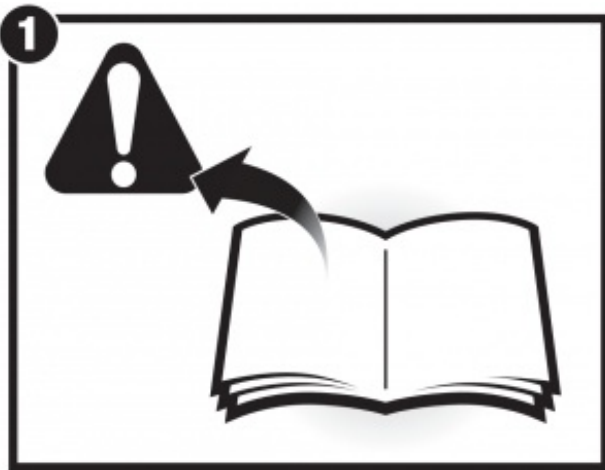

2. Align arrow with “unlock” symbol

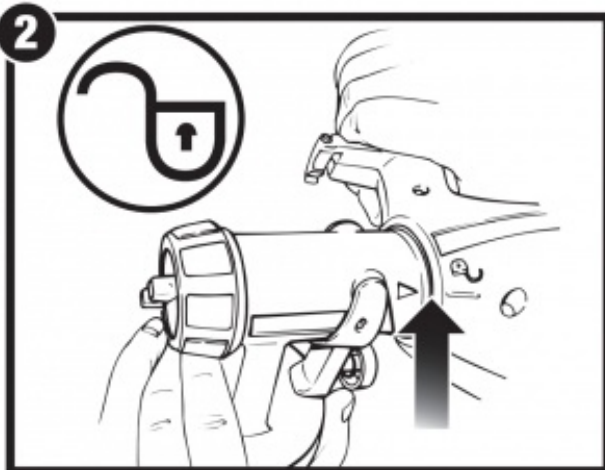

3. Twist to lock handle in place

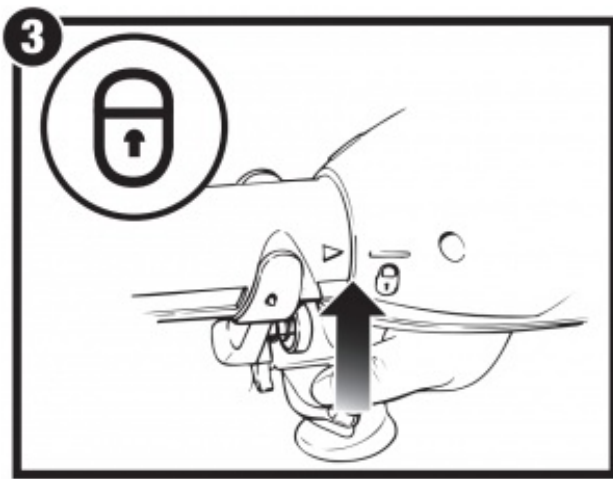

4. Align suction tube

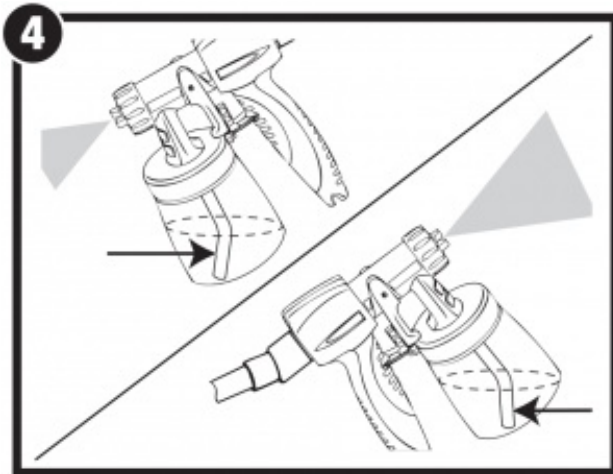

5. Prepare material / Fill container

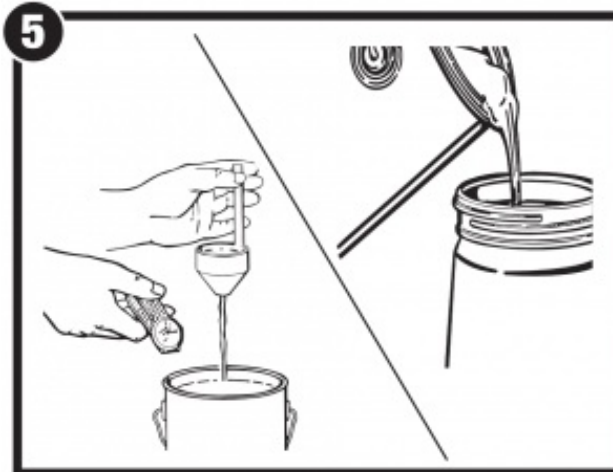

6. Attach hose to turbine and gun

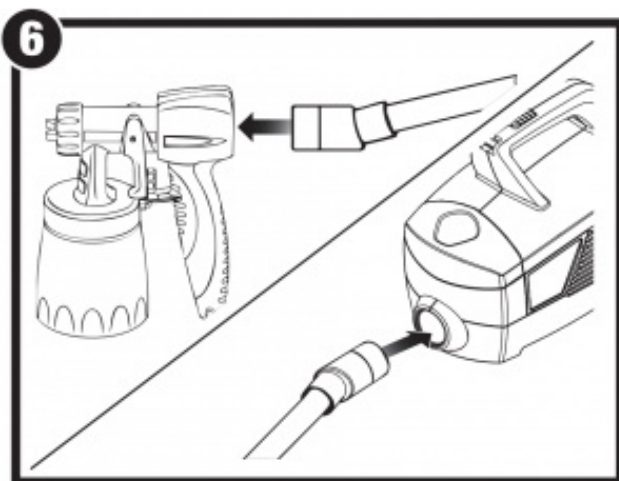

7. Adjust spray pattern

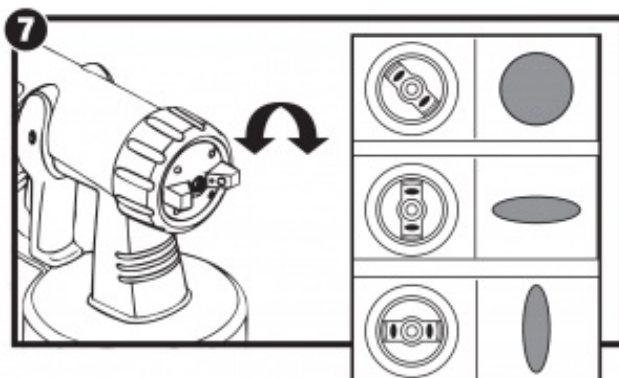

8. Plug in, practice spraying

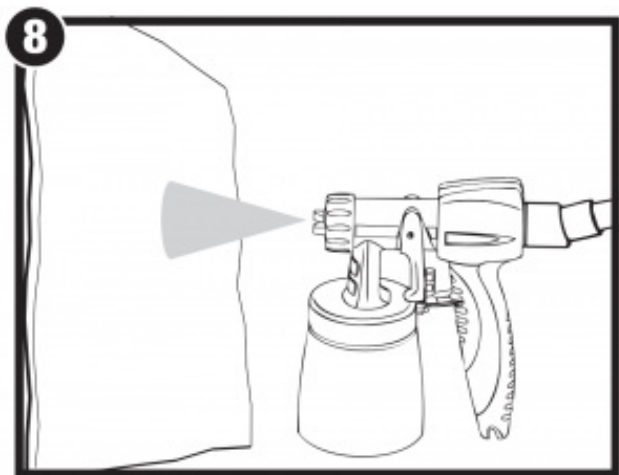

Important Safety Safety Information



Read all safety information before operating the equipment. Save these instructions



Indicates a hazardous situation which, if not avoided, could result in death or serious injury.

a) To reduce the risks of fire or explosion, electrical shock and the injury to persons, read and understand all instructions included in this manual. Be familiar with the controls and proper usage of the equipment.

Grounding Instructions

This product must be grounded. In the event of an electrical short circuit, grounding reduces the risk of electric shock by providing an escape wire for the electric current. This product is equipped with a cord having a grounding wire with an appropriate grounding plug. The plug must be plugged into an outlet that is properly installed and grounded in accordance with all local codes and ordinances.

WARNING – Improper installation of the grounding plug can result in a risk of electric shock.



If repair or replacement of the cord or plug is necessary, do not connect the green grounding wire to either flat blade terminal. The wire with insulation having a green outer surface with or without yellow stripes is the grounding wire and must be connected to the grounding pin.

Check with a qualified electrician or serviceman if the grounding instructions are not completely understood, or if you are in doubt as to whether the product is properly grounded. Do not modify the plug provided. If the plug will not fit the outlet, have the proper outlet installed by a qualified electrician.

This product is for use on a nominal 120 volt circuit and has a grounding plug that looks like the plug illustrated below. Make sure that the product is connected to an outlet having the same configuration as the plug. No adapter should be used with this product.

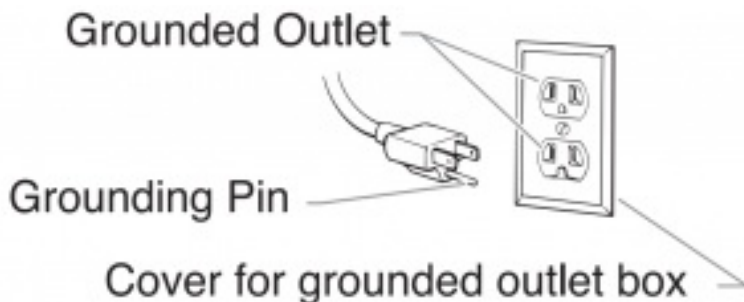

b) WARNING – To reduce the risk of fire or explosion:

1. Do not spray flammable or combustible materials near an open flame, pilot lights or sources of ignition such as hot objects, cigarettes, motors, electrical equipment and electrical appliances.
Avoid creating sparks from connecting and disconnecting power cords.
2. For use with only water-based or mineral spirit-type materials with a minimum flash point of 21°C (70° F) — Do not spray or clean with liquids having a flash point of less than 21°C (70° F). Flash point is the temperature at which a fluid can produce enough vapor to ignite.
3. Verify that all containers and collection systems are grounded to prevent static discharge.
4. Connect to a grounded outlet and use grounded extension cords (electric models only). Do not use a 3 to 2 adapter.
5. Do not use a paint or solvent containing halogenated hydrocarbons. Such as chlorine, bleach mildewcide, methylene chloride and trichloroethane. They are not compatible with aluminum. Contact the coating supplier about compatibility of material with aluminum.
6. Keep spray area well ventilated. Keep a good supply of fresh air moving through the area to keep the air within the spray area free from accumulation of flammable vapors.
Keep pump assembly in well ventilated area. Do not spray pump assembly.
7. Do not smoke in the spray area.
8. Do not operate light switches, engines, or similar spark producing products in the spray area.

9. Keep area clean and free of paint or solvent containers, rags, and other flammable materials.
10. Know the contents of the paint and solvents being sprayed.
Read all Material Safety Data Sheets (MSDS) and container labels provided with the paints and solvents.
Follow the paint and solvent manufacture's safety instructions.
11. Fire extinguisher equipment shall be present and working.

c) WARNING – To reduce the risk of injury:

1. Always wear appropriate gloves, eye protection, clothing and a respirator or mask when painting. Hazardous vapors – Paints, solvents, insecticides, and other materials can be harmful if inhaled or come in contact with body. Vapors can cause severe nausea, fainting or poisoning.
2. Do not operate or spray near children. Keep children away from equipment at all times.
3. Do not overreach or stand on an unstable support. Keep effective footing and balance at all times.
4. Stay alert and watch what you are doing.
5. Do not operate the unit when fatigued or under the influence of drugs or alcohol.
6. Never aim spray gun at any part of the body.
7. Follow all appropriate local, state, and national codes governing ventilation, fire prevention, and operation.
8. The United States Government Safety Standards have been adopted under the Occupational Safety and Health Act (OSHA). These standards, particularly part 1910 of the General Standards and part 1926 of the Construction Standards should be consulted.
9. Use only manufacturer authorized parts. User assumes all risks and liabilities when using parts that do not meet the minimum specifications and safety devices of the turbine manufacturer.
10. Power cord must be connected to a grounded circuit.
11. All hoses, swivels, guns and accessories must be rated at or above 10 PSI.
12. Do not spray outdoors on windy days.
13. Hose may become hot and cause skin burn.
14. Use only Wagner HVLP hose.

d) WARNING – To reduce the risk of electric shock:



1. Always remove turbine before cleaning.
2. Power cord must be connected to a grounded circuit.
3. Never submerge electrical parts.
4. Never expose the equipment to rain. Store indoors.
5. Keep electrical cord plug and spray gun trigger free from paint and other liquids. Never hold the cord at plug connections to support the cord. Failure to observe may result in an electrical shock.

Important Electrical Information

Use only a 3-wire extension cord that has a 3-blade grounding plug and a 3-slot receptacle that will accept the

plug on the product. Make sure your extension cord is in good condition.

When using an extension cord, be sure to use one heavy enough to carry the current your product will draw. An undersized cord will cause a drop in line voltage resulting in loss of power and overheating. A 14 gauge or 12 gauge cord is recommended. If an extension cord is to be used outdoors, it must be marked with the suffix W-A after the cord type designation. For example, a designation of SJTW-A would indicate that the cord would be appropriate for outdoor use.

Wagner Spray Tech accessory extension cords recommended:

P/N 0090241 20 foot extension cord

P/N 0090242 35 foot extension cord

IMPORTANT: Household use only.

Components

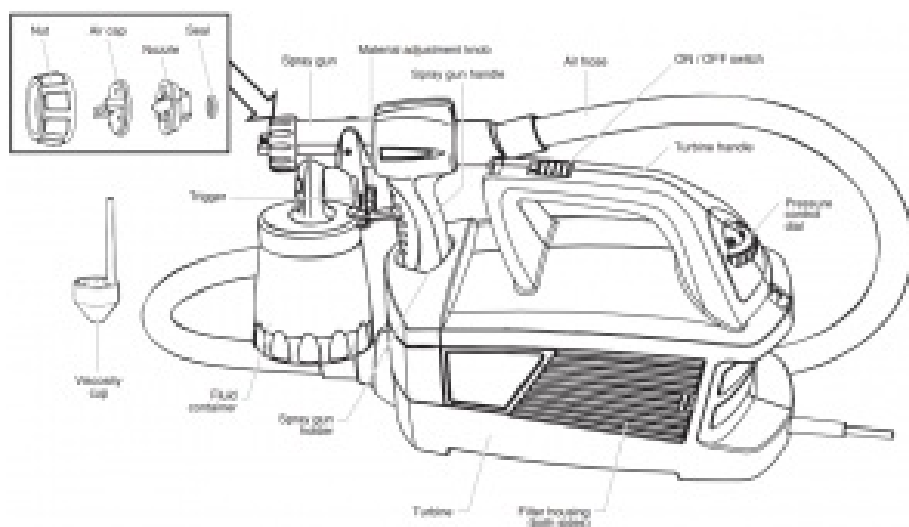

Assembly

1. Align the arrow on the spray gun with the “unlock” symbol on the turbine.

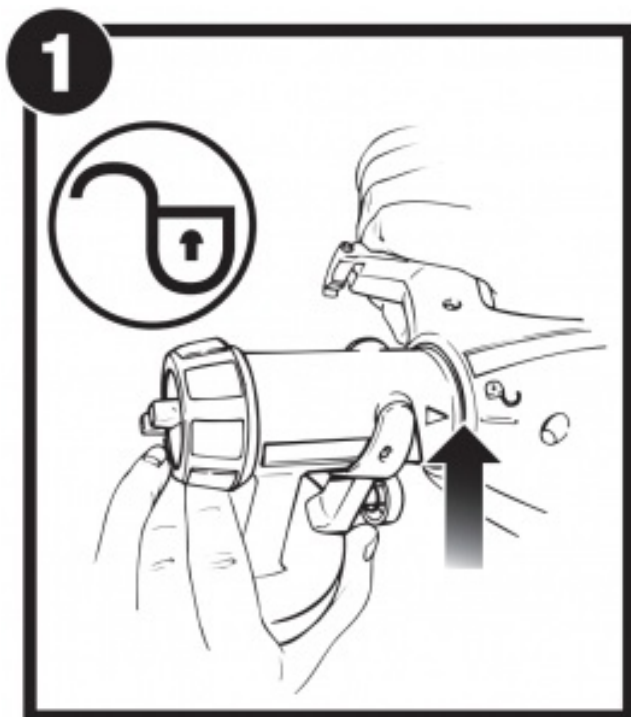

2. Insert and twist the spray gun into the turbine toward the “lock” symbol on the turbine. The tab below the trigger will lock the two pieces into place.

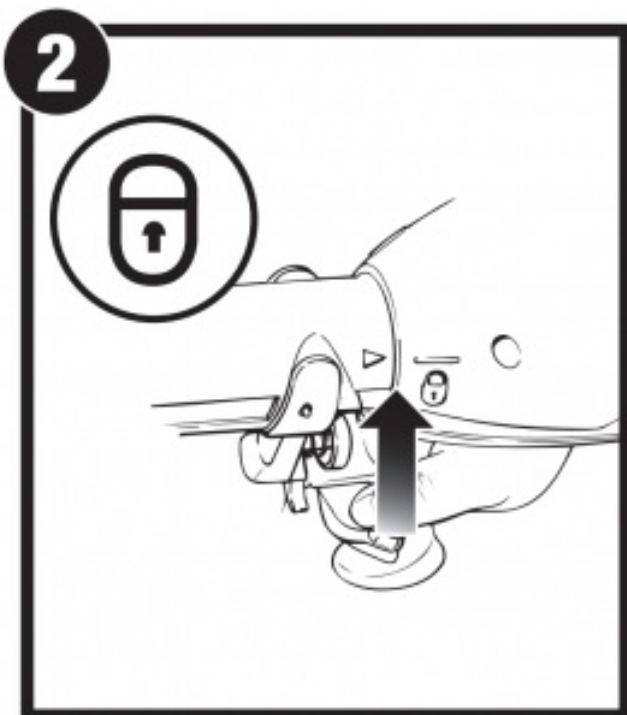

3. Insert the air hose tightly into the connections onto the spray gun **(a)** and the turbine **(b)**. The connections can be positioned as desired.

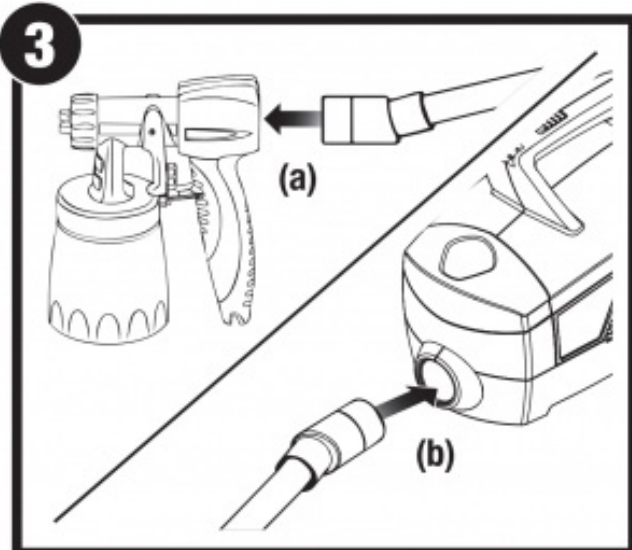

Aligning the suction tube

If you are going to be spraying in a downward direction, the angled end of the suction tube should be pointing toward the front of the gun.

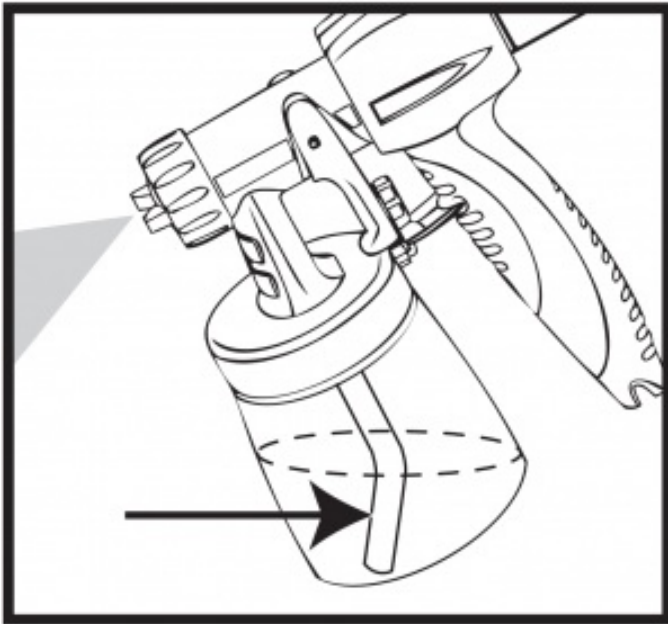

If you are going to be spraying in an upward direction, the angled end of the suction tube should be pointing toward the rear of the gun.

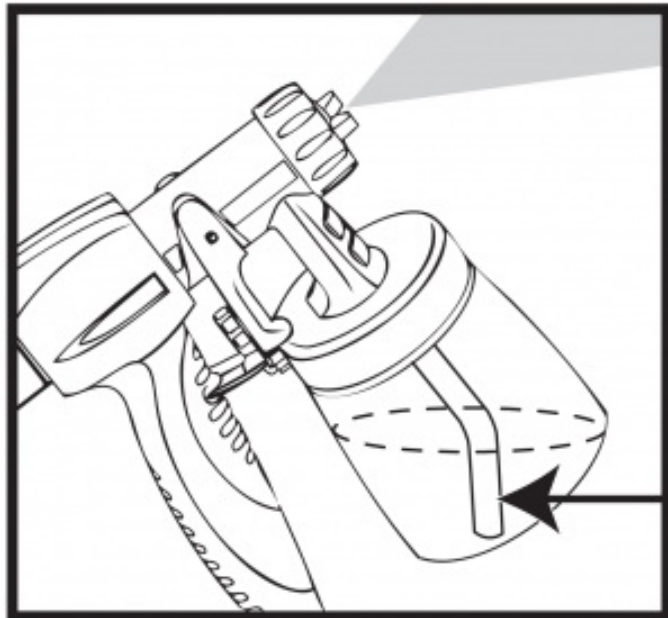

Note: By pointing the suction tube in the proper direction, you will not have to refill the container as often.

1. Stir the spraying material thoroughly before measuring viscosity.



2. Dip the viscosity test cup completely into the spraying material.



3. Hold the test cup up and measure the time in seconds until the liquid empties out. This time is referred to as Runout Time.

Thinning Chart

Material	Runout Time (seconds)
Oil enamel	25-40
Oil based primer	30-45
Oil stain	No thinning required
Clear sealer	No thinning required
Polyurethane	No thinning required
Varnish	20-50
Lacquer / lacquer sanding sealer	25-35
Automotive finishes	20-40
Latex paint	Follow manufacturer's recommendations



Material flash point must be 70°F (21°C) or higher.

4. Unscrew the cup from the spray gun.

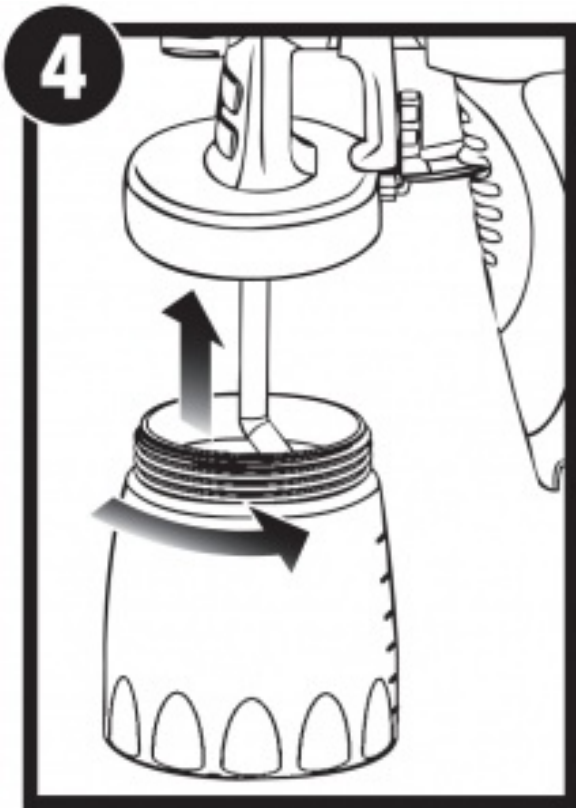

5. After the material has been properly thinned and strained, fill the container to the top of the neck.

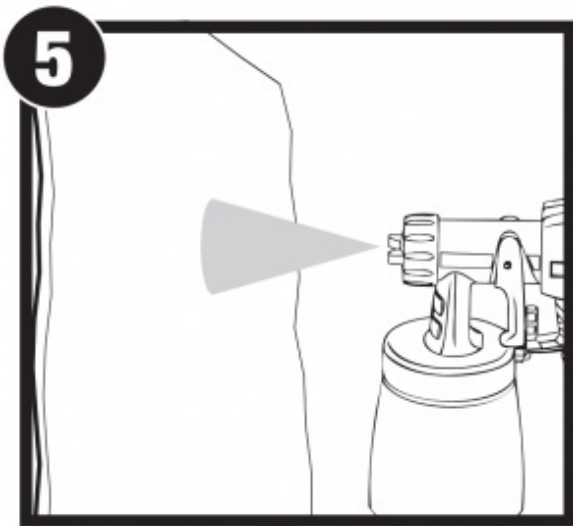

6. Carefully screw the cup back onto the spray gun.

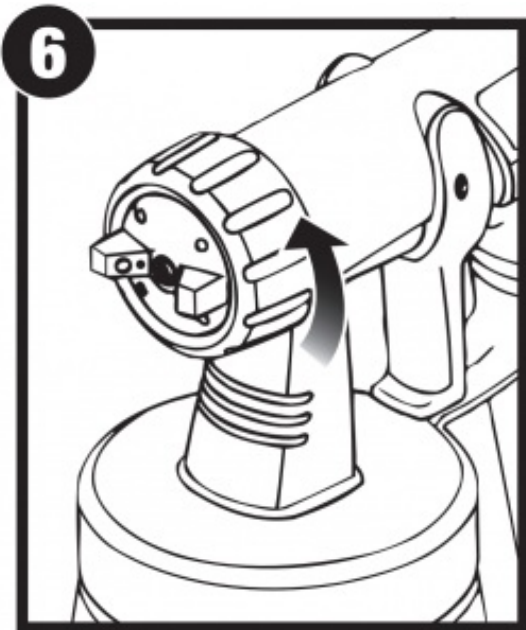

Spraying

ON / OFF switch

The ON/OFF switch is located on top of the carrying handle of the turbine.

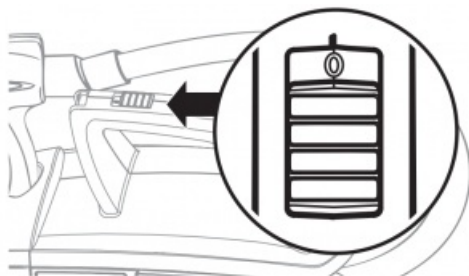

Pressure Control Dial

The pressure control dial adjusts the level of air pressure produced by the turbine. For thinner materials, (low viscosity), use a lower pressure setting. For thicker materials (higher viscosity), use a higher pressure setting. If you have too much overspray, decrease the pressure setting.

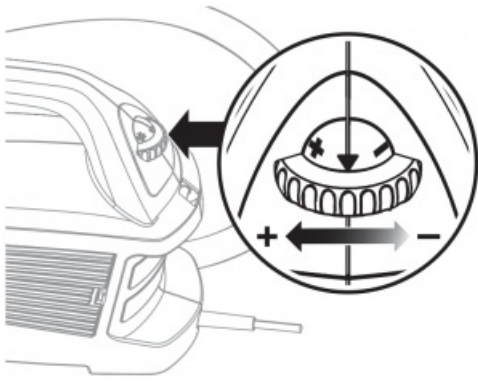

Adjust Spray Pattern

The spray pattern shape is adjusted by turning the ears of the air cap to either the vertical, horizontal, or diagonal positions. The positions of the air cap and the corresponding spray pattern shapes are illustrated below. Test each pattern and use whichever pattern is suitable for your application.



NEVER trigger the gun while adjusting the ears on the air cap. **NEVER** point the spray gun at any part of the body.

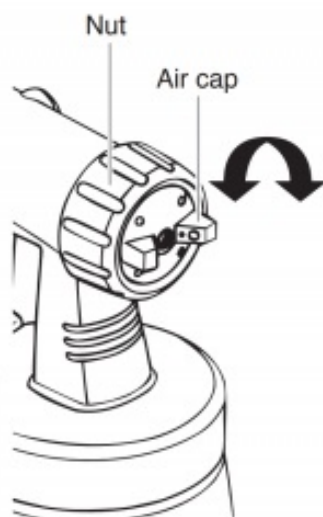
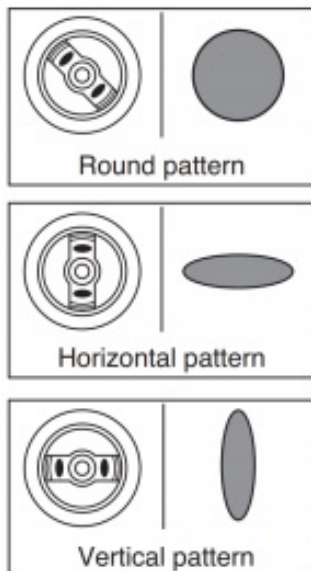

Material Flow Adjustment

Set the material volume by turning the regulator on the trigger of the spray gun.

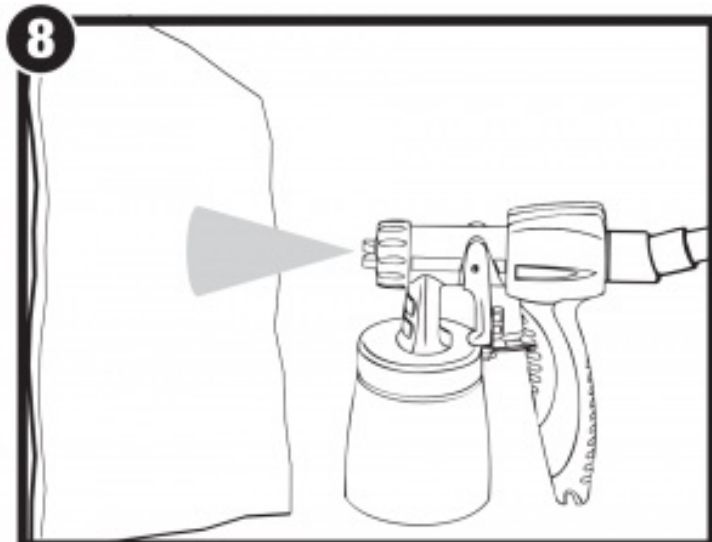

Proper Spraying Technique

If spraying with an HVLP spray system is new or unfamiliar to you, it is advisable to practice on a piece of scrap wood or cardboard before beginning on your intended workpiece.

Surface Preparation

All objects to be sprayed should be thoroughly cleaned before spraying material on them. Areas not to be sprayed may, in certain cases, need to be masked or covered.

Spray Area Preparation

The spray area must be clean and free of dust in order to avoid blowing dust onto your freshly sprayed surface.

How to Spray Properly

- Position the spray gun perpendicular to and one (1) or more inches from the spray surface, depending upon the spray pattern size desired.
- Spray parallel to the surface with smooth passes at a consistent speed as illustrated below. Doing this will help avoid irregularities in the finish (i. e. runs and sags).
- Always apply a thin coat of material on the first pass and allow to dry before applying a second, slightly heavier coat.

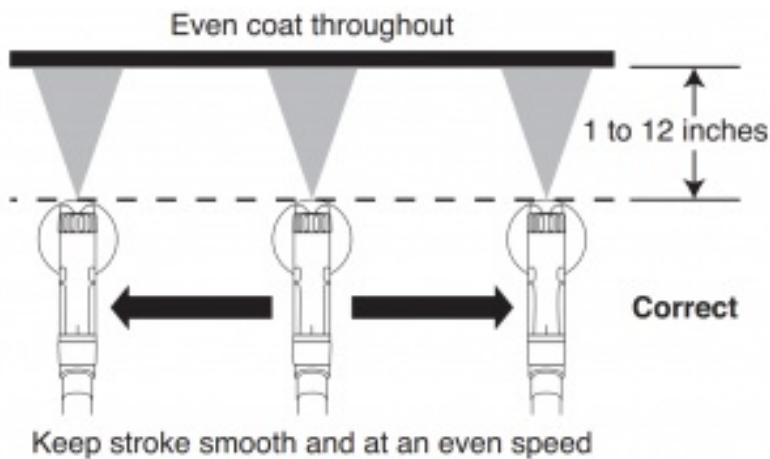

- When spraying, always trigger the spray gun after spray pass has begun and release trigger before stopping the pass. Always keep the gun pointed squarely at the spray surface and overlap passes slightly to obtain the most consistent and professional finish possible.

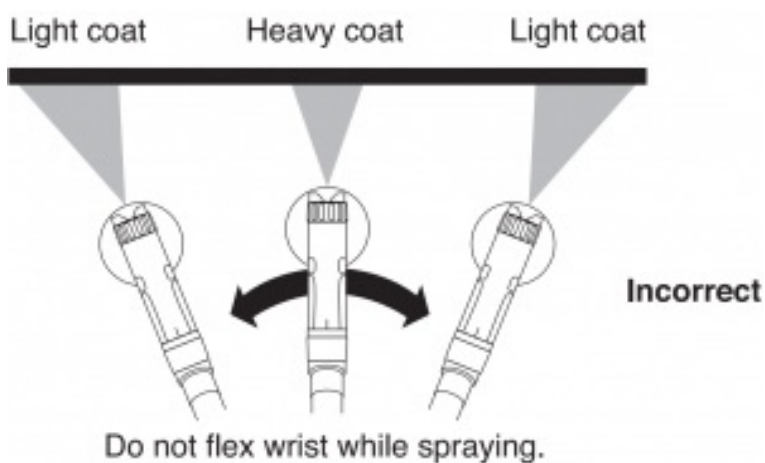

When you quit spraying for any length of time, turn the turbine OFF and place the spray gun into the spray gun holder on the turbine.

Cleanup

Start

Before you begin:

When cleaning, use the appropriate cleaning solution (warm, soapy water for latex materials; mineral spirits for oil-based materials)

IMPORTANT : Never clean nozzle or air holes in the spray gun with sharp metal objects. Do not use solvents or lubricants containing silicone.



Special cleanup instructions for use with flammable solvents (must have a flashpoint above 70°F (21°C):

- Always flush spray gun outside.
- Area must be free of flammable vapors.
- Cleaning area must be well-ventilated.
- Do not submerge turbine!

1. Turn the turbine OFF.

Trigger the spray gun so that the material inside the spray gun flows back into the container

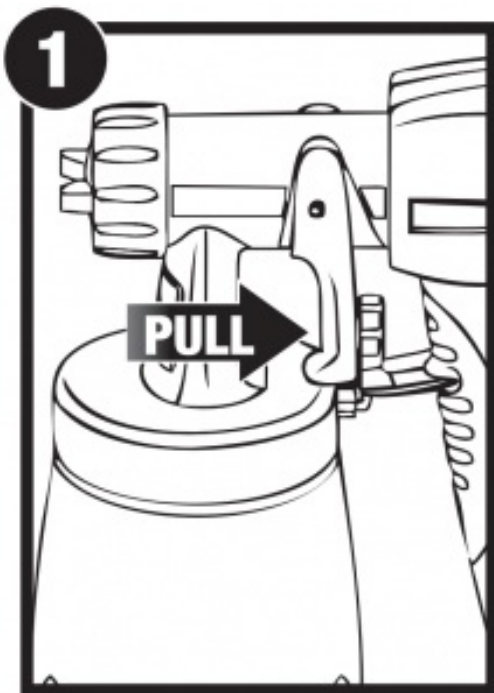

2. Unscrew the container.

Empty any remaining material back into the material container.



3. Pour a small amount of the appropriate cleaning solution into the cup (warm, soapy water for latex materials; mineral spirits for oil-based materials). Clean cup and properly dispose of cleaning solution. Refill the cup with new cleaning solution.



4. Attach the cup to the gun and plug in the sprayer.

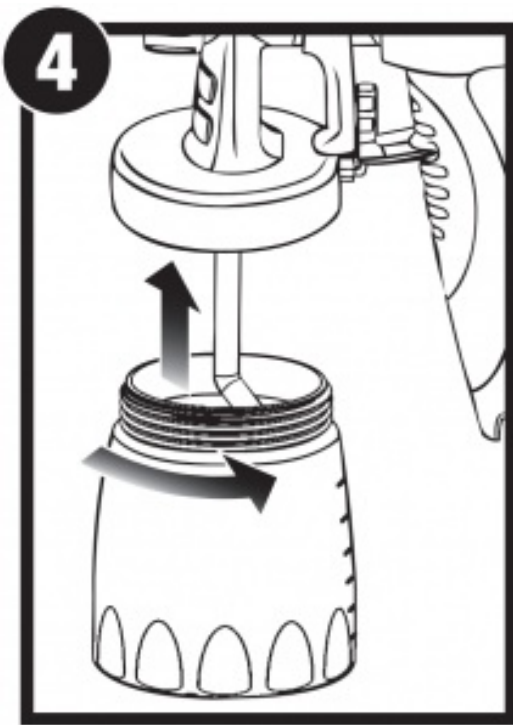

5. Turn the turbine ON. Spray the solution through the gun for two seconds in a safe area. Spray again for two seconds.

Turn off the turbine, and trigger the spray gun so that the material inside the spray gun flows back into the container.

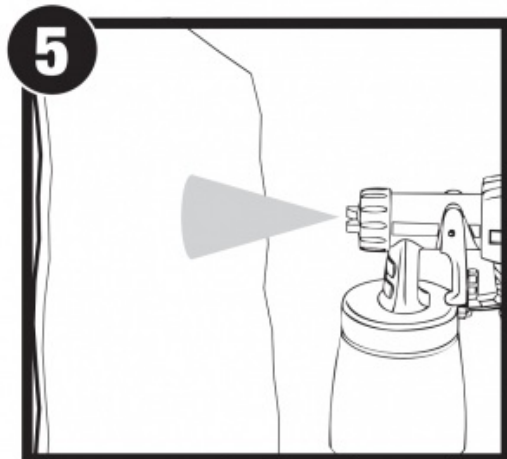

6. Wipe the exterior of the cup and gun until clean.

Unscrew the nut and remove the air cap and nozzle.

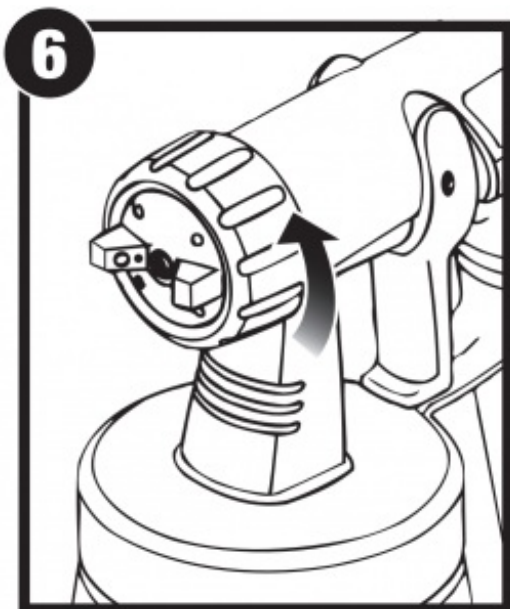

7. Clean the container (a), container seal (b), suction tube (c), air cap (d) and nozzle (e) with a cleaning brush and the appropriate cleaning solution.

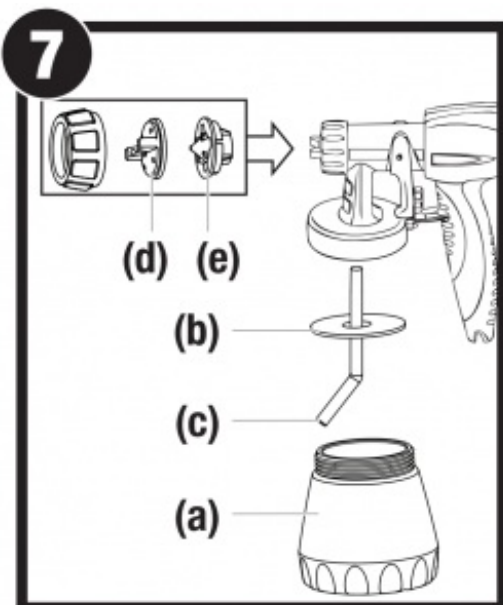

8. Push the tab below the trigger, twist and separate the spray gun from the turbine.

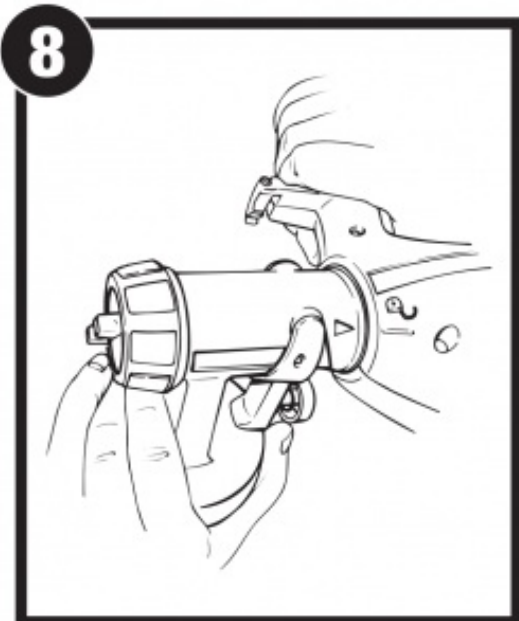

9. Clean the rear of the spray gun **(a)** with the appropriate cleaning solution. Use a thin layer of petroleum jelly to lubricate the O-ring **(b)**. Reassemble spray gun.

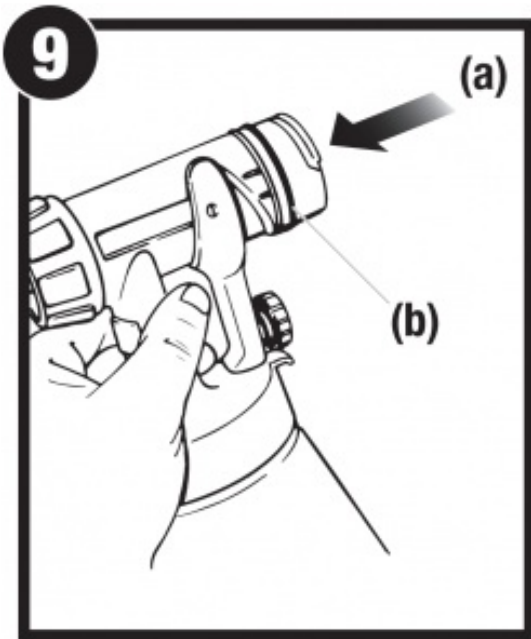

Maintenance

Start

Important:

You should inspect the air filter in the turbine to see if it is excessively dirty. If it is dirty, follow these steps to replace it.

IMPORTANT: never operate your unit without the air filters. Dirt could be sucked in and interfere with the function of the unit.

1. Press the tabs on each side of the turbine to remove the filter covers.
2. Remove the dirty filters from the turbine and replace with new ones. The smooth side of the air filter must be placed toward the turbine.

Secure the covers back onto the turbine.

Troubleshooting

Problem A: Little or no material flow

Cause		Solution
1.	Nozzle clogged.	Clean.
2.	Suction tube clogged.	Clean.
3.	Material volume setting turned too low (-).	Increase volume setting (+).
4.	Suction tube loose.	Insert.
5.	No pressure build up in container.	Tighten container.
6.	Air filter clogged.	Change.

Problem B: Material leaking

Cause		Solution
1.	Nozzle loose.	Tighten.
2.	Nozzle worn.	Replace.
3.	Nozzle seal worn.	Replace.
4.	Material build-up on air cap and nozzle	Clean.

Problem C: Atomization is too coarse

Cause		Solution
1.	Viscosity of material too high.	Thin.
2.	Material volume too large.	Decrease volume setting (-).
3.	Material volume setting too high (+).	Decrease volume setting (-).
4.	Pressure setting too low.	Increase pressure setting (+).
5.	Nozzle clogged.	Clean.
6.	Air filter clogged.	Change.
7.	Too little pressure build-up in container.	Tighten container.

Problem D: Spray jet pulsates

Cause		Solution
1.	Material in container running out.	Refill.
2.	Air filter clogged.	Change.

Problem E: Pattern runs or sags

Cause		Solution
1.	Applying too much material.	Refill.

Problem F: Too much overspray

Cause		Solution
1.	Gun too far from spray object.	Reduce distance.
2.	Too much material applied.	Decrease volume setting (-).
3.	Pressure setting too high.	Decrease pressure setting.

Problem G: Pattern is very light and splotchy

Cause		Solution
1.	Moving the spray gun too fast.	Adjust material flow or decrease movement of spray gun.



Have you tried the recommendations above and are still having problems? In the United States, to speak to a customer service representative, call our Technical Service at 1-800-328-8251 Monday through Friday between 8:00 AM and 4:30 PM Central time.

Questions?

Call Wagner Technical Service at: 1-800-328-8251

Product Registration

Register your product online at www.wagnerspraytech.com.

Proper registration will serve as proof of purchase in the event your original receipt becomes misplaced or lost.



Documents / Resources

	WAGNER Control Spray Max [pdf] User Guide Control Spray Max, 0518604B
-------------------------------------------------------------------------------------	------------------------------------------------------------------------------------------

References

-  [Paint Sprayers, Heat Guns, Power Rollers | Wagner SprayTech](#)

