

VTOMAN X5 Jump Starter with Air Compressor

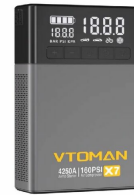

VTOMAN X5 Jump Starter with Air Compressor User Manual

[Home](#) » [VTOMAN](#) » VTOMAN X5 Jump Starter with Air Compressor User Manual 

Contents

- 1 VTOMAN X5 Jump Starter with Air Compressor
- 2 Introduction
- 3 COMPONENTS AND FUNCTIONS
- 4 KEY POINTS
- 5 BUTTONS AND DISPLAY SCREEN
- 6 OPERATION GUIDANCE
- 7 TECHNICAL SPECIFICATIONS
- 8 FAQs
- 9 TROUBLESHOOTING
- 10 REMINDERS
- 11 MAINTENANCE AND SUPPORT
- 12 Documents / Resources
 - 12.1 References



VTOMAN X5 Jump Starter with Air Compressor



Introduction

WELCOME

Thank you for choosing vtoman jump starter. To ensure a good user experience, personal safety, and property security, please read all of the instructions carefully before using this product, please keep this manual for reference.

Charge it first!

- While reading through the manual, you can start to charge your X5 with type-c cable provided.

Warning!

- This unit is for vehicle (equipment) with 12V batteries. It may be dangerous if it is used with other types of batteries.
- Read and understand the safety information before using the jump starter. Failure to follow the safety information may cause damage to the jump starter, and may also result in electric shock, explosions, fire, property damage, and personal injury.

COMPONENTS AND FUNCTIONS

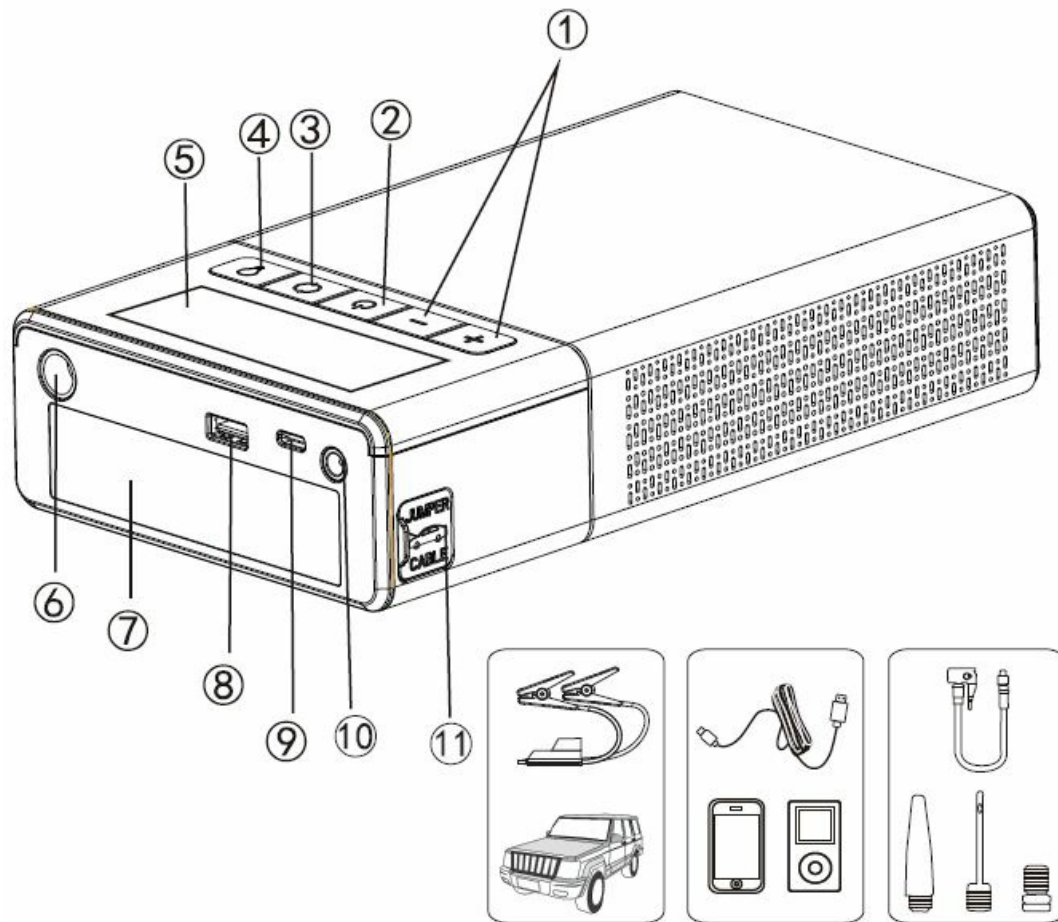

1. Pressure adjustment
2. Power switch / Inflating pump starting button
3. Settings
4. Lamp switch
5. LED display screen
6. Air inflating port
7. LED flashlight (distress signal light)
8. 5V/9V/12V output port
9. USB-C 9V/2A input port
10. 15V 10A output port
11. 12V Automobile starting port

KEY POINTS

Powerful 3500A Jump Starter

Instantly jump-start a battery with 3500A cranking power. If your car battery is totally dead or the battery voltage is too low to detect, just press the "BOOST" button, your car can restart immediately. With X5, you can start all 12V vehicles (up 9L gas and 8L diesel engine) up to 60 times on a single charge. It's universal compatible with cars, trucks, motorcycles, lawnmowers, SUV, snowmobiles, boats etc. Never anxiously wait hours for roadside assistance again.

2 Mins Super Fast Inflation

The VTOMAN X5 car battery charger jump starter is equipped with an 160psi digital air compressor that can inflate a typical car tire to 20 PSI in just 2 minutes, 2 time faster than others. Additionally, the X5 features real-time tire pressure detection and an auto shut-off function when the set PSI is reached. The set also includes an extension air hose and 3 different nozzles, allowing you to inflate cars, bikes, balls, mattresses, pool floats, etc.

Large 5.1-Inch Smart Screen

Unlike traditional jump starters that only have analog indicators, the X5 jump starter for car battery boasts a large and intelligent 5.1-inch smart screen. This display provides vital information such as battery level, inflator mode, inflate volume, and tire pressure in 3 units (psi, bar, kpa), making it more easier and clearer for you to use.

Enhanced Safety Technology

VTOMAN car battery jump starter pack prioritizes safety and ease of use. The jump cable indicator uses a reverse red light to notify you of incorrect usage, eliminating any concerns about incorrect connections or sparks. It offers a comprehensive range of protection features, including spark-proof, reverse-charge, over-current, over-charge, reverse-polarity, high-temp, low-temp, short-circuit, over-voltage, and over-load protection.

Upgraded Thermal Design

The X5 battery booster pack features an upgraded thermal design that ensures cool operation even during prolonged use. This advanced design prevents overheating, ensuring optimal performance and durability over the long term, even in extreme weather(-4 F to 140 F).

All-in-one jumper starter

Say goodbye to old bulky battery jump boxes! The VTOMAN X5 is not just a powerful jump starter and tire inflator, but also a compact power bank battery pack. 24 months standby time make it to be your all-in-one solution for emergencies on the road. Moreover, the X5 features a 400-lumen LED light with 3 lighting modes (normal, strobe, sos). Plus it supports 18W Type-c fast charging, just 10 minutes to charge to fully inflate a tire!

Perfect gift for your loved ones

This jump starter kit includes 1 x jump starter with air compressor, 1 x smart jumper cable, 1 x USB-A to USB-C cable, 1 x storage bag, 1 x pump tube, 3 x air nozzle, 1 x user manual, 24 months warranty and lifetime tech support. It makes for a perfect gift for car owners, camping enthusiasts, and adventure lovers. Contact us if you have any questions, our customer service team is always ready to help.

Note

- Please do not use the air pump function continuously.
- When the tire battery compressor is seriously hot, please cool down for a few minutes before continuing to inflate the tire.

BUTTONS AND DISPLAY SCREEN

1. Long press the switch button for 2 seconds so that the starter displays information on the electrical configuration, and the charger will enter the to-be-inflated mode.

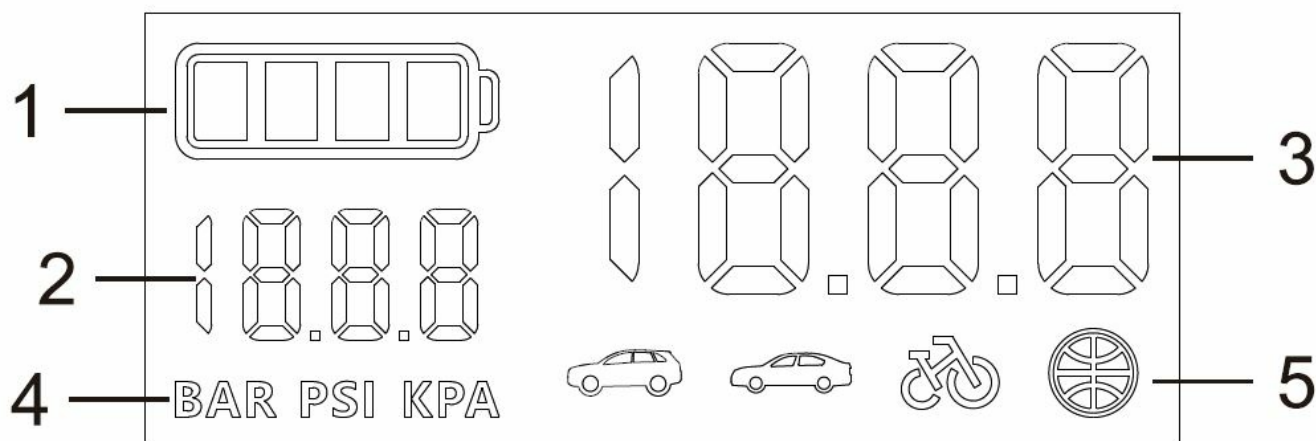

1. Battery states
 2. Preset tire pressure value
 3. Static air pressure value
 4. BAR, PSI & KPA
 5. Cars, SUVs, basketballs, bicycles or other inflatable items
2. Short press the lighting button to turn on the LED light, and the white light will remain on. Press the switch button again, and the LED will enter the red flashing mode. Press again to turn off the light.
 3. After the load is removed, the product automatically enters the dormant mode 30 seconds later.
 4. When the product is in the standby mode or working normally, press the "Set" key to enter the inflating pump editing mode, after which the SUV icon will display; at the same time, preset the tire pressure value (unit: BAR), where you can short press the "+" "-" key to adjust the pressure value, or long press the "Set" key to alter the unit (KPA, BAR or PSI); short press the "Set" key to switch the item to be inflated until the car icon displays, and preset the pressure value (unit: BAR), before short pressing the "+" "-" key to adjust the pressure value or long pressing the "Set" key to switch the unit (KPA, BAR or PSI). Then short press the "Set" button until the bicycle icon and the preset air pressure value (unit: PSI) are displayed; press the "Set" button again to adjust the air pressure value, and long press the "Set" button to switch the unit (KPA, BAR or PSI). Press the "Set" button again to display the basketball icon and the preset air pressure value (unit: PSI); short press the "+" and "-" button again to adjust the air pressure value. Long press the "Set" key to switch units between KPA, BAR and PSI under the free mode.
 5. While choosing the mode for the inflating pump for SUVs, cars, bicycles or basketballs, icon 4 will display the preset tire pressure value. Note that the preset value serves as reference only, and please adjust in accordance with the actual situation. The preset values for different inflatable items are:
 - **SUVs:** 2.5 BAR
 - **Cars:** 2.4 BAR
 - **Bicycles:** 45 PSI
 - **Basketballs:** 8PSI

Please switch the unit accordingly on the left. Only one unit can be displayed for each item.
 6. While charging, the bars at the battery icon will flash in accordance with the actual level of remaining battery life.
 7. When a product's remaining battery life falls below 10%, the corresponding indicator will flash.

OPERATION GUIDANCE

Charging the host machine of the jump starter

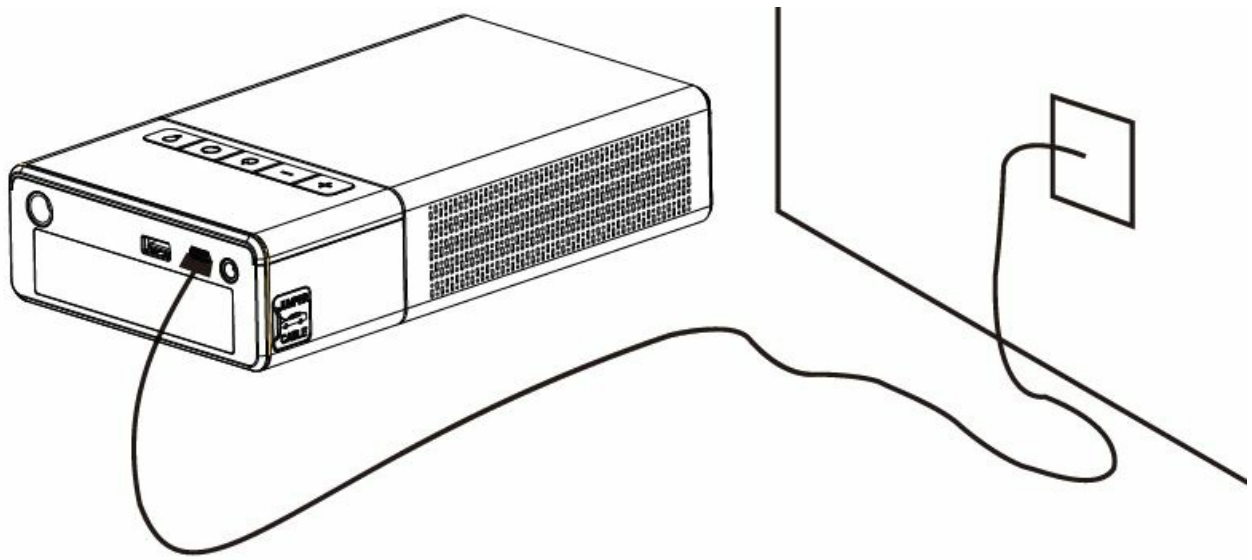

How to Use the Smart Cable

1. First, plug the blue connector of the intelligent battery clamp into the main unit, ensuring that the clamp's indicator light is off.

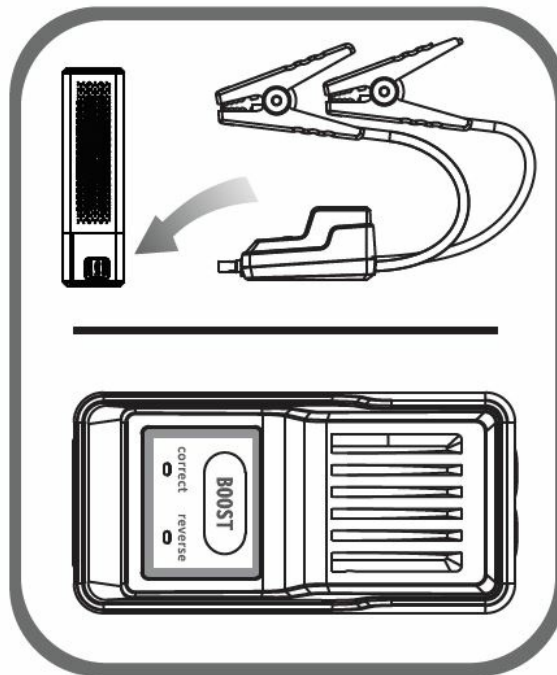

2. Next, correctly connect the battery clamp to the positive and negative terminals of the car battery. Attach the red clamp to the positive terminal (+) and the black clamp to the negative terminal (-).
3. Then, follow the corresponding operation based on the battery clamp's indicator light:

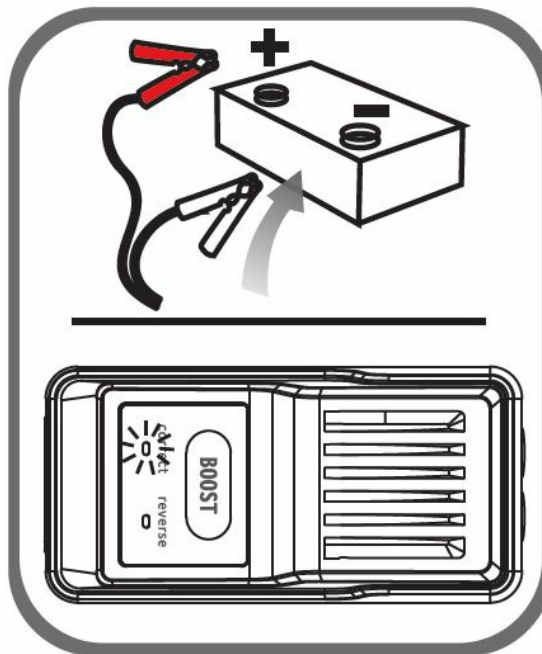

- **Solid green light:** This indicates that the connection is correct and powered on. You can now proceed with the emergency jump-start.

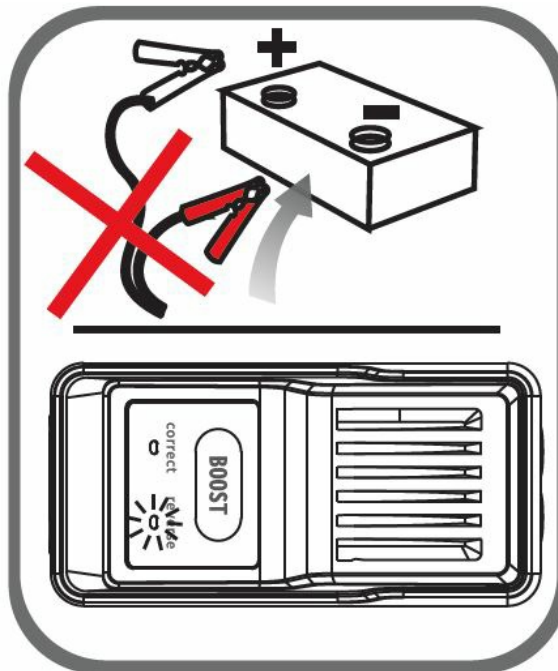

- **Solid red light:** This indicates that the positive and negative terminals are incorrectly connected. Please reconnect them correctly, and once the green light turns solid, proceed with the emergency jump-start.

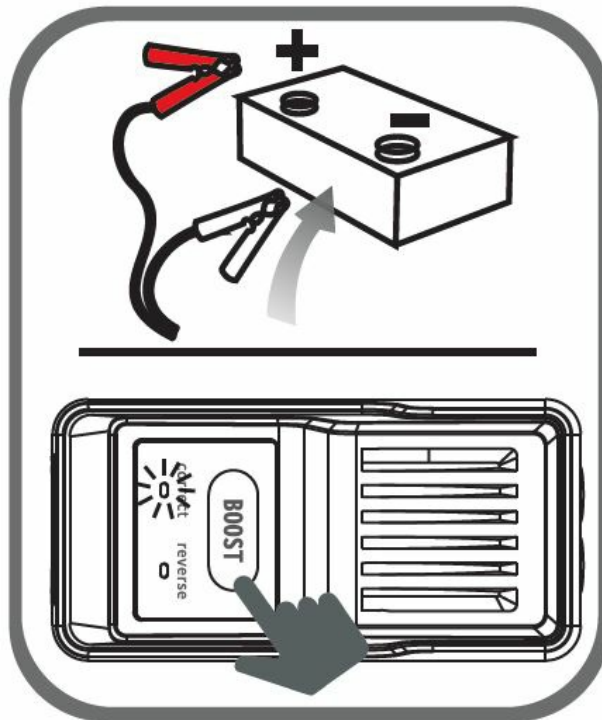

- **Flashing green light:** This indicates that the battery voltage is too low. Press the BOOST button, and once the green light turns solid, complete the jump-start within 30 seconds.

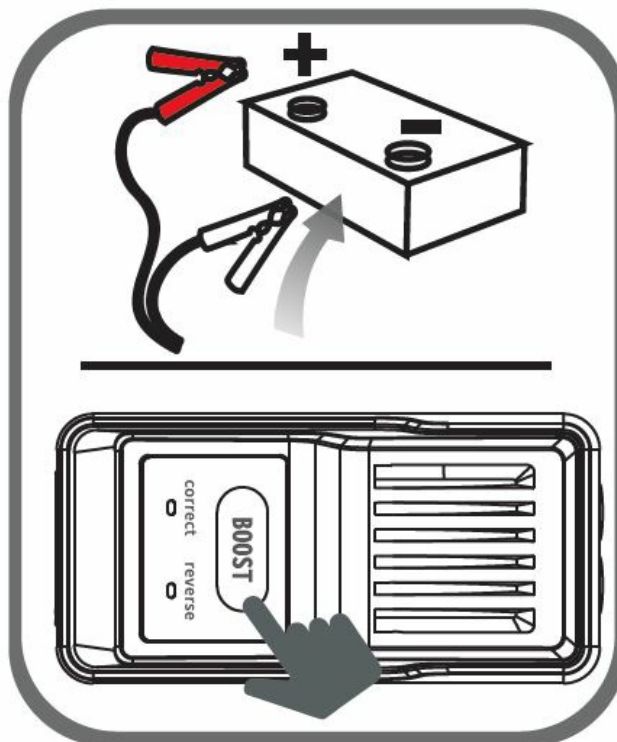

- **No red or green light:** This may indicate that the battery is completely damaged. Ensure the positive and negative terminals are correctly connected, then press the BOOST button. Once the green light turns solid, complete the jump-start within 30 seconds.

Charging electronic devices such as smartphones or tablets

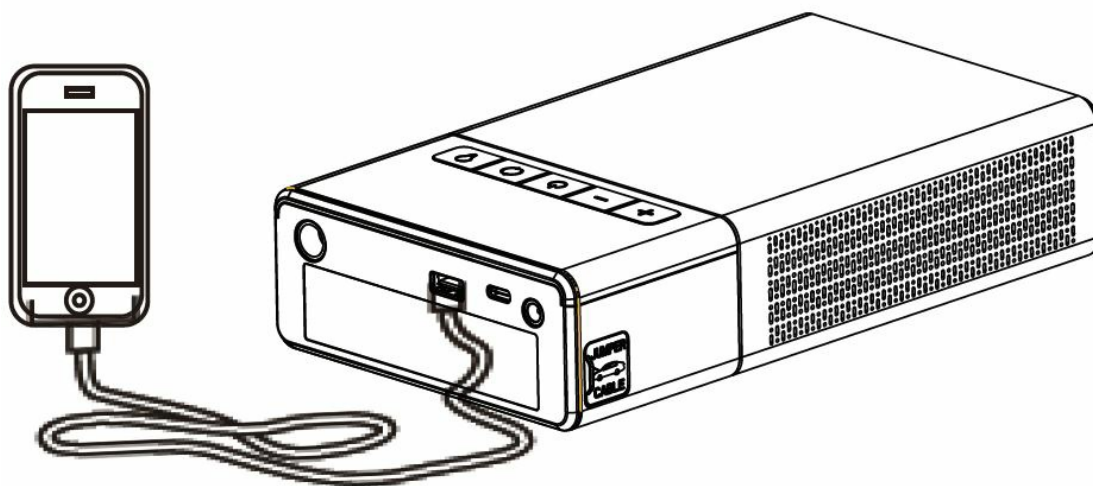

1. Choose a proper charging plug to connect to the port of the mobile phone adapter cable
2. Connect the USB plug of the mobile phone adapter cable to the USB output port of the host machine
3. Connect the charging port to your phone/tablet
4. Press the switch button to start charging your electronic devices.

Powering 12 V electronic/on-board devices

1. Insert the adaptor end of the adaptor cable to the 15V output port of the host machine
2. Connect the 12V device to be charged to the other end of the adaptor cable
3. Tap the switch button to start charging the on-board products

Switch LED light modes

No.	Name of the accessory	Quantity
1	Host machine	1
2	Inflating pump	1
3	Smartphone adapter cable	1
4	Intelligent battery clip	1
5	User manual	1
6	Multifunctional air cock	3
7	Carrying Bag	1

TECHNICAL SPECIFICATIONS

Technical specifications:
Size: 223*123*63mm
Weight 1352 ±5g
Capacity: 59.2Wh
Output: Fast charging (5V $\overline{\text{---}}$ 3A, 9V $\overline{\text{---}}$ 2A, 12V $\overline{\text{---}}$ 1.5A); 15V $\overline{\text{---}}$ 10A, 12V car starting
Input: 9V $\overline{\text{---}}$ 2A
Time taken to charge to the full: Around 4 hours
Starting current: 600A (3S)
Peak current: 3500A
Temperature: -4~140°F

FAQS

- Q:** How to turn off the jump starter?
 - A:** The product has an automatic detection function. Once it has no loading or the charging process is finished, the starter will automatically go dormant to save electricity.
 - Press the switch button for 2 seconds to turn it off.
- Q:** How long does it take to charge the host machine?
 - A:** It takes 4 hours to charge it to the full with a USB 9V/2A charger.
- Q:** How many times can the host machine start a car?
 - A:** For over 50 times in a row.
- Q:** How long is the host machine's service life?
 - A:** 5-7 years under normal circumstances.
- Q:** How long can the host machine be shelved after charged to the full for it to work again immediately?
 - A:** The host machine boasts scientific design that it can be shelved for 6-12 months. But it is suggested to charge it every three months to protect its service life.

TROUBLESHOOTING

Please stop using the product and contact the seller if the instructions below cannot solve the problems you have encountered.

Phenomenon	Reason	Instruction
Tap the switch button and EPOWER does not react.	The EPOWER's voltage is excessively low that the low-voltage protection function is triggered to cut the circuits.	Insert the charging plug into the 5V input port to activate it.

Product ingredients

Product name	Toxic and Hazardous Substances or Elements					
	Plumbum (pb)	Mercury (Hg)	Cadmium (Cd)	(Cr(VI) Chromium VI (Cr VI)	(PBB) Polybrominated biphenyls (PBB)	(PBDE) Polybrominated diphenyl ethers (PBDE)
Jump starter	O	O	O	O	O	O

REMINDERS





1. Please carefully read through the user manual before using this product.
2. This product can only be used to start 12V cars. It can cause danger if used on other cars. It is prohibited on airplanes or ships.
3. Please use it with care.
4. Please stop using the product if the battery clips or cables are damaged.
5. It cannot be used as a replacement of car batteries.
6. It cannot be used as a portable battery charger.
7. Do not continue to clip the product to the battery after the car has been successfully started.
8. Please use the battery clip attached with the product.
9. Make sure the blue plug of the battery clip is fully inserted into the product starter port; otherwise, the blue plug may melt. Before starting, make sure all battery connectors are clean and the battery clips are properly connected. If the battery end of the car is dirty or corroded, the product's starting performance will be reduced.
10. Please do not start the product for more than three consecutive times, as this may cause it to overheat and damage the product. If you need to start the product multiple times, please make sure to wait for two minutes between each start-up.
11. Please remove the product from the car battery within 30 seconds after starting, otherwise it may cause damage.
12. Please connect the positive/negative polar of the clip correctly.
13. Please make sure that 3-4 indicators are on before starting.
14. Please keep the product away from children.
15. Please do not use the product as a toy.
16. Keep the product dry.
17. Do not put the product in water.
18. Please do not use the product in explosive environments such as when there are flammable liquids, dusts or

gas.

19. Please do not modify or disassemble the product. It can only be repaired by professional technicians.
20. Do not expose the product to extremely hot conditions or fire.
21. Make sure that you can be heard or helped while you use the product.
22. Take off all metal items you wear such as rings, bracelets, necklaces before using the product.
23. Please do not drop the product. In case it is damaged, please have eligible technicians to detect and fix it.
24. Do not expose the product to heat of over 158°F.
25. Charge at room temperature (32-140°F).
26. Please charge with the charger attached.
27. Do not start the car while the host machine is charged.
28. In case of liquid leakage from the host machine, restore the leaked liquid immediately with proper containers.
29. Under extreme conditions, battery leakage can occur. If the liquid is coming out of the product, it cannot be handled directly by hand. In case of skin contact, wash immediately with soap and water. If fluid comes into contact with eyes, flush the eyes with cold running water for at least 10 minutes and seek medical attention immediately.
30. Products based on lithium batteries shall be disposed of at the end of their service life in accordance with local regulations.

MAINTENANCE AND SUPPORT

Attention

-  Do Not Submerge In Water
-  Do Not Disassemble
-  Do Not Drop
-  Avoid Extreme Temperatures
-  Do Not Place Near or Into Fire



Overcharge/discharge
Protection



Fuse Protection



Against-revers
Plug

Customer Service

- 18 Months Limited Warranty Service
- Lifetime Technical Service
- Feel Free to Contact Us
 - Support@vtoman.com
- For FAQ and More Information
 - Support@vtoman.com

Thank You for Choosing Us!

Made in China

Documents / Resources

 <p>VTOMAN User Manual Jump Starter with Air Compressor X5</p>	<p>VTOMAN X5 Jump Starter with Air Compressor [pdf] User Manual B0CTF9X8Q5, B0BBG7RZTN, B0C2887FTM, B0C3CTKNFY, B0BBG7Y96C, X5 Jump Starter with Air Compressor, X5, Jump Starter with Air Compressor, Starter with Air Compressor, Air Compressor, Compressor</p>
--	--

References

- [User Manual](#)

[Manuals+.](#) [Privacy Policy](#)

This website is an independent publication and is neither affiliated with nor endorsed by any of the trademark owners. The "Bluetooth®" word mark and logos are registered trademarks owned by Bluetooth SIG, Inc. The "Wi-Fi®" word mark and logos are registered trademarks owned by the Wi-Fi Alliance. Any use of these marks on this website does not imply any affiliation with or endorsement.