

VTOMAN X7 Jump Starter Air Compressor



VTOMAN X7 Jump Starter Air Compressor User Manual

[Home](#) » [Support](#) » VTOMAN X7 Jump Starter Air Compressor User Manual 

Contents

- [1 VTOMAN X7 Jump Starter Air Compressor](#)
- [2 COMPONENTS AND FUNCTIONS](#)
- [3 KEY POINTS](#)
- [4 BUTTONS AND DISPLAY SCREEN](#)
- [5 OPERATION GUIDANCE](#)
- [6 Technical specifications](#)
- [7 TROUBLESHOOTING](#)
- [8 REMINDERS](#)
- [9 MAINTENANCE AND SUPPORT](#)
- [10 FAQs](#)
- [11 Video- VTOMAN X7 Jump Starter Air Compressor](#)
- [12 References](#)

VTOMAN

VTOMAN X7 Jump Starter Air Compressor



Thank you for choosing the vtoman jump starter. To ensure a good user experience, personal safety, and property security, please read all of the instructions carefully before using this product, please keep this manual for reference.

Charge it first!

While reading through the manual, you can start to charge your X7 with the 18W wall charger and type-c cable provided.

Warning!

This unit is for vehicles (equipment) with 12V batteries. It may be dangerous if it is used with other types of batteries. Read and understand the safety information before using the jump starter. Failure to follow the safety information may cause damage to the jump starter, and may also result in electric shock, explosions, fire, property damage, and personal injury.

COMPONENTS AND FUNCTIONS

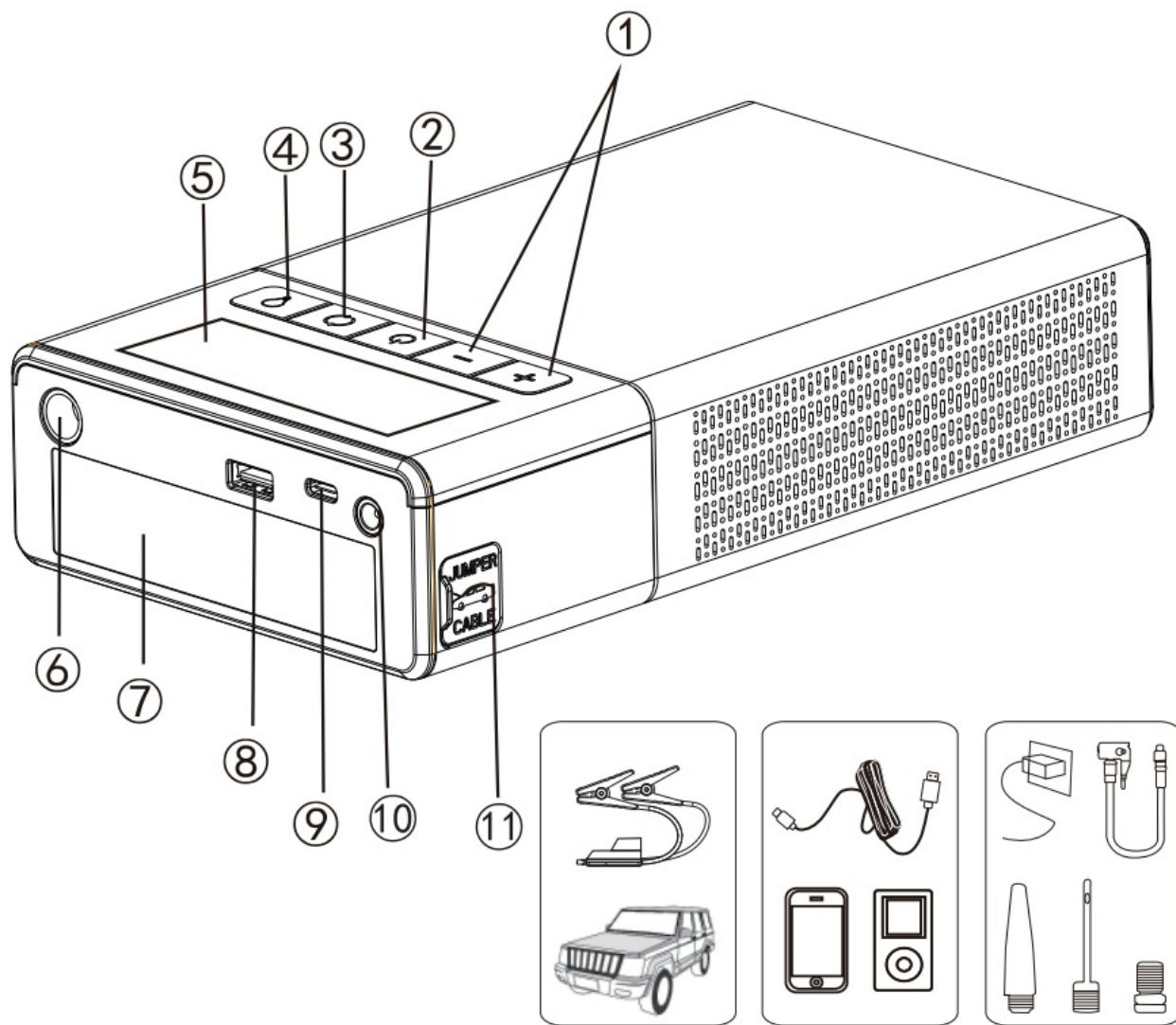

1. Pressure adjustment
2. Power switch / Inflating pump starting button
3. Settings
4. Lamp switch
5. LED display screen
6. Air inflating port
7. LED flashlight (distress signal light)
8. 5V/9V/12V output port
9. USB-C 9V/2A input port
10. 15V 10A output port
11. 12V Automobile starting port

KEY POINTS

- **UNMATCHED STARTUP PERFORMANCE:** The X7 jump starter has a peak starting current of 4250A and a large battery capacity, especially professional for heavy-duty vehicles like trucks and boats.
The X7 battery starter is able to start all 12V vehicles (10L Gas/10L Diesel engines) up to 70 times at once. Additionally, our X7 battery jump starter is equipped with BOOST FUNCTION for TOTALLY DEAD BATTERY.
- **INTELLIGENT DIGITAL TIRE INFLATOR:** The X7 car jump starter is equipped with a 5.1-inch smart screen and tire pressure detection function to make your operation more convenient. Not only that, our X7 jump starter

with air compressor can adjust the inflation mode at any time during the pumping process. The jumper starter battery pack supports 3 optional units (PSI, BAR, KPA). A 160PSI air compressor takes about 2 minutes to inflate a typical car tire to 20 PSI.

- **5.1-INCH LARGE INTELLIGENT DISPLAY:** A user-friendly 5.1-inch smart screen provides you with important data such as battery level, inflator mode and real-time tire pressure, making it easier and clearer to use the product.
- **MULTIPLE PROTECTION:** The upgraded smart chip of the X7 jump starter battery pack makes it easy and fast to start the car in extreme environments (-4°F to 140°F), with 10 built-in safety protection technologies(over-charge, over-current, short-circuit, reverse-polarity, low-temp, high-temp, over-voltage, over-load, spark-proof, reverse-charge).
- **UPGRADED THERMAL DESIGN:** The unique honeycomb heat dissipation design enables the X7 car battery booster to obtain more powerful heat dissipation performance, so the safety performance of the X7 car starter is Enhanced by 30%, and its service life is promoted by 50%.
- **MORE THAN A JUMP STARTER:** X7 is not only jump box, power bank, Tire Inflator, LED flashlight, but it also supports 18W Type-c fast charging. The X7 jump pack takes just ten minutes to charge to fully inflate a tire. In addition, the 400-lumen LED light equipped with the X7 battery starter supports three lighting modes: constant lighting (white), flash and SOS.
- **WHAT YOU GET:** 1 X jump starter with air compressor, 1 X wall charger, 1 X smart jumper cable, 1 X USB-A to USB-C cable, 1 X carrying bag, 1 X pump tube, 3 X air nozzle, 1 X user manual and 18 months warranty. If you have any after-sales questions about jump starter, please feel free to contact us.

BUTTONS AND DISPLAY SCREEN

1. Long press the switch button for 2 seconds so that the starter displays information on the electrical configuration, and the charger will enter the to-be-inflated mode.

- Battery states
- Preset tire pressure value
- Static air pressure value
- BAR, PSI & KPA
- Cars, SUVs, basketballs, bicycles or other inflatable items

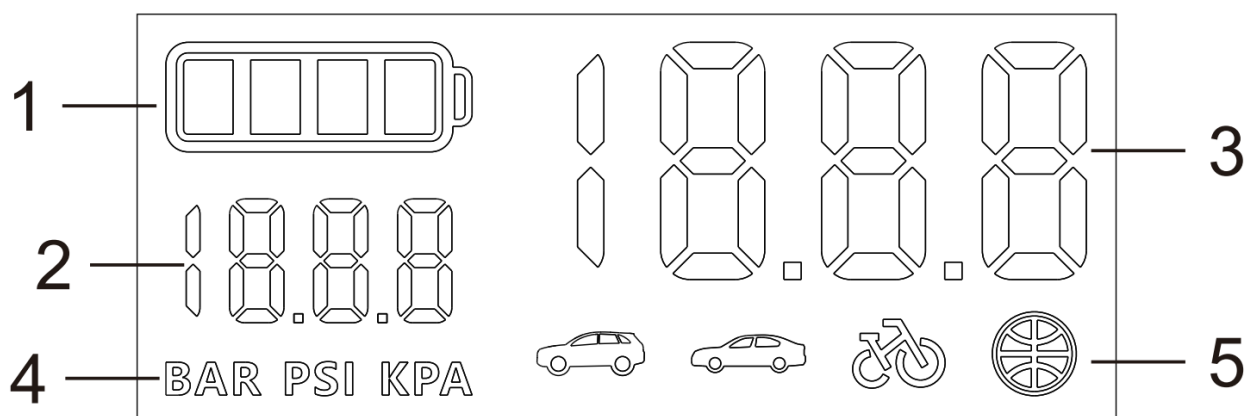

2. Short press the lighting button to turn on the LED light, and the white light will remain on. Press the switch button again, and the LED will enter the red flashing mode. Press again to turn off the light.
3. After the load is removed, the product automatically enters the dormant mode 30 seconds later.
4. When the product is in the standby mode or working normally, press the "Set" key to enter the inflating pump editing mode, after which the SUV icon will display; at the same time, preset the tire pressure value (unit: BAR),

where you can short press the “+” “-” key to adjust the pressure value, or long press the “Set” key to alter the unit (KPA, BAR or PSI); short press the “Set” key to switch the item to be inflated until the car icon displays, and preset the pressure value (unit: BAR), before short pressing the “+” “-” key to adjust the pressure value or long pressing the “Set” key to switch the unit (KPA, BAR or PSI). Then short press the “Set” button until the bicycle icon and the preset air pressure value (unit: PSI) are displayed; press the “Set” button again to adjust the air pressure value, and long press the “Set” button to switch the unit (KPA, BAR or PSI). Press the “Set” button again to display the basketball icon and the preset air pressure value (unit: PSI); short press the “+” and “-” button again to adjust the air pressure value. Long press the “Set” key to switch units between KPA, BAR and PSI under the free mode.

5. While choosing the mode for the inflating pump for SUVs, cars, bicycles or basketballs, icon 4 will display the preset tire pressure value. Note that the preset value serves as reference only, and please adjust in accordance with the actual situation. The preset values for different inflatable items are:

- SUVs: 2.5 BAR
- Cars: 2.4 BAR
- Bicycles: 45 PSI
- Basketballs: 8PSI

Please switch the unit accordingly on the left. Only one unit can be displayed for each item.

6. While charging, the bars at the battery icon will flash in accordance with the actual level of remaining battery life.

7. When a product’s remaining battery life falls below 10%, the corresponding indicator will flash.

OPERATION GUIDANCE

Charging the host machine of the jump starter

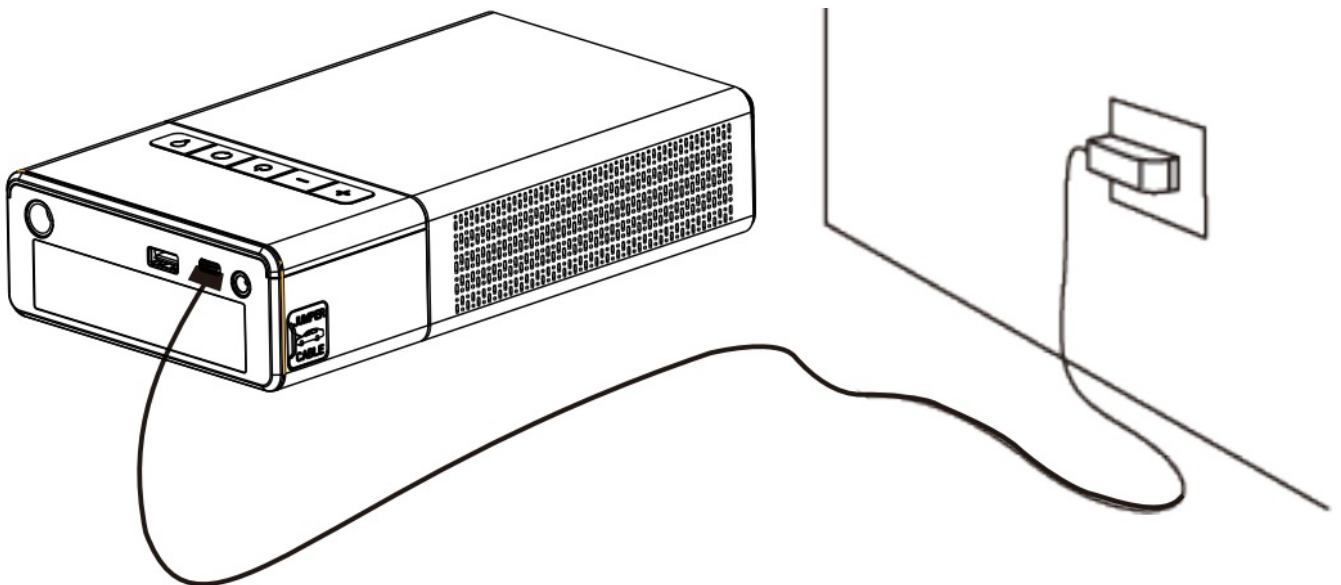

How to Use the Smart Cable

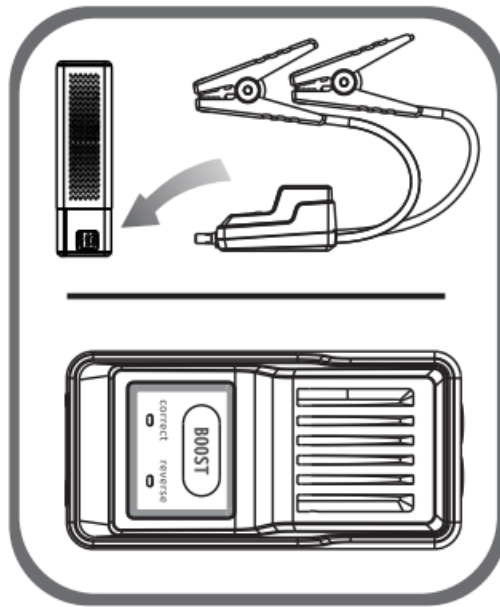

1. First, plug the blue connector of the intelligent battery clamp into the main unit, ensuring that the clamp's indicator light is off.
2. Next, correctly connect the battery clamp to the positive and negative terminals of the car battery. Attach the red clamp to the positive terminal (+) and the black clamp to the negative terminal (-).
3. Then, follow the corresponding operation based on the battery clamp's indicator light:
 - **Solid green light:** This indicates that the connection is correct and powered on. You can now proceed with the emergency jump-start.

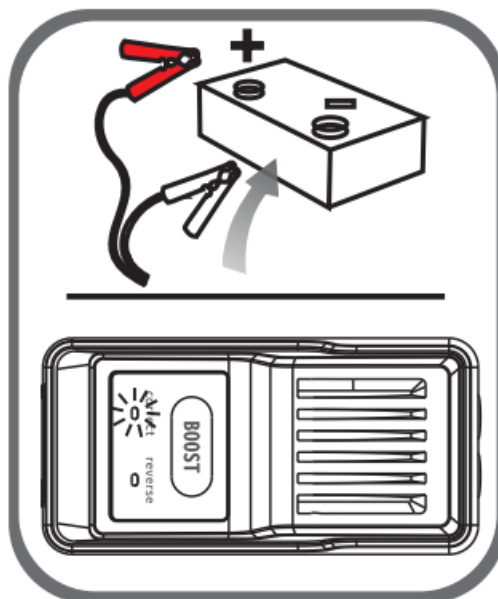

- **Solid red light:** This indicates that the positive and negative terminals are incorrectly connected. Please reconnect them correctly, and once the green light turns solid, proceed with the emergency jump-start.

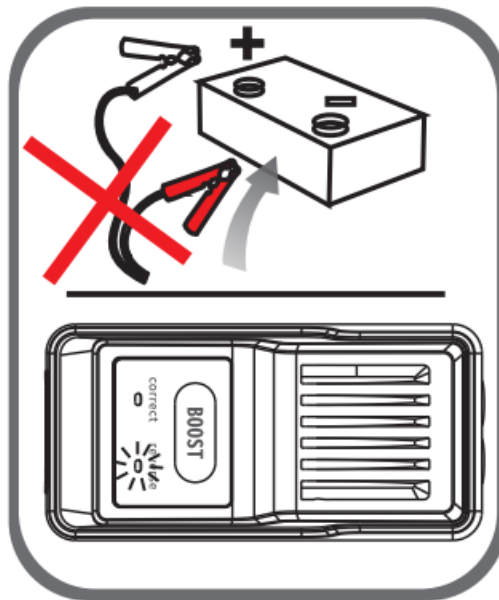

- **Flashing green light:** This indicates that the battery voltage is too low. Press the BOOST button, and once the green light turns solid, complete the jump-start within 30 seconds.

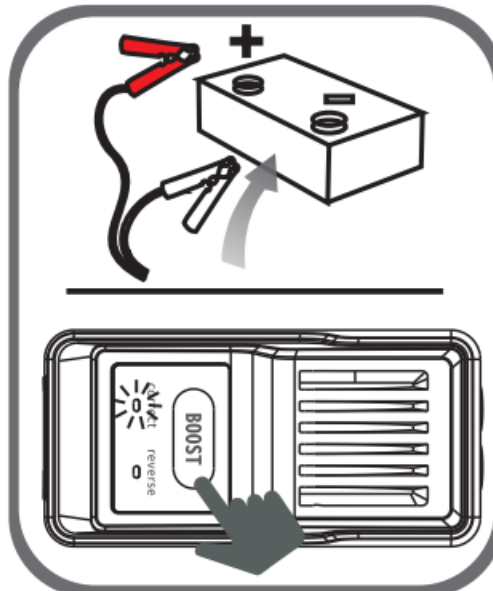

- **No red or green light:** This may indicate that the battery is completely damaged. Ensure the positive and negative terminals are correctly connected, then press the BOOST button. Once the green light turns solid, complete the jump-start within 30 seconds.

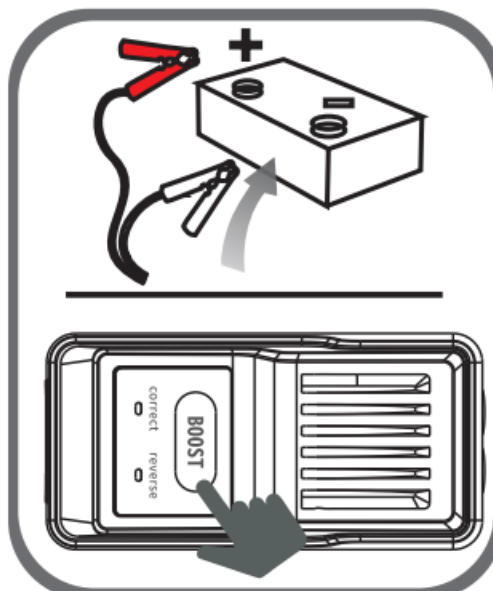

Charging electronic devices such as smartphones or tablets

1. Choose a proper charging plug to connect to the port of the mobile phone adapter cable
2. Connect the USB plug of the mobile phone adapter cable to the USB output port of the host machine
3. Connect the charging port to your phone/tablet
4. Press the switch button to start charging your electronic devices

Powering 12 V electronic/on-board devices

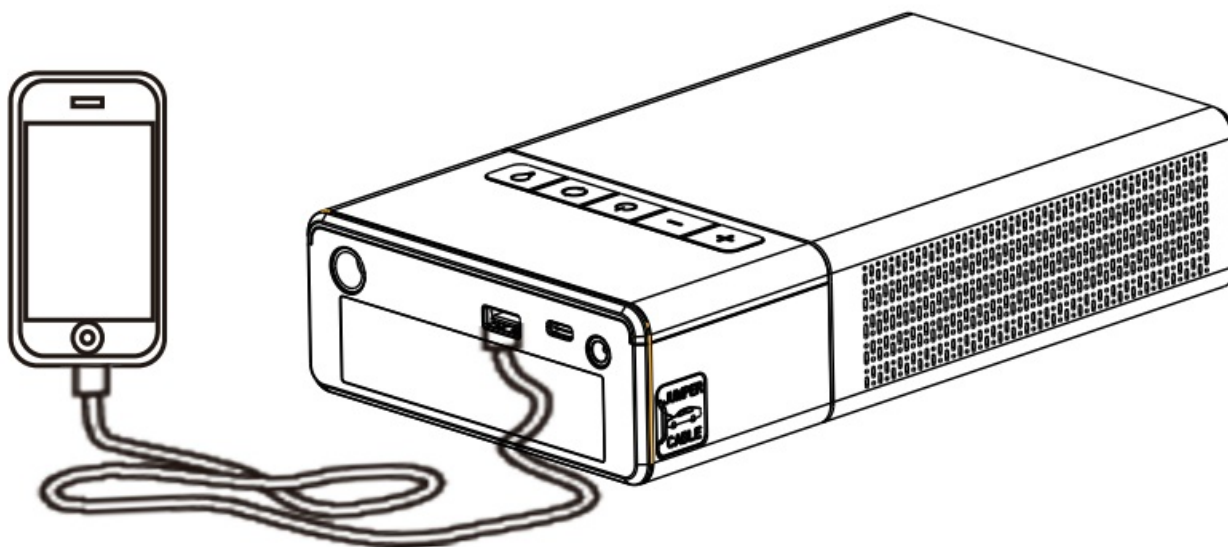

1. Insert the adaptor end of the adaptor cable to the 15V output port of the host machine
2. Connect the 12V device to be charged to the other end of the adaptor cable
3. Tap the switch button to start charging the on-board products

| No. | Name of the Accessory | Quantity |
|-----|--------------------------|----------|
| 1 | Host Machine | 1 |
| 2 | Inflating Pump | 1 |
| 3 | Smartphone Adapter Cable | 1 |
| 6 | Intelligent Battery Clip | 1 |
| 7 | User Manual | 1 |
| 8 | Multifunctional Air Cock | 1 |
| 9 | Wall Charger | 1 |
| 10 | Carrying Bag | 1 |

Technical specifications

| Parameter | Value |
|------------------------------|---|
| Size | 223 x 123 x 63mm |
| Weight | 1548.5g (1.5485 kg) |
| Capacity | 88.8Wh |
| Output | Fast charging (5V=3A, 9V=2A, 12V=1.5A); 15V=10A, 12V car starting |
| Input | 9V=2A |
| Time taken to charge to full | Around 7 hours |
| Starting current | 800A (3S) |
| Peak current | 4250A |
| Temperature | -4°F to 140°F |

TROUBLESHOOTING

Please stop using the product and contact the seller if the instructions below cannot solve the problems you have encountered.

| | |
|-------------|--|
| Phenomenon | Tap the switch button and EPOWER does not react. |
| Reason | The EPOWER's voltage is excessively low that the low-voltage protection function is triggered to cut the circuits. |
| Instruction | Insert the charging plug into the 5V input port to activate it. |

Product ingredients

| Product Name | Jump Starter Plumbum (pb) |
|--|--|
| Toxic and Hazardous Substances or Elements | Mercury (Hg), Cadmium (Cd), Chromium (Cr/), Lead (Pb), Polybrominated biphenyl (PBB), Polybrominated diphenyl ethers (PBDE), Chromium VI (Cr VI) |





REMINDERS

1. Please carefully read through the user manual before using this product.
2. This product can only be used to start 12V cars. It can cause danger if used on other cars. It is prohibited on airplanes or ships.
3. Please use it with care.
4. Please stop using the product if the battery clips or cables are damaged.
5. It cannot be used as a replacement of car batteries.
6. It cannot be used as a portable battery charger.
7. Do not continue to clip the product to the battery after the car has been successfully started.

8. Please use the battery clip attached with the product.
9. Make sure the blue plug of the battery clip is fully inserted into the product starter port; otherwise, the blue plug may melt. Before starting, make sure all battery connectors are clean and the battery clips are properly connected. If the battery end of the car is dirty or corroded, the product's starting performance will be reduced.
10. Please do not start the product for more than three consecutive times, as this may cause it to overheat and damage the product. If you need to start the product multiple times, please make sure to wait for two minutes between each start-up.
11. Please remove the product from the car battery within 30 seconds after starting, otherwise it may cause damage.
12. Please connect the positive/negative polar of the clip correctly.
13. Please make sure that 3-4 indicators are on before starting.
14. Please keep the product away from children.
15. Please do not use the product as a toy.
16. Keep the product dry.
17. Do not put the product in water.
18. Please do not use the product in explosive environments such as when there are flammable liquids, dusts or gas.
19. Please do not modify or disassemble the product. It can only be repaired by professional technicians.
20. Do not expose the product to extremely hot conditions or fire.
21. Make sure that you can be heard or helped while you use the product.
22. Take off all metal items you wear such as rings, bracelets, and necklaces before using the product.
23. Please do not drop the product. In case it is damaged, please have eligible technicians to detect and fix it.
24. Do not expose the product to heat of over 158°F.
25. Charge at room temperature (32-140°F).
26. Please charge with the charger attached.
27. Do not start the car while the host machine is charged.
28. In case of liquid leakage from the host machine, restore the leaked liquid immediately with proper containers.
29. Under extreme conditions, battery leakage can occur. If the liquid is coming out of the product, it cannot be handled directly by hand. In case of skin contact, wash immediately with soap and water. If fluid comes into contact with eyes, flush the eyes with cold running water for at least 10 minutes and seek medical attention immediately.
30. Products based on lithium batteries shall be disposed of at the end of their service life in accordance with local regulations.

MAINTENANCE AND SUPPORT



An Attention

-  Do Not Submerge In Water
-  Do Not Disassemble
-  Do Not Drop
-  Avoid Extreme Temperatures
-  Do Not Place Near or Into Fire

Overcharge/discharge



Customer Service

-  18 Months Limited Warranty Service
-  Lifetime Technical Service
-  Feel Free to Contact Us: Support@vtoman.com

For FAQ and More Information: Support@vtoman.com

FAQs

What is the VTOMAN X7 Jump Starter with Air Compressor designed for?

The VTOMAN X7 Jump Starter with Air Compressor is designed to start 12V vehicles and inflate tires.

What should users do before using the VTOMAN X7 Jump Starter?

Users should read the user manual thoroughly and ensure the device is fully charged using the provided 18W wall charger and Type-C cable.

What are the components and functions of the VTOMAN X7 Jump Starter?

The components include pressure adjustment, power switch/inflating pump starting button, LED display screen, air inflating port, LED flashlight, output ports, input port, and automobile starting port.

What is the peak starting current of the VTOMAN X7 Jump Starter?

The VTOMAN X7 Jump Starter has a peak starting current of 4250A.

How many times can the VTOMAN X7 Jump Starter start a vehicle on a single charge?

The VTOMAN X7 Jump Starter can start all 12V vehicles up to 70 times on a single charge.

What is the function of the intelligent digital tire inflator feature in the VTOMAN X7 Jump Starter?

The intelligent digital tire inflator allows users to monitor tire pressure and adjust inflation modes conveniently. It supports three optional units (PSI, BAR, KPA) and can inflate a typical car tire to 20 PSI in about 2 minutes.

How does the VTOMAN X7 Jump Starter ensure user safety during operation?

The VTOMAN X7 Jump Starter is equipped with 10 built-in safety protection technologies, including protection against over-charge, over-current, short-circuit, reverse-polarity, low-temp, high-temp, over-voltage, over-load, spark-proof, and reverse-charge.

What is the unique thermal design feature of the VTOMAN X7 Jump Starter?

The VTOMAN X7 Jump Starter features a honeycomb heat dissipation design, enhancing safety performance by 30% and extending its service life by 50%.

Apart from jump-starting and inflating tires, what other functions does the VTOMAN X7 Jump Starter offer?

The VTOMAN X7 Jump Starter functions as a power bank, LED flashlight, and supports 18W Type-C fast charging.

What accessories are included with the VTOMAN X7 Jump Starter?

The VTOMAN X7 Jump Starter comes with a wall charger, smart jumper cable, USB-A to USB-C cable, carrying bag, pump tube, air nozzles, and a user manual.

How long does it take to fully charge the VTOMAN X7 Jump Starter?

It takes around 7 hours to fully charge the VTOMAN X7 Jump Starter.

What is the operating temperature range of the VTOMAN X7 Jump Starter?

The VTOMAN X7 Jump Starter operates within a temperature range of -4°F to 140°F.

How can users troubleshoot if the VTOMAN X7 Jump Starter does not react when the switch button is

pressed?

Users should insert the charging plug into the 5V input port to activate it, as the low-voltage protection function may have been triggered due to excessively low voltage.

Video- VTOMAN X7 Jump Starter Air Compressor



[Download this Manual: p7011an v71 cards, 282a/08 ATCOM Air-Compressor Manual Air-Compressor.mp4](#)

References

- User Manual

[Manuals+](#), [Privacy Policy](#)

This website is an independent publication and is neither affiliated with nor endorsed by any of the trademark owners. The "Bluetooth®" word mark and logos are registered trademarks owned by Bluetooth SIG, Inc. The "Wi-Fi®" word mark and logos are registered trademarks owned by the Wi-Fi Alliance. Any use of these marks on this website does not imply any affiliation with or endorsement.