

VTECH
80-506000
PUSH
&
POP
BULLDOZER



VTech 80-506000 Push & Pop Bulldozer User's Guide

[Home](#) » [vtech](#) » VTech 80-506000 Push & Pop Bulldozer User's Guide 

Contents

- 1 VTech 80-506000 Push & Pop Bulldozer
- 2 INTRODUCTION
- 3 GETTING STARTED
- 4 ASSEMBLY INSTRUCTIONS
- 5 PRODUCT FEATURES
- 6 ACTIVITIES
- 7 SONG LIST
- 8 MELODY LIST
- 9 CARE & MAINTENANCE
- 10 TROUBLESHOOTING
- 11 PRODUCT WARRANTY
- 12 FREQUENTLY ASKED QUESTIONS
- 13 VIDEO – PRODUCT OVERVIEW
- 14 References
- 15 Related Posts



VTech 80-506000 Push & Pop Bulldozer



INTRODUCTION

Thank you for purchasing the VTech® Pop-a-Balls™ Push & Pop Bulldozer™. The bulldozer comes to life when the colorful balls are dropped into the cab of the bulldozer. Load the balls and push the bulldozer to see the balls pop up through the smoke stack, into the scoop bucket and back again.

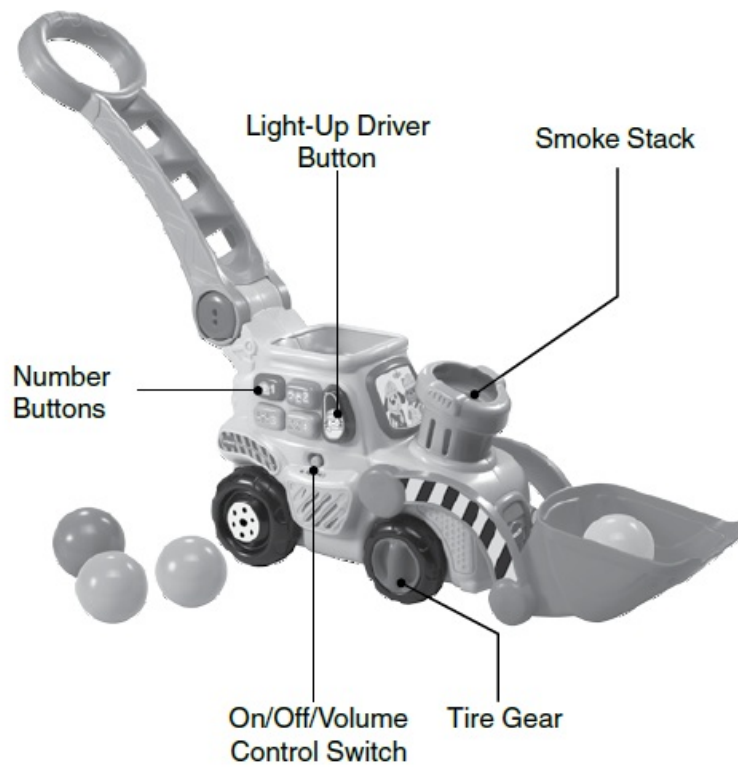

INCLUDED IN THIS PACKAGE

- One Push & Pop Bulldozer™
- Four balls
- One handle
- Two large plugs

• One Push & Pop Bulldozer™ • Four balls

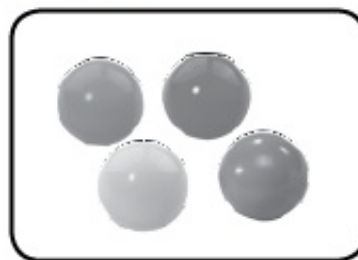

• One handle



• Two large plugs



- Four small screws
- One parent's guide

WARNING: All packing materials, such as tape, plastic sheets, packaging locks, removable tags, cable ties and packaging screws are not part of this toy, and should be discarded for your child's safety.

NOTE: Please keep this parent's guide as it contains important information.

Unlock the packaging locks:

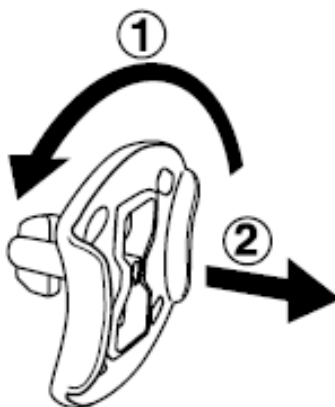

1. Rotate the packaging locks 90 degrees counter-clockwise.
2. Pull out the packaging locks.

GETTING STARTED

BATTERY INSTALLATION

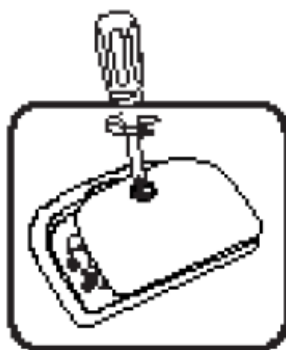

1. Make sure the unit is turned OFF.
2. Locate the battery cover on the back of the bulldozer. Use a screwdriver to loosen the screw.
3. Install 2 new AAA (AM-4/LR03) batteries following the diagram inside the battery box. (The use of new alkaline batteries is recommended for maximum performance.)
4. Replace the battery cover and tighten the screw to secure it.

BATTERY NOTICE

- Use new alkaline batteries for maximum performance.
- Use only batteries of the same or equivalent type as recommended.
- Do not mix different types of batteries: alkaline, standard (carbon-zinc) or rechargeable, or new and used batteries.
- Do not use damaged batteries.
- Insert batteries with the correct polarity.

- Do not short-circuit the battery terminals.
- Remove exhausted batteries from the toy.
- Remove batteries during long periods of non-use.
- Do not dispose of batteries in fire.
- Do not charge non-rechargeable batteries.
- Remove rechargeable batteries from the toy before charging (if removable).
- Rechargeable batteries are only to be charged under adult supervision.



ASSEMBLY INSTRUCTIONS

With the Push & Pop Bulldozer™, safety comes first. To ensure your child's safety, adult assembly is required.

- Place the handle over the slot on the bulldozer, making sure that the recessed ball storage slots on the handle are facing up. Place the two large plugs in the holes on either side of the handle. Using a screwdriver, secure two small screws into each of the large plugs.



PRODUCT FEATURES

1. **On/Off/Volume Control Switch** To turn the unit ON, slide the On/Off/ Volume Control Switch to the Low Volume () or High Volume () position. You will hear a song and a welcoming phrase. To turn the unit OFF, slide the On/Off/ Volume Control Switch to the OFF () position.

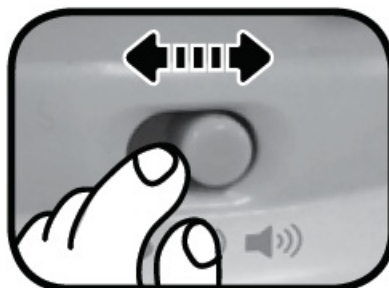

2. **Automatic Shut-Off** To preserve battery life, the Push & Pop Bulldozer™ will automatically power down after approximately 30 seconds without input. The unit can be turned on again by pressing any button or twisting the tire gear.

NOTE: If the unit repeatedly powers down, we suggest changing the batteries.

ACTIVITIES

1. **Light-Up Driver Button**

Press the Light-Up Driver Button to hear a variety of playful phrases, songs, sounds, and short tunes. The light will flash with the sounds.

2. Number Buttons

Press the Number Buttons to learn about numbers, colors, and construction objects, and hear playful music and sounds. The light will flash with the sounds.

3. Bulldozer Cab

Drop the colorful balls into the Bulldozer Cab, then push the bulldozer forward to see the scoop bucket move up and down and the balls pop out of the Smoke Stack. The balls will be counted as they pop out of the Smoke Stack. The light will flash with the sounds.

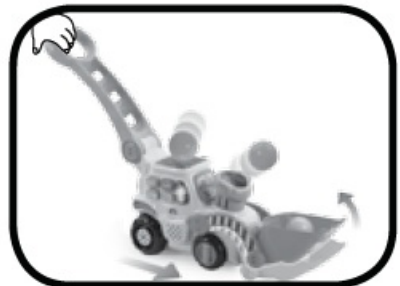

4. Smoke Stack

Drop a ball into the Smoke Stack to hear fun sounds. The light will flash with the sounds.

5. Tire Gear

Twist the Tire Gear to the left then release to manually pop the balls out of the Smoke Stack. You will hear a variety of fun sounds or a short tune. The light will flash with the sounds.

Note: Please avoid inserting feet and arms into the bulldozer cab and smoke stack. When there is only one ball left in the smokestack, you will need to use the tire gear to pop the ball out or add more balls to the bulldozer cab and push the bulldozer.

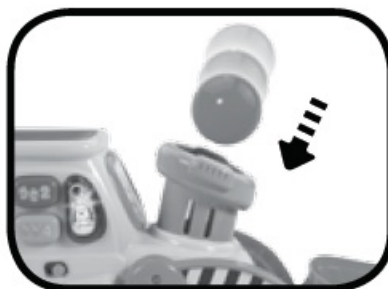

SONG LIST

SONG 1

- I've been working in my bulldozer,

- All the live long day.
- I've been working in my bulldozer,
- Scooping the balls away.

SONG 2

- Scoop, scoop, scoop the balls.
- Clear them off the ground.
- One, two, three, four,
- How many have you found?

SONG 3

- Scooping up, and cleaning the site.
- Every single day and night!

MELODY LIST

1. I've Been Working on the Railroad
2. Row, Row, Row Your Boat
3. Swing Low, Sweet Chariot
4. Turkey in the Straw
5. When the Saints Go Marching In
6. One Man Went to Mow a Meadow
7. Yankee Doodle
8. Blow the Man Down
9. BINGO
10. The Wheels on the Bus

CARE & MAINTENANCE

1. Keep the unit clean by wiping it with a slightly damp cloth.
2. Keep the unit out of direct sunlight and away from any direct heat source.
3. Remove the batteries when the unit will not be in use for an extended period of time.
4. Do not drop the unit on hard surfaces and do not expose the unit to moisture or water.

TROUBLESHOOTING

If for some reason the program/activity stops working or malfunctions, please follow these steps:

1. Please turn the unit OFF.
2. Interrupt the power supply by removing the batteries.
3. Let the unit stand for a few minutes, then replace the batteries.
4. Turn the unit ON. The unit should now be ready to play again.

5. If the product still does not work, replace it with a new set of batteries.

If the problem persists, please call our Consumer Services Department at 1-[800-521-2010](tel:800-521-2010) in the U.S. or 1-[877-352-8697](tel:877-352-8697) in Canada, and a service representative will be happy to help you.

For information on this product's warranty, please call our Consumer Services Department at 1-[800-521-2010](tel:800-521-2010) in the U.S. or 1-[877-352-8697](tel:877-352-8697) in Canada.

IMPORTANT NOTE: Creating and developing Infant Learning products is accompanied by a responsibility that we at VTech® take very seriously. We make every effort to ensure the accuracy of the information, which forms the value of our products. However, errors sometimes can occur. It is important for you to know that we stand behind our products and encourage you to call our Consumer Services Department at 1-[800-521-2010](tel:800-521-2010) in the U.S., or 1-[877-352-8697](tel:877-352-8697) in Canada, with any problems and/or suggestions that you might have. A service representative will be happy to help you.

NOTE:

This equipment has been tested and found to comply with the limits for a Class B digital device, pursuant to Part 15 of the FCC Rules. These limits are designed to provide reasonable protection against harmful interference in a residential installation. This equipment generates, uses and can radiate radio frequency energy and, if not installed and used in accordance with the instructions, may cause harmful interference to radio communications. However, there is no guarantee that interference will not occur in a particular installation. If this equipment does cause harmful interference to radio or television reception, which can be determined by turning the equipment off and on, the user is encouraged to try to correct the interference by one or more of the following measures:

- Reorient or relocate the receiving antenna.
- Increase the separation between the equipment and receiver.
- Connect the equipment into an outlet on a circuit different from that to which the receiver is connected.
- Consult the dealer or an experienced radio/TV technician for help.

THIS DEVICE COMPLIES WITH PART 15 OF THE FCC RULES. OPERATION IS SUBJECT TO THE FOLLOWING TWO CONDITIONS:

1. THIS DEVICE MAY NOT CAUSE HARMFUL INTERFERENCE, AND
2. THIS DEVICE MUST ACCEPT ANY INTERFERENCE RECEIVED, INCLUDING INTERFERENCE THAT MAY CAUSE UNDESIRE OPERATION.

CAN ICES-3 (B)/NMB-3(B)

Caution: changes or modifications not expressly approved by the party responsible for compliance could void the user's authority to operate the equipment.



CAUTION: Adult assembly required. This package contains small screws. For your child's safety, do not let your child play with the toy until it is fully assembled.

PRODUCT WARRANTY

- This Warranty is applicable only to the original purchaser, is non-transferable, and applies only to "VTech" products or parts. This product is covered by a 3-month Warranty from the original purchase date, under normal

use and service, against defective workmanship and materials. This Warranty does not apply to (a) consumable parts, such as batteries; (b) cosmetic damage, including but not limited to scratches and dents; (c) damage caused by use with non-VTech products; (d) damage caused by accident, misuse, unreasonable use, immersion in water, neglect, abuse, battery leakage, or improper installation, improper service, or other external causes; (e) damage caused by operating the product outside the permitted or intended uses described by VTech in the owner's manual; (f) a product or part that has been modified (g) defects caused by normal wear and tear or otherwise due to the normal aging of the product; or (h) if any VTech serial number has been removed or defaced.

- Prior to returning a product for any reason, please notify the VTech Consumer Services Department, by sending an email to vtechkids@vtechkids.com or calling 1-800-521-2010. If the service representative is unable to resolve the issue, you will be provided instructions on how to return the product and have it replaced under Warranty. Return of the product under Warranty must adhere to the following rules:
- If VTech believes that there may be a defect in the materials or workmanship of the product and can confirm the purchase date and location of the product, we will at our discretion replace the product with a new unit or product of comparable value. A replacement product or parts assumes the remaining Warranty of the original product or 30 days from the date of replacement, whichever provides longer coverage.
- THIS WARRANTY AND THE REMEDIES SET FORTH ABOVE ARE EXCLUSIVE AND IN LIEU OF ALL OTHER WARRANTIES, REMEDIES AND CONDITIONS, WHETHER ORAL, WRITTEN, STATUTORY, EXPRESS OR IMPLIED. IF VTECH CANNOT LAWFULLY DISCLAIM STATUTORY OR IMPLIED WARRANTIES THEN TO THE EXTENT PERMITTED BY LAW, ALL SUCH WARRANTIES SHALL BE LIMITED TO THE DURATION OF THE EXPRESS WARRANTY AND TO THE REPLACEMENT SERVICE AS DETERMINED BY VTECH IN ITS SOLE DISCRETION.
- To the extent permitted by law, VTech will not be responsible for direct, special, incidental or consequential damages resulting from any breach of Warranty.
- This Warranty is not intended to persons or entities outside the United States of America. Any disputes resulting from this Warranty shall be subject to the final and conclusive determination of VTech.

To register your product online at www.vtechkids.com/warranty

FREQUENTLY ASKED QUESTIONS

What are the dimensions of the VTech 80-506000 Push & Pop Bulldozer?

The dimensions of the VTech 80-506000 Push & Pop Bulldozer are 6.18 x 6.18 x 6.3 inches.

What is the weight of the VTech 80-506000 Push & Pop Bulldozer?

The VTech 80-506000 Push & Pop Bulldozer weighs 2.48 pounds.

How many batteries does the VTech 80-506000 Push & Pop Bulldozer require?

The VTech 80-506000 Push & Pop Bulldozer requires 2 AAA batteries.

What is the item model number of the VTech 80-506000 Push & Pop Bulldozer?

The item model number of the VTech 80-506000 Push & Pop Bulldozer is 80-506000.

Who is the manufacturer of the VTech 80-506000 Push & Pop Bulldozer?

VTech is the manufacturer of the VTech 80-506000 Push & Pop Bulldozer.

Does the VTech 80-506000 Push & Pop Bulldozer come with a warranty?

VTech 80-506000 Push & Pop Bulldozer comes with a 3-month warranty.

What age range is the VTech 80-506000 Push & Pop Bulldozer suitable for?

The VTech 80-506000 Push & Pop Bulldozer is suitable for toddlers and young children.

What should I do if my VTech 80-506000 Push & Pop Bulldozer is not popping the balls correctly?

Ensure that the bulldozer is pushed firmly and smoothly on a flat surface. Sometimes debris or small objects can hinder the popping mechanism.

My VTech 80-506000 Push & Pop Bulldozer's wheels are not moving smoothly. How can I fix this?

Check if there is any dirt or debris stuck in the wheels. Clean the wheels and axles gently with a damp cloth to ensure smooth movement.

Why is my VTech 80-506000 Push & Pop Bulldozer making unusual noises during operation?

The noises could be due to friction from dirt or misaligned parts. Clean the toy and ensure all parts are properly aligned and secured.

The balls on my VTech 80-506000 Push & Pop Bulldozer are not popping out evenly. What could be the issue?

This may happen if the bulldozer is not pushed evenly or if there is an obstruction in the popping mechanism. Check for any blockages and ensure even pressure when pushing.

My VTech 80-506000 Push & Pop Bulldozer's handle is loose. How can I tighten it?

Check the assembly of the handle and tighten any screws or bolts that may have come loose during play. Avoid over-tightening to prevent damage.

Why is my VTech 80-506000 Push & Pop Bulldozer not moving forward smoothly?

Inspect the wheels and axles for debris or obstruction. Clean and ensure all parts are free from dirt that may hinder movement.

VIDEO – PRODUCT OVERVIEW



DOWNLOAD THE PDF LINK [Vtech 80-506000 Push & Pop Bulldozer User's Guide](#)
[Bulldozer-Users-Guide.mp4](#)

REFERENCE: [VTech 80-506000 Push & Pop Bulldozer User’s Guide-Device.Report](#)

References

- [User Manual](#)

[Manuals+](#), [Privacy Policy](#)

This website is an independent publication and is neither affiliated with nor endorsed by any of the trademark owners. The "Bluetooth®" word mark and logos are registered trademarks owned by Bluetooth SIG, Inc. The "Wi-Fi®" word mark and logos are registered trademarks owned by the Wi-Fi Alliance. Any use of these marks on this website does not imply any affiliation with or endorsement.