

VTECH 80-150309
CLICK AND COUNT REMOTE
USER'S MANUAL



VTech 80-150309 Click and Count Remote User's Manual

[Home](#) » [vtech](#) » VTech 80-150309 Click and Count Remote User's Manual 

Contents

- 1 VTech 80-150309 Click and Count Remote
- 2 INTRODUCTION
- 3 GETTING STARTED
- 4 PRODUCT FEATURES
- 5 ACTIVITIES
- 6 CARE & MAINTENANCE
- 7 TROUBLESHOOTING
- 8 PRODUCT WARRANTY
- 9 FREQUENTLY ASKED QUESTIONS
- 10 VIDEO – PRODUCT OVERVIEW
- 11 References
- 12 Related Posts



VTech 80-150309 Click and Count Remote



Dear Parent,

Ever notice the look on your baby's face when they learn something new through their own discovery? These self-accomplished moments are a parent's greatest reward. To help fulfill them, VTech® created the Infant Learning® series of toys.

These unique interactive learning toys directly respond to what children do naturally – play! Using innovative technology, these toys react to baby's interactions, making each play experience fun and unique as they learn age-appropriate concepts like first words, numbers, shapes, colors and music. More importantly, VTech®'s Infant Learning® toys develop babies' mental and physical abilities by inspiring, engaging, and teaching.

At VTech®, we know that a child has the ability to do great things. That's why all of our electronic learning products are uniquely designed to develop a child's mind and allow them to learn to the best of their ability. We thank you for trusting VTech® with the important job of helping your child learn and grow!

Sincerely,

Your friends at VTech®

To learn more about VTech® toys, visit vtechkids.com

INTRODUCTION

The Click & Count Remote™ by VTech® looks just like mom and Dad's remote control! It has songs and melodies for sing-along fun and pretend channels to keep your child entertained. Press the buttons for a fun channel-changing role-play while learning numbers, colors, and shapes.

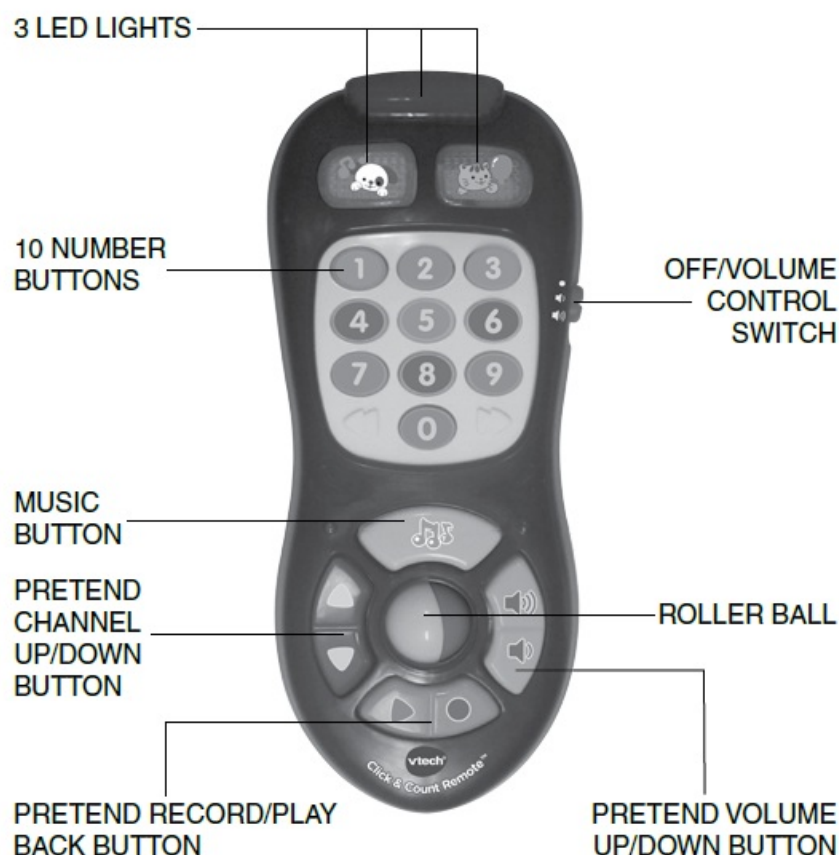

INCLUDED IN THIS PACKAGE

- One VTech® Click & Count Remote™ learning toy
- One user's manual

WARNING: All packing materials, such as tape, plastic sheets, packaging locks, and tags are not part of this toy, and should be discarded for your child's safety.

NOTE: Please keep this instruction manual as it contains important information.

GETTING STARTED

BATTERY INSTALLATION

1. Make sure the unit is turned OFF.
2. Locate the battery cover on the back of the Click & Count Remote™. Use a coin or a screwdriver to loosen the screw.
3. Install 2 new 'AAA' (LR03/AM-4) batteries following the diagram inside the battery box. (The use of new alkaline batteries is recommended for maximum performance.)

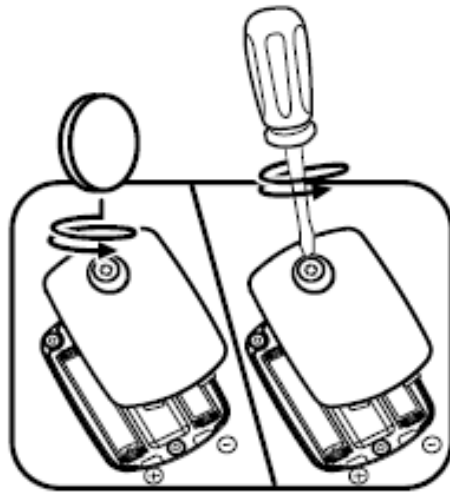



4. Replace the battery cover and tighten the screw to secure it.

BATTERY NOTICE

- Use new alkaline batteries for maximum performance.
- Use only batteries of the same or equivalent type as recommended.
- Do not mix different types of batteries: alkaline, standard (carbonzinc) or rechargeable (Ni-Cd, Ni-MH), or new and used batteries.
- Do not use damaged batteries.
- Insert batteries with the correct polarity.
- Do not short-circuit the battery terminals.
- Remove exhausted batteries from the toy.
- Remove batteries during long periods of non-use.
- Do not dispose of batteries in a fire.
- Do not charge non-rechargeable batteries.
- Remove rechargeable batteries from the toy before charging (if removable).
- Rechargeable batteries are only to be charged under adult supervision.

PRODUCT FEATURES

1. OFF/VOLUME CONTROL SWITCH

To turn the unit ON, slide the OFF/ VOLUME CONTROL SWITCH to the low volume () or high volume () position. To turn the unit OFF, slide the OFF/VOLUME CONTROL SWITCH to the OFF () position.

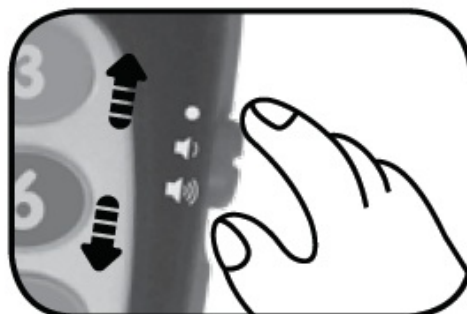

2. SMART REMOTE DESIGN

The Click & Count Remote™ resembles a modern-day remote control. Its different buttons simulate fun activities like changing channels, watching different programs, using a DVR, and more.

3. AUTOMATIC SHUT-OFF

To preserve battery life, the VTech® Click & Count Remote™ will automatically power-down after approximately 60 seconds without input. The unit can be turned on again by pressing any button.

ACTIVITIES

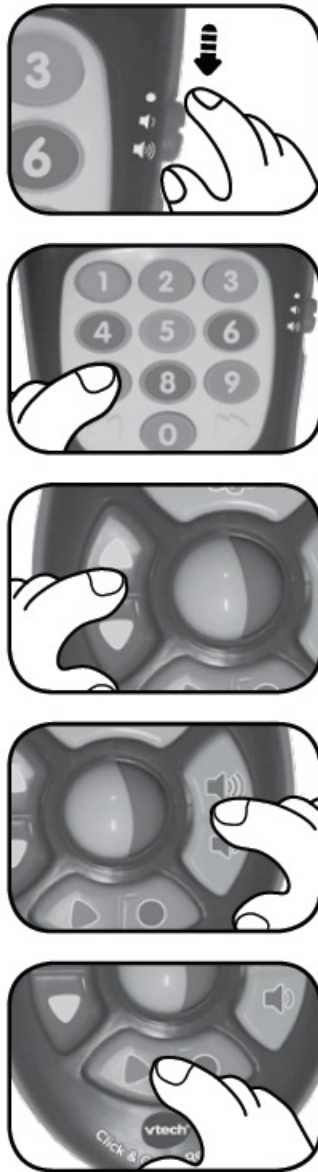

1. Slide the OFF/VOLUME CONTROL SWITCH to the low or high volume position to turn the unit on. You will hear fun sounds and an entertaining sing-along song. The lights will flash along with the sounds.
2. Press the NUMBER BUTTONS to hear fun sounds, short tunes, singalong songs or talking phrases about numbers, colors, and pretend channels.
3. Press the PRETEND CHANNEL UP/DOWN BUTTON to hear fun sounds and to change to one of the fun pretend channels. The light will flash with the sounds.
4. Press the PRETEND VOLUME UP/DOWN BUTTON to hear fun sounds and to learn about loud volume and quiet volume. The light will flash with the sounds. If the PRETEND VOLUME UP/DOWN BUTTON is pressed while a melody is playing, it will alter the volume of the melody.
5. Press the PRETEND RECORD/PLAY BACK BUTTON to hear fun sounds and talking phrases, and to learn about colors and shapes.
6. Press the MUSIC BUTTON to hear fun sing-along songs and lively melodies. The lights will flash along with the

sounds.

7. Press and roll the ROLLER BALL to hear fun sounds. The lights will flash along with the sounds.

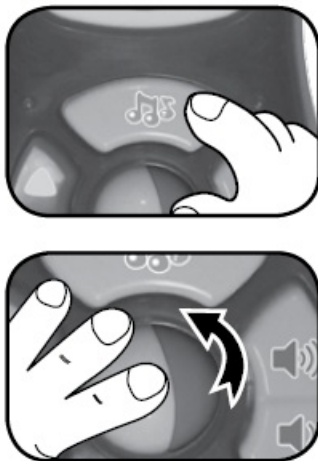

MELODY LIST:

1. Camptown Races
2. My Bonnie Lies Over the Ocean
3. Take Me Out to the Ball Game
4. Clementine
5. I've Been Working on the Railroad

SUNG SONG LYRICS

• SONG 1

- Gather 'round to pretend
- Time to enjoy TV shows with some friends!

• SONG 2

- 1-2-3-4-5, So many fun channels to watch live,
- 6-7-8-9, So many to watch, so little time!

CARE & MAINTENANCE

1. Keep the unit clean by wiping it with a slightly damp cloth.
2. Keep the unit out of direct sunlight and away from any direct heat source.
3. Remove the batteries when the unit will not be in use for an extended period of time.
4. Do not drop the unit on hard surfaces and do not expose the unit to moisture or water.

TROUBLESHOOTING

If for some reason the program/activity stops working or malfunctions, please follow these steps:

1. Please turn the unit OFF.
2. Interrupt the power supply by removing the batteries.

3. Let the unit stand for a few minutes, then replace the batteries.
4. Turn the unit ON. The unit should now be ready to play again.
5. If the product still does not work, replace it with a new set of batteries.

If the problem persists, please call our Consumer Services Department at 1-[800-521-2010](tel:800-521-2010) in the U.S. or 1-[877-352-8697](tel:877-352-8697) in Canada, and a service representative will be happy to help you.

For information on this product's warranty, please call our Consumer Services Department at 1-[800-521-2010](tel:800-521-2010) in the U.S. or 1-[877-352-8697](tel:877-352-8697) in Canada.

IMPORTANT NOTE: Creating and developing Infant Learning products is accompanied by a responsibility that we at VTech® take very seriously. We make every effort to ensure the accuracy of the information, which forms the value of our products. However, errors sometimes can occur. It is important for you to know that we stand behind our products and encourage you to call our Consumer Services Department at 1-[800-521-2010](tel:800-521-2010) in the U.S., or 1-[877-352-8697](tel:877-352-8697) in Canada, with any problems and/or suggestions that you might have. A service representative will be happy to help you.

NOTE:

This equipment has been tested and found to comply with the limits for a Class B digital device, pursuant to Part 15 of the FCC Rules. These limits are designed to provide reasonable protection against harmful interference in a residential installation. This equipment generates, uses and can radiate radio frequency energy and, if not installed and used in accordance with the instructions, may cause harmful interference to radio communications. However, there is no guarantee that interference will not occur in a particular installation. If this equipment does cause harmful interference to radio or television reception, which can be determined by turning the equipment off and on, the user is encouraged to try to correct the interference by one or more of the following measures:

- Reorient or relocate the receiving antenna.
- Increase the separation between the equipment and receiver.
- Connect the equipment into an outlet on a circuit different from that to which the receiver is connected.
- Consult the dealer or an experienced radio/TV technician for help.

THIS DEVICE COMPLIES WITH PART 15 OF THE FCC RULES. OPERATION IS SUBJECT TO THE FOLLOWING TWO CONDITIONS:

1. THIS DEVICE MAY NOT CAUSE HARMFUL INTERFERENCE, AND
2. THIS DEVICE MUST ACCEPT ANY INTERFERENCE RECEIVED, INCLUDING INTERFERENCE THAT MAY CAUSE UNDESIRE OPERATION.

CAN ICES-3 (B)/NMB-3(B)

Caution: changes or modifications not expressly approved by the party responsible for compliance could void the user's authority to operate the equipment.

PRODUCT WARRANTY

- This Warranty is applicable only to the original purchaser, is non-transferable and applies only to "VTech" products or parts. This product is covered by a 3-month Warranty from the original purchase date, under normal use and service, against defective workmanship and materials. This Warranty does not apply to (a) consumable

parts, such as batteries; (b) cosmetic damage, including but not limited to scratches and dents; (c) damage caused by use with non-VTech products; (d) damage caused by accident, misuse, unreasonable use, immersion in water, neglect, abuse, battery leakage, or improper installation, improper service, or other external causes; (e) damage caused by operating the product outside the permitted or intended uses described by VTech in the owner's manual; (f) a product or part that has been modified (g) defects caused by normal wear and tear or otherwise due to the normal aging of the product; or (h) if any VTech serial number has been removed or defaced.

- Prior to returning a product for any reason, please notify the VTech Consumer Services Department, by sending an email to vtechkids@vtechkids.com or calling 1-[800-521-2010](tel:800-521-2010). If the service representative is unable to resolve the issue, you will be provided instructions on how to return the product and have it replaced under Warranty. Return of the product under Warranty must adhere to the following rules:
- If VTech believes that there may be a defect in the materials or workmanship of the product and can confirm the purchase data and location of the product, we will at our discretion replace the product with a new unit or product of comparable value. A replacement product or parts assumes the remaining Warranty of the original product or 30 days from the date of replacement, whichever provides longer coverage.
- THIS WARRANTY AND THE REMEDIES SET FORTH ABOVE ARE EXCLUSIVE AND IN LIEU OF ALL OTHER WARRANTIES, REMEDIES AND CONDITIONS, WHETHER ORAL, WRITTEN, STATUTORY, EXPRESS OR IMPLIED. IF VTECH CANNOT LAWFULLY DISCLAIM STATUTORY OR IMPLIED WARRANTIES THEN TO THE EXTENT PERMITTED BY LAW, ALL SUCH WARRANTIES SHALL BE LIMITED TO THE DURATION OF THE EXPRESS WARRANTY AND TO THE REPLACEMENT SERVICE AS DETERMINED BY VTECH IN ITS SOLE DISCRETION.
- To the extent permitted by law, VTech will not be responsible for direct, special, incidental or consequential damages resulting from any breach of Warranty.
- This Warranty is not intended to persons or entities outside the United States of America. Any disputes resulting from this Warranty shall be subject to the final and conclusive determination of VTech .

To register your product online at www.vtechkids.com/warranty

FREQUENTLY ASKED QUESTIONS

What age group is the VTech 80-150309 Click and Count Remote suitable for?

The VTech 80-150309 Click and Count Remote is suitable for toddlers aged around 6 months to 3 years old.

What are the dimensions and weight of the VTech 80-150309 Click and Count Remote?

The VTech 80-150309 Click and Count Remote measures 2.95 x 6.69 x 0.1 inches and weighs 5.4 ounces, making it lightweight and easy for toddlers to handle.

Where can I purchase the VTech 80-150309 Click and Count Remote?

You can purchase the VTech 80-150309 Click and Count Remote from major retailers, online marketplaces, and the VTech website, priced at approximately \$9.96.

Why is my VTech 80-150309 Click and Count Remote not turning on?

Ensure that the batteries are inserted correctly and that they are not depleted. Try replacing the batteries with new ones and make sure they are properly aligned according to the polarity (+ and -) markings.

The sounds on my VTech 80-150309 Click and Count Remote are distorted or unclear. What should I do?

Check the batteries to ensure they are fully charged and replace them if necessary. Also, inspect the speaker for any debris or obstruction that might be affecting the sound quality.

Why does my VTech 80-150309 Click and Count Remote turn off unexpectedly?

This could be due to low battery power. Replace the batteries with new ones. If the issue persists, check for any signs of damage to the battery compartment or internal components.

The buttons on my VTech 80-150309 Click and Count Remote are not responding. What should I do?

Ensure that the buttons are not stuck and that there is no debris underneath them. Try gently pressing each button to see if it loosens. If the problem continues, the internal circuitry might need inspection by a professional.

How do I clean my VTech 80-150309 Click and Count Remote?

Use a soft, damp cloth to wipe the surface of the remote. Avoid using any harsh chemicals or submerging the remote in water. For any stubborn dirt, a mild soap solution can be used on the cloth.

Why is the volume on my VTech 80-150309 Click and Count Remote too low?

Check if the volume control is set to a low level and adjust it accordingly. Ensure that the batteries are fully charged as low battery power can affect volume output.

The lights on my VTech 80-150309 Click and Count Remote are not working. How can I fix this?

Replace the batteries to see if that resolves the issue. If the lights still do not work, there may be an issue with the internal LED components, which would require professional repair or replacement.

Why is my VTech 80-150309 Click and Count Remote not making any sounds?

Ensure the volume is turned up and that the batteries are properly installed and fully charged. If the remote still doesn't make sounds, check if the sound output is obstructed or damaged.

The VTech 80-150309 Click and Count Remote seems to drain batteries quickly. What should I do?

Ensure you are using fresh, high-quality batteries. If the issue persists, check for any signs of a short circuit or other internal issues that could be causing excessive power consumption.

My child accidentally dropped the VTech 80-150309 Click and Count Remote, and it stopped working. What can I do?

Inspect the remote for any visible damage. Replace the batteries to see if it resumes working. If the remote still does not function, there may be internal damage that requires professional repair or replacement.

VIDEO – PRODUCT OVERVIEW



[Download the PDF link: Vtech 80-150309 Click and Count Remote Users Manual](#)
[Count-Remote-Users-Manual.mp4](#)

References

- [User Manual](#)

[Manuals+](#), [Privacy Policy](#)

This website is an independent publication and is neither affiliated with nor endorsed by any of the trademark owners. The "Bluetooth®" word mark and logos are registered trademarks owned by Bluetooth SIG, Inc. The "Wi-Fi®" word mark and logos are registered trademarks owned by the Wi-Fi Alliance. Any use of these marks on this website does not imply any affiliation with or endorsement.