

  
80-142000  
3-IN-1  
RACE  
AND  
LEARN



## VTech 80-142000 3-in-1 Race and Learn User's Manual

[Home](#) » [vtech](#) » VTech 80-142000 3-in-1 Race and Learn User's Manual 

### Contents

- [1 VTech 80-142000 3-in-1 Race and Learn](#)
- [2 INTRODUCTION](#)
- [3 GETTING STARTED](#)
- [4 PRODUCT FEATURES](#)
- [5 ACTIVITIES](#)
- [6 CARE & MAINTENANCE](#)
- [7 TROUBLESHOOTING](#)
- [8 PRODUCT WARRANTY](#)
- [9 FREQUENTLY ASKED QUESTIONS](#)
- [10 VIDEO – PRODUCT OVERVIEW](#)
- [11 References](#)
- [12 Related Posts](#)



**VTech 80-142000 3-in-1 Race and Learn**



## INTRODUCTION

Thank you for purchasing the VTech® 3-in-1 Race & Learn™! Exciting missions await with the 3-In-1 Race & Learn™! Easily switch from car to motorcycle or jet and take off on a fun learning journey. Along the way, your child will learn letters, phonics, spelling, counting, shapes and more. Realistic sounds, lights, controls, and a special vibration effect create the feeling of a real driving experience!

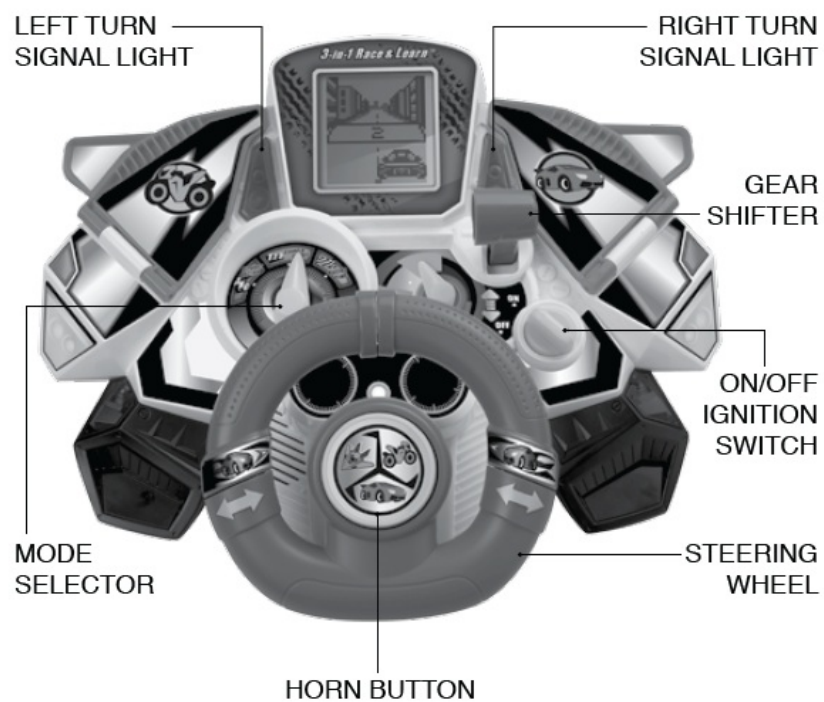

**TRANSFORM THE STEERING WHEEL INTO 3 DIFFERENT STYLES.**



**To transform into Car, Motorcycle, or Jet.**

**1. Car Mode:**

Turn the left and right steering wheel handles toward the center until they click into place. Flip up the left and right wing section if they are currently in Jet Mode. (Note: When the steering wheel is placed in this position the game will automatically enter Car Mode.)

**2. Jet Mode:**

Turn the left and right steering wheel handles up until they click into place. Flip down the left and right wing sections. (Note: When the steering wheel is placed in this position the game will automatically enter Jet Mode.)

**3. Motorcycle Mode:**

Turn the left and right steering wheel handles outward until they click into place. Flip up the left and right wing section if they are currently in Jet Mode. (Note: When the steering wheel is placed in this position the game will automatically enter Motorcycle Mode.)



**INCLUDED IN THIS PACKAGE**

- One VTech® 3-in-1 Race & Learn™
- One user's manual

**WARNING:** All packing materials, such as tape, plastic sheets, packaging locks and tags are not part of this toy, and should be discarded for your child's safety.

**NOTE:** Please keep instruction manual as it contains important information.

**Unlock the packaging locks:**

1. Rotate the packaging locks 90 degrees counter-clockwise.
2. Pull out the packaging lock.

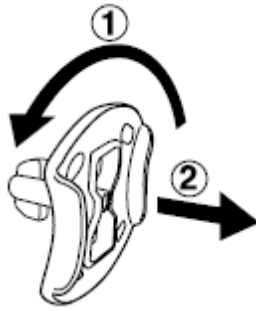

## GETTING STARTED

### BATTERY INSTALLATION

1. Make sure the unit is OFF.
2. Locate the battery cover on the bottom of the unit. Install 3 new “AA” (AM-3/LR6) batteries into the compartment as illustrated. (The use of new, alkaline batteries is recommended for maximum performance.)
3. Replace the battery cover.

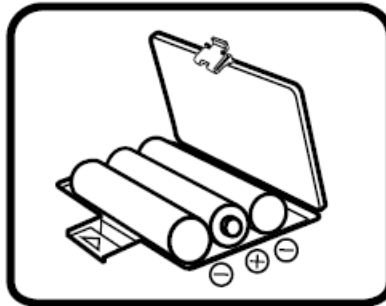

### BATTERY NOTICE

- Use new alkaline batteries for maximum performance.
- Use only batteries of the same or equivalent type as recommended.
- Do not mix different types of batteries: alkaline, standard (carbon-zinc) or rechargeable (Ni-Cd, Ni-MH), or new and used batteries.
- Do not use damaged batteries.
- Insert batteries with the correct polarity.
- Do not short-circuit the battery terminals.
- Remove exhausted batteries from the toy.
- Remove batteries during long periods of non-use.
- Do not dispose of batteries in fire.
- Do not charge non-rechargeable batteries.
- Remove rechargeable batteries from the toy before charging (if removable).
- Rechargeable batteries are only to be charged under adult supervision.

## PRODUCT FEATURES

### 1. ON /OFF IGNITION SWITCH

Turn the ON/OFF IGNITION SWITCH from OFF to ON to turn the unit on. Turn the ON/ OFF IGNITION SWITCH from ON to OFF to turn the unit off.

## 2. **MODE SELECTOR**

Move the Mode Selector to enter different activities.

## 3. **GEAR SHIFTER**

Move the GEAR SHIFTER to hear real racing sounds.

**NOTE:** Moving the GEAR SHIFTER forward will also help you to pass other vehicles.

## 4. **HORN BUTTON**

Press the Horn button to hear fun sounds.

## 5. **STEERING WHEEL**

Turn the STEERING WHEEL left or right to move the car, motorcycle or jet left or right.

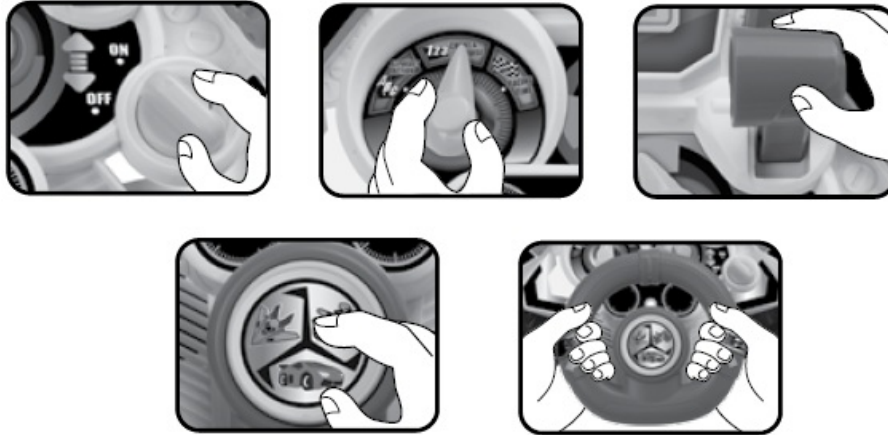

## 6. **VIBRATION EFFECT**

The unit will vibrate in response to different actions performed while driving or flying.

## 7. **VOLUME SWITCH**

Slide the VOLUME SWITCH on the back of the unit to adjust the volume. There are 3 volume levels available.

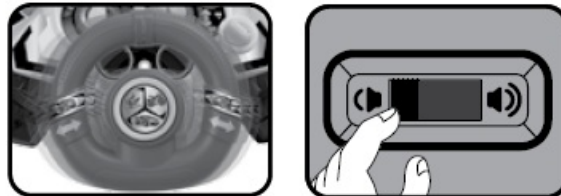

## 8. **automatic shut-off**

To preserve battery life, the VTech® 3-in-1 Race & Learn™ will automatically turn off after several minutes without input. The unit can be turned on again by transforming the Steering Wheel, or pressing the Horn Button, Mode Selector, Gear Shifter or On/Off Ignition Switch.

# **ACTIVITIES**

## **ALPHABET ACTION MODE**

### • **Car Mode**

Pass the letter checkpoints from A to Z as fast as you can while avoiding the obstacles in the road.

### • **Jet Mode**

Collect the missing letters to complete words while avoiding obstacles in the sky.

### • **Motorcycle Mode**

Listen for the instructions and drive through the capital or small letters while avoiding obstacles in the road.

## COUNT & CRUISE MODE

- **Car Mode**

Pass the number checkpoints from 1 to 20 as fast as you can while avoiding the obstacles in the road.

- **Jet Mode**

Collect the correct number of stars while avoiding obstacles in the sky.

- **Motorcycle Mode**

Collect the correct number of requested shapes as fast as you can while avoiding the obstacles in the road.

## RACING TIME MODE

- Test your skills in a racing mode against other cars, motorcycles, or jets. Watch out for obstacles along the way as you try to pass by your opponents and improve your rank. Your final rank will be shown at the end of each game.

## CARE & MAINTENANCE

1. Keep the unit clean by wiping it with a slightly damp cloth.
2. Keep the unit out of direct sunlight and away from any direct heat source.
3. Remove the batteries when the unit will not be in use for an extended period of time.
4. Do not drop the unit on hard surfaces and do not expose the unit to moisture or water.

## TROUBLESHOOTING

**If for some reason the program/activity stops working or malfunctions, please follow these steps:**

1. Please turn the unit OFF.
2. Interrupt the power supply by removing the batteries.
3. Let the unit stand for a few minutes, then replace the batteries.
4. Turn the unit ON. The unit should now be ready to play again.
5. If the product still does not work, replace it with a new set of batteries.

If the problem persists, please call our Consumer Services Department at 1-[800-521-2010](tel:800-521-2010) in the U.S. or 1-[877-352-8697](tel:877-352-8697) in Canada, and a service representative will be happy to help you.

For information on this product's warranty, please call our Consumer Services Department at 1-[800-521-2010](tel:800-521-2010) in the U.S. or 1-[877-352-8697](tel:877-352-8697) in Canada.

## IMPORTANT NOTE

Creating and developing Infant Learning products is accompanied by a responsibility that we at VTech® take very seriously. We make every effort to ensure the accuracy of the information, which forms the value of our products. However, errors sometimes can occur. It is important for you to know that we stand behind our products and encourage you to call our Consumer Services Department at 1-[800-521-2010](tel:800-521-2010) in the U.S., or 1-[877-352-8697](tel:877-352-8697) in Canada, with any problems and/or suggestions that you might have. A service representative will be happy to help you.



## NOTE

This equipment has been tested and found to comply with the limits for a Class B digital device, pursuant to Part 15 of the FCC Rules. These limits are designed to provide reasonable protection against harmful interference in a residential installation. This equipment generates, uses and can radiate radio frequency energy and, if not installed and used in accordance with the instructions, may cause harmful interference to radio communications. However, there is no guarantee that interference will not occur in a particular installation. If this equipment does cause harmful interference to radio or television reception, which can be determined by turning the equipment off and on, the user is encouraged to try to correct the interference by one or more of the following measures:

- Reorient or relocate the receiving antenna.
- Increase the separation between the equipment and the receiver.
- Connect the equipment to an outlet on a circuit different from that to which the receiver is connected.
- Consult the dealer or an experienced radio/TV technician for help.

## **THIS DEVICE COMPLIES WITH PART 15 OF THE FCC RULES. OPERATION IS SUBJECT TO THE FOLLOWING TWO CONDITIONS:**

1. THIS DEVICE MAY NOT CAUSE HARMFUL INTERFERENCE, AND
2. THIS DEVICE MUST ACCEPT ANY INTERFERENCE RECEIVED, INCLUDING INTERFERENCE THAT MAY CAUSE UNDESIRE OPERATION.

CAN ICES-3 (B)/NMB-3(B)

**Caution:** changes or modifications not expressly approved by the party responsible for compliance could void the user's authority to operate the equipment.

## **PRODUCT WARRANTY**

- This Warranty is applicable only to the original purchaser, is non-transferable and applies only to "VTech" products or parts. This product is covered by a 3-month Warranty from the original purchase date, under normal use and service, against defective workmanship and materials. This Warranty does not apply to (a) consumable parts, such as batteries; (b) cosmetic damage, including but not limited to scratches and dents; (c) damage caused by use with non-VTech products; (d) damage caused by accident, misuse, unreasonable use, immersion in water, neglect, abuse, battery leakage, or improper installation, improper service, or other external causes; (e) damage caused by operating the product outside the permitted or intended uses described by VTech in the owner's manual; (f) a product or part that has been modified (g) defects caused by normal wear and tear or otherwise due to the normal aging of the product; or (h) if any VTech serial number has been removed or defaced.
- Prior to returning a product for any reason, please notify the VTech Consumer Services Department, by sending an email to [vtechkids@vtechkids.com](mailto:vtechkids@vtechkids.com) or calling 1-800-521-2010. If the service representative is unable to resolve the issue, you will be provided instructions on how to return the product and have it replaced under Warranty. Return of the product under Warranty must adhere to the following rules:
- If VTech believes that there may be a defect in the materials or workmanship of the product and can confirm the purchase date and location of the product, we will at our discretion replace the product with a new unit or product of comparable value. A replacement product or parts assumes the remaining Warranty of the original product or 30 days from the date of replacement, whichever provides longer coverage.

- THIS WARRANTY AND THE REMEDIES SET FORTH ABOVE ARE EXCLUSIVE AND IN LIEU OF ALL OTHER WARRANTIES, REMEDIES AND CONDITIONS, WHETHER ORAL, WRITTEN, STATUTORY, EXPRESS OR IMPLIED. IF VTECH CANNOT LAWFULLY DISCLAIM STATUTORY OR IMPLIED WARRANTIES THEN TO THE EXTENT PERMITTED BY LAW, ALL SUCH WARRANTIES SHALL BE LIMITED TO THE DURATION OF THE EXPRESS WARRANTY AND TO THE REPLACEMENT SERVICE AS DETERMINED BY VTECH IN ITS SOLE DISCRETION.
- To the extent permitted by law, VTech will not be responsible for direct, special, incidental or consequential damages resulting from any breach of Warranty.
- This Warranty is not intended to persons or entities outside the United States of America. Any disputes resulting from this Warranty shall be subject to the final and conclusive determination of VTech.

To register your product online at [www.vtechkids.com/warranty](http://www.vtechkids.com/warranty)

## FREQUENTLY ASKED QUESTIONS

What is the VTech 80-142000 3-in-1 Race and Learn?

The VTech 80-142000 3-in-1 Race and Learn is a versatile educational toy that combines a race car, a track, and a learning platform. It offers interactive play that promotes early learning through fun activities and games.

What are the dimensions of the VTech 80-142000 3-in-1 Race and Learn?

The toy measures 4.41 x 12.13 x 8.86 inches, providing a compact yet engaging play experience for children.

How much does the VTech 80-142000 3-in-1 Race and Learn weigh?

The 3-in-1 Race and Learn weighs approximately 2.2 pounds, making it sturdy yet manageable for young children to handle.

What is the recommended age range for the VTech 80-142000 3-in-1 Race and Learn?

This toy is recommended for children aged 36 months to 6 years, making it suitable for preschoolers and early learners.



What type of batteries does the VTech 80-142000 3-in-1 Race and Learn require?

The 3-in-1 Race and Learn requires 3 AA batteries. Be sure to use fresh batteries to ensure optimal performance.

What features does the VTech 80-142000 3-in-1 Race and Learn offer?

It includes interactive features such as educational games, songs, and activities that teach numbers, letters, and basic problem-solving skills while providing a fun racing experience.

How does the VTech 80-142000 3-in-1 Race and Learn aid in a child's development?

The toy supports cognitive development by incorporating learning activities and problem-solving games. It also enhances motor skills and hand-eye coordination through interactive play.

What materials is the VTech 80-142000 3-in-1 Race and Learn made from?

The toy is made from durable, child-safe plastic materials designed to withstand active play and ensure safety.

What warranty does the VTech 80-142000 3-in-1 Race and Learn come with?

The toy includes a 3-month warranty, covering any manufacturing defects or issues that may arise within that period.

Are there any customer reviews available for the VTech 80-142000 3-in-1 Race and Learn?

Customer reviews for the 3-in-1 Race and Learn can often be found on retailer websites and review platforms. These reviews can provide insights into the toy's performance and satisfaction from other buyers.

Why is my VTech 80-142000 3-in-1 Race and Learn not turning on?

Ensure that the batteries are correctly installed and have sufficient charge. If the product still doesn't turn on, try replacing the batteries with new ones.

What should I do if the sound on my VTech 80-142000 3-in-1 Race and Learn is too low or not working?

Check the volume settings on the toy. If the sound is still low or not working, try replacing the batteries as they might be low.

Why is the steering wheel on my VTech 80-142000 3-in-1 Race and Learn not responding properly?

Ensure that the steering wheel is securely attached and that there are no obstructions. If the issue persists, turn the toy off and on again to reset it.

What can I do if the screen on my VTech 80-142000 3-in-1 Race and Learn is blank or not displaying properly?

A blank screen could indicate low battery power. Try replacing the batteries. If the screen is still not working, there may be a hardware issue.

How can I fix the issue of my VTech 80-142000 3-in-1 Race and Learn freezing during play?

If the toy freezes, turn it off and then back on. If it continues to freeze, remove and reinsert the batteries to reset the device.

## VIDEO – PRODUCT OVERVIEW



[Download the PDF link: VTech 80-142000 3-in-1 Race and Learn User's Manual Race-and-Learn-Users-Manual.mp4](#)

REFERENCE: [VTech 80-142000 3-in-1 Race and Learn User's Manual-Device.Report](#)

## References

- [User Manual](#)