

VTECH  
80-124050  
SPIN  
AND  
LEARN  
COLOR  
FLASHLIGHT



# VTech 80-124050 Spin and Learn Color Flashlight User's Manual

[Home](#) » [vtech](#) » VTech 80-124050 Spin and Learn Color Flashlight User's Manual 

## Contents

- [1 VTech 80-124050 Spin and Learn Color Flashlight](#)
- [2 INTRODUCTION](#)
- [3 INSTRUCTIONS](#)
- [4 PRODUCT FEATURES](#)
- [5 MELODY LIST](#)
- [6 CARE & MAINTENANCE](#)
- [7 TROUBLESHOOTING](#)
- [8 PRODUCT WARRANTY](#)
- [9 FREQUENTLY ASKED QUESTIONS](#)
- [10 VIDEO – PRODUCT OVERVIEW](#)
- [11 References](#)
- [12 Related Posts](#)



**VTech 80-124050 Spin and Learn Color Flashlight**



**Dear Parent,**

Ever notice the look on your baby's face when they learn something new through their own discovery? These self-accomplished moments are a parent's greatest reward. To help fulfill them, VTech® created the Infant Learning® series of toys.

These unique interactive learning toys directly respond to what children do naturally – play! Using innovative technology, these toys react to baby's interactions, making each play experience fun and unique as they learn age-appropriate concepts like first words, numbers, shapes, colors and music. More importantly, VTech®'s Infant Learning® toys develop babies' mental and physical abilities by inspiring, engaging, and teaching.

At VTech®, we know that a child has the ability to do great things. That's why all of our electronic learning products are uniquely designed to develop a child's mind and allow them to learn to the best of their ability. We thank you for trusting VTech® with the important job of helping your child learn and grow!

Sincerely,

Your friends at VTech®

To learn more about VTech® toys, visit [vtechkids.com](http://vtechkids.com)

**INTRODUCTION**

Thank you for purchasing the VTech® Spin & Learn Color Flashlight™! The Spin & Learn Color Flashlight™ from VTech® will light up your child's life! With its engaging ladybug button and three number buttons, your child will learn all about numbers as they hear fun songs. The flashlight glows with a rainbow of colors and can be changed by spinning the ring that also teaches your child about colors and animals. With its easy-to-grip handle, your child will want to take the VTech® Spin & Learn Color Flashlight™ with them on every learning adventure!

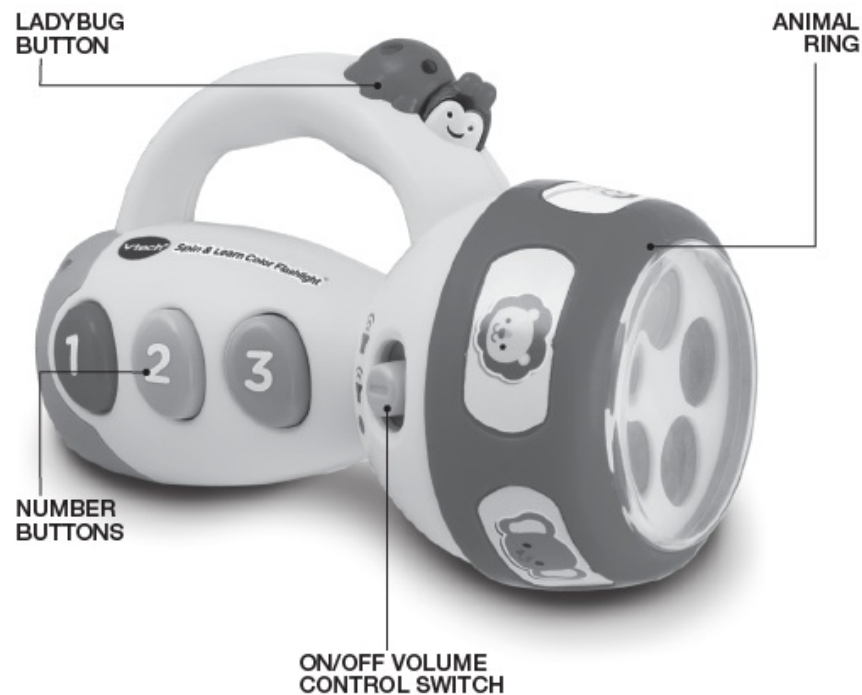

## INCLUDED IN THIS PACKAGE

- One VTech® Spin & Learn Color Flashlight™
- One User's Manual

**WARNING:** All packing materials, such as tape, plastic sheets, and tags are not part of this toy, and should be discarded for your child's safety.

**Note:** Please keep the user's manual as it contains important information.

## INSTRUCTIONS

### BATTERY INSTALLATION

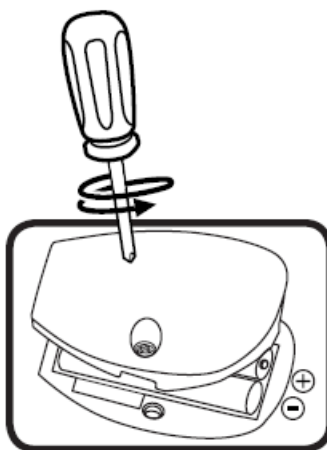

1. Make sure the unit is turned OFF.
2. Locate the battery cover on the back of the unit. Use a screwdriver to loosen the screw.
3. Install 2 new 'AAA' (AM-4/LRO3) batteries following the diagram inside the battery box.
4. Replace the battery cover and tighten the screw to secure it.

## **BATTERY NOTICE**

- Use new alkaline batteries for maximum performance.
- Use only batteries of the same or equivalent type as recommended.
- Do not mix different types of batteries: alkaline, standard (carbon-zinc) or rechargeable (Ni-Cd, Ni-MH), or new and used batteries.
- Do not use damaged batteries.
- Insert batteries with the correct polarity.
- Do not short-circuit the battery terminals.
- Remove exhausted batteries from the toy.
- Remove batteries during long periods of non-use.
- Do not dispose of batteries in a fire.
- Do not charge non-rechargeable batteries.
- Remove rechargeable batteries from the toy before charging (if removable).
- Rechargeable batteries are only to be charged under adult supervision.

## **PRODUCT FEATURES**

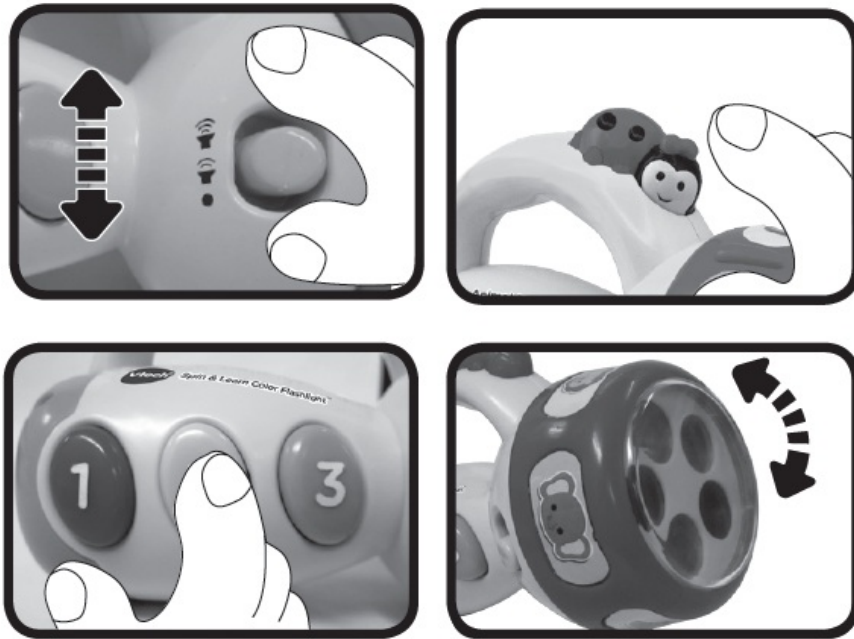

### 1. VOLUME SELECTOR SWITCH

To turn the unit ON, slide the VOLUME SELECTOR SWITCH to the LOW ( ) or HIGH POSITION ( ). To turn the unit OFF, slide the VOLUME SELECTOR SWITCH to the OFF ( ) position.

### 2. AUTOMATIC SHUT-OFF

To preserve battery life, the VTech® Spin & Learn Color Flashlight™ will automatically power down after approximately 45 seconds without input. The unit can be turned on again by pressing any button or turning the animal ring.

### ACTIVITIES

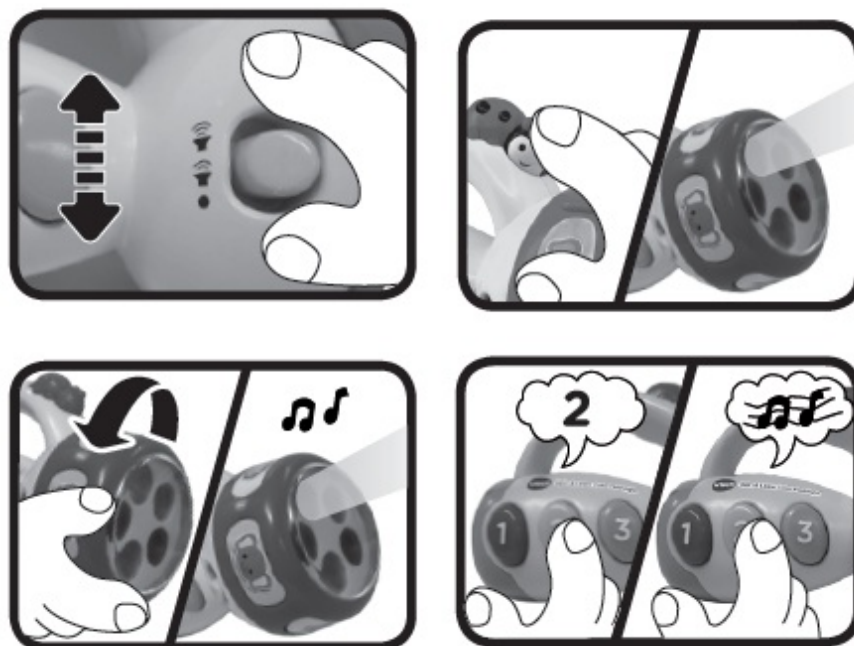

1. Slide the VOLUME SELECTOR SWITCH to the LOW or HIGH position to turn the unit on. You will hear an entertaining sing-along-song and a fun phrase. The light will flash with the sounds and will remain on for about 5s.

2. Turn the animal RING to any position to hear fun sound effects, color names, and short tunes. Turn the ring a second time to hear the animal sounds, their names, and fun jungle tunes. The clear light will remind you to continue to explore. The light will flash with the sounds and will remain on for about 5s.
3. Press the Ladybug button to hear her name, sounds, and song. The ladybug will invite you to explore and flash the light on and off.
4. Press a NUMBER button to hear and learn numbers one, two, and three. The number names will play the first time the buttons are pressed. Short tunes will play the next time the numbers are pressed. Pressing a number button when a tune is playing will jam the number names and fun sound effects along with the tune.

## **MELODY LIST**

1. The Bear Went Over the Mountain
2. William Tell Overture
3. Toreador Song
4. Home Sweet Home
5. Hickory Dickory Dock
6. The Teddy Bear's Picnic

## **SING-ALONG SONG**

- Red, green, yellow, blue, let's follow the jungle crew!

## **CARE & MAINTENANCE**

1. Keep the unit clean by wiping it with a slightly damp cloth.
2. Keep the unit out of direct sunlight and away from any direct heat source.
3. Remove the batteries when the unit will not be in use for an extended period of time.
4. Do not drop the unit on hard surfaces and do not expose the unit to moisture or water.

## **TROUBLESHOOTING**

**If for some reason the program/activity stops working or malfunctions, please follow these steps:**

1. Please turn the unit OFF.
2. Interrupt the power supply by removing the batteries.
3. Let the unit stand for a few minutes, then replace the batteries.
4. Turn the unit ON. The unit should now be ready to play again.
5. If the product still does not work, replace it with a new set of batteries.

If the problem persists, please call our Consumer Services Department at 1-[800-521-2010](tel:800-521-2010) in the U.S. or 1-[877-352-8697](tel:877-352-8697) in Canada, and a service representative will be happy to help you.

For information on this product's warranty, please call our Consumer Services Department at 1-[800-521-2010](tel:800-521-2010) in the U.S. or 1-[877-352-8697](tel:877-352-8697) in Canada.

**IMPORTANT NOTE:** Creating and developing Infant Learning products is accompanied by a responsibility that we at VTech® take very seriously. We make every effort to ensure the accuracy of the information, which forms the value of our products. However, errors sometimes can occur. It is important for you to know that we stand behind our products and encourage you to call our Consumer Services Department at 1-[800-521-2010](tel:800-521-2010) in the U.S., or 1-[877-352-8697](tel:877-352-8697) in Canada, with any problems and/or suggestions that you might have. A service representative will be happy to help you.

**NOTE:**

This equipment has been tested and found to comply with the limits for a Class B digital device, pursuant to Part 15 of the FCC Rules. These limits are designed to provide reasonable protection against harmful interference in a residential installation. This equipment generates, uses and can radiate radio frequency energy and, if not installed and used in accordance with the instructions, may cause harmful interference to radio communications. However, there is no guarantee that interference will not occur in a particular installation. If this equipment does cause harmful interference to radio or television reception, which can be determined by turning the equipment off and on, the user is encouraged to try to correct the interference by one or more of the following measures:

- Reorient or relocate the receiving antenna.
- Increase the separation between the equipment and the receiver.
- Connect the equipment to an outlet on a circuit different from that to which the receiver is connected.
- Consult the dealer or an experienced radio/TV technician for help.

**THIS DEVICE COMPLIES WITH PART 15 OF THE FCC RULES. OPERATION IS SUBJECT TO THE FOLLOWING TWO CONDITIONS:**

1. THIS DEVICE MAY NOT CAUSE HARMFUL INTERFERENCE, AND
2. THIS DEVICE MUST ACCEPT ANY INTERFERENCE RECEIVED, INCLUDING INTERFERENCE THAT MAY CAUSE UNDESIRE OPERATION.

CAN ICES-3 (B)/NMB-3(B)

**Caution:** changes or modifications not expressly approved by the party responsible for compliance could void the user's authority to operate the equipment.

**PRODUCT WARRANTY**

- This Warranty is applicable only to the original purchaser, is non-transferable, and applies only to "VTech" products or parts. This product is covered by a 3-month Warranty from the original purchase date, under normal use and service, against defective workmanship and materials. This Warranty does not apply to (a) consumable parts, such as batteries; (b) cosmetic damage, including but not limited to scratches and dents; (c) damage caused by use with non-VTech products; (d) damage caused by accident, misuse, unreasonable use, immersion in water, neglect, abuse, battery leakage, or improper installation, improper service, or other external causes; (e) damage caused by operating the product outside the permitted or intended uses described by VTech in the owner's manual; (f) a product or part that has been modified (g) defects caused by normal wear and tear or otherwise due to the normal aging of the product; or (h) if any VTech serial number has been removed or defaced.
- Prior to returning a product for any reason, please notify the VTech Consumer Services Department, by sending an email to [vtechkids@vtechkids.com](mailto:vtechkids@vtechkids.com) or calling 1-[800-521-2010](tel:800-521-2010). If the service representative is



unable to resolve the issue, you will be provided instructions on how to return the product and have it replaced under Warranty. Return of the product under Warranty must adhere to the following rules:

- If VTech believes that there may be a defect in the materials or workmanship of the product and can confirm the purchase date and location of the product, we will at our discretion replace the product with a new unit or product of comparable value. A replacement product or parts assumes the remaining Warranty of the original product or 30 days from the date of replacement, whichever provides longer coverage.
- THIS WARRANTY AND THE REMEDIES SET FORTH ABOVE ARE EXCLUSIVE AND IN LIEU OF ALL OTHER WARRANTIES, REMEDIES AND CONDITIONS, WHETHER ORAL, WRITTEN, STATUTORY, EXPRESS OR IMPLIED. IF VTECH CANNOT LAWFULLY DISCLAIM STATUTORY OR IMPLIED WARRANTIES THEN TO THE EXTENT PERMITTED BY LAW, ALL SUCH WARRANTIES SHALL BE LIMITED TO THE DURATION OF THE EXPRESS WARRANTY AND TO THE REPLACEMENT SERVICE AS DETERMINED BY VTECH IN ITS SOLE DISCRETION.
- To the extent permitted by law, VTech will not be responsible for direct, special, incidental, or consequential damages resulting from any breach of Warranty.
- This Warranty is not intended for persons or entities outside the United States of America. Any disputes resulting from this Warranty shall be subject to the final and conclusive determination of VTech.

To register your product online at [www.vtechkids.com/warranty](http://www.vtechkids.com/warranty)

## **FREQUENTLY ASKED QUESTIONS**

What is the product name of VTech 80-124050?

The product name is Spin and Learn Color Flashlight.

What are the product dimensions of the VTech 80-124050 Spin and Learn Color Flashlight?

The product dimensions of the VTech 80-124050 Spin and Learn Color Flashlight are 3 x 4.2 x 5.9 inches.

What is the weight of the VTech 80-124050 Spin and Learn Color Flashlight?

The weight of the VTech 80-124050 Spin and Learn Color Flashlight is 7.5 ounces.

What is the item model number of the VTech 80-124050 Spin and Learn Color Flashlight?

The item model number of the VTech 80-124050 Spin and Learn Color Flashlight is 80-124050.

What is the manufacturer recommended age for the VTech 80-124050 Spin and Learn Color Flashlight?

The manufacturer recommended age for the VTech 80-124050 Spin and Learn Color Flashlight is 12 months to 3 years.

How many batteries does the VTech 80-124050 Spin and Learn Color Flashlight require?



The VTech 80-124050 Spin and Learn Color Flashlight requires 2 AAA batteries.

Who is the manufacturer of the VTech 80-124050 Spin and Learn Color Flashlight?

VTech is the manufacturer of the VTech 80-124050 Spin and Learn Color Flashlight.

What is the price of the VTech 80-124050 Spin and Learn Color Flashlight?

The price of the VTech 80-124050 Spin and Learn Color Flashlight is \$14.99.

What is the warranty period for the VTech 80-124050 Spin and Learn Color Flashlight?

The VTech 80-124050 Spin and Learn Color Flashlight comes with a 3-month warranty.

Why is my VTech 80-124050 Spin and Learn Color Flashlight not turning on?

Ensure that the batteries are inserted correctly according to the polarity markings inside the battery compartment of the VTech 80-124050 Spin and Learn Color Flashlight. Replace the batteries if necessary.

How do I fix it if my VTech 80-124050 Spin and Learn Color Flashlight's lights are not working properly?

Check the battery compartment for any corrosion on the terminals. Clean the terminals with a dry cloth and replace the batteries with fresh ones.

My VTech 80-124050 Spin and Learn Color Flashlight is not displaying the correct colors. What should I do?

Make sure that the color selector wheel on the flashlight is set to the correct position. Rotate the wheel to cycle through the different color modes and check if the issue persists.

The buttons on my VTech 80-124050 Spin and Learn Color Flashlight are not responding when pressed. What should I check?

Ensure that the toy is turned on and that the buttons are not stuck. Clean around the buttons gently with a dry cloth to remove any dirt or debris.

Why does my VTech 80-124050 Spin and Learn Color Flashlight produce dim light or flicker?

This could be due to low battery power or poor contact between the batteries and terminals. Replace the batteries with fresh ones and clean the terminals as needed.

How can I replace the batteries in my VTech 80-124050 Spin and Learn Color Flashlight?

Locate the battery compartment on the flashlight and open it using a screwdriver if necessary. Replace the old

batteries with new ones according to the polarity markings.

## VIDEO – PRODUCT OVERVIEW



[Download the PDF link: VTech 80-124050 Spin and Learn Color Flashlight User's Manual  
Learn-Color-Flashlight-Users-Manual.mp4](#)

REFERENCE: [VTech 80-124050 Spin and Learn Color Flashlight User's Manual-Device.Report](#)

## References

- [User Manual](#)

[Manuals+](#), [Privacy Policy](#)

This website is an independent publication and is neither affiliated with nor endorsed by any of the trademark owners. The "Bluetooth®" word mark and logos are registered trademarks owned by Bluetooth SIG, Inc. The "Wi-Fi®" word mark and logos are registered trademarks owned by the Wi-Fi Alliance. Any use of these marks on this website does not imply any affiliation with or endorsement.