



vtech VM3261 Video Monitor User Guide

[Home](#) » [vtech](#) » vtech VM3261 Video Monitor User Guide 

Contents

- 1 vtech VM3261 Video Monitor
- 2 What's in the box
- 3 Install the battery
- 4 Connect the baby monitor
- 5 Power on the baby monitor
- 6 Positioning the baby monitor
- 7 Status check
- 8 Basic operation – Parent unit
- 9 Overview
 - 9.1 Parent unit
 - 9.2 Baby unit
- 10 Sound sensitivity and sound activation
- 11 Night vision
- 12 Mount the baby unit (optional)
- 13 For VM3261-2 only
- 14 Documents / Resources
- 15 Related Posts

vtech®

vtech VM3261 Video Monitor



What's in the box

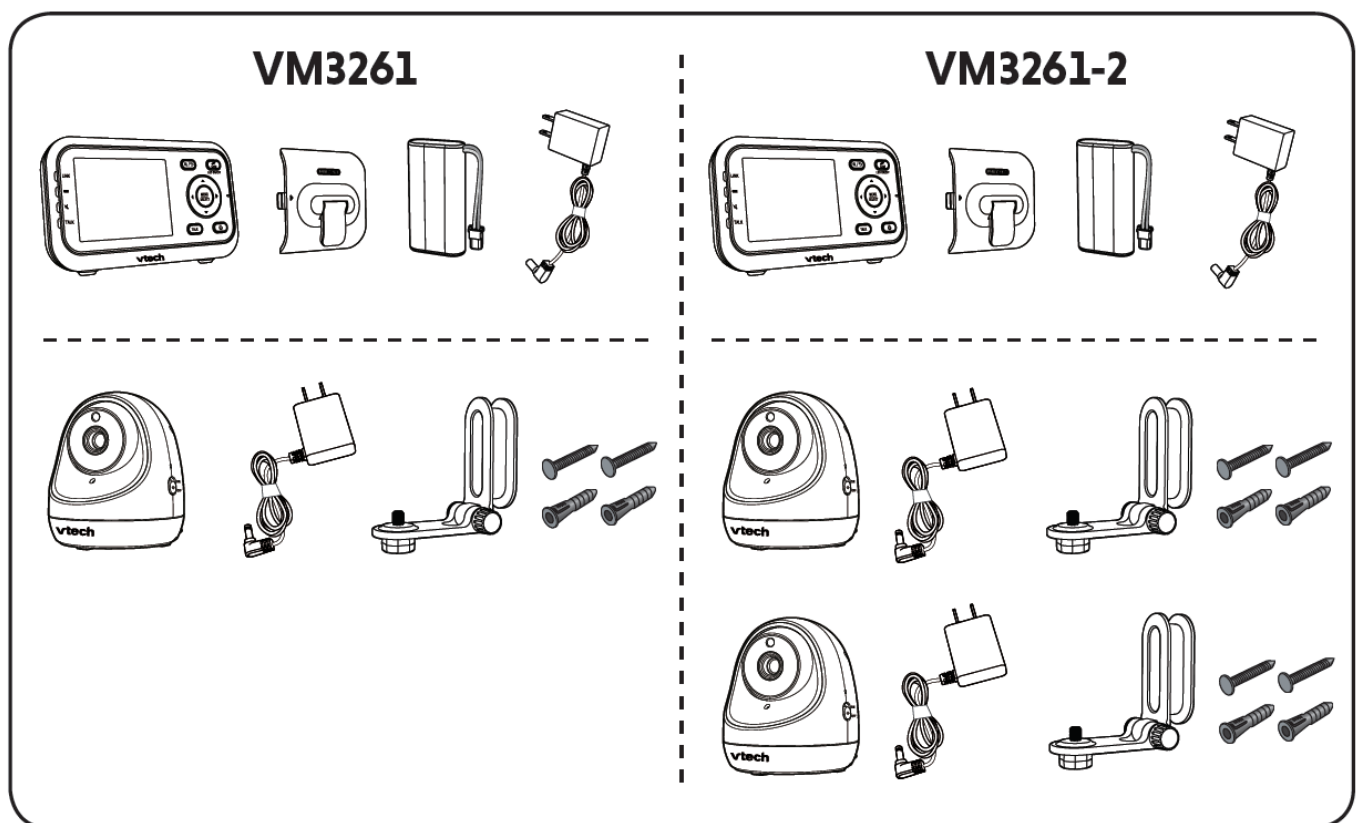

Install the battery

1

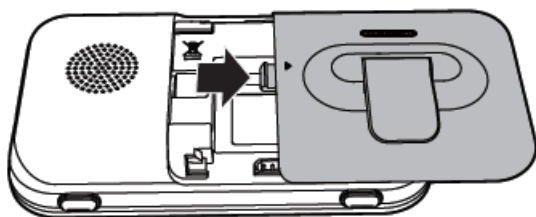

2

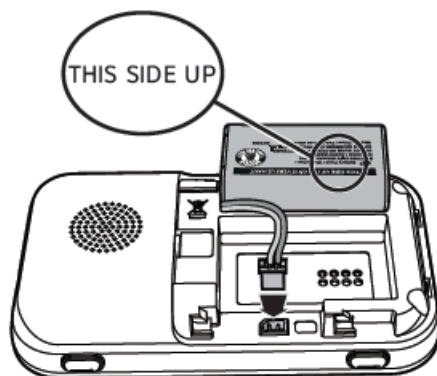

3

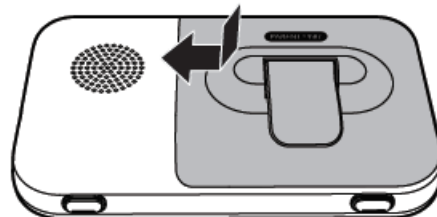

Connect the baby monitor

NOTES

- The rechargeable battery is pre-installed in your parent unit.
- Use only the power adapters supplied with this product.
- Make sure the baby monitor is not connected to the switch controlled electric outlet.
- Connect the power adapters in a vertical or floor mount position only. The adapters' prongs are not designed to hold the weight of baby monitor, so do not connect them to any ceiling, under-the-table, or cabinet outlets. Otherwise, the adapters may not properly connect to the outlets.
- Make sure the parent unit, the baby unit and the power adapter cords are out of reach of children.

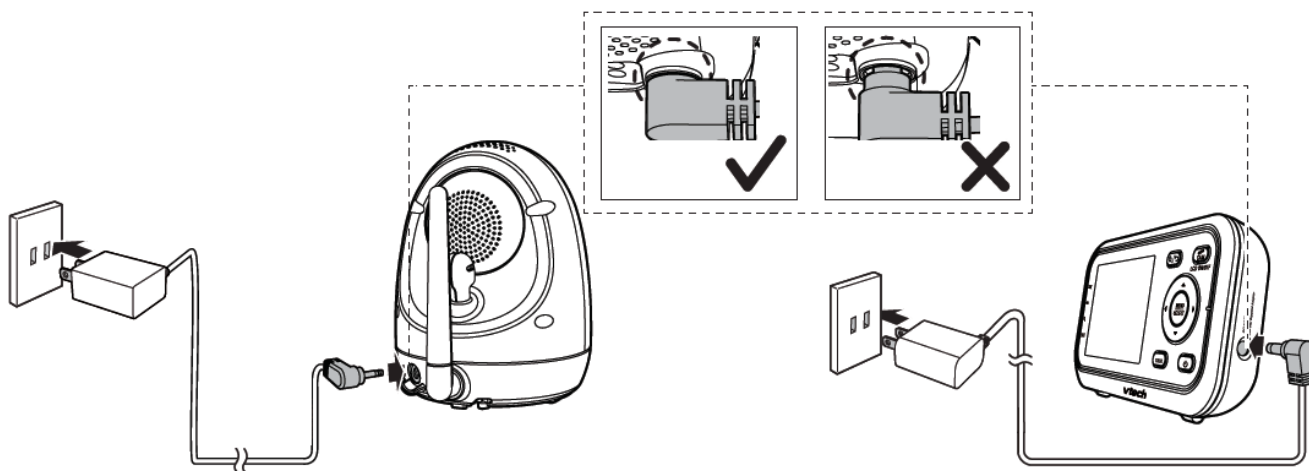

Power on the baby monitor

1. Slide the ON/OFF switch to power on your baby unit.

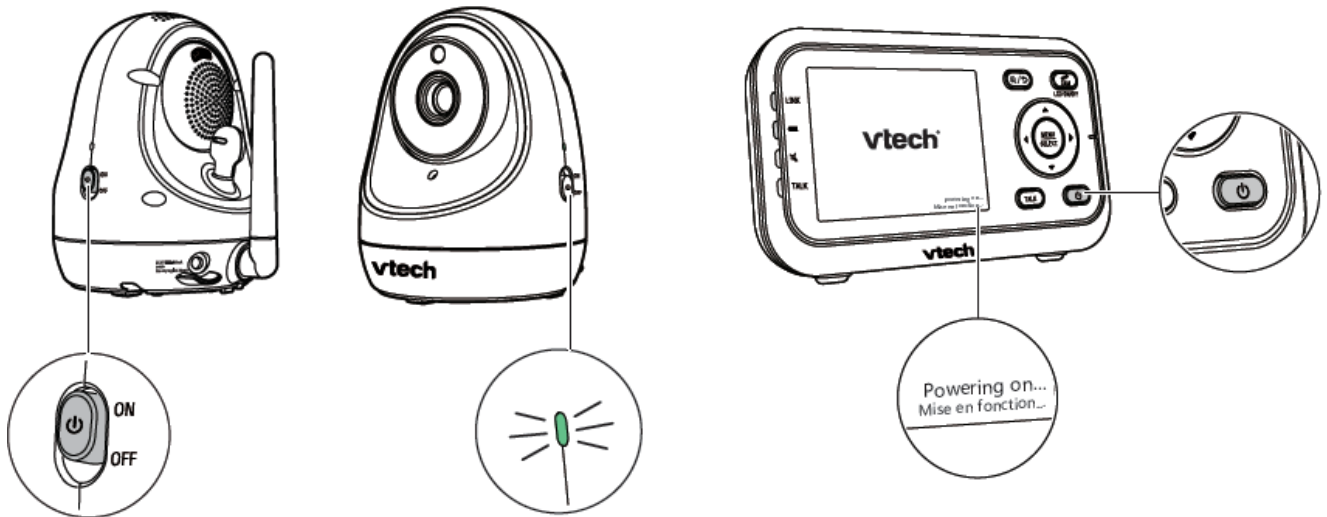

2. Press and hold to power on your parent unit.

Positioning the baby monitor

Caution

- The default volume of your parent unit is level 3, and the maximum volume is level 5. If you experience high-pitched screeching noise from your baby monitor while positioning:
- Make sure your baby unit and parent unit are more than 1 meter (3 feet) apart, OR
- Turn down the volume of your parent unit.

1

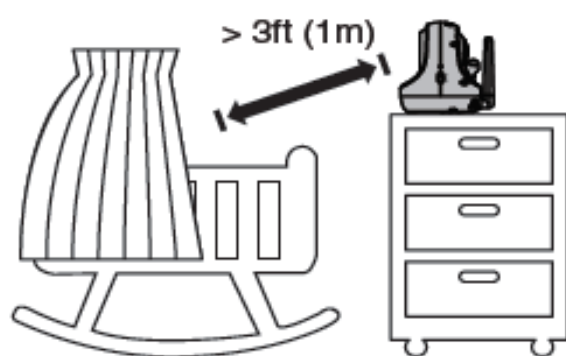

2

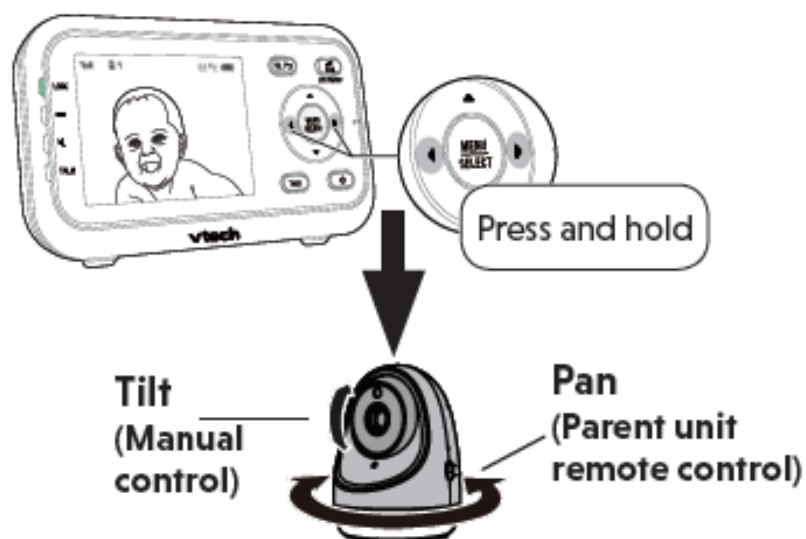

3

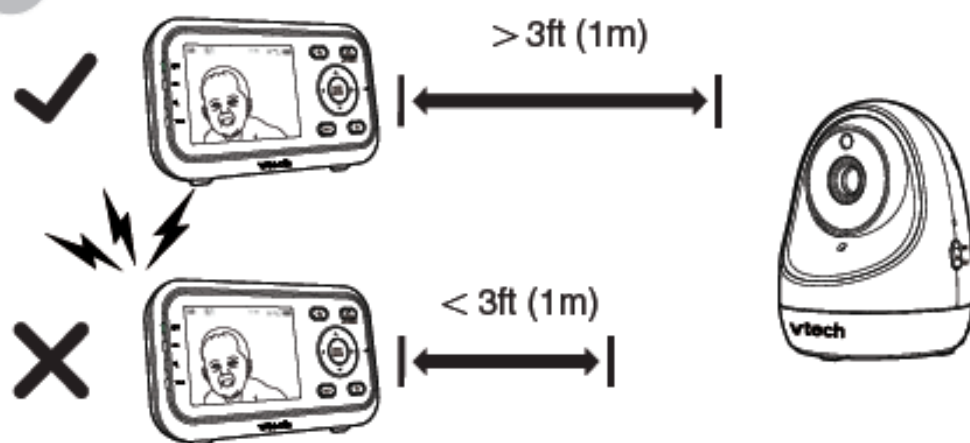

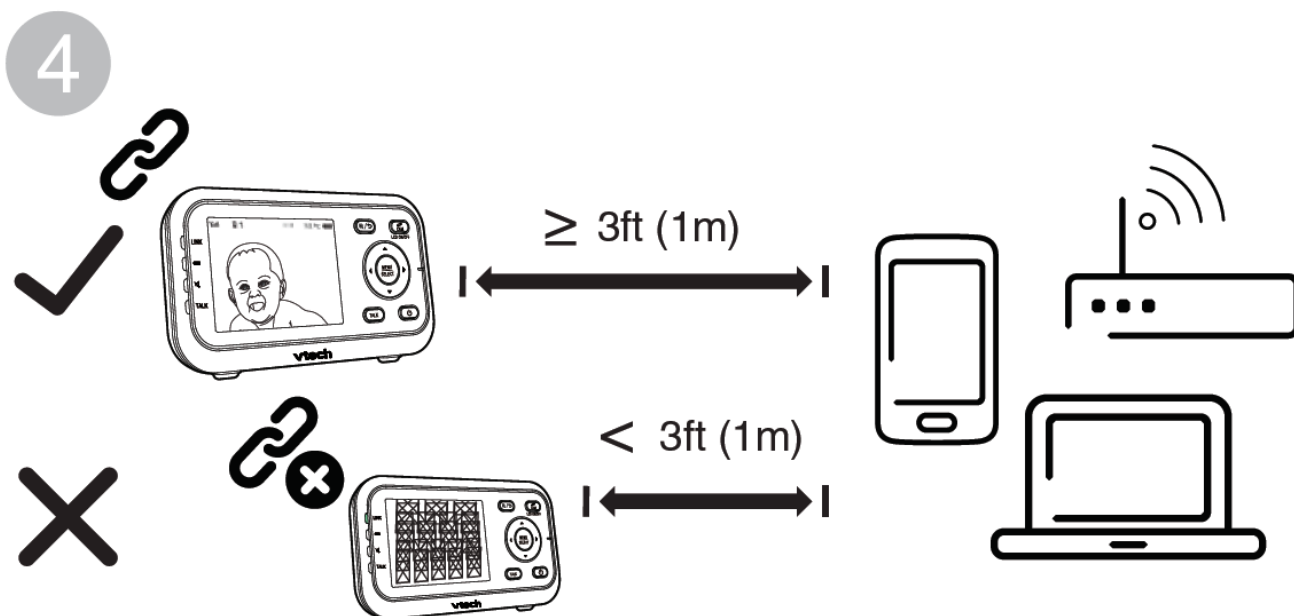

NOTE: To avoid interference from other electronic devices, place your baby monitor at least 3 feet (1 meter) away from devices such as wireless routers, microwaves, cell phones and computers.

Status check

Once you power on both your baby unit and parent unit, your parent unit displays image from the baby unit, and the LINK LED light turns on.

The POWER LED light of baby unit turns on.

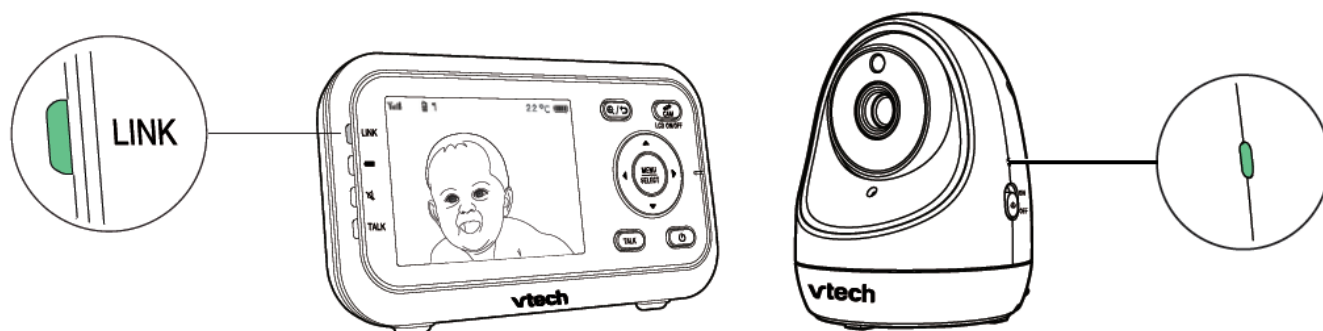

Basic operation – Parent unit

Talk to your baby unit

Press and hold TALK and speak to your parent unit. Your voice is transmitted to the baby unit.

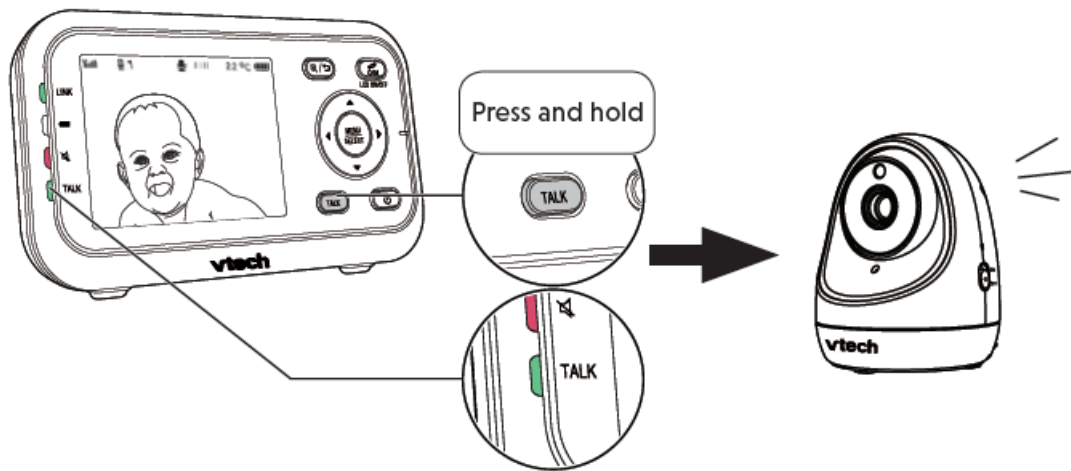

Adjust speaker volume

Press VOL+ / VOL- to adjust your parent unit speaker volume.

The sound sensitivity setting also affects the speaker volume. For details, refer to Sound sensitivity and sound activation.

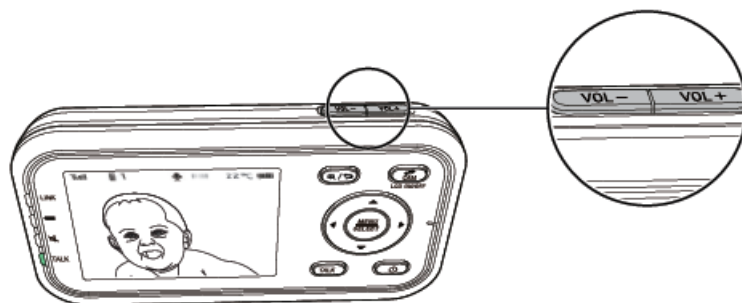

Turn off the screen

Press and hold LCD ON/OFF to switch off the screen. You can still hear sound from the selected baby unit.

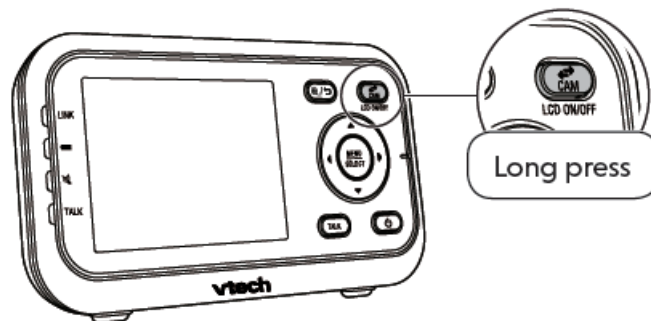

Tip: Press any keys on the parent unit to turn on the screen again.

Use the menu

Press MENU to enter the menu, or save a setting. You can use the parent unit for advanced settings or operations, such as to play or stop the baby unit lullaby, or to adjust the baby unit sound sensitivity.

While in the menu:

- Press back or next to scroll among the menu options.
- Press SELECT or to enter the desired submenu.
- Press or to select an item.
- Press SELECT to confirm your selection.
- Press or to exit the submenu.

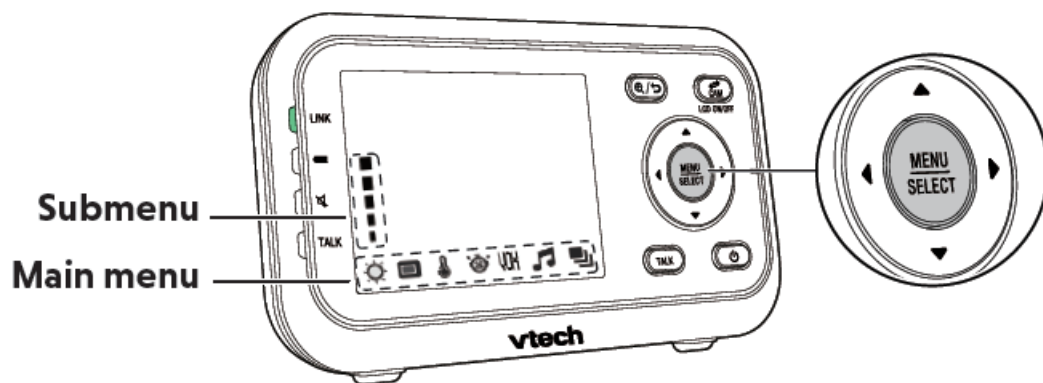

Pan, tilt, zoom

Press and hold or to pan or tilt the image leftward or rightward.

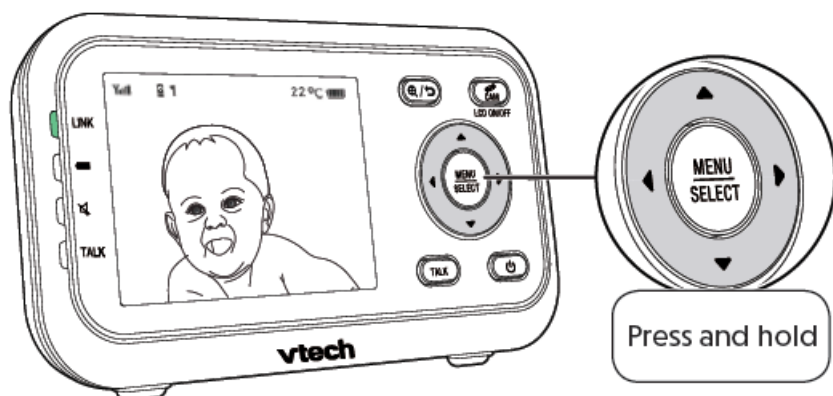

Press  to zoom in or out.

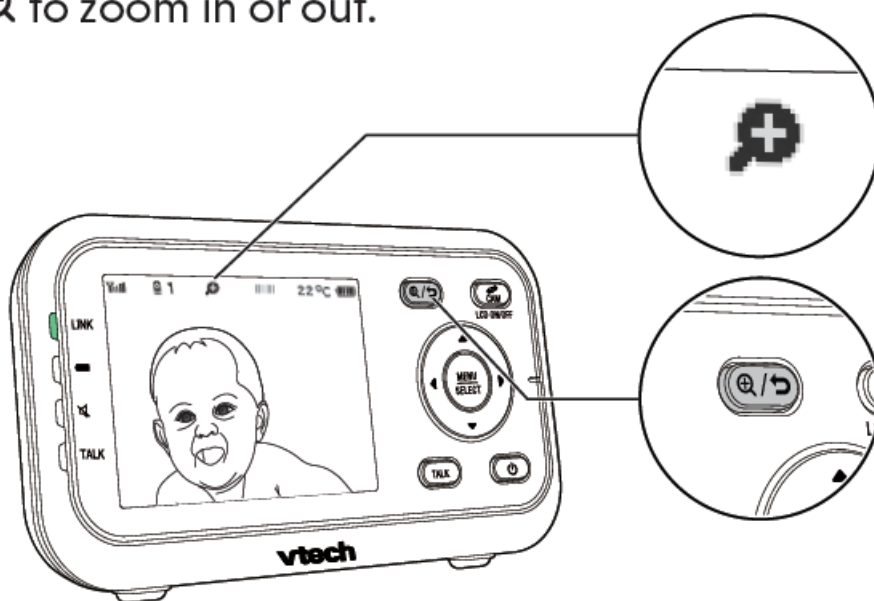

Overview

Parent unit

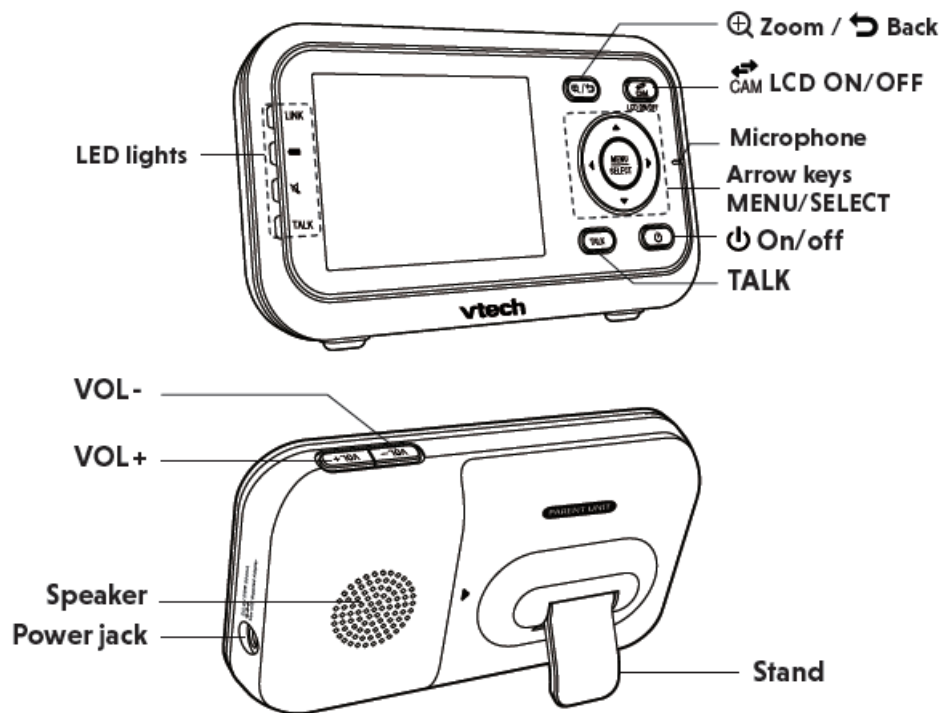

Baby unit

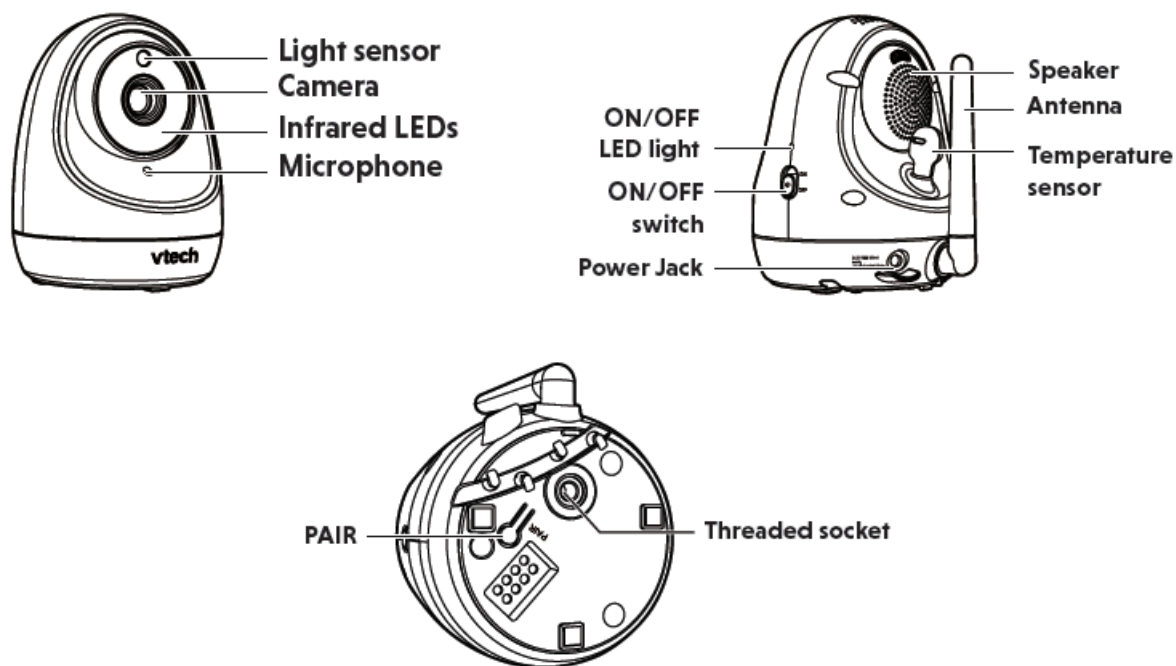

Sound sensitivity and sound activation

Adjust sound detection sensitivity



With sound sensitivity setting, you can choose to hear sounds from the baby unit all the time, or to hear sounds that exceed a certain level.

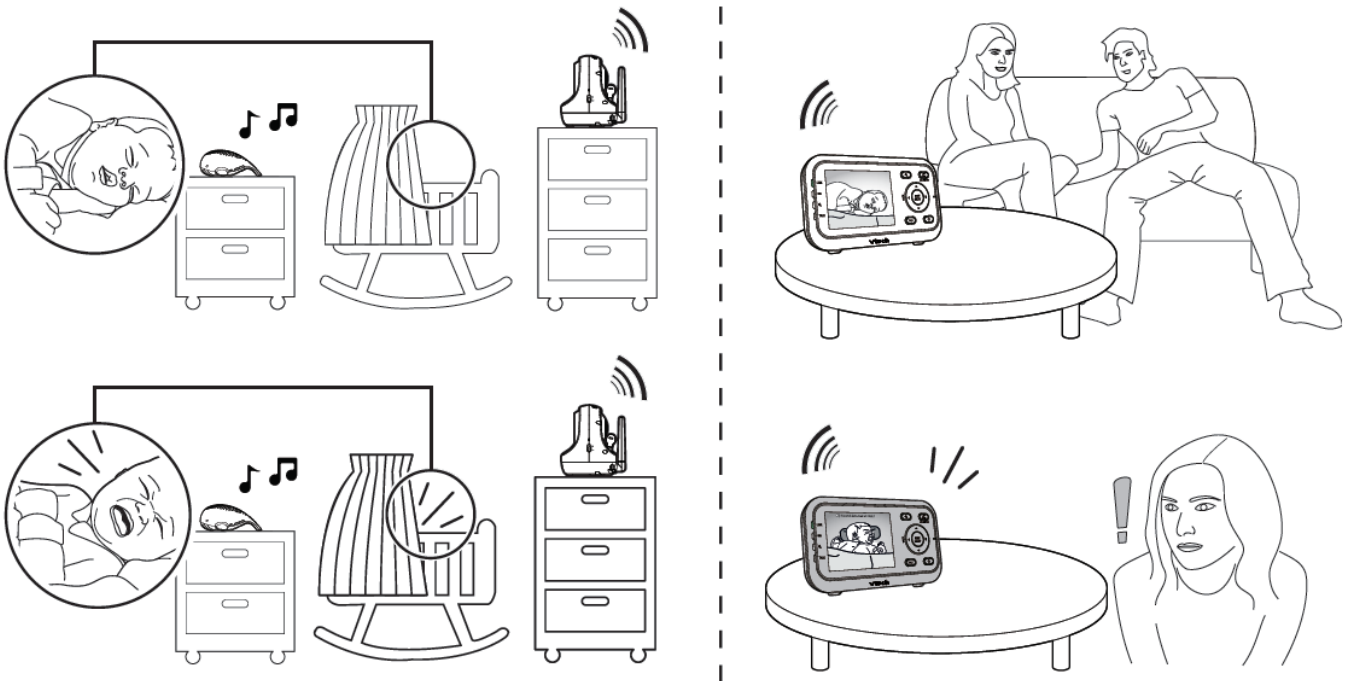

Parent unit setting	What happens...	You may experience ...	What you could do...
Speaker volume: Low Sensitivity: Highest [Default]	Hear all sounds all the time, including background sounds.	Difficulty in hearing your baby's soft sounds if the background sounds are louder.	<ul style="list-style-type: none"> • Increase parent unit's speaker volume, and lower sound sensitivity. • If you are using a white noise machine or sound machine, set its volume to low, or relocate it to minimize background sounds.
Speaker volume: MAX Sensitivity: Low / Medium	Only hear sounds that exceed the selected sound sensitivity level.	No sound; or sounds that cut in and out at times as the baby unit may not detect extra soft sounds.	Increase the sound sensitivity, and adjust the volume level if necessary.

For details, please see Adjust the sound sensitivity of the baby unit in the User's manual.

Sound activated screen



When sound activation is on, the parent unit screen stays off to save power when the baby unit detects no sound. Once the baby unit detects sounds that are louder than the chosen sound sensitivity level, the parent unit screen turns on automatically. It will then turn off again after 50 seconds of no sound detection.

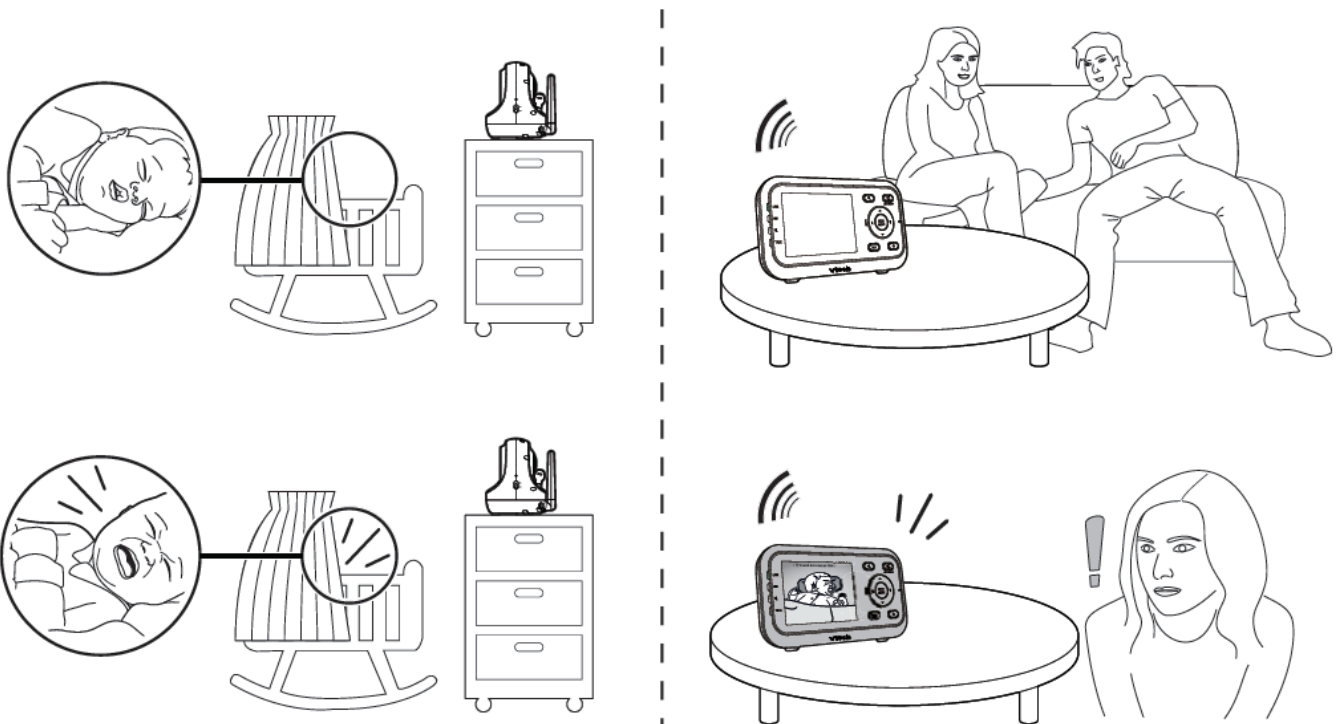

Night vision

The baby unit has infrared LEDs that allow you to see your baby clearly at night or in a dark room. When the baby unit being viewed detects low light levels, the infrared LEDs are switched on automatically. The images from the baby unit are in black and white, and appears on the screen.

Notes

- It is normal if you see a short white glare on your parent unit screen as the baby unit is adapting to the dark environment.
- When the infrared LEDs are on, the images are in black and white. This is normal.

Tip

- Depending on the surroundings and other interfering factors, like lightings, objects, colors and backgrounds, the display resolution may vary. Adjust the baby unit's angle or place the baby unit at a higher level to prevent glare and blurry display.

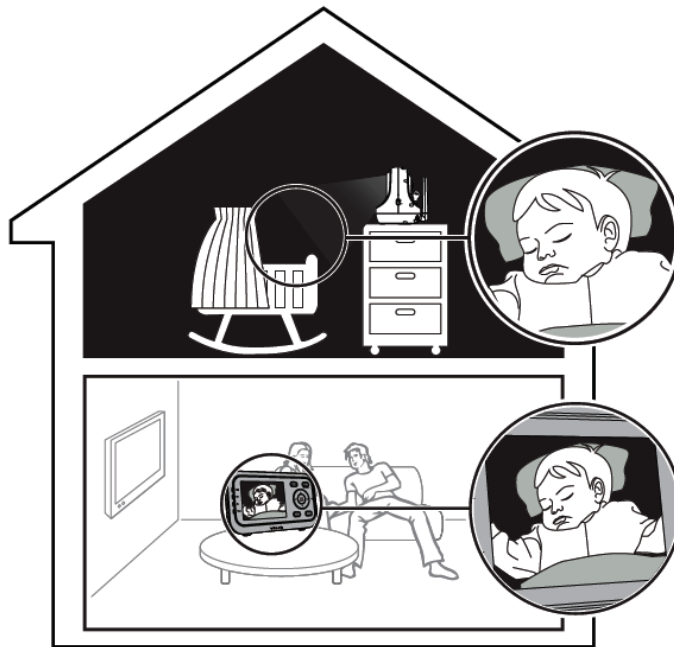

Mount the baby unit (optional)

1

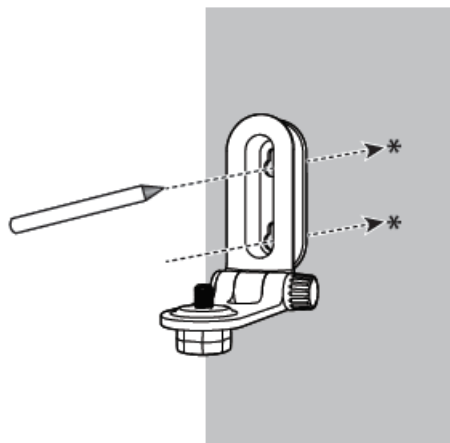

Note

- Check for reception strength and camera angle before drilling the holes.
- The types of screws and anchors you need depend on the composition of the wall.
- Use a pencil to mark two holes in parallel. Make sure they are the same distance apart as the wall mount holes on the baby unit.

2

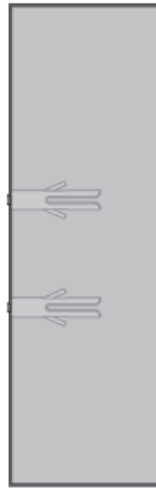

If you drill the holes into a stud, go to step 3.

If you drill the holes into an object other than a stud, insert the wall anchors into the holes. Tap gently on the ends with a hammer until the wall anchors are flush with the wall.

3

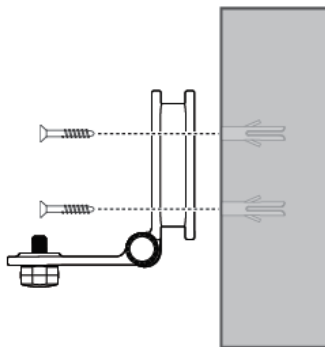

3

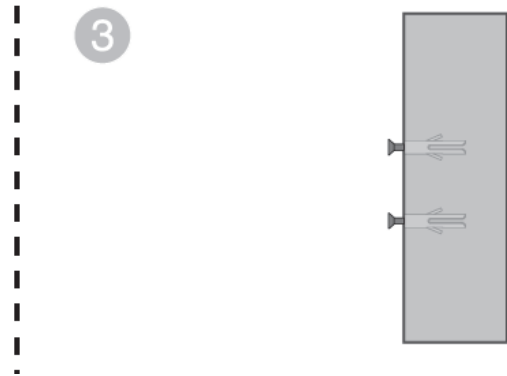

- Align the wall mount bracket and screws with the holes in the wall as shown. Tighten the screw in the middle hole first, so that the wall mount bracket position is fixed. You can tighten the other screw in the top hole.
- Insert the screws into the holes and tighten the screws until only 1/4 inch of the screws are exposed.

4

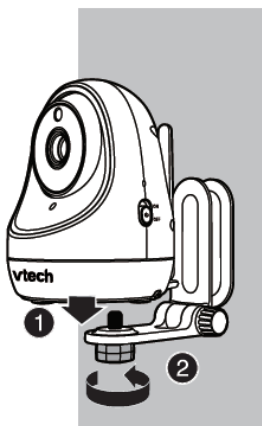

4

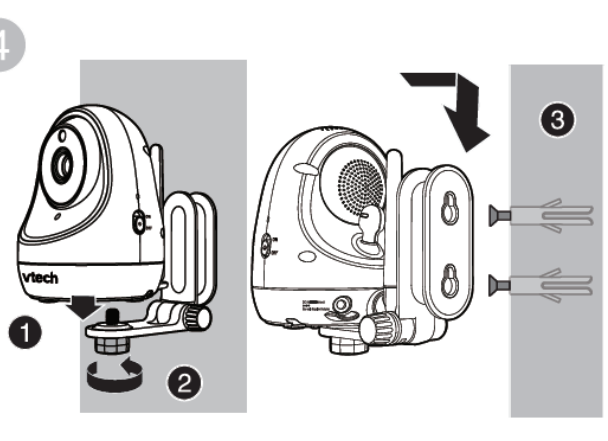

- Place the baby unit on the wall mount bracket. Tighten the screw into the threaded socket at the bottom to secure the baby unit.

- Place the baby unit on the wall mount bracket. Tighten the screw into the threaded socket at the bottom to secure the baby unit. Align the holes on the wall mount bracket with the screws on the wall, and slide the wall mount bracket down until it locks into place.

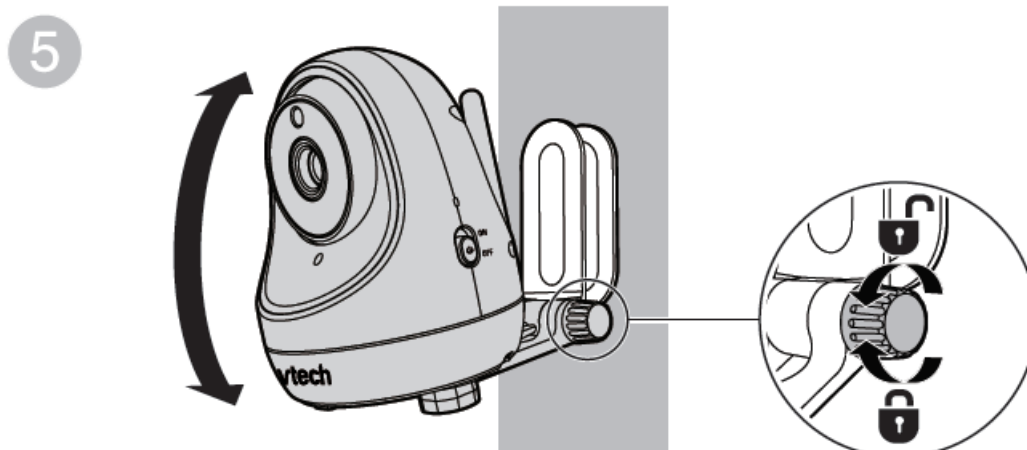

You can maximize your baby unit's viewing angles by tilting the wall mount bracket. Hold the baby unit, and then rotate the knob in anticlockwise direction. This will loosen the joint of the wall mount bracket.

Tilt your baby unit up or down to adjust to your preferred angle.

Then, rotate the knob in clockwise direction to tighten the joint and secure the angle.

For VM3261-2 only

Status check – Two baby units

If you are viewing baby unit , the POWER LED light of baby unit turns on. As baby unit is not being viewed, its POWER LED light flashes.

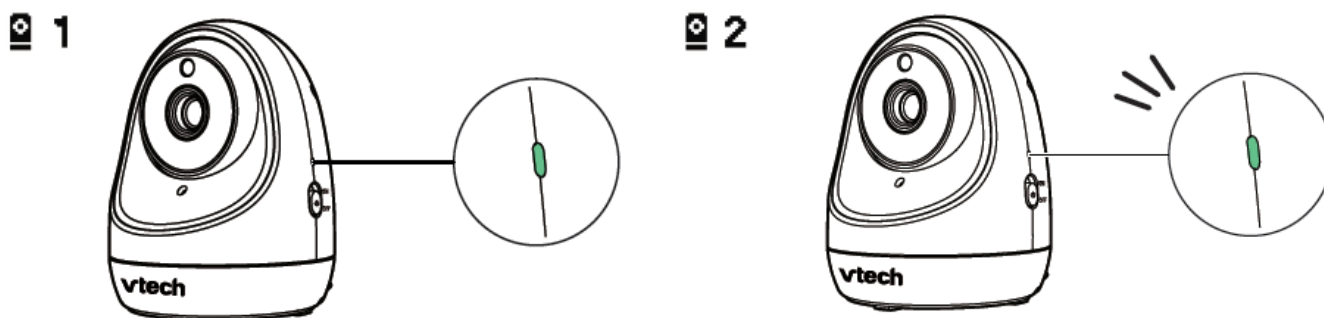

Note: If you power on only one baby unit, your parent unit may display and the LINK LED light flashes. Press to switch to the baby unit you have powered on.

Change different views – Patrol

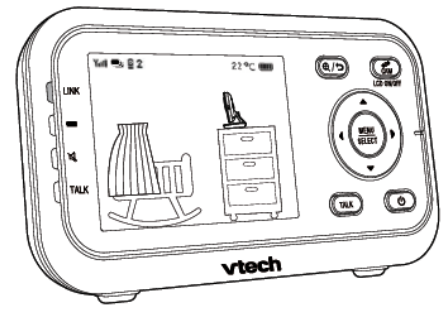
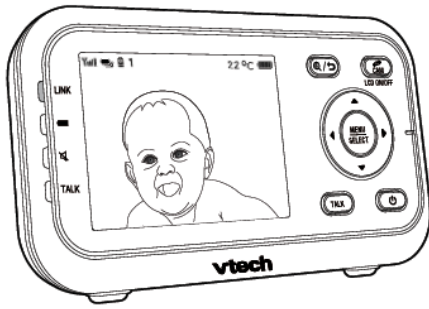

Change different views – Single-cam

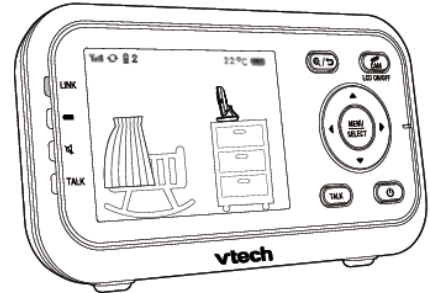
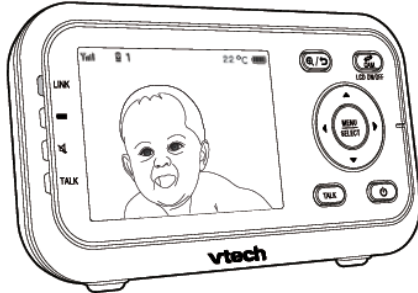

Documents / Resources



[vtech VM3261 Video Monitor](#) [pdf] User Guide
VM3261, Video Monitor, VM3261-2