



vtech Triceratops Switch and Go Dinos Turbo Instruction Manual

[Home](#) » [vtech](#) » vtech Triceratops Switch and Go Dinos Turbo Instruction Manual 

Contents

- 1 [vtech Triceratops Switch and Go Dinos Turbo](#)
- 2 [Product Information](#)
- 3 [Product Usage Instructions](#)
- 4 [INTRODUCTION](#)
- 5 [INCLUDED IN THE PACKAGE](#)
- 6 [Battery Removal and Installation](#)
- 7 [ASSEMBLY INSTRUCTIONS](#)
- 8 [HOW TO SWITCH](#)
- 9 [EGG SHELL DINO STORAGE](#)
- 10 [PRODUCT FEATURES](#)
- 11 [CARE & MAINTENANCE](#)
- 12 [TROUBLESHOOTING](#)
- 13 [CONSUMER SERVICES](#)
- 14 [PRODUCT WARRANTY/ CONSUMER GUARANTEES](#)
- 15 [Documents / Resources](#)
 - 15.1 [References](#)
- 16 [Related Posts](#)



vtech Triceratops Switch and Go Dinos Turbo



Product Information

- Product Name: Triceratops
- Product Modes: Dino Mode, Vehicle Mode, Off
- Features: Talk Button, Automatic Shut-Off
- Battery Requirement: 1 AAA battery (alkaline or fully charged Ni-MH rechargeable batteries recommended)
- Assembly Required: Yes
- Age Recommendation: Not specified

Product Usage Instructions

1. To exit try-me mode:
 - Slide the Off/Dino Mode/Vehicle Mode Switch from Vehicle mode to Dino mode/Off.
1. Battery Removal and Installation:
 1. Make sure the unit is turned Off.
 2. Find the battery cover located on the bottom of the unit. Use a screwdriver to loosen the screw, and then open the battery cover.
 3. Remove the old battery by pulling up on one end of the battery.
 4. Install 1 new AAA battery following the diagram inside the battery box. For best performance, alkaline batteries or fully charged Ni-MH rechargeable batteries are recommended.
2. Replace the battery cover and tighten the screw to secure.

Assembly Instructions

1. Identify the following pieces for assembly
2. Separately install the A, B, C, D, E, F, and G parts as shown in the illustrations.

How to Switch

1. Dino mode:

Flip down the crest, then flip down the Dino's tail. Close the Dino's mouth, then flip up the front legs. Next, flip up the back legs.
2. **Vehicle mode:**

The Dino is now in Vehicle mode. Slide the Off/Dino mode/Vehicle mode Switch to Vehicle mode to play Vehicle responses.

Note: To switch from Vehicle mode to Dino mode, follow the above steps in reverse order.

1. Egg Shell Dino Storage:

- Triceratops can be dismantled and stored back inside the egg shell.
- To store Triceratops:
 1. Place the battery module and the 4 dino legs into the egg shell as illustrated.
 2. Put the remaining dino pieces into the other half of the egg shell.
 3. Then, connect the first half of the egg shell to seal.]

2. Product Features:

3. Slide the Off/Dino Mode/Vehicle Mode Switch to turn the unit ON and choose Dino mode or Vehicle mode to play. Slide the Off/Dino Mode/Vehicle Mode Switch to the Off position to turn the unit OFF.

- Press the Talk Button to hear fun phrases and cool dinosaur sounds in Dino mode, or hear fun phrases and great vehicle sounds in Vehicle mode.
- To preserve battery life, Triceratops will automatically turn off after a few seconds. Triceratops can be woken up again by pressing the Talk Button or by switching between Dino and Vehicle modes. Note: If the unit powers down or if the light flashes 3 times without.

VTech understands that a child's needs and abilities change as they grow and with that in mind we develop our toys to teach and entertain at just the right level.

vtech BoY

Toys that will stimulate their interest in different textures, sounds and colours.

I am

responding to colours, sounds and textures responding to colours, sounds and textures understanding cause and effect

PRE-SCHOOL

Interactive toys to develop their imagination and encourage language development.

I want

to get ready for school by starting to learn the alphabet and counting my learning to be as fun, easy and exciting as can be to show my creativity with drawing and music so my whole brain develops. Cool, aspirational and inspiring computers for curriculum related learning

I need

challenging activities that can keep pace with my growing mind intelligent technology that adapts to my level of learning National Curriculum based content to support what I'm learning at school.

To learn more about this and other VTech® products. visit www.vtech.co.uk

INTRODUCTION

Assemble this tough Triceratops, then switch it into a powerful car and back again in just a few simple steps! Let's switch and stomp.

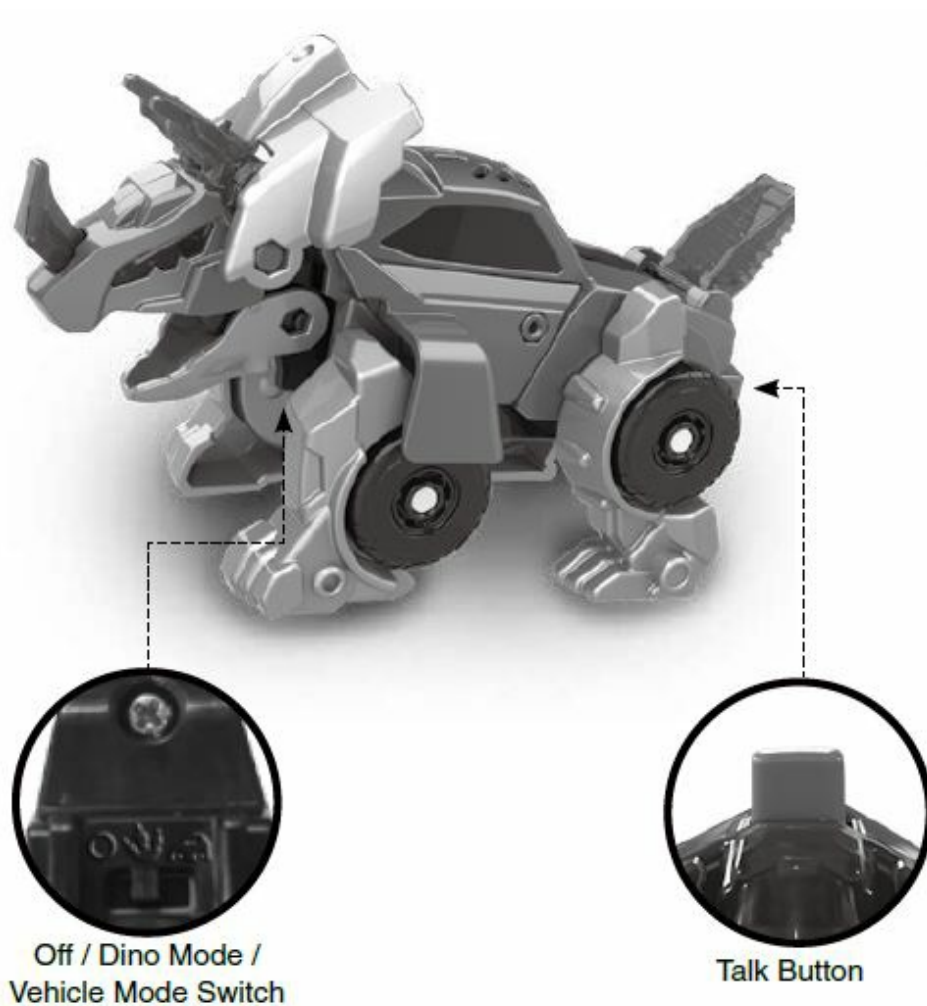

INCLUDED IN THE PACKAGE

- Switch & Go Dinos® Eggs Triceratops
- 15 Pieces for Assembly
- Quick Start Guide

WARNING

All packing materials such as tape, plastic sheets, packaging locks, removable tags, cable ties, cords and packaging screws are not part of this toy, and should be discarded for your child's safety.

NOTE

Please save this Instruction Manual as it contains important information.

GETTING STARTED

Exit Try-Me Mode:

The product is in try-me mode in the packaging. To exit try-me mode, just slide the Off/Dino Mode/Vehicle Mode Switch from Vehicle mode to Dino mode/Off.

Battery Removal and Installation

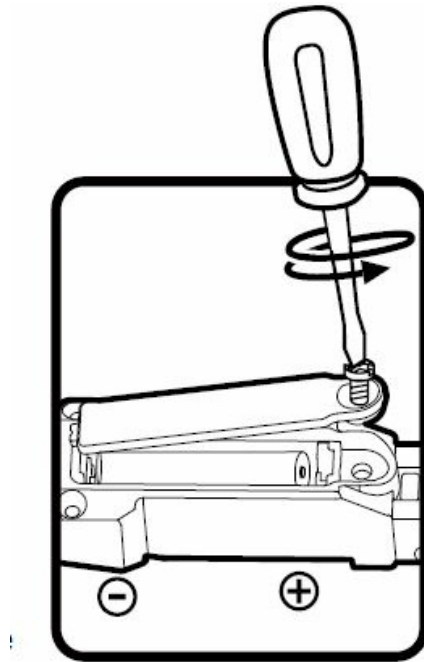

1. Make sure the unit is turned Off.
2. Find the battery cover located on the bottom of the unit. Use a screwdriver to loosen the screw, and then open the battery cover.
3. Remove the old battery by pulling up on one end of the battery.
4. Install 1 new AAA battery following the diagram inside the battery box. (For best performance, alkaline batteries or fully charged Ni-MH rechargeable batteries are recommended).
5. Replace the battery cover and tighten the screw to secure.

WARNING:

Adult assembly required for battery installation. Keep batteries out of reach of children.

IMPORTANT BATTERY INFORMATION

- Insert batteries with the correct polarity (+ and -).
- Do not mix old and new batteries.
- Do not mix alkaline, standard (carbon-zinc) or rechargeable batteries.
- Only batteries of the same or equivalent type as recommended are to be used.
- Do not short-circuit the supply terminals.
- Remove batteries during long periods of non-use.
- Remove exhausted batteries from the toy.
- Dispose of batteries safely. Do not dispose of batteries in fire. **RECHARGEABLE BATTERIES:**
- Remove rechargeable batteries from the toy before charging.
- Rechargeable batteries are only to be charged under adult supervision.
- Do not charge non-rechargeable batteries.

Disposal of batteries and product

The crossed-out wheellie bin symbols on products and batteries, or on their respective packaging, indicates they

must not be disposed of in domestic waste as they contain substances that can be damaging to the environment and human health.

The chemical symbols Hg, Cd or Pb, where marked, indicate that the battery contains more than the specified value of mercury (Hg), cadmium (Cd) or lead (Pb) set out in the Batteries and Accumulators Regulation. The solid bar indicates that the product was placed on the market after 13th August, 2005. Help protect the environment by disposing of your product or batteries responsibly.

VTech® cares for the planet

Care for the environment and give your toy a second life by disposing of it at a small electricals collection point so all its materials can be recycled.

In the UK:

Visit www.recyclenow.com to see a list of collection points near you.

In Australia & New Zealand:

Check with your local council for kerbside collections.

ASSEMBLY INSTRUCTIONS

1. Identify the following pieces for assembly:

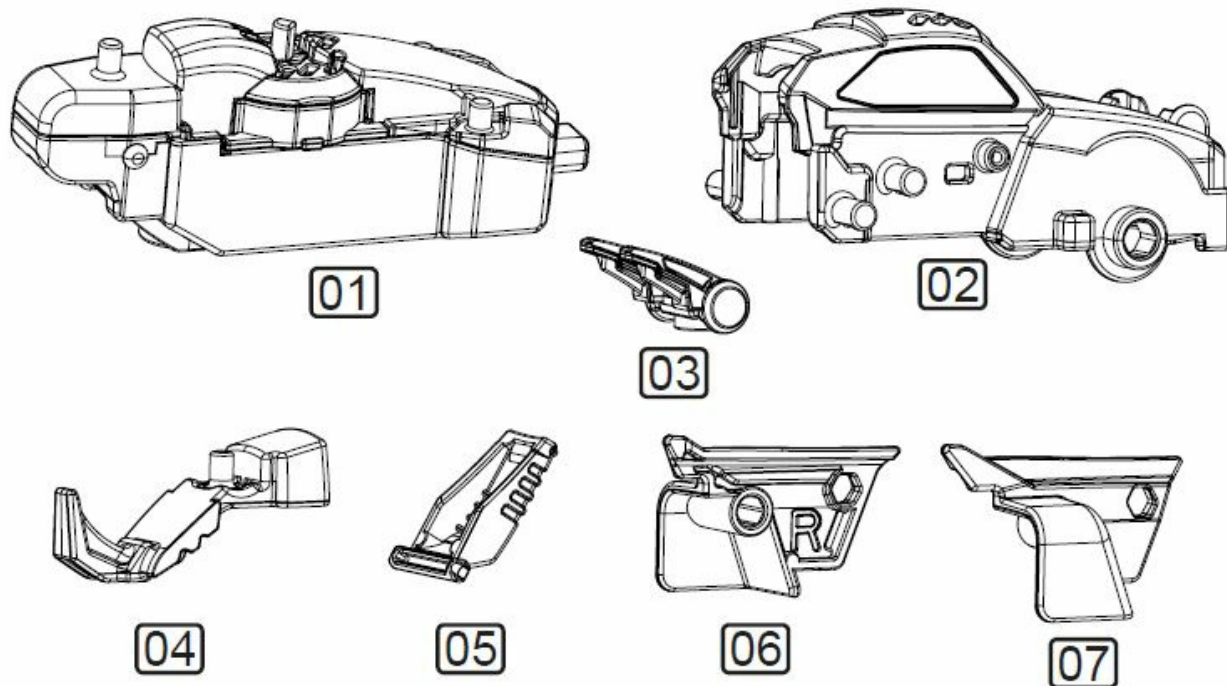

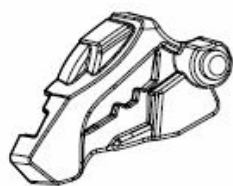

08



09

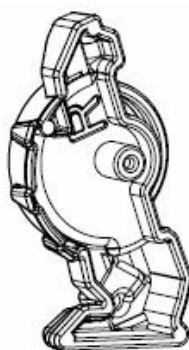

10

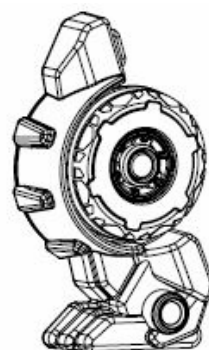

11

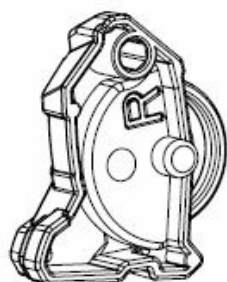

12

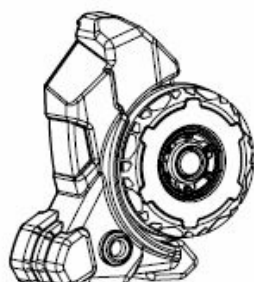

13

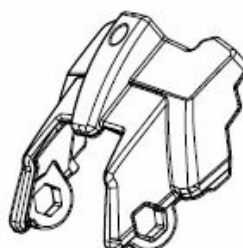

14



15

2. Separately install the A, B, C, D, E, F and G parts as shown in the illustrations.

A

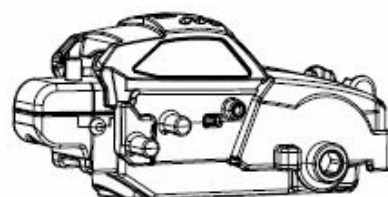
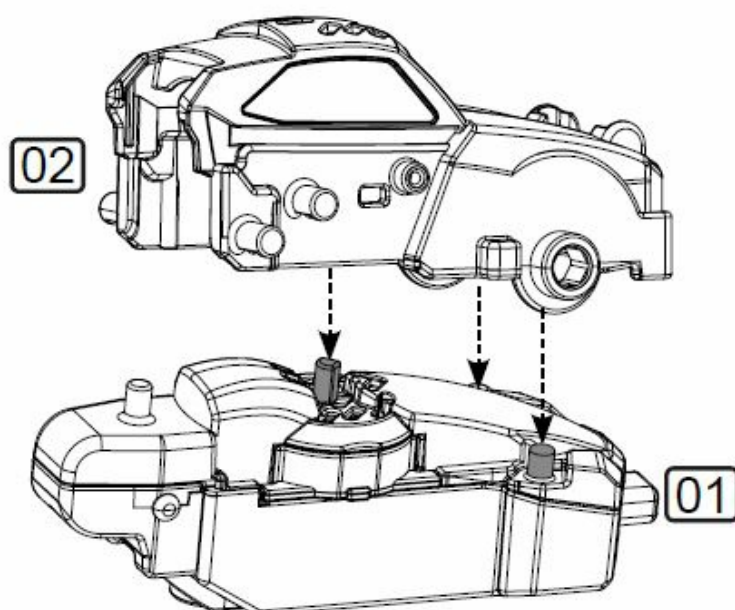

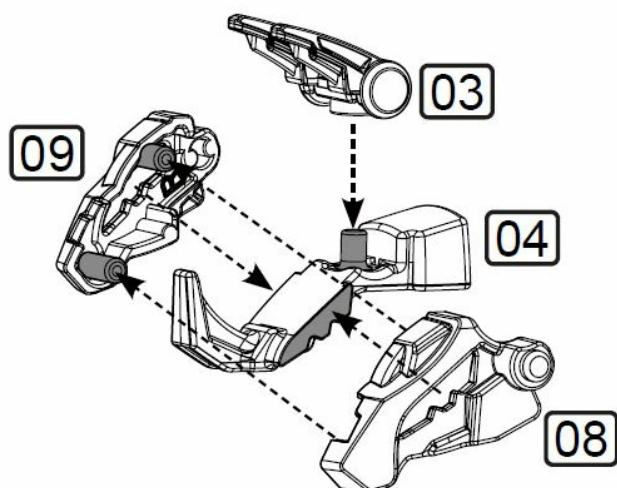
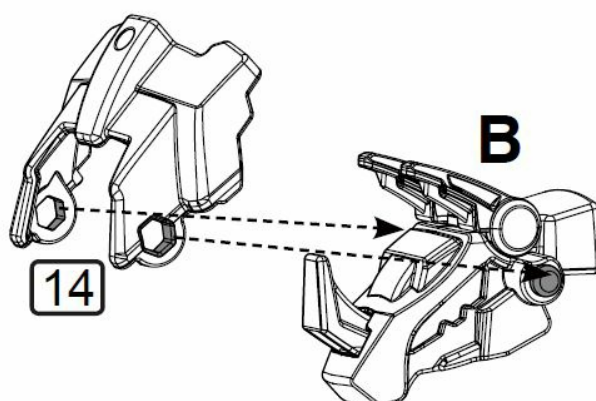
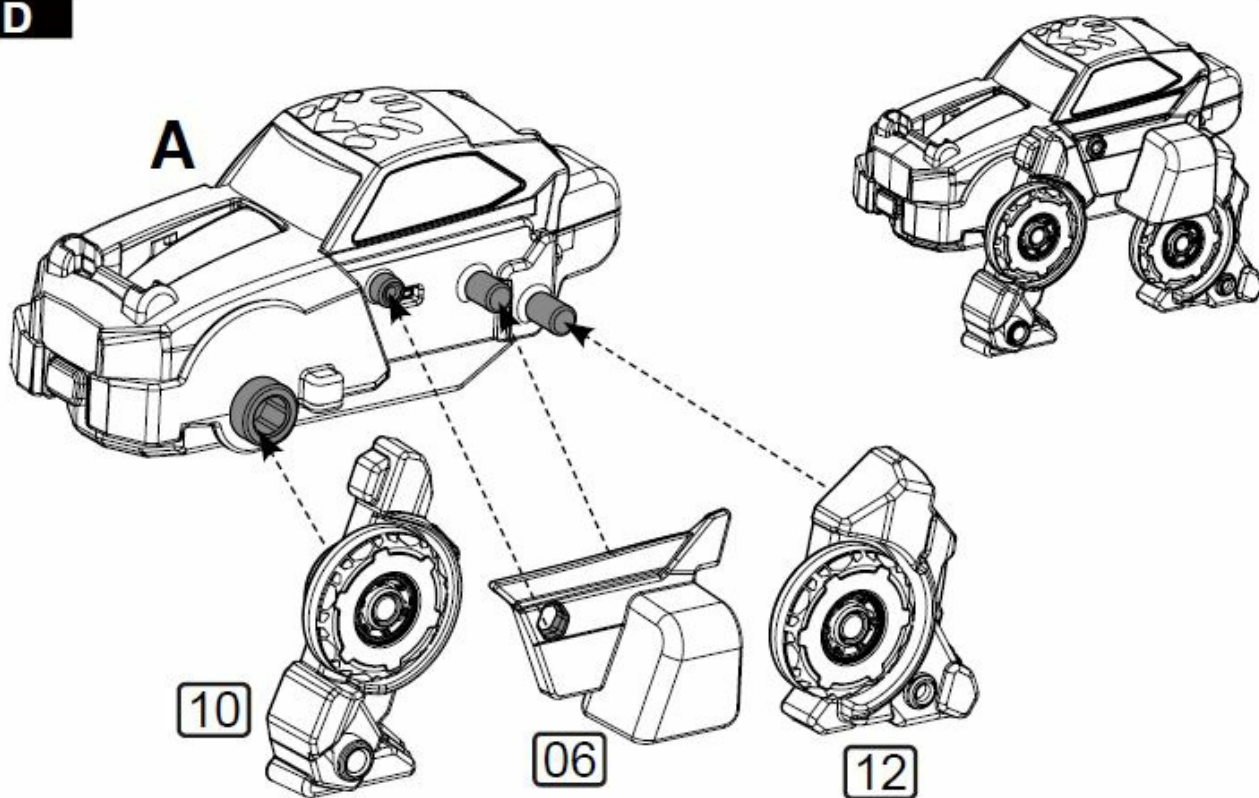
B**C****D**

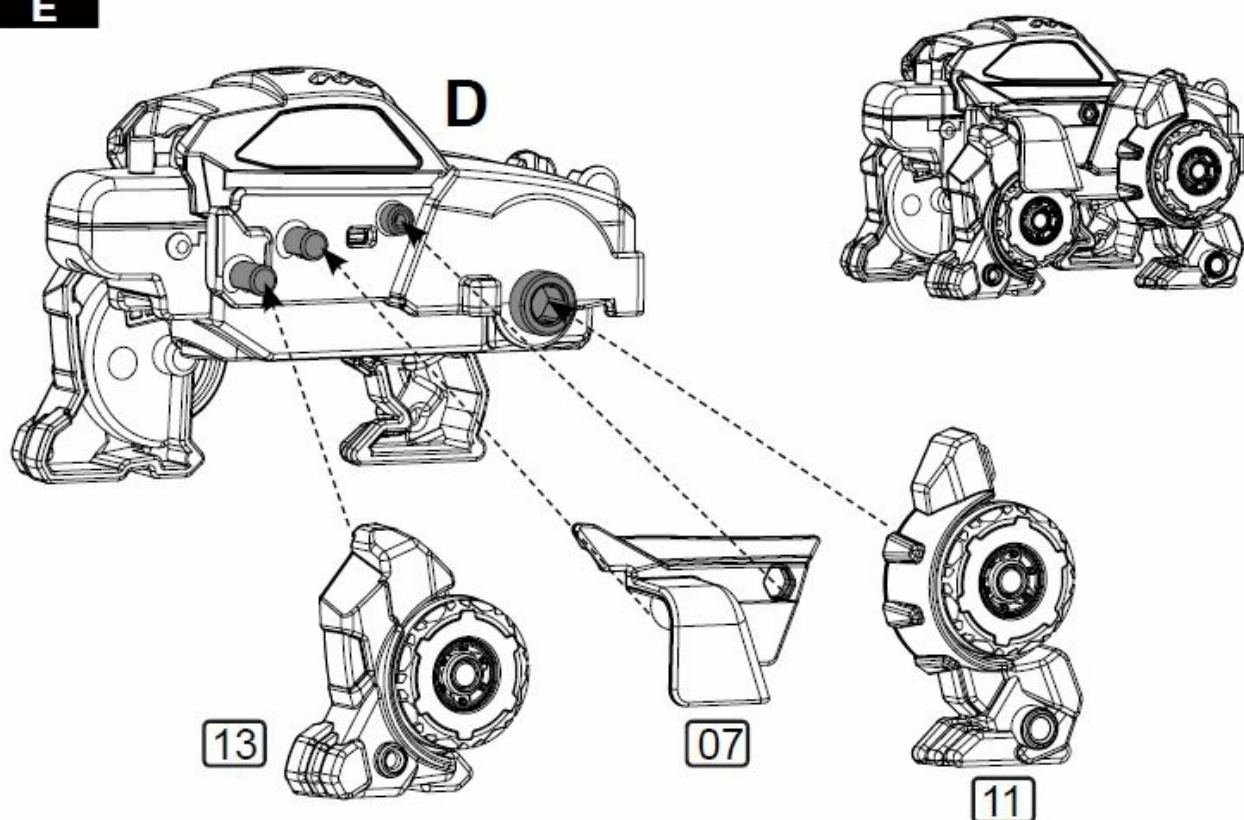
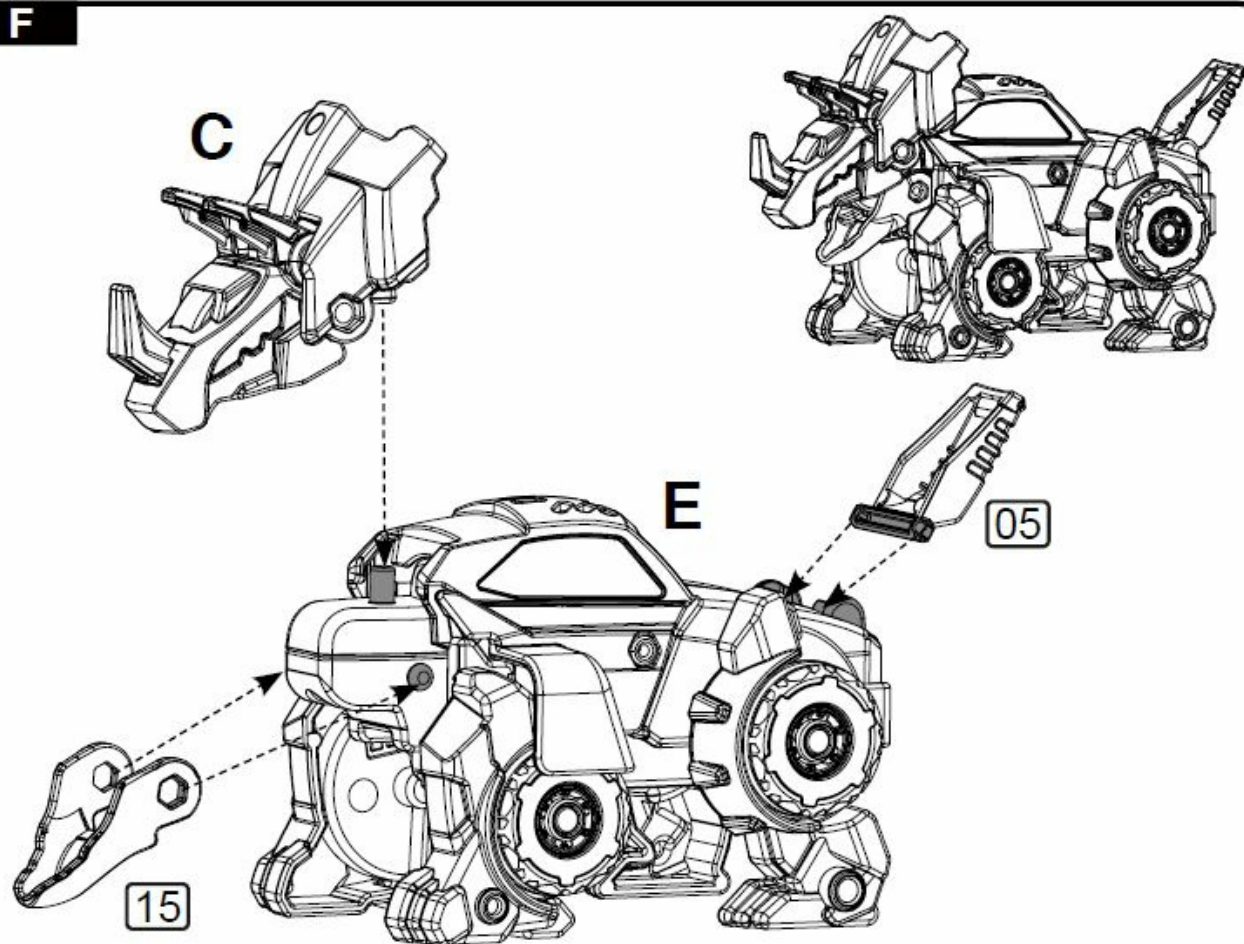
E**F**

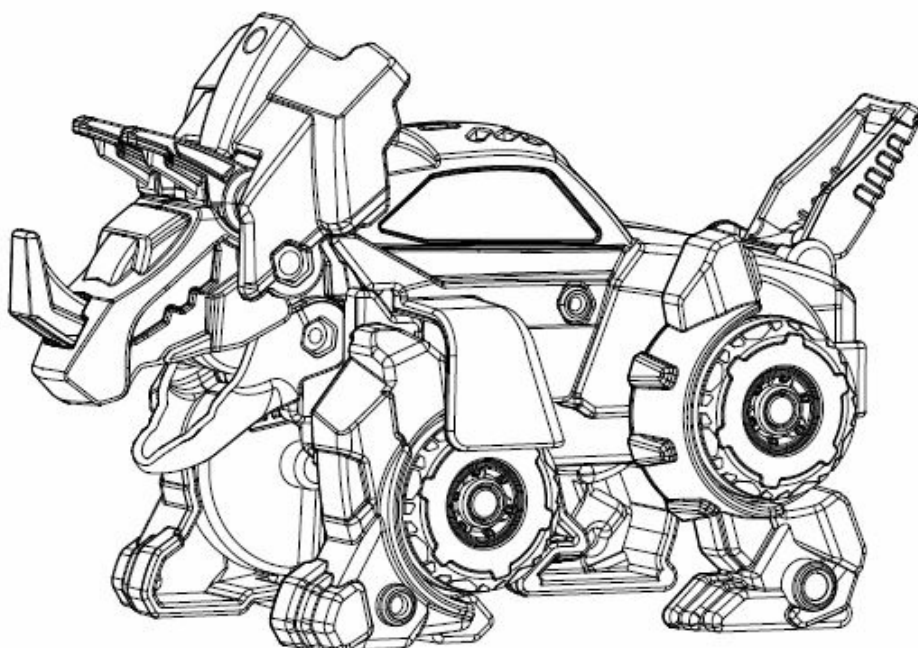
G

HOW TO SWITCH

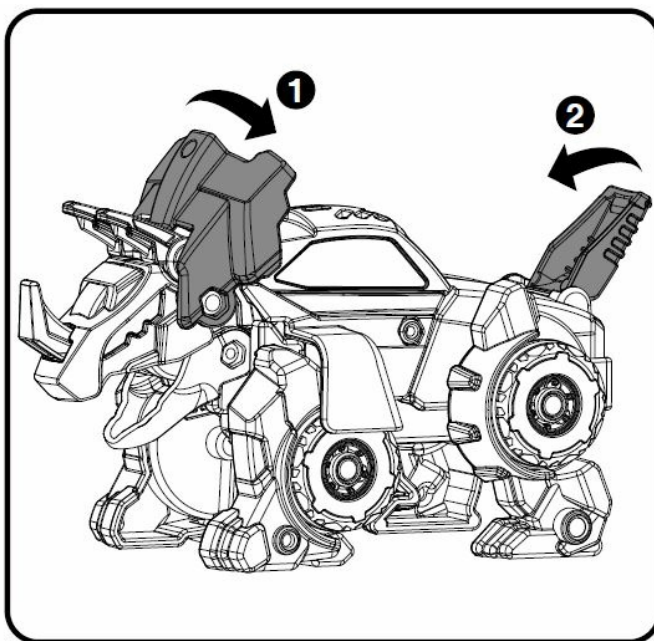
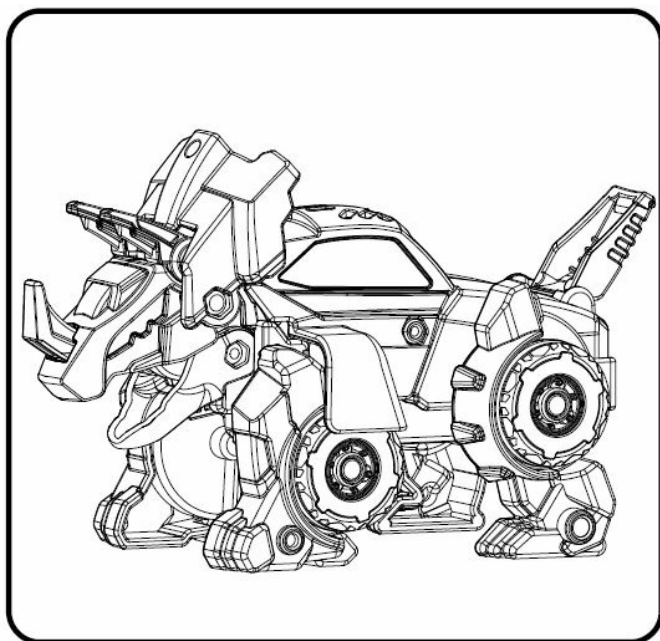

1. Dino mode.
2. Flip down the crest, then flip down the Dino's tail.

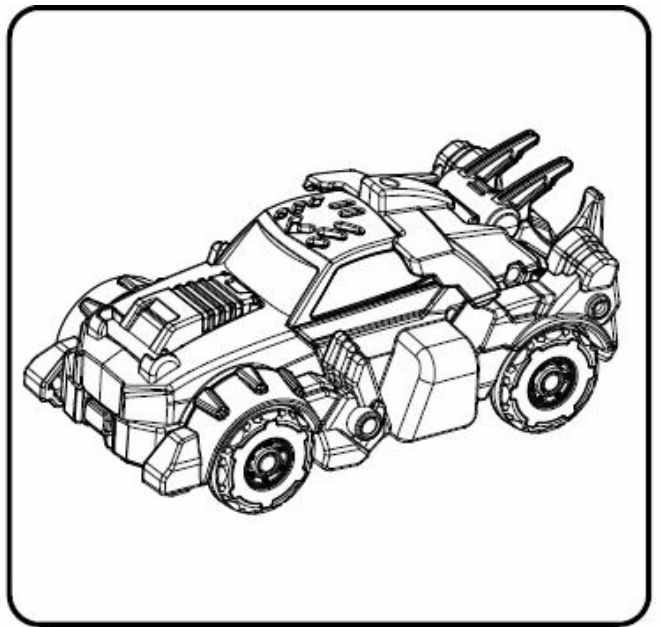
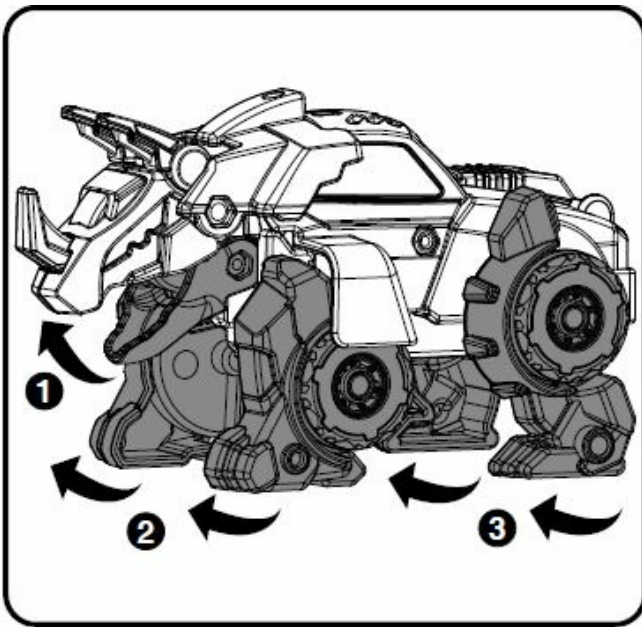

3. Close the Dino's mouth, then flip up the front legs. Next, flip up the back legs.
4. The Dino is now in Vehicle mode. Slide the Off/Dino mode/Vehicle mode Switch to Vehicle mode to play Vehicle responses.

Note: To switch from Vehicle mode to Dino mode, follow the above steps in reverse order.

EGG SHELL DINO STORAGE

Triceratops can be dismantled and stored back inside the egg shell. Follow the below steps to store Triceratops:

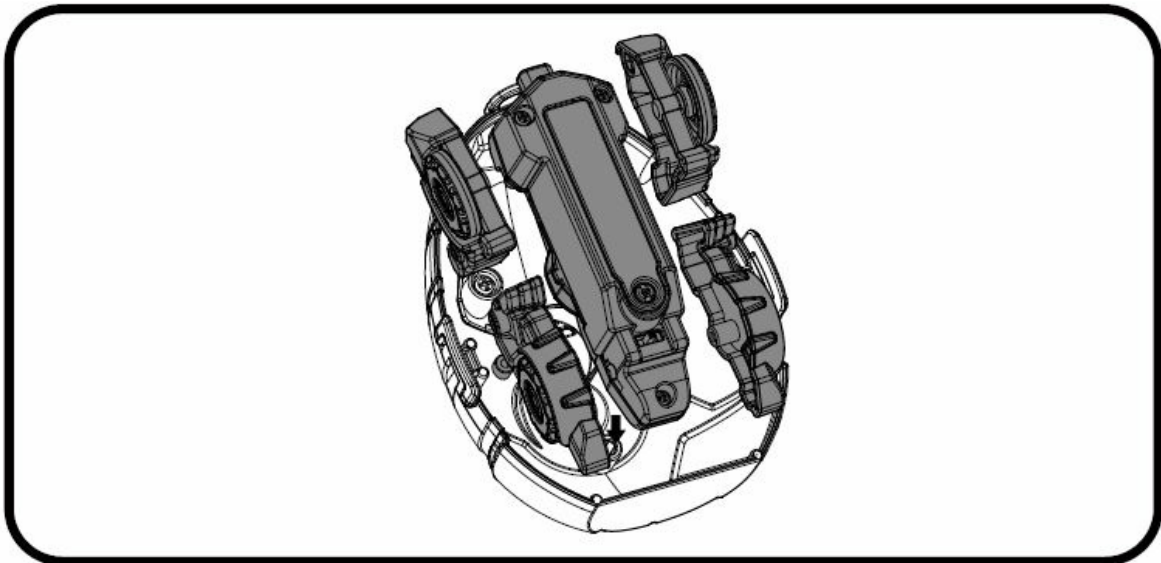

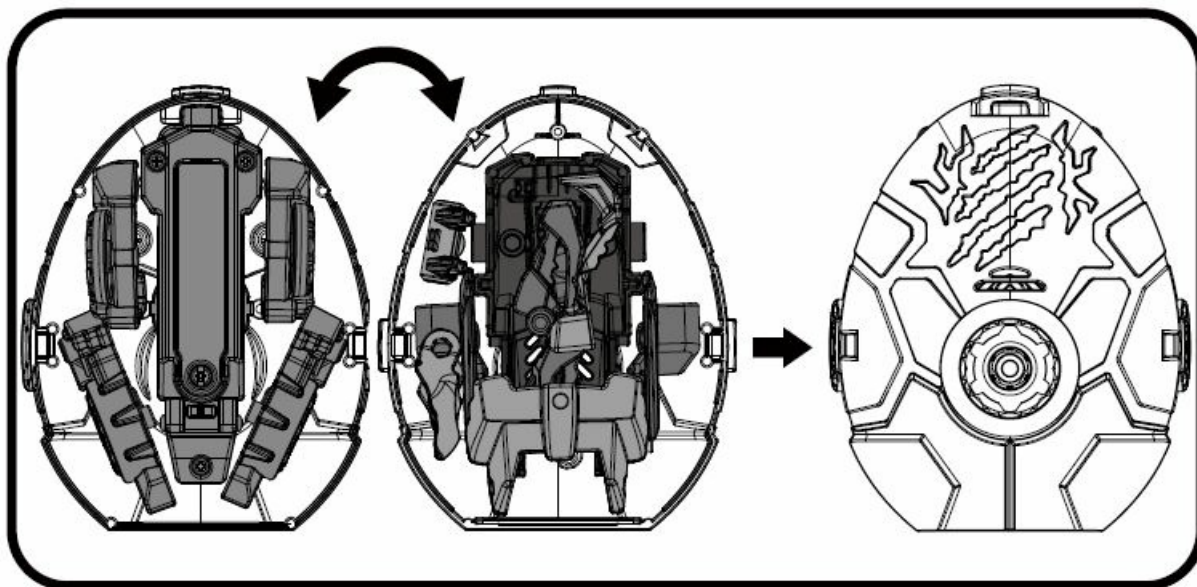

Place the battery module and the 4 dino legs into the egg shell as illustrated.



Put the remaining dino pieces into the other half of the egg shell. Then, connect the first half of the egg shell to seal.

PRODUCT FEATURES

1. OFF / DINO MODE / VEHICLE MODE SWITCH

Slide the Off / Dino Mode / Vehicle Mode Switch to turn the unit ON and choose Dino mode() or Vehicle mode() to play. Slide the Off / Dino Mode / Vehicle Mode Switch to the Off position to turn the unit OFF.

2. Talk Button

Press the Talk Button to hear fun phrases and cool dinosaur sounds in Dino mode, or hear fun phrases and great vehicle sounds in Vehicle mode.

3. AUTOMATIC SHUT-OFF

To preserve battery life, Triceratops will automatically turn off after a few seconds. Triceratops can be woken up again by pressing the Talk Button, or by switching between Dino and Vehicle modes.

NOTE

If the unit powers down or if the light flashes 3 times without sounds during play, please install a new set of batteries.

CARE & MAINTENANCE

1. Keep the unit clean by wiping it with a slightly damp cloth.
2. Keep the unit out of direct sunlight and away from any direct heat sources.
3. Remove the batteries if the unit will not be in use for an extended period of time.
4. Do not drop the unit on hard surfaces and do not expose the unit to moisture or water.

TROUBLESHOOTING

If for some reason the unit stops working or malfunctions, please follow these steps:

1. Turn the unit Off.

2. Interrupt the power supply by removing the batteries.
3. Let the unit stand for a few minutes, then replace the batteries.
4. Turn the unit On. The unit should now be ready to use again.
5. If the unit still does not work, install a new set of batteries.

If the problem persists, please contact our Consumer Services Department and a service representative will be happy to help you.

CONSUMER SERVICES

Creating and developing VTech® products is accompanied by a responsibility that we at VTech® take very seriously. We make every effort to ensure the accuracy of the information, which forms the value of our products. However, errors sometimes can occur. It is important for you to know that we stand behind our products and encourage you to call our Consumer Services Department with any problems and/or suggestions that you might have. A service representative will be happy to help you.

UK Customers:

Phone: 0330 678 0149 (from UK) or +44 330 678 0149 (outside UK) Website: www.vtech.co.uk/support

Australian Customers:

Phone: 1800 862 155

Website: support.vtech.com.au

NZ Customers:

Phone: 0800 400 785

Website: support.vtech.com.au

PRODUCT WARRANTY/ CONSUMER GUARANTEES

UK Customers:

Read our complete warranty policy online at vtech.co.uk/warranty.

Australian Customers:

VTECH ELECTRONICS (AUSTRALIA) PTY LIMITED – CONSUMER GUARANTEES

Under the Australian Consumer Law, a number of consumer guarantees apply to goods and services supplied by VTech Electronics (Australia) Pty Limited. Please refer to vtech.com.au/consumerguarantees for further information.

Visit our website for more information about our products, downloads, resources and more.

www.vtech.co.uk

www.vtech.com.au

TM & © 2022 VTech Holdings Limited. All rights reserved.

IM-559300-001

Version:0

Documents / Resources



[vtech Triceratops Switch and Go Dinos Turbo](#) [pdf] Instruction Manual

Triceratops Switch and Go Dinos Turbo, Triceratops, Switch and Go Dinos Turbo, Go Dinos Turbo, Dinos Turbo

References

- [📄 Support : VTech Electronics](#)
- [📄 Electronic Learning Toys | Best Learning Toys | VTech UK](#)
- [📄 VTech Toys Australia - Electronic Learning Toys - Best Learning Toys - VTech Australia and New Zealand](#)
- [📄 Electronic Learning Toys | Best Learning Toys | VTech UK](#)
- [📄 Electronic Learning Toys | Best Learning Toys | VTech UK](#)
- [📄 VTech Toys Australia - Electronic Learning Toys - Best Learning Toys - VTech Australia and New Zealand](#)