



vtech Spidey Learning Watch Instruction Manual

[Home](#) » [vtech](#) » vtech Spidey Learning Watch Instruction Manual 

Contents

- 1 vtech Spidey Learning Watch1
- 2 INTRODUCTION
- 3 INCLUDED IN THE PACKAGE
- 4 PRODUCT SPECIFICATION
- 5 GETTING STARTED
- 6 TO BEGIN USING
- 7 PRODUCT FEATURES
- 8 ACTIVITIES
- 9 CARE & MAINTENANCE
- 10 TROUBLESHOOTING
- 11 Documents / Resources
 - 11.1 References
- 12 Related Posts



vtech Spidey Learning Watch1



INTRODUCTION

Thank you for purchasing the Spidey Learning Watch! This full-function watch includes nine digital clock faces, time tools and four games. Hear Spidey say fun phrases and listen as the narrator guides you through crime-fighting adventures.

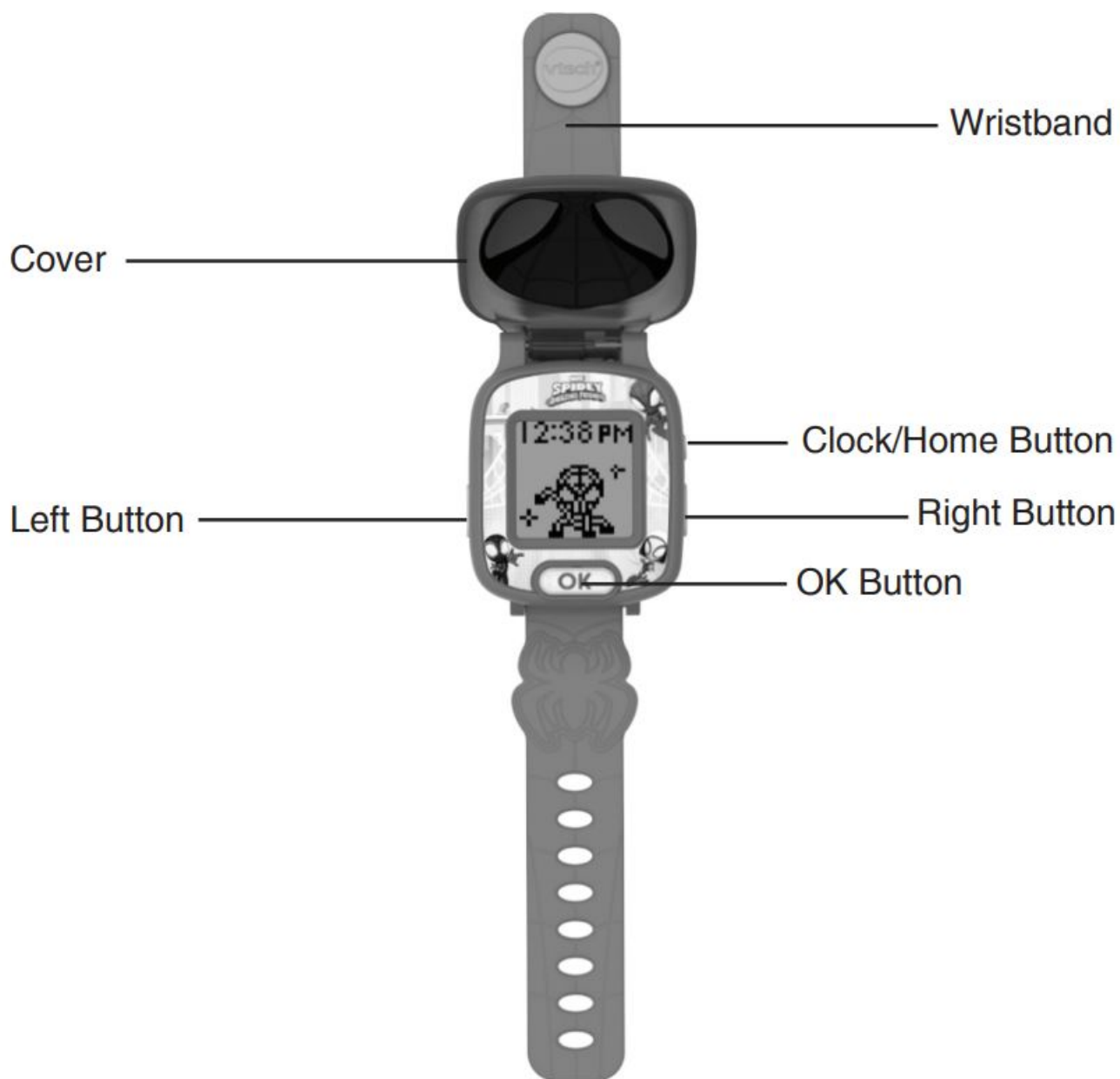

INCLUDED IN THE PACKAGE

WARNING

All packing materials such as tape, plastic sheets, packaging locks, removable tags, cable ties, cords and packaging screws are not part of this toy, and should be discarded for your child's safety.

NOTE

Please save this Instruction Manual as it contains important information.

PRODUCT SPECIFICATION

| | |
|-------------------------------|---------------------------|
| Battery | One CR2450 battery |
| Time Format | 12h or 24h |
| Display | Digital |
| Optimum Operating Temperature | 32°F – 104°F (0°C – 40°C) |

Important Note

- Do not place the watch under running water.
- Do not submerge. Not suitable for showering, bathing or swimming.
- Keep the cover closed when the watch is not in use.

WARNING

People with very sensitive skin may notice some irritation after wearing the Spidey Learning Watch for extended periods of time. The skin may become irritated when moisture, sweat, soap, or other irritants get trapped under the wristband and are left in contact with the skin. To prevent this, we suggest children remove the watch before going to bed for the night, take the watch off if it's feeling uncomfortable, and keep their wrist and the band clean and dry. In addition, wearing the watch too tightly may also cause irritation. Make sure the fit is good—tight enough so the watch stays in place but not so tight that it's uncomfortable. If you notice any redness, swelling, or other irritation, you may want to consult a doctor before wearing the watch again.

GETTING STARTED

Battery Removal and Installation

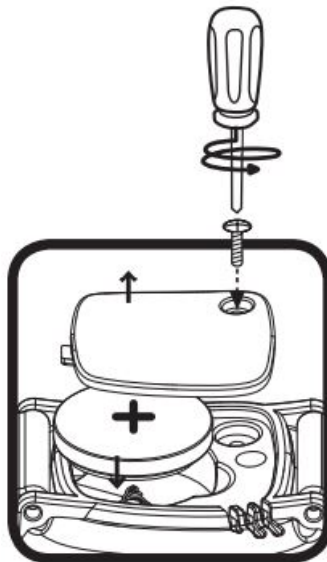

1. Close the cover of the watch.
2. Find the battery cover located on the back of the unit, use a screwdriver to loosen the screw and then open the battery cover.
3. Remove the old battery by pulling up on one end of the battery.
4. Install one new CR2450 battery following the diagram inside the battery cover.
5. Replace the battery cover and tighten the screw to secure.

WARNING:

Adult assembly required for battery installation. Keep batteries out of reach of children.

IMPORTANT: BATTERY INFORMATION

- Insert batteries with the correct polarity (+ and -).
- Do not mix old and new batteries.

- Do not mix alkaline, standard (carbon-zinc) or rechargeable batteries.
- Only batteries of the same or equivalent type as recommended are to be used.
- Do not short-circuit the supply terminals.
- Remove batteries during long periods of non-use.
- Remove exhausted batteries from the toy.
- Dispose of batteries safely. Do not dispose of batteries in fire.

RECHARGEABLE BATTERIES

- Remove rechargeable batteries (if removable) from the toy before charging.
- Rechargeable batteries are only to be charged under adult supervision.
- Do not charge non-rechargeable batteries.

WARNING

This product contains one button cell or coin battery. If swallowed, a button cell or coin battery can cause internal chemical burns in as little as two hours and can lead to death. Dispose of used batteries immediately. Keep new and used batteries away from children. If you think batteries might have been swallowed or placed inside any part of the body, seek immediate medical attention, and go straight to the nearest hospital emergency department.

Australia/New Zealand:

If you suspect your child has swallowed or placed a button cell/coin battery inside any part of their body, immediately call the 24-hour Poisons Information Centre on 13 11 26 (in Australia) or 24-hour National Poisons Centre on 0800 764 766 (in New Zealand) for fast, expert advice and go straight to the nearest hospital emergency room.

TO BEGIN USING

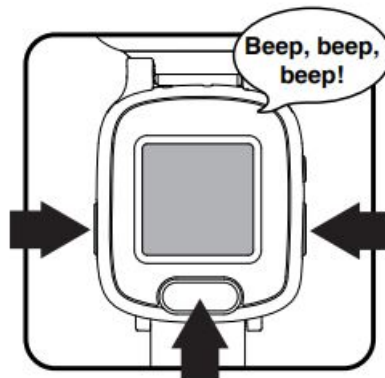

When you use the watch for the first time, you must unlock it from Try-Me mode to play. To unlock from Try-Me mode, open the Cover, and press the Left + Right + OK Buttons together for approximately five seconds. You will then hear three beeping sounds to indicate it has been unlocked. Press any button to activate the watch and set the time. Press the Left or Right Buttons to select, then press the OK Button to confirm and move to the next option. A checkmark will be displayed when the setting is complete.

Note:

- When the battery level is low, most functions on the watch may not be activated, except for the clock display. It is recommended to install a new battery as soon as possible before further use.
- If the battery level is too low and cannot keep the clock running, you will need to enter the time again after the battery has been replaced.

PRODUCT FEATURES

Cover

Open the Cover to view the time. When the Cover is closed, tap the bottom of the Cover to activate character voices and sounds with a light effect.

Left/Right Buttons

Use the Left or Right Buttons to select an activity or option.

OK Button OK

Press the OK Button to confirm a selection and move to the next option in different activities.

Clock/Home Button

Press the Clock/Home Button to return to the clock from any other function or activity.

Clock Display

When the Clock/Home Button is pressed, the time will be displayed. Press the Left or Right Buttons to display the Home Menu where other activities can be selected.\

Home Menu

Press the Left or Right Buttons to display the Home Menu. There are five activities to choose from:

- Press the Left or Right Buttons to scroll through the menu options.
- Press the OK Button to enter the chosen activity.

Alarm Clock



- Press the Left or Right Buttons to select the time and choose between three alarm tones.
- Press the OK Button to confirm and move to the next setting.
- Press the Clock/Home Button to automatically save the current setting.

Stopwatch

- Press the OK Button to start the Stopwatch, press again to stop.
- When the Stopwatch is stopped, you can press the Left or Right Buttons to reset.



Timer

- Press the Left or Right Buttons to change the time.
- Press the OK Button to confirm.
- Press the Clock/Home Button to automatically save the current setting.
- Press the OK Button to confirm the Timer duration and the countdown will start immediately.
- While the Timer is running, press the OK Button to pause/resume or press the Left or Right Buttons to reset.

Settings

In the Settings menu, press the Left or Right Buttons to scroll through the various options:

Setting the time-setting the Time



- Press the Left or Right Buttons to change the options. (The AM/PM setting is only applicable in 12-hour time format)
- Press the OK Button to confirm.
- Press the Clock/Home Button to automatically save the current setting.

Clock Face

- Press the Left or Right Buttons to select from nine different clock faces.
- Press the OK Button or Clock/Home Button to confirm and save the setting.



Cuckoo Clock

- Press the Left or Right Buttons to turn the Cuckoo Clock on or off.
- Press the OK Button or Clock/Home Button to confirm and save the setting.
- Please note that when the Cuckoo Clock is activated, the watch will chime at the top of each hour between 7 AM and 7 PM, unless a game is currently in progress.

Automatic Shut-Off

To preserve battery life, the Spidey Learning Watch will automatically shut off after approximately 30 seconds without input. The unit can be turned on again by pressing any button or opening the cover.

Note:

The Spidey Learning Watch will not automatically power off when the Stopwatch is running. The unit will automatically turn Off when the battery power is very low. If you see the Low Battery icon appear on screen, please replace the battery.

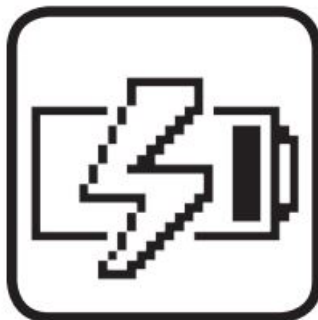

ACTIVITIES



Games

In the Games menu, press the Left or Right Buttons to scroll through the different learning game options:

Laser Craze

Dodge Doc Ock's lasers to help Spidey get the stolen Energy Star back. Press the Left or Right Buttons to dodge the laser.

Goblin Bubble Blast

Count the bubbles to help Spidey flip over Goblin's glider. Press the Left or Right Buttons to choose and press the OK Button to confirm.

Tire Track Pattern Match

Follow the tire tracks to find a child's missing scooter with Ghost Spider. Press the Left or Right Buttons to choose the matching pattern and press the OK Button to confirm.

Rhino Robbery

Select the path with the correct letter to help Miles catch Rhino. Press the Left or Right Buttons to choose and press the OK Button to confirm.

CARE & MAINTENANCE

1. Keep the unit clean by wiping it with a slightly damp cloth.
2. Keep the unit out of direct sunlight and away from any direct heat sources.

3. Remove the battery if the unit will not be in use for an extended period of time.
4. Do not drop the unit on hard surfaces and do not expose the unit to moisture or water.

TROUBLESHOOTING

If for some reason the unit stops working or malfunctions, please follow these steps:

1. Interrupt the power supply by removing the battery.
2. Let the unit stand for a few minutes, then replace the battery.
3. The unit should now be ready to use again.
4. If the unit still does not work, install a new battery.

IMPORTANT NOTE:

If the problem persists, please call our Consumer Services Department at 1-800-521-2010 in the U.S., 1-877-352-8697 in Canada, or by going to our website vtechkids.com and filling out our Contact Us form located under the Customer Support link. Creating and developing VTech products is accompanied by a responsibility that we take very seriously. We make every effort to ensure the accuracy of the information, which forms the value of our products. However, errors sometimes can occur. It is important for you to know that we stand behind our products and encourage you to contact us with any problems and/or suggestions you might have. A service representative will be happy to help you.

NOTE



This equipment has been tested and found to comply with the limits for a Class B digital device, pursuant to Part 15 of the FCC Rules. These limits are designed to provide reasonable protection against harmful interference in a residential installation. This equipment generates, uses and can radiate radio frequency energy and, if not installed and used in accordance with the instructions, may cause harmful interference to radio communications. However, there is no guarantee that interference will not occur in a particular installation. If this equipment does cause harmful interference to radio or television reception, which can be determined by turning the equipment off and on, the user is encouraged to try to correct the interference by one or more of the following measures:

- Reorient or relocate the receiving antenna.
- Increase the separation between the equipment and receiver.
- Connect the equipment into an outlet on a circuit different from that to which the receiver is connected.
- Consult the dealer or an experienced radio/TV technician for help.

CAUTION

Changes or modifications not expressly approved by the party responsible for compliance could void the user's authority to operate the equipment.

Documents / Resources

| | |
|---|---|
|  | vtech Spidey Learning Watch [pdf] Instruction Manual Spidey Learning Watch, Learning Watch |
|  | vtech SPIDEY Learning Watch [pdf] Instruction Manual SPIDEY Learning Watch, SPIDEY Watch, Spidey Amazing Friends, Learning Watch |

References

- [📞 Support : VTech Electronics](#)
- [📑 Electronic Learning Toys | Best Learning Toys | VTech UK](#)
- [📑 VTech Toys Australia - Electronic Learning Toys - Best Learning Toys - VTech Australia and New Zealand](#)
- [📑 VTech Canada | Official Electronic Learning Toys & Games for Kids](#)
- [📑 VTech Canada | Official Electronic Learning Toys & Games for Kids](#)
- [📑 Best Kids Tech Toys | Electronic Learning Toys | VTech America](#)
- [📑 Best Kids Tech Toys | Electronic Learning Toys | VTech America](#)
- [📑 Electronic Learning Toys | Best Learning Toys | VTech UK](#)
- [📑 Electronic Learning Toys | Best Learning Toys | VTech UK](#)
- [📑 VTech Toys Australia - Electronic Learning Toys - Best Learning Toys - VTech Australia and New Zealand](#)