



## vtech Remote Control Cory User Guide

[Home](#) » [vtech](#) » vtech Remote Control Cory User Guide 



Parent's Guide  
Remote Control Cory



VTech understands that a child's needs and abilities change as they grow and with that in mind we develop our toys to teach and entertain at just the right level...

<b>vtech Baby</b>	<b>Toys that will teach stimulate the ir interest in different textures, s ounds, and colors.</b>	I am ...responding to colors, sound s, and textures ...understanding cause and effect ...learning to touch, reach, grasp, s it-up, crawl and
<b>Pre-School</b>	<b>Interactive toys to develop their i magination and encourage langu age development</b>	I Want...to get ready for school by s tarting to learn the alphabet and co unting ...my learning to be as fun, easy, a nd exciting as can be ...to show my creativity with drawin g and music so my whole brain dev elops
<b>Electronic Learning Computers</b>	<b>Cool, aspirational and inspiring c omputers for curriculum-related l earning</b>	...challenging activities that can ke ep pace with my growing mind ...intelligent technology that adapts to my level of learning ...National Curriculum based conte nt to support what I'm learning at sc hool

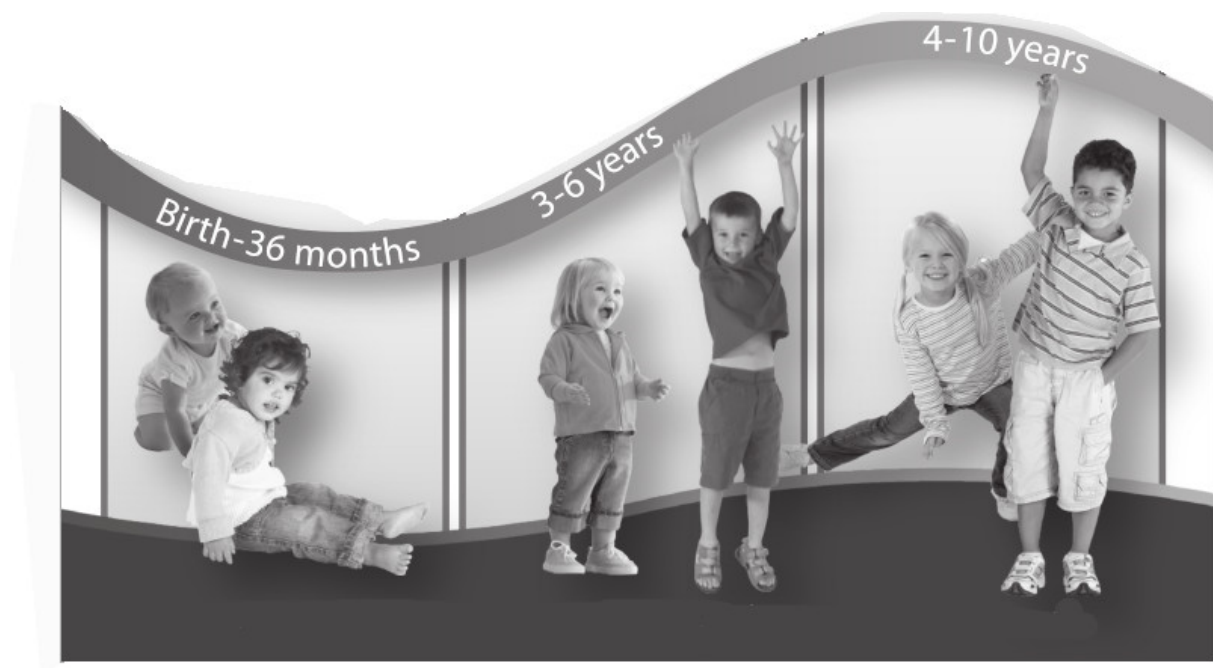

To learn about this and other VTech® products, visit [www.vtech.co.uk](http://www.vtech.co.uk)

## Contents

- 1 INTRODUCTION
- 2 INCLUDED IN THIS PACKAGE
- 3 INSTRUCTIONS
- 4 IMPORTANT: BATTERY INFORMATION
- 5 PRODUCT FEATURES
- 6 ACTIVITIES
- 7 CARE & MAINTENANCE
- 8 TROUBLESHOOTING
- 9 CONSUMER SERVICES
- 10 VTECH ELECTRONICS (AUSTRALIA) PTY LIMITED – CONSUMER GUARANTEES
- 11 Documents / Resources
  - 11.1 References
- 12 Related Posts

## INTRODUCTION

Thank you for purchasing the VTech® Toot-Toot Cory Carson ® Remote Control Cory!

Let's have fun with Cory! Use the two-button remote control to move Cory forward or reverse the spin! Press the light-up button to hear fun phrases, sounds, and music from the show.

Come on, let's go!

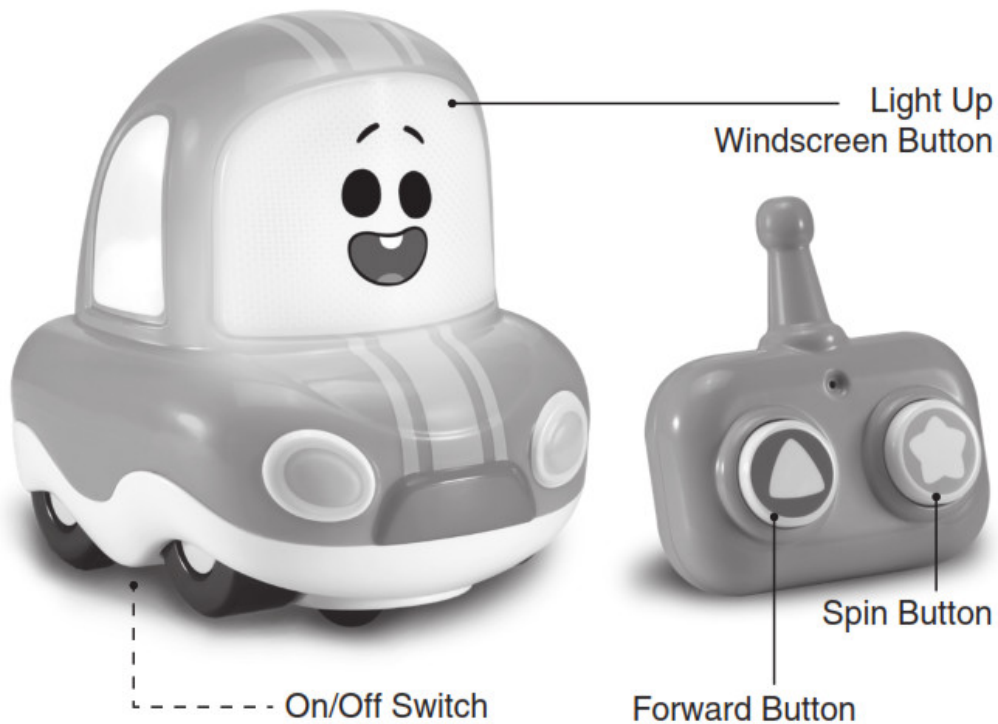

## INCLUDED IN THIS PACKAGE

### Toot-Toot Cory Carson® Remote Control Cory

- One remote control
- One Parent's Guide

#### **WARNING:**

All packing materials such as tape, plastic sheets, packaging locks, removable tags, cable ties, cords, and packaging screws are not part of this toy and should be discarded for your child's safety.

#### **NOTE:**

Please keep this Parent's Guide as it contains important information.

### Removing the Packaging Locks:

1. Turn the packaging locks anticlockwise several times.
2. Pull out the packaging locks and discard them.

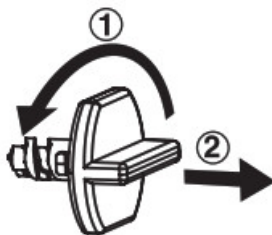

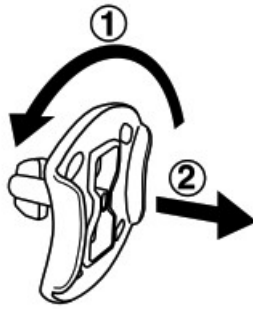

1. Rotate the packaging locks 90 degrees anticlockwise.
2. Pull out the packaging locks and discard them.

## INSTRUCTIONS

### BATTERY REMOVAL AND INSTALLATION

#### Car

1. Make sure the unit is turned OFF.
2. Locate the battery cover on the bottom of the unit. Use a screwdriver to loosen the screw.
3. If used batteries are present, remove these batteries from the unit by pulling up one end of each battery.
4. Install 4 new AA (AM-3/LR6) batteries following the diagram inside the battery box.  
(For best performance, alkaline batteries or fully charged Ni-MH rechargeable batteries are recommended).
5. Replace the battery cover and tighten the screw to secure.

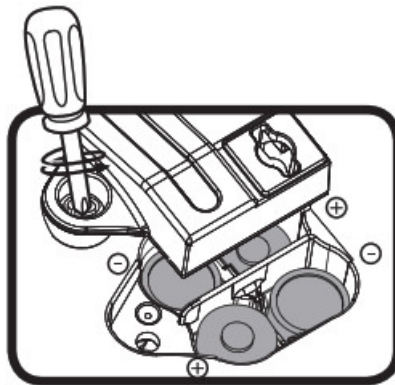

#### Remote Control

1. Make sure the unit is turned OFF.
2. Locate the battery cover on the back of the unit. Use a screwdriver to loosen the screw.
3. If used batteries are present, remove these batteries from the unit by pulling up one end of each battery.
4. Install 2 new AAA (AM-4/LR03) batteries following the diagram inside the battery box.  
(For best performance, alkaline batteries or fully charged Ni-MH rechargeable batteries are recommended).
5. Replace the battery cover and tighten the screw to secure.

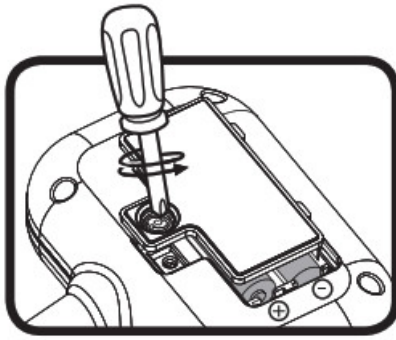
**WARNING:**

Adult assembly is required for battery installation.  
Keep batteries out of reach of children.

**IMPORTANT: BATTERY INFORMATION**

- Insert batteries with the correct polarity (+ and -).
- Do not mix old and new batteries.
- Do not mix alkaline, standard (carbon-zinc), or rechargeable batteries.
- Only batteries of the same or equivalent type as recommended are to be used.
- Do not short-circuit the supply terminals.
- Remove batteries during long periods of non-use.
- Remove exhausted batteries from the toy.
- Dispose of batteries safely. Do not dispose of batteries in a fire.

**RECHARGEABLE BATTERIES:**

- Remove rechargeable batteries from the toy before charging.
- Rechargeable batteries are only to be charged under adult supervision.
- Do not charge non-rechargeable batteries.

**Disposal of batteries and product**

The crossed-out wheeled bin symbols on products and batteries, or on their respective packaging, indicates they must not be disposed of in domestic waste as they contain substances that can be damaging to the environment and human health.

The chemical symbols Hg, Cd, or Pb, where marked, indicate that the battery contains more than the specified value of mercury (Hg), cadmium (Cd) or lead (Pb) set out in the Batteries and Accumulators Regulation.



The solid bar indicates that the product was placed on the market after 13th August 2005. Help protect the environment by disposing of your product or batteries responsibly.  
VTech @cares for the planet.

Care for the environment and give your toy a second life by disposing of it at a small electricals collection point so all its materials can be recycled. In the UK:

Visit [www.recyclenow.com](http://www.recyclenow.com) to see a list of collection points near you.

In Australia & New Zealand:

Check with your local council for curbside collections.

## PRODUCT FEATURES

### 1. On/Off Switch

To turn the unit ON, slide the ON/ OFF Switch to the ON  position. To turn the unit OFF, slide the ON/ OFF Switch to the OFF position.

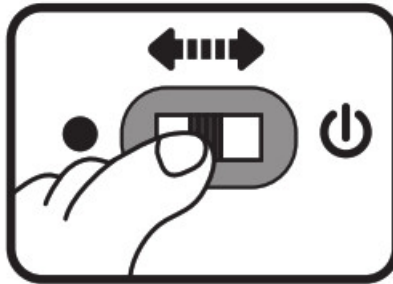

### 2. Remote Control

Use the Forward Button to move Cory forward and the Spin Button to reverse spin. Cory will play fun sounds while driving.



### 3. Automatic Shut-Off

To preserve battery life, Remote Control Cory will power down after approximately 100 seconds without input. The unit can be turned on again by pressing Cory's Light Up Button.

If the Forward Button or Spin Button is held for more than 15 minutes, the Remote Control and the car will go into sleep mode. The Remote Control will not work if the vehicle is in sleep mode.

#### **Note:**

If the unit repeatedly powers down while playing or the light fades out, we suggest changing the batteries.

#### **Note:**

This product is in Try-Me mode in the packaging. After opening the package, turn the unit off and on again to proceed with normal play. If the unit powers down while playing, please install a new set of batteries.

#### **Note:**

This toy's ideal operating temperature range: 0° – 35°C (32° – 95°F)

### **IMPORTANT:**

1. For optimal performance, please use Remote Control Cory on a flat, smooth surface.
2. For your child's safety, do not place or roll the car on clothing, body or hair. Especially when the RC is turned on.
3. If something gets caught in the wheels, lift the car up, slide the ON/OFF SWITCH to the OFF position and remove the obstruction.

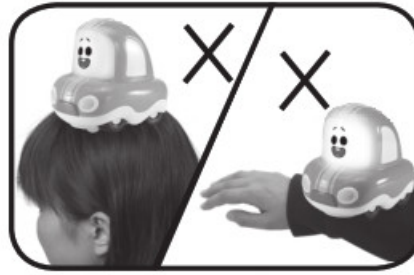

## ACTIVITIES

### 1. Light Up Button

Press the Light-Up Button to hear fun songs, exciting phrases, sounds and music. The light will flash with the sounds.

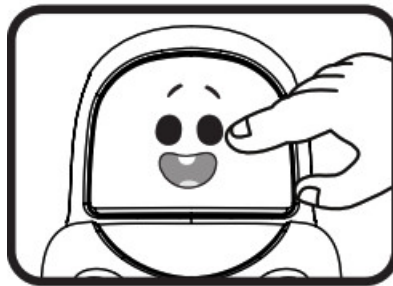

### 2. Forward Button

Press the Forward Button to move Cory forward with fun sounds and phrases. The light will flash with the sounds.



### 3. Spin Button

Press the Spin Button to reverse spin while playing fun sounds and phrases. The light will flash with the sounds.



## CARE & MAINTENANCE

1. Keep the unit clean by wiping it with a slightly damp cloth.
2. Keep the unit out of direct sunlight and away from any direct heat sources.
3. Remove the batteries when the unit will not be in use for an extended period of time.
4. Do not drop the unit on hard surfaces and do not expose the unit to moisture or water.



## TROUBLESHOOTING

If for some reason the unit stops working or malfunctions, please follow these steps:

1. Please turn the unit OFF.
2. Interrupt the power supply by removing the batteries.
3. Let the unit stand for a few minutes, then replace the batteries.
4. Turn the unit ON. The unit should now be ready to play again.
5. If the product still does not work, replace it with an entire set of new batteries.

If the problem persists, please contact our Consumer Services Department and a service representative will be happy to help you.

### DECLARATION OF CONFORMITY

Hereby, VTech Electronics Europe BV declares that the radio equipment type 5459 is in compliance with Directive 2014/53/EU. The full text of the EU declaration of conformity is available at the following internet address:

[www.vtech.com/re-directive](http://www.vtech.com/re-directive)

Frequency Band: 2414MHz – 2474MHz

Maximum RF power: 0.000335W(-4.74dBm)

### DECLARATION OF CONFORMITY

Hereby, VTech Electronics Europe Plc declares that the radio equipment type 5459 is in compliance with The Radio Equipment Regulations 2017 (2017 No.1206). The full text of the Declaration of conformity is available at the following internet address:

[www.vtech.com/re-directive](http://www.vtech.com/re-directive)

Frequency Band: 2414MHz – 2474MHz

Maximum RF power: 0.000335W(-4.74dBm)

#### RF warning statement:

The device has been evaluated to meet general RF exposure requirements. The device can be used in portable exposure conditions without restriction.

## CONSUMER SERVICES

Creating and developing VTech ® products is accompanied by a responsibility that we at VTech ® take very seriously. We make every effort to ensure the accuracy of the information, which forms the value of our products. However, errors sometimes can occur. It is important for you to know that we stand behind our products and encourage you to call our Consumer Services Department with any problems and/or suggestions that you might have. A service representative will be happy to help you.

#### UK Customers:

Phone: 0330 678 0149 (from UK) or +44 330 678 0149 (outside UK)

Website: [www.vtech.co.uk/support](http://www.vtech.co.uk/support)

#### Australian Customers:

Phone: 1800 862 155

Website: [support.vtech.com.au](http://support.vtech.com.au)

#### NZ Customers:

Phone: 0800 400 785

Website: [support.vtech.com.au](http://support.vtech.com.au)

PRODUCT WARRANTY/

CONSUMER GUARANTEES

#### UK Customers:

Read our complete warranty policy online at [vtech.co.uk/warranty](http://vtech.co.uk/warranty).

Australian Customers:

## VTECH ELECTRONICS (AUSTRALIA) PTY LIMITED – CONSUMER GUARANTEES

Under the Australian Consumer Law, a number of consumer guarantees apply to goods and services supplied by VTech Electronics (Australia) Pty Limited. Please refer to [vtech.com.au/consumerguarantees](http://vtech.com.au/consumerguarantees) for further information.

Visit our website for more information about our products, downloads, resources, and more.

[www.vtech.co.uk](http://www.vtech.co.uk)  
[www.vtech.com.au](http://www.vtech.com.au)



TM & © 2021 VTech Holdings Limited.  
All rights reserved.  
IM-545900-001  
Version:0

### Documents / Resources

 The image shows the packaging for the Vtech Remote Control Cory toy. It features a cartoon character named Cory, a small robot-like figure, and a remote control. The text on the packaging includes "vtech", "Parent's Guide", "TOO-TOOT CORY CARSON", and "Remote Control Cory".	<p><a href="#">vtech Remote Control Cory</a> [pdf] User Guide Remote Control Cory, Too-Toot Cory Carson</p>
--	---

### References

- [🔗 Support : VTech Electronics](#)
- [✔ Electronic Learning Toys | Best Learning Toys | VTech UK](#)
- [✔ Electronic Learning Toys | Best Learning Toys | VTech UK](#)
- [✔ Electronic Learning Toys | Best Learning Toys | VTech UK](#)
- [✔ VTech Toys Australia - Electronic Learning Toys - Best Learning Toys - VTech Australia and New Zealand](#)
- [✔ VTech | Product Support](#)