



vtech Installing E-Smart W960 Thermostat User Manual

[Home](#) » [vtech](#) » vtech Installing E-Smart W960 Thermostat User Manual 

Contents

- [1 vtech Installing E-Smart W960 Thermostat](#)
- [2 Product Information](#)
- [3 Product Usage Instructions](#)
- [4 BEFORE YOU BEGIN](#)
- [5 LET'S GET STARTED](#)
- [6 Documents / Resources](#)
- [7 Related Posts](#)



vtech Installing E-Smart W960 Thermostat



Product Information

The E-Smart W960 Thermostat is a smart thermostat designed for use with PTAC (Packaged Terminal Air Conditioners) or Heat Pump systems. It allows for easy control and customization of your heating and cooling settings.

Key Features:

- Compatible with PTAC and Heat Pump systems
- Smartphone app for easy setup and configuration
- USB-C input terminal for device connectivity
- LED indicator for pairing status
- Adjustable target temperature settings
- Short-cycle protection to prevent compressor activation after power-up

Product Usage Instructions

1. Power down the PTAC and remove the cover.
2. Using a Philips screwdriver, remove the cover panel to access the Wired Thermostat Terminal panel.
3. Using a precision screwdriver, change the Dip Switches positions for S3 (Up/On) and S9 (Dn/Off) to enable Wall Thermostat control.
 - S3 – UP/ON
 - S9 – DOWN/OFF
4. Attach the VTech Wiring Harness to the appropriate wired thermostat terminals.
5. Plug the VTech Wiring Harness into the Controller module. Press the connector firmly to ensure it snaps into

place securely. Then, restore power to the PTAC/PTHP.

6. Install the batteries into the thermostat. Tap any key to wake the thermostat. The LED on the controller will change from alternating Green/Red to solid green to indicate it is paired.

7. Prepare the thermostat for configuration:

1. Tap the Menu icon to wake the thermostat.
2. Use Menu and up/down to select: System Settings > System Configuration > Adv Config via App > Plug cable for setup
3. Plug the USB-C cable into the thermostat.

8. Using the App, provision the thermostat:

- Tap installation to begin
- Select a stored profile
- Assign room number (optional)
- Verify security pin
- Confirm wiring diagram
- Tap start to begin

9. Once the setup is completed, remove the cable, and the thermostat will reboot.

10. Test your system:

- Tap any key to wake, then use the UP/DOWN arrows to adjust the target temperature.
- Verify heat first, then cool.
- **Note:** Short-cycle protection will prevent the compressor from activating for approximately 3 minutes after power up.

11. Mount the controller to the PTAC chassis and secure the wiring. Cover/protect unused wire leads. Route the wires so they do not sag into the condensation pan.

12. Replace the cover panel and cover.

13. Use the included mounting hardware to mount the thermostat wall plate to the wall, then secure the thermostat to the wall plate using the security screw. The installation is complete.

BEFORE YOU BEGIN

Search the Google Play store for the “VTech EC Tool” app or scan the QR code below to access the app and installation documents on the VTech site. Download and install the app (.apk file) on your Android smartphone or tablet.



Open the EC Tool app, tap menu > profiles, then follow the prompts for creating a customized profile for your PTAC or Heat Pump. This profile will be used later to provision your thermostats.

Note:

You must create separate profiles for Conventional PTACs vs Heat Pumps for the unit to function properly.

Be sure to have a USB-C to USB-C cable as you will need to connect your smart device to the USB-C input

terminal on the thermostat for provisioning.

LET'S GET STARTED

1. Power down the PTAC and remove the cover.



2. Using a Philips screwdriver, remove the cover panel to access the Wired Thermostat Terminal panel.



3. Using a precision screwdriver, change the Dip Switches positions for S3 (Up/On) and S9 (Dn/Off) to enable Wall Thermostat control. Note: Switch labels are located on the PCB, just below the switch assembly.

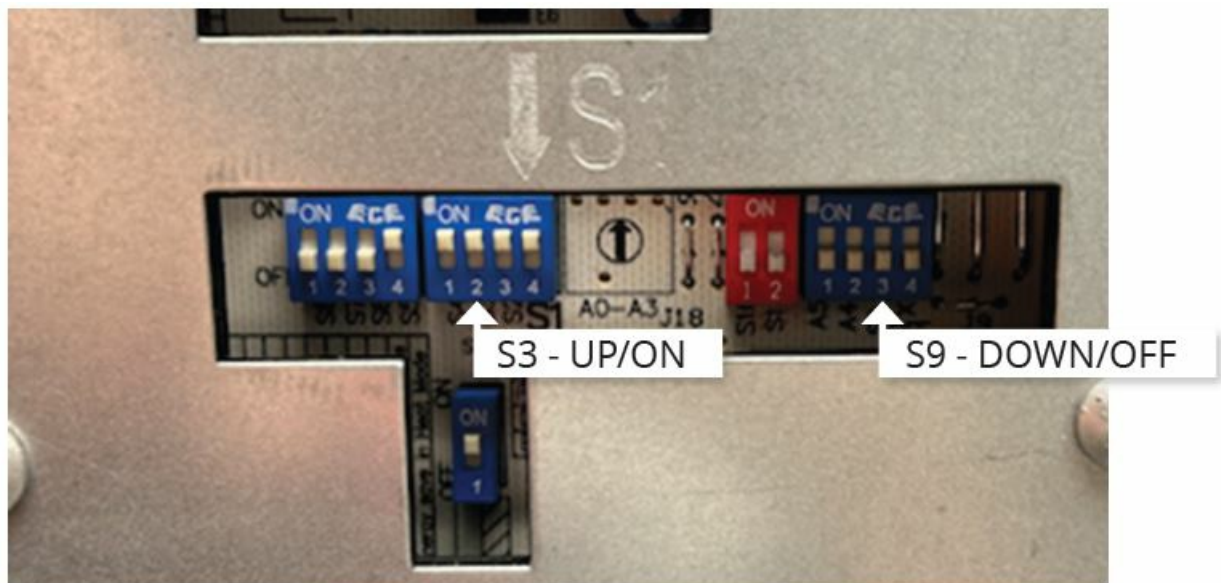

4. Attach the VTech Wiring Harness to the appropriate wired thermostat terminals.

Conventional PTAC – 1Heat / 1Cool / 2 Fan



PTHP – Heat Pump / Electric Heat / 2 Fan

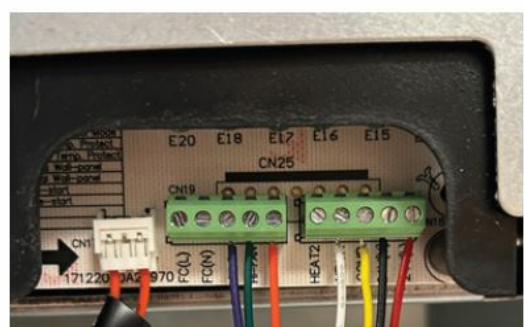

5. Plug the VTech Wiring Harness into the Controller module. Press the connector firmly to ensure it snaps into place securely. Then, restore power to the PTAC/PTHP.



6. Install the batteries into the thermostat. Tap any key to wake the thermostat. The LED on the controller will change from alternating Green/Red, to solid green to indicate it is paired.



7. Prepare the thermostat for configuration:

1. Tap the Menu icon to wake the thermostat.
2. **Use Menu and up/down to select:**

System Settings > System Configuration > Adv Config via App > Plug cable for setup



3. Plug the USB-C cable into the thermostat.



8. Using the App, provision the thermostat:

- Tap installation to begin

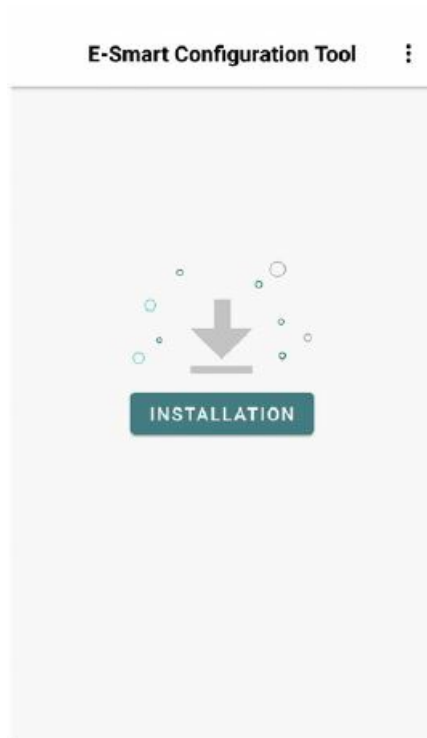

- Select a stored profile

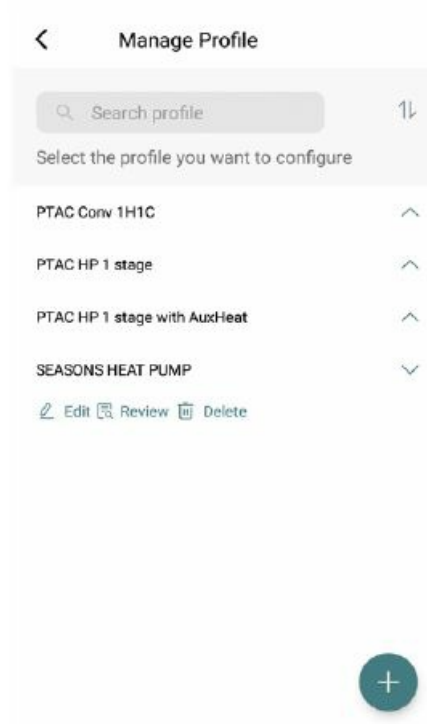

- Assign room number (optional)

- Verify security pin

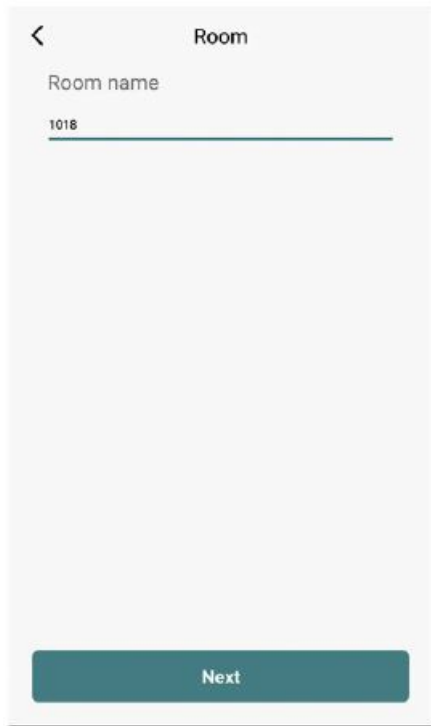
A mobile app screen titled "Room" with a back arrow. It features a "Room name" label and a text input field containing "1018". A teal "Next" button is at the bottom.

< Room

Room name

1018

Next

- Confirm wiring diagram

A mobile app screen titled "Review PIN Code" with a back arrow. It has two input fields: "Old PIN code on thermostat:" with "0000" and "New PIN code to thermostat:". A red warning icon and message are at the bottom. A teal "Next" button is at the very bottom.

< Review PIN Code

Old PIN code on thermostat:

0000

New PIN code to thermostat:

⚠ Please make sure the current PIN code of the profile matches your thermostat's PIN code.

Next

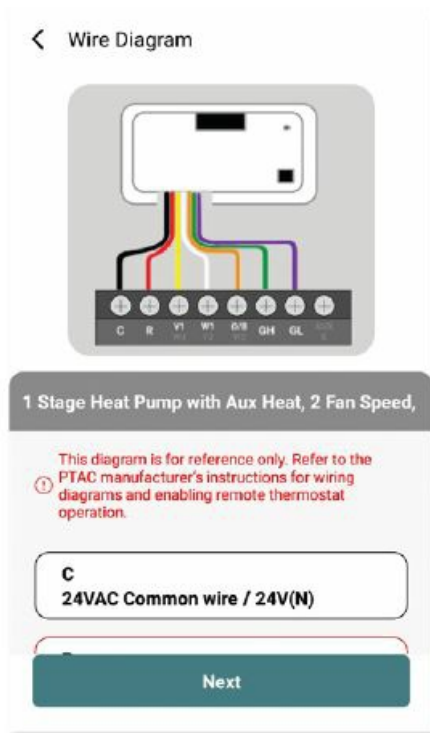

- Tap start to begin

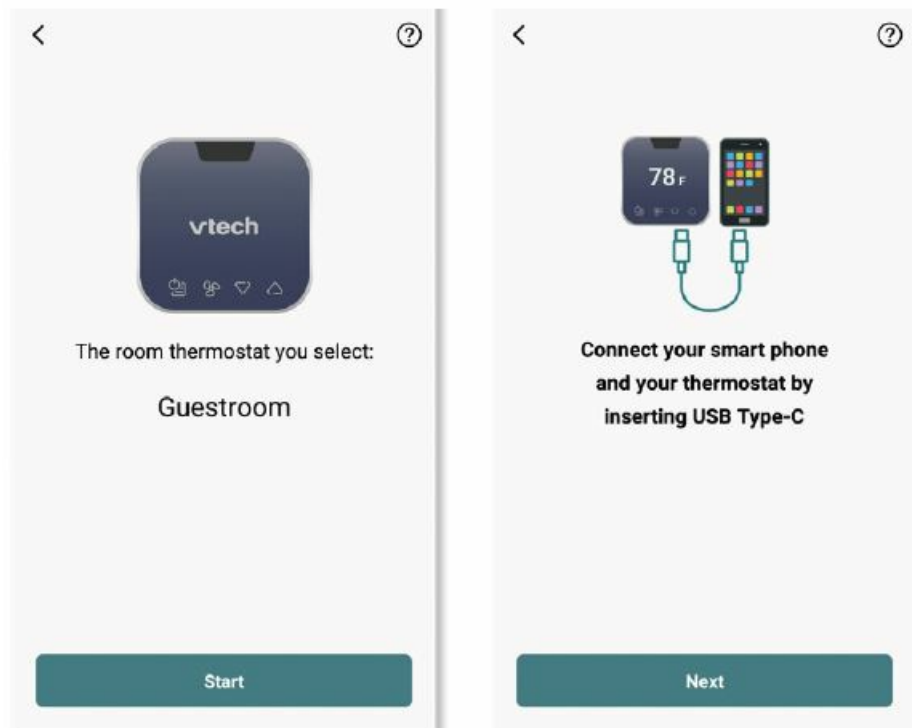

- Once the setup is completed, remove the cable and the thermostat will reboot.

9. Test your system any key to wake, then use the UP/DOWN arrows to adjust the target temperature. Verify heat first, then cool.

Note: Short-cycle protection will prevent the compressor from activating for ~3 minutes after power-up.



10. Mount the controller to the PTAC chase and secure wiring. Cover/protect unused wire leads. Route the wires so they do not sag into the condensation pan.



11. Replace the cover panel and cover.



12. Use the included mounting hardware to mount the thermostat wall plate to the wall, then secure the thermostat to the wall plate using the security screw. The installation is complete.





Installing E-Smart W960 Thermostat, Installing, E-Smart W960 Thermostat, W960 Thermostat, Thermostat

Manuals+,