



Vtech FPO Write and Learn Creative Center User Manual

[Home](#) » [vtech](#) » Vtech FPO Write and Learn Creative Center User Manual 



**User's Manual
Write & Learn Creative Center™**

Contents

- [1 FPO Write and Learn Creative Center](#)
- [2 INTRODUCTION](#)
- [3 GETTING STARTED](#)
- [4 BATTERY NOTICE](#)
- [5 PRODUCT FEATURES](#)
- [6 ACTIVITIES](#)
- [7 MELODY LIST](#)
- [8 CARE & MAINTENANCE](#)
- [9 PRODUCT WARRANTY](#)
- [10 Documents / Resources](#)
 - [10.1 References](#)

FPO Write and Learn Creative Center



© 2015 VTech
Printed in China
91-002987-003 US

Dear Parent,

*At VTech®, we know how important the first day of school is for your child. To help prepare preschoolers for this important event, VTech® has developed the **Preschool Learning™** series of interactive toys.*

***Preschool Learning™** features fun characters and inviting school themes that use technology to capture a child's attention and teach important preschool skills like spelling, counting and the alphabet. These vital skills are taught in a way that's both fun and highly engaging to maintain a child's interest. Children will also be introduced to fun school subjects such as art class, music class and even recess! With **Preschool Learning™**, learning is fun from day one!*

At VTech®, we know that a child has the ability to do great things. That's why all of our electronic learning products are uniquely designed to develop a child's mind and allow them to learn to the best of their ability. We thank you for trusting VTech® with the important job of helping your child learn and grow!

Sincerely,

Your friends at VTech®

To learn more about VTech® toys, visit vtechkids.com

INTRODUCTION

Thank you for purchasing the VTech® Write & Learn Creative Center™!

The Write & Learn Creative Center™ is an interactive learning board your child will love. Drawing objects and writing letters will help them develop language and drawing skills.

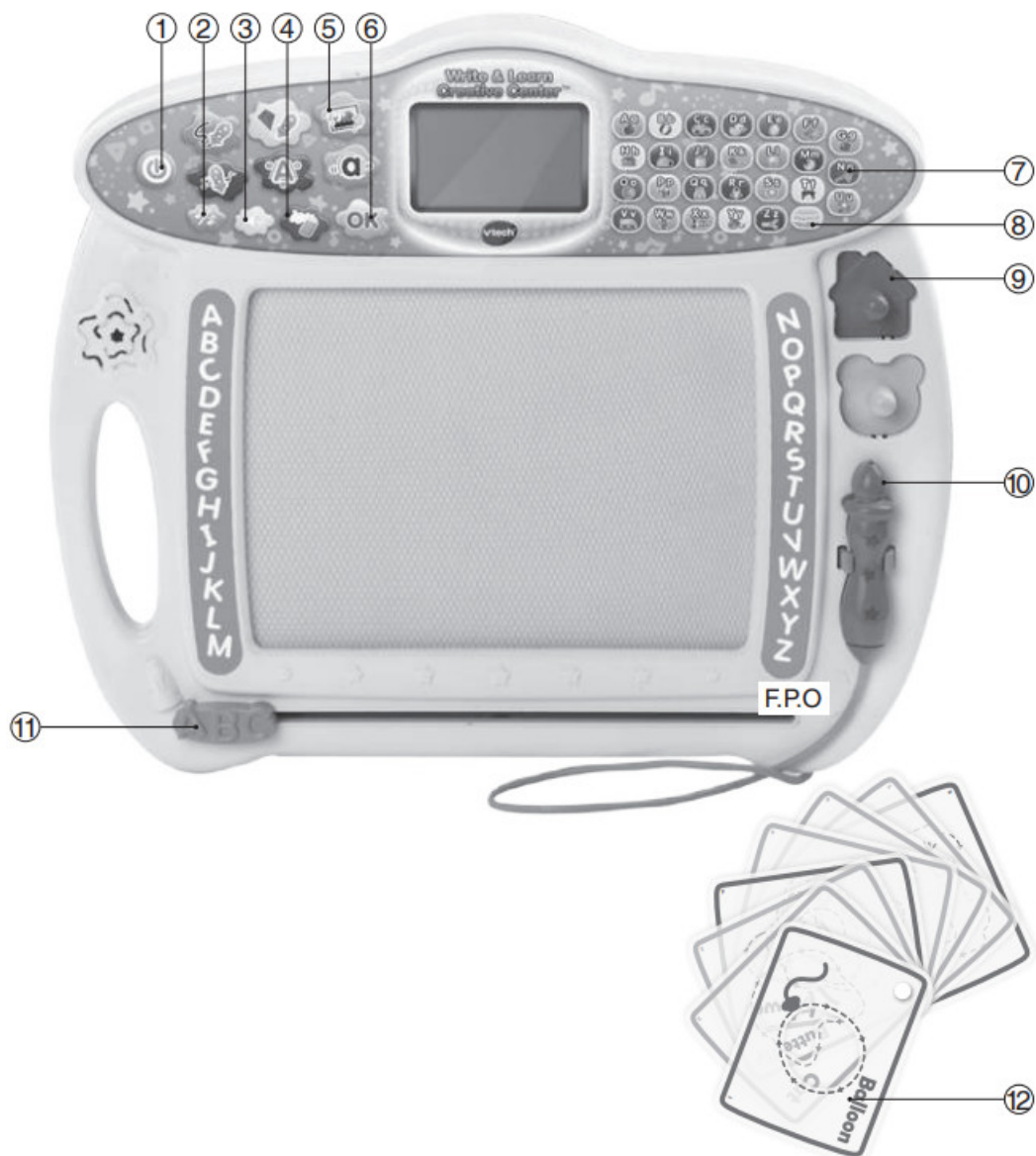

1. ON/OFF BUTTON
2. MUSIC ON/OFF BUTTON
3. VOLUME BUTTON
4. DELETE BUTTON
5. 6 ACTIVITY BUTTONS
6. OK BUTTON

7. 26 LETTER BUTTONS
8. REPEAT BUTTON
9. MAGNETIC STAMPS
10. DRAWING PEN
11. ABC SLIDE ERASER
12. 8 OBJECT STENCILS

INCLUDED IN THIS PACKAGE

- One VTech® Write & Learn Creative Center™
- One User's Manual
- Two Magnetic Stamps
- Eight Object Cards

WARNING: All packing materials such as tape, plastic sheets, wire ties and tags are not part of this toy, and should be discarded for your child's safety.

NOTE:

Please keep this instruction manual as it contains important information.

Unlock the packaging locks:

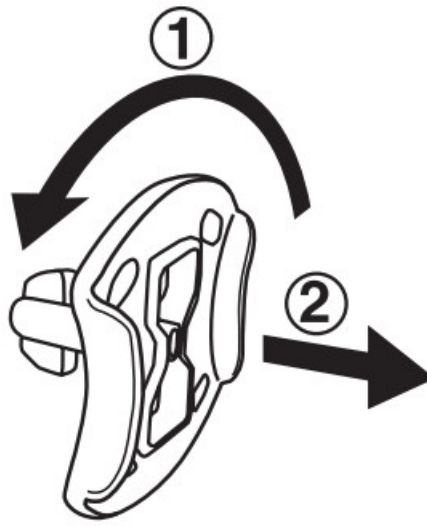

1. Rotate the packaging locks 90 degrees counter-clockwise.
2. Pull out the packaging locks.

GETTING STARTED

BATTERY INSTALLATION

1. Make sure the unit is OFF.
2. Locate the battery cover on the back of the unit.
3. Install 2 new AA (LR6/AM-3) batteries following the diagram inside the battery box. (The use of new, alkaline batteries is recommended for maximum performance.)
4. Replace the battery cover.

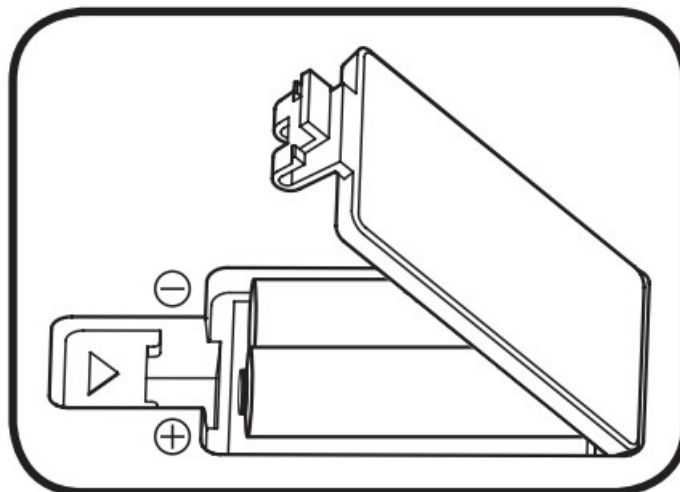

BATTERY NOTICE

- Use new alkaline batteries for maximum performance.
- Use only batteries of the same or equivalent type as recommended.
- Do not mix different types of batteries: alkaline, standard (carbon zinc) or rechargeable (Ni-Cd, Ni-MH), or new and used batteries.
- Do not use damaged batteries.

- Insert batteries with the correct polarity.
- Do not short-circuit the battery terminals.
- Remove exhausted batteries from the toy.
- Remove batteries during long periods of non-use.
- Do not dispose of batteries in fire.
- Do not charge non-rechargeable batteries.
- Remove rechargeable batteries from the toy before charging (if removable).
- Rechargeable batteries are only to be charged under adult supervision.

BEFORE USE

After unpacking, or after a long period of non-use, the magnetic surface of the studio screen will need to be re-activated to improve the drawing and writing functions. Use the STAMPS to cover the surface of the screen, and then slide the ABC SLIDE ERASER back and forth several times until the surface is clear.



PRODUCT FEATURES

1. ON/OFF BUTTON

To turn the unit ON, press the ON/OFF BUTTON. Press the ON/OFF BUTTON again to turn the unit OFF.



2. DRAWING PEN

Use the DRAWING PEN for tracing and drawing.



3. ACTIVITY BUTTONS

Press any of the six ACTIVITY BUTTONS to choose an activity to play.



4. LETTER BUTTONS

Press the 26 LETTER BUTTONS to learn letters, objects, or letter strokes, depending on the activity selected.



5. OK BUTTON

Press the OK BUTTON to confirm the choice or answer.



6. REPEAT BUTTON

Press the REPEAT BUTTON to hear or see the current instruction or animation repeated.

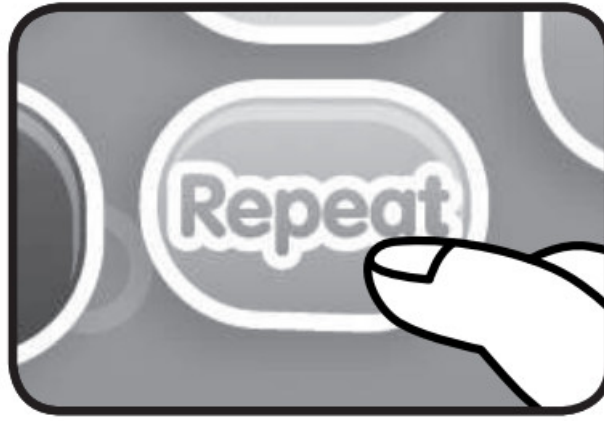

7. DELETE BUTTON

Press the DELETE BUTTON to delete typed letters.



8. VOLUME BUTTON

Press the VOLUME BUTTON to change the volume.



9. MUSIC ON/OFF BUTTON

Press the MUSIC ON/OFF BUTTON to turn the background music on or off.



10. ABC SLIDE ERASER

Move the ABC SLIDE ERASER at the bottom of the drawing area from left to right, and back again to erase

your designs.



11. MAGNETIC STAMPS

Use the two MAGNETIC STAMPS to add creative designs to your artwork. Just press the stamps on the surface of the drawing area and the designs will appear.

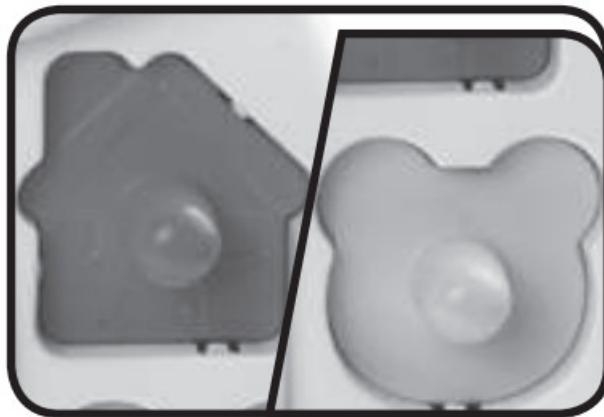

12. OBJECT STENCILS

Place any of the OBJECT STENCILS onto the drawing board to practice tracing objects.

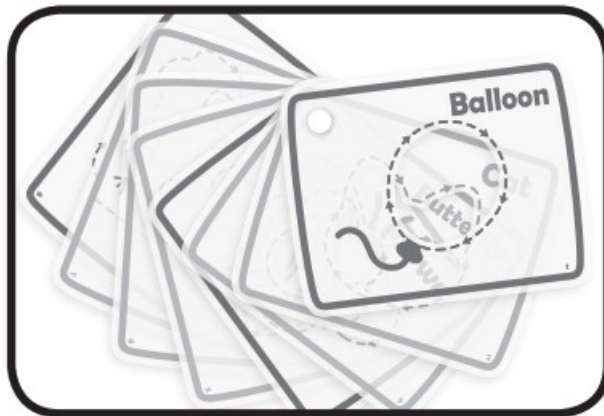

13. AUTOMATIC SHUT-OFF

To preserve battery life, the Write & Learn Creative Center™ will shut off automatically after several minutes without any input. The unit can be turned on again by pressing the ON/OFF BUTTON.

ACTIVITIES

1. LINES & SHAPES

Use the pen to follow along with the lines and shapes that are shown on the screen.



2. HOW TO DRAW

Use the pen to follow along to the step-by-step instructions on the screen to practice drawing the 26 objects.

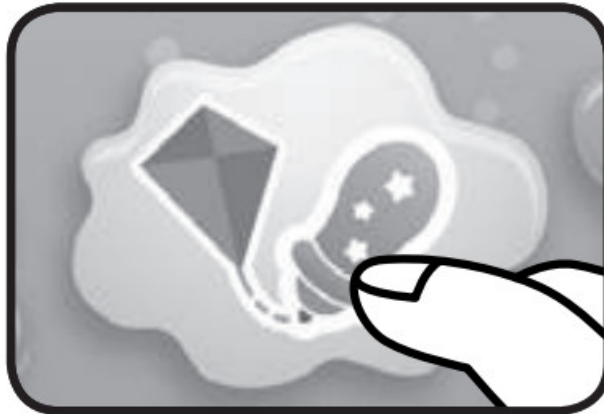

3. GUESS THE PICTURE

Draw on the board with the pen and watch a picture appear on the animated screen. Try to guess what the picture is before it fully appears by pressing the matching LETTER BUTTON.



4. MUSICAL DRAWING

Music will play as you draw on the screen. Press the letter buttons to change the melody.



5. UPPERCASE LETTER WRITING

Use the pen to follow along with the demonstration to learn the stroke order for uppercase letters.

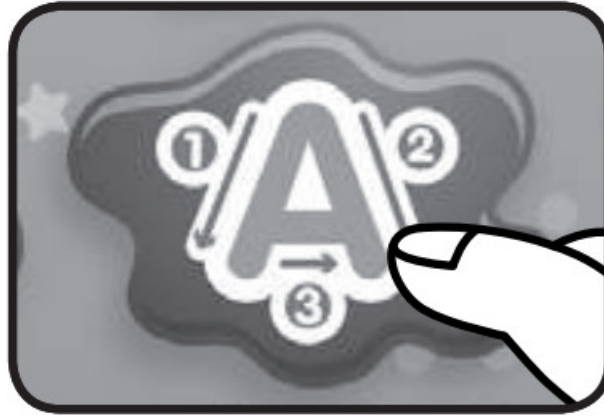

6. LOWERCASE LETTER WRITING

Use the pen to follow along with the demonstration to learn the stroke order for lowercase letters.



MELODY LIST

In the activity Musical Drawing, each letter plays a different song:

- A – Apples and Bananas
- B – Take Me out to the Ball Game
- C – The Wheels on the Bus
- D – Old MacDonald Had a Farm
- E – Humpty Dumpty
- F – Row, Row, Row Your Boat
- G – ‘Round the Mulberry Bush
- H – This is the House That Jack Built
- I – Jack and Jill
- J – Bingo
- K – Little Miss Muffet
- L – London Bridge
- M – Hey Diddle Diddle
- N – On Top of Old Smoky
- O – Oranges and Lemons
- P- A-Tisket, A-Tasket
- Q – Old King Cole
- R – Twinkle, Twinkle Little Star
- S – Itsy Bitsy Spider
- T – Farmer in the Dell
- U – It’s Raining, It’s Pouring
- V – Three Little Kittens
- W – Sing a Song of Sixpence

X – Where Has My Little Dog Gone
Y – This Old Man
Z – Alphabet Song

CARE & MAINTENANCE

1. Keep the unit clean by wiping it with a slightly damp cloth.
2. Keep the unit out of direct sunlight and away from any direct heat source.
3. Remove the batteries when the unit is not in use for an extended period of time.
4. Do not drop the unit on hard surfaces, and do not expose the unit to moisture or water.

TROUBLESHOOTING

If for some reason the unit stops working or malfunctions, please follow these steps:

1. Please turn the unit OFF.
2. Interrupt the power supply by removing the battery.
3. Let the unit stand for a few minutes, then replace the battery.
4. Turn the unit ON. The unit should now be ready to play again.
5. If the product still does not work, replace with a new battery.

If the problem persists, please call our Consumer Services Department at 1-800-521-2010 in the U.S. or 1-877-352-8697 in Canada, and a service representative will be happy to help you.

IMPORTANT NOTE:

Creating and developing VTech® Preschool Learning products is accompanied by a responsibility that we at VTech® take very seriously. We make every effort to ensure the accuracy of the information, which forms the value of our products. However, errors sometimes can occur. It is important for you to know that we stand behind our products and encourage you to call our Consumer Services Department at 1-800-521-2010 in the U.S., or 1-877-352-8697 in Canada, with any problems and/or suggestions that you might have. A service representative will be happy to help you.

NOTE:

This equipment has been tested and found to comply with the limits for a Class B digital device, pursuant to Part 15 of the FCC Rules.

These limits are designed to provide reasonable protection against harmful interference in a residential installation. This equipment generates, uses and can radiate radio frequency energy and, if not installed and used in accordance with the instructions, may cause harmful interference to radio communications. However, there is no guarantee that interference will not occur in a particular installation. If this equipment does cause harmful interference to radio or television reception, which can be determined by turning the equipment off and on, the user is encouraged to try to correct the interference by one or more of the following measures:

- Reorient or relocate the receiving antenna.
- Increase the separation between the equipment and receiver.
- Connect the equipment into an outlet on a circuit different from that to which the receiver is connected.
- Consult the dealer or an experienced radio/TV technician for help.

Caution: Changes or modifications not expressly approved by the party responsible for compliance could void the user's authority to operate the equipment.

THIS DEVICE COMPLIES WITH PART 15 OF THE FCC RULES OPERATION IS SUBJECT TO THE FOLLOWING TWO CONDITIONS: (1) THIS DEVICE MAY NOT CAUSE HARMFUL INTERFERENCE, AND (2) THIS DEVICE MUST ACCEPT ANY INTERFERENCE RECEIVED, INCLUDING INTERFERENCE THAT MAY CAUSE UNDESIRE OPERATION. CAN ICES-3 (B)/NMB-3(B)

PRODUCT WARRANTY



This Warranty is applicable only to the original purchaser, is non-transferable and applies only to "VTech" products or parts. This product is covered by a 3-month Warranty from the original purchase date, under normal use and service, against defective workmanship and materials. This Warranty does not apply to (a) consumable parts, such as batteries; (b) cosmetic damage, including but not limited to scratches and dents; (c) damage caused by use with non VTech products; (d) damage caused by accident, misuse, unreasonable use, immersion in water, neglect, abuse, battery leakage, or improper installation, improper service, or other external causes; (e) damage caused by operating the product outside the permitted or intended uses described by VTech in the owner's manual; (f) a product or part that has been modified (g) defects caused by normal wear and tear or otherwise due to the normal aging of the product; or (h) if any VTech serial number has been removed or defaced.

Prior to returning a product for any reason, please notify the VTech Consumer Services Department, by sending an email to vtechkids@vtechkids.com or calling 1-800-521-2010. If the service representative is unable to resolve the issue, you will be provided instructions on how to return the product and have it replaced under Warranty. Return of the product under Warranty must adhere to the following rules:

If VTech believes that there may be a defect in the materials or workmanship of the product and can confirm the purchase data and location of the product, we will at our discretion replace the product with a new unit or product of comparable value. A replacement product or parts assumes the remaining Warranty of the original product or 30 days from the date of replacement, whichever provides longer coverage.

THIS WARRANTY AND THE REMEDIES SET FORTH ABOVE ARE EXCLUSIVE AND IN LIEU OF ALL OTHER WARRANTIES, REMEDIES AND CONDITIONS, WHETHER ORAL, WRITTEN, STATUTORY, EXPRESS OR IMPLIED. IF VTECH CANNOT LAWFULLY DISCLAIM STATUTORY OR IMPLIED WARRANTIES THEN TO THE EXTENT PERMITTED BY LAW, ALL SUCH WARRANTIES SHALL BE LIMITED TO THE DURATION OF THE EXPRESS WARRANTY AND TO THE REPLACEMENT SERVICE AS DETERMINED BY VTECH IN ITS SOLE DISCRETION.

To the extent permitted by law, VTech will not be responsible for direct, special, incidental or consequential damages resulting from any breach of Warranty.

This Warranty is not intended to persons or entities outside the United States of America. Any disputes resulting from this Warranty shall be subject to the final and conclusive determination of VTech .

Register your product online at vtechkids.com/warranty



[Vtech FPO Write and Learn Creative Center](#) [pdf] User Manual

FPO Write and Learn Creative Center, FPO, Write and Learn Creative Center, Learn Creative Center, Creative Center, Center

References

- [User Manual](#)

[Manuals+.](#)