



Vtech Dollhouse Time to Get Tiny Watch Instruction Manual

[Home](#) » [vtech](#) » Vtech Dollhouse Time to Get Tiny Watch Instruction Manual 

Contents

- 1 Vtech Dollhouse Time to Get Tiny Watch
- 2 Product Usage Instructions
- 3 INTRODUCTION
- 4 INCLUDED IN THE PACKAGE
- 5 PRODUCT SPECIFICATION
- 6 INSTRUCTIONS
- 7 BATTERY REMOVAL AND INSTALLATION
- 8 IMPORTANT: BATTERY INFORMATION
- 9 Disposal of batteries and product
- 10 PRODUCT FEATURES
- 11 Automatic Shut-Off
- 12 ACTIVITIES
- 13 CARE & MAINTENANCE
- 14 TROUBLESHOOTING
- 15 PRODUCT WARRANTY/
- 16 Documents / Resources
 - 16.1 References
- 17 Related Posts



Vtech Dollhouse Time to Get Tiny Watch



Product Specifications

- **Battery:** One CR2450 battery
- **Time Format:** 12h or 24h
- **Display:** Digital

Product Usage Instructions

Important Note

WARNING: People with very sensitive skin may notice some irritation after wearing the Time to Get Tiny Watch for extended periods of time. To prevent irritation, suggest removing the watch before bedtime, keeping the wrist and band clean and dry, and ensuring a comfortable fit.

Power Source

The Time to Get Tiny Watch operates using one CR2450 battery. The included battery is for demo purposes only.

Battery Removal and Installation

1. Make sure the watch cover is closed.
2. Locate the battery cover on the back of the unit and open it using a screwdriver.
3. Follow the diagram inside to replace the battery with a new CR2450 battery.
4. Secure the battery cover by tightening the screw.

FAQ

Q: Can I wear the watch while swimming?

A: It is recommended to avoid wearing the watch while swimming to prevent damage.

VTech understands that a child's needs and abilities change as they grow and with that in mind we develop our toys to teach and entertain at just the right level...

Pre-School

Interactive toys to develop their imagination and encourage language development

Electronic Learning Computers

Cool, aspirational and inspiring computers for curriculum related learning

vtech Baby

Toys that will stimulate their interest in different textures, sounds and colours

I am...

...responding to colours, sounds and textures

...understanding cause and effect

...learning to touch, reach, grasp, sit-up, crawl and toddle

I want...

...to get ready for school by starting to learn the alphabet and counting

...my learning to be as fun, easy and exciting as can be

...to show my creativity with drawing and music so my whole brain develops

I need...

...challenging activities that can keep pace with my growing mind

...intelligent technology that adapts to my level of learning

...National Curriculum based content to support what I'm learning at school

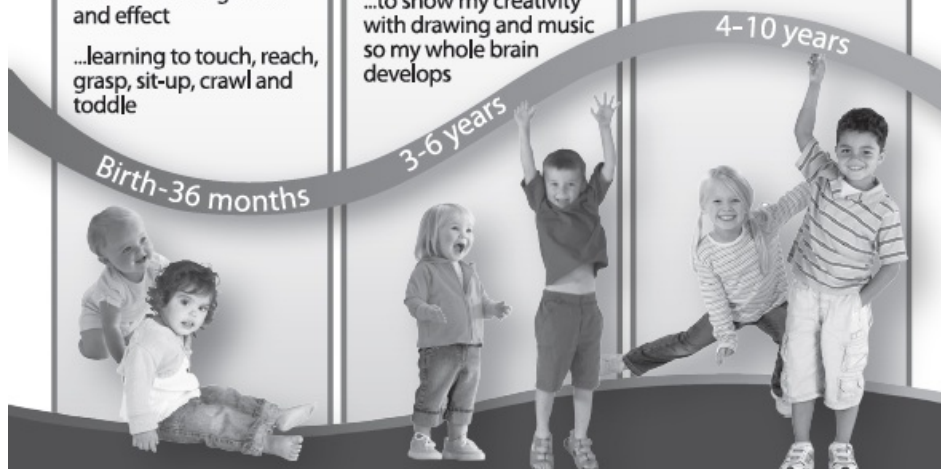

INTRODUCTION

Thank you for purchasing the VTech® Gabby's Dollhouse Time to Get Tiny Watch.

This full-function watch includes four A-Meow-Zing games that help encourage age-appropriate skills. Choose from a variety of clock faces featuring Gabby and her friends and use the handy alarm, timer and stopwatch functions.

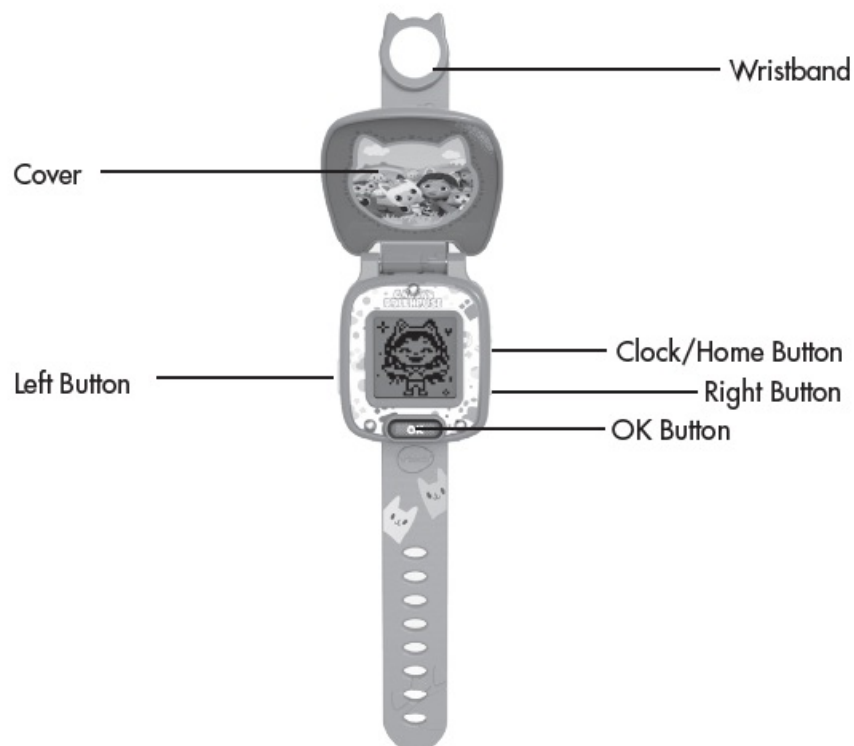

INCLUDED IN THE PACKAGE

- One Time to Get Tiny Watch
- One CR2450 battery
- Quick Start Guide

WARNING

All packing materials such as tape, plastic sheets, packaging locks, removable tags, cable ties, cords and packaging screws are not part of this toy, and should be discarded for your child's safety.

NOTE

Please save this Instruction Manual as it contains important information.

PRODUCT SPECIFICATION

Battery	One CR2450 battery
Time Format	12h or 24h
Display	Digital
Optimum Operating Temperature	32°F – 104°F (0°C – 40°C)

Important Note

- Do not place the watch under running water.
- Do not submerge. Not suitable for showering, bathing or swimming.
- Keep the cover closed when the watch is not in use.

WARNING

People with very sensitive skin may notice some irritation after wearing the Time to Get Tiny Watch for extended periods of time. The skin may become irritated when moisture, sweat, soap, or other irritants get trapped under the wristband and are left in contact with the skin. To prevent this, we suggest children remove the watch before going to bed for the night, take the watch off if it's feeling uncomfortable, and keep their wrist and the band clean and dry.

In addition, wearing the watch too tightly may also cause irritation. Make sure the fit is good – tight enough so the watch stays in place but not so tight that it's uncomfortable. If you notice any redness, swelling, or other irritation, you may want to consult a doctor before wearing the watch again.

INSTRUCTIONS

WARNING:

Adult assembly required for battery installation.

Keep batteries out of reach of children.

Power Source

The Time to Get Tiny Watch operates using one CR2450 battery. The CR2450 battery included with the product is for demo purposes only.

BATTERY REMOVAL AND INSTALLATION

NOTE: For best performance, remove the factory-installed battery from the Gabby Watch and use a new battery.

1. Make sure the watch cover is closed.
2. Find the battery cover located on the back of the unit, use a screwdriver to loosen the screw and then open the battery cover.
3. Use the screwdriver to push the metal piece according to the diagram. Remove the battery when one end of the battery pops up.
4. Follow the diagram inside the battery box to install one new CR2450 battery, press it into the battery room.
5. Replace the battery cover and tighten the screw to secure.

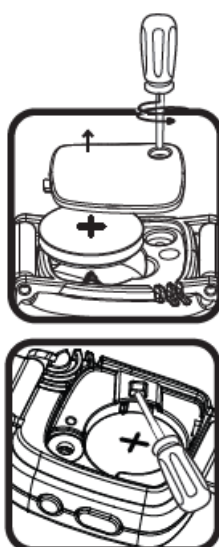

WARNING!

Contains coin battery.

A coin battery can cause severe or fatal injuries in 2 hours or less if it is swallowed or placed inside any part of the body.

Individual battery is hazardous. Dispose of used batteries immediately. Keep new and used batteries away from

children. If you think batteries might have been swallowed or placed inside any part of the body, seek immediate medical attention.

Australia

If you think batteries might have been swallowed or placed inside any part of the body, immediately call the 24-hour Poisons Information Centre on 13 11 26 for fast, expert advice.

IMPORTANT: BATTERY INFORMATION

- Insert batteries with the correct polarity (+ and -).
- Do not mix old and new batteries.
- Do not mix alkaline, standard (carbon-zinc) or rechargeable batteries.
- Only batteries of the same or equivalent type as recommended are to be used.
- Do not short-circuit the supply terminals.
- Remove batteries during long periods of non-use.
- Remove exhausted batteries from the toy.
- Dispose of batteries safely. Do not dispose of batteries in fire.

RECHARGEABLE BATTERIES

- Remove rechargeable batteries (if removable) from toy before charging.
- Rechargeable batteries are only to be charged under adult supervision.
- Do not charge non-rechargeable batteries.

Disposal of batteries and product



The crossed-out wheeled bin symbols on products and batteries, or on their respective packaging, indicates they must not be disposed of in domestic waste as they contain substances that can be damaging to the environment and human health.

The chemical symbols Hg, Cd or Pb, where marked, indicate that the battery contains more than the specified value of mercury (Hg), cadmium (Cd) or lead (Pb) set out in the Batteries and Accumulators Regulation.

The solid bar indicates that the product was placed on the market after 13th August, 2005.

Please dispose of your product and batteries responsibly.

In the UK, give this toy a second life by disposing of it at a small electricals collection point* so all of its materials can be recycled.

Learn more at:

www.vtech.co.uk/recycle

www.vtech.com.au/sustainability

* Visit www.recyclenow.com to see a list of collection points near you.

Activate Normal Play

When you use the watch for the first time, you must unlock from Try-Me mode to play. To unlock from Try-Me mode, open the Cover, and press the Left + Right + OK Buttons together for approximately five seconds. You will then hear three beeping sounds to indicate it has been unlocked. Press any button to activate the watch and set the time. Press the Left or Right Button to select, then press the OK Button to confirm and move to the next option. A tick will be displayed when the setting is complete.

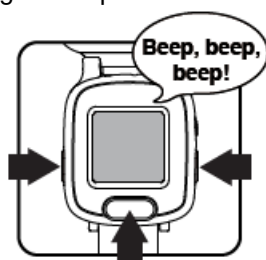

Note

When the battery level is low, most functions on the watch may not be activated, except for the clock display. It is recommended to install a new battery as soon as possible before further use.

If the battery level is too low and cannot keep the clock running, you will need to enter the time again after the battery has been replaced.

PRODUCT FEATURES

1. Cover

Open the Cover to view the time. When the Cover is closed, tap the bottom of the Cover to activate character voices and sounds with a light effect.

2. Left/Right Buttons

Use the Left or Right Button to select an activity or option.

3. OK Button **OK**

Press the OK Button to confirm a selection and move to the next option in different activities.

4. Clock/Home Button

Press the Clock/Home Button to return to the clock from any other function or activity.





Or press the the Clock/Home Button to change the clock face directly.

5. Clock Display

When the Clock/Home Button is pressed, the time will be displayed and clock face will be changed. Press the Left or Right Button to display the Home Menu where other activities can be selected.

6. Home Menu

Press the Left or Right Button to display the Home Menu. There are five activities to choose from:

1. Alarm Clock 	2. Stopwatch 	3. Timer 
4. Games 	5. Settings 	

- Press the Left or Right Button to scroll through the menu options.
- Press the OK Button to enter the chosen activity.

7. Alarm Clock

- Press the Left or Right Button to select the time and choose between three alarm tones.
- Press the OK Button to confirm and move to the next setting.
- Press the Clock/Home Button to automatically save the current setting.

8. Stopwatch

- Press the OK Button to start the Stopwatch, press again to stop.
- When the Stopwatch is stopped, you can press the Left or Right Button to reset.

9. Timer

- Press the Left or Right Button to set the time.
- Press the OK Button to confirm the Timer duration and the countdown will start immediately.
- While the Timer is running, press the OK Button to pause/resume.



- While the Timer is paused, press the Left or Right Button to reset the time.
- Press the Clock/Home Button to automatically save the current setting.

10. Settings

In the Settings menu, press the Left or Right Button to scroll through the various options:

Cuckoo Clock

- Press the Left or Right Button to turn the Cuckoo Clock on or off.
- Press the OK Button or Clock/Home Button to confirm and save the setting.
- Please note that when the Cuckoo Clock is activated, the watch will chime at the top of each hour between 7am and 7pm, unless a game is currently in progress.

Setting the Time and Clock Face

- Press the Left or Right Button to change the options. (The AM/PM setting is only applicable in 12-hour time format)
- Press the OK Button or Clock/Home Button to confirm and save the setting. After the time is set, the clock face options will be shown.
- Press the Left or Right Button to select from 10 different clock faces.
- Press the OK Button or Clock/Home Button to confirm and save the setting.



Automatic Shut-Off

To preserve battery life, the Gabby Watch will automatically shut off after approximately 30 seconds without input. The unit can be turned on again by pressing any button or opening the cover.

Note

The Time to Get Tiny Watch will not automatically power off when the Stopwatch is running.

The unit will also automatically turn Off when the battery power is very low. If you see the Low Battery icon appear on screen, please replace the battery.

ACTIVITIES

1. Games

In the Games menu, press the Left or Right Button to scroll through the different game options:

1. Paw Print Mystery

Let's guess who slipped out of the Dollhouse by looking at the paw prints. Press the Left or Right Button to choose, then press OK Button to confirm.

2. Avoid the obstacles

Carlita loves to race in the playroom! Press the Left or Right Button to help her avoid the obstacles.





3. Shape Bubbles

Kitty Fairy got stuck in a bubble! Press the Left or Right Button to help Gabby jump onto the correct bubbles so that she can get up to help Kitty Fairy get down.

4. More or Less

Let's help Gabby and Pandy Paws get the growing potion by comparing the objects and numbers. Press the Left or Right Button to choose, then press OK Button to confirm.



CARE & MAINTENANCE

1. Keep the unit clean by wiping it with a slightly damp cloth.
2. Keep the unit out of direct sunlight and away from any direct heat sources.
3. Remove the battery if the unit will not be in use for an extended period of time.
4. Do not drop the unit on hard surfaces and do not expose the unit to moisture or water.
5. Try to change the battery for a new one if the toy is not working properly.

TROUBLESHOOTING

If for some reason the program/activity stops working or malfunctions, please follow these steps:

1. Interrupt the power supply by removing the battery.
2. Let the unit stand for a few minutes, then replace the battery.
3. The unit should now be ready to use again.
4. If the unit still does not work, install a new battery.

CONSUMER SERVICES

Creating and developing VTech® products is accompanied by a responsibility that we at VTech® take very seriously. We make every effort to ensure the accuracy of the information, which forms the value of our products. However, errors sometimes can occur. It is important for you to know that we stand behind our products and encourage you to call our Consumer Services Department with any problems and/or suggestions that you might have. A service representative will be happy to help you.

UK Customers:

Phone: 0330 678 0149 (from UK) or +44 330 678 0149 (outside UK) Website: www.vtech.co.uk/support

Australian Customers:

Phone: 1800 862 155

Website: support.vtech.com.au

NZ Customers:

Phone: 0800 400 785

Website: support.vtech.com.au

PRODUCT WARRANTY/

CONSUMER GUARANTEES

UK Customers:

Read our complete warranty policy online at vtech.co.uk/warranty.

Australian Customers:

VTECH ELECTRONICS (AUSTRALIA) PTY LIMITED – CONSUMER GUARANTEES

Under the Australian Consumer Law, a number of consumer guarantees apply to goods and services supplied by VTech Electronics (Australia) Pty Limited. Please refer to vtech.com.au/consumerguarantees for further information.

Visit our website for more information about our products, downloads, resources and more.

www.vtech.co.uk

www.vtech.com.au

© 2024 VTech Holdings Limited. All rights reserved.

Printed in China.

IM-561800-005

Version:0

Documents / Resources

	<p>Vtech Dollhouse Time to Get Tiny Watch [pdf] Instruction Manual</p> <p>Dollhouse Time to Get Tiny Watch, Dollhouse, Time to Get Tiny Watch, to Get Tiny Watch, Get Tiny Watch, Tiny Watch, Watch</p>
---	---

References

- [Support : VTech Electronics](#)
- [User Manual](#)

Manuals+. Privacy Policy

This website is an independent publication and is neither affiliated with nor endorsed by any of the trademark owners. The "Bluetooth®" word mark and logos are registered trademarks owned by Bluetooth SIG, Inc. The "Wi-Fi®" word mark and logos are registered trademarks owned by the Wi-Fi Alliance. Any use of these marks on this website does not imply any affiliation with or endorsement.