



Vtech 80-578543 Tiny Tech Tablet



Vtech 80-578543 Tiny Tech Tablet Instruction Manual

[Home](#) » [vtech](#) » Vtech 80-578543 Tiny Tech Tablet Instruction Manual 

Contents

- [1 Vtech 80-578543 Tiny Tech Tablet](#)
- [2 Product Usage Instructions](#)
- [3 INTRODUCTION](#)
- [4 INSTRUCTIONS](#)
- [5 PRODUCT FEATURES](#)
- [6 CARE & MAINTENANCE](#)
- [7 TROUBLESHOOTING](#)
- [8 PRODUCT WARRANTY/ CONSUMER GUARANTEES](#)
- [9 Documents / Resources](#)
 - [9.1 References](#)
- [10 Related Posts](#)



Vtech 80-578543 Tiny Tech Tablet



Specifications

- Product Name: Tiny Tech Tablet
- Features: 12 Light Up App Activity Buttons, English/Off/French Control Switch, Four Directional Control Buttons
- Battery Requirement: 2 AAA batteries (AM-4/LR03)
- Automatic Shut-Off: After approximately 25 seconds without input

Product Usage Instructions

Battery Removal and Installation

1. Make sure the unit is turned Off.
2. Locate the battery cover on the back of the unit. Use a screwdriver to loosen the screw and open the battery cover.
3. Remove old batteries by pulling up on one end of each battery.
4. Install 2 new AAA batteries following the diagram inside the battery box. Alkaline or fully charged Ni-MH rechargeable batteries are recommended for best performance.
5. Replace the battery cover and tighten the screw to secure.

WARNING: Adult assembly is required for battery installation. Keep batteries out of reach of children.

Product Features

1. **English/Off/French Control Switch:** Slide the switch to English or French position to turn the unit On. Slide to Off position to turn it Off.
2. **Automatic Shut-Off:** The tablet will power down after 25 seconds without input to preserve battery life. Press any button to turn it On again.

Activities

Slide the English/Off/French Control Switch to turn the unit On. You'll hear a power-on sound effect, a sing-along song, and a playful phrase. The lights will flash with the sounds.

FAQ

- **Q: What type of batteries should I use for the Tiny Tech Tablet?**

- **A:** The tablet requires 2 AAA batteries (AM-4/LR03). Alkaline batteries or fully charged Ni-MH rechargeable batteries are recommended for best performance.

- **Q: How can I dispose of old batteries and the product responsibly?**

- **A:** Do not dispose of batteries or the product in domestic waste. Look for collection points for proper disposal. Visit www.recyclenow.com for more information on recycling options near you.

INTRODUCTION

Thank you for purchasing the Tiny Tech Tablet!

A beginner tablet built just for little ones! The Tiny Tech Tablet features apps that mimic grown-up tablets while introducing numbers, weather, animals and more.

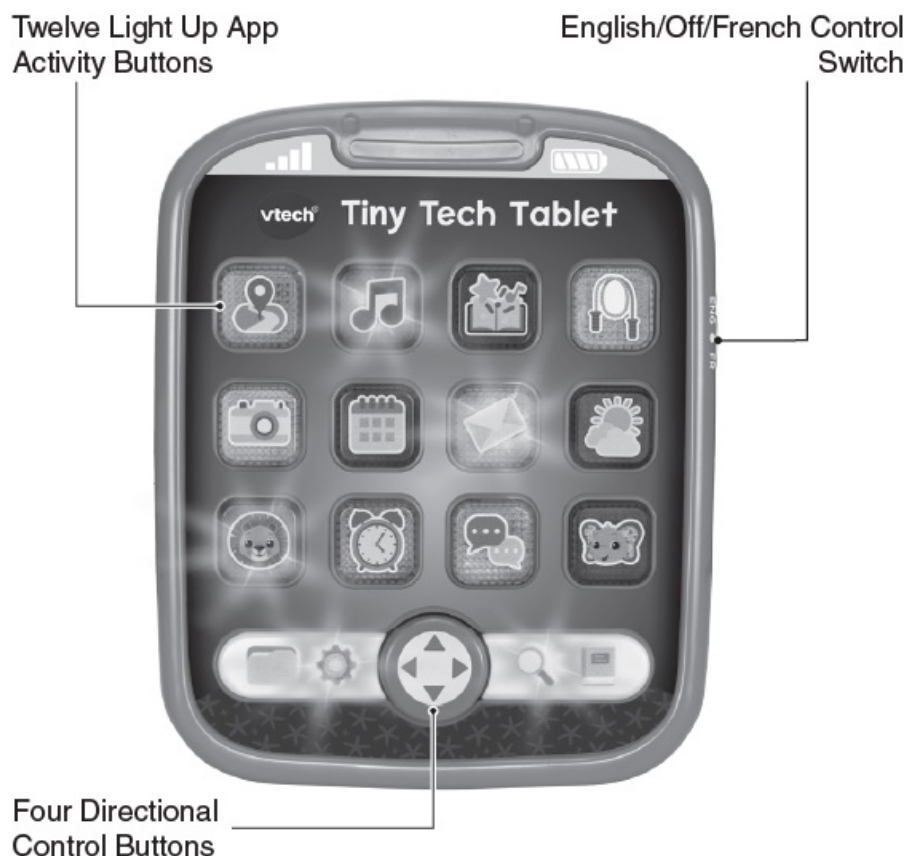

INCLUDED IN THE PACKAGE

- Tiny Tech Tablet
- Quick Start Guide

WARNING

All packing materials such as tape, plastic sheets, packaging locks, removable tags, cable ties, cords and

packaging screws are not part of this toy, and should be discarded for your child's safety.

NOTE

Please save this Instruction Manual as it contains important information.

Unlock the Packaging Locks

1. Turn the packaging locks anticlockwise several times.
2. Pull out and discard the packaging locks.

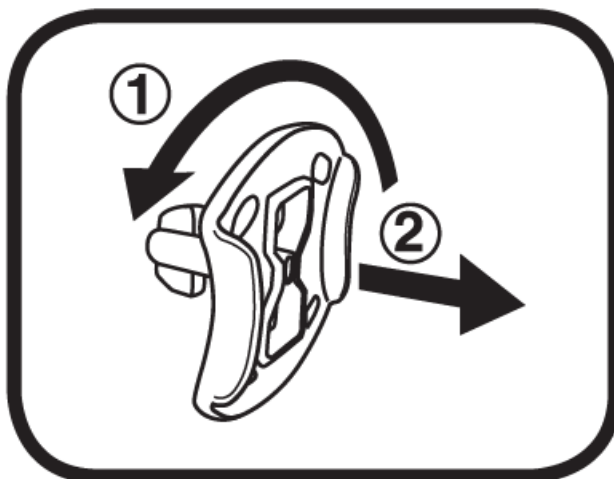

INSTRUCTIONS

Battery Removal and Installation

1. Make sure the unit is turned Off.
2. Locate the battery cover on the back of the unit. Use a screwdriver to loosen the screw, and then open the battery cover.
3. Remove old batteries by pulling up on one end of each battery.
4. Install 2 new AAA batteries (AM-4/ LR03) batteries following the diagram inside the battery box. (For best performance, alkaline batteries or fully charged Ni-MH rechargeable batteries are recommended.)
5. Replace the battery cover and tighten the screw to secure.

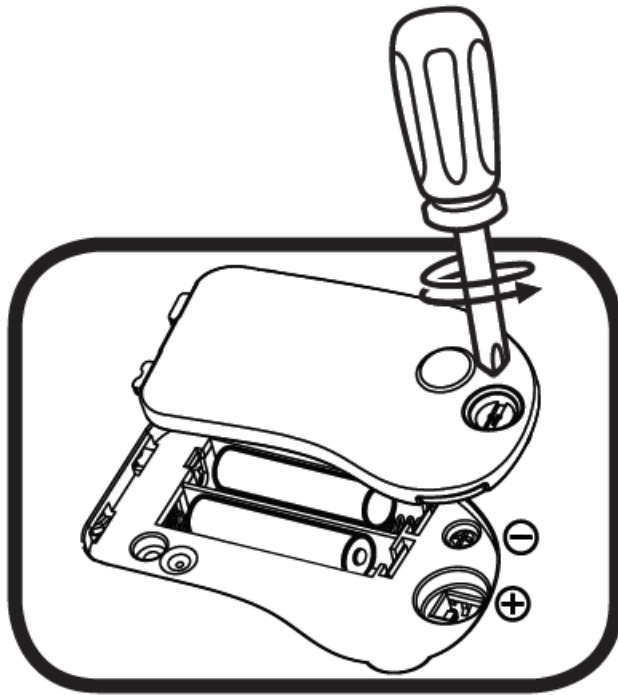

WARNING:

- Adult assembly required for battery installation.
- Keep batteries out of reach of children.

IMPORTANT: BATTERY INFORMATION

- Insert batteries with the correct polarity (+ and -).
- Do not mix old and new batteries.
- Do not mix alkaline, standard (carbon-zinc) or rechargeable batteries.
- Only batteries of the same or equivalent type as recommended are to be used.
- Do not short-circuit the supply terminals.
- Remove batteries during long periods of non-use.
- Remove exhausted batteries from the toy.
- Dispose of batteries safely. Do not dispose of batteries in fire.

RECHARGEABLE BATTERIES

- Remove rechargeable batteries (if removable) from the toy before charging.
- Rechargeable batteries are only to be charged under adult supervision.
- Do not charge non-rechargeable batteries.

Disposal of batteries and product



The crossed-out wheeled bin symbols on products and batteries, or on their respective packaging, indicates they must not be disposed of in domestic waste as they contain substances that can be damaging to the environment and human health.

The chemical symbols Hg, Cd or Pb, where marked, indicate that the battery contains more than the specified value of mercury (Hg), cadmium (Cd) or lead (Pb) set out in the Batteries and Accumulators Regulation.



■ The solid bar indicates that the product was placed on the market after 13th August, 2005.
Please dispose of your product and batteries responsibly.

In the UK, give this toy a second life by disposing of it at a small electricals collection point* so all of its materials can be recycled.

Learn more at:

- www.vtech.co.uk/recycle
- www.vtech.com.au/sustainability

Visit www.recyclenow.com to see a list of collection points near you.

PRODUCT FEATURES

1. English/Off/French Control Switch

To turn the unit On, slide the English/Off/French Control Switch to the English (ENG) or the French (FR) position. To turn the unit Off , slide the English/Off/French Control Switch to the Off (●) position.

2. Automatic Shut-Off

To preserve battery life, the Tiny Tech Tablet will automatically power down after approximately 25 seconds without input. The unit can be turned On again by pressing any button.

NOTE

If the unit powers down or if the light fades out during play, we suggest changing the batteries.

ACTIVITIES

1. English/Off/French Control Switch

Slide the English/Off/French Control Switch to turn the unit On. You'll hear a power-on sound effect, a sing-along song and a playful phrase. The lights will flash with the sounds.

2. Map Button

Press the Map Button to pretend to follow the map to various destinations, with phrases, and sounds. The lights will flash with the sounds.

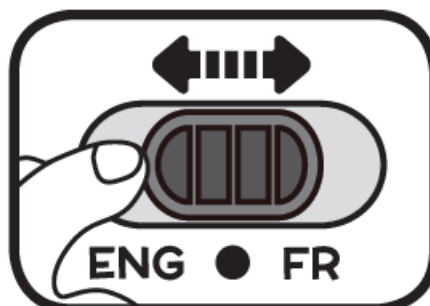

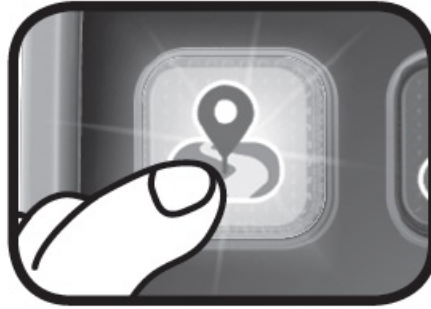
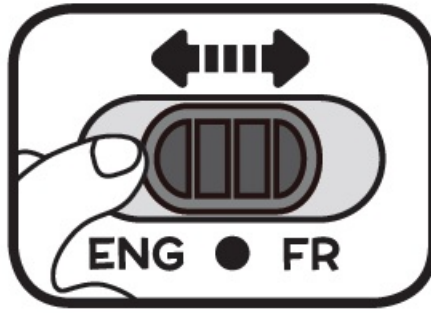

3. **Music Button**

Press the Music Button to hear a variety of melodies and two sing-along songs. The lights will flash with the sounds.

4. **Entertainment Button**

Press the Entertainment Button to hear amusing phrases about news, stories and music. The lights will flash with the sounds.



5. **Exercise Button**

Press the Exercise Button to listen to energetic sounds and phrases. The lights will flash with the sounds.

6. **Camera Button**

Press the Camera Button to enjoy playful role-play phrases and sounds. The lights will flash with the sounds.

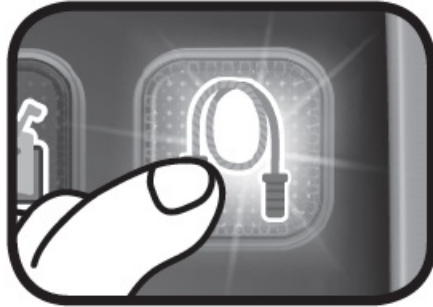
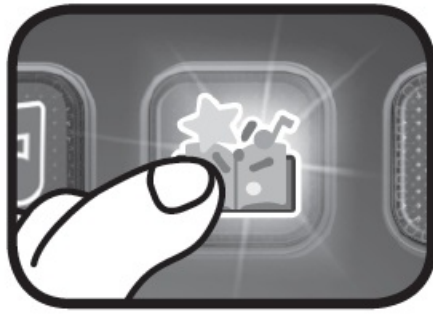

7. Calendar Button

Press the Calendar Button to listen to uplifting phrases and sounds. The lights will flash with the sounds.

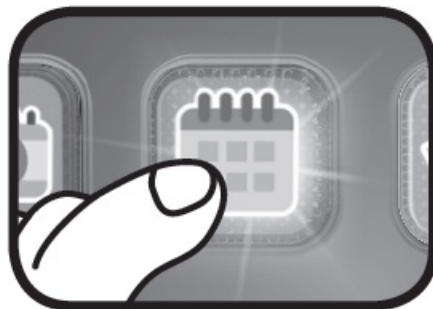
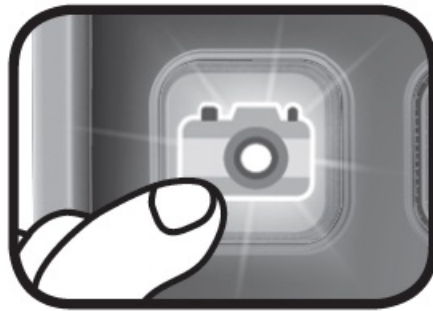

8. Mail Button

Press the Mail Button to discover numbers and hear counting sounds. The lights will flash with the sounds.

9. Weather Button

Press the Weather Button to explore different weather conditions. The lights will flash with the sounds.

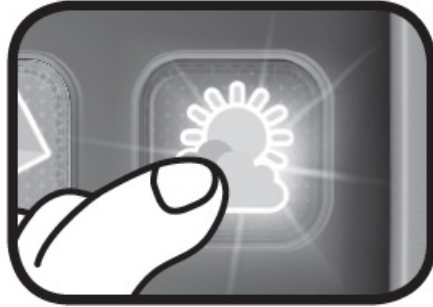
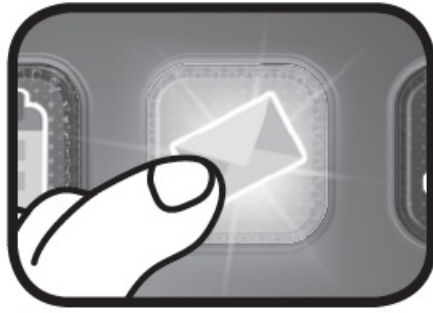

10. **Lion Button**

Press the Lion Button to hear Lion roaring sounds. The lights will flash with the sounds.

11. **Alarm Button**

Press the Alarm Button to enjoy playful sounds and phrases announcing upcoming events. The lights will flash with the sounds.

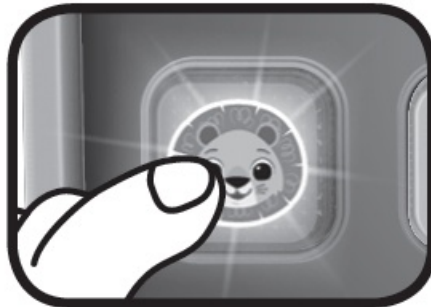

12. **Message Button**

Press the Message Button to engage with entertaining role-play phrases and sounds. The lights will flash with the sounds.

13. **Elephant Button**

Press the Elephant Button to hear elephants sounds. The lights will flash with the sounds.

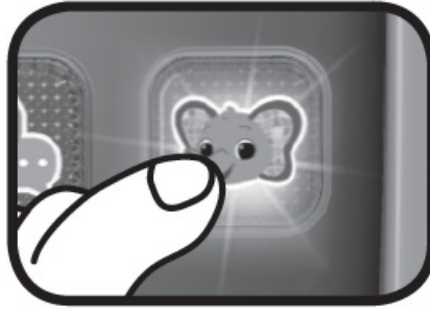
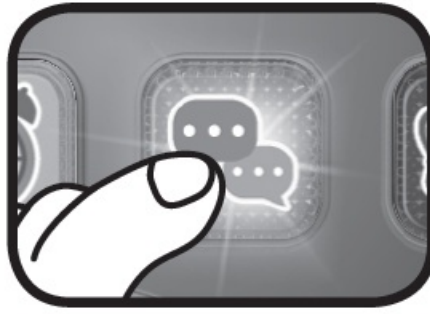

14. Direction Control Buttons

Press the Direction Control Buttons to interact with enjoyable sounds and control the light pattern on the tablet.

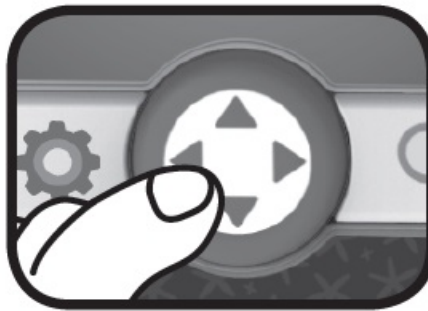

MELODIES

1. One, Two, Buckle My Shoe
2. Good Morning Merry Sunshine
3. Wheels on the Bus
4. Twinkle, Twinkle, Little Star
5. Sailor's Hornpipe
6. Incy Wincy Spider
7. Hickory, Dickory, Dock
8. Head and Shoulders
9. Glow Worm
10. Hey, Diddle Diddle

SONG LYRICS

• English Song 1

Are you ready to explore and have some fun? You can take this tablet wherever you go. Pressing, playing, learning, and talking with your animal pals.

- **English Song 2**

Playing and exploring, with this light-up tablet We can play pretend and sing-along all day.

CARE & MAINTENANCE

1. Keep the unit clean by wiping it with a slightly damp cloth.
2. Keep the unit out of direct sunlight and away from any direct heat sources.
3. Remove the batteries if the unit will not be in use for an extended period of time.
4. Do not drop the unit on hard surfaces and do not expose the unit to moisture or water.

TROUBLESHOOTING

If for some reason the unit stops working or malfunctions, please follow these steps:

1. Turn the unit Off.
2. Interrupt the power supply by removing the batteries.
3. Let the unit sit for a few minutes, then replace the batteries.
4. Turn the unit On. The unit should now be ready to play with again.
5. If the unit is not working properly, install a brand new set of batteries.

If the problem persists, please contact our Consumer Services Department, and a service representative will be happy to help you.

CONSUMER SERVICES

Creating and developing VTech® products is accompanied by a responsibility that we at VTech® take very seriously. We make every effort to ensure the accuracy of the information, which forms the value of our products. However, errors sometimes can occur. It is important for you to know that we stand behind our products and encourage you to call our Consumer Services Department with any problems and/or suggestions that you might have. A service representative will be happy to help you.

- **UK Customers:**

Phone: 0330 678 0149 (from UK) or +44 330 678 0149 (outside UK)

Website: www.vtech.co.uk/support

- **Australian Customers:**

Phone: 1800 862 155

Website: support.vtech.com.au

- **NZ Customers:**

Phone: 0800 400 785

Website: support.vtech.com.au

PRODUCT WARRANTY/ CONSUMER GUARANTEES

- **UK Customers:**

Read our complete warranty policy online at vtech.co.uk/warranty.

- **Australian Customers:**

VTECH ELECTRONICS (AUSTRALIA) PTY LIMITED – CONSUMER GUARANTEES

Under the Australian Consumer Law, a number of consumer guarantees apply to goods and services supplied by VTech Electronics (Australia) Pty Limited. Please refer to vtech.com.au/consumerguarantees for further information.

Visit our website for more information about our products, downloads, resources and more.

- www.vtech.co.uk
- www.vtech.com.au

Documents / Resources

| | |
|---|--|
|  | <p>Vtech 80-578543 Tiny Tech Tablet [pdf] Instruction Manual 80-578543, 80-578543 Tiny Tech Tablet, 80-578543, Tiny Tech Tablet, Tech Tablet, Tablet</p> |
|---|--|

References

- [User Manual](#)

Manuals+, Privacy Policy

This website is an independent publication and is neither affiliated with nor endorsed by any of the trademark owners. The "Bluetooth®" word mark and logos are registered trademarks owned by Bluetooth SIG, Inc. The "Wi-Fi®" word mark and logos are registered trademarks owned by the Wi-Fi Alliance. Any use of these marks on this website does not imply any affiliation with or endorsement.