

vtech 5696 Push and Ride Alphabet Train Multi Color Instruction Manual



Contents

1 Go! Go! Smart Wheels® Instruction Manual

1.1 Battery Removal and Installation

1.2 Unlock the packaging locks:

1.3 IMPORTANT: BATTERY INFORMATION

1.3.1 RECHARGEABLE BATTERIES

1.4 PRODUCT FEATURES

1.4.1 1. On/Off Switch

1.4.2 2. Automatic Shut-Off

1.5 ACTIVITIES

1.5.1 1. Light-Up Windshield Button

1.5.2 2. Moving Parts

1.5.3 3. Sounds and Melodies

1.5.4 4. SmartPoint® Locations

1.6 CARE & MAINTENANCE

1.7 TROUBLESHOOTING

2 Documents / Resources

2.1 References

3 Related Posts

Go! Go! Smart Wheels® Instruction Manual

Battery Removal and Installation

1. Make sure the unit is turned **Off**.
2. Find the battery cover located on the bottom of the unit, use a screwdriver to loosen the screw and then open the battery cover.
3. Remove old batteries by pulling up on one end of each battery.
4. Install 2 new AAA (AM-4/LR03) batteries following the diagram inside the battery box. (For best performance, alkaline batteries or fully charged Ni-MH rechargeable batteries are recommended.)
5. Replace the battery cover and tighten the screw to secure.

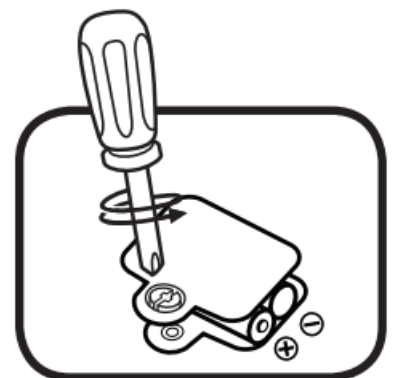

WARNING:

Adult assembly required for battery installation.
Keep batteries out of reach of children.

WARNING: All packing materials such as tape, plastic sheets, packaging locks, removable tags, cable ties, cords and packaging screws are not part of this toy, and should be discarded for your child's safety.

NOTE: Please save this Instruction Manual as it contains important information

Unlock the packaging locks:

- (1) Turn the packaging lock counterclockwise several times.
- (2) Pull out and discard the packaging lock.

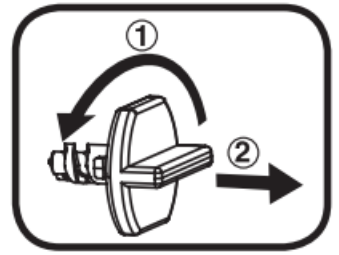

IMPORTANT: BATTERY INFORMATION

- Insert batteries with the correct polarity (+ and -).
- Do not mix old and new batteries.
- Do not mix alkaline, standard (carbon-zinc) or rechargeable batteries.
- Only batteries of the same or equivalent type as recommended are to be used.
- Do not short-circuit the supply terminals.
- Remove batteries during long periods of non-use.
- Remove exhausted batteries from the toy.
- Dispose of batteries safely. Do not dispose of batteries in fire.

RECHARGEABLE BATTERIES

- Remove rechargeable batteries (if removable) from the toy before charging.
- Rechargeable batteries are only to be charged under adult supervision.
- Do not charge non-rechargeable batteries.

PRODUCT FEATURES

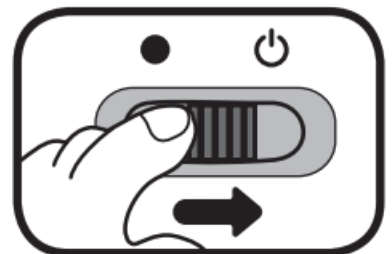

1. On/Off Switch

To turn the unit **On**, slide the **On/Off Switch** to the **On**  position. To turn the unit **Off**, slide the **On/Off Switch** to the **Off**  position.

2. Automatic Shut-Off

To preserve battery life, the **Go! Go! Smart Wheels®** vehicle will automatically shut off after approximately 60 seconds without input. The unit can be turned on again by pressing the **Light-Up Windshield Button** or pushing the vehicle quickly.

NOTE:

This product is in Try-Me mode in the packaging. After opening the package, turn the vehicle off and on again to proceed with normal play. If the unit powers down while playing, install a new set of batteries.

ACTIVITIES

1. Light-Up Windshield Button

Press the **Light-Up Windshield Button** to hear sounds, songs, phrases and melodies. A flashing light will accompany the responses.

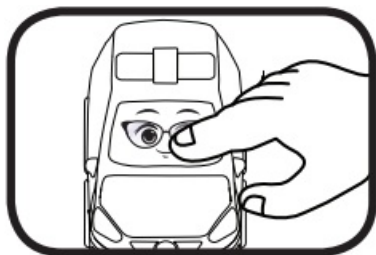

2. Moving Parts

Flip the moving part on the vehicle to activate fun sounds. A flashing light will accompany the sounds.

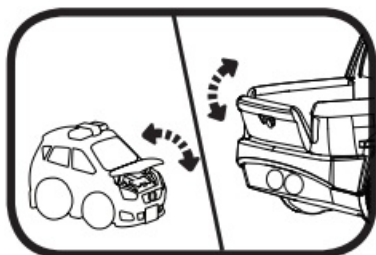

3. Sounds and Melodies

Push the vehicle to hear fun sounds. While a melody is playing, push the vehicle again to add in fun sounds on top of the melody. A flashing light will accompany the responses.

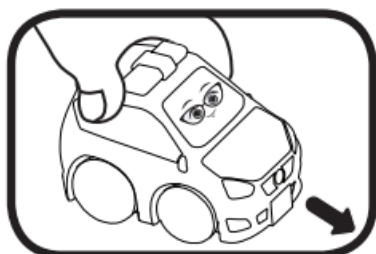

4. SmartPoint® Locations

For added fun, the vehicle responds to most Go! Go! Smart Wheels® playsets. Simply roll the vehicle over one of the **SmartPoint®** locations to see the light flash and to hear greetings, fun sounds, short tunes and singalong songs (playsets sold separately).

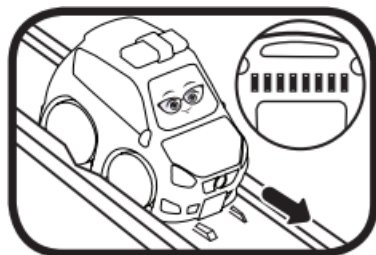

CARE & MAINTENANCE

1. Keep the unit clean by wiping it with a slightly damp cloth.

2. Keep the unit out of direct sunlight and away from any direct heat sources.
3. Remove the batteries if the unit will not be in use for an extended period of time.
4. Do not drop the unit on hard surfaces and do not expose the unit to moisture or water.

TROUBLESHOOTING

If for some reason the unit stops working or malfunctions, please follow these steps:

1. Turn the unit **Off**.
2. Interrupt the power supply by removing the batteries.
3. Let the unit stand for a few minutes, then replace the batteries.
4. Turn the unit **On**. The unit should now be ready to use again.
5. If the unit still does not work, install a new set of batteries.

IMPORTANT NOTE

If the problem persists, please call our **Consumer Services Department** at **1-800-521-2010** in the U.S., **1-877-352-8697** in Canada, or by going to our website vtechkids.com and filling out our **Contact Us** form located under the **Customer Support** link. Creating and developing VTech products is accompanied by a responsibility that we take very seriously. We make every effort to ensure the accuracy of the information, which forms the value of our products. However, errors sometimes can occur. It is important for you to know that we stand behind our products and encourage you to contact us with any problems and/or suggestions you might have. A service representative will be happy to help you.

NOTE:

This equipment has been tested and found to comply with the limits for a Class B digital device, pursuant to Part 15 of the FCC Rules. These limits are designed to provide reasonable protection against harmful interference in a residential installation. This equipment generates, uses and can radiate radio frequency energy and, if not installed and used in accordance with the instructions, may cause harmful interference to radio communications. However, there is no guarantee that interference will not occur in a particular installation. If this equipment does cause harmful interference to radio or television reception, which can be determined by turning the equipment off and on, the user is encouraged to try to correct the interference by one or more of the following measures:

- Reorient or relocate the receiving antenna.
- Increase the separation between the equipment and receiver.
- Connect the equipment into an outlet on a circuit different from that to which the receiver is connected.
- Consult the dealer or an experienced radio/TV technician for help.

CAUTION

Changes or modifications not expressly approved by the party responsible for compliance could void the user's authority to operate the equipment.

Supplier's Declaration of Conformity 47 CFR § 2.1077 Compliance Information

Trade Name: VTech®
Model: 5559/5560/5562/5563/5576/5577/5578/5653/ 5654/5655/5696/5697
Responsible Party: VTech Electronics North America, L.L.C.
Address: 1156 W. Shure Drive, Suite 200 Arlington Heights, IL 60004
Website: vtechkids.com

THIS DEVICE COMPLIES WITH PART 15 OF THE FCC RULES. OPERATION IS SUBJECT TO THE FOLLOWING TWO CONDITIONS: (1) THIS DEVICE MAY NOT CAUSE HARMFUL INTERFERENCE, AND (2) THIS DEVICE MUST ACCEPT ANY INTERFERENCE RECEIVED, INCLUDING INTERFERENCE THAT MAY CAUSE UNDESIRE OPERATION.

CAN ICES-003(B)/NMB-003(B)

Visit our website for more information about our products, downloads, resources and more.

vtechkids.com
vtechkids.ca

Read our complete warranty policy online at
vtechkids.com/warranty
vtechkids.ca/warranty



TM & © 2022 VTech Holdings Limited.
All rights reserved.
Printed in China.
91-004177-011 (US) (CA)

Documents / Resources

	vtech 5696 Push and Ride Alphabet Train Multi Color [pdf] Instruction Manual 5696 Push and Ride Alphabet Train Multi Color, 5696, Push and Ride Alphabet Train Multi Color, Alphabet Train Multi Color, Train Multi, Color
---	---

References

- [✔ VTech Canada | Official Electronic Learning Toys & Games for Kids](#)
- [✔ VTech Canada | Official Electronic Learning Toys & Games for Kids](#)
- [✔ Best Kids Tech Toys | Electronic Learning Toys | VTech America](#)
- [✔ Best Kids Tech Toys | Electronic Learning Toys | VTech America](#)
- [📄 Manual-Hub.com - Free PDF manuals!](#)
- [User Manual](#)

[Manuals+](#), [Privacy Policy](#)

This website is an independent publication and is neither affiliated with nor endorsed by any of the trademark owners. The "Bluetooth®" word mark and logos are registered trademarks owned by Bluetooth SIG, Inc. The "Wi-Fi®" word mark and logos are registered trademarks owned by the Wi-Fi Alliance. Any use of these marks on this website does not imply any affiliation with or endorsement.