

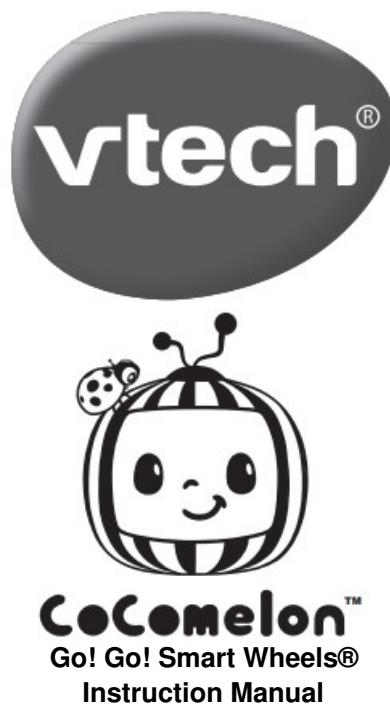

VTech 5580 Cocomelon Go Go Smart Wheels Codys User Guide

[Home](#) » [vtech](#) » VTech 5580 Cocomelon Go Go Smart Wheels Codys User Guide 



Contents

- [1 5580 Cocomelon Go Go Smart Wheels Codys](#)
- [2 PRODUCT FEATURES](#)
- [3 ACTIVITIES](#)
- [4 CARE & MAINTENANCE](#)
- [5 TROUBLESHOOTING](#)
- [6 Documents / Resources](#)
 - [6.1 References](#)

Battery Removal and Installation

1. Make sure the unit is turned Off.
2. Find the battery cover located on the bottom of the unit, use a screwdriver to loosen the screw and then open the battery cover.
3. Remove old batteries by pulling up on one end of each battery.
4. Install 2 new AAA (AM-4/LR03) batteries following the diagram inside the battery box. (For best performance, alkaline batteries or fully charged Ni-MH rechargeable batteries are recommended.)
5. Replace the battery cover and tighten the screw to secure.

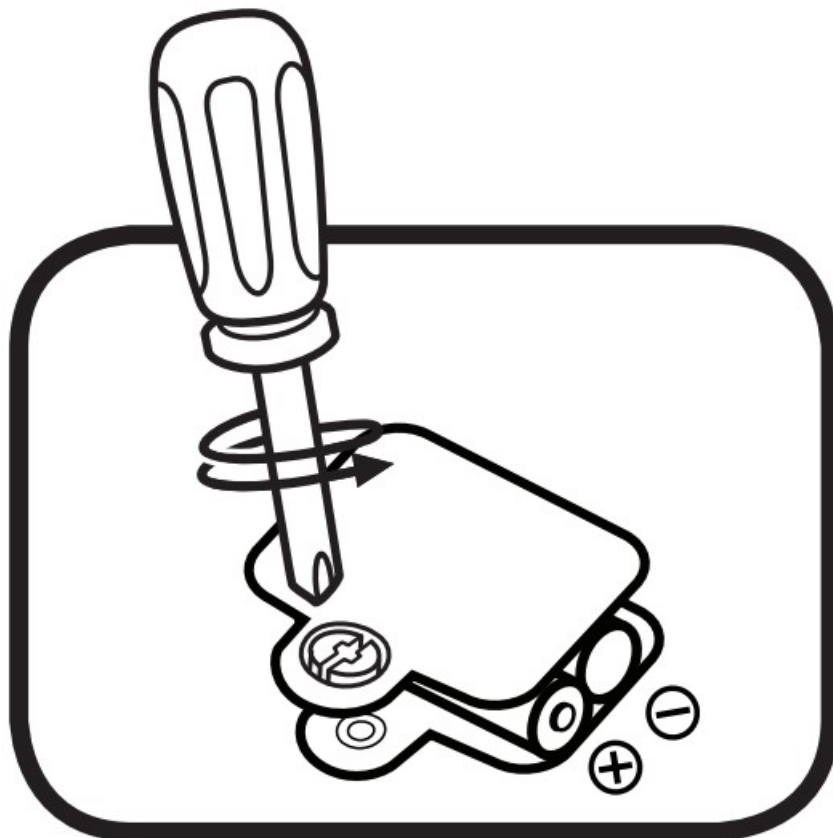

WARNING:

Adult assembly required for battery installation.

Keep batteries out of reach of children.

WARNING: All packing materials such as tape, plastic sheets, packaging locks, removable tags, cable ties, cords and packaging screws are not part of this toy, and should be discarded for your child's safety.

NOTE: Please save this Instruction Manual as it contains important information.

Unlock the packaging locks:

1. Turn the packaging lock counterclockwise several times.
2. Pull out and discard the packaging lock.

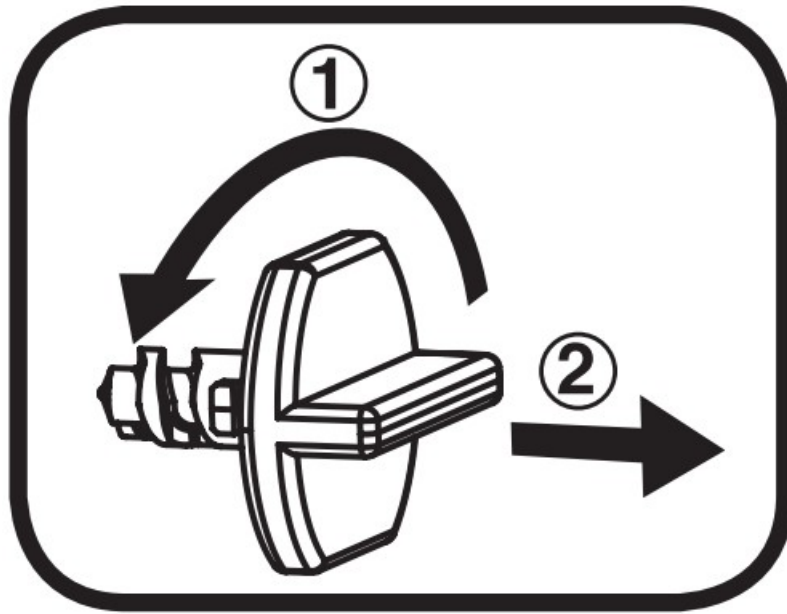

IMPORTANT: BATTERY INFORMATION

- Insert batteries with the correct polarity (+ and -).
- Do not mix old and new batteries.
- Do not mix alkaline, standard (carbon-zinc) or rechargeable batteries.
- Only batteries of the same or equivalent type as recommended are to be used.
- Do not short-circuit the supply terminals.
- Remove batteries during long periods of non-use.
- Remove exhausted batteries from the toy.
- Dispose of batteries safely. Do not dispose of batteries in fire.

RECHARGEABLE BATTERIES

- Remove rechargeable batteries (if removable) from the toy before charging.
- Rechargeable batteries are only to be charged under adult supervision.
- Do not charge non-rechargeable batteries.

PRODUCT FEATURES

1. On/Off Switch

To turn the unit On, slide the On/Off Switch to the On  position. To turn the unit Off, slide the On/Off Switch to the Off  position.

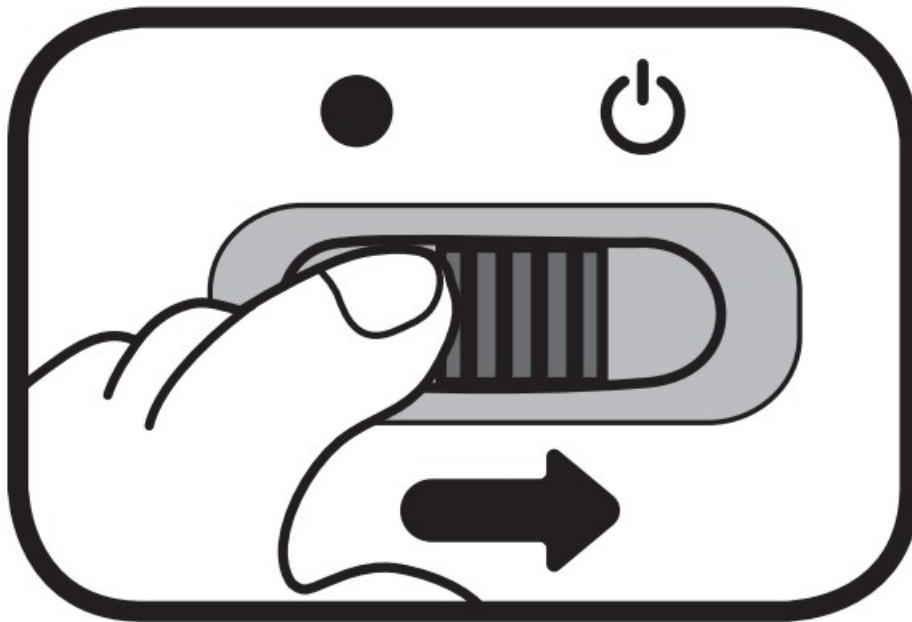

2. Automatic Shut-Off

To preserve battery life, the Go! Go! Smart Wheels® vehicle will automatically shut off after approximately 60 seconds without input. The unit can be turned on again by pressing the Figure Button or triggering a Smartpoint® location.

NOTE: This product is in Try-Me mode in the packaging. After opening the package, turn the vehicle off and on again or put the vehicle on Smartpoint® to proceed with normal play. If the unit powers down while playing, install a new set of batteries.

ACTIVITIES

1. Figure Button

Press the figure button to hear sounds, songs, phrases and melodies. A flashing light will accompany the responses.

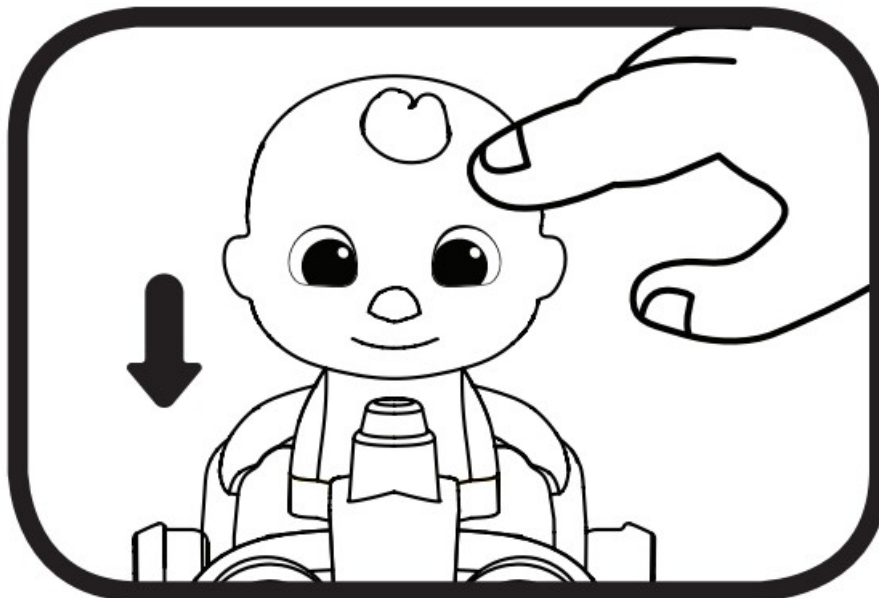

2. SmartPoint® Locations

Put the vehicle on the SmartPoint® of the bundled track piece to see the light flash and to hear JJ talk, sound effects, short tunes and sing-along songs. For added fun, the vehicle also responds to other SmartPoint® locations of Go! Go! Smart Wheels® playsets (playsets sold separately).

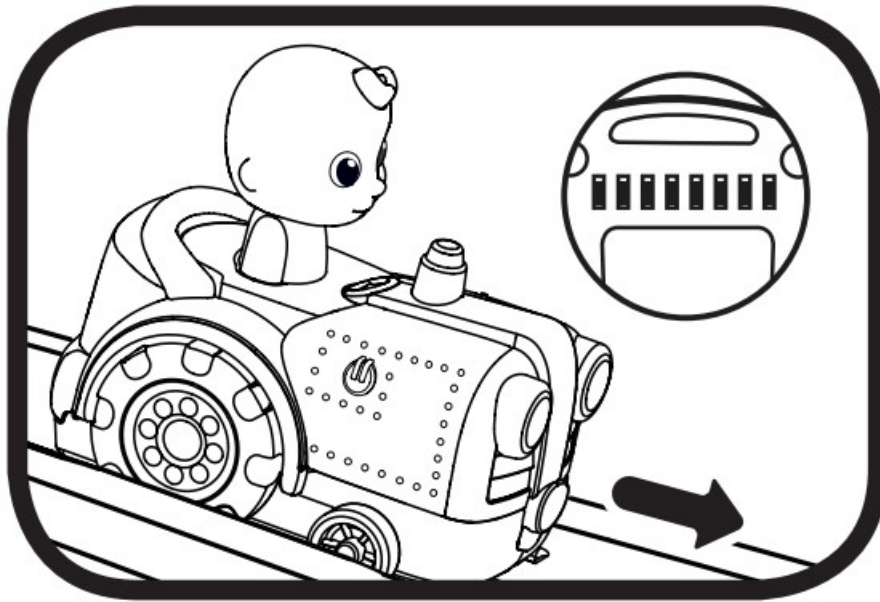

CARE & MAINTENANCE

1. Keep the unit clean by wiping it with a slightly damp cloth.
2. Keep the unit out of direct sunlight and away from any direct heat sources.
3. Remove the batteries if the unit will not be in use for an extended period of time.
4. Do not drop the unit on hard surfaces and do not expose the unit to moisture or water.

TROUBLESHOOTING

If for some reason the unit stops working or malfunctions, please follow these steps:

1. Turn the unit Off.
2. Interrupt the power supply by removing the batteries.
3. Let the unit stand for a few minutes, then replace the batteries.
4. Turn the unit On. The unit should now be ready to use again.
5. If the unit still does not work, install a new set of batteries.

IMPORTANT NOTE

If the problem persists, please call our Consumer Services Department at 1-800-521-2010 in the U.S., 1-877-352-8697 in Canada, or by going to our website vtechkids.com and filling out our Contact Us form located under the Customer Support link. Creating and developing VTech products is accompanied by a responsibility that we take very seriously. We make every effort to ensure the accuracy of the information, which forms the value of our products. However, errors sometimes can occur. It is important for you to know that we stand behind our products and encourage you to contact us with any problems and/or suggestions you might have. A service representative will be happy to help you.

NOTE:

This equipment has been tested and found to comply with the limits for a Class B digital device, pursuant to Part 15 of the FCC Rules. These limits are designed to provide reasonable protection against harmful interference in a residential installation. This equipment generates, uses and can radiate radio frequency energy and, if not installed and used in accordance with the instructions, may cause harmful interference to radio communications. However, there is no guarantee that interference will not occur in a particular installation. If this equipment does cause harmful interference to radio or television reception, which can be determined by turning the equipment off and on, the user is encouraged to try to correct the interference by one or more of the following measures:

- Reorient or relocate the receiving antenna.
- Increase the separation between the equipment and receiver.
- Connect the equipment into an outlet on a circuit different from that to which the receiver is connected.
- Consult the dealer or an experienced radio/TV technician for help.

CAUTION

Changes or modifications not expressly approved by the party responsible for compliance could void the user's authority to operate the equipment.

Supplier's Declaration of Conformity

47 CFR § 2.1077 Compliance Information

Trade Name: VTech®

Model: 5580/5581/5613/5614

Responsible Party: VTech Electronics North America, L.L.C.

Address: 1156 W. Shure Drive, Suite 200

Arlington Heights, IL 60004

Website: vtechkids.com

THIS DEVICE COMPLIES WITH PART 15 OF THE FCC RULES.

OPERATION IS SUBJECT TO THE FOLLOWING TWO CONDITIONS:

(1) THIS DEVICE MAY NOT CAUSE HARMFUL INTERFERENCE, AND (2) THIS DEVICE MUST ACCEPT ANY INTERFERENCE RECEIVED, INCLUDING INTERFERENCE THAT MAY CAUSE UNDESIRE OPERATION.

CAN ICES-003(B)/NMB-003(B)

Visit our website for more information about our products, downloads, resources and more.

vtechkids.com

vtechkids.ca

Read our complete warranty policy online at

vtechkids.com/warranty

vtechkids.ca/warranty



CoComelon™ & © 2022 Moonbug Entertainment.

All Rights Reserved.

TM & © 2022 VTech Holdings Limited.

All rights reserved.

Printed in China.

91-004198-001

Documents / Resources

A small thumbnail image of the user guide document, showing a page with text and a small illustration of a child's hand.	<p>VTech 5580 Cocomelon Go Go Smart Wheels Codys [pdf] User Guide</p> <p>5580 Cocomelon Go Go Smart Wheels Codys, 5580, Cocomelon Go Go Smart Wheels Codys, Smart Wheels Codys, Wheels Codys</p>
--	--

References

- [!\[\]\(fd4127b9e2af37bd6ea0fa06afa8e6d8_img.jpg\) VTech Canada | Official Electronic Learning Toys & Games for Kids](#)
- [!\[\]\(3278d6283d12f18012b5aa7d40747611_img.jpg\) VTech Canada | Official Electronic Learning Toys & Games for Kids](#)
- [!\[\]\(bb96b32142ec45f72f12316beae3ef61_img.jpg\) Best Kids Tech Toys | Electronic Learning Toys | VTech America](#)
- [!\[\]\(a75d0d7d1ac0ea815a0c027a77b137d5_img.jpg\) Best Kids Tech Toys | Electronic Learning Toys | VTech America](#)
- [User Manual](#)