



## Vtech 549303 Dino 2-in-1 Launcher Instruction Manual

[Home](#) » [vtech](#) » Vtech 549303 Dino 2-in-1 Launcher Instruction Manual 

### Vtech 549303 Dino 2-in-1 Launcher Instruction Manual



#### Contents

- 1 INTRODUCTION
- 2 INCLUDED IN THE PACKAGE
- 3 INSTRUCTIONS
- 4 RECHARGEABLE BATTERIES
- 5 PRODUCT FEATURES
- 6 HOW TO SWITCH
- 7 Combination
- 8 CARE & MAINTENANCE
- 9 TROUBLESHOOTING
- 10 CONSUMER SERVICES
- 11 PRODUCT WARRANTY/ CONSUMER GUARANTEES
- 12 Documents / Resources
  - 12.1 References

## INTRODUCTION

Switch into fun with Switch & Go Dinos® Dino Launcher 2-In-1! Combine these two daring prehistoric creatures to form a mega car! Launch the two fireball projectiles, then launch the race car and watch it switch into a super Spinosaurus as it rockets forward.

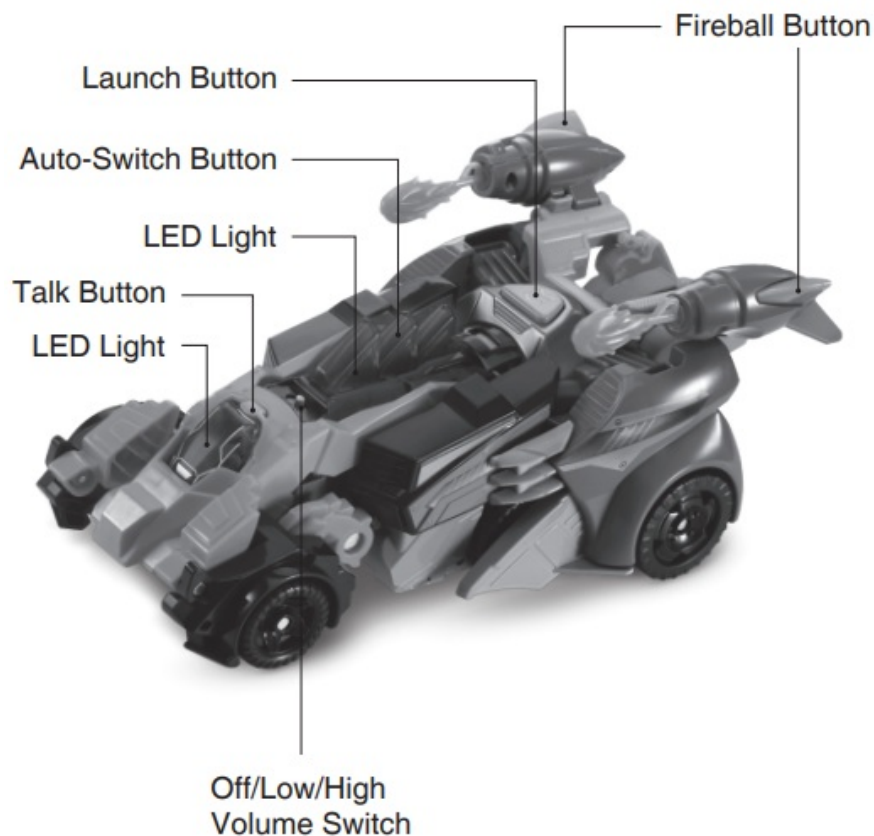

## INCLUDED IN THE PACKAGE

- One Switch & Go Dinos® Dino Launcher 2-in-1
- One Quick Start Guide

### WARNING

All packing materials such as tape, plastic sheets, packaging locks, removable tags, cable ties, cords and packaging screws are not part of this toy, and should be discarded for your child's safety.

### NOTE

Please save this Instruction Manual as it contains important information.

### WARNING

Do not aim at eyes or face.

### WARNING

Do not discharge any object other than the projectile provided with this toy.

## INSTRUCTIONS

### Battery Removal and Installation

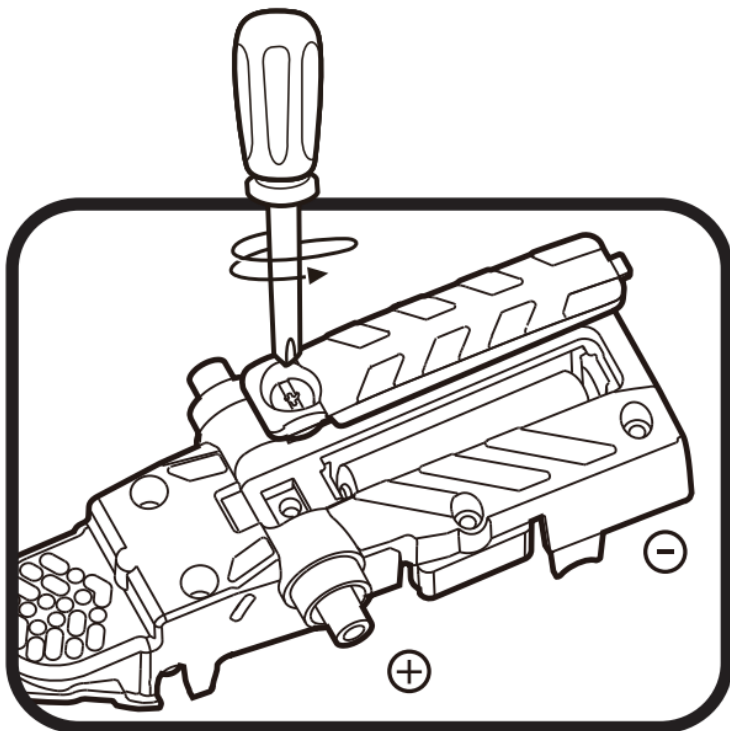

1. Make sure the unit is turned Off.
2. Find the battery cover located on the bottom of the unit, use a screwdriver to loosen the screw, and then open the battery cover.
3. Remove the old battery by pulling up on one end of the battery.
4. Install 1 new AAA (LR03/ AM-4) battery following the diagram inside the battery box. (For best performance, alkaline batteries or fully Ni-MH charged rechargeable batteries are recommended).
5. Replace the battery cover and tighten the screw to secure.

**WARNING:**

Adult assembly required for battery installation. Keep batteries out of reach of children.

**IMPORTANT: BATTERY INFORMATION**

- Insert batteries with the correct polarity (+ and -).
- Do not mix old and new batteries.
- Do not mix alkaline, standard (carbon-zinc) or rechargeable batteries.
- Only batteries of the same or equivalent type as recommended are to be used.
- Do not short-circuit the supply terminals.
- Remove batteries during long periods of non-use.
- Remove exhausted batteries from the toy.
- Dispose of batteries safely. Do not dispose of batteries in fire.

**RECHARGEABLE BATTERIES**

- Remove rechargeable batteries from the toy before charging.
- Rechargeable batteries are only to be charged under adult supervision.
- Do not charge non-rechargeable batteries.

## NOTE

This product is in Try-Me mode in the packaging. After opening the package, turn Switch & Go Dinos® Dino Launcher 2-in-1 off and on again to proceed with normal play. If the unit powers down or if the light fades out during play, please install a new battery.

## Disposal of batteries and product



The crossed-out wheeled bin symbols on products and batteries, or on their respective packaging, indicates they must not be disposed of in domestic waste as they contain substances that can be damaging to the environment and human health.



The chemical symbols Hg, Cd or Pb, where marked, indicate that the battery contains more than the specified value of mercury (Hg), cadmium (Cd) or lead (Pb) set out in the Batteries and Accumulators Regulation. The solid bar indicates that the product was placed on the market after 13th August, 2005. Please dispose of your product and batteries responsibly. In the UK, give this toy a second life by disposing of it at a small electricals collection point\* so all of its materials can be recycled.

Learn more at:



[www.vtech.co.uk/recycle](http://www.vtech.co.uk/recycle)

[www.vtech.com.au/sustainability](http://www.vtech.com.au/sustainability)

\* Visit [www.recyclenow.com](http://www.recyclenow.com) to see a list of collection points near you.

## PRODUCT FEATURES

### 1. Off/Low/High Volume Switch

To turn the unit On or to adjust the volume,  slide the Off/Low/High  Volume Switch to the Low or High Volume position. To turn the unit Off, slide the switch to the Off position. 

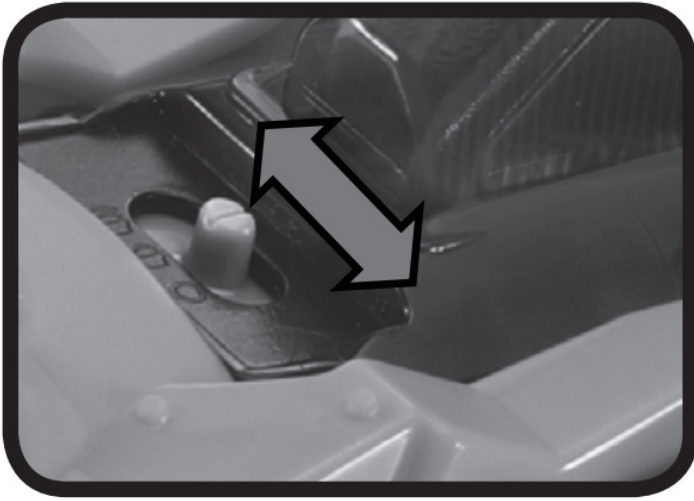

## 2. Talk Button

Press the Talk Button to hear fun phrases and cool dinosaur sounds with light effects in Dino mode, or to hear fun phrases and great vehicle sounds in Vehicle mode.

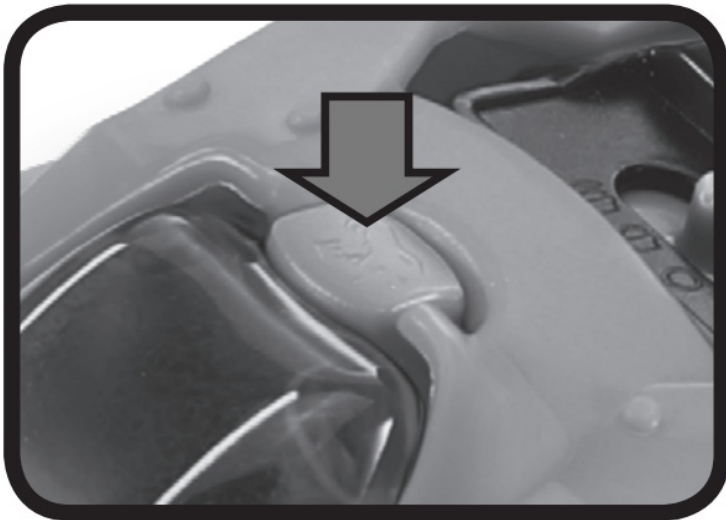

## 3. Auto-Switch Button

In Vehicle mode, press the AutoSwitch Button to automatically switch from Vehicle mode to Dino mode.

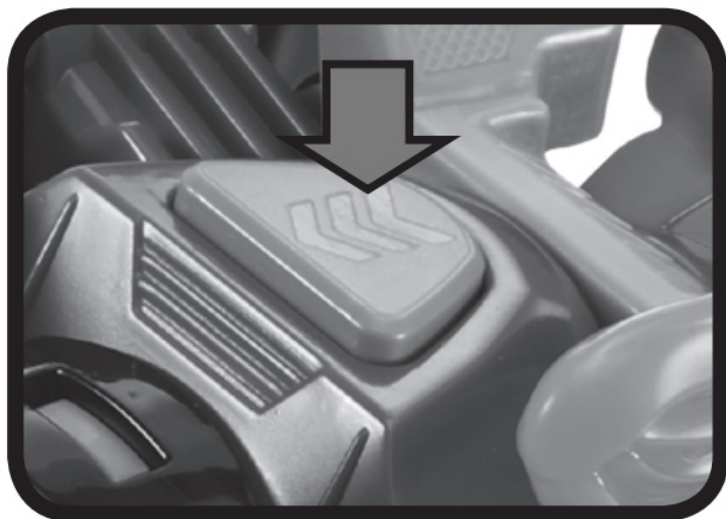

## 4. Launch Button

In Mega Car mode, press the Launch Button to launch the race car and switch into a Spinosaurus

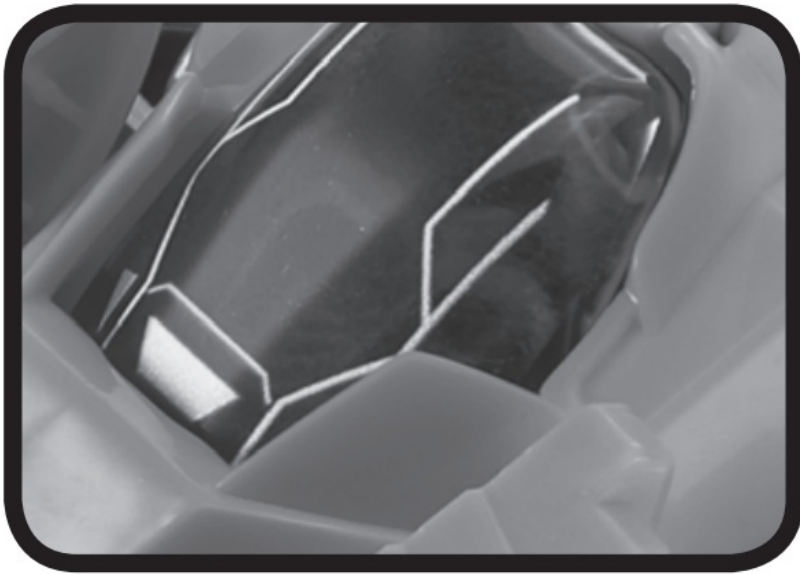

#### 5. **LED Lights**

The LED Lights flash along with the sounds in all modes.

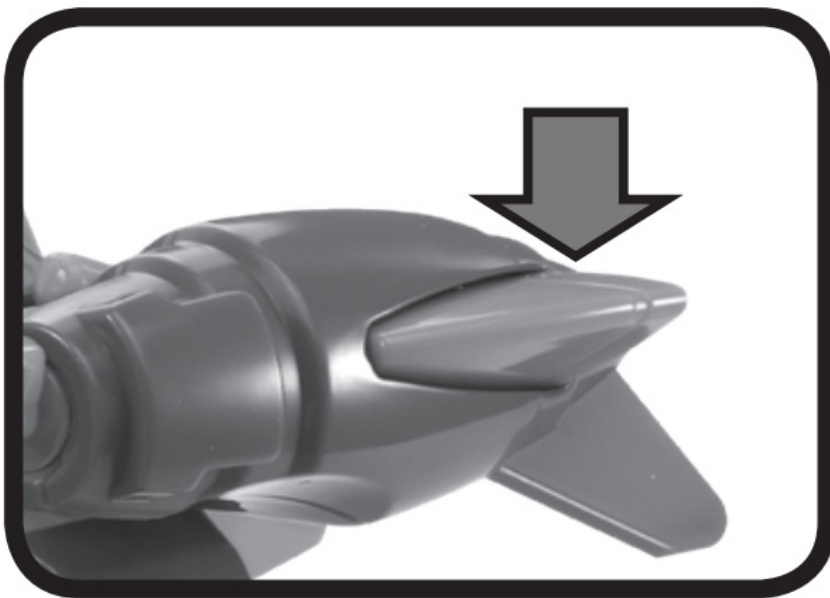

#### 6. **Fireball Button**

Press the Fireball Button to launch a fireball projectile.

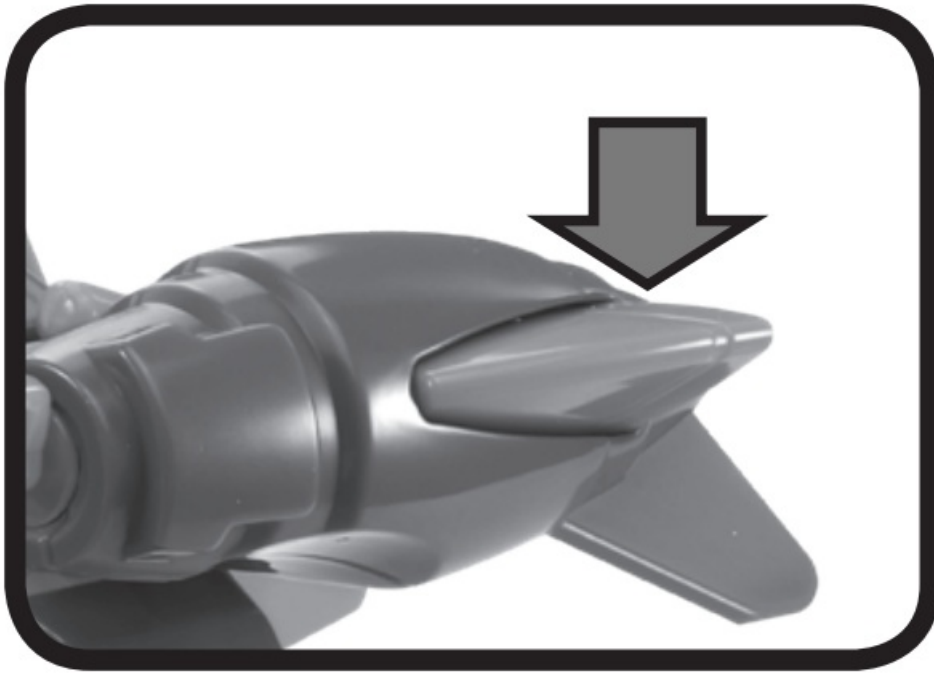

### 7. Automatic Shut-Off

To preserve battery life, the unit will automatically shut off after approximately 20 seconds without input. The unit can be turned on again by pressing the Talk Button, or by switching between Dino and Vehicle modes. The unit will also automatically turn off when battery power is very low.

### 8. NOTE

If the unit powers down or if the light fades out during play, please install a new battery.

## HOW TO SWITCH

Switching from Spinosaurus mode to Vehicle mode

1. Begin in Spinosaurus mode.

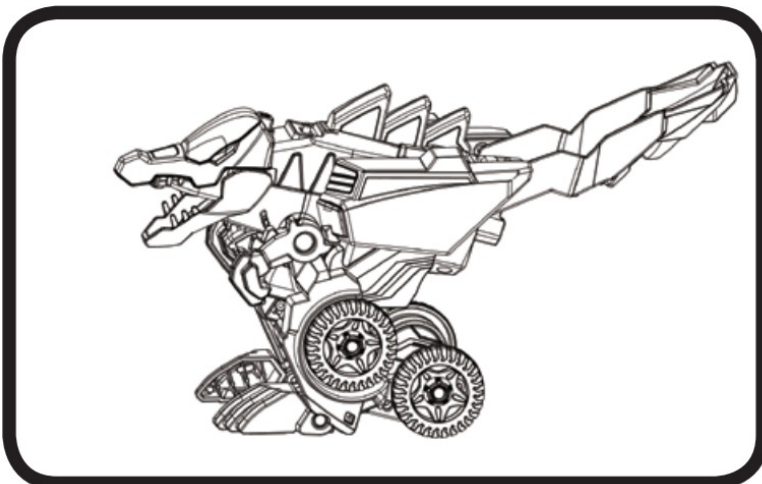

2. Flip the tail towards the head of the dino.



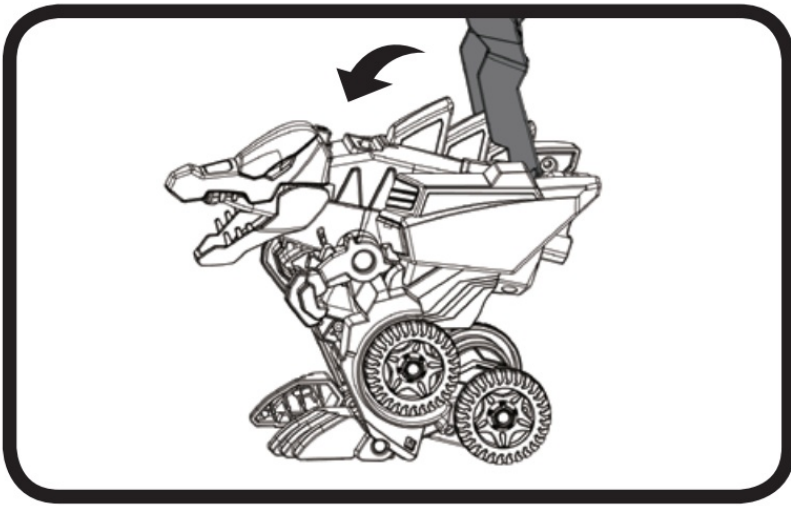

3. Push the back wheels up.

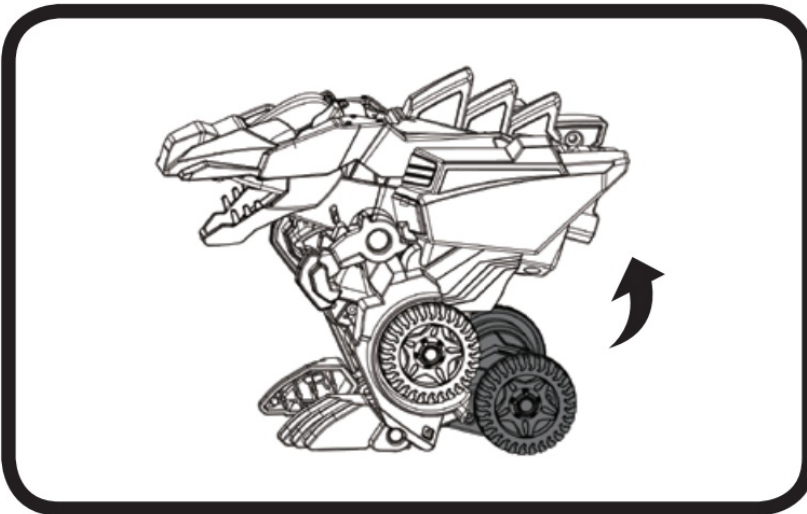

4. Flip the Dino's mouth up and then flip the legs towards the head of the dino.

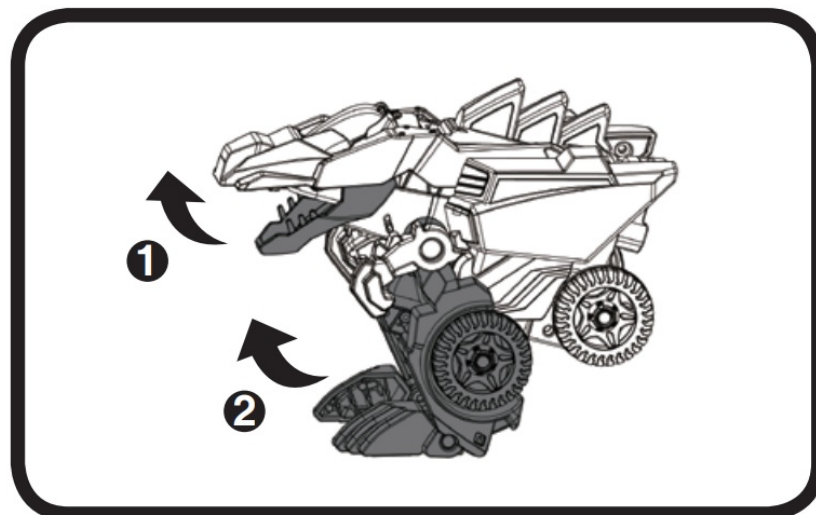

5. The Spinosaurus is now in Vehicle mode



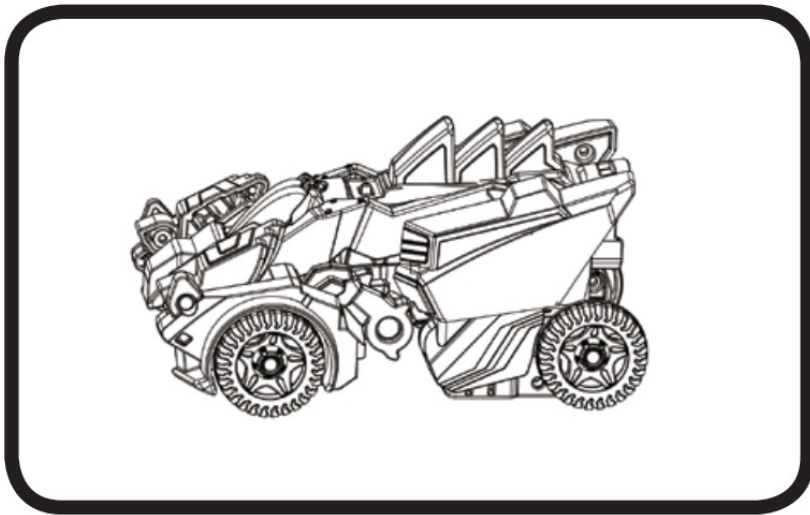

### Switching from Vehicle mode to Spinosaurus mode

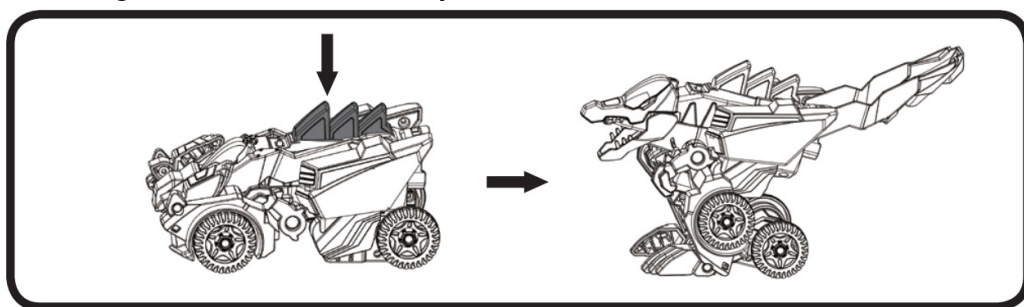

Press the Auto-Switch Button to automatically switch from Vehicle to Spinosaurus mode

### Switching from Pterodactyl mode to Launcher mode

1. Begin in Pterodactyl mode

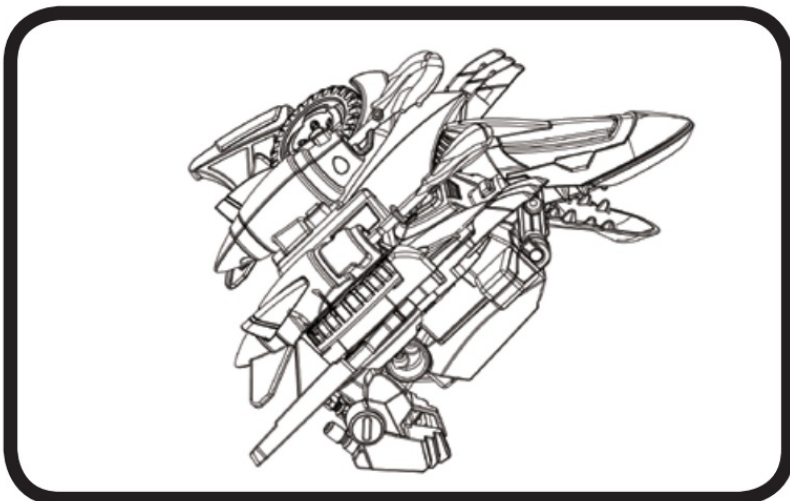

2. Flip the head down towards the Pterodactyl's body

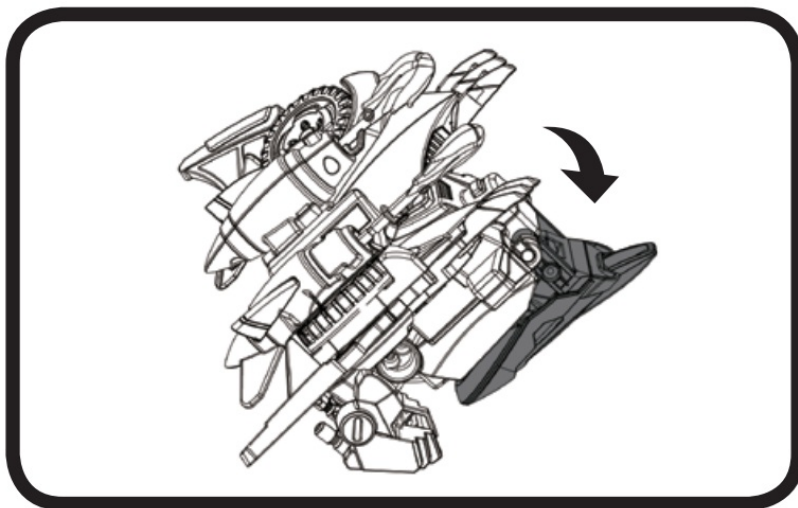

3. Flip the wing tips up and then fold the wings towards the Pterodactyl's body

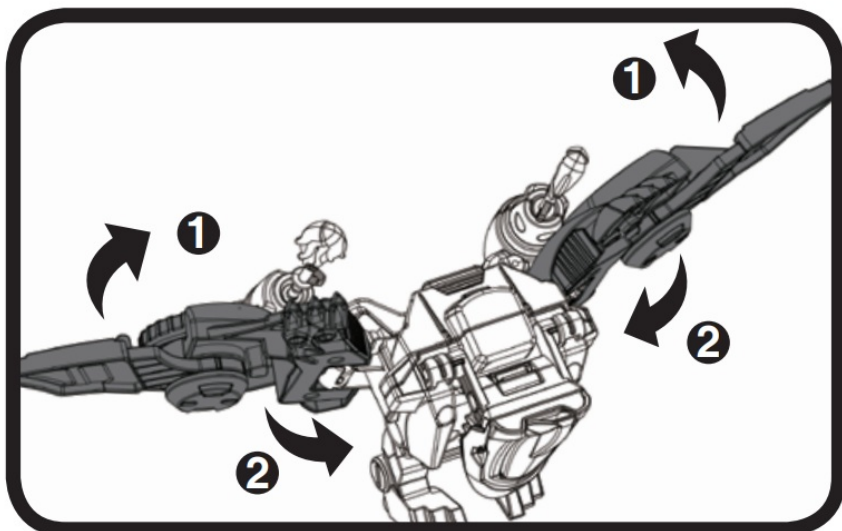

4. Flip the feet up

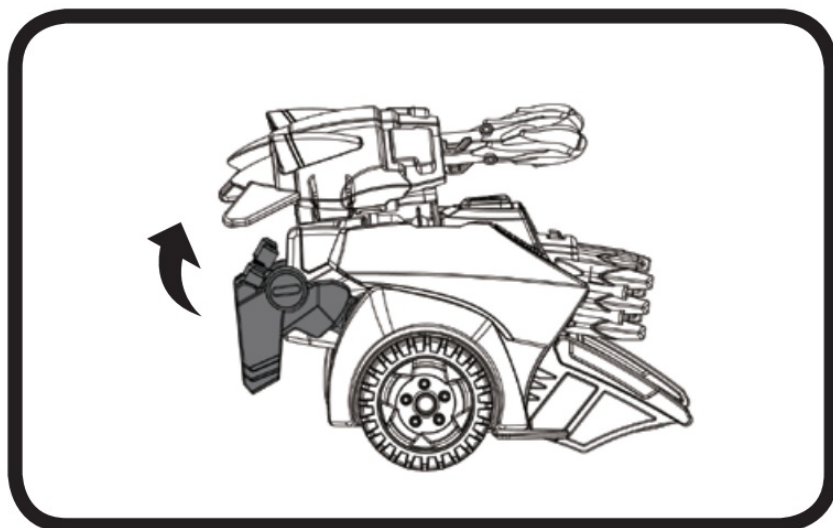

5. The Pterodactyl is now in Launcher mode.

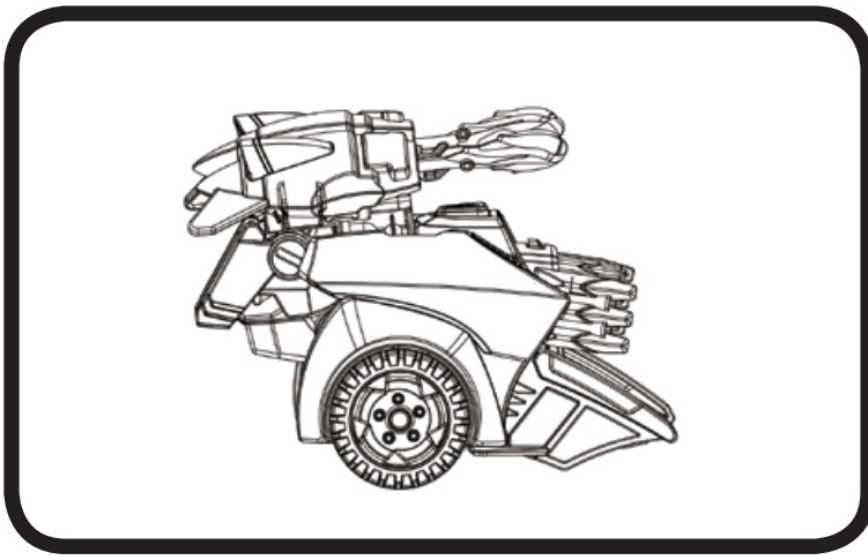

## Combination

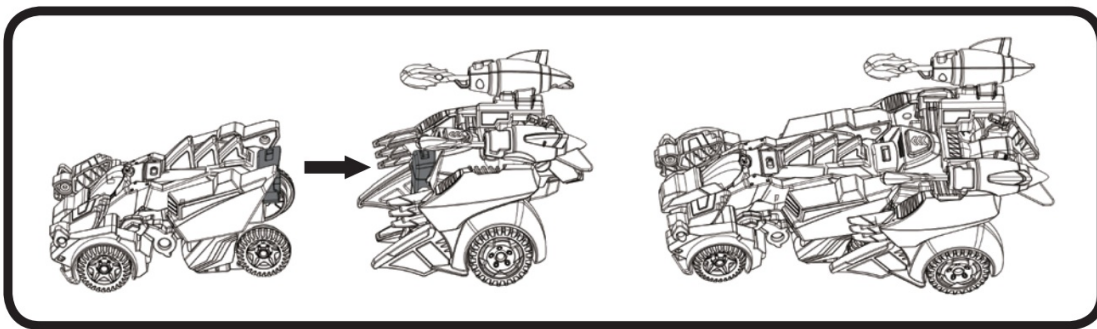

Insert the vehicle into the launcher to form the Mega Car.

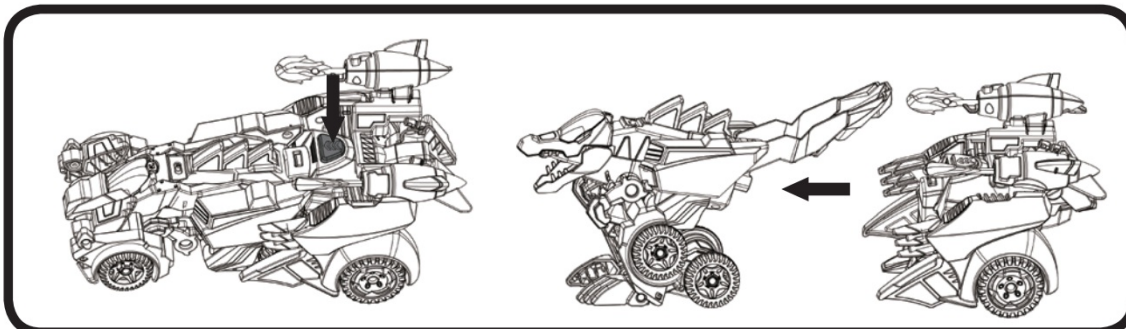

Press the Launch Button to release the vehicle and auto-switch into a Spinosaurus.

## CARE & MAINTENANCE

1. Keep the unit clean by wiping it with a slightly damp cloth.
2. Keep the unit out of direct sunlight and away from any direct heat source.
3. Remove the batteries when the unit is not in use for an extended period of time.
4. Do not drop the unit on hard surfaces and do not expose the unit to moisture or water.

## TROUBLESHOOTING

If for some reason the program/activity stops working or malfunctions, please follow these steps:

1. Please turn the unit OFF.
2. Interrupt the power supply by removing the batteries.
3. Let the unit stand for a few minutes, then replace the batteries.
4. Turn the unit ON. The unit should now be ready to play with again.
5. If the product still does not work, install a brand new set of batteries.

If the problem persists, please contact our Consumer Services Department and a service representative will be happy to help you.

## **CONSUMER SERVICES**

Creating and developing VTech® products is accompanied by a responsibility that we at VTech® take very seriously. We make every effort to ensure the accuracy of the information, which forms the value of our products. However, errors sometimes can occur. It is important for you to know that we stand behind our products and encourage you to call our Consumer Services Department with any problems and/or suggestions that you might have. A service representative will be happy to help you

### **UK Customers:**

Phone: 0330 678 0149 (from UK) or +44 330 678 0149 (outside UK)

Website: [www.vtech.co.uk/support](http://www.vtech.co.uk/support)

### **Australian Customers:**

Phone: 1800 862 155

Website: [support.vtech.com.au](http://support.vtech.com.au)

### **NZ Customers:**

Phone: 0800 400 785

Website: [support.vtech.com.au](http://support.vtech.com.au)

## **PRODUCT WARRANTY/ CONSUMER GUARANTEES**

### **UK Customers:**

Read our complete warranty policy online at [vtech.co.uk/warranty](http://vtech.co.uk/warranty).

Australian Customers:

### **VTECH ELECTRONICS (AUSTRALIA) PTY LIMITED – CONSUMER GUARANTEES**

Under the Australian Consumer Law, a number of consumer guarantees apply to goods and services supplied by VTech Electronics (Australia) Pty Limited. Please refer to [vtech.com.au/consumerguarantees](http://vtech.com.au/consumerguarantees) for further information.

### **Visit our website for more**

information about our products,  
downloads, resources and more.

[www.vtech.co.uk](http://www.vtech.co.uk)

[www.vtech.com.au](http://www.vtech.com.au)



## Documents / Resources



[Vtech 549303 Dino 2-in-1 Launcher](#) [pdf] Instruction Manual  
549303 Dino 2-in-1 Launcher, 549303, Dino 2-in-1 Launcher, Launcher

## References

- [📞 Support : VTech Electronics](#)
- [📖 Electronic Learning Toys | Best Learning Toys | VTech UK](#)
- [📖 VTech Toys Australia - Electronic Learning Toys - Best Learning Toys - VTech Australia and New Zealand](#)
- [📖 Electronic Learning Toys | Best Learning Toys | VTech UK](#)
- [📖 Electronic Learning Toys | Best Learning Toys | VTech UK](#)
- [📖 Electronic Learning Toys | Best Learning Toys | VTech UK](#)
- [📖 VTech Toys Australia - Electronic Learning Toys - Best Learning Toys - VTech Australia and New Zealand](#)