



vttech 4-in-1 Learning Letters Train Instruction Manual

[Home](#) » [vttech](#) » vttech 4-in-1 Learning Letters Train Instruction Manual 

Contents

- [1 vttech 4-in-1 Learning Letters Train](#)
- [2 INTRODUCTION](#)
- [3 INCLUDED IN THE PACKAGE](#)
- [4 Quick Start Guide](#)
- [5 Battery Removal and Installation](#)
- [6 IMPORTANT: BATTERY INFORMATION](#)
- [7 LABEL APPLICATION](#)
- [8 ASSEMBLY INSTRUCTIONS](#)
- [9 PRODUCT FEATURES](#)
- [10 ACTIVITIES](#)
- [11 MELODIES](#)
- [12 SONG LYRICS](#)
- [13 CARE & MAINTENANCE](#)
- [14 TROUBLESHOOTING](#)
- [15 FCC STATEMENT](#)
- [16 Documents / Resources](#)
 - [16.1 References](#)
- [17 Related Posts](#)



vttech 4-in-1 Learning Letters Train



INTRODUCTION

Thank you for purchasing the 4-in-1 Learning Letters Train™.

Enjoy multiple ways to play with a detachable electronic learning panel, a ride-on train, pull-cart and interactive blocks. Learn about 26 letters, animals and objects by inserting the 13 double-sided learning blocks into the recognition port. Take the learning panel on-the-go to learn and play with fun sounds, phrases, songs and melodies. All aboard for learning!

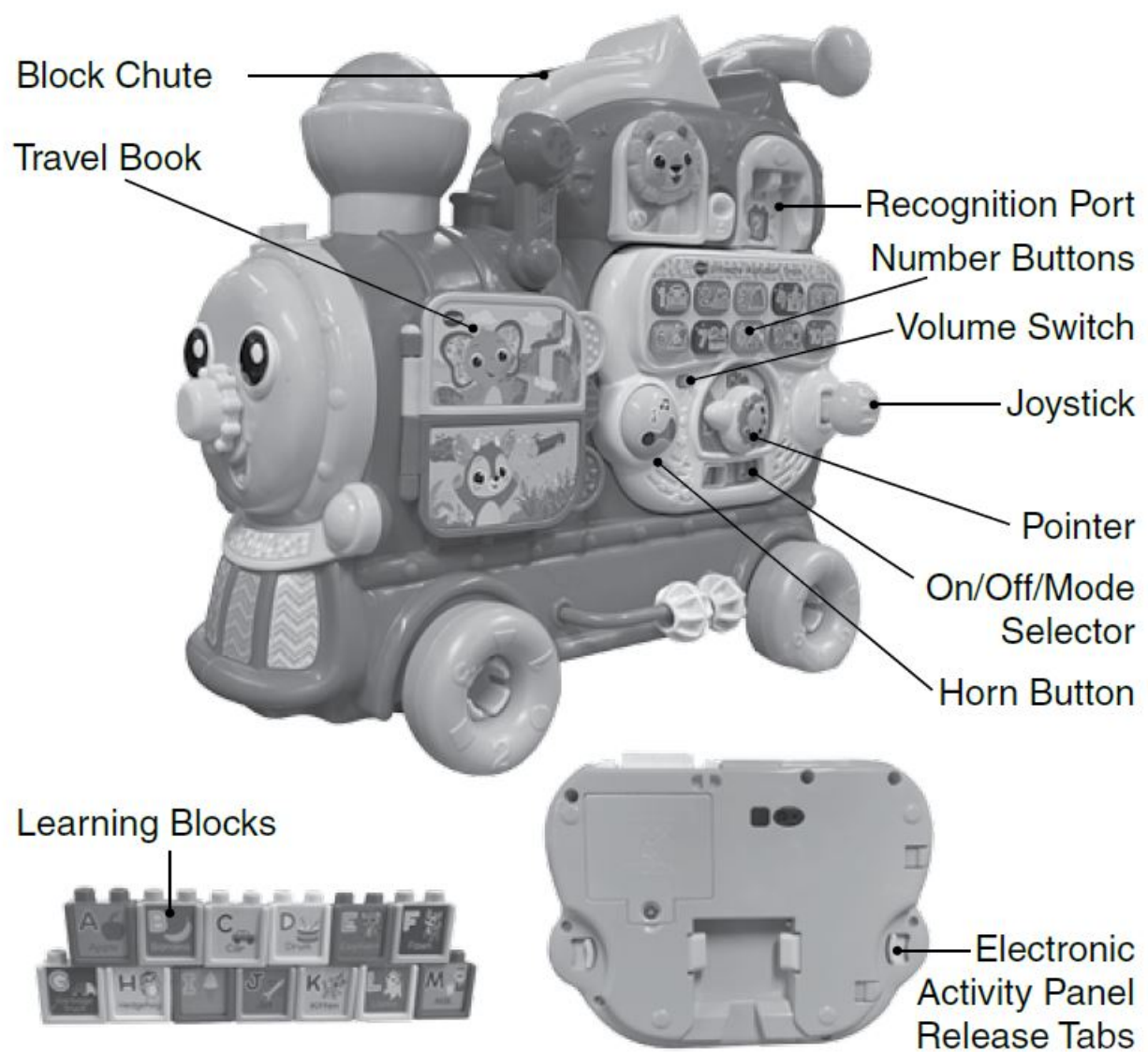

INCLUDED IN THE PACKAGE

4-in-1 Learning Letters Train™



Train Engine

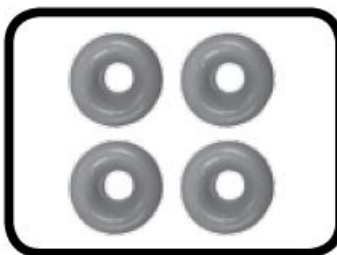

4 Engine Wheels

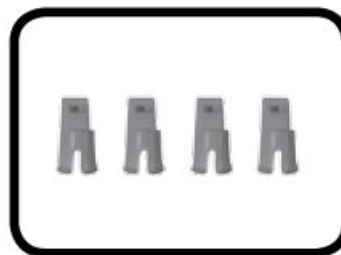

4 Engine Wheel
Axle Covers



Handle



Bead Rail



Joystick



Hinge



Pull Cart
Front Support



2 Pull Cart
Back Supports



Pull Cart Seat



Pull Cart Base

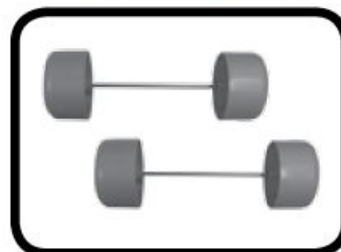

2 Sets of Pull Cart
Wheels with Axles



Electronic
Activity Panel

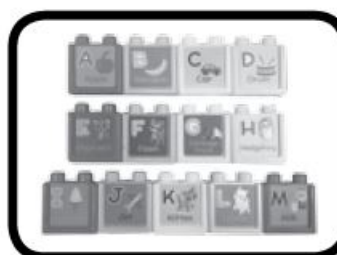

13 Double-Sided
Learning Blocks



2 Label Sheets

Quick Start Guide

WARNING

All packing materials such as tape, plastic sheets, packaging locks, removable tags, cable ties and packaging screws are not part of this toy, and should be discarded for your child's safety.

NOTE

Please save this Instruction Manual as it contains important information.

NOTE

Please cut and discard the cord before playing with the unit. The cord is not part of the product and should be discarded for your child's safety.

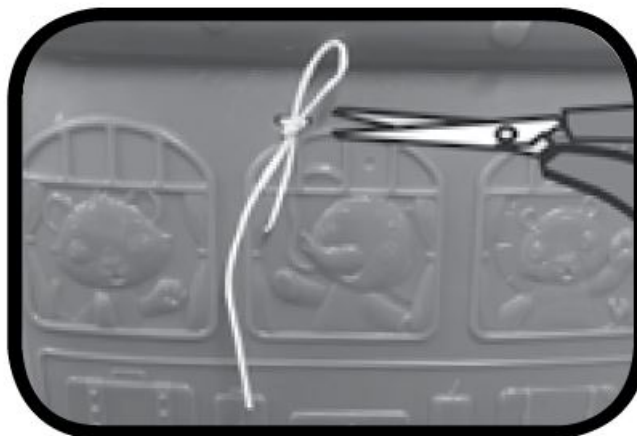
**GETTING STARTED****Battery Removal and Installation**

1. Make sure the unit is turned Off.
2. Find the battery cover on the back of the electronic activity panel. Use a screwdriver to loosen the screw and then open the battery cover.
3. Remove old batteries by pulling up on one end of each battery.
4. Install 3 new AA batteries following the diagram inside the battery box. (For best performance, alkaline batteries or fully charged Ni-MH rechargeable batteries are recommended.)
5. Replace the battery cover and tighten the screw to secure.

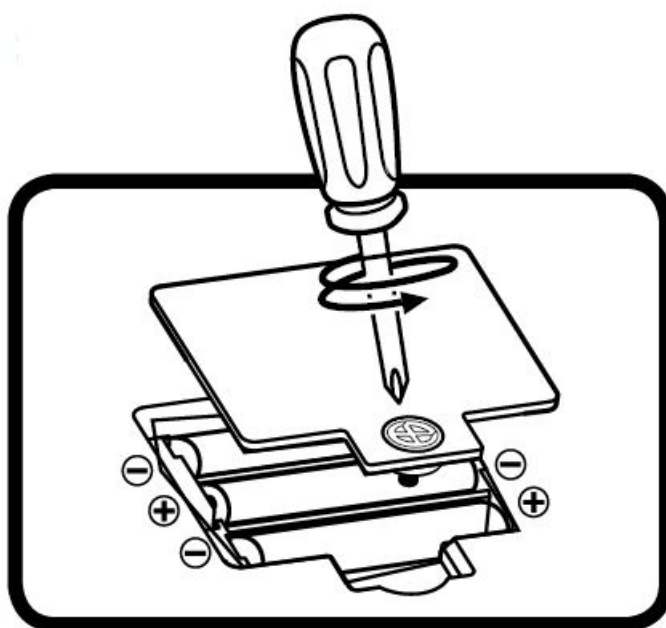
**IMPORTANT: BATTERY INFORMATION**

- Insert batteries with the correct polarity (+ and -).
- Do not mix old and new batteries.

- Do not mix alkaline, standard (carbon-zinc) or rechargeable batteries.
- Only batteries of the same or equivalent type as recommended are to be used.
- Do not short-circuit the supply terminals.
- Remove batteries during long periods of non-use.
- Remove exhausted batteries from the toy.
- Dispose of batteries safely. Do not dispose of batteries in fire.

RECHARGEABLE BATTERIES

- Remove rechargeable batteries from the toy before charging.
- Rechargeable batteries are only to be charged under adult supervision.
- Do not charge non-rechargeable batteries.

LABEL APPLICATION

Please securely stick the labels to the train engine as indicated below:

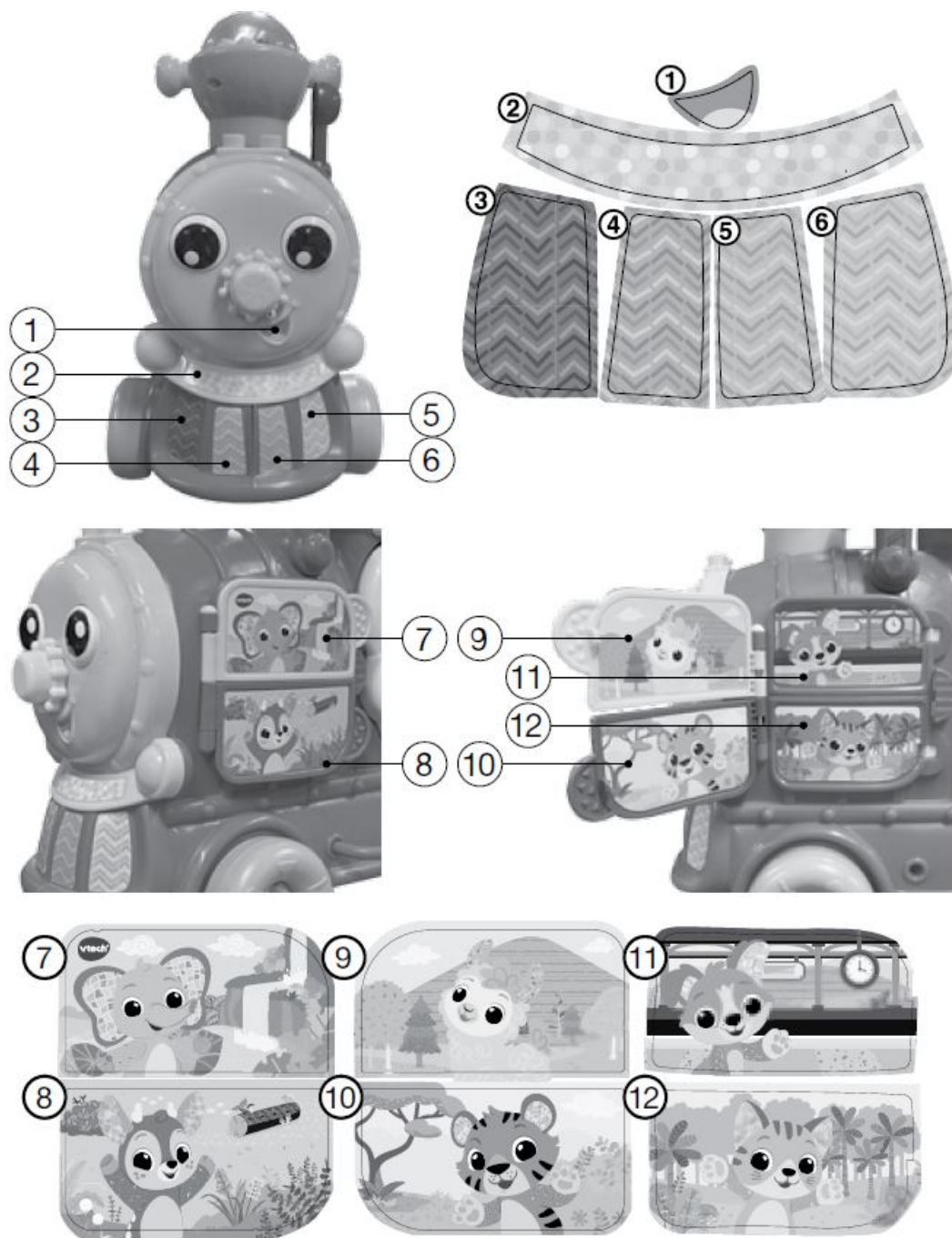

ASSEMBLY INSTRUCTIONS

With the 4-in-1 Learning Letters Train™, safety comes first. To ensure your child's safety, adult assembly is required.

1. Insert the Joystick into the Electronic Activity Panel. Push down on the Joystick until you hear it click into place. Once you have installed the Joystick, it cannot be removed.
2. Insert the Bead Rail into the side of the Train Engine. Press down on the Bead Rail until you hear it click into place. Once you have installed the Bead Rail, it cannot be removed.
3. Position the Handle with the curved part of the handle facing the back of the Train Engine. Insert the Handle into the slot on the top of the Train Engine. Push down the Handle until you hear it click into place. Once you have installed the Handle, it cannot be removed.
4. Insert the Axles into the Engine Wheels and then insert the Axles into the sockets on the body of the Train Engine. Push down on the Engine Wheels until you hear the wheels click into place. Once you have installed

the Engine Wheels, they cannot be removed.

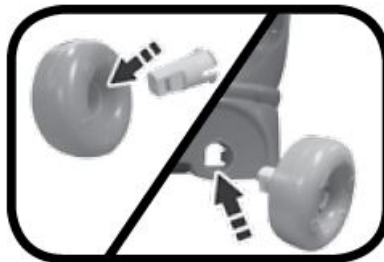

5. Position the Hinge so that the large hole is facing up. Insert the Hinge into the hole on the front of the Pull Cart until you hear it click into place. Once you have attached the Hinge to the Pull Cart, it cannot be removed.
6. Insert the Pull Cart Wheels with Axles into the bottom of the Pull Cart until you hear them click into place. Once you have installed the Pull Cart Wheels, they cannot be removed.
7. Attach the Pull Cart Back Support Pieces to the sides of the Pull Cart Seat. Insert the Pull Cart Back Support Pieces and the Pull Cart Front Support into the base of the Pull Cart until you hear them click into place. Once you have assembled the Pull Cart, it cannot be taken apart.
8. To attach the Pull Cart to the Train Engine, insert the Hinge into the slot on the back of the Train Engine. You will hear the Hinge click into position to indicate the Pull Cart is attached correctly.

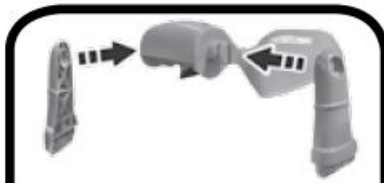
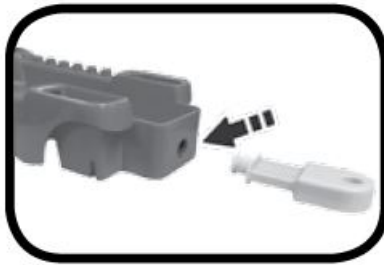

9. To detach the Pull Cart from the Train Engine, press and hold the circle button under the bottom of the Train Engine, then pull the Hinge out of the slot.
10. To attach the Electronic Activity Panel to the top of the Train Engine, insert the Electronic Activity Panel onto the post on the top of the Train Engine. To remove the Electronic Activity Panel, slide the two Electronic Activity Panel Release Tabs on the back of the Electronic Activity Panel inward to release the Electronic Activity Panel.
11. To attach the Electronic Activity Panel on the side of the Train Engine, insert the Electronic Activity Panel into the slot while sliding the tab up. To remove the Electronic Activity Panel, slide the tab up and pull gently on the Electronic Activity Panel.

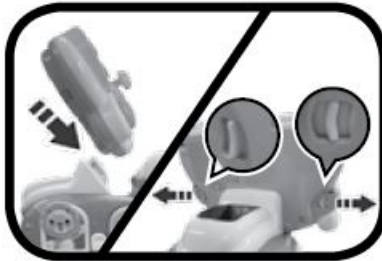
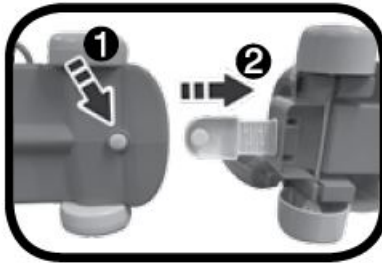

WARNING:

The maximum weight for this product is 42 pounds. Insufficient strength. It is not recommended for children older than 36 months.

PRODUCT FEATURES

1. On/Off/Mode Selector

To turn the unit On, slide the On/Off/ Mode Selector to Travel mode or Learning mode . You will hear a song, a phrase and fun sounds. To turn the unit Off, slide the On/Off/Mode Selector to the Off position.

2. Volume Switch

Slide the Volume Switch to the Low volume or the High volume position.

3. Automatic Shut-Off

To preserve battery life, the 4-in-1 Learning Letters Train™ will automatically shut off after approximately 45 seconds without input. The unit can be turned on again by pressing any button, inserting a Letter Block, turning the Pointer or moving the Joystick.



NOTE

If the unit powers down or if the light fades out during play, please install a new set of batteries.

ACTIVITIES

1. Electronic Panel

Attach the Electronic Activity Panel to the side or top of the train engine to hear a fun sound and a phrase. The lights will flash with sounds.

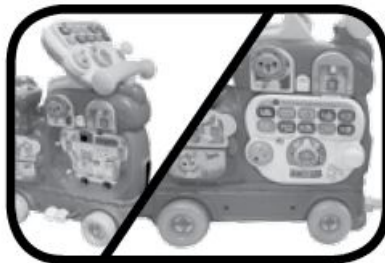

2. Number Buttons

Press the Number Buttons to learn about numbers, colors, and locations and hear playful melodies in Learning mode. Pretend to travel to different locations and learn about a variety of different places and objects in Travel mode. The lights will flash with sounds.

3. Pointer

Turn the Pointer on the dial to hear a variety of playful train phrases in both modes. The lights will flash with sounds.

4. Horn Button

Press the Horn Button to hear a fun train whistle in Learning mode, and hear fun sounds, phrases and playful melodies in Travel mode. The lights will flash with the sounds.

5. Joystick

Push or pull the Joystick to learn about opposites. The lights will flash with the sounds.

6. Letter Blocks

When the Electronic Activity Panel is attached to the side of the train, insert the Letter Blocks into the Recognition Port to learn about letters, objects and animals in Learning mode, and learn about objects and hear fun sounds and short tunes in Travel mode. The lights will flash with the sounds.



7. **Travel Book**

When the Electronic Activity Panel is attached to the side of the train engine, open and close the Travel Book pages to hear fun phrases, songs and melodies in Learning mode, and hear fun phrases in Travel mode. The lights will flash with the sounds.

8. **Block Chute**

When the Electronic Activity Panel is attached to the side of the train engine, drop the blocks down the Block Chute to hear the blocks counted in Learning mode, and hear fun sounds in Travel mode. The lights will flash with the **sounds**.

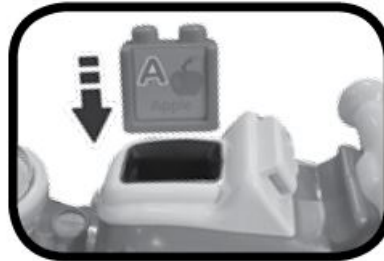
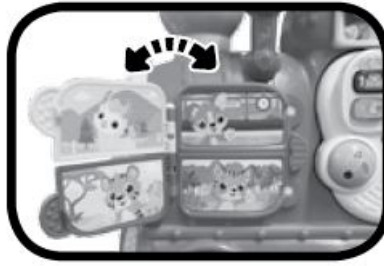

NOTE

The infrared light sensor in the block chute is sensitive to sunlight. The sensor may not perform properly in brightly lit, sunny rooms or under direct sunlight.

WARNING:

Do not put hands, arms and feet inside either of the Block Chute openings. Adult supervision is recommended.

9. Motion Sensor

Push the train engine to activate the Motion Sensor to play fun sounds, phrases and songs when the Electronic Activity Panel is attached to the side of the train engine. You will hear fun sounds when the panel is detached or attached on the top of the train engine. The lights will flash with the sounds.

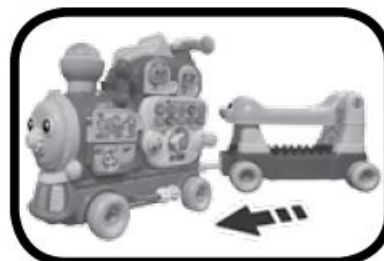

MELODIES

1. Alphabet Song
2. A-Tisket, A-Tasket
3. Bingo
4. The Entertainer
5. Girls and Boys Come Out to Play
6. Old MacDonald
7. On Top of Old Smokey
8. Toyland
9. Bear Went Over the Mountain
10. Diddle, Diddle Dumpling
11. While Strolling Through the Park

12. The Green Grass Grew All Around

SONG LYRICS

Song 1

Did you ever see a lion, a lion, a lion, Did you ever see a lion riding on a train?

Song 2

Here we go chugging down the tracks, Down the tracks, Down the tracks.

Song 3

Chugga-chugga, chugga-chugga, Off we go!

CARE & MAINTENANCE

1. Keep the unit clean by wiping it with a slightly damp cloth.
2. Keep the unit out of direct sunlight and away from any direct heat sources.
3. Remove the batteries if the unit will not be in use for an extended period of time.
4. Do not drop the unit on a hard surface and do not expose the unit to excess moisture.

TROUBLESHOOTING

If for some reason the unit stops working or malfunctions, please follow these steps:

1. Please turn the unit Off.
2. Interrupt the power supply by removing the batteries.
3. Let the unit stand for a few minutes, then replace the batteries.
4. Turn the unit On. The unit should now be ready to play again.
5. If the unit still does not work, install a new set of batteries.

IMPORTANT NOTE:

If the problem persists, please call our Consumer Services Department at 1-800-521-2010 in the U.S. or 1-877-352-8697 in Canada, or by going to our website at vtechkids.com and filling out our Contact Us form located under the Customer Support link. A service representative will be happy to help you. Creating and developing VTech® products is accompanied by a responsibility that we take very seriously. We make every effort to ensure the accuracy of the information, which forms the value of our products. However, errors sometimes can occur. It is important for you to know that we stand behind our products and encourage you to contact us with any problems and/or suggestions you might have. A service representative will be happy to help you.

FCC STATEMENT

NOTE

This equipment has been tested and found to comply with the limits for a Class B digital device, pursuant to Part 15 of the FCC Rules. These limits are designed to provide reasonable protection against harmful interference in a residential installation. This equipment generates, uses and can radiate radio frequency energy and, if not installed and used in accordance with the instructions, may cause harmful interference to radio communications. However, there is no guarantee that interference will not occur in a particular installation. If this equipment does cause harmful interference to radio or television reception, which can be determined by turning the equipment off and on, the user is encouraged to try to correct the interference by one or more of the following measures:

- Reorient or relocate the receiving antenna.
- Increase the separation between the equipment and receiver.
- Connect the equipment into an outlet on a circuit different from that to which the receiver is connected.
- Consult the dealer or an experienced radio/TV technician for help.

CAUTION

Changes or modifications not expressly approved by the party responsible for compliance could void the user's authority to operate the equipment.

Visit our website for more information about our products, downloads, resources and more.

vtechkids.com

vtechkids.ca

Documents / Resources

	<p>vtech 4-in-1 Learning Letters Train [pdf] Instruction Manual 4-in-1 Learning Letters Train</p>
---	---

References

- [V Tech Canada | Official Electronic Learning Toys & Games for Kids](#)
- [V Tech Canada | Official Electronic Learning Toys & Games for Kids](#)
- [V Best Kids Tech Toys | Electronic Learning Toys | VTech America](#)
- [V Best Kids Tech Toys | Electronic Learning Toys | VTech America](#)