



## vtech 211092 3-in-1 Magic Move Ball Instruction Manual

[Home](#) » [vtech](#) » vtech 211092 3-in-1 Magic Move Ball Instruction Manual 

### Contents

- 1 vtech 211092 3-in-1 Magic Move Ball
- 2 INTRODUCTION
- 3 INCLUDED IN THIS PACKAGE
- 4 GETTING STARTED
  - 4.1 BATTERY REMOVAL AND INSTALLATION
- 5 PRODUCT FEATURES
  - 5.1 Stickers
- 6 ACTIVITIES
  - 6.1 Instructions : Transformation
- 7 MELODY LIST
- 8 SONG LYRICS
- 9 CARE & MAINTENANCE
- 10 TROUBLESHOOTING
- 11 CONSUMER SERVICES
- 12 PRODUCT WARRANTY/ CONSUMER GUARANTEES
- 13 Documents / Resources
  - 13.1 References
- 14 Related Posts



**vtech 211092 3-in-1 Magic Move Ball**



## INTRODUCTION



Spin, dance and tap with the 3-in-1 Magic Move Ball! This free moving ball has three easily convertible forms; ball, roller and drum mode. Stimulate baby's sensory awareness as they watch the ball spin with flashing lights, fun phrases and melodies.

## INCLUDED IN THIS PACKAGE

- 3-in-1 Magic Move Ball
- Quick Start Guide

### **WARNING:**

All packing materials such as tape, plastic sheets, packaging locks, removable tags, cable ties, cords and packaging screws are not part of this toy, and should be discarded for your child's safety.

**NOTE:** Please save this Instruction Manual as it contains important information.

**NOTE:** Please cut and discard the plastic strap that attaches the 3-in-1 Magic Move Ball to the box. The strap is not part of this toy and should be discarded for your child's safety.

## GETTING STARTED

### **BATTERY REMOVAL AND INSTALLATION**

1. Make sure the unit is turned off.
2. Pull out the top cap of the ball and find the battery cover located on the surface of the unit. Use a screwdriver to loosen the screw and open the battery cover.

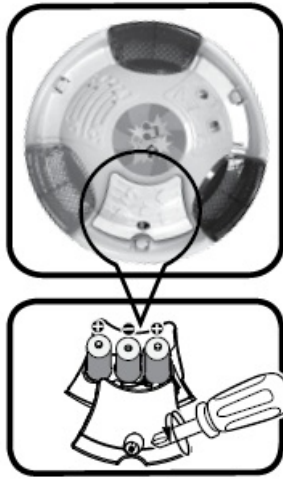

3. Remove old batteries by pulling up on one end of each battery.
4. Install 3 new AA batteries following the diagram inside the battery box. (The use of new, alkaline batteries is recommended for maximum performance).
5. Replace the battery cover and tighten the screw to secure.

**WARNING:** Adult assembly required for battery installation. Keep batteries out of reach of children.

**IMPORTANT: BATTERY INFORMATION**

- Insert batteries with the correct polarity (+ and -).
- Do not mix old and new batteries.
- Do not mix alkaline, standard (carbon-zinc) or rechargeable batteries.
- Only batteries of the same or equivalent type as recommended are to be used.
- Do not short-circuit the supply terminals.
- Remove batteries during long periods of non-use.
- Remove exhausted batteries from the toy.
- Dispose of batteries safely. Do not dispose of batteries in fire.

**RECHARGEABLE BATTERIES**

- Remove rechargeable batteries from the toy before charging.
- Rechargeable batteries are only to be charged under adult supervision.
- Do not charge non-rechargeable batteries.

**Disposal of batteries and product**

The crossed-out wheellie bin symbols on products and batteries, or on their respective packaging, indicates they must not be disposed of in domestic waste as they contain substances that can be damaging to the environment and human health.

The chemical symbols Hg, Cd or Pb, where marked, indicate that the battery contains more than the specified value of mercury (Hg), cadmium (Cd) or lead (Pb) set out in the Batteries and Accumulators Regulation.

The solid bar indicates that the product was placed on the market after 13th August, 2005.

Help protect the environment by disposing of your product or batteries responsibly.

**VTech® cares for the planet.**

Care for the environment and give your toy a second life by disposing of it at a small electricals collection point so all its materials can be recycled.

**In the UK:**

Visit [www.recyclenow.com](http://www.recyclenow.com) to see a list of collection points near you.

## In Australia & New Zealand:

Check with your local council for kerbside collections.

## RODUCT FEATURES

### 1. Off/Mode Switch

To turn the unit On, slide the Off/Mode song, welcoming phrase and sounds. To turn the unit Off, slide the Off/Mode Switch to the Off ( ) position.

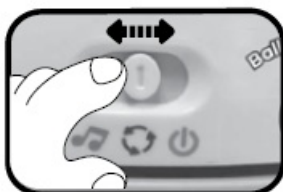

### 2. Three Interactive Light Up Buttons

Press the three interactive light up buttons to learn about animals, colours and numbers, and to trigger fun songs and melodies.



### 3. Automatic Shut-Off

To preserve battery life, the 3-in-1 Magic Move Ball will automatically shut off after approximately 40 seconds without input. The unit can be turned on again by pressing any button or by sliding the Off/Mode Switch.

**NOTE :** In the packaging, the product is in Try-Me mode. After removing the product from the box, remove the Try-Me tag, then close and reopen the toy. Now it can be used normally. If the toy is turned off repeatedly while

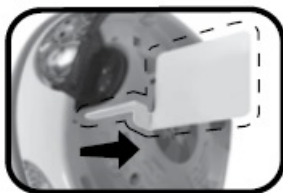

the child is playing, or the light intensity decreases, we recommend that you replace the battery.

## Stickers



Put the three stickers on the toy, as shown in the figure.

## ACTIVITIES

### 1. Dance Mode

Move the Off/Mode Switch to Dance Mode to hear interesting songs, phrases and sounds. Press the three light up buttons to explore animals, colours and numbers, and to trigger melodies. The 3- in-1 Magic Move Ball rotates and moves with the melody. The lights will also flash with the music.



### 2. Music Mode

Move the Off/Mode Switch to Music Mode to hear interesting phrases and sounds. Press the three light up interactive buttons to trigger songs, sounds and melodies. The lights will flash with the music.



### 3. Motion Sensor

Tap the surface of the 3-in-1 Magic Move Ball in Drum Mode to trigger fun drum sounds. The light will flash with the music.



### 4. Transformation

Place the top of the 3-in-1 Magic Move Ball under the base and turn it into a drum. Place the drum horizontally so that it becomes a roller.



## Instructions : Transformation

Warning: the conversion of the 3-in-1 Magic Move Ball must be completed by an adult.

### 1. Ball.

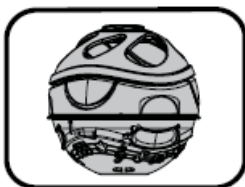

### 2. Remove the upper part of the ball.

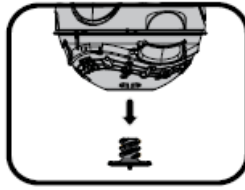

3. Remove the orange screw under the ball.

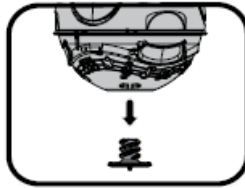

4. Place the upper part of the bale under the lower part, as shown above. Secure the entire unit with the orange screws.

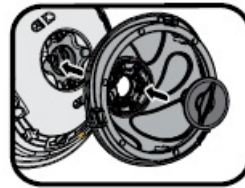

5. Roller/Drum.

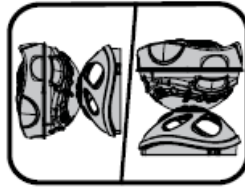

## MELODY LIST

1. Humpty Dumpty
2. Jack and Jill
3. Skip to My Lou
4. Teddy Bears' Picnic
5. Yankee Doodle
6. Rockin' Robin
7. Old MacDonald
8. Bingo
9. The Entertainer
10. Little Bo Peep
11. A Hunting We Will Go
12. Can Can

## SONG LYRICS

- Song 1  
 Roll, roll like a ball,  
 Come and roll with all your friends,  
 Tap, tap on your drum,  
 Let's play music all day long!

- Song 2  
Woof, woof, woof, puppy sings,  
Tap the drum and hear it ring!
- Song 3  
Elephant loves to stamp and prance,  
In the mud you'll find him dance!
- Song 4  
Monkey's swinging through the trees,  
To play with you and me!

## CARE & MAINTENANCE

1. Keep the unit clean by wiping it with a slightly damp cloth.
2. Keep the unit out of direct sunlight and away from any direct heat source.
3. Remove the batteries if the unit will not be in use for an extended period of time.
4. Do not drop the unit on hard surfaces and do not expose the unit to excess moisture.

## TROUBLESHOOTING

If for some reason the program/activity stops working or malfunctions, please follow these steps:

1. Please turn the unit Off.
2. Interrupt the power supply by removing the batteries.
3. Let the unit stand for a few minutes, then replace the batteries.
4. Turn the unit On. The unit should now be ready to play with again.
5. If the product still does not work, install a brand new set of batteries.

If the problem persists, please contact our Consumer Services Department and a service representative will be happy to help.

## CONSUMER SERVICES

Creating and developing VTech® products is accompanied by a responsibility that we at VTech® take very seriously. We make every effort to ensure the accuracy of the information, which forms the value of our products. However, errors sometimes can occur. It is important for you to know that we stand behind our products and encourage you to call our Consumer Services Department with any problems and/or suggestions that you might have. A service representative will be happy to help you.

### **UK Customers:**

Phone: 0330 678 0149 (from UK) or +44 330 678 0149 (outside UK) Website: [www.vtech.co.uk/support](http://www.vtech.co.uk/support)

### **Australian Customers:**

Phone: 1800 862 155

Website: [support.vtech.com.au](http://support.vtech.com.au)

### **NZ Customers:**

Phone: 0800 400 785

Website: If the problem persists, please contact our Consumer Services Department and a service representative will be happy to help.

## PRODUCT WARRANTY/ CONSUMER GUARANTEES

### UK Customers:

Read our complete warranty policy online at [vtech.co.uk/warranty](http://vtech.co.uk/warranty).

### Australian Customers:

VTECH ELECTRONICS (AUSTRALIA) PTY LIMITED – CONSUMER GUARANTEES

Under the Australian Consumer Law, a number of consumer guarantees apply to goods and services supplied by VTech Electronics (Australia) Pty Limited. Please refer to /consumer guarantees for further information.

Visit our website for more information about our products, downloads, resources and more.

[www.vtech.co.uk](http://www.vtech.co.uk)

[www.vtech.com.au](http://www.vtech.com.au)

## Documents / Resources

	<p><a href="#">vtech 211092 3-in-1 Magic Move Ball</a> [pdf] Instruction Manual</p> <p>211092, 3-in-1 Magic Move Ball, 211092 3-in-1 Magic Move Ball, Magic Move Ball, Move Ball, Ball</p>
---	--

## References

- [Support : VTech Electronics](#)
- [Electronic Learning Toys | Best Learning Toys | VTech UK](#)
- [VTech Toys Australia - Electronic Learning Toys - Best Learning Toys - VTech Australia and New Zealand](#)
- [Electronic Learning Toys | Best Learning Toys | VTech UK](#)
- [Electronic Learning Toys | Best Learning Toys | VTech UK](#)
- [VTech Toys Australia - Electronic Learning Toys - Best Learning Toys - VTech Australia and New Zealand](#)