



vsitoo S3PLUS Smart Mug User Guide

[Home](#) » [vsitoo](#) » vsitoo S3PLUS Smart Mug User Guide 

Contents

- 1 vsitoo S3PLUS Smart Mug
- 2 Know Your Mug
- 3 Usage method
- 4 APP Connection
- 5 Warranty Policy
- 6 Documents / Resources
 - 6.1 References

vsitoo

vsitoo S3PLUS Smart Mug



Know Your Mug

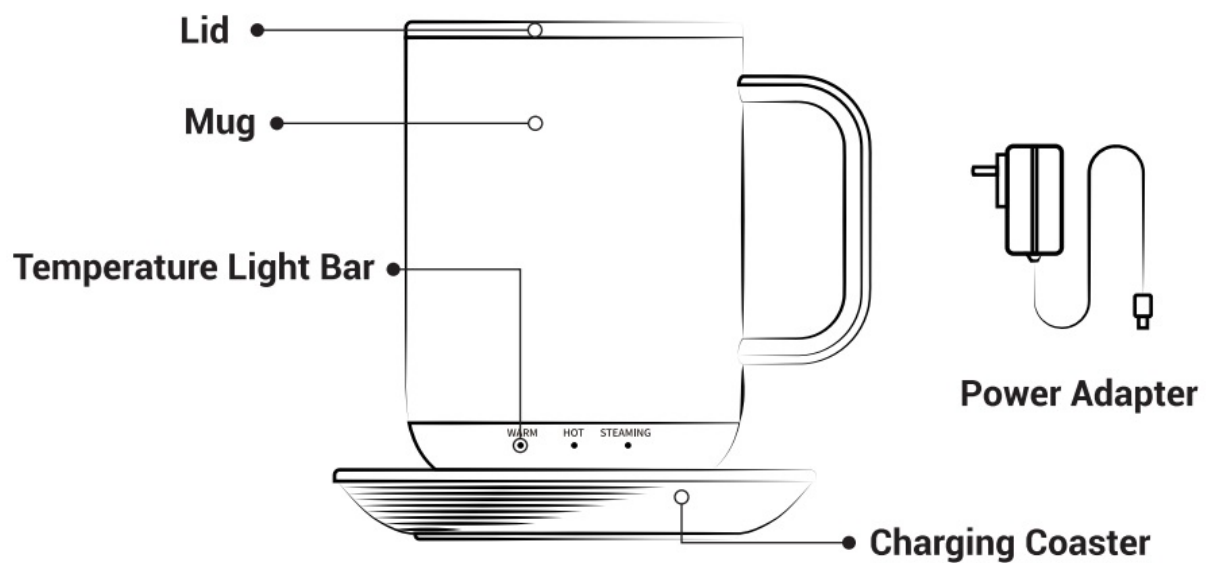

Parameter

- Name: VSITOO Smart Mug
- Model: S3PLUS
- Colour: Black/White/China Red/Rose/Copper/Golden
- Size: 144*130*144mm
- Capacity: 14oz/420ml
- Material: 304 Stainless Steel
- Waterproof Level: IPX7
- Built-in Battery:2750mAh

Packing list

- Smart Mug X1
- BPA Free Lid X1
- Charging Coaster X1
- Power Adapter X1
- User Guide X1

Usage method

Power Supply

The power indicator light will be on after connecting the base to the power supply through the power adapter. The mug is placed on the base, and the three lights will be lit one by one, indicating that the mug has been connected to the power supply.

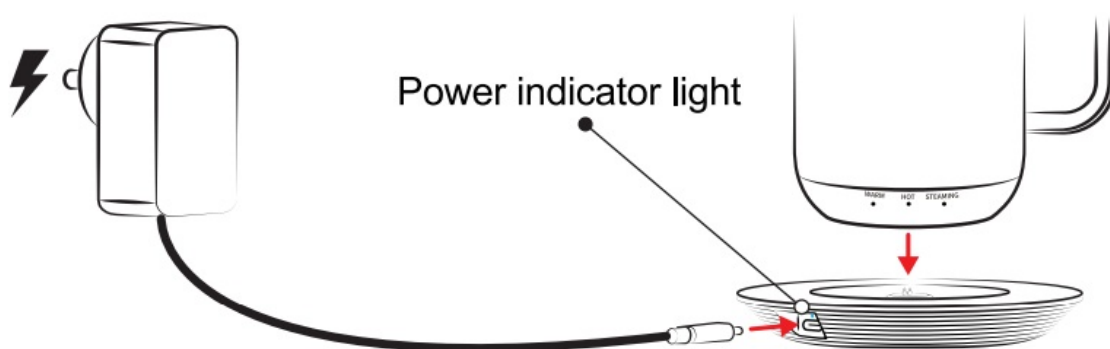

turn on/turn off

Press and hold the button at the bottom of the cup for 3 seconds to turn the cup on /off.



Temperature setting

Click the button to select the desired temperature, and the corresponding indicator light will light up. The flashing light(breathing light) indicates the mug is working, the solid light indicates the target temperature is reached, and all lights off indicate the mug is in a shutdown state.

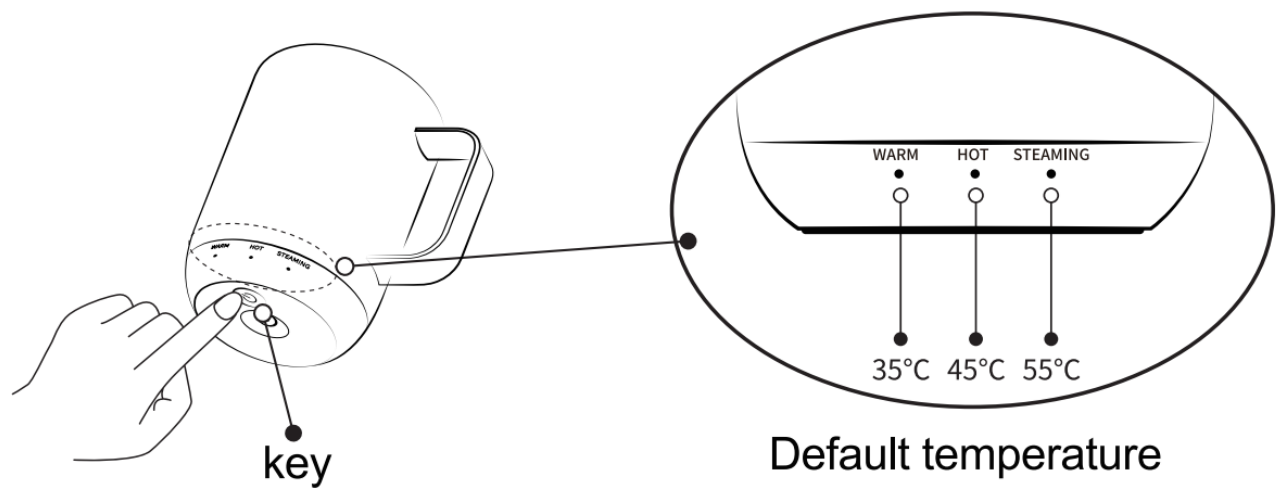

Reminder for preventing dry burning

When the mug is without water during the use process, it will stop heating after the indicator light appears and the flashing warning for considering the safety problem. And it will start working again after adding water to it and clicking the button.

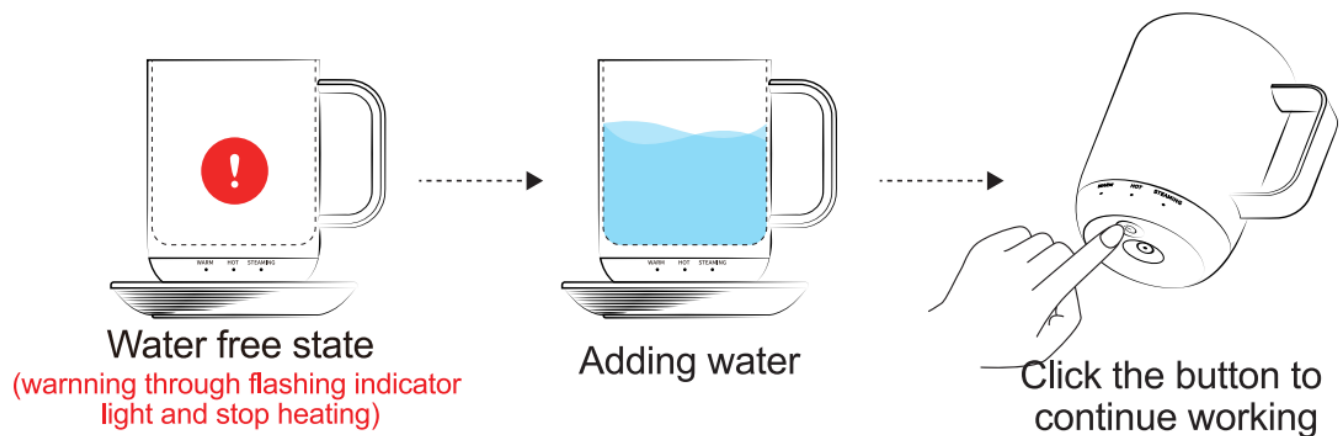

Charging reminder

When the three lights turn dark and flash, please put them back to the base in time to charge. When charging, three lights will Synchronous breathing, the mug enters the charging state, and when the full charge, all the lights are on for 3 seconds and then off.

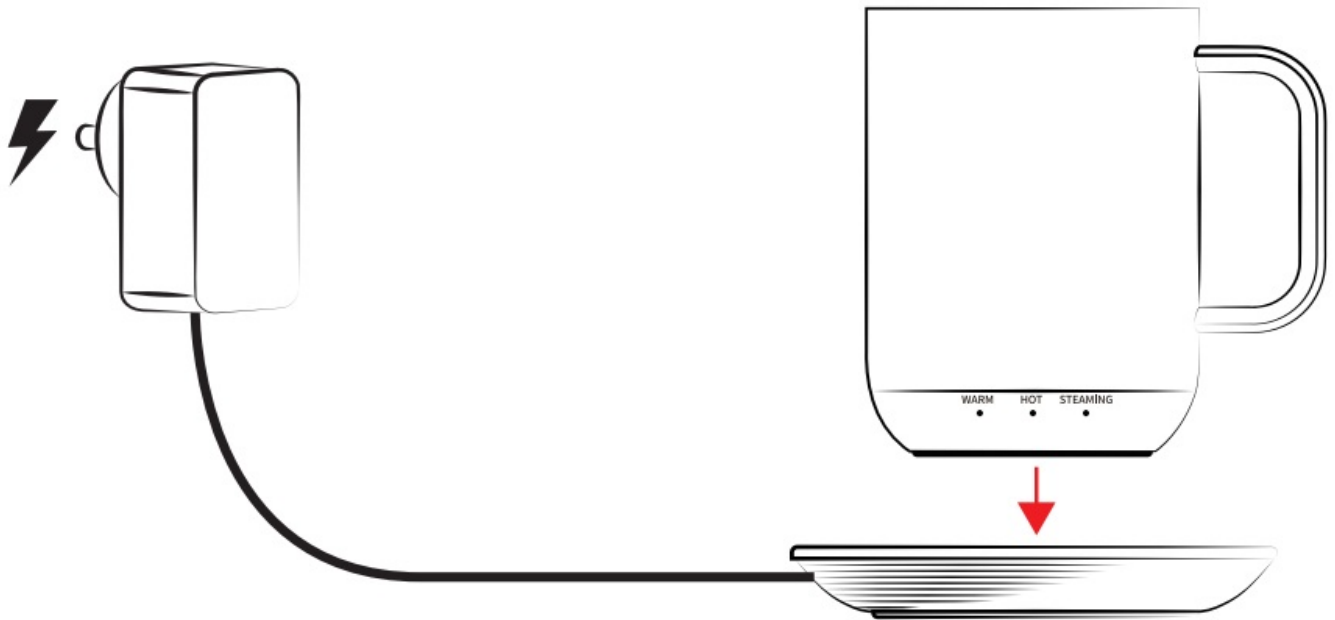

Auto Sleep

For safety reasons, when you have not used the mug for more than 2 hours, the mug will enter Auto Sleep, if you think the auto sleep time is too short, you can also change it to 4 hours on the APP.

APP Connection



1. Search "visitor" in the APP store /Google store, download and install the "visitor" app
2. Sign up and Login;

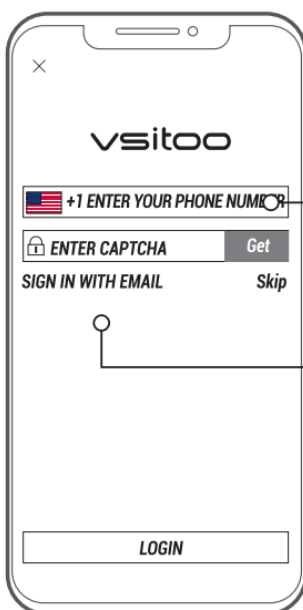

Please choose right Country Code before entering your phone number

You can also use your Email to sign up



Add the device

3. Add your mug and build the connection following the instructions. (Ensure Bluetooth is turned on in the phone)

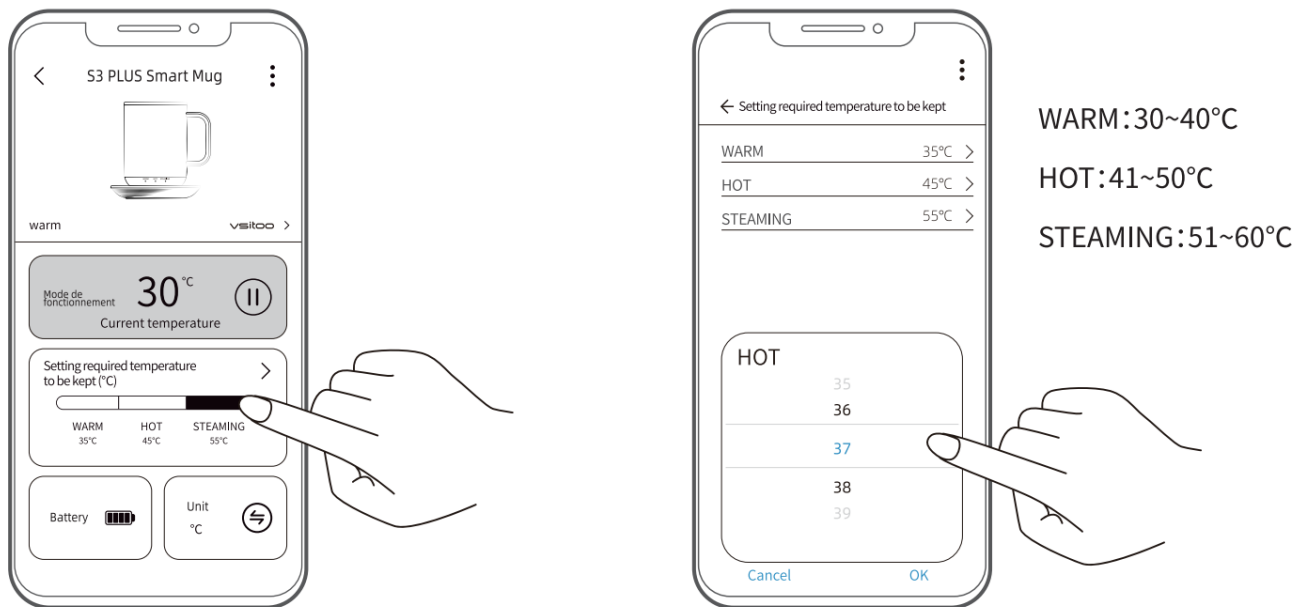

4. .Switching temperature through the APP.

Update

Please upgrade in time when the APP has an update reminder.

Attention

- Do not put it in the microwave, dishwasher, refrigerator or freezer;
- Do not bump or drop the mug, otherwise the sensor may be damaged, which will affect the measurement accuracy of the mug
- The waterproof grade of the mug is IPX7, it can be cleaned normally, but please do not soak it in the liquid for an extended period
- Please dry the mug before putting it on the charging base;
- When using a metal spoon, use it carefully to avoid scratching the Mug's liner;
- Please use a metal spoon carefully to avoid scratching the coating on the inner wall;
- Please keep out of the reach of children when the mug is filled with hot drinks;
- Do not fill the mug too full with hot drinks to avoid burns caused by spillage;
- Do not use steel balls, bleach or other corrosive acid-base solvents to clean the mug;
- Be careful to avoid steam burns when holding the mug or opening the lid.

PAY ATTENTION!!

The following conditions are not covered by the warranty:

- Failure and damage caused by disassembly, modification and repair without authorization;
- Failure or damage caused by incorrect use;
- Failure or damage caused by human factors;
- Warranty period exceeded;
- Product purchased from unauthorized dealers.

Warranty Policy

The product is guaranteed for one year from the date of purchase. You can contact market customer service to exchange for a new replacement or get a refund within the valid return date. If your purchase date exceeds the valid return period, please contact us by any of the following methods:

1. You can submit your request through the Feedback option on the JIMI Pro APP (You'd better attach your order number and your contact information so that we can solve the problem for you further)
2. You can send an email to our customer service mailbox: service@vsitoo.com.
3. Similarly, you need to describe the problem you encountered in detail and attach your order number and product photos so that we can solve the problem for you better.
4. You can visit our official website and leave your suggestions and feedback, and our customer service staff will reply to you as soon as possible.

Please ensure the integrity of the product and packaging when you send it back.

Official Website: <http://www.vsitoo.com/>

Customer Service Number: 86-0760-87954495

Customer Service Email: service@vsitoo.com

Manufacturer: Guangdong Jimi Youpin Intelligent Technology Co., LTD

Address: Tongmao Industrial Avenue, xiaolan Town, Zhongshan City, Guangdong Province

Documents / Resources

	vsitoo S3PLUS Smart Mug [pdf] User Guide S3PLUS Smart Mug, S3PLUS, Smart Mug, Mug
-------------------------------------------------------------------------------------	------------------------------------------------------------------------------------------------------

References

- [User Manual](#)

[Manuals+](#), [Privacy Policy](#)

This website is an independent publication and is neither affiliated with nor endorsed by any of the trademark owners. The "Bluetooth®" word mark and logos are registered trademarks owned by Bluetooth SIG, Inc. The "Wi-Fi®" word mark and logos are registered trademarks owned by the Wi-Fi Alliance. Any use of these marks on this website does not imply any affiliation with or endorsement.