



vsitoo S3 Temperature Control Smart Mug 2 with Lid User Guide

[Home](#) » [vsitoo](#) » vsitoo S3 Temperature Control Smart Mug 2 with Lid User Guide 



S3 User Guide

Customer Service Email: service@vsitoo.com

Contents

- [1 induction](#)
- [2 Usage method](#)
- [3 APP Connection](#)
- [4 Warranty Policy](#)
- [5 Documents / Resources](#)
 - [5.1 References](#)

induction

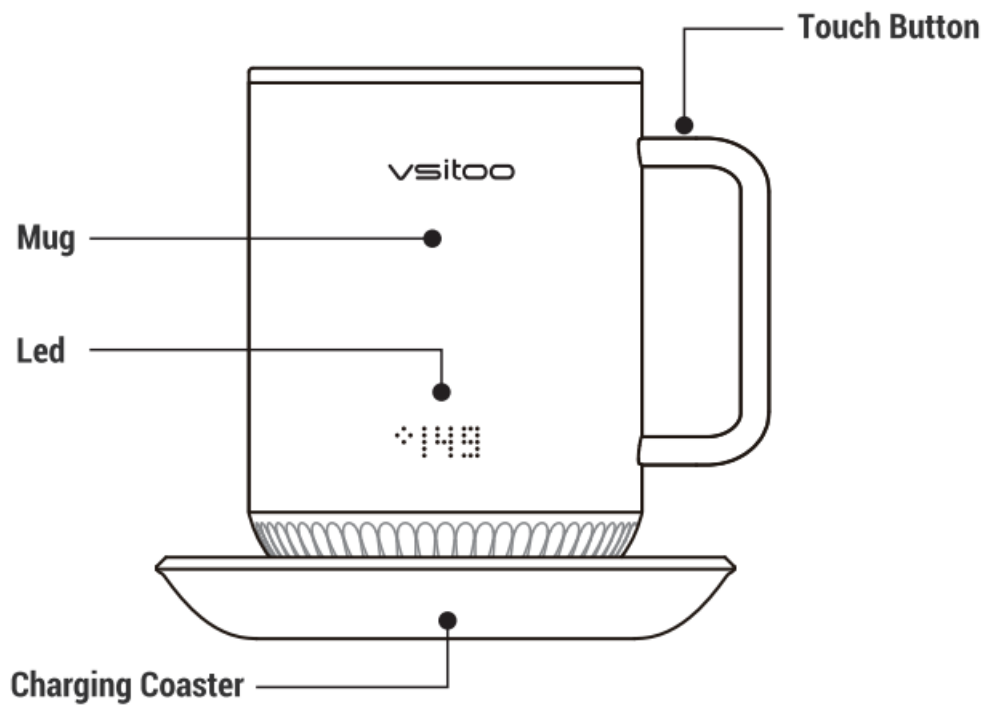

Parameter

Name : VSITOO Smart Mug

Model: S3

Product weight : 430g

Capacity : 300ml

Color : Black/White

Waterproof Level : IPX7

Liner Material : 304 Stainless Steel

Built-in Battery : 2500mAh

Size : 112X86.5X17mm

Packing list

Smart Mug	XI
BPAFree Lid	XI
Charging Coaster	XI
Power Adapter	XI
User Guide	XI

Usage method

- Power on/Power off



Take a long press on the power button for 3 seconds to turn on, the icon “” will appear on the LED screen.

Take a long press on the power button for 3 seconds to turn off, the icon “” will appear on the LED screen.

APP Connection

Ready to connect:

1. Please make sure that the battery was charged for at least half an hour before first use;
2. Please make sure that the mug is turned on and has enough power;
3. Please make sure that your phone's Bluetooth is turned on.

Connection Steps:

1. Search “vsitoo” in APP store /Google store, download and install app;



2. Sign up and Log in;

Please choose right Country Code before entering your phone number

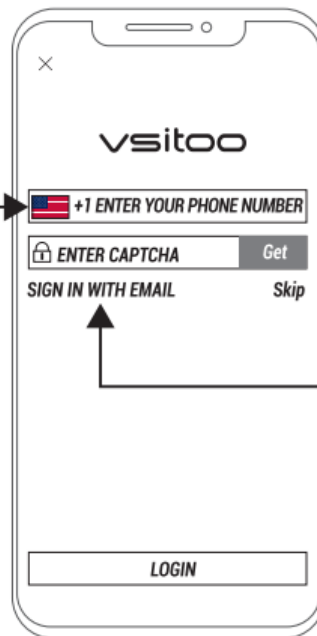

You can also use your Email to sign up

3. Add your mug and built the connection follow the instruction.

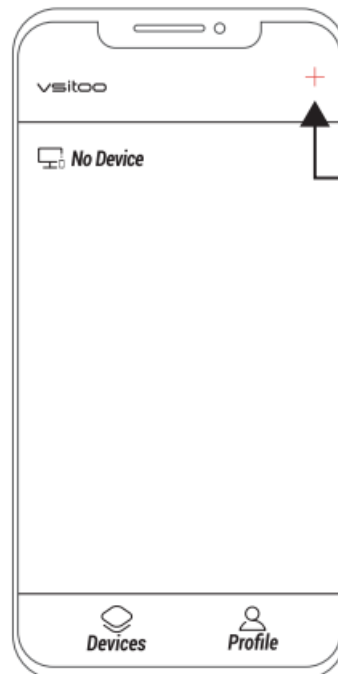

Add the device

4. Click the power button at the bottom of the mug to enter Pair Mode, the icon  will appear on the LED screen(click the power button can also cancel the pairing mode).



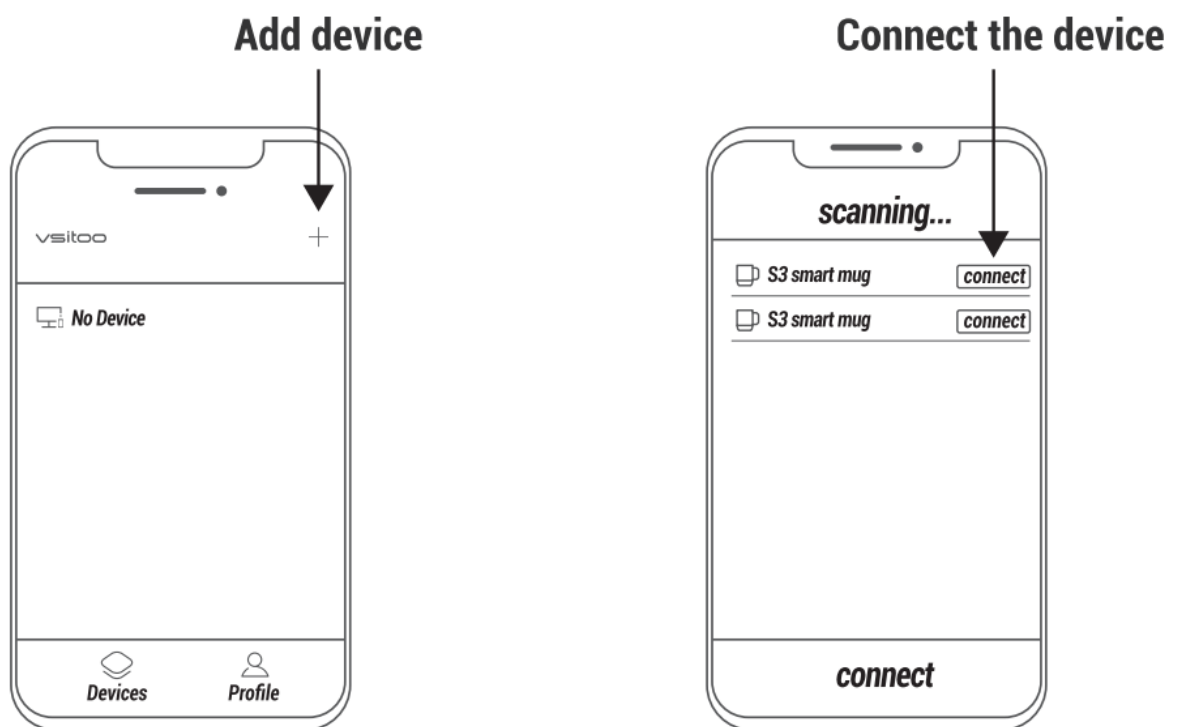

5. Open the APP to add and connect the mug.



6. After the connection is successful the icon  the displayed on the LED screen.

Temperature setting

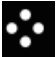

Press and hold the touch button for 3 seconds, the icon “” will appear on the LED screen, click the touch button again, the screen will display the icon “” indicating that the unlocking is successful. After unlocking, click the touch button to set target temperatures. One click adds a degree, and you can keep clicking until reach target temperature. Ex: click to 131 degrees Fahrenheit, wait 3 seconds, and the mug will go into heating mode.

When the mug is in heating mode, the icon “” on the upper left corner of the screen will rotate continuously. When the beverage is at the target temperature, it will stop rotating.

Status description

Battery life:

When the icon “” flashes, please put the mug on the charging base to charge. When the power is below 20%, the mug will automatically stop heating.

Empty Cup:

The system automatically starts the overheating protection mode when the mug is empty to ensure safety. This icon “” means the mug is in overheating protection mode.

Safety Setting

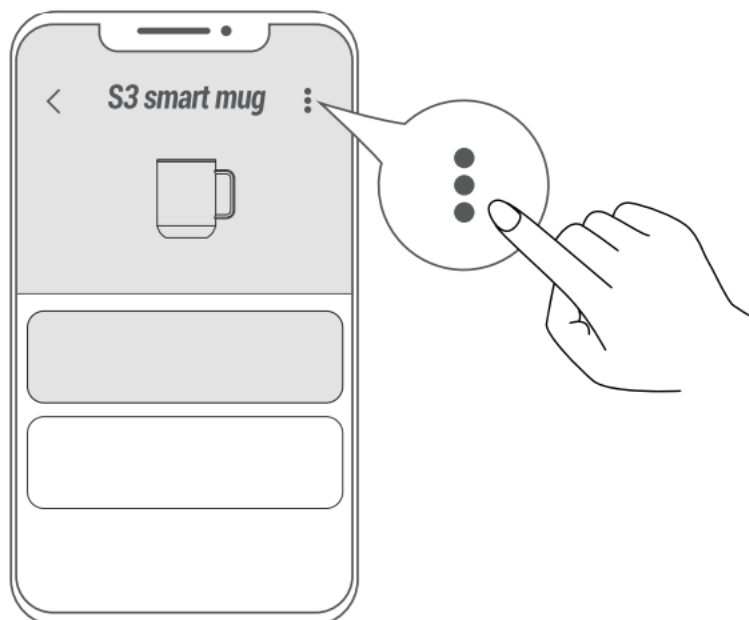

Step 1
Click the icon“ ⋮ ” in the
upper right corner

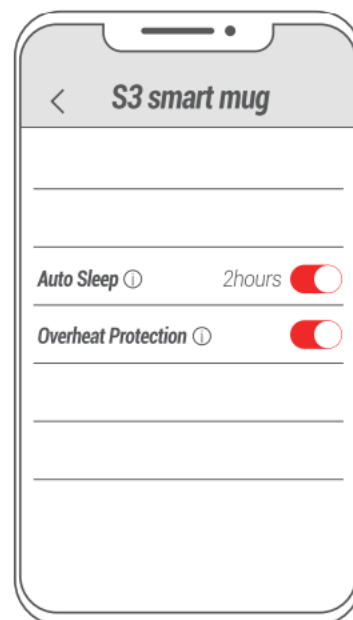

Step 2
Choose Auto Sleep or Overheat
Protection

Auto Sleep

You can choose to let the mug go to sleep after 2 hours/4 hours/6 hours, and the mug will stop heating or keep warm when the time is up.

Overheat Protection

If this setting is on, the mug will stop heating when it is empty.

(To avoid sediment in the cup or the liquid is too thick, it will be mistakenly judged that the empty cup and will enter the anti-dry burning mode.)

Attention

- Do not put it in the microwave, dishwasher, refrigerator or freezer;
- Do not bump or drop the mug, otherwise the sensor may be damaged, which will affect the measurement accuracy of the mug;
- The waterproof grade of the mug is IPX7, it can be cleaned normally, but please do not soak it in the liquid for an extended period of time;
- Please dry the mug before putting it on the charging base;
- When using a metal spoon, use it carefully to avoid scratching the Mug's liner;
- Please use a metal spoon carefully to avoid scratching the coating on the inner wall;
- Please keep out of the reach of children when the mug is filled with hot drink;
- Do not fill the mug too full with hot drink to avoid burns caused by spillage;
- Do not use steel balls, bleach or other corrosive acid-base solvents to clean the mug;
- Be careful to avoid steam burns when holding the mug or opening the lid.

PAV ATTENTION!!

The following conditions are not covered by the warranty:

- Failure and damage caused by disassembly, modification and repair without authorization;

- Failure or damage caused by incorrect use;
- Failure or damage caused by human factors;
- Warranty period exceeded;
- Product purchased from unauthorized dealers.

Warranty Policy

- The product is guaranteed for one year from the date of purchase.
- You can contact market customer service to exchange for a new replacement or get a refund within the valid return date firstly.
- If your purchase date exceeds the valid return period, please contact us by any of the following methods:
 1. You can submit your request through the Feedback option on the JIMI Pro APP (You'd better attach order number and your contact information so that we can solve the problem for you further);
 2. You can send an email to our customer service mailbox: service@vsitoo.com. Similarly, you need to describe the problem you encountered in detail and attach your order number and product photos so that we can solve the problem for you better;
 3. You can visit our official website and leave your suggestion and feedback, our customer service staff will reply you as soon as possible.
- Please ensure the integrity of the product and packaging when you send it back.

Official Website : <http://www.vsitoo.com/>

Customer Service Number: 86-0760-87954495

Customer Service Email: service@vsitoo.com

Manufacturer: Guangdong Jimi Youpin Intelligent Technology Co.,LTD

Address: Tongmao Industrial Avenue, xiaolan Town ,Zhongshan City,
Guangdong Province

Documents / Resources

 <p>vsitoo® VSITOO S3 智能Mug杯 使用说明书 User Guide Customer Service Email: service@vsitoo.com</p>	<p>vsitoo S3 Temperature Control Smart Mug 2 with Lid [pdf] User Guide S3, S3 Temperature Control Smart Mug 2 with Lid, Temperature Control Smart Mug 2 with Lid, Control Smart Mug 2 with Lid, Smart Mug 2 with Lid, Mug 2 with Lid, Lid</p>
--	---

References

- [User Manual](#)