



VPG CR338 Wireless Charging Sensor Installation Guide

[Home](#) » [VPG](#) » VPG CR338 Wireless Charging Sensor Installation Guide 

Contents

- 1 VPG CR338 Wireless Charging Sensor
- 2 TOOLS & PARTS NEEDED
- 3 ALL MOUNTING
- 4 ADHESIVE MOUNTING
- 5 NON-ADHESIVE MOUNTING
- 6 IR Keyfob
- 7 Product Removal
- 8 Sensor Removal
- 9 System Shut Down
- 10 Audible & LED Functionality
 - 10.1 Audible Signals
 - 10.2 Other Functionalities
- 11 Documents / Resources
- 12 Related Posts



VPG CR338 Wireless Charging Sensor



TOOLS & PARTS NEEDED



VP-1751#



KF-1106



VP-1742#



AD-239-5



K-1140



AP-001-200

or



V-T99



K-1106



V-39

* = Optional | # = Substitute W for White

ALL MOUNTING

IMPORTANT: Ensure the tamper switch on the base of the pedestal is fully depressed when attaching.

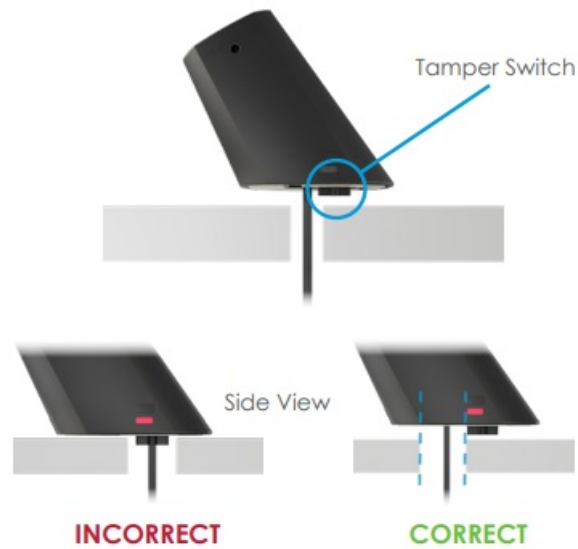

ADHESIVE MOUNTING

Clean the fixture surface and wipe dry. Thread the power cable through the fixture slot.



Remove the adhesive liner from the base of the pedestal and adhere to the fixture. Skip to step 6.

IMPORTANT: Hold firmly for 30 seconds to ensure a strong bond.

NON-ADHESIVE MOUNTING

Option 1 – Slot Hole Fixtures

*For slot hole fixtures not suitable for adhesive mounting, use the K-1106 Mounting Ring Kit.

K-1106 Kit Includes

- Mounting Ring
- Threaded Rods
- Thumb Nuts



Screw the threaded rods through the mounting ring and into the pedestal. Mount to the fixture with the two thumb nuts. Skip to step 6.

Option 2 – Single Hole Fixtures

*For single hole fixtures not suitable for adhesive mounting, use the K-1140 Single Hole Adapter.



IMPORTANT: Fully remove both the adhesive liner and the adhesive tape from the bottom of the pedestal.

A. Thread the pedestal power cord through the single hole adapter plate and screw to the bottom of the pedestal.

K-1140 Kit Includes:

- Adapter Plate
- Ring Nut
- Screws



B. Place the connected pedestal and adapter through the hole in the fixture and tighten nut.

Attach the sensor to the pedestal by twisting the boot into the sensor.



Attach the sensor to the pedestal by twisting the boot into the sensor.

Make sure the text “TOP” and “BOTTOM” on the sensor is oriented with the top and bottom of the phone.



Before adhering, find the best placement for the sensor to charge the device.

Clean the back of the device with an alcohol pad and wipe dry. Adhere sensor to the center of the device.



Arm the system with your IR Keyfob. Point the key near the black receiver above the LED.

IR Keyfob

The IR Keyfob allows for touchless control of the CR338. The security code in the IR Keyfob has programmed to the CR338 the first time the system is armed.

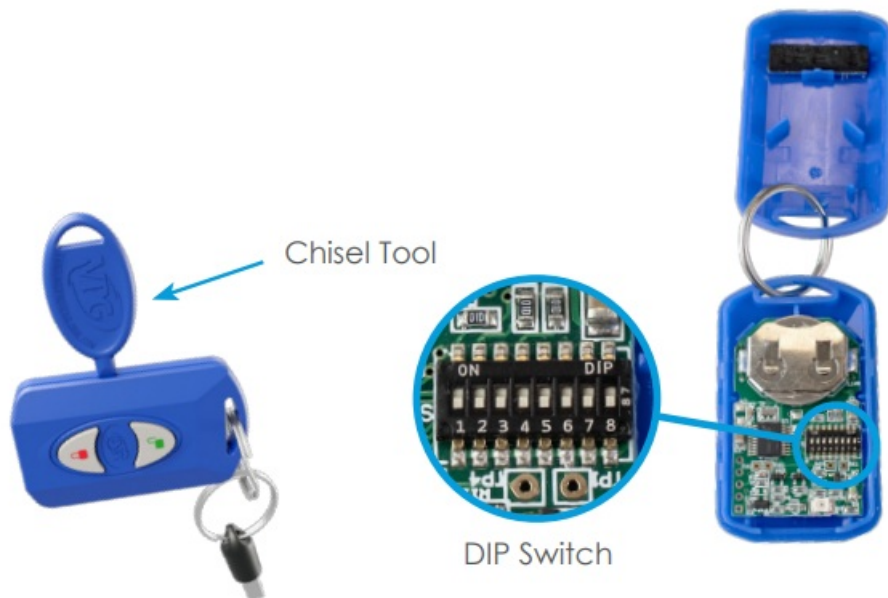

How to change the security code:

1. Disarm the CR338 and open the keyfob using the chisel tool found on the key ring.
2. Change the code on the DIP switch.
3. Press and hold the red lock button to rearm the system. The sensor and pedestal are now set to the new code.

Click or scan QR code for Keyfob video



Product Removal



Overnight Storage or Customer Interaction

1. Disarm the CR338 with the IR Keyfob aimed at the pedestal's IR window above the LED; press and hold the

green unlock button until a descending tone is heard.

2. Place the Magnet Tool into the larger notch on the side of the boot while rotating the boot off the sensor.
3. After 3 minutes the CR338 will automatically rearm itself with a low toned beep indicating the pedestal is secure and the sensor is not.
4. Store the device with the sensor attached overnight or staff can provide customer interaction.
5. Sensor will automatically re-arm when reconnected to the pedestal.

Click or scan QR code for Training video



Sensor Removal

Product Re-Merchandise

1. Disarm the CR338 and remove the sensor from the pedestal with the magnet tool.
2. Place the sensor removal tool over the sensor and twist to break the adhesive bond.



Click or scan QR code for Sensor Removal video



System Shut Down

Power-off CR338

1. Unplug the CR338 from external power.

2. Using the keyfob, hold the green disarm button for several seconds.

When the system is shut down, you will hear a descending tone, and all the LEDs will be off.



Click or scan QR code for Troubleshooting video



Audible & LED Functionality



IMPORTANT: The tamper switches on the sensor and the pedestal, detect if the security has been breached. If either of the tamper switches are not fully depressed, the CR338 will alarm.

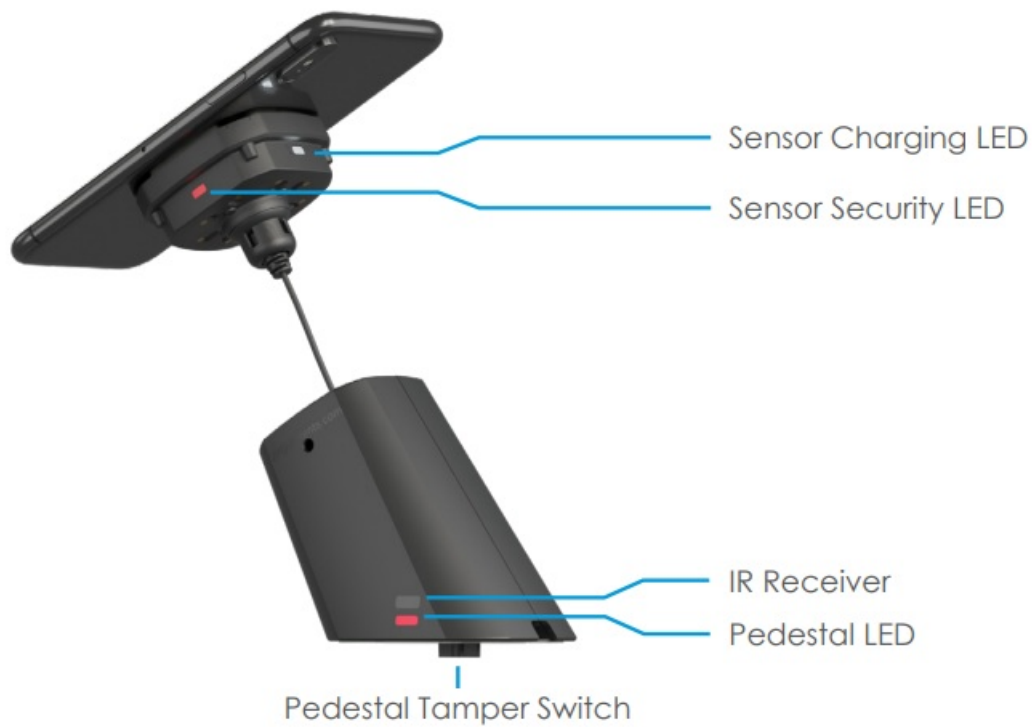

LED Behavior	CR338 Status & Meaning
Steady solid red on sensor security LED, pedestal LED off	Unit armed, secured, and receiving power
Red and blue flash on pedestal and flashing red on sensor security LEDs	Alarming event – unit has been breached
Constant red flash on the sensor security LEDs	Unit is disarmed and the product is properly depressing the sensor tamper switch
Constant red flash on the pedestal	Unit is disarmed and the tamper switch on the base of the pedestal is NOT depressed
Red strobe (brief flash) every 10 seconds on pedestal and sensor security LEDs	Unit armed, but not receiving power and running off internal back-up battery
Alternating red/yellow flash on pedestal	Factory reset mode – how the unit will arrive. It's ready to accept programming from any VPG IR Keyfob
Both pedestal and sensor security LEDs are off	Unit is shut down OR the unit is disarmed & powered, and the sensor tamper switch is NOT depressed, but the pedestal is secured
Charging LED is solid white, flashing white or off.	LEDs with the Lightning bolt symbol show charge status – solid white when device is charging, off when not charging, or flashing when device is partially charging (some phones may charge properly while sensor flashes; see battery percentage on phone).

Audible Signals

Ascending tone followed by 2 confirmation beeps Device is properly secured and armed. Ascending tone followed by a low toned beep Pedestal is secure, but one or more of the following apply:

- Sensor is not attached
- Sensor tamper switch is not depressed

Once the sensor is reconnected, the tamper switch is properly depressed, and/or the power coupler is secured, the CR338 will rearm itself.

Other Functionalities

Back-Up Battery

If the CR338 has lost power, the unit will switch to its internal backup battery (3-5 day battery life); and the IR Keyfob will only work when the alarm is triggered or power is restored.

Factory Reset

Factory reset mode can be engaged by first triggering the alarm, then, using the SIM tool, press the reset button in the small hole on the bottom of the pedestal (3 beeps should be heard), afterwards, any VPG keyfob can be used to disarm the unit.

FCC REGULATIONS

THIS DEVICE COMPLIES WITH PART 15 OF THE FCC RULES. OPERATION IS SUBJECT TO THE FOLLOWING TWO CONDITIONS: (1) THIS DEVICE MAY NOT CAUSE HARMFUL INTERFERENCE, AND (2) THIS DEVICE MUST ACCEPT ANY INTERFERENCE RECEIVED, INCLUDING INTERFERENCE THAT MAY CAUSE UNDESIRE OPERATION.

NOTE: THE GRANTEE IS NOT RESPONSIBLE FOR ANY CHANGES OR MODIFICATIONS NOT EXPRESSLY APPROVED BY THE PARTY RESPONSIBLE FOR COMPLIANCE. SUCH MODIFICATIONS COULD VOID THE USER'S AUTHORITY TO OPERATE THE EQUIPMENT.

Customer Care | 1-877-477-4874

International | +1-813-855-9639

vanguardprotexglobal.com

©2022 Vanguard Protex Global

Documents / Resources

	<p>VPG CR338 Wireless Charging Sensor [pdf] Installation Guide VP1742, 2AKCG-VP1742, 2AKCGVP1742, CR338 Wireless Charging Sensor, CR338, CR338 Charging Sensor, Wireless Charging Sensor, Charging Sensor, Wireless Charging</p>
-------------------------------------------------------------------------------------	------------------------------------------------------------------------------------------------------------------------------------------------------------------------------------------------------------------------------------------------------