



VOYEE Wireless Controller for NS User Guide

[Home](#) » [VOYEE](#) » VOYEE Wireless Controller for NS User Guide 

VOYEE®

Wireless Controller For NS
Quick Start Guide



Contents

- [1 Wireless Controller for NS](#)
- [2 Connection Method](#)
- [3 Turbo Function](#)
- [4 Vibration Function](#)
- [5 Programming Setting](#)
- [6 Lighting effect control](#)
- [7 About charging](#)
- [8 Gyro Manual Calibration](#)
- [9 Service Support](#)
- [10 Documents / Resources](#)
- [11 Related Posts](#)

Wireless Controller for NS

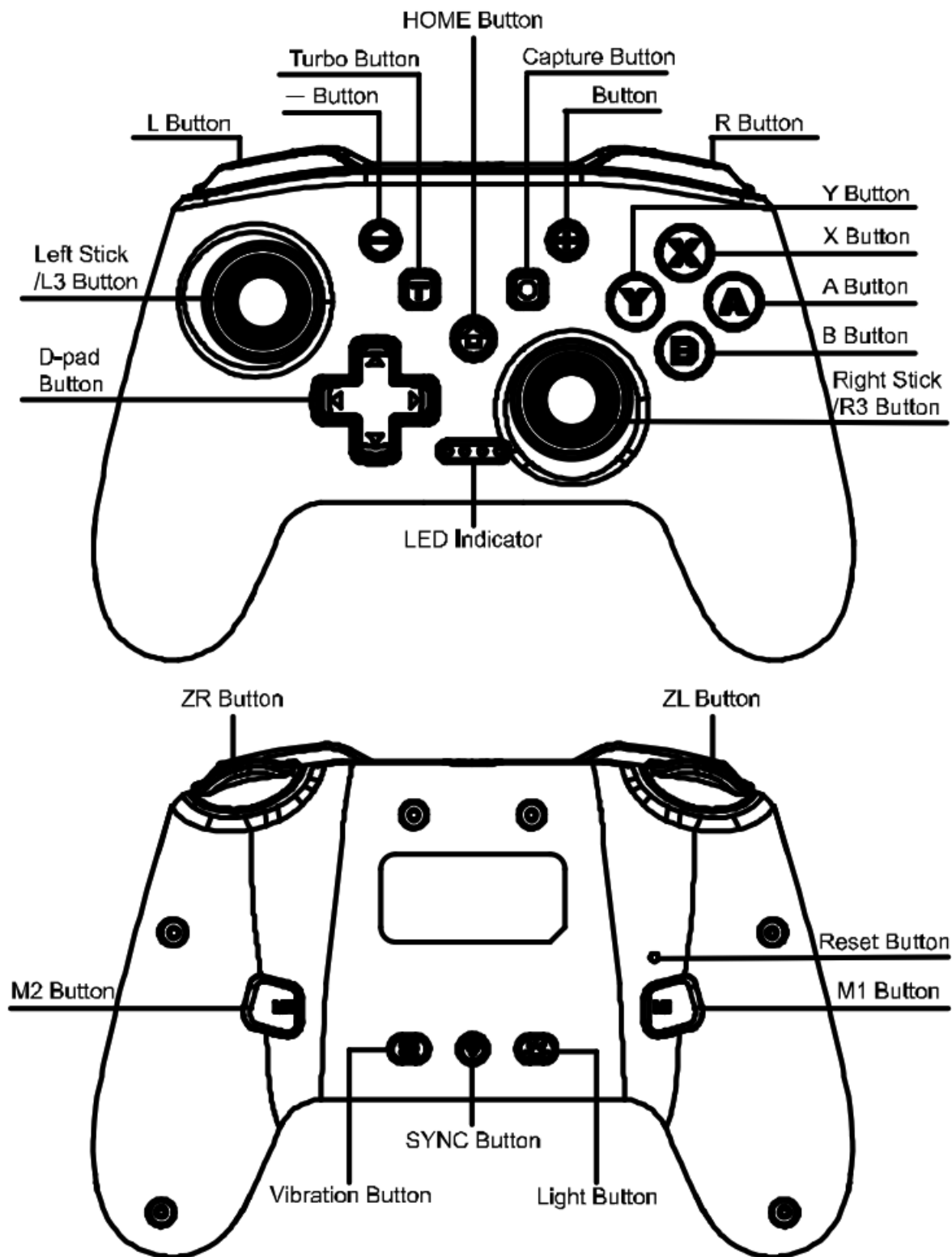

Connection Method

I. Connect to NS:

Notice: Please turn off airplane mode. Do not touch the stick while connected.

1. Enter the connection interface (refer to Figure 1-3).
2. Press the "SYNC" button on the back of the controller for about 2 seconds until the signal light flashes back and forth and then release your finger and wait for the connection to be successful.

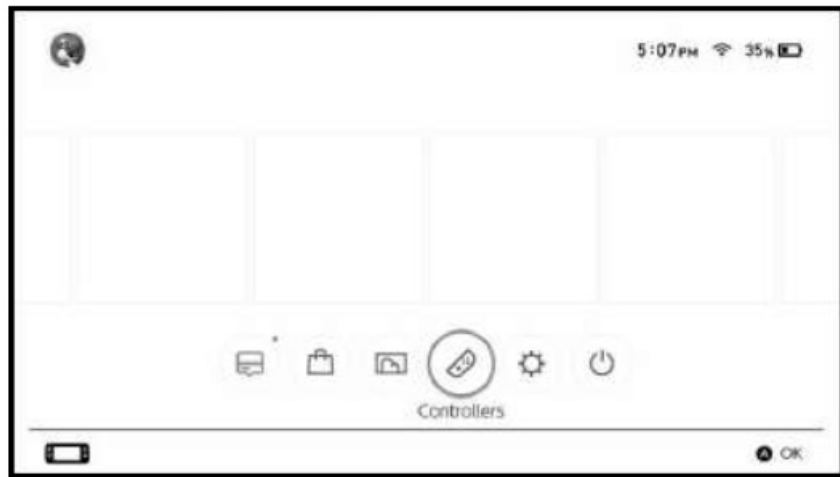

Image 1

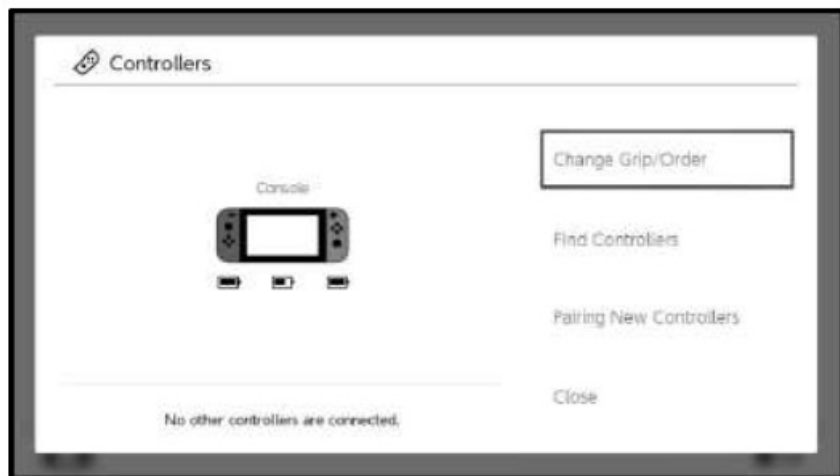

Image 2



Image 3

※ Press the [HOME] button can wake up and re-connect the console after the first connection with the controller.
Unable to connect, please follow under three steps to solve:

1. Turn off airplane mode.
2. Delete the information of this controller in the NS console: Path: system setting-controllers and sensors-disconnect controllers.
3. Follow the first time connection method and re-pair again.

II. Connect to Android Devices:

1. Turn on the Bluetooth function of Android device and search device;
2. Press the “A” and “HOME” button on the controller at the same time, until LED1 and LED2 flash and then release your finger.
3. Find the Bluetooth name “Gamepad” on the Android device, click on the pairing, LED1 and LED2 are always on after success.

※ This controller supports HID mode games on the Android device.

Note: On the Android device, the vibration function, screenshot, and motion control functions are not available on the wireless controller.

III. Connect to IOS Devices:

1. Turn on the Bluetooth function of IOS device and search device;
2. Press the “B” and “HOME” button on the controller at the same time until LED2 and LED3 flash and then release your finger.
3. Find the Bluetooth name “Xbox Wireless Controller” on the IOS device, click on the pairing, LED2 and LED3 are always on after success.

※ The controller supports MFI games on the IOS device.

Note: This wireless controller only supports the IOS13.0 version or above system. The vibration function, screenshot, and motion control functions are not available.

IV. Connect to Windows PC:

Simply connect the controller to your Windows PC using the included USB cable and LED1 and LED4 will light up. (If you purchased the receiver version, you can also use the receiver to connect wirelessly, how to connect: D Plug the receiver into the USB port of the computer host. (2 press the “X” and “HOME” button on the controller at the same time, until LED2 and LED3 flashing and then release your finger, wait for the successful connection, after the successful LED2 and LED3 long light. If you encounter a long time connection can not be connected, please unplug the receiver and repeat ①② steps.)

※ This controller supports X-INPUT mode games on Windows system, and game platforms such as Steam.

Note: This controller only supports Windows 7 and above system.

The screenshot and motion control functions of the controller are not available.

Special prompt:

1. Above I,II,III connection mode, you can press the HOME button to connect back with the most recently connected device.
2. On Android, IOS, Windows PC device, long press [Capture] and [L3] button about 1 second, the controller will vibrate one time which means the function of left joystick and cross key is switched cyclically, long press [Capture] and [R3] button about 1 second, the controller will vibrate one time which means the function of A and B, X and Y is switched cyclically.

Turbo Function

The function button: A/B/X/Y/L/ZL/R/ZR

Set manual Turbo function: press and hold the Turbo button first and then press one of the function buttons such as “A”, the button “A” starts the manual turbo function.

Set auto Turbo function: press and hold the Turbo button then press the function button such as “A” which has set the manual turbo function before, the button “A” starts the auto turbo function.

Turn off the Turbo function: press and hold the Turbo button then press the function key such as “A” which has set the auto Turbo function before, the Turbo function of the button “A” has been turned off.

Close the Turbo function of all keys one time: Disable All Turbo In One Time: Press the “-” and the “D-pad DOWN” button, the controller will vibrate one time, which means disable successfully.

There are three levels of Turbo speed:

Slow: 5 bursts per second corresponding to a slow flashing of the signal light.

Medium: 12 bursts per second corresponding to a medium flashing of the signal light.

Fast: 20 bursts per second corresponding to a fast flashing of the signal light.

Increase the Turbo speed:

Press the Turbo button and “↑” at the same time to increase the turbo speed.

Reduce the Turbo speed:

Press the Turbo button and “↓” at the same time to reduce the turbo speed.

Vibration Function

There are four levels of vibration strength: none, weak, medium, and strong.

Adjust the vibration strength:

1. Ensure that the controller is successfully connected to the console;
2. Each time you press the “Vibration” button on the back, you can adjust the vibration intensity cyclically.

Programming Setting

Reminder: Assign other button’s function to programmable rear buttons (M1/M2).

Available for programming Buttons: A/B/X/Y/L/ZL/R/ZR/L3/R3 and D-pad buttons.

Programming single button steps:

1. Firstly, keep the controller under working, press the “-” button and “M1/M2” button about 2 seconds simultaneously, the controller vibrates one time, joystick’s aperture will light up white and blink.
2. Then press a function button (A/B/X/Y/L/ZL/R/ZR/L3/R3/D-pad).
3. Lastly, press the M1/M2 button again to save, the controller vibrates one time, joystick’s aperture return to the normal connection status, programming setting of a single button is completed. (For example: press the “-” button and the M1 button at the same time for 2 seconds, until the joystick’s aperture light up white and blink, press the “A” button, last press the “M1” button to save, joystick’s aperture return to the normal connection status; “M1” button function is equal to “A” button function at this time, “M2” button can be set similarly).

Programming multiple buttons steps:

1. Firstly, keep the controller under working, press the “+” button and “M1/M2” button about 2 seconds simultaneously, the controller vibrates one time, joystick’s aperture will light up white and blink.
2. Then sequentially press multiple buttons you want to set (A/B/X/Y/L/ZL /R/ZR/L3/R3/D-pad), and the programmable button will record the time interval of each button.
3. Lastly, press the “M1/M2” button again to save, the controller vibrates one time, joystick’s aperture return to the normal connection status, programming setting of multiple buttons is completed, (For example: press the “+” button and the “M1” button at the same time for 2 seconds, until the joystick’s aperture light up white and blink, press the “B” button, then press the “A” button after 1 second, last press the “X” button after 3 seconds, when the setting is completed, press “M1” button to save and exit ;The function of “M1” button at this time is “B” button function, after 1 second is “A” button, after 3 seconds is “X” button), you can test whether the setting is

successful on the console “System Settings — Controllers and Sensors » TestInput Devices » Test Controller Buttons’.

Clear Programming:

1. Press the “+” button and “M1/M2” button about 2 seconds simultaneously until the joystick’s aperture light up white and blink, then press “M1/M2” button to clear the programming of single button.
2. Press “T” and “-” button simultaneously, the controller will vibrate one time which means all macro will be cleared,

Lighting effect control

Press [Light] button: You can control the fixed color of the light cyclically.

Press [Light] and [I] button: Can be adjusted to breathing mode or light mode,

Press [Light] and [L3] button: Close or open the joystick aperture light effect.

Press [Light] and [R3] button: Turn off or turn on the panel light effect. (Matte black version without panel light effect, not applicable to this function)

Press [Light] and move the left joystick up or down: The brightness of the can be adjusted.

About charging

1. LED light will flash slowly while charging if controller is connecting; after fully charged, the LED light will stay on.
2. LED light will flash slowly while charging if controller is off, and LED light will be off after fully charged.

Gyro Manual Calibration

If there are drifting or joystick problems occur in the game, you can try manual calibration to solve it.

Operation method: Place the Controller off on a horizontal surface, press the HOME and “=” button at the same time, wait for LED1, LED2 and LED3, LED4 to flash alternately three times and then press the “+” button, the signal light goes out and the calibration is completed.

Service Support

If you encounter difficulties or product defects in the process of using the product, please contact our after-sales service through the purchase platform. We will take analyzing once received your feedback, and assist you to solve the problem or provide replacement of the product. We also welcome your valuable suggestions to help us continuously optimize this product. We wish you a pleasant life.

FCC Caution:

This device complies with part 15 of the FCC Rules. Operation is subject to the following two conditions: (1) This device may not cause harmful interference, and (2) this device must accept any interference received, including interference that may cause undesired operation.

Any Changes or modifications not expressly approved by the party responsible for compliance could void the user’s authority to operate the equipment.

Note: This equipment has been tested and found to comply with the limits for a Class B digital device, pursuant to part 15 of the FCC Rules. These limits are designed to provide reasonable protection against harmful interference in a residential installation. This equipment generates uses and can radiate radio frequency energy and, if not installed and used in accordance with the instructions, may cause harmful interference to radio communications. However, there is no guarantee that interference will not occur in a particular installation. If this equipment does cause harmful interference to radio or television reception, which can be determined by turning the equipment off

and on, the user is encouraged to try to correct the interference by one or more of the following measures:

- Reorient or relocate the receiving antenna.
- Increase the separation between the equipment and receiver.
- Connect the equipment into an outlet on a circuit different from that to which the receiver is connected.
- Consult the dealer or an experienced radio/TV technician for help.

The device has been evaluated to meet general RF exposure requirement. The device can be used in portable exposure condition without restriction.

Documents / Resources

	VOYEE Wireless Controller for NS [pdf] User Guide S08, 2A4RB-S08, 2A4RBS08, Wireless Controller for NS, Wireless Controller, Controller for NS , Controller
---	---