



**V0 Vortice  
Thermoconvector**



# MICROSOL V0 Vortice Thermoconvector Instruction Manual

[Home](#) » [VORTICE](#) » MICROSOL V0 Vortice Thermoconvector Instruction Manual 

## Contents

- [1 Vortice MICROSOL V0 Thermoconvector](#)
- [2 OBLIGATION](#)
- [3 Product Description](#)
- [4 PROHIBITION](#)
- [5 Minimum application distances](#)
- [6 Installation](#)
- [7 Disposal](#)
- [8 Documents / Resources](#)
  - [8.1 References](#)



**Vortice MICROSOL V0 Thermoconvector**



Read the instructions contained in this booklet carefully before using the appliance. VORTICE cannot assume any responsibility for damage to property or personal injury resulting from failure to abide by the instructions given in this booklet. Following these instructions will ensure a long service life and overall electrical and mechanical reliability. Keep this instruction booklet in a safe place.

### **General information**

- GENERIC OBLIGATION.
- READING INSTRUCTIONS IS MANDATORY.
- TURNING OFF THE POWER IS MANDATORY.
- CONTACT PROFESSIONALLY QUALIFIED PERSONNEL ONLY.

### **Purpose of the manual**

This manual contains information on the use and maintenance of the appliance and provides useful information for the correct use of the appliance.

### **OBLIGATION**

- Before installing and using the appliance, read the warnings in this manual carefully. The instructions in the manual must be stored carefully.
- Appliance installers and users and all persons working in the area where the fan is in operation must be aware of the warnings and information in this manual and must have been properly trained by the purchaser.
- Handle the document with care and with clean hands.
- The parts must not be removed, torn, or arbitrarily changed.
- The manual should always be kept available for reference in an environment protected from humidity or heat sources.
- VORTICE S.p.A. cannot assume any responsibility for damage to property or personal injury resulting from failure to abide by the instructions given in this booklet.
- Following these instructions will ensure a long service life and overall electrical and mechanical reliability. Keep this instruction booklet in a safe place. Do not make modifications to this manual.

### **Product Description**

The appliance you have purchased is a fan heater for wall mounting. The appliance is ideal for use as a primary heat source for a room when it would be too costly and impractical to start up the central heating system. Silent operation means that it is also ideal for nighttime use. The appliance is fitted with enclosed heating elements. The unit is splash-proof. Plastic body parts are made from self-extinguishing resin (V0). The appliance also has a thermal trip switch to protect against overheating. The thermostat incorporates an anti-frost function.

## **Compliance**

- This appliance can be used by children aged 8 years and above and persons with reduced physical, sensory, or mental capabilities or lack of experience and knowledge if they have been given supervision or instruction concerning the use of the appliance in a safe way and understand the hazards involved. Children shall not play with the appliance.
- Cleaning and user maintenance shall not be done by children without supervision.
- These appliances are designed for use in residential and commercial properties.
- The appliance must be installed by a professionally qualified electrician only.
- Ensure that the electrical system to which the appliance is connected complies with applicable standards.
- An omnipolar switch with a contact opening distance of 3 mm or higher should be provided for installation, enabling complete disconnection under overvoltage category III conditions.
- Products equipped with single-phase wiring (M) engines ALWAYS require connection to 220-240V (or only 230V where required) singlephase lines.
- Any kind of modification shall be considered as product tampering and shall nullify the relative Warranty.
- When used in a bathroom, the towel rails must be installed so that switches and the other controls cannot be touched by a person in the bath or shower.
- Children of less than 3 years should be kept away unless continuously supervised.
- Children aged from 3 years and less than 8 years shall only switch on/off the appliance provided that it has been placed or installed in its intended normal operating position and they have been given supervision or instruction concerning the use of the appliance in a safe way and understand the hazards involved.
- Children aged from 3 years and less than 8 years shall not plug in.
- Children aged from 3 years and less than 8 years shall not regulate and clean the appliance or perform use maintenance.
- Unit is equipped with manual reset thermal breaker device: to avoid any danger of accidental reset of the thermal breaker device, units must not be powered by an external switch device such as a timer, or must not be connected to a circuit that is regularly powered or disconnected from power utilities.

## **OBLIGATION**

- After removing the appliance from its packaging, ensure that it is complete and undamaged. If in doubt contact an authorized VORTICE service center.
- Do not leave packaging within the reach of children or differently able persons.
- Store the appliance out of the reach of children and disabled persons if you decide to disconnect it from the power supply and use it no more.
- For full compliance with European Regulation No. 2015/1188 EU, this product must be subjected to an external control device that regulates heat emission in the room where it is installed.
- If the appliance malfunctions or develops a fault, contact VORTICE immediately.
- Ensure that only genuine original VORTICE spares are used for repairs.

- Regularly inspect the appliance for visible defects. If they are found, do not operate the appliance and contact VORTICE immediately.
- Check that the electrical power supply/socket provides the maximum electrical power required by the appliance.
- If this is not the case, arrange for a qualified electrician to make the necessary modifications.
- If the appliance is dropped or suffers a heavy blow, have it checked immediately by VORTICE.
- If the appliance is to be used in a bathroom, it must be installed where its switches and controls are inaccessible to persons in the bath or under the shower (Fig. 3).
- Make sure that the door protecting the controls is closed properly after making any adjustments.
- The appliance must be properly connected to an electrical system in compliance with applicable regulations and must be equipped with an efficient earthing system.
- If in doubt, have a qualified electrician perform a thorough check.
- Specifications for the power supply must correspond to the electrical data on plate A (Fig. A).

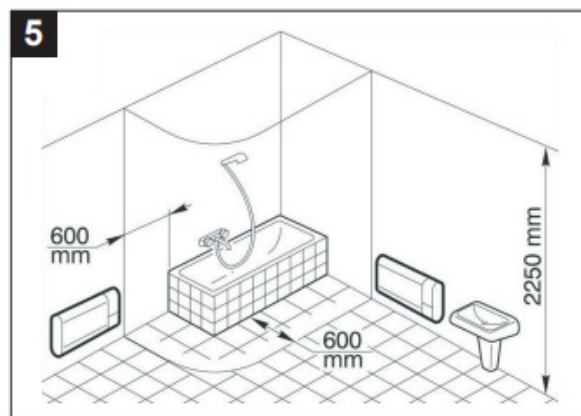
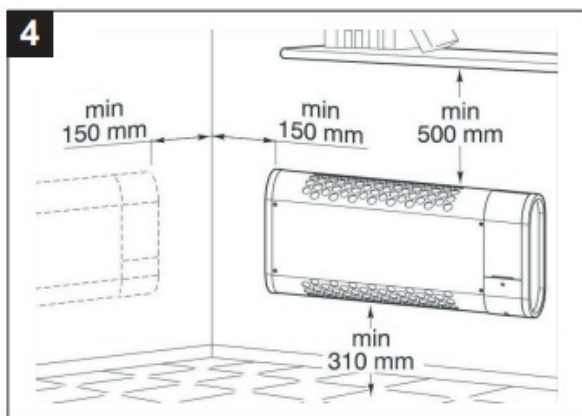
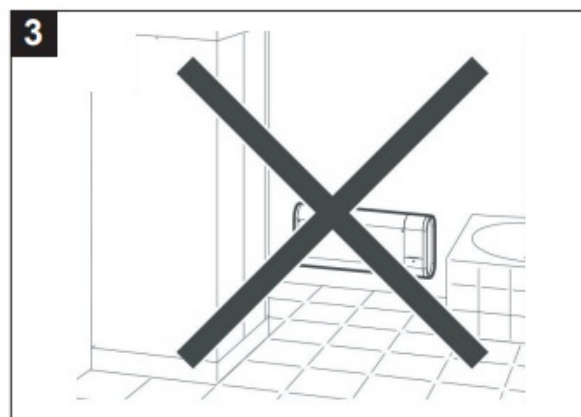
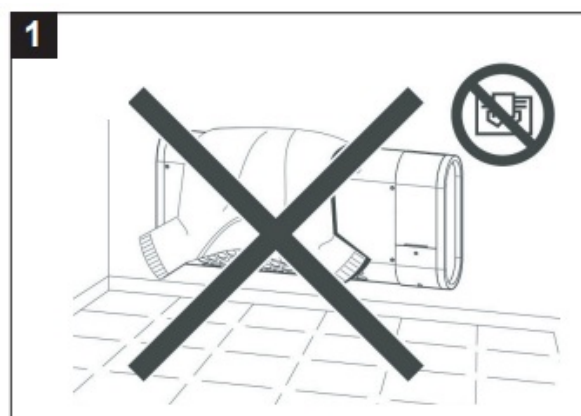
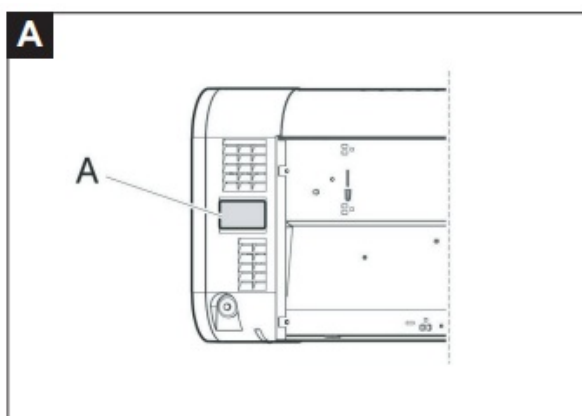

- Switch off the system main switch when:
  - if the appliance does not function correctly;
  - before cleaning the outside of the appliance

- the appliance will not be used for a short or long period.

## **PROHIBITION**

- Do not use this appliance for functions other than those described in this booklet.
- Do not make modifications of any kind to this appliance.
- Do not sit on the appliance or leave objects standing on it (Fig. 1).
- Do not operate the appliance where inflammable vapors or substances are present like alcohol, insecticides, petrol, etc. (Fig. 2).
- Do not expose the appliance to the weather (rain, sun, etc.).
- Do not insert any objects into the appliance.
- Do not cover the appliance to prevent dangerous overheating.
- Do not cover or block appliance intake or outlet vent grilles, as this may prevent optimum airflow.
- Certain fundamental rules must be observed when using any electrical appliance: never touch appliances with wet hands;
- never touch appliances while barefoot; do not allow the unit to be operated by unsupervised children or disabled persons.
- If the power cord becomes damaged, it must be replaced by the manufacturer or its technical assistance service, or in any case by a person with similar qualifications, to prevent any risk.
- Never position the appliance directly under a power socket.
- Some parts of this product can become very hot and cause burns. Particular attention has to be given where children and vulnerable people are present.

## **Minimum application distances**

### **Fig. 4 – 5. N.B.**

Install the appliance only in the position indicated in Fig. 4 – 5.

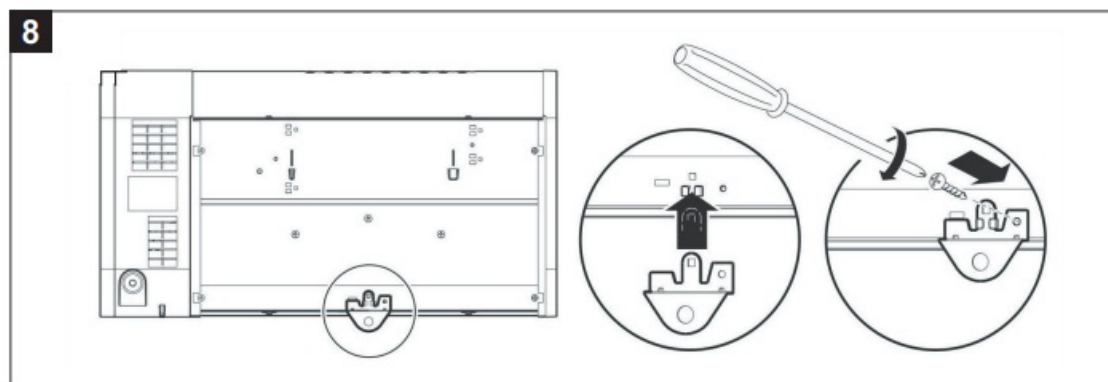
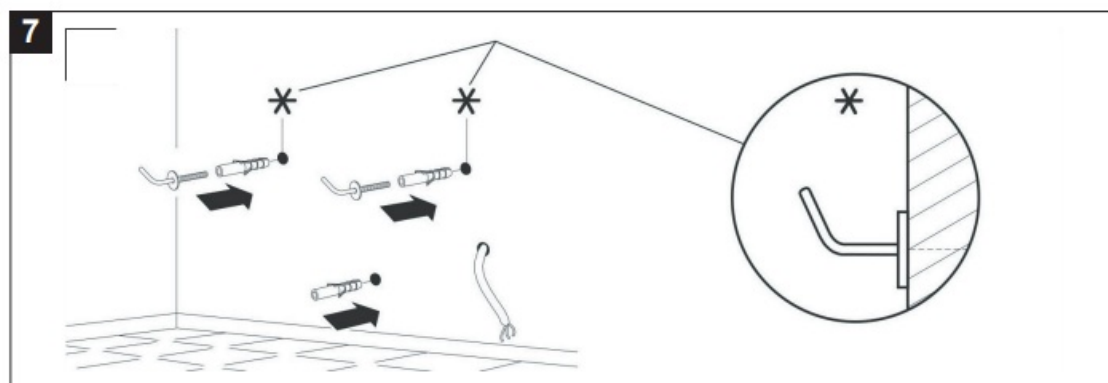
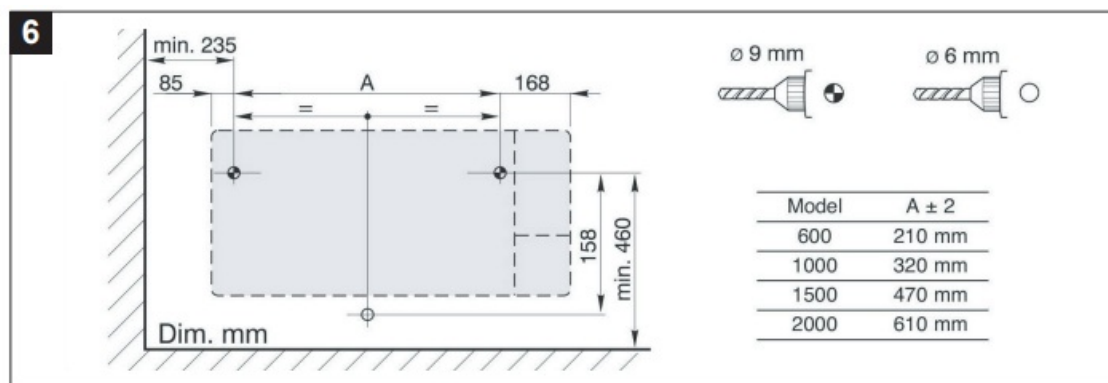

## Installation

Fig. 6 ÷ 15.

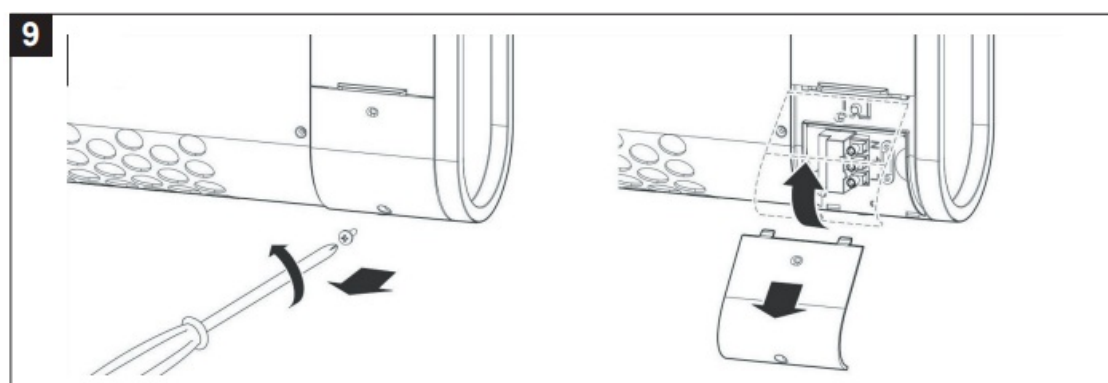

10

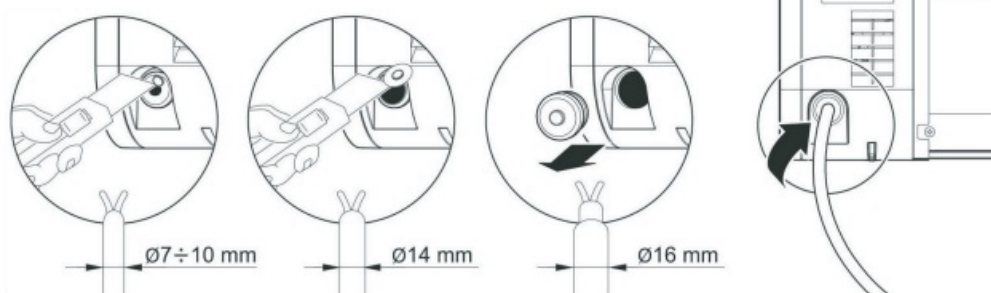

11

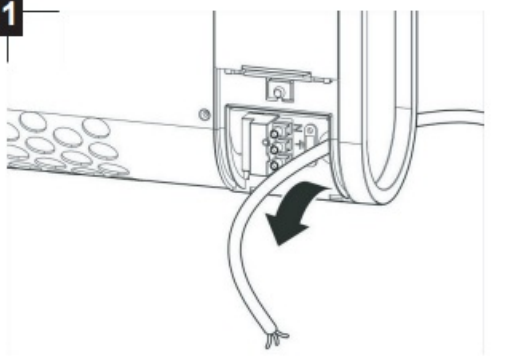

12

# ROOM THERMOSTAT

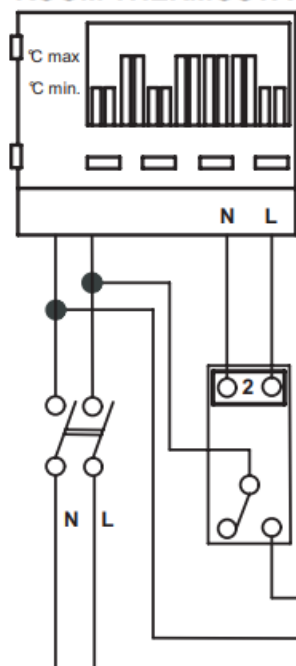

1 = Teleruttore o Relè / Remote control switch or Relay

2 = Bobina / Coil

3 = Morsettiera / terminal block - MICRORAPID/MICROSOL

## Main controls

Fig. 16.

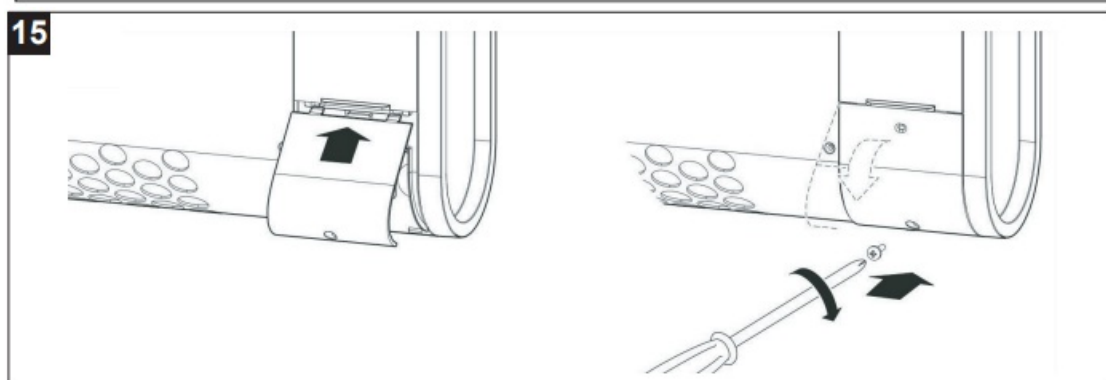
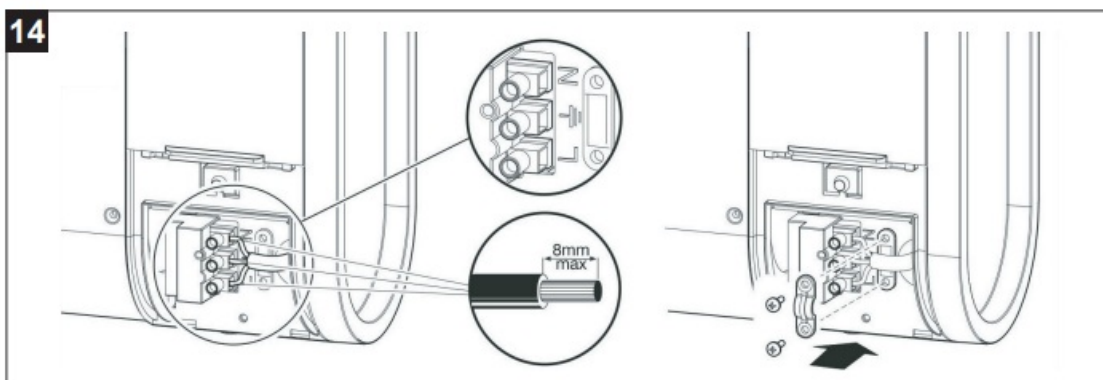
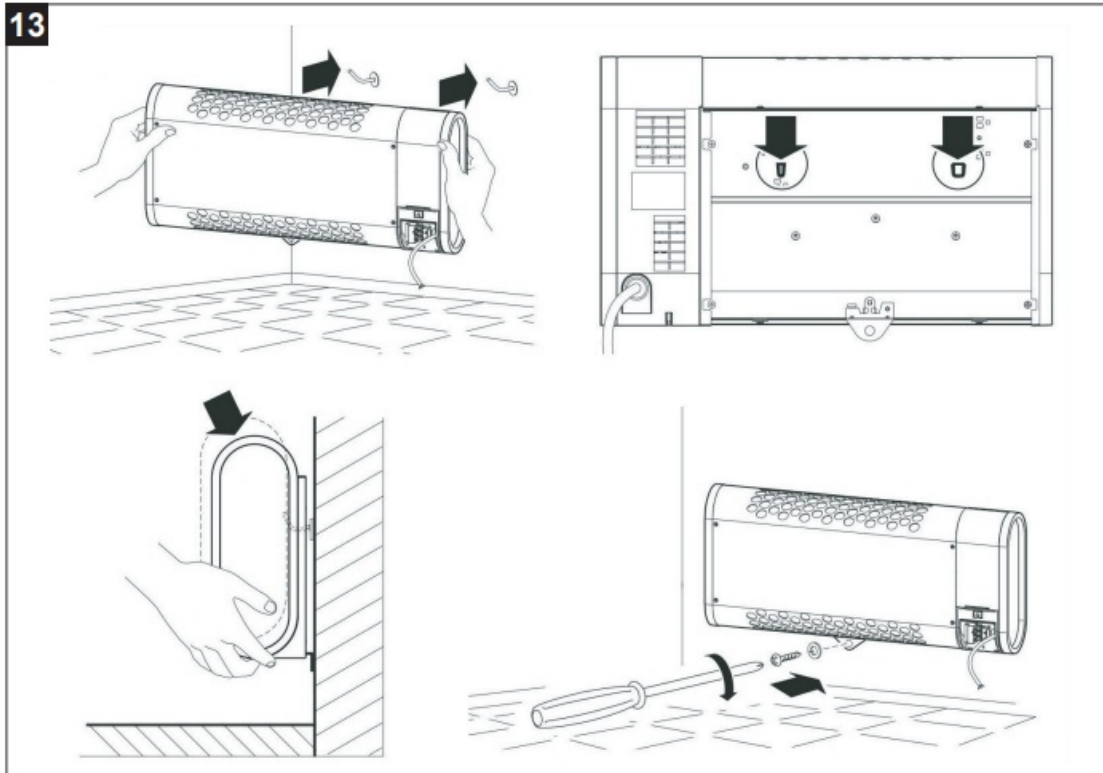

**Maintenance and cleaning**  
Fig. 17 – 18.

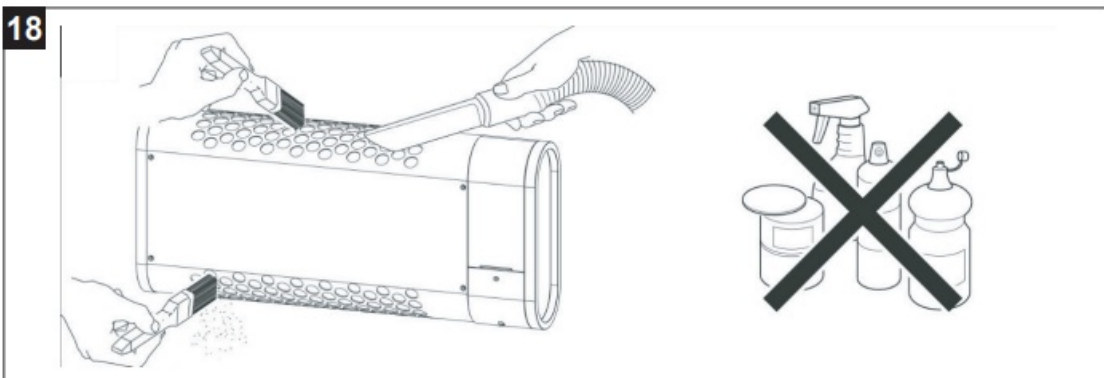
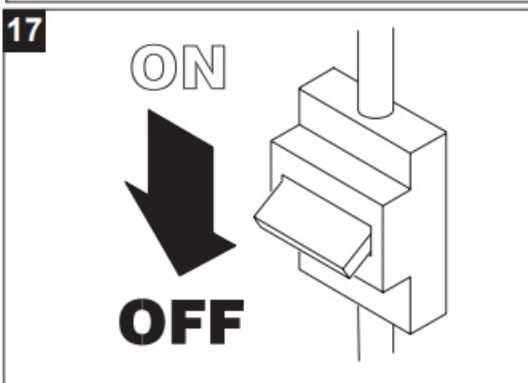
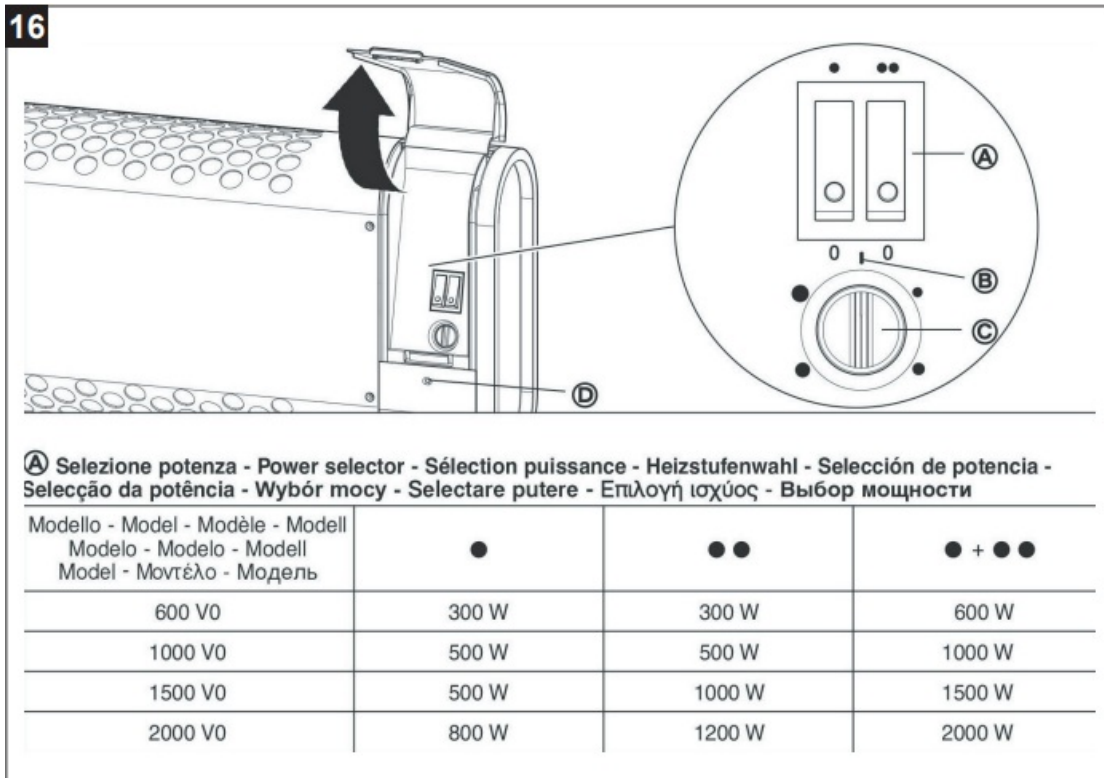

## Disposal

This product complies with Directive 2012/19/EU on the management of waste electrical and electronic equipment (WEEE). The crossed-out wheeled bin symbol on the appliance indicates that, at the end of its life, the product should not be discarded together with household waste but must be taken to a separate collection point for electrical and electronic equipment. This will avoid negative effects on the environment and health and will encourage correct treatment, disposal, and recycling of the materials from which the product is made. Contact the municipal authority for the location of this type of facility. Alternatively, the distributor is obliged to take back the appliance.

## Power selector

See the table above.

### Anti-frost function

If you turn the power selector to 1, the appliance switches on automatically at the selected power if the room temperature falls below 5°C.

### Room temperature thermostat

This switches the appliance on (at the selected power) whenever the room temperature falls below the set temperature.

### LED indicator

Lights to show that the appliance is powered on.

### WARRANTY – OTHER COUNTRIES

since January 1, 8 021 mercer outies al go refer to lot a regulation with the seller, as described in Directive (EU) 2019/771 in force. VORTICE S.p.A. reserves the right to make improvements to products at any time and without prior notice.

### VORTICE GROUP COMPANIES

VORTICE S.p.A.  
Strada Cerca, 2 – frazione di Zoate  
20067 – Tribiano (MI)  
Tel. +39 02-90.69.91

### ITALY

[vortice.com](http://vortice.com)

[postvendita@vortice-italy.com](mailto:postvendita@vortice-italy.com)

## Documents / Resources

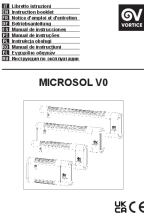
	<p><a href="#">VORTICE MICROSOL V0 Vortice Thermoconvector</a> [pdf] Instruction Manual MICROSOL V0 Vortice Thermoconvector, MICROSOL V0, Vortice Thermoconvector, Thermocvector</p>
---	--

## References

- [Vortice ventilation, fans and air conditioners](#)
- [User Manual](#)

### [Manuals+](#), [Privacy Policy](#)

This website is an independent publication and is neither affiliated with nor endorsed by any of the trademark owners. The "Bluetooth®" word mark and logos are registered trademarks owned by Bluetooth SIG, Inc. The "Wi-Fi®" word mark and logos are registered trademarks owned by the Wi-Fi Alliance. Any use of these marks on this website does not imply any affiliation with or endorsement.