



Vorago Hoverboard plus KART 400 User Guide

[Home](#) » [Vorago](#) » Vorago Hoverboard plus KART 400 User Guide 

Contents

- [1 Vorago Hoverboard plus KART 400](#)
- [2 KNOW YOUR KART](#)
- [3 COMPONENTS LIST](#)
- [4 ASSEMBLY STEPS](#)
- [5 SAFE USE OF YOUR KART](#)
- [6 TECHNICAL SPECIFICATIONS](#)
- [7 Limited product warranty](#)
- [8 Documents / Resources](#)
- [9 Related Posts](#)



Vorago Hoverboard plus KART 400



Unfortunately, the given text extract from the user manual does not provide any product information or usage instructions. It only includes some technical information about the file, such as the file name, page number, and time stamp. To provide product information, we need more details about the product. Please provide us with the product name, brand, and model number. Once we have this information, we can provide detailed product information and usage instructions in a clear and concise manner using HTML formatting.

CAUTIONS AND WARNINGS

Respect these limits and use your kart safely

- **Max. speed:** 15 km/h
- **Max, weight limit:** 100kg

KNOW YOUR KART

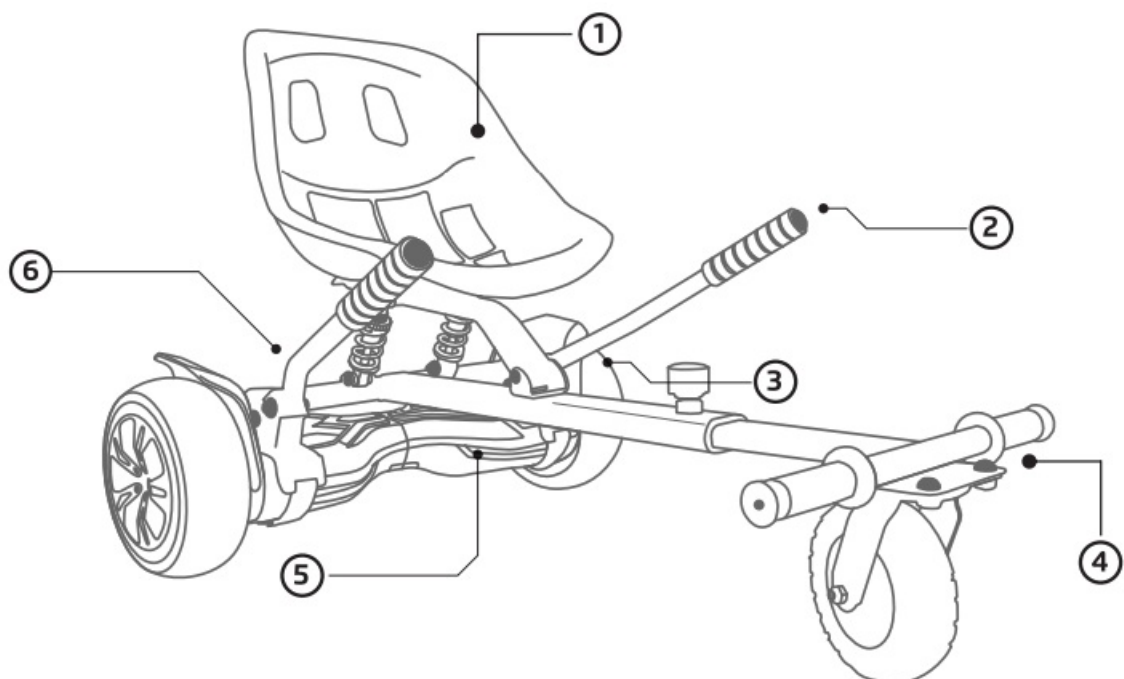

	Comfortable seat
2	Precise handling
3	Adjustable central bar
4	Foot support
5	Reinforced nylon strap
6	Double suspension

COMPONENTS LIST

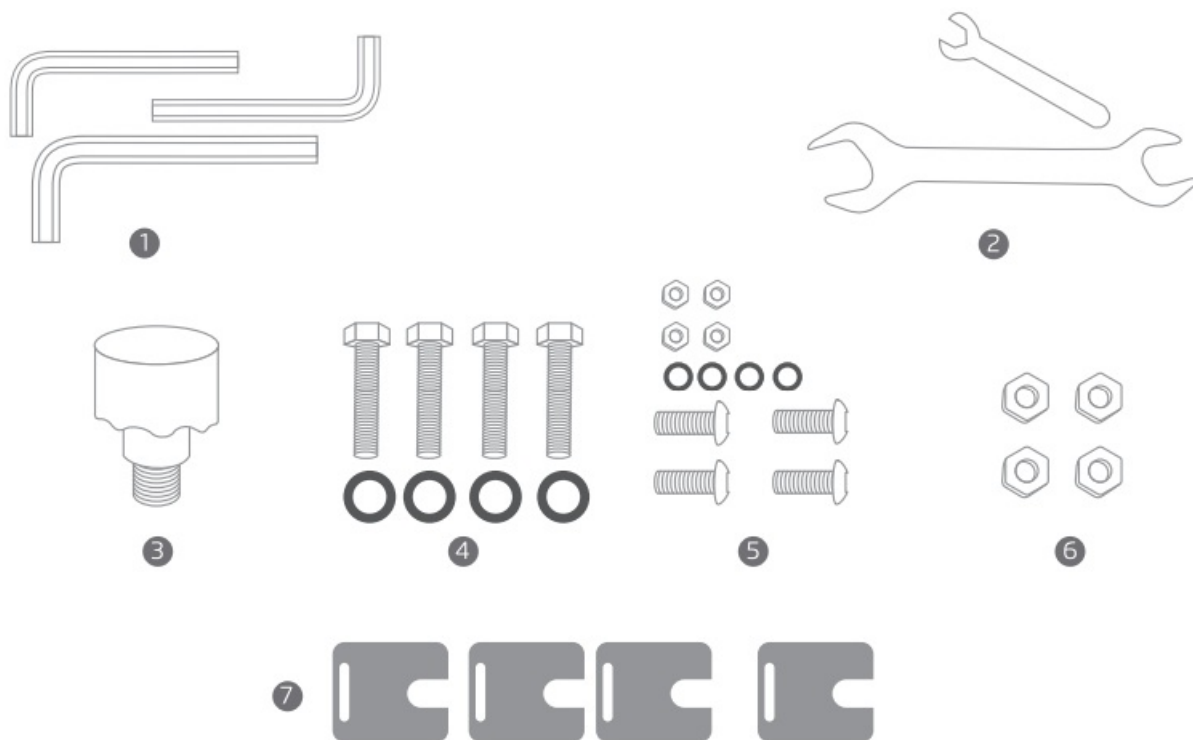

1. Allen key x 3
2. Keys
3. Allen screw M8 x50 mm x4t
4. Knob x 1
5. Allen screw M8 x 20 mm x 4
6. Anti-slip nut M8 x 8
7. Rubber protectors

ASSEMBLY STEPS

- **Step 1:** Open the box and check if no parts are missing.
- **Step 2:** Front tube: put the tube into the hole and adjust with the knob to fit the proper length.

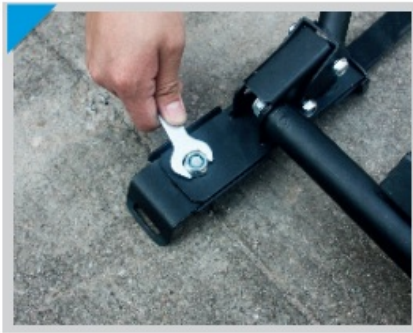

- **Step 3:** Handles: Use the Allen key and Spanish key e to assemble the handles, use the four screws and the four anti-slip nuts. Make sure you have positioned the handles correctly before the next step .



- **Step 4:** Seat: Use the Allen key to attach the seat to the cross bracket with the four screws



- **Step 5:** Attach the kart to your hoverboard and adjust the nut on the end of the cross bracket, to make it fit the size of your hoverboard. Secure the kart to the plate with the belts. Please check if the straps are tight before Use.

SAFE USE OF YOUR KART

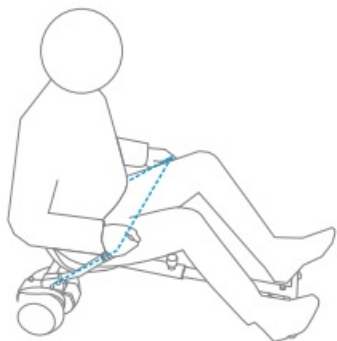

Stop

Hold both sticks
in a horizontal position.

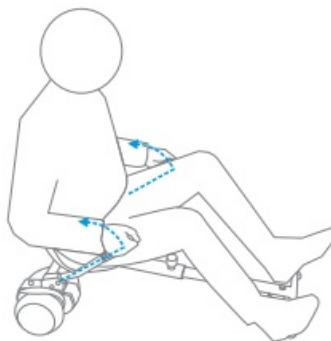

Backwards

Raise both sticks.

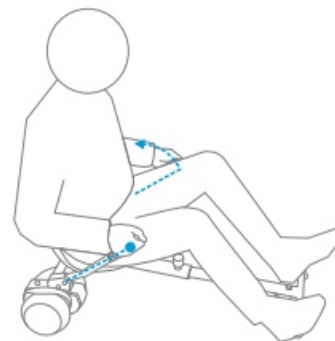

Turn left

Raise the left stick
Don't move the right stick.

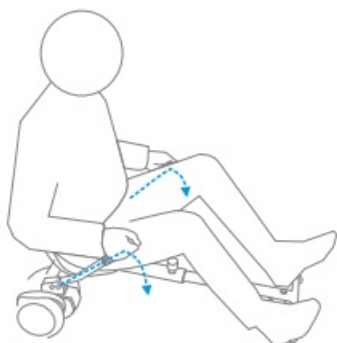

Forward

Push forward
both sticks.

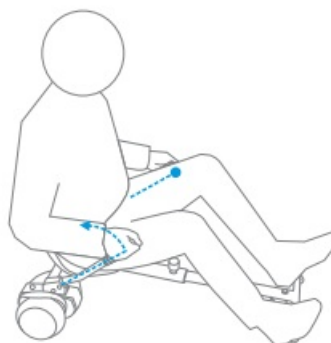

Turn to the right

Raise the right lever
Don't move the left stick.

1. Sit on the seat.
2. Keep the handle horizontal.
3. Press the power button.

TECHNICAL SPECIFICATIONS

- **Material:** Steel
- **Max weight supported:** 100 k

Limited product warranty

Vorago equipment and/or accessories are covered by a limited warranty for the time indicated in the annexed validity table, counting from the date of acquisition, against any manufacturing and operation defect, provided they have been used under normal conditions of use during the warranty period and for which it was manufactured. Vorago guarantees the buyer the absence of anomalies regarding the materials.

Products	Validity
PC, tablets, cell phones, audio, keyboards, mouse, networks and accessories	12 Months
LCD Monitor * Except in panel (screen display) for which it will only be 12 months.	36 Months*
Computer equipment 3 years including Nanobay 3. * Except computer equipment where the processor is integrated on the motherboard it will only be 12 months.	36 Months *

Warranty Important: Please read and complete this warranty policy and seal it in the store when purchasing the product.

Product: Hoverboard+ kart	Dealer stamp
Model: HB-400	
Brand: Vorago	
Serial number:	
Invoice number:	
Delivery date:	

Responsibilities

The total responsibility of Vorago will be to repair or replace the product, including labor and parts, at no cost to the buyer when it is returned to the point of sale, presenting this warranty policy properly completed and stamped by the establishment where it was purchased. The product or copy of the receipt or receipt or invoice, in which data of the product the date of purchase is specified, to verify the times within the guarantee. vorago may use new parts, restored or used in good condition to repair or replace any product, at no additional cost to the consumer. In the case of equipment and / or accessories that can not be repaired, the change will be generated by a similar product or with superior characteristics. this guarantee covers the transportation expenses of the product derived from its fulfillment; which will be directly attributable to the supplier of the product.

In all replacement products, the original warranty period will be renewed. Vorago is governed by international standards for the manufacture of products.

How to obtain warranty support

Guarantee claims are processed through the point of sale, during the first 15 days after the purchase, as long as they meet the requirements. Guaranteeclaims that can not be processed through the point of sale and any concerns related to the product purchased should be sent with the prepaid guide by Vorago to the address of the Vorago headquarters in Francisco Villa No. 3, Col. San Agustin, CP 45645, Tlajomulco de Züfiiga, Jalisco, Mexico.

Except in situations of force majeure or fortuitous event, the repair time in no case will be greater than 30 calendar days from the date of receive of the equipment in Vorago.

Exclusions

This guarantee is not valid in the following cases:

- When the product had been used in conditions other than normal.
- When the product has not been operated in accordance with the instructions for use instructions of Use.
- When the product has been altered or repaired by unauthorized persons by Vorago.

Vorago does not offer any other express warranty for this product.

To make the guarantee valid, as well as the acquisition of parts, components, consumables and accessories
To validate a guarantee, the following information must be sent to the email: garantias@voragolive.com

1. Model and color
2. Product failure
3. Ticket or purchase invoice (digitized)
4. Your address with CP, telephone and full Name.

Available in the establishment where the product was purchased and/or in our central offices:

Returns

In the case of product return, it will only be the place of purchase by the end customer. Subject to the return policies established by the same seller.

Vorago, S.A. de C.V. Francisco Villa No. 3 Col. san Agustin, C.P. 45645 Tlajomulco de Zúñiga, Jalisco, México.

Tel. (33) 3044 6666

Importadora Global Rida S.A. de C.V. Matilde Méquez No. 68 Colonia Pefiñ de los Bahos C.P. 15520 Alcaldia Venustiano Carranza, CDMX

RFC: IGR1510164C2

www.voragolive.com



Queremos escucharte (33) 3044 6666

Call us + 52 (33) 3044 6666

We invite you to register your product and enjoy the benefits. Register your purchase on our website and participate in promotions at:

Documents / Resources

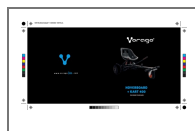

[Vorago Hoverboard plus KART 400](#) [pdf] User Guide
Hoverboard plus KART 400, Hoverboard, KART 400