



[Home](#) » [Vonshef](#) » **VonShef 2000158 Double Induction Hobs Instruction Manual** 

Contents [[hide](#)]

- [1 VonShef 2000158 Double Induction Hobs](#)
- [2 Product Information](#)
- [3 Product Usage Instructions](#)
- [4 GENERAL SAFETY](#)
- [5 CLEANING & MAINTENANCE](#)
- [6 TECHNICAL SPECIFICATION](#)
- [7 COMPONENT LIST](#)
- [8 BEFORE FIRST USE](#)
- [9 OPERATION](#)
- [10 ERROR CODES](#)
- [11 Component overheat – allow to cool sufficiently.](#)
- [12 FAQ](#)
- [13 Documents / Resources](#)
 - [13.1 References](#)

VonShef

VonShef 2000158 Double Induction Hobs



Specifications

- **Rated Voltage:** 220-240V
- **Rated Power:** 2800W
- **Rated Frequency:** 50/60Hz

Product Information

This appliance is designed with a thermal cut out switch that activates if the appliance overheats, ensuring safety during use.

The control panel has a protective film that needs to be removed before the first use to ensure touch sensitivity.

Components include a ceramic plate, indicator lights, control panel, and LED display.

Product Usage Instructions

Safety Precautions

- Do not allow children to use the appliance as a toy. Always supervise children around the appliance.
- If the appliance is damaged, contact Customer Services before further use.
- Ensure all parts are securely attached before using the appliance.

Cleaning and Maintenance

- Never soak electrical components or those with plugs attached.
- Hand wash recommended using warm soapy water and a soft sponge.
- Use non-abrasive cleaning tools to remove stubborn stains. Avoid harsh cleaning solutions.
- Do not wash any electrical components in a dishwasher.

Operation Instructions

- Make full contact with the touch screen sensors on the control panel for all operations to work effectively.
- Use your thumb for better coverage on the sensory area surrounding the buttons.

Please read all instructions carefully before use and retain for future reference.

ATTENTION This appliance has a thermal cut out switch. The thermal cut out will activate and shut down the appliance should the appliance overheat.

Unplug from the mains and or battery and allow to cool for 30 minutes before re-use.

CAUTION Do not immerse in water.

CAUTION hot surfaces

IMPORTANT: Remove the protective film from the control panel before first use to ensure touch sensitivity.

Please read all instructions carefully before use and retain for future reference.

INTENDED USE

Only operate the appliance for its intended purpose and within the parameters specified in this manual.

This appliance is for domestic use only. Do not use outdoors or on wet surfaces.

This appliance is not intended for use by persons with reduced physical, sensory or mental capabilities, or lack of experience and knowledge, unless supervised or given appropriate instruction concerning the product's use by a person responsible for their safety.

The appliance is not intended to be operated by means of an external timer or separate remote-control system.

GENERAL SAFETY

- Do not allow to be used as a toy.
- Children should be supervised to ensure they do not play with the appliance.
- If the appliance is not functioning properly, has been dropped, damaged, left outdoors, or immersed in liquid, do not use, contact DOMU Brands Customer Services.
- Do not use the appliance if any parts appear to be faulty, missing or damaged.
- Ensure all parts are securely attached as instructed by this instruction manual before use.
- **CABLES AND PLUGS** Check to ensure your electricity supply matches that shown on the rating plate. This product should only be used as rated. Preferably, the socket outlet should be protected by a Residual Current Device RCD (UK/EU) Ground Fault Indicator (US).
- Do not use with a damaged cable or plug. If the supply cable is damaged, it must be replaced by a qualified engineer or authorised service agent in order to avoid a hazard. The use of an extension cable is not recommended.
- Do not handle the plug or appliance with wet hands.
- Keep the cable away from heated surfaces.
- Do not let the cable hang over the edge of the table or countertop where it could be pulled on inadvertently by children or pets.
- Do not pull the cable around sharp edges or corners.
- Do not leave unattended when plugged in. Unplug from outlet when not in use.
- Turn off all controls before unplugging.
- Do not unplug by pulling on the cable. To unplug, grasp the plug, not the cable.
- Always unplug before performing user maintenance, connecting or disconnecting attachments, or changing accessories.
- Ensure the cable is stored safely to prevent hazards.

RISK OF PERSONAL INJURY

- Always locate your appliance away from the edge of the worktop, on a firm, flat, heat-resistant surface with sufficient space around all sides. Do not insert any objects into

openings or cover the appliance.

- Do not place any cardboard, plastics or paper inside or on the appliance unless stated in the instructions.
- Do not use the appliance near any combustible surfaces. Only use suitable cookware where applicable.
- Do not use outdoors or near heat sources.
- Take care not to touch any surfaces that may get hot when in use. Take care not to touch any surfaces that may remain hot for a period of time after use.
- Do not overload/overfill the appliance.
- When using for the first time your appliance may give off a 'new' smell or vapour. This will dissipate after a few uses. Do not lift or move the appliance whilst in use.
- Do not operate continuously for periods longer than those marked on the product or indicated in the instructions.
- Ensure the appliance is switched off and unplugged before changing accessories or cleaning.

Use only as described in this manual and with DOMU Brands recommended attachments only.

CLEANING & MAINTENANCE

Never soak or immerse electrical or heating components and or a component that has a plug attached.

Hand washing recommended; soak in warm soapy water and wipe down using a soft sponge. To remove stubborn stains, use a non abrasive cleaning brush.

Do not use abrasive, harsh cleaning solutions or metal scouring pads.

Never wash any electrical or heating components and or a component that has a plug attached in a dishwasher.

TECHNICAL SPECIFICATION

- Rated Voltage 220-240V
- Rated Power 2800W
- Rated Frequency 50/60Hz

COMPONENT LIST

1. Ceramic Plate.
2. Indicator Lights.
3. Control Panel.
4. LED display.

COMPONENTS

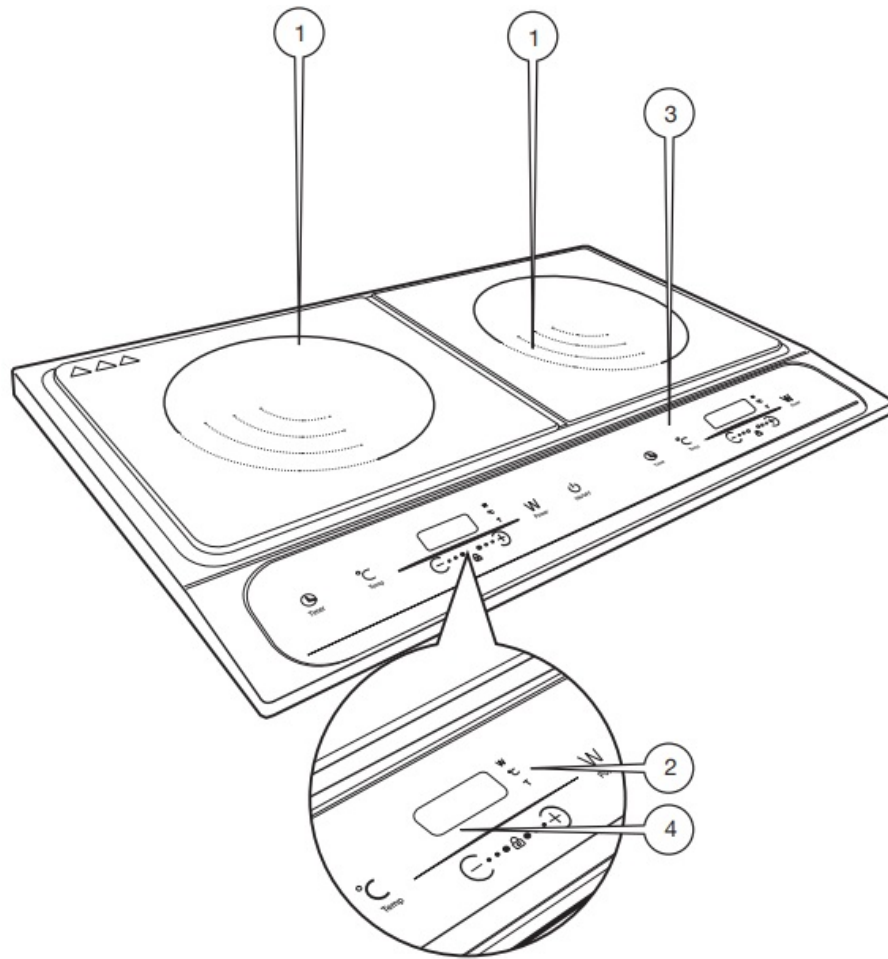

BEFORE FIRST USE

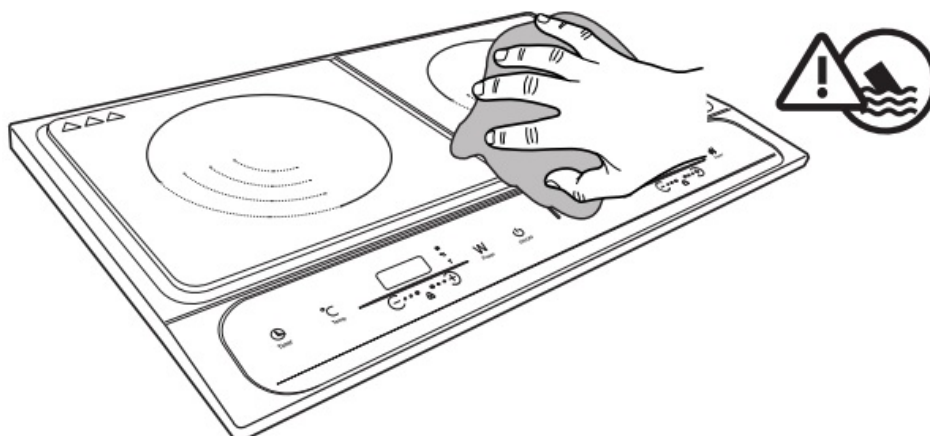

CAUTION Do not immerse in water.

Wipe with a damp cloth

IMPORTANT: You will need to make full contact with the touch screen sensors in order for all operations on the CONTROL PANEL to work. This may require you to make contact with the button itself and the sensory area surrounding it (it may be necessary to use your thumb rather than finger for better coverage).



OPERATION

1. Add cookware to centre first.

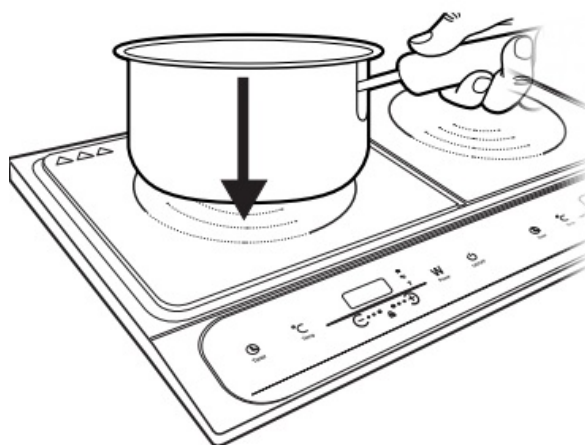

2. Press & Hold.

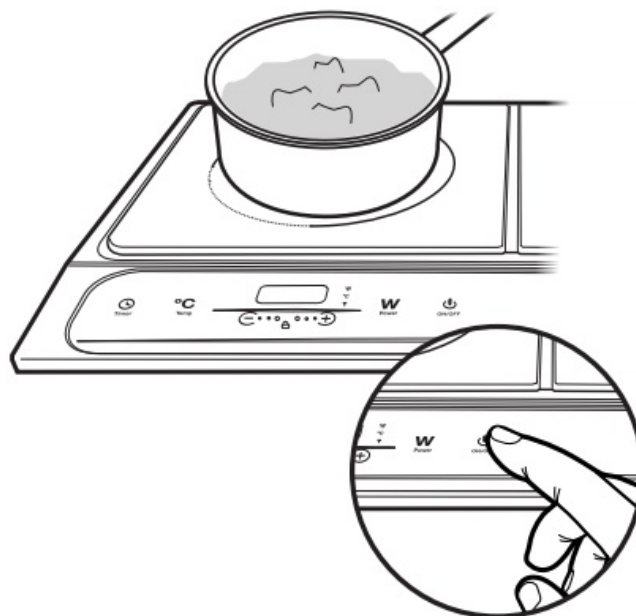

3. Increase or decrease power (fig 2)

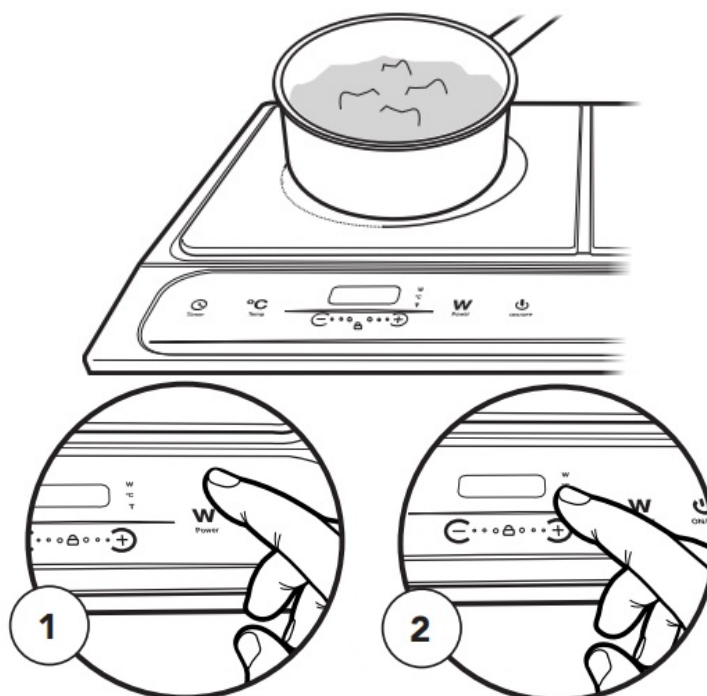

200W – 2800W

MAX

NOTE! 2800W is the output for both plate surfaces combined. Not individually.

1. Adjust time.

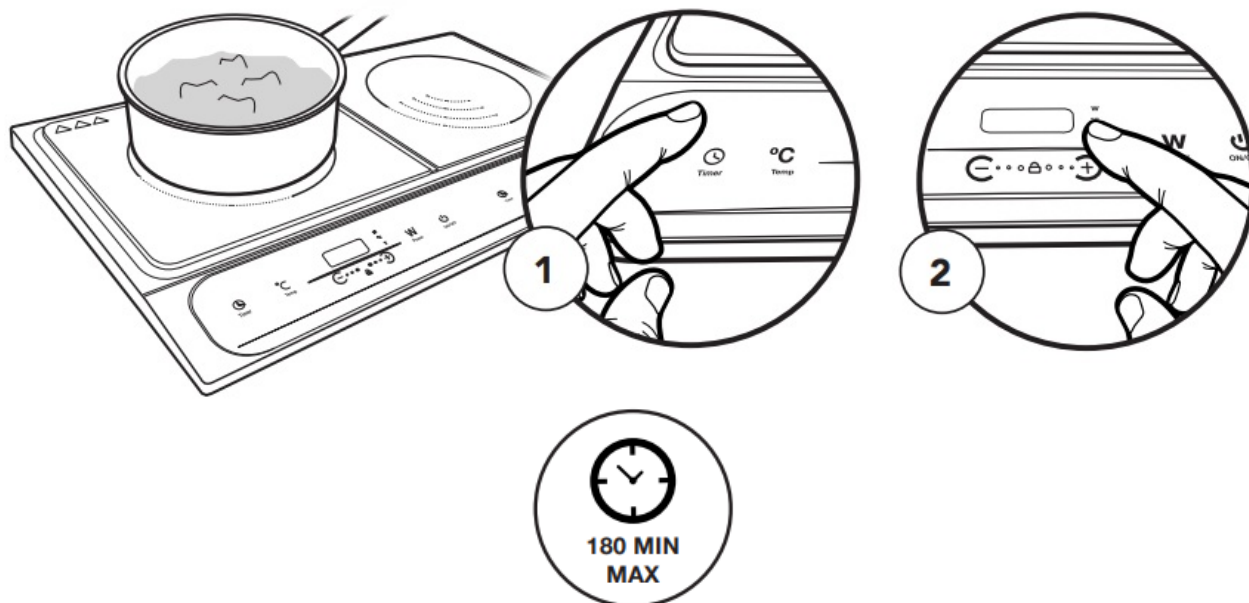

4. Increase or decrease temperature

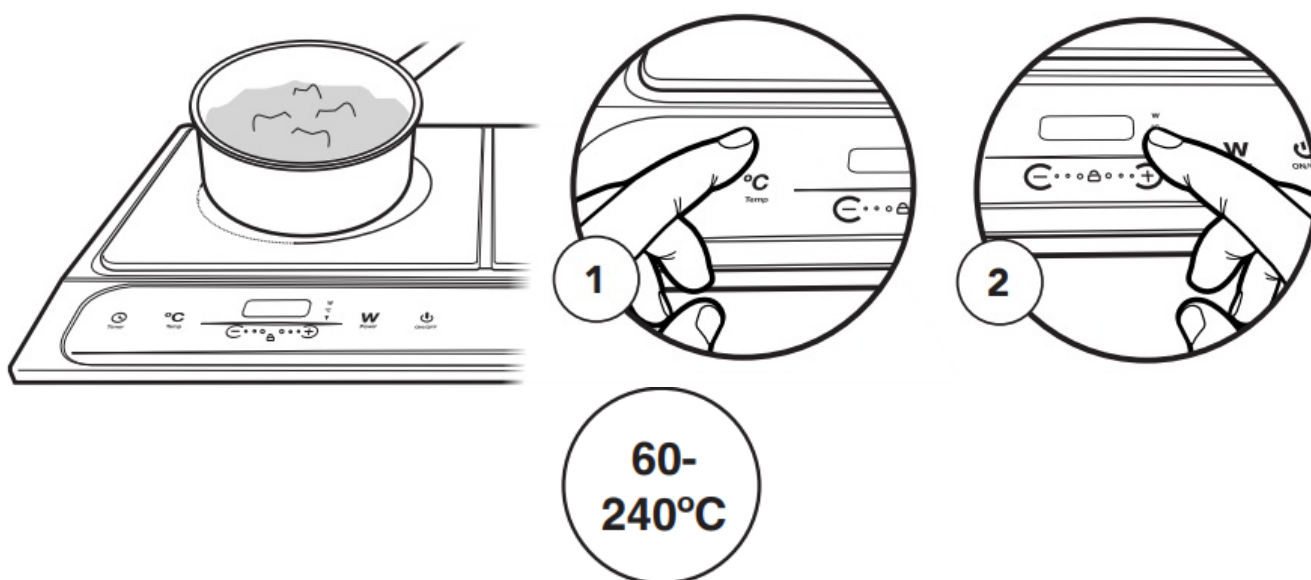

5. To engage the 'Safety Lock' feature, press and hold – and + at the same time. Repeat to unlock.



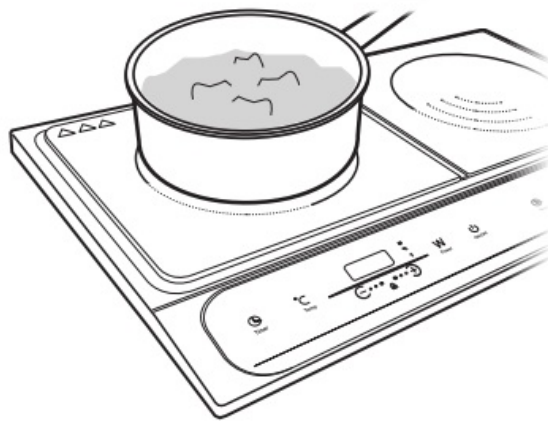

6. Switch off and allow to cool.

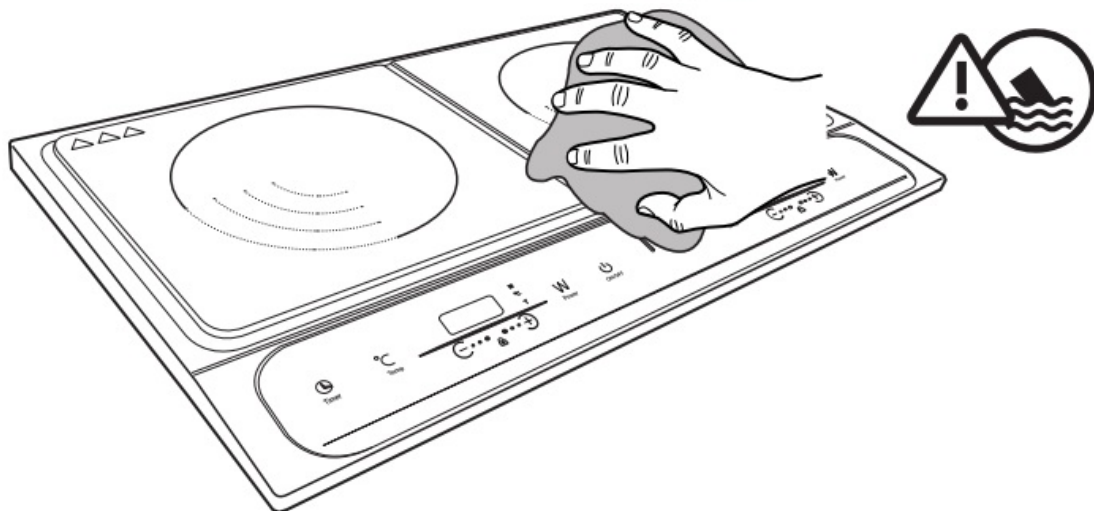
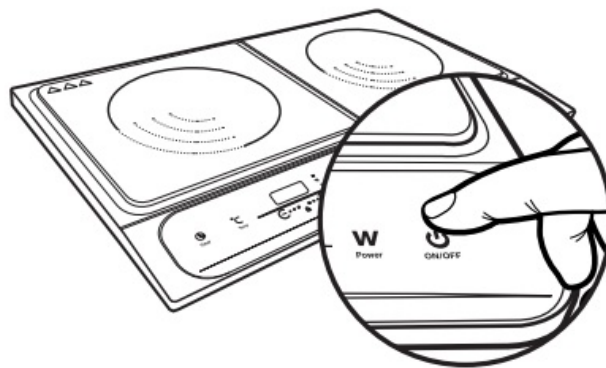

TIPS

- Always position the appliance on a flat and stable surface with sufficient space around all sides.
- Ensure the area the appliance is positioned in is fully ventilated.
- **IMPORTANT:** Do not use pots or pans made from aluminium, copper or aluminium alloy. Pans must have a smooth, flat base with a diameter of 12cm -26cm.

- Ensure the pan has food inside before placing on the ceramic plate.
- Stir food from time to time to ensure food is cooked evenly.
- Metal cooking utensils are not recommended since they can be heated through the induction hob if left in the pan during cooking
- Temperatures can be adjusted at any time during operation if required.
- Avoid touching any part of the appliance once in operation. The surfaces will get very hot. The use of an oven mitt is highly recommended.
- Once food is fully cooked and the appliance is switched off, allow the cooling fan to stop before disconnecting from the mains outlet.
- The fan takes a few minutes to stop.
- Allow the appliance to fully cool before cleaning.

NOTE:

- If the cookware is unsuitable for use, the Hob will show “E0” on the LED Display.
- If the wrong sized pan is used, the Hob will show “E0” on the LED Display.

ERROR CODES

If there is a problem with the induction hob, one of the following error codes may appear on the display.

- E0
No pan in place or wrong size pan used.
- E1
Low voltage protection.
- E2
High voltage protection.
- E3
Pan has no water/contents.
- E4
Short Circuit.
- E5
Ceramic plate has overheated – allow to cool completely.
- E6

Component overheat – allow to cool sufficiently.

Component overheat – allow to cool sufficiently.

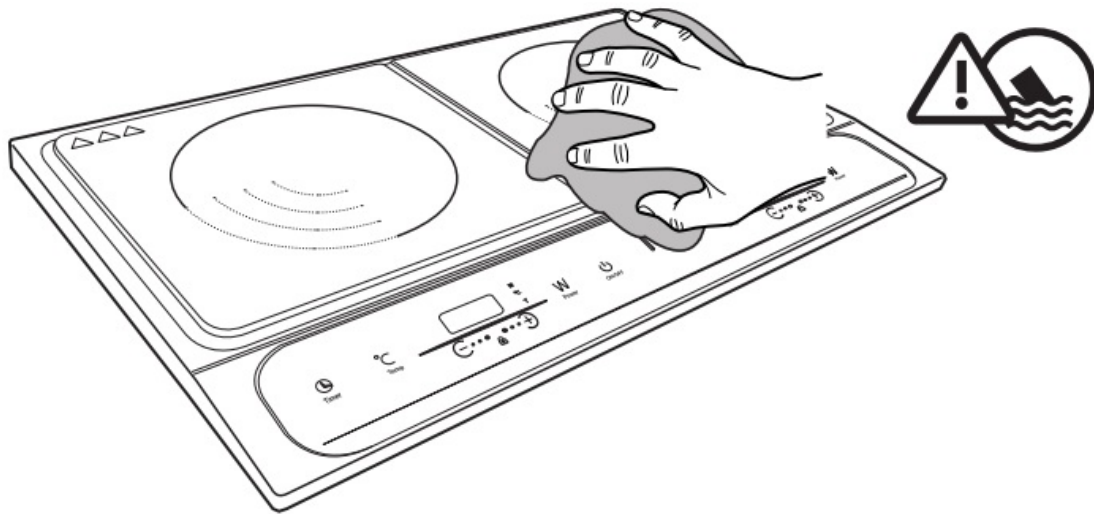

CAUTION Do not immerse in water.

Wipe with a damp cloth



DISPOSAL INFORMATION Please recycle where facilities exist. Check with your local authority for recycling advice.

CUSTOMER SERVICE If you are having difficulty using this product and require support, please contact support@domu.co.uk

WARRANTY To register your product and find out if you qualify for a free extended warranty please go to www.vonshef.com/warranty.

Please retain a proof of purchase receipt or statement as proof of the purchase date. The warranty only applies if the product is used solely in the manner indicated in the warnings page of this manual, and all other instructions have been followed accurately. Any abuse of the product or the manner in which it is used will invalidate the warranty. Returned goods will not be accepted unless re-packaged in its original packaging and accompanied by a relevant and completed returns form.

This does not affect your statutory rights. No rights are given under this warranty to a

person acquiring the appliance second-hand or for commercial or communal use.
COPYRIGHT All material in this instruction manual are copyrighted by DOMU Brands. Any unauthorised use may violate worldwide copyright, trademark, and other laws.

THANK YOU

Thank you for purchasing your product/appliance. Should you require assistance with your purchase, please contact us at support@domu.co.uk
VonHaus is a registered trademark of DOMU Brands Ltd.

Made in China for DOMU Brands Ltd.
Unit 30, Stakehill Industrial Estate Middleton,
Manchester, M24 2RW
EU Authorised Representative
EU Authorised Representative Service
77 Camden Street Lower Dublin, D02 XE80 Ireland

FAQ

Q: What should I do if the appliance overheats?
A: Unplug the appliance and let it cool for 30 minutes before reusing.

Q: Can I wash the electrical components in a dishwasher?
A: No, never wash any electrical components in a dishwasher. Hand washing is recommended.

Documents / Resources

	<p>VonShef 2000158 Double Induction Hobs [pdf] Instruction Manual</p> <p>2000158 Double Induction Hobs, 2000158, Double Induction Hobs, Induction Hobs, Hobs</p>
---	--

References

- [User Manual](#)

💎 2000158, 2000158 Double Induction Hobs, Double Induction Hobs, HOBS, Induction Hobs,

📁 Vonshef Vonshef

Leave a comment

Your email address will not be published. Required fields are marked *

Comment *

Name

Email

Website

☐ Save my name, email, and website in this browser for the next time I comment.

Post Comment

Search:

e.g. whirlpool wrf535swhz

Search

[Manuals+](#) | [Upload](#) | [Deep Search](#) | [Privacy Policy](#) | [@manuals.plus](#) | [YouTube](#)

This website is an independent publication and is neither affiliated with nor endorsed by any of the trademark owners. The "Bluetooth®" word mark and logos are registered trademarks owned by Bluetooth SIG, Inc. The "Wi-Fi®" word mark and logos are registered trademarks owned by the Wi-Fi Alliance. Any use of these marks on this website does not imply any affiliation with or endorsement.