



[Home](#) » [Vonshef](#) » **VonShef 2000157 Single Induction Hob Instruction Manual** 

Contents [[hide](#)]

- [1 VonShef 2000157 Single Induction Hob](#)
- [2 CLEANING & MAINTENANCE](#)
- [3 TECHNICAL SPECIFICATION](#)
- [4 COMPONENT LIST](#)
- [5 BEFORE FIRST USE](#)
- [6 OPERATION](#)
- [7 Tips](#)
- [8 ERROR CODES](#)
- [9 MAINTENANCE](#)
- [10 FAQ](#)
- [11 Documents / Resources](#)
 - [11.1 References](#)

VonShef

VonShef 2000157 Single Induction Hob

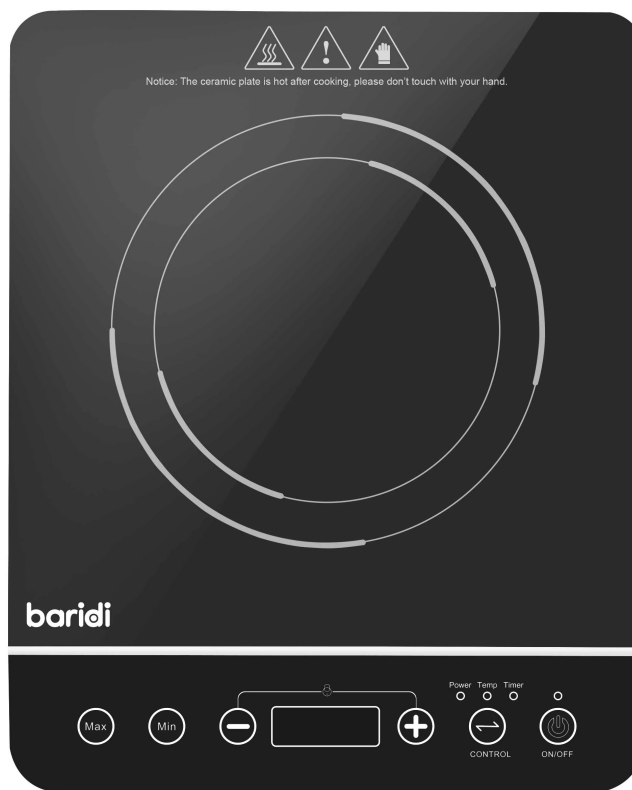

Please read all instructions carefully before use and retain for future reference.

- **ATTENTION** This appliance has a thermal cut out switch. The thermal cut out will activate and shut down the appliance should the appliance overheat. Unplug from the mains and or battery and allow to cool for 30 minutes before re-use.
- **CAUTION** Do not immerse in water.
- **CAUTION** hot surfaces
- **IMPORTANT:** Remove the protective film from the control panel before first use to ensure touch sensitivity.

Please read all instructions carefully before use and retain for future reference.

- **INTENDED USE:** Only operate the appliance for its intended purpose and within the parameters specified in this manual.
- This appliance is for domestic use only. Do not use outdoors or on wet surfaces.
- This appliance is not intended for use by persons with reduced physical, sensory or mental capabilities, or lack of experience and knowledge, unless supervised or given appropriate instruction concerning the product's use by a person responsible for their safety.
- The appliance is not intended to be operated by means of an external timer or

separate remote-control system.

- **GENERAL SAFETY:** Do not allow to be used as a toy.
- Children should be supervised to ensure they do not play with the appliance. If the appliance is not functioning properly, has been dropped, damaged, left outdoors, or immersed in liquid, do not use, contact DOMIJ Brands Customer Services.
- Do not use the appliance if any parts appear to be faulty, missing or damaged.
- Ensure all parts are securely attached as instructed by this instruction manual before use.
- **CABLES AND PLUGS** Check to ensure your electricity supply matches that shown on the rating plate. This product should only be used as rated. Preferably, the socket outlet should be protected by a Residual Current Device RCD (UK/EU), Ground Fault Indicator (US).
- Do not use with a damaged cable or plug. If the supply cable is damaged, it must be replaced by a qualified engineer or authorised service agent in order to avoid a hazard. The use of an extension cable is not recommended.
- Do not handle the plug or appliance with wet hands.
- Keep the cable away from heated surfaces.
- Do not let the cable hang over the edge of the table or countertop where it could be pulled on inadvertently by children or pets. Do not pull the cable around sharp edges or corners.
- Do not leave unattended when plugged in. Unplug from the outlet when not in use.
- Turn off all controls before unplugging.
- Do not unplug by pulling on the cable. To unplug, grasp the plug, not the cable.
- Always unplug before performing user maintenance, connecting or disconnecting attachments, or changing accessories.
- Ensure the cable is stored safely to prevent hazards.
- **RISK OF PERSONAL INJURY** Always locate your appliance away from the edge of the worktop, on a firm, flat, heat-resistant surface with sufficient space around all sides. Do not insert any objects into openings or cover the appliance.
- Do not place any cardboard, plastics or paper inside or on the appliance unless stated in the instructions.
- Do not use the appliance near any combustible surfaces. Only use suitable cookware where applicable.
- Do not use outdoors or near heat sources.

- Take care not to touch any surfaces that may get hot when in use. Take care not to touch any surfaces that may remain hot for a period of time after use.
- Do not overload/overfill the appliance.
- When using for the first time your appliance may give off a 'new' smell or vapour. This will dissipate after a few uses. Do not lift or move the appliance whilst in use.
- Do not operate continuously for periods longer than those marked on the product or indicated in the instructions.
- Ensure the appliance is switched off and unplugged before changing accessories or cleaning.
- Use only as described in this manual and with DOMIJ Brands' recommended attachments only.

CLEANING & MAINTENANCE

- Never soak or immerse electrical or heating components and or a component that has a plug attached.
- Hand washing is recommended; soak in warm soapy water and wipe down using a soft sponge. To remove stubborn stains, use a non-abrasive cleaning brush.
- Do not use abrasive, harsh cleaning solutions or metal scouring pads.
- Never wash any electrical or heating components and or a component that has a plug attached in a dishwasher.

TECHNICAL SPECIFICATION

- Rated Voltage 220-240V
- Rated Power 2000W
- Rated Frequency 50/60Hz

COMPONENT LIST

1. Ceramic Plate.
2. Indicator Lights.
3. Control Panel.
4. LED display.

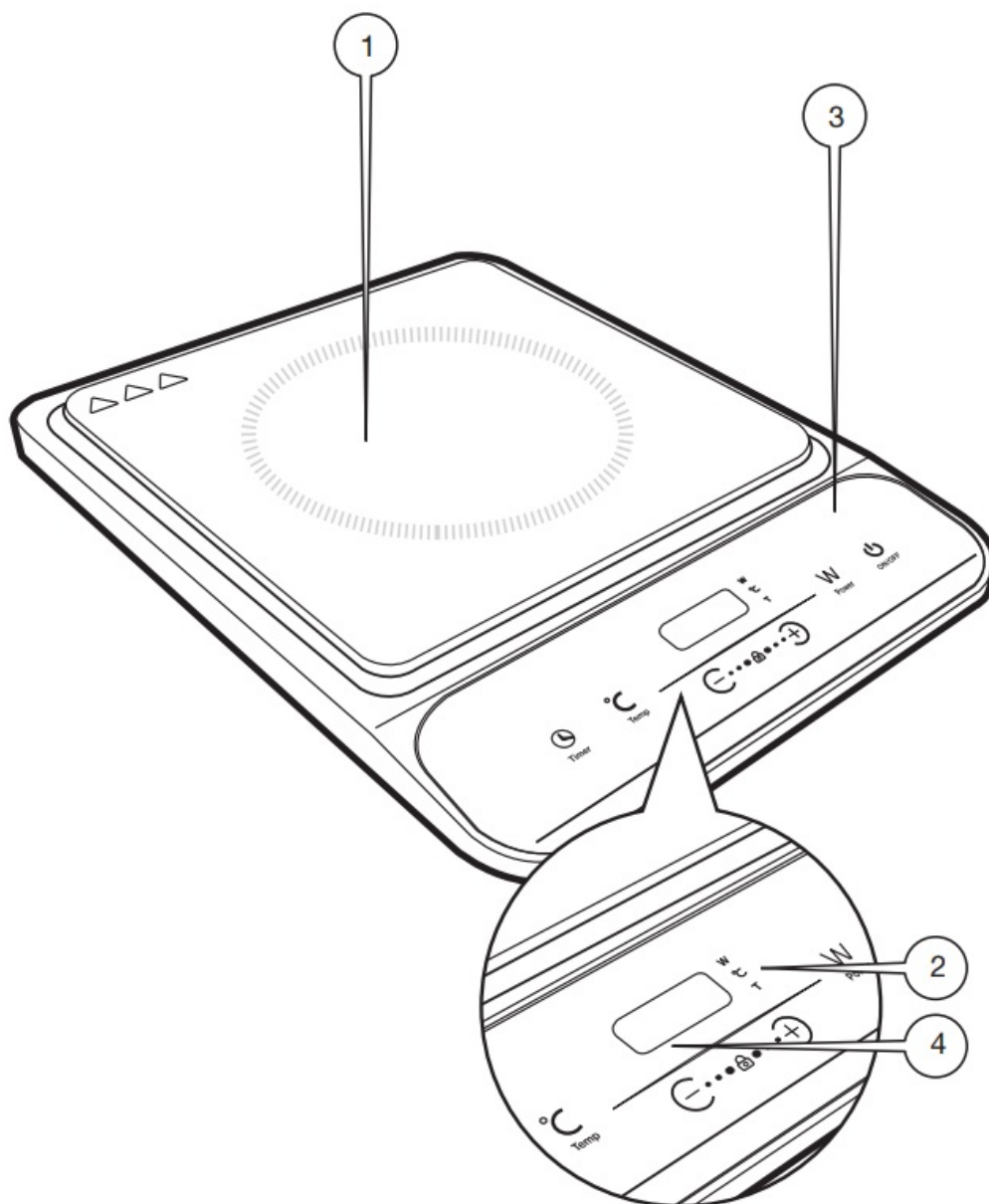

BEFORE FIRST USE

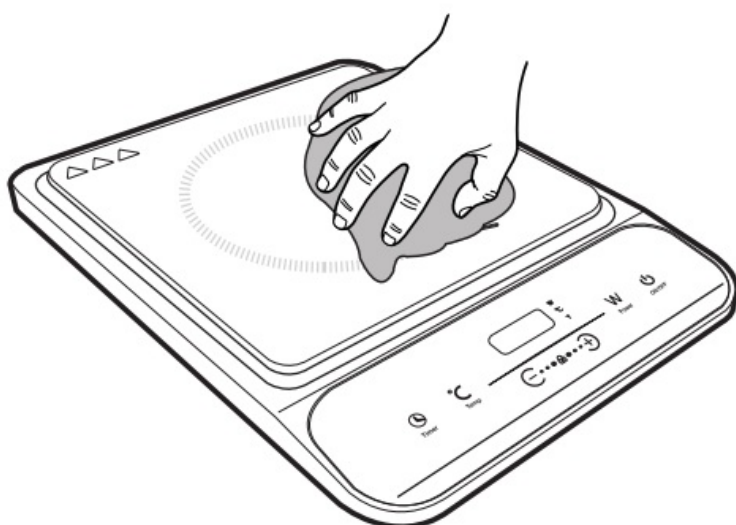

CAUTION Do not immerse in water.

IMPORTANT: You will need to make full contact with the touch screen sensors in order for all operations on the CONTROL PANEL to work. This may require you to make contact with the button itself and the sensory area surrounding it (it may be necessary to use your thumb rather than finger for better coverage).



OPERATION

1

Add cookware to centre first.
Ajoutez d'abord la batterie de cuisine.
Fügen Sie zuerst das Kochgeschirr hinzu.
Primero, agregue los utensilios de cocina.
Per prima cosa aggiungi le pentole.

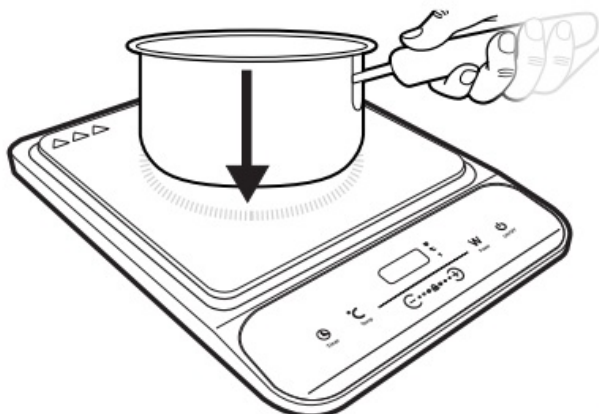

2



Press & Hold.
Appuyez et maintenez.
Gedrückt halten.
Presione "Hold".
Premere e tenere premuto.

3

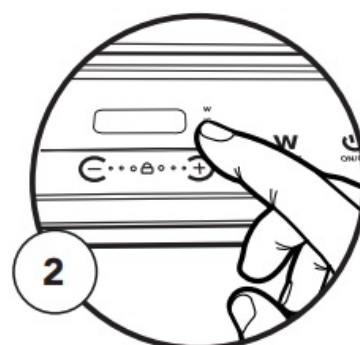
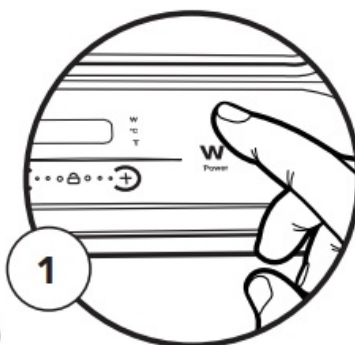

Increase or decrease power (fig 2)
Augmenter ou diminuer la puissance.
Leistung erhöhen oder verringern.
Aumentar o disminuir la potencia.
Aumentare o diminuire la potenza.

200W - 2000W
MAX

4

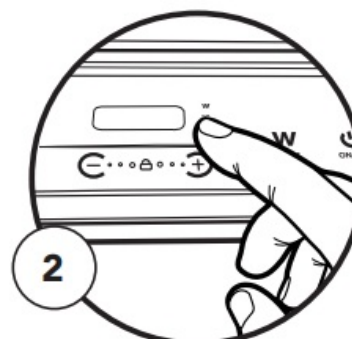
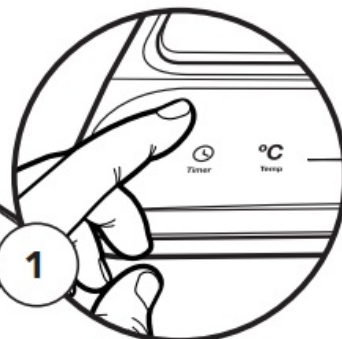
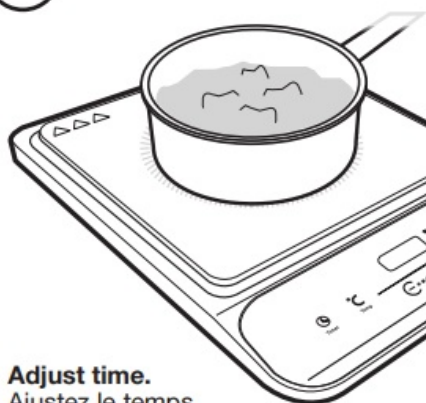

Adjust time.
Ajustez le temps.
Stellen Sie die Zeit ein.
Ajusta el tiempo.
Regola il tempo.



5

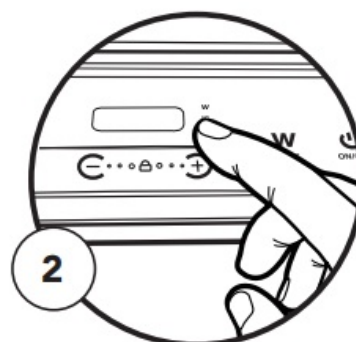
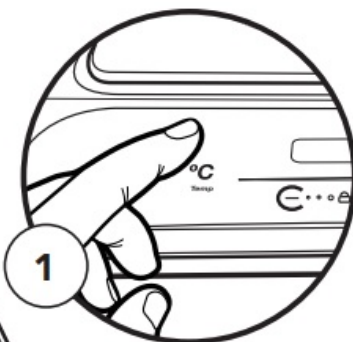

Increase or decrease temperature.
 Augmenter ou diminuer la température.
 Temperatur erhöhen oder senken.
 Aumentar o disminuir la temperatura.
 Aumentare o diminuire la temperatura.

60-
240°C

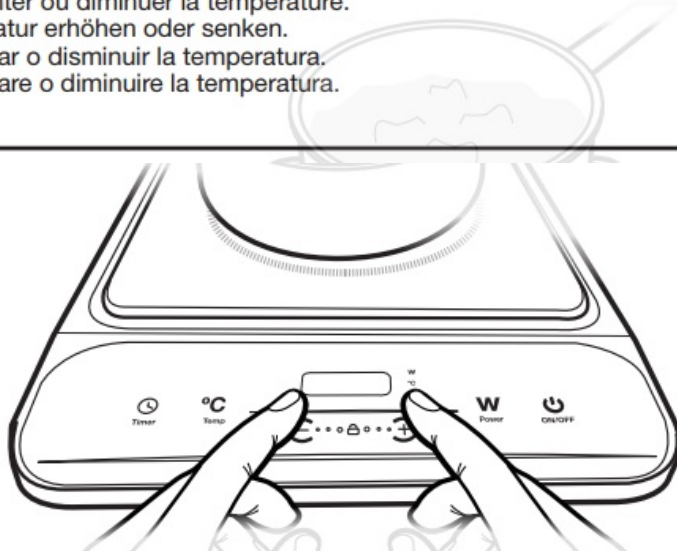

7



8

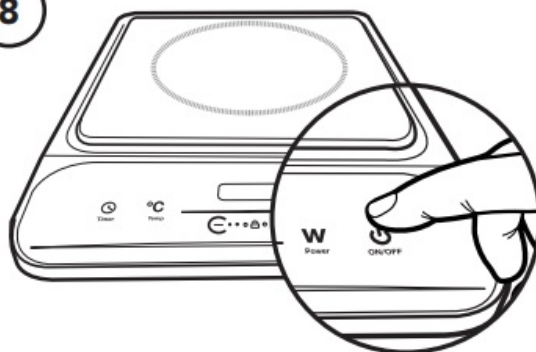

Switch off and allow to cool.
 Éteignez et laissez refroidir.
 Ausschalten und abkühlen lassen.
 Apagar y dejar enfriar.
 Spegner e lasciare raffreddare.

Tips

- Always position the appliance on a flat and stable surface with sufficient space around all sides.

- Ensure the area the appliance is positioned in is fully ventilated.
- IMPORTANT: Do not use pots or pans made from aluminium, copper aluminium alloy. Pans must have a smooth, flat base with a diameter of 12cm -26cm
- Ensure the pan has food inside before placing on the ceramic plate.
- Stir food from time to time to ensure food is cooked evenly.
- Metal utensils are not recommended since they can be heated through the induction hob if left in the pan during cooking
- Temperatures can be adjusted at any time during operation if required.
- Avoid touching any part of the appliance once in operation. The surfaces will get very hot. The use of an oven mitt is highly recommended.
- Once food is fully cooked and the appliance is switched off, allow the cooling fan to stop before disconnecting from the mains outlet.
- The fan takes a few minutes to stop.
- Allow the appliance to fully cool before cleaning.

NOTE: If the cookware is unsuitable for use, the Hob will show “E0” on the LED Display.

NOTE: If the wrong pan is used, the Hob will show “E0” on the LED display.

ERROR CODES

E0	<p>No pan in place or wrong size pan used. Pas de casserole en place ou de casserole de taille incorrecte. Keine Wanne an Ort und Stelle oder falsche Größe verwendet. No se usa una sartén en su lugar o una sartén de tamaño incorrecto. Nessuna padella sul posto o pad di dimensioni errate usato.</p>
E1	<p>Low voltage protection. Protection basse tension. Niederspannungsschutz. Protección de baja tensión. Protezione a bassa tensione.</p>
E2	<p>High voltage protection. Protection haute tension. Hochspannungsschutz. Protección de alta tensión. Protezione ad alta tensione.</p>
E3	<p>Pan has no water/contents. La casserole n'a pas d'eau / contenu. Pfanne hat kein Wasser / Inhalt. La cacerola no tiene agua / contenido. La padella non ha acqua / contenuto.</p>
E4	<p>Short Circuit. Court-circuit. Kurzschluss. Cortocircuito. Corto circuito.</p>
E5	<p>Ceramic plate has overheated - allow to cool completely. La plaque en céramique a surchauffé - laissez-le refroidir complètement. Keramikplatte ist überhitzt - vollständig abkühlen lassen. La placa de cerámica se ha sobrecalentado - deje que se enfríe completamente. La piastra di ceramica si è surriscaldata, lasciare raffreddare completamente.</p>
E6	<p>Component overheat - allow to cool sufficiently. Surchauffe des composants - laissez refroidir suffisamment. Komponentenüberhitzung - ausreichend abkühlen lassen. Componente de sobrecalentamiento - dejar enfriar lo suficiente. Surriscaldamento del componente - lasciare raffreddare sufficientemente.</p>

MAINTENANCE

CAUTION Do not immerse in water

Wipe with a damp cloth

DISPOSAL INFORMATION: Please recycle where facilities exist. Check with your local authority for recycling advice.

CUSTOMER SERVICE If you are having difficulty using this product and require support, please contact support@domu.co.uk

WARRANTY To register your product and find out if you qualify for a free extended warranty, please go to www.vonshef.com/warranty.

Please retain a proof of purchase receipt or statement as proof of the purchase date. The warranty only applies if the product is used solely in the manner indicated in the warnings page of this manual, and all other instructions have been followed accurately. Any abuse of the product or the manner in which it is used will invalidate the warranty. Returned goods will not be accepted unless re-packaged in its original packaging and accompanied by a relevant and completed returns form. This does not affect your statutory rights. No rights are given under this warranty to a person acquiring the appliance second-hand or for commercial or communal use.

COPYRIGHT All material in this instruction manual are copyrighted by DOMIJ Brands. Any unauthorised use may violate worldwide copyright, trademark, and other laws.

THANK YOU

Thank you for purchasing your product/appliance. Should you require assistance with your purchase, please contact us at support@domu.co.uk

VonHaus is a registered trademark of DOMU Brands Ltd.

Made in China for DOMU Brands Ltd.

Unit 30, Stakehill Industrial Estate, Middleton,
Manchester, M24 2RW

EU Authorised Representative

EU Authorised Representative Service

77 Camden Street Lower Dublin, D02 XE80 Ireland

FAQ

- **Q: Can I use pots or pans made from aluminium or copper?**
 - A: No, it is recommended to use cookware with a diameter of 12cm – 26cm that is not made from aluminium, copper, or aluminium alloy.
- **Q: How do I adjust the temperature settings during operation?**
 - A: You can adjust the temperature settings at any time during operation on the control panel.
- **Q: How should I handle the appliance when it's hot?**
 - A: Avoid touching any part of the appliance once in operation as the surfaces can

get very hot. It is recommended to use an ovenmitt for safety.

Documents / Resources

	VonShef 2000157 Single Induction Hob [pdf] Instruction Manual 2000157, A5P, 2000157 Single Induction Hob, Single Induction Hob, Induction Hob, Hob
---	---

References

- [User Manual](#)

2000157, 2000157 Single Induction Hob, A5P, Hob, Induction Hob, Single Induction Hob,

Vonshef Vonshef

Leave a comment

Your email address will not be published. Required fields are marked *

Comment *

Name

Email

Website

☐ Save my name, email, and website in this browser for the next time I comment.

Post Comment

Search:

e.g. whirlpool wrf535swhz

Search

[Manuals+](#) | [Upload](#) | [Deep Search](#) | [Privacy Policy](#) | [@manuals.plus](#) | [YouTube](#)

This website is an independent publication and is neither affiliated with nor endorsed by any of the trademark owners. The "Bluetooth®" word mark and logos are registered trademarks owned by Bluetooth SIG, Inc. The "Wi-Fi®" word mark and logos are registered trademarks owned by the Wi-Fi Alliance. Any use of these marks on this website does not imply any affiliation with or endorsement.