



Contents [[hide](#)]

- [1 VOLVO Load Carrier Rails](#)
- [2 Product Information](#)
- [3 Product Usage Instructions](#)
- [4 Installing a load carrier with a square profile](#)
- [5 Installing load carrier with T-track](#)
- [6 Installing load carrier with wing profile](#)
- [7 Removing load carriers](#)
- [8 Safety instructions](#)
- [9 FAQ](#)
- [10 Documents / Resources](#)
 - [10.1 References](#)

V O L V O

VOLVO Load Carrier Rails



Product Information

Specifications

- Product Name: Load Carrier Rails
- Profiles: Square, T-track, Wing
- Language: English (en-GB)
- Tightening Torque: 6 Nm
- Maximum Speed: 130 km/h / 80 mph

Product Usage Instructions

- Follow the specific instructions for T-track installation.
- Position the front load carrier approximately 200 mm in front of the center rail foot on XC90s without a load.
- Position the rear load carrier opposite the center and rear rail foot to minimize wind noise.
- Remove load carriers by detaching the mountings.
- Check that load carriers are secure by rocking them.
- Do not exceed the maximum permitted roof load and total weight of the car.

- Distribute the load evenly over the loading surface with a low center of gravity.
- Check the position and securement of the load regularly.
- Check screw joints and mountings after a short distance and tighten if necessary.
- Adapt driving speed to the vehicle's load, observing speed limits and traffic regulations.
- Remove load carriers when not in use for safety and energy efficiency.

The specifications, constructional data, and illustrations contained in this publication are not binding. We reserve the right to make alterations without prior notification.

Installing a load carrier with a square profile

- Place the load carriers loosely on the rails. Adjust the profile laterally so that it protrudes equal amounts on both sides.

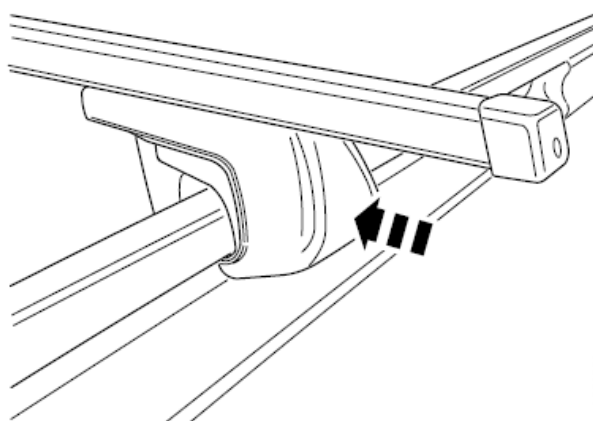

GD8C906

- When positioning and the protrusions are correct, push the mountings in and up.

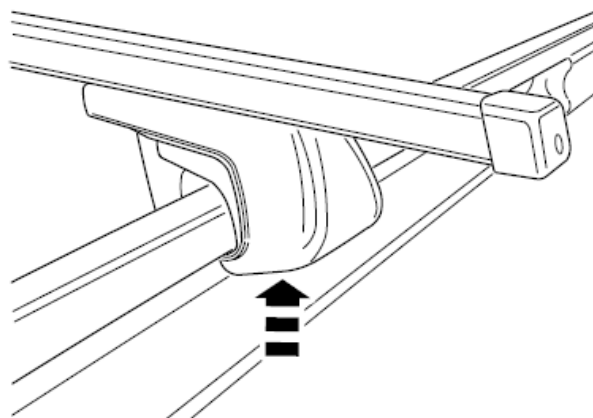

GD8C907

TIP

It is easiest to move the profile by pushing it away from you.

- Insert a torque wrench in the end of the load carrier and tighten until the mounting engages the rail.
- Do the same for the other mountings.
- Tighten the screws in the ends of the load carriers until the indicator on the handle is opposite the two markings. The correct tightening torque of 4 Nm has then been reached.

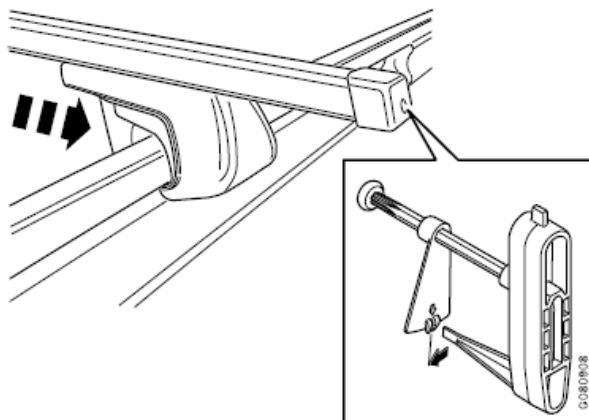

Installing load carrier with T-track

- For T-track load carriers the same installation procedure applies as for square profile load carriers, but with the exception that the end must be opened to access the mounting screw.

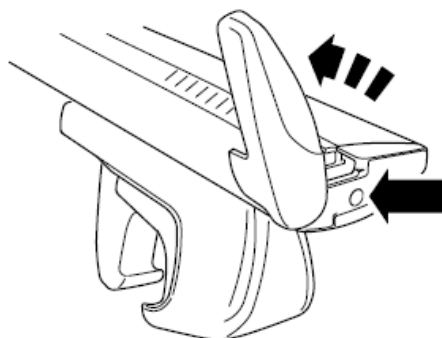

IMPORTANT

- Check that the load carriers are secure by rocking them.

Removing load carriers

- Insert a torque wrench in the end of the load carrier and slacken off the screws until the mountings detach.

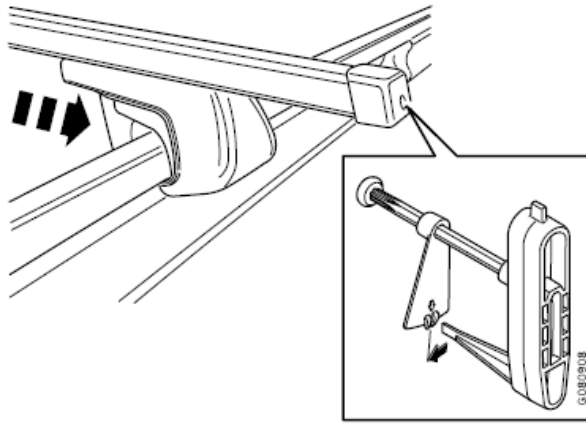

Installing load carrier with wing profile

- Make sure that the load carrier is positioned in the right direction on the rails. The load carriers can be positioned anywhere along the rails. The longer load carrier should be in the front.

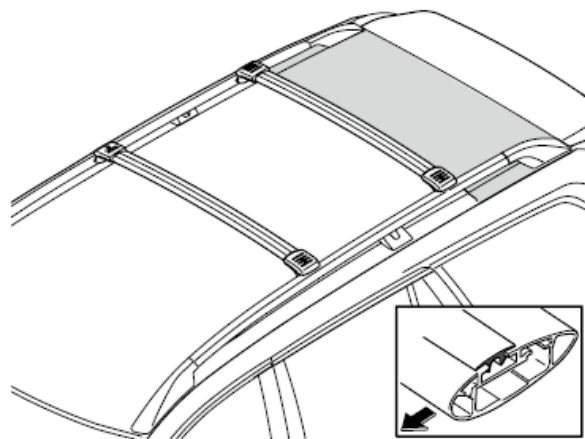

NOTE

On XC90s without load, the front load carrier should be positioned approximately 200 mm in front of the centre rail foot and rear load carrier opposite the centre and rear rail foot to minimise wind noise.

- Use the lug on the torque wrench or the car's ignition key to detach and secure the cover. Turn a 1/4 of a turn.

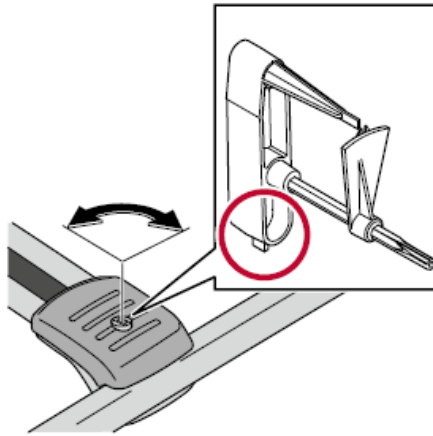

- Press in the end (A) of the load carrier and slide it carefully into position (B) so as not to scratch the rails.
- Ensure that the load carrier is straight above the car.
- Check that the load carrier extends properly along the rails.

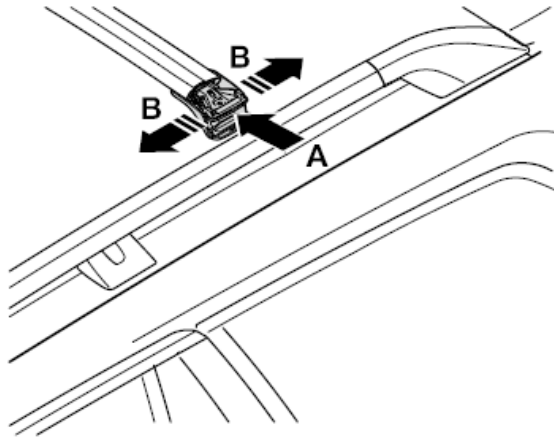

Removing load carriers

- Screw the load carrier into place.
- Tighten the screws until the indicator on the handle is opposite the two markings.
- Then the correct tightening torque of 6 Nm has been reached.

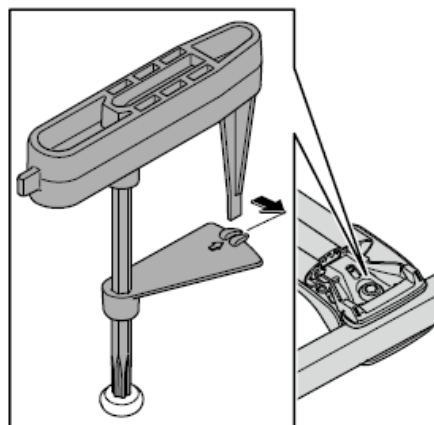

- Use the lug on the torque wrench or the car's ignition key to detach and secure the cover. Turn a 1/4 of a turn.
- Slacken off all screws.
- Press in the end (A) of the load carrier.
- Lift the load carriers up and out from the rails.

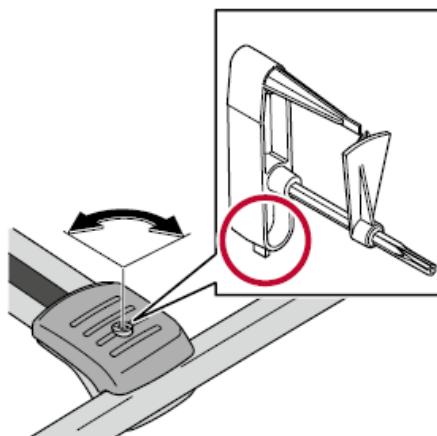

IMPORTANT

Check that the load carriers are secure by rocking them.

Safety instructions

NOTE

- Under no circumstances must the maximum permitted roof load and total weight of the car be exceeded (see the car's owner's manual).
- The maximum permitted roof load is based on the total of the load carriers' weight, accessories, and load.

NOTE

- Distribute the load evenly over the loading surface, with as low a centre of gravity as possible, and secure it so that it cannot come loose.

NOTE

- Check the position and securement of the load at regular intervals.

NOTE

- Check the screw joints and mountings after a short distance. If necessary, tighten to the torque prescribed. Check at regular intervals.

NOTE

- The driving characteristics and the vehicle's sensitivity to side winds are changed by loads on the roof. Adapt the speed to the vehicle's load (max. 130 km/h/80 mph).
- The applicable speed limits and other traffic regulations must always be observed.

NOTE

- For the safety of other road users and to save energy, the load carriers should be removed when not in use.

31373414 2012-04. © Copyright – Volvo Car Corporation

FAQ

- **What is the tightening torque for the load carriers?**
 - The correct tightening torque for the load carriers is 6 Nm.
- **How should I position the front and rear load carriers on XC90s without load?**
 - The front load carrier should be positioned approximately 200 mm in front of the center rail foot, and the rear load carrier should be opposite the center and rear rail foot to minimize wind noise.

Documents / Resources

	VOLVO Load Carrier Rails [pdf] Installation Guide Load Carrier Rails, Carrier Rails, Rails
---	---

References

- [User Manual](#)

Leave a comment

Your email address will not be published. Required fields are marked *

Comment *

Name

Email

Website

☐ Save my name, email, and website in this browser for the next time I comment.

Post Comment

Search:

e.g. whirlpool wrf535swhz

Search

[Manuals+](#) | [Upload](#) | [Deep Search](#) | [Privacy Policy](#) | [@manuals.plus](#) | [YouTube](#)

This website is an independent publication and is neither affiliated with nor endorsed by any of the trademark owners. The "Bluetooth®" word mark and logos are registered trademarks owned by Bluetooth SIG, Inc. The "Wi-Fi®" word mark and logos are registered trademarks owned by the Wi-Fi Alliance. Any use of these marks on this website does not imply any affiliation with or endorsement.