



VOLA NR.21 Chrome Flow Control Handle



# VOLA NR.21 Chrome Flow Control Handle Installation Guide

[Home](#) » [vola](#) » VOLA NR.21 Chrome Flow Control Handle Installation Guide 

## Contents

- [1 VOLA NR.21 Chrome Flow Control Handle](#)
- [2 Product Information](#)
- [3 Product Usage Instructions](#)
- [4 Installation](#)
- [5 Operation](#)
- [6 Maintenance](#)
- [7 Frequently Asked Questions \(FAQ\)](#)
- [8 Documents / Resources](#)
  - [8.1 References](#)
- [9 Related Posts](#)



**VOLA NR.21 Chrome Flow Control Handle**



## Product Information

### Specifications

- Model: VOLA NR.21/28/19/24
- Compatible with: VR2260/VR1400/VR2019
- Tile Thickness Range: 3 – 65 mm

### Product Usage Instructions

Do not cut the membrane

### Installation

1. Ensure the surface is clean and dry.
2. Select the appropriate tile thickness setting based on the range provided.
3. Adjust the product to the desired thickness level for your tiles.
4. Securely install the product according to the manufacturer's instructions.

### Extension

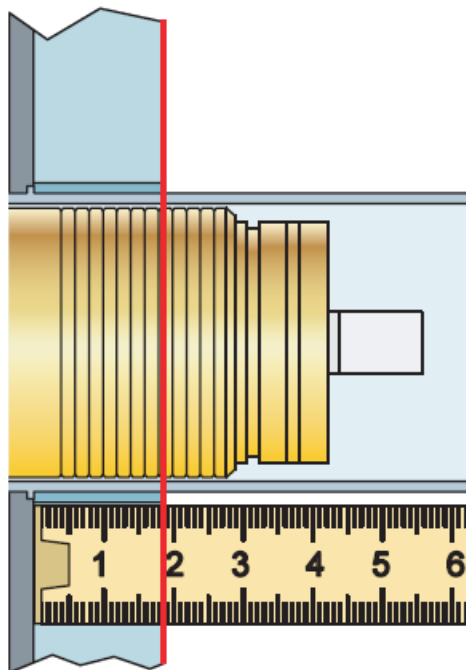

VR2260/VR1400/VR2019

Tiles:

3 – 15 mm

Std.

15 – 25 mm

+10

25 – 35 mm

+20

35 – 45 mm

+30

45 – 55 mm

+40

55 – 65 mm

+50

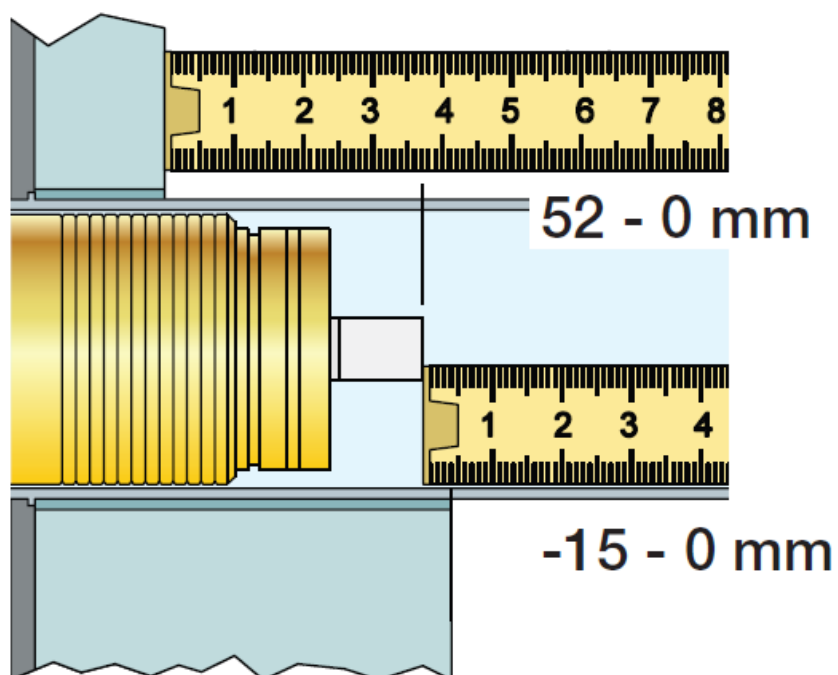

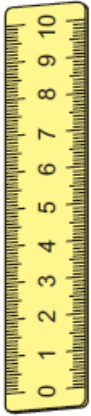
VR2260/VR1400/VR2019		
	35 – 47 mm	Std.
	25 – 35 mm	+10
	15 – 25 mm	+20
	5 – 15 mm	+30
	-5 – 5 mm	+40
	-15 – -5 mm	+50

NR 21

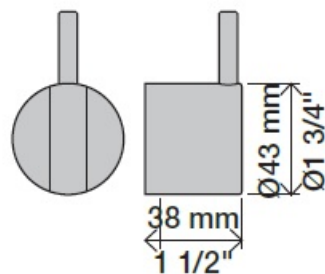

NR 21 - 1

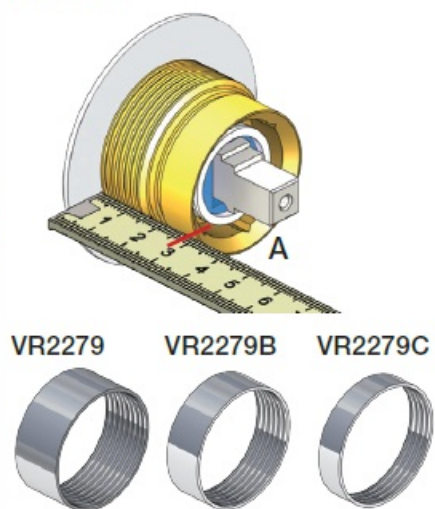

		A
VR2279	16 mm	30 – 34 mm
VR2279B	12 mm	26 – 30 mm
VR2279C	8 mm	22 – 26 mm

## Operation

To operate the product:

1. Insert the tiles into the designated area.
2. Use the product adjustment features to align the tiles correctly.
3. Ensure proper positioning before finalizing the installation.

NR 21 - 2

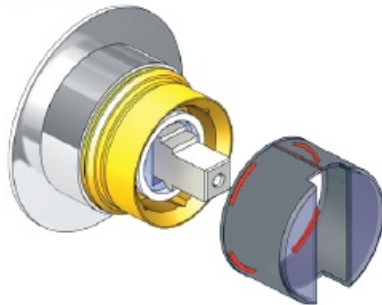

NR 21 - 3

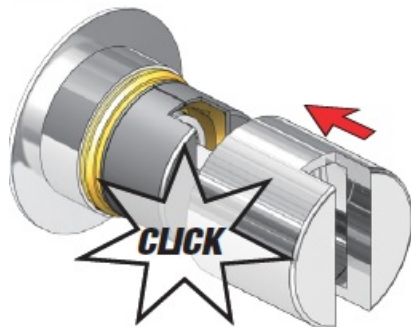

NR 21 - 4

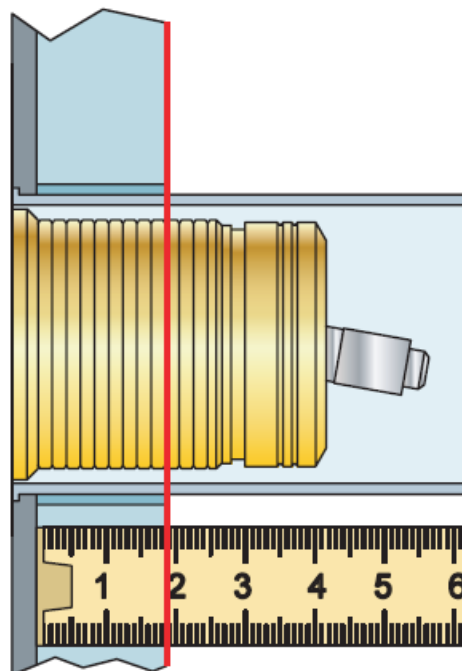
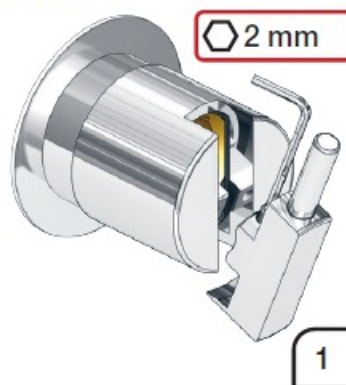

VR1260/VR1400/VR2019		
Tiles:	3 – 15 mm	Std.
	15 – 25 mm	+10
	25 – 35 mm	+20
	35 – 45 mm	+30
	45 – 55 mm	+40
	55 – 65 mm	+50

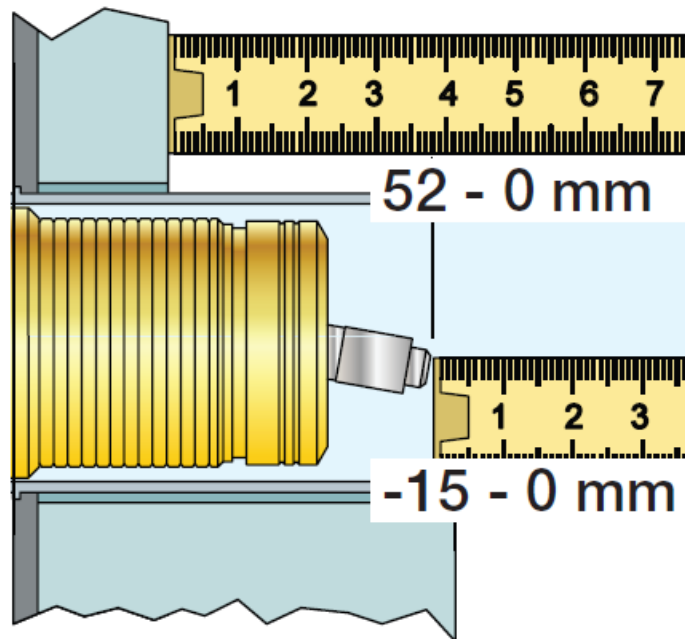

VR1260/VR1400/VR2019

- 40 – 52 mm Std.
- 30 – 40 mm +10
- 20 – 30 mm +20
- 10 – 20 mm +30
- 0 – 10 mm +40
- -10 – 0 mm +50

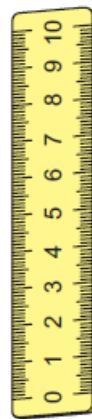

NR 19/NR24

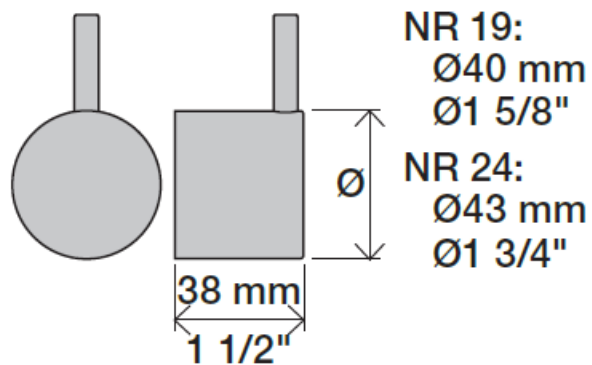

NR 28

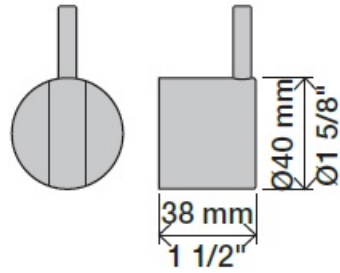

NR 28 - 1

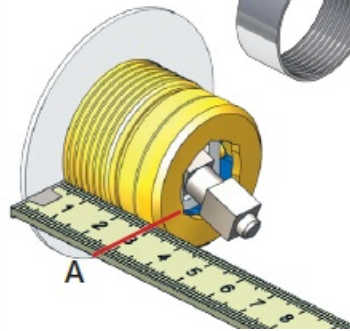

VR3279



VR3279B



VR3279C



		A
VR3279	16 mm	31 – 36 mm
VR3279B	12 mm	27 – 32 mm
VR3279C	8 mm	23 – 28 mm

## Maintenance

Regular maintenance is essential for product longevity.

- Clean the product with a mild detergent and water solution.
- Avoid using abrasive cleaners that may damage the surface.
- Inspect the product periodically for any signs of wear or damage.

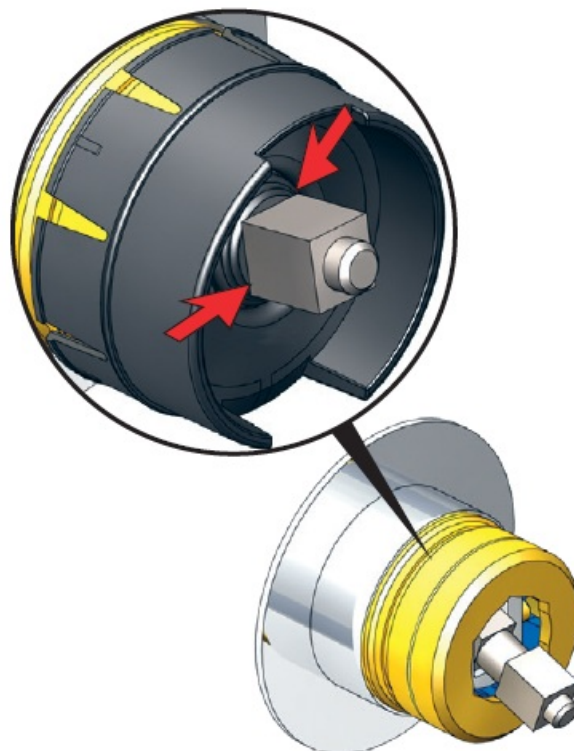

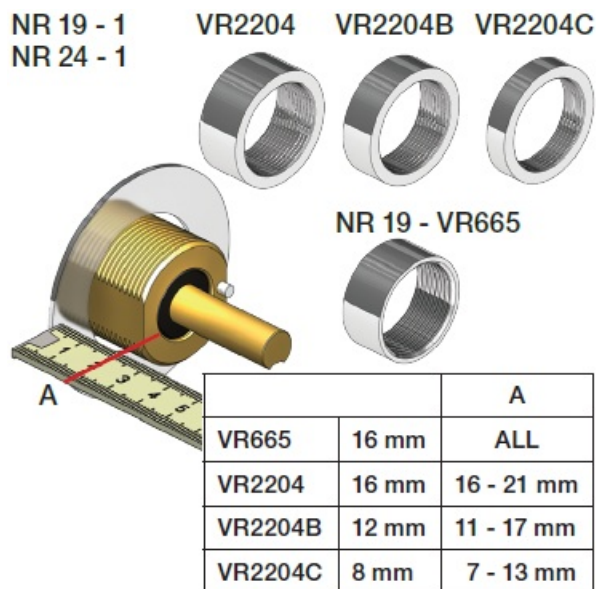

NR 28 - 3

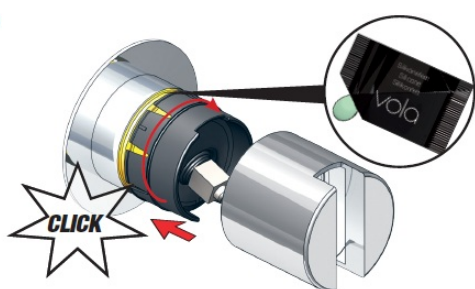

NR 28 - 4

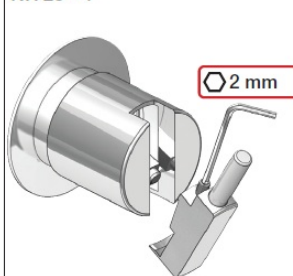

NR 19 - 2  
NR 24 - 2

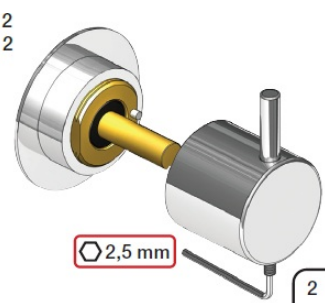

## Frequently Asked Questions (FAQ)

- **Q: How do I adjust the tile thickness setting?**
  - A: To adjust the tile thickness setting, use the provided controls on the product to select the appropriate range for your tiles.
- **Q: Can this product be used for different tile sizes?**
  - A: Yes, this product is designed to accommodate various tile thicknesses within the specified range for optimal versatility.
- **Q: What is the recommended maintenance schedule for this product?**
  - A: It is recommended to clean the product regularly and inspect it periodically to ensure proper functionality and durability.

## Documents / Resources

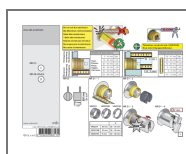

[VOLA NR.21 Chrome Flow Control Handle](#) [pdf] Installation Guide  
NR.21, NR.21 Chrome Flow Control Handle, Chrome Flow Control Handle, Flow Control Handle, Control Handle, Handle

## References

- [Vola Taps and accessories in timeless Scandinavian design | VOLA](#)



- [User Manual](#)

[Manuals+](#), [Privacy Policy](#)

This website is an independent publication and is neither affiliated with nor endorsed by any of the trademark owners. The "Bluetooth®" word mark and logos are registered trademarks owned by Bluetooth SIG, Inc. The "Wi-Fi®" word mark and logos are registered trademarks owned by the Wi-Fi Alliance. Any use of these marks on this website does not imply any affiliation with or endorsement.