



# VIZULO STRAW LED Linear luminaire 220 Instructions

[Home](#) » [VIZULO](#) » VIZULO STRAW LED Linear luminaire 220 Instructions 

# vizULO

STRAW LED Linear luminaire 220  
Instructions

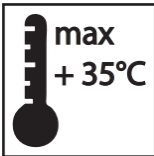
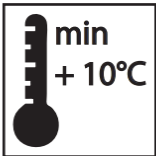
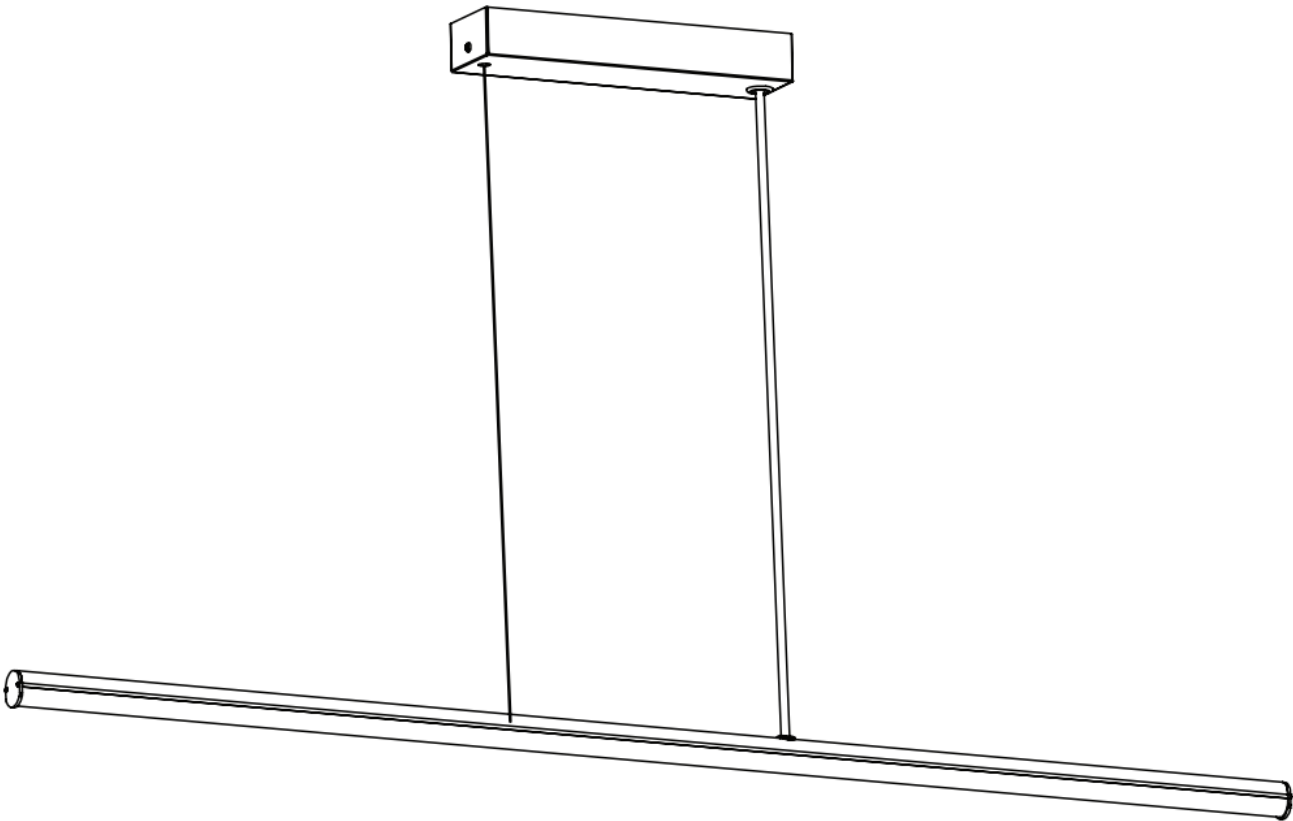

## Contents

- [1 STRAW LED Linear luminaire 220](#)
- [2 Dimensions](#)
- [3 Mounting](#)
- [4 Indoor Luminaire cleaning](#)
- [5 Cleaning and drying](#)
- [6 Terms of use and maintenance](#)
- [7 Safety instructions](#)
- [8 Maintenance and repair](#)
- [9 Documents / Resources](#)
- [10 Related Posts](#)

## STRAW LED Linear luminaire 220

### VIZULO STRAW LED Linear luminaire Mounting instruction

\* Depends on configuration. Check label or technical specification.

### Dimensions

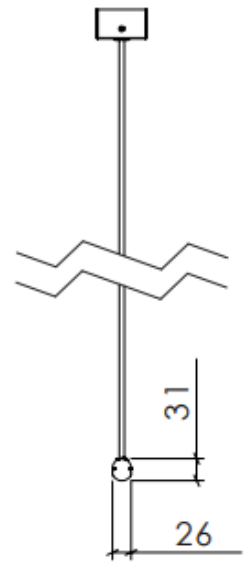
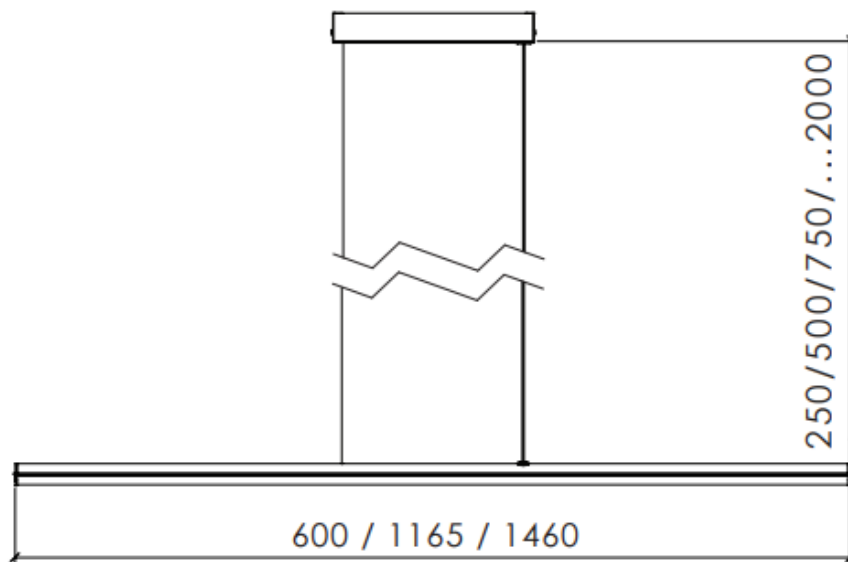

### Driver box

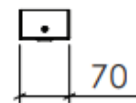
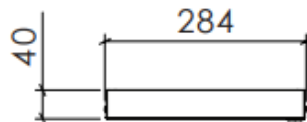

Neto Svārs  
Netto Bērs  
Netto Weight

SWP □□□ □□□ □□□□□ □□□□ □□ □□□ □□□

0.96 kg

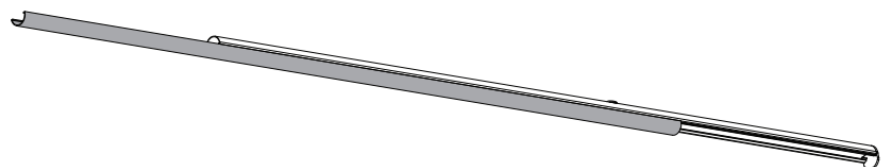

### Install prism only in a clean room using gloves!

Prism cover may accumulate small electrostatic charges that makes it susceptible to dust and other small particles; It should only be cleaned using dry microfiber cloth or compressed air duster.

Remove all protective film before installing the prism!

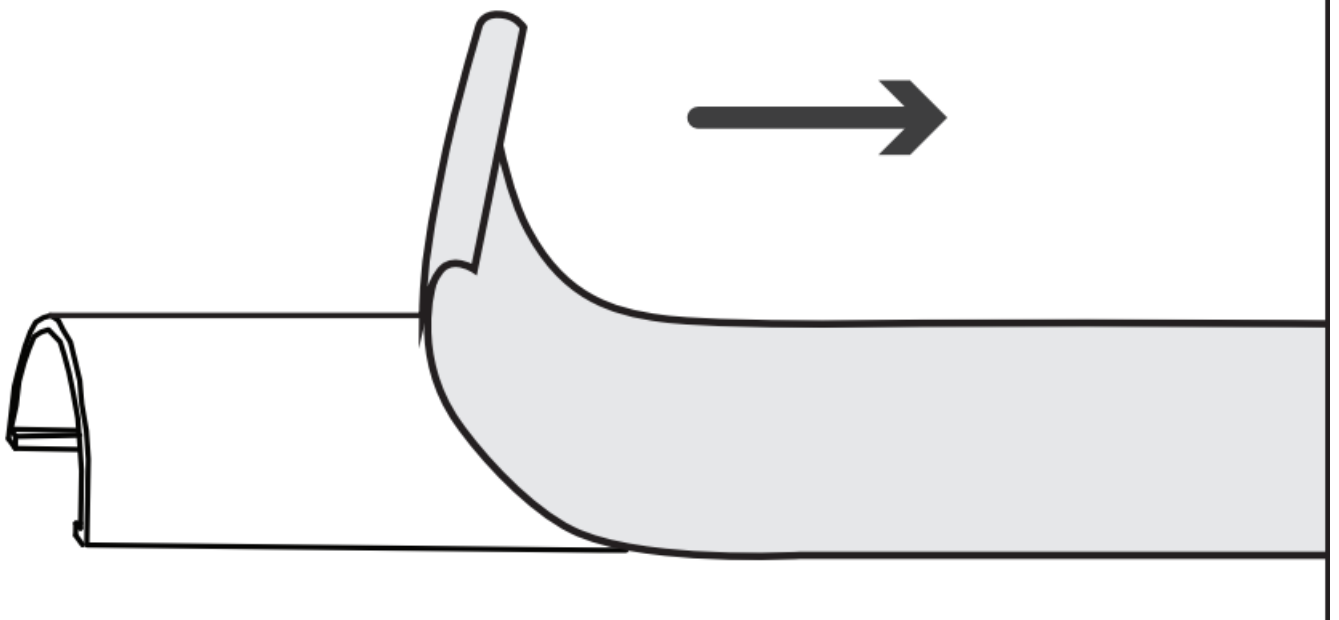

## Mounting

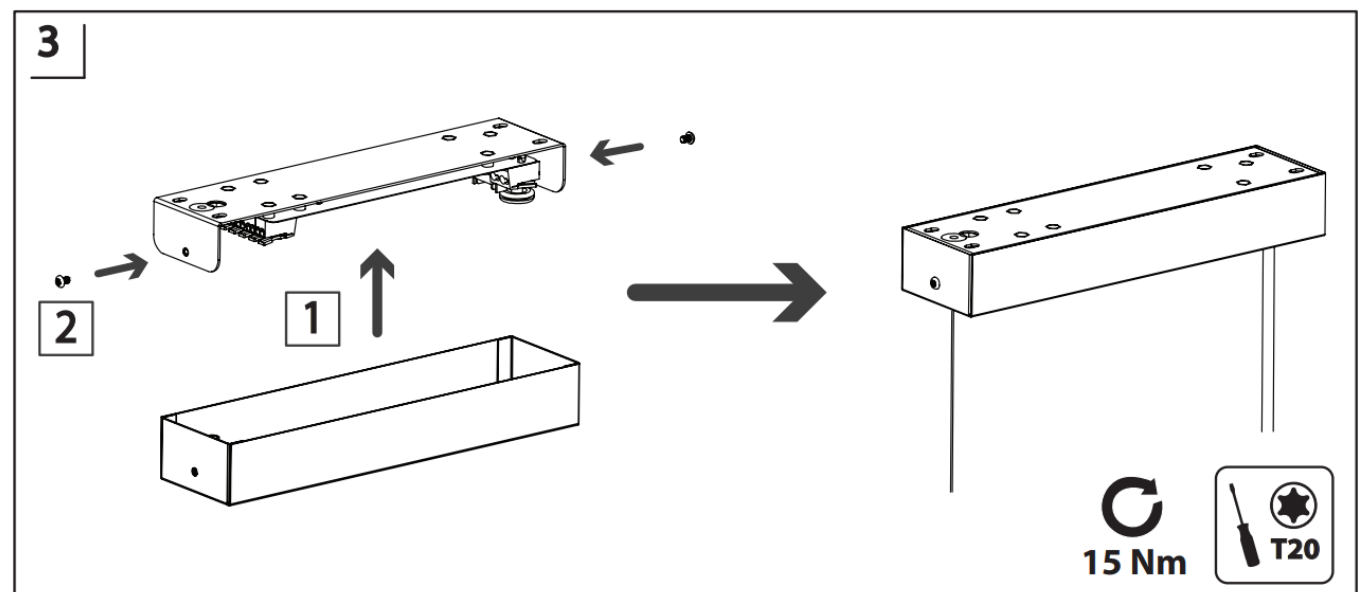
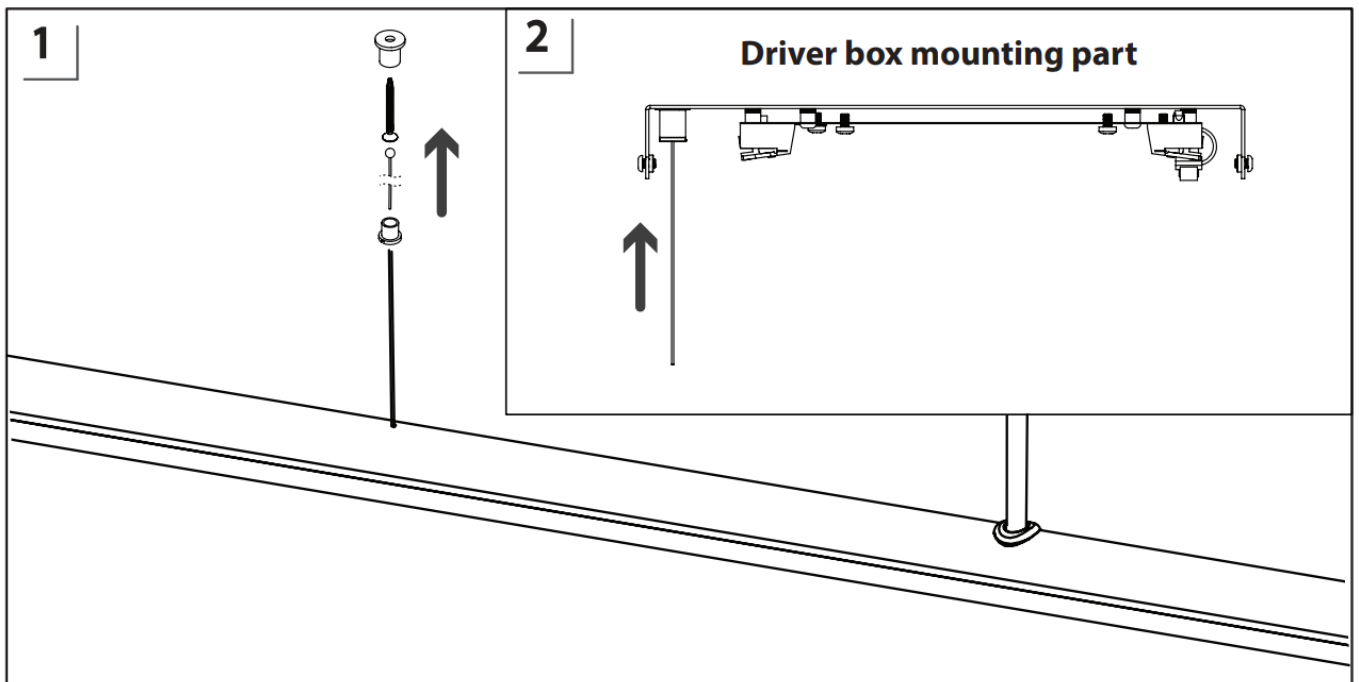

## Mounting dimensions

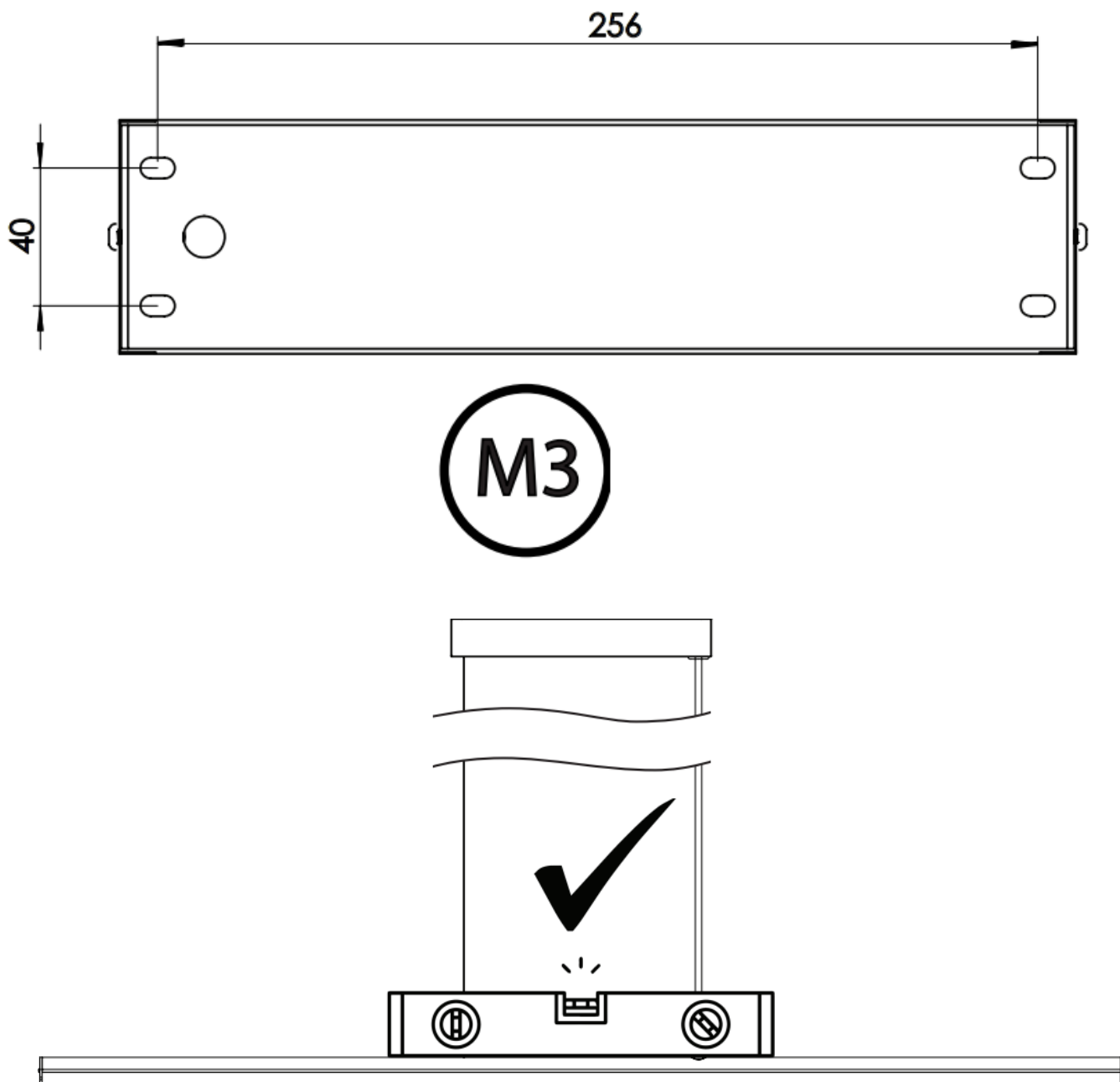

Use level to chek if the luminaire is parallel to the ground!

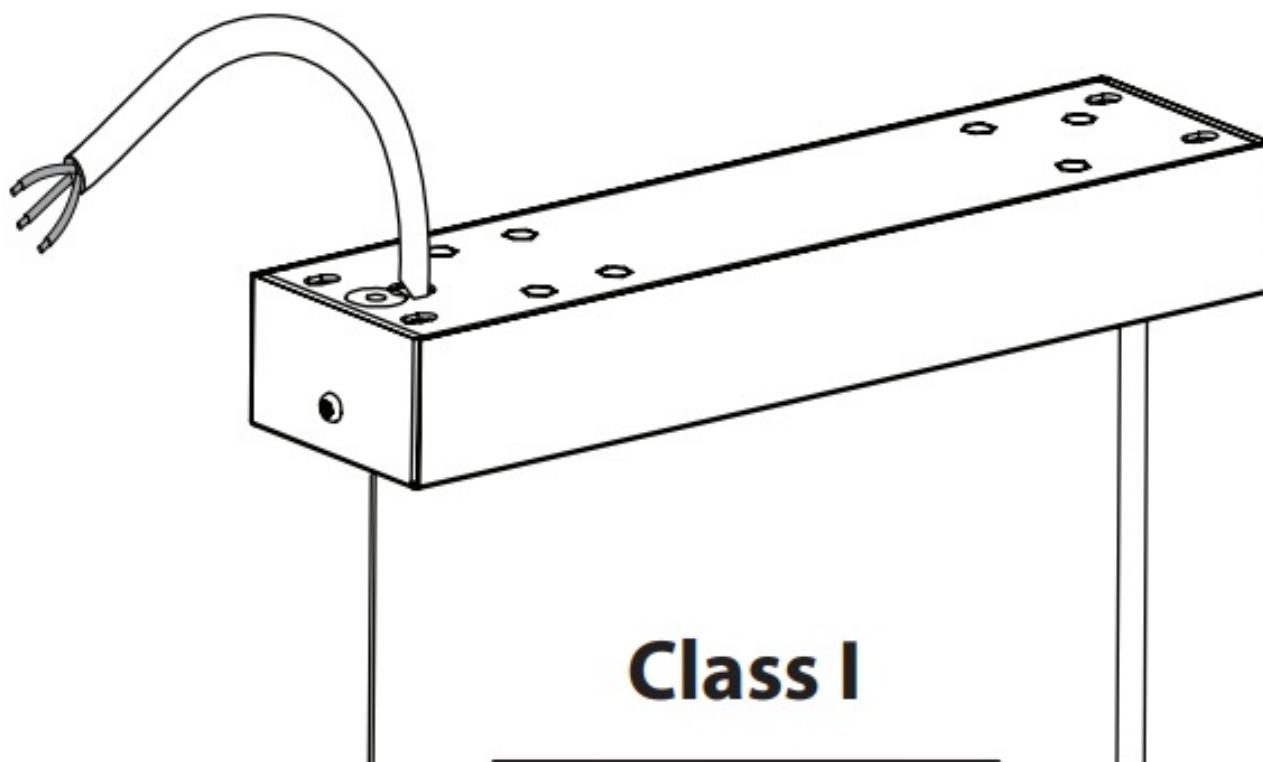

## Class I

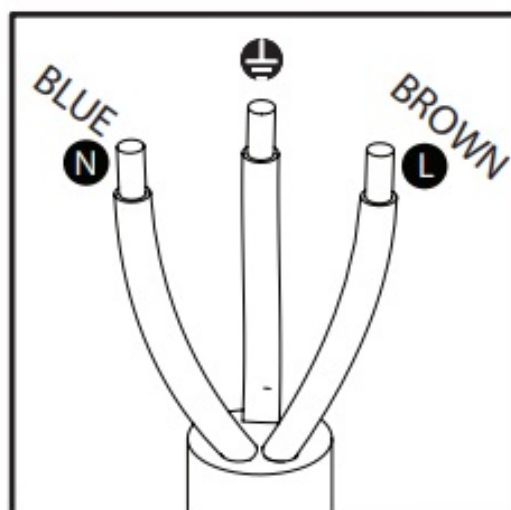

Remove all protective film before installing the diffusor!

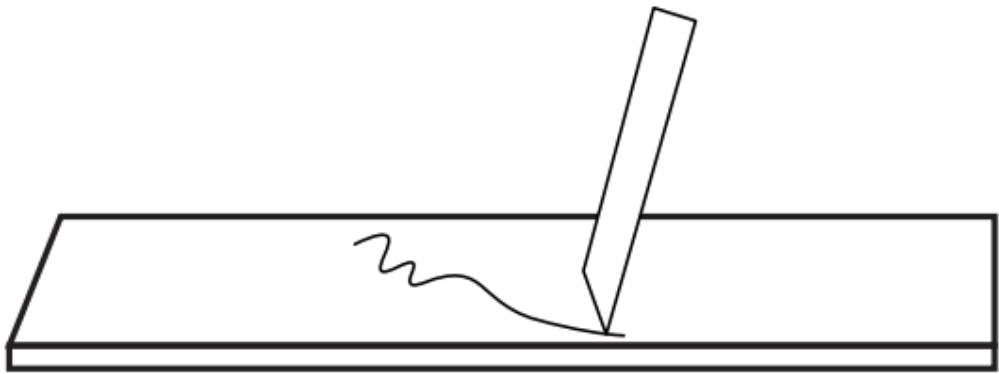

**WARNING!**

- Do not touch LED modules!
- Do not put any tools or other items on LED modules!
- In case any LED is physically damaged (example shown below) the warranty is void.

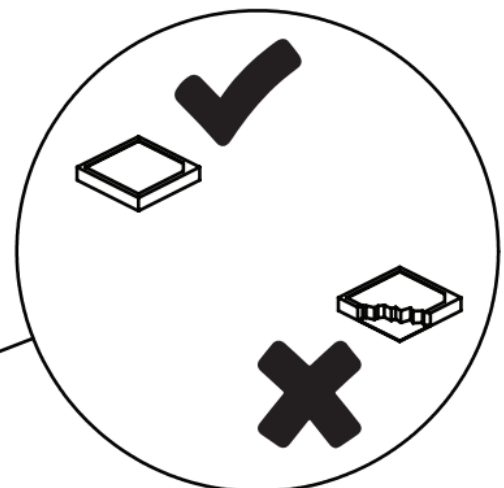
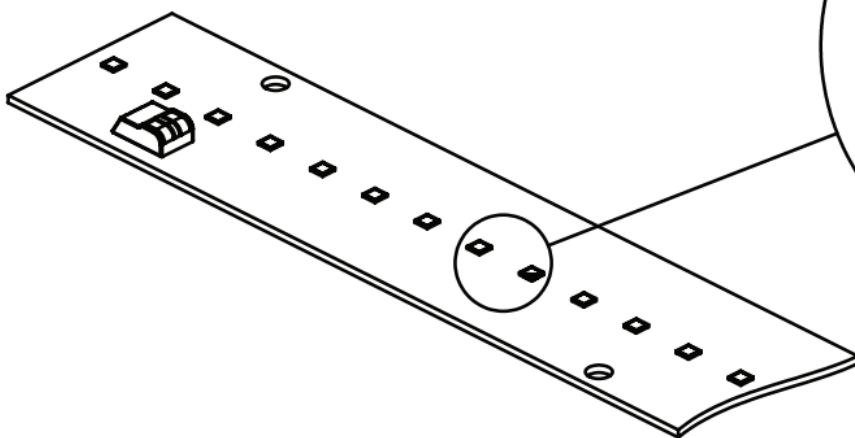
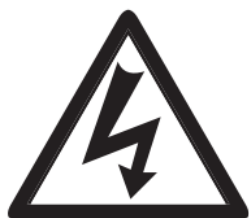

**Energy efficiency class of contained light source(s)**



		CRI	
		80	90
CCT	2200	E	F
	2700	E	F
	3000	E	E
	4000	E	E
	5000	E	E
	5700	E	E
	6500	E	E

## Indoor Luminaire cleaning

### Possible cleaning equipment

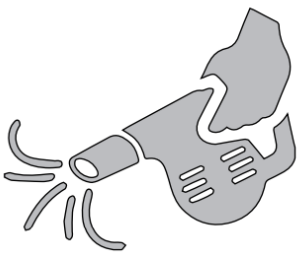

**It is important** to clean luminaires in association with luminaire mounting or component changing. Reflective parts surfaces should be cleaned from dust and grime pollution.

**It is also important** to remember that the voltage should be disconnected before the cleaning process is initiated. Electrical components and cables must not be exposed to water or detergents.

**Information about luminaire's components disassembling can be found in user's instructions**

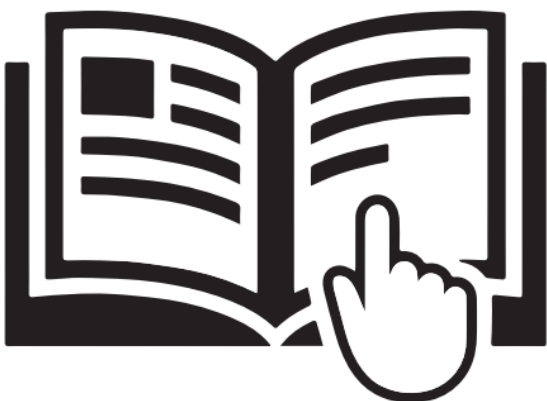

**Mounting Instruction**



**Component  
replacement  
instruction**



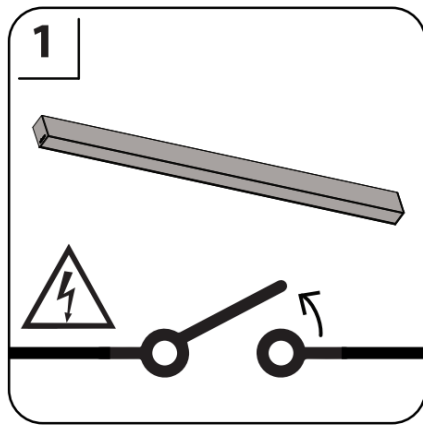

Switch off power supply.

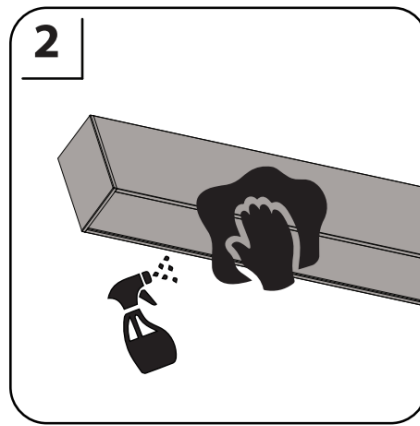

Wash and wipe the outside part.

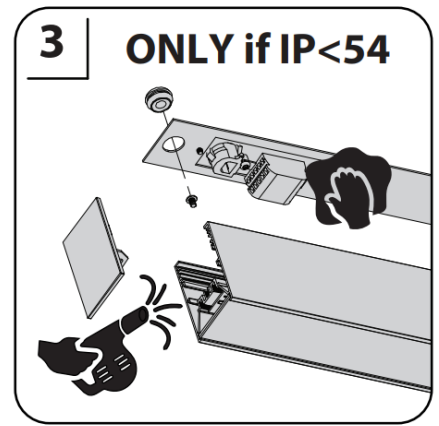

Clean the inside of luminaire.

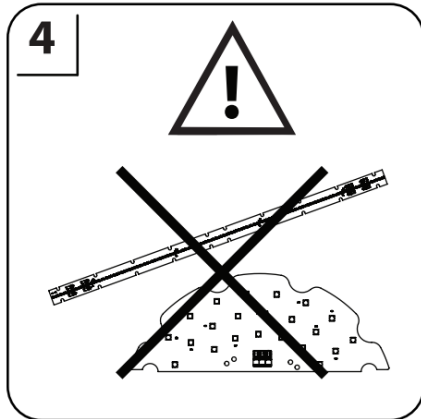

Do not touch or wet LED modules.

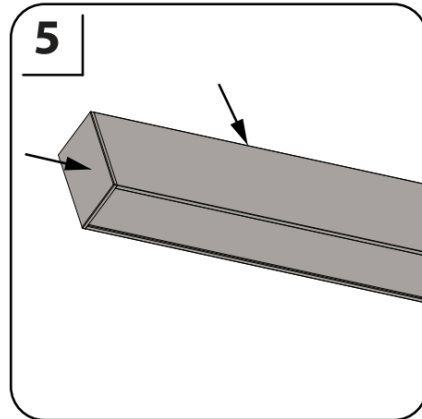

Close the luminaire tightly.

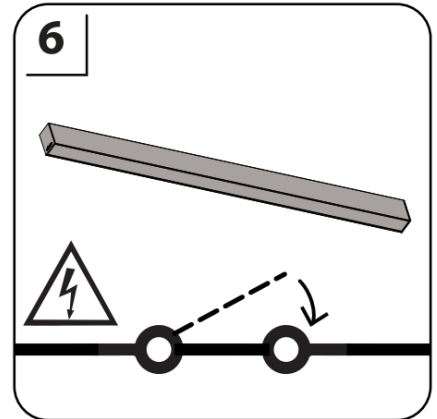

Make function test.

## Cleaning and drying

### Luminaire body

Vacuuming with a soft brush. Neutral dishwashing detergent with lukewarm water / Cleaning detergent, without grinding effects, in lukewarm water. Drying: Self-drying in room temperature or wipe off with a slightly damp cleaning cloth.

### Reflector and diffuser cover

In case of loose dirt clean with soft duster or cleaning cloth without microfibers, or use a compressed air. For light soiling dilute a citric acid based cleaning product with water (e.g. 30 ml Frosch® citrus cleaner in 5 litre of water). Cleaner should be non-abrasive, pH neutral, alcohol-free. In case of heavy soiling: Oil and grease can be removed using a mixture of alcohol and water (1:1), e.g. methylated spirits. Residues of alcohol based cleaning products are easily wiped away with a water-soaked cotton cloth. Stubborn stains can be soaked in diluted citrus cleaner. Drying: Blow-off with compressed air or use a lint-free, fresh and clean cotton cloth.

### Plastic covers and caps

Vacuuming with soft brush or compressed air. In case of heavy soiling: cleaning detergent, without grinding effects, in warm water, maximum 55 degrees Celcius. Wash with a soft, clean cloth (without microfibers) in plenty of water. Rins with lukewarm water. Drying: Self-drying in room temperature or wipe off with a slightly damp cleaning cloth (without microfibers).

## Terms of use and maintenance

Before luminaire is turned on, it should be mounted according with this mounting instruction or any other applicable regulations.

### Mounting instructions

Mounting of luminaire must be performed by a qualified person according with following instructions:

- The warranty of luminaire does not apply, if the mounting of luminaire has been performed in precipitation (rain, snow, hail).

- The warranty of luminaire does not apply, if a control system unauthorized by VIZULO or an inapplicable LED driver has been used to drive the luminaire.
- The warranty of luminaire does not apply, if it has been used in an unsuitable ambient temperature or has been supplied by voltage outside of the specified range.
- The warranty of luminaire does not apply, if the LED driver program has been changed in any way.
- The warranty of the luminaire does not apply, if the logged history data of the LED driver has been deleted without the permission of VIZULO.
- The warranty of luminaire does not apply, if it has been mounted in unspecified angles or upside down (luminaire glass directed up), or it has been completely submerged under water.

## **Safety instructions**

Any actions with the luminaire must be performed by a qualified person, who is certified according with national regulations and requirements.

To prevent any accidents person installing the luminaire must follow national safety requirements and following instructions:

- The label containing technical parameters of the luminaire has to be studied before the work on it has begun.
- Any luminaire build or design changes are prohibited.
- The luminaire must be used in good technical condition and according with this instruction.
- Only VIZULO authorized spare parts and accessories can be used to repair the luminaire.
- The repair of luminaire has to be performed by a qualified and certified person.

## **Maintenance and repair**

Luminaire has to be disconnected from electrical grid before it is opened and/or repaired!

- The person working with the luminaire must follow national regulations and legislations that apply to maintenance and testing of electrical or electronic appliances.
- The luminaire may need to be cleaned depending on its environment. Only a damp cloth or a sponge may be used to clean the luminaire. Use only household detergents diluted by water.
- Only VIZULO authorized spare parts may be used for the luminaire.
- Instruction for changing spare parts must be requested from VIZULO and studied before the repair is attempted.
- LED modules, lens and LED drivers can be changed on an installed luminaire, but it is advised to perform this task indoor to avoid water entering the luminaire.
- Spare parts (lens, LED modules and drivers) should be ordered from the information available on the luminaire label.

# **vizULO**

25-04-2022

SIA VIZULO

Laucu Lejas, Iecava, Latvia, LV-3913

Documents / Resources

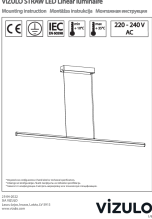
 <p>VIZULO STRAW LED Linear luminaire 220 Mounting instructions - Montážní návod - Montagem manual - Montageanleitung</p> <p>CE IEC 220-240V AC</p> <p>vizulo</p>	<p><a href="#">VIZULO STRAW LED Linear luminaire 220</a> [pdf] Instructions</p> <p>STRAW LED Linear luminaire 220, STRAW, LED Linear luminaire 220, Linear luminaire 220, lu minaire 220</p>
--	--