



# vizulo Pine Connect LED Linear Luminaire Modular System Instruction Manual

[Home](#) » [VIZULO](#) » vizulo Pine Connect LED Linear Luminaire Modular System Instruction Manual 

## Contents

- [1 vizulo Pine Connect LED Linear Luminaire Modular System](#)
- [2 Dimensions](#)
- [3 Module mounting](#)
- [4 Terms of use and maintenance](#)
- [5 Mounting instructions](#)
- [6 Safety instructions](#)
- [7 Documents / Resources](#)
- [8 Related Posts](#)

# vizulo

## vizulo Pine Connect LED Linear Luminaire Modular System



## Dimensions

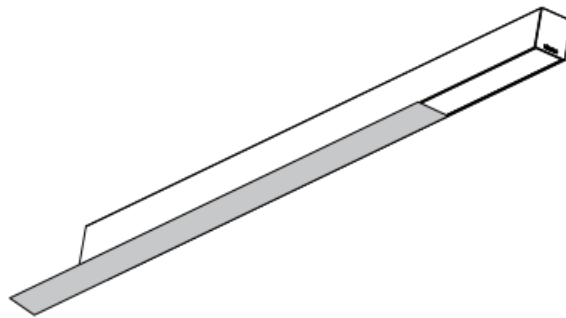
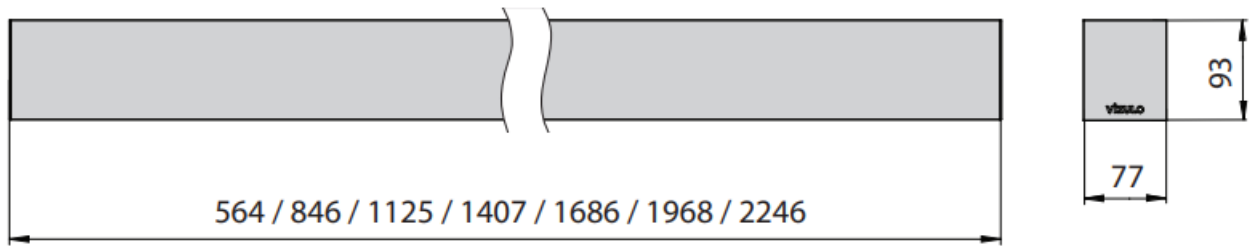

### **Install diffuser only in a clean room using gloves!**

Diffuser cover may accumulate small electrostatic charges that make it susceptible to dust and other small particles; It should only be cleaned using dry microfiber cloth or a compressed air duster.

### **Remove all protective film before installing the diffuser!**

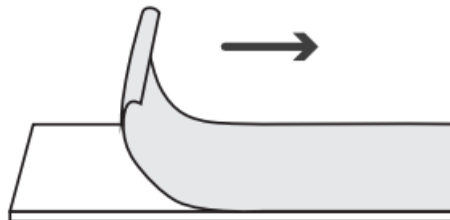

### **Module mounting**

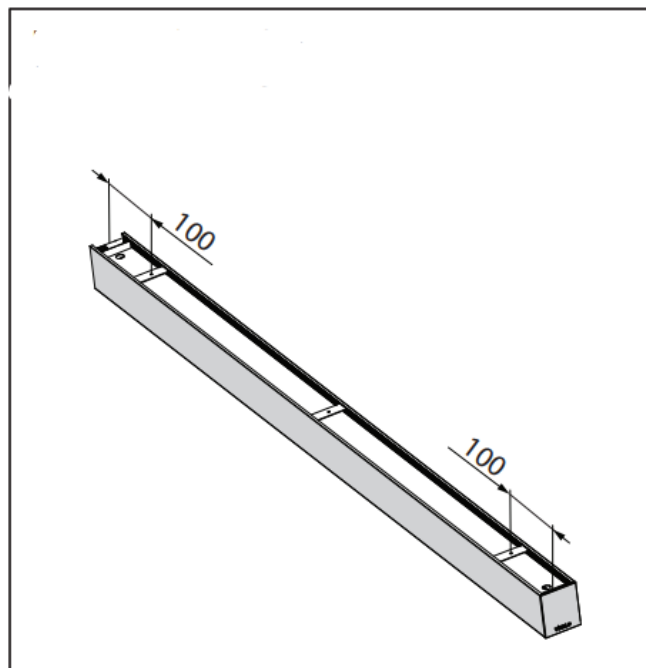
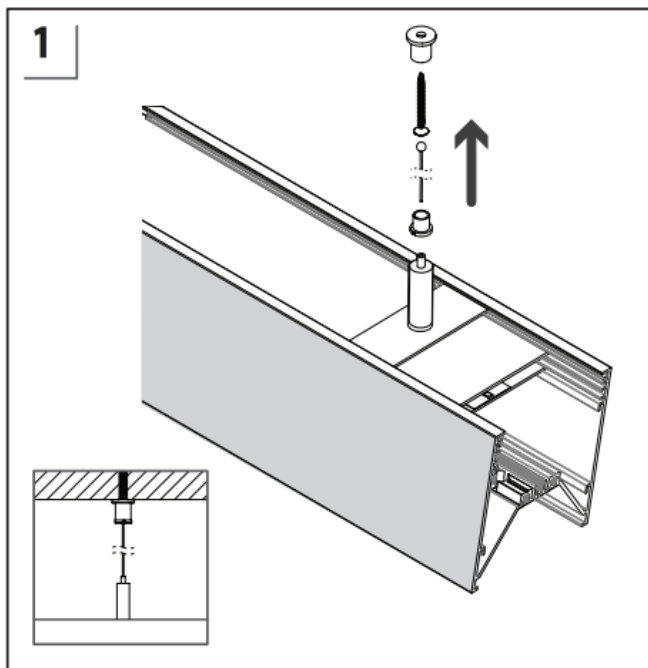

Modules should be parallel, aligned, without a gap in between before installing a connection bracket in order not to create excessive load! Use level to check if modules are parallel

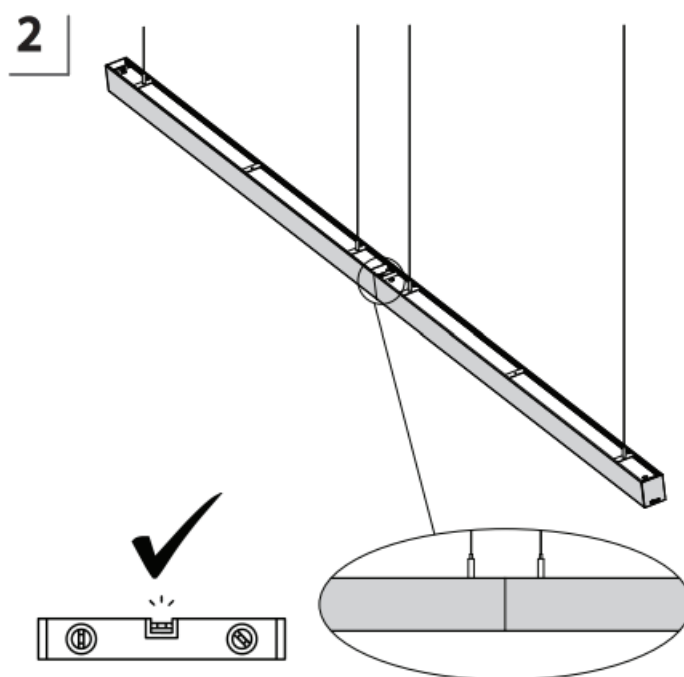

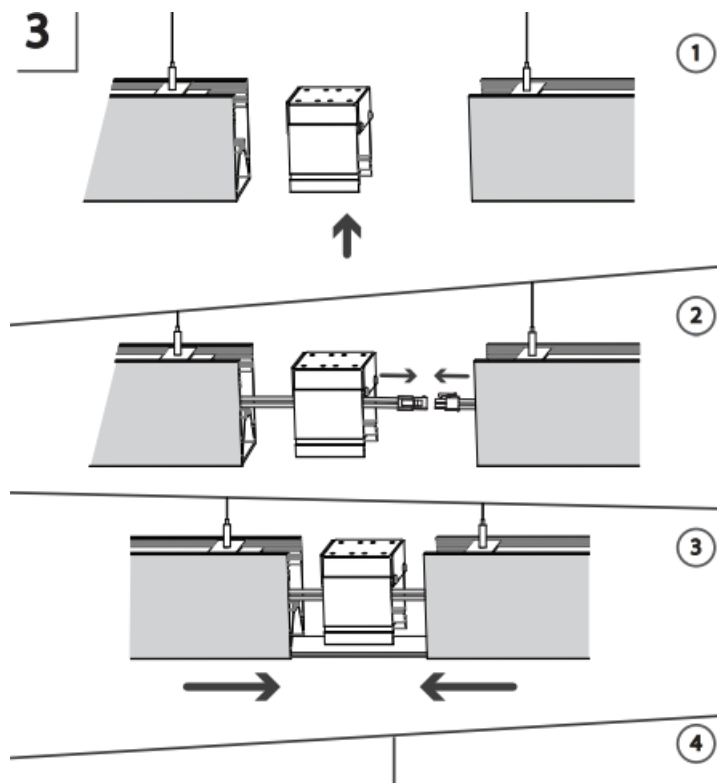

The connection bracket is not designed to handle the excessive load, caused by incorrect luminaire installation!

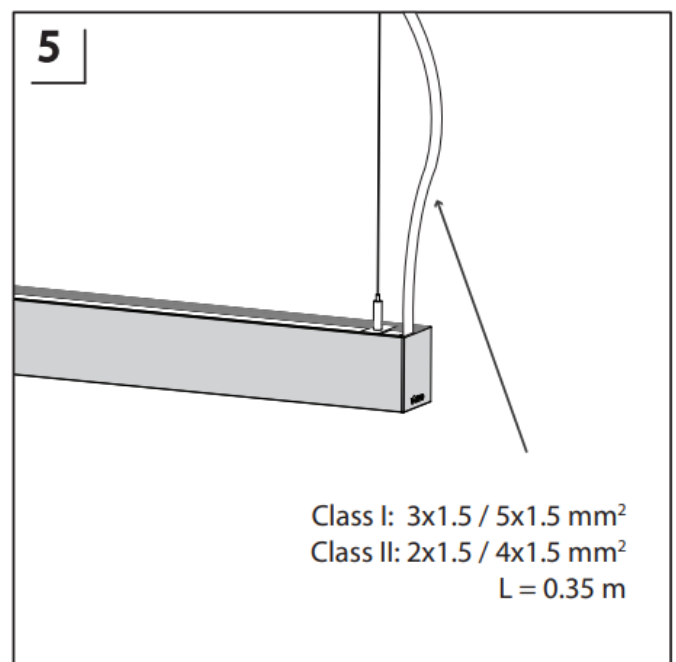
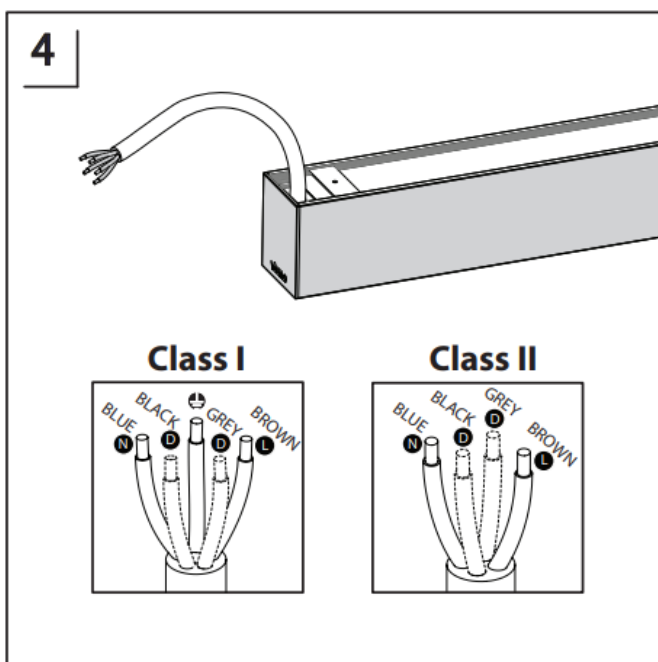
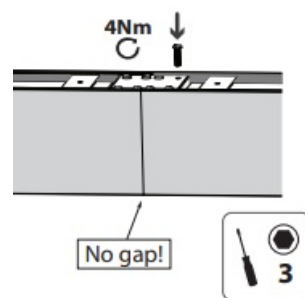

**WARNING!**

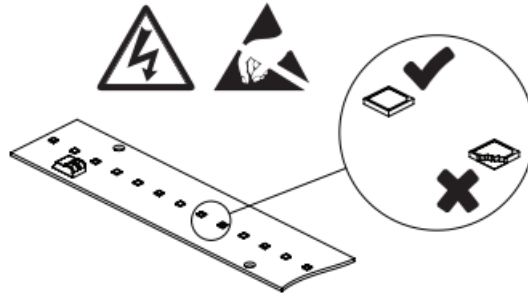

- Do not touch LED modules!
- Do not put any tools or other items on LED modules!
- In case any LED is physically damaged (example shown below) the warranty is void.

### Energy efficiency class of contained light source(s)

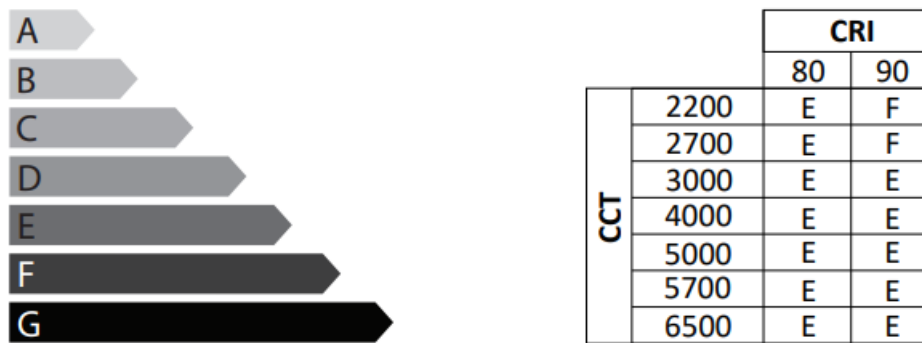

### Terms of use and maintenance

Before the luminaire is turned on, it should be mounted according with this mounting instruction or any other applicable regulations.

### Mounting instructions

Mounting of luminaire must be performed by a qualified person according to the following instructions:

- The warranty of the luminaire does not apply if the mounting of the luminaire has been performed in precipitation (rain, snow, hail).
- The warranty of the luminaire does not apply if a control system unauthorized by VIZULO or an inapplicable LED driver has been used to drive the luminaire.
- The warranty of luminaire does not apply if it has been used in an unsuitable ambient temperature or has been supplied by voltage outside of the specified range.
- The warranty of the luminaire does not apply if the LED driver program has been changed in any way.
- The warranty of the luminaire does not apply if the logged history data of the LED driver has been deleted without the permission of VIZULO.
- The warranty of luminaire does not apply, if it has been mounted at unspecified angles or upside down (luminaire glass directed up), or it has been completely submerged under water.

## Safety instructions

Any actions with the luminaire must be performed by a qualified person, who is certified according with national regulations and requirements. To prevent any accidents person installing the luminaire must follow national safety requirements and following instructions:

- The label containing the technical parameters of the luminaire has to be studied before the work on it has begun.
- Any luminaire build or design changes are prohibited.
- The luminaire must be used in good technical condition and according to this instruction.
- Only VIZULO-authorized spare parts and accessories can be used to repair the luminaire.
- The repair of the luminaire has to be performed by a qualified and certified person.

## Maintenance and repair

Luminaire has to be disconnected from the electrical grid before it is opened and/or repaired!

- The person working with the luminaire must follow national regulations and legislations that apply to the maintenance and testing of electrical or electronic appliances.
- The luminaire may need to be cleaned depending on its environment. Only a damp cloth or a sponge may be used to clean the luminaire. Use only household detergents diluted by water.
- Only VIZULO-authorized spare parts may be used for the luminaire.
- Instruction for changing spare parts must be requested from VIZULO and studied before the repair is attempted.
- LED modules, lenses and LED drivers can be changed on an installed luminaire, but it is advised to perform this task indoors to avoid water entering the luminaire.
- Spare parts (lens, LED modules and drivers) should be ordered from the information available on the luminaire label.

## Documents / Resources

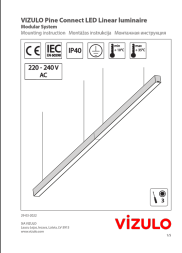
	<p><a href="#">vizulo Pine Connect LED Linear Luminaire Modular System</a> [pdf] Instruction Manual Pine Connect, LED Linear Luminaire Modular System, Pine Connect LED Linear Luminaire Modular System, Linear Luminaire Modular System, Luminaire Modular System, Modular System</p>
---	--