



VIZULO Nest Basic Tilttable LED Downlight Installation Guide

[Home](#) » [VIZULO](#) » VIZULO Nest Basic Tilttable LED Downlight Installation Guide 

Contents

- [1 VIZULO Nest Basic Tilttable LED Downlight](#)
- [2 Dimensions](#)
- [3 Installation instruction for downlight with external driver](#)
- [4 Terms of use and maintenance](#)
- [5 SIA VIZULO](#)
- [6 Documents / Resources](#)
- [7 Related Posts](#)

vizULO

VIZULO Nest Basic Tilttable LED Downlight



Dimensions

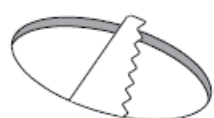
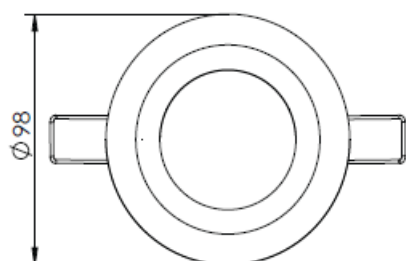
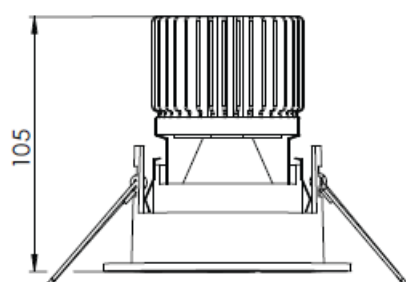

CUT OUT
80 mm

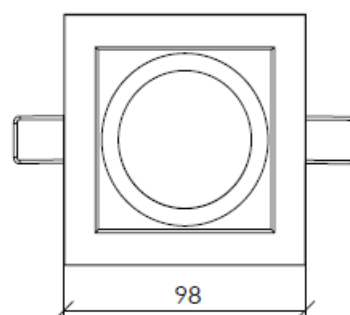
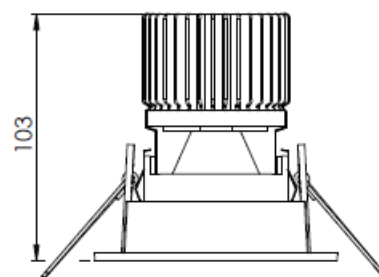

CUT OUT
80 mm

Netto Weight

- 98 mm — 0.34kg
- 98 mm — 0.33kg

Light beam angle adjustment

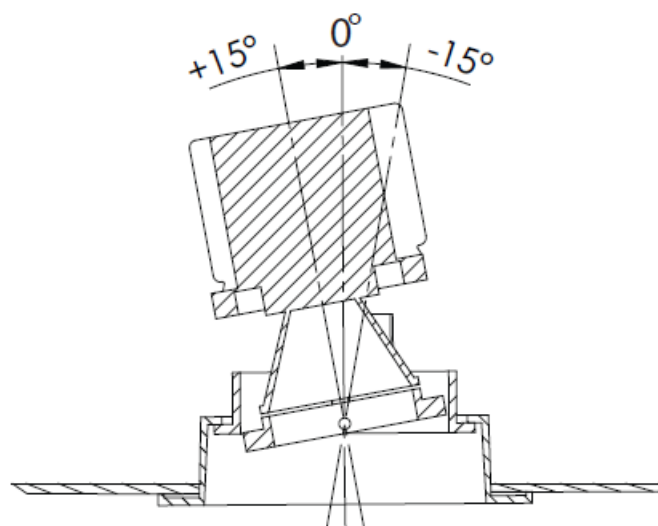

WARNING

- Keep minimal indicated distance from the ceiling!
- Do not cover LED luminaire with thermal insulation material.

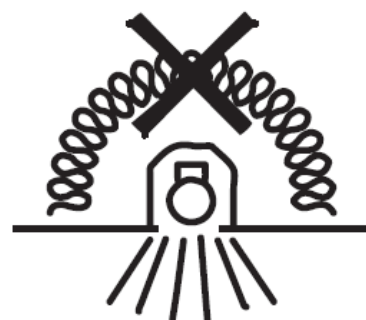
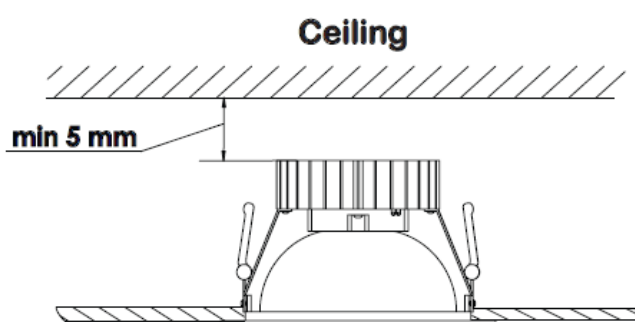

Install LED luminaire only in a clean room using gloves

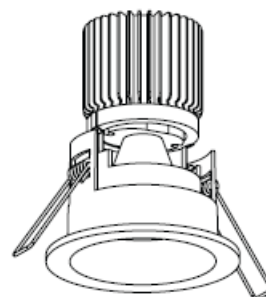

- Diffuser cover may accumulate small electrostatic charges that makes it susceptible to dust and other small particles;
- It should only be cleaned using dry microber cloth or compressed air duster.

Installation instruction for downlight with external driver

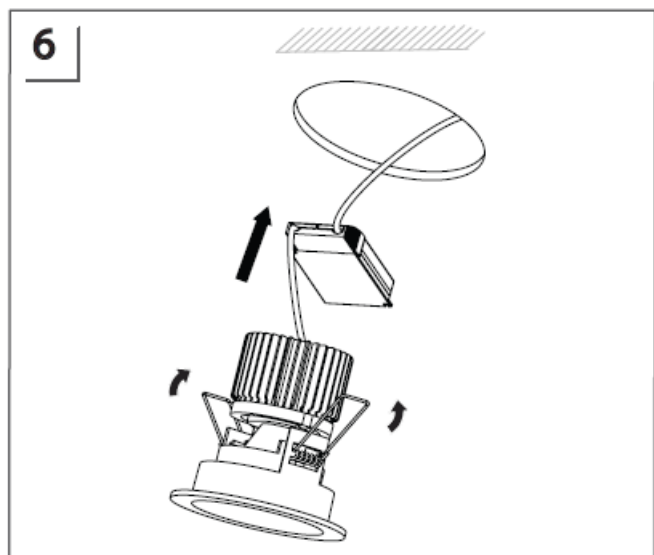
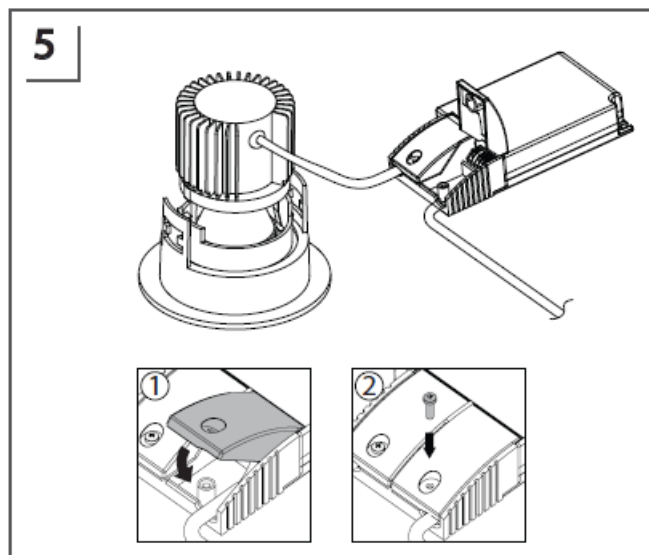
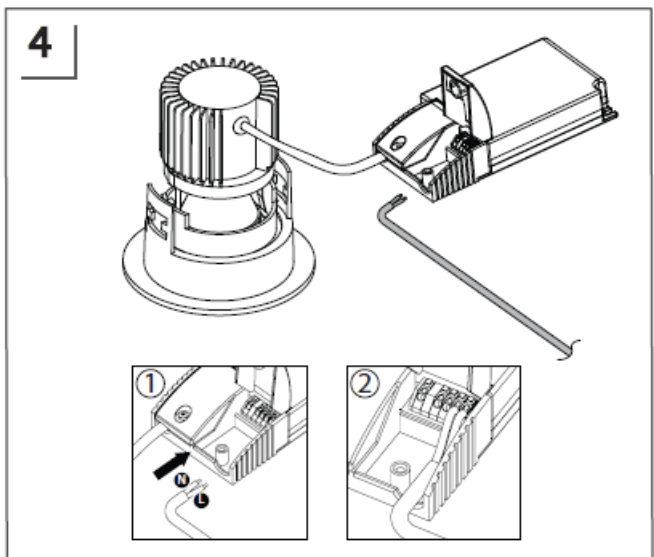
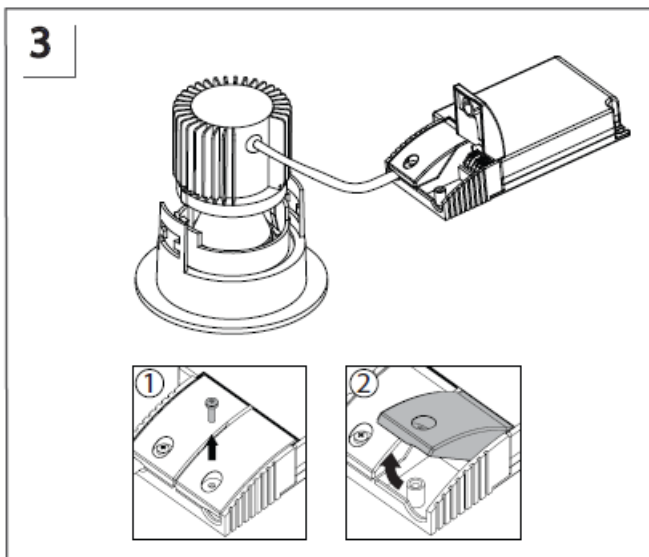
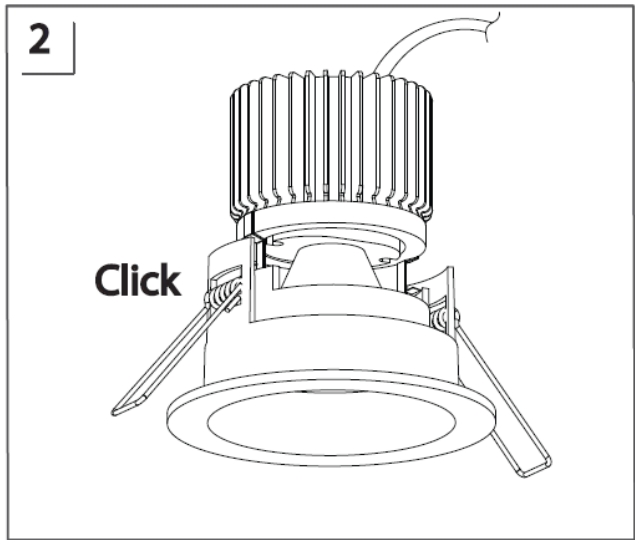
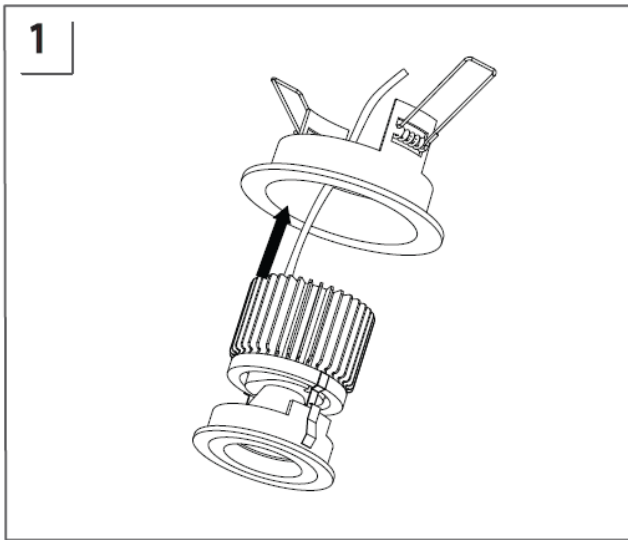

Energy efficiency class of contained light source(s)

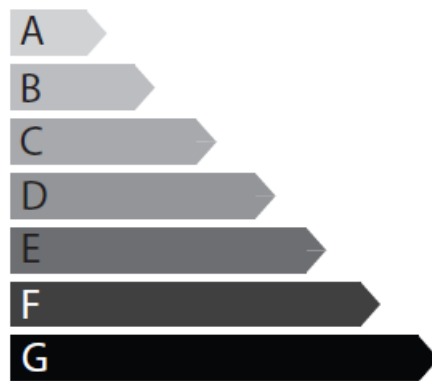

		CRI	
		80	90
CCT	2200	E	F
	2700	E	F
	3000	E	E
	4000	E	E
	5000	E	E
	5700	E	E
	6500	E	E

Terms of use and maintenance

Before luminaire is turned on, it should be mounted according with this mounting instruction or any other applicable regulations.

Mounting instructions

Mounting of luminaire must be performed by a qualified person according with following instructions:

- The warranty of luminaire does not apply, if the mounting of luminaire has been performed in precipitation (rain, snow, hail).
- The warranty of luminaire does not apply, if a control system unauthorized by VIZULO or an inapplicable LED driver has been used to drive the luminaire.
- The warranty of luminaire does not apply, if it has been used in an unsuitable ambient temperature or has been

supplied by voltage outside of the specified range.

- The warranty of luminaire does not apply, if the LED driver program has been changed in any way.
- The warranty of the luminaire does not apply, if the logged history data of the LED driver has been deleted without the permission of VIZULO.
- The warranty of luminaire does not apply, if it has been mounted in unspecified angles or upside down (luminaire glass directed up), or it has been completely submerged under water.

Safety instructions

Any actions with the luminaire must be performed by a qualified person, who is certified according with national regulations and requirements. To prevent any accidents person installing the luminaire must follow national safety requirements and following instructions:

- The label containing technical parameters of the luminaire has to be studied before the work on it has begun.
- Any luminaire build or design changes are prohibited.
- The luminaire must be used in good technical condition and according with this instruction.
- Only VIZULO authorized spare parts and accessories can be used to repair the luminaire.
- The repair of luminaire has to be performed by a qualified and certified person.

Maintenance and repair

Luminaire has to be disconnected from electrical grid before it is opened and/or repaired!

- The person working with the luminaire must follow national regulations and legislations that apply to maintenance and testing of electrical or electronic appliances.
- The luminaire may need to be cleaned depending on its environment. Only a damp cloth or a sponge may be used to clean the luminaire. Use only household detergents diluted by water.
- Only VIZULO-authorized spare parts may be used for the luminaire.
- Instruction for changing spare parts must be requested from VIZULO and studied before the repair is attempted.
- LED modules, lens and LED drivers can be changed on an installed luminaire, but it is advised to perform this task indoor to avoid water entering the luminaire.
- Spare parts (lens, LED modules and drivers) should be ordered from the information available on the luminaire label.

2022-05-20

SIA VIZULO

- Lauču Lejas, Iecava, Latvia, LV-3913
- www.vizulo.com

Documents / Resources

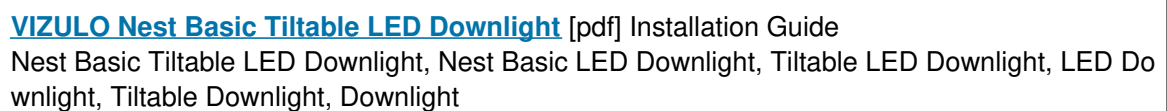

Manuals+