



# VIVOSUN VSV-IFB4 Inline Booster Duct Fan with Speed Controller User Manual

[Home](#) » [VIVOSUN](#) » VIVOSUN VSV-IFB4 Inline Booster Duct Fan with Speed Controller User Manual 

## **VIVOSUN®** VSV-IFB4 Inline Booster Duct Fan with Speed Controller User Manual



Inline Duct Fan  
USER MANUAL

### Contents

- [1 VSV-IFB4 Inline Booster Duct Fan with Speed Controller](#)
- [2 PRODUCT WARNING](#)
- [3 FEATURES & ADVANTAGE](#)
- [4 INSTALLATION](#)
- [5 Documents / Resources](#)
  - [5.1 References](#)

VSV-IFB4 Inline Booster Duct Fan with Speed Controller



What you grow™

## Welcome to VIVOSUN

Thank you for choosing VIVOSUN. We are committed to product quality and friendly customer service. If you have any questions or suggestions, please don't hesitate to contact us,

### PRODUCTS INCLUDED IN THIS MANUAL:

Product	SKU
Inline Booster Duct Fan 4" with Speed Controller	VSV-IFB4
Inline Booster Duct Fan 6" with Speed Controller	VSV-IFB6
Inline Booster Duct Fan 8" with Speed Controller	VSV-IFB8

## PRODUCT WARNING

1. Ensure all parts are included in package.
2. Do not use product if it is damaged (Contact authorized seller immediately for further information).
3. It is important not to touch or install this fan while it is running. The impeller is unguarded, and there is no fan guard included. Furthermore, this fan has sharp edges that may cause physical harm.
4. When installing the fan, connect the air pipes at both ends. Do not connect the filter element directly.
5. Keep away from children.

## FEATURES & ADVANTAGE

1. VIVOSUN fans are designed with superior quality steel for maximum durability.
2. Use VIVOSUN fans as an affordable and efficient way to create the healthiest environment. Applications include but are not limited to:
3. Premium ventilation-quickly and efficiently moving a vast amount of air.
4. Temperature control-cooling rooms that tend to accumulate too much heat or "hot spots." Air purification-removing a large amount of air pollution and pathogens.
5. Use in any environment-commercial or residential.
6. The fan has a governor, which can adjust the product wind speed and air volume according to the demand.

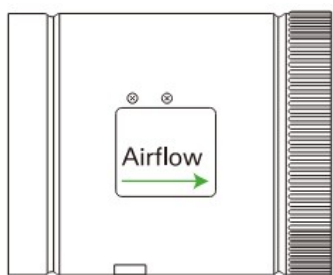

Label on fan indicates  
airflow direction.

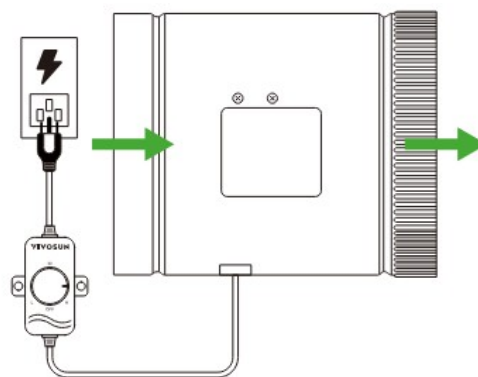

Plug into a power supply.  
Fan turns itself on.

## INSTALLATION

### STEP 1

Check whether the product is intact. If there is no problem, please go to the second step.

### STEP 2

One fan is equipped with two VIVOSUN air pipes, or one air pipe is cut into two sections and placed at both ends of the fan.

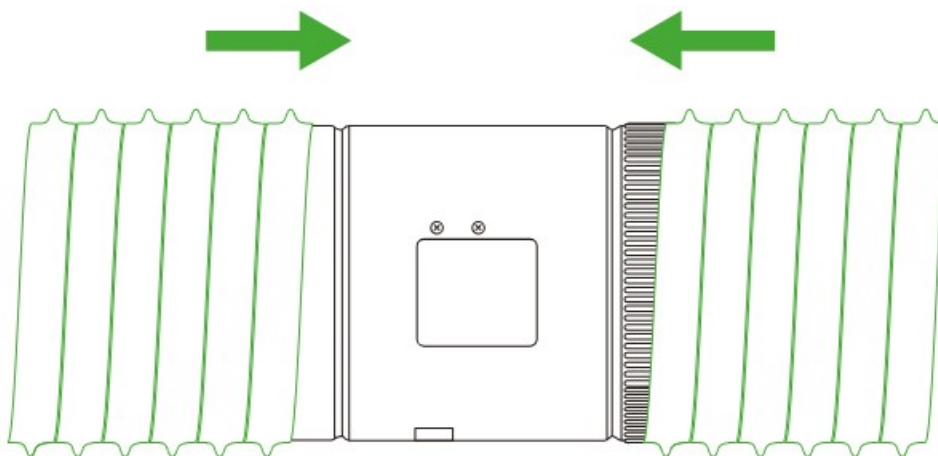

### STEP 3

Clamp (VIVOSUN air duct will be equipped with two clamp) is used to fix the fan and air duct interface,

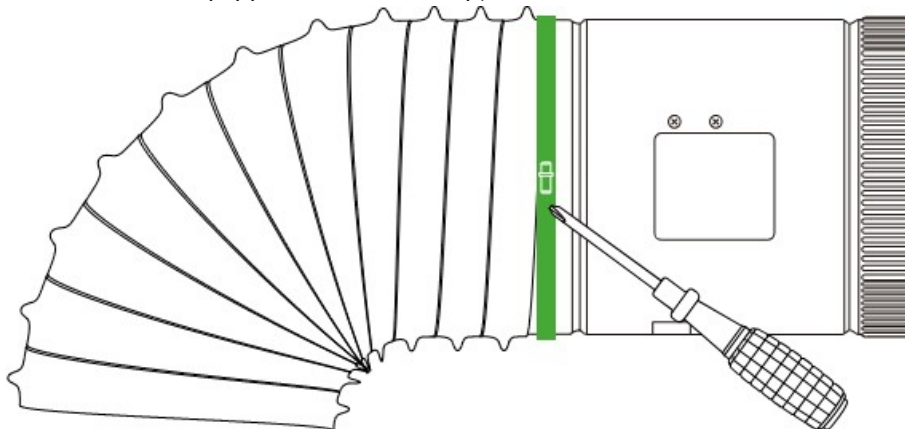

### STEP 4

Place the connected product in the desired place. If you need to hang, you can configure two VIVOSUN hooks for use

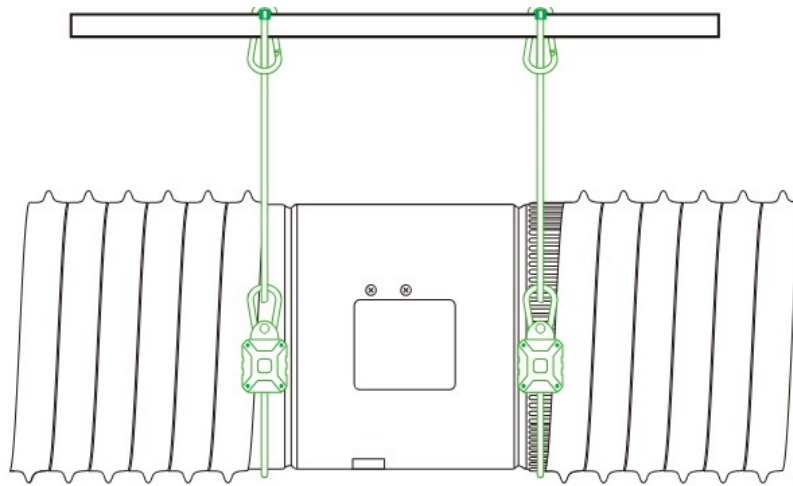

## STEP 5

Check whether the product is installed properly, insert the power supply after no problem, run the product, adjust the governor to the required air volume and wind speed, installation is completed.

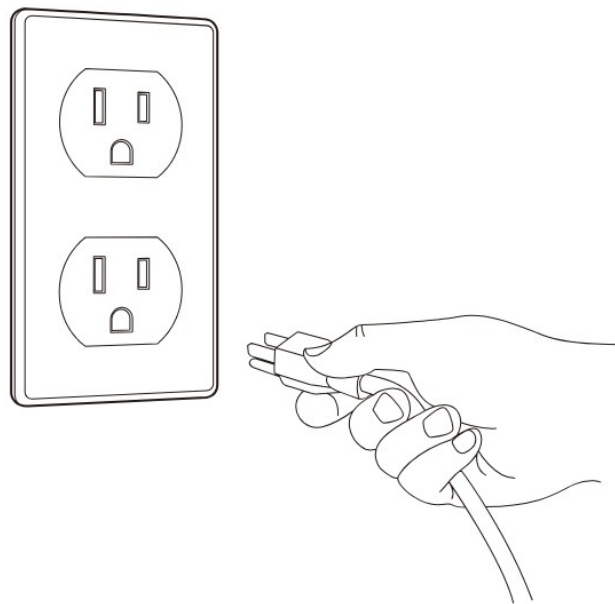

Designed by YIVOSUN in California.  
Made in China

## Documents / Resources

	<p><a href="#">VIVOSUN VSV-IFB4 Inline Booster Duct Fan with Speed Controller</a> [pdf] User Manual VSV-IFB4 Inline Booster Duct Fan with Speed Controller, VSV-IFB4, Inline Booster Duct Fan with Speed Controller, Duct Fan with Speed Controller, Speed Controller, Controller</p>
---	---

## References

- [User Manual](#)

[Manuals+](#), [Privacy Policy](#)

This website is an independent publication and is neither affiliated with nor endorsed by any of the trademark owners. The "Bluetooth®" word mark and logos are registered trademarks owned by Bluetooth SIG, Inc. The "Wi-Fi®" word mark and logos are registered trademarks owned by the Wi-Fi Alliance. Any use of these marks on this website does not imply any affiliation with or endorsement.